

Diversion Dam.  
New York Canal on left Gage is Downstream apx.1 mile.  
Penitentiary Canal, on right face of Dam



New York Gates,0000/00/00 00:00:00



East on Boise Ave., North on Eckert, West into Barber Park.



Rated Section

Ridenbaugh Gage, 0000/00/00 00:00:00



Located off Warm Springs Ave. Inside the Shakespere Festival



FLOW METER ON PUMP

Shakespere Pump,0000/00/00 00:00:00



East Boise Ave. to North on Park River Dr., to first right  
past Rivernest Dr. Access is between house's 3010 & 3018



3' Ramp Flume installed  
3/2011  
Old gage was 3 square ft orifice

Bubb Gage,0000/00/00 00:00:00



Parkcenter Blvd. to Pennsylvania, Then East to  
Pennsylvania Ln., then South to culdesack



4 Square foot fixed orifice

Rossi Mill Gage,0000/00/00 00:00:00



One Block North of Parkcenter Blvd. an Pennsylvania Ave.  
on West side of Parkcenter



Flow Meter On Pump

Meeves Pump,0000/00/00 00:00:00



Warm Springs Blvd. to WarmSprings Golf Course. From parking  
lot gage is in southeast corner of golfcourse.



10 Square foot fixed orifice

Boise City Canal, 2009/04/27 11:02:50



Americana Blvd. to A.M. Park, turn left into park and stay left. Pump is along River.



Flow Meters on Both Pumps

Ann Morrison Park Pump, 2009/04/23 09:46:13



Americana blvd to K.A. Park, turn into park and stay right.  
Pump house is behind trees.



Kathryn Albertson Park Pump, 2009/04/23 10:03:59



Orchard, South To Irving, East to Garden, North to end of road.



Rated Section

Settlers Gage Station, 0000/00/00 00:00:00



Upstream from Settlers Gage Station



Ramp Flume

Davis Canal (Fairview Acres), 0000/00/00 00:00:00



20/26 (Chinden Blvd) to North on Orchard, about 2 blocks to canal. POD is 200 yds upstream



8 Square Foot Office

Thrumman Mill Gage, 0000/00/00 00:00:00



Hyway 44 to south on Veterans Parkway, left on Stilson Rd.,  
to Canal upstream to gage.

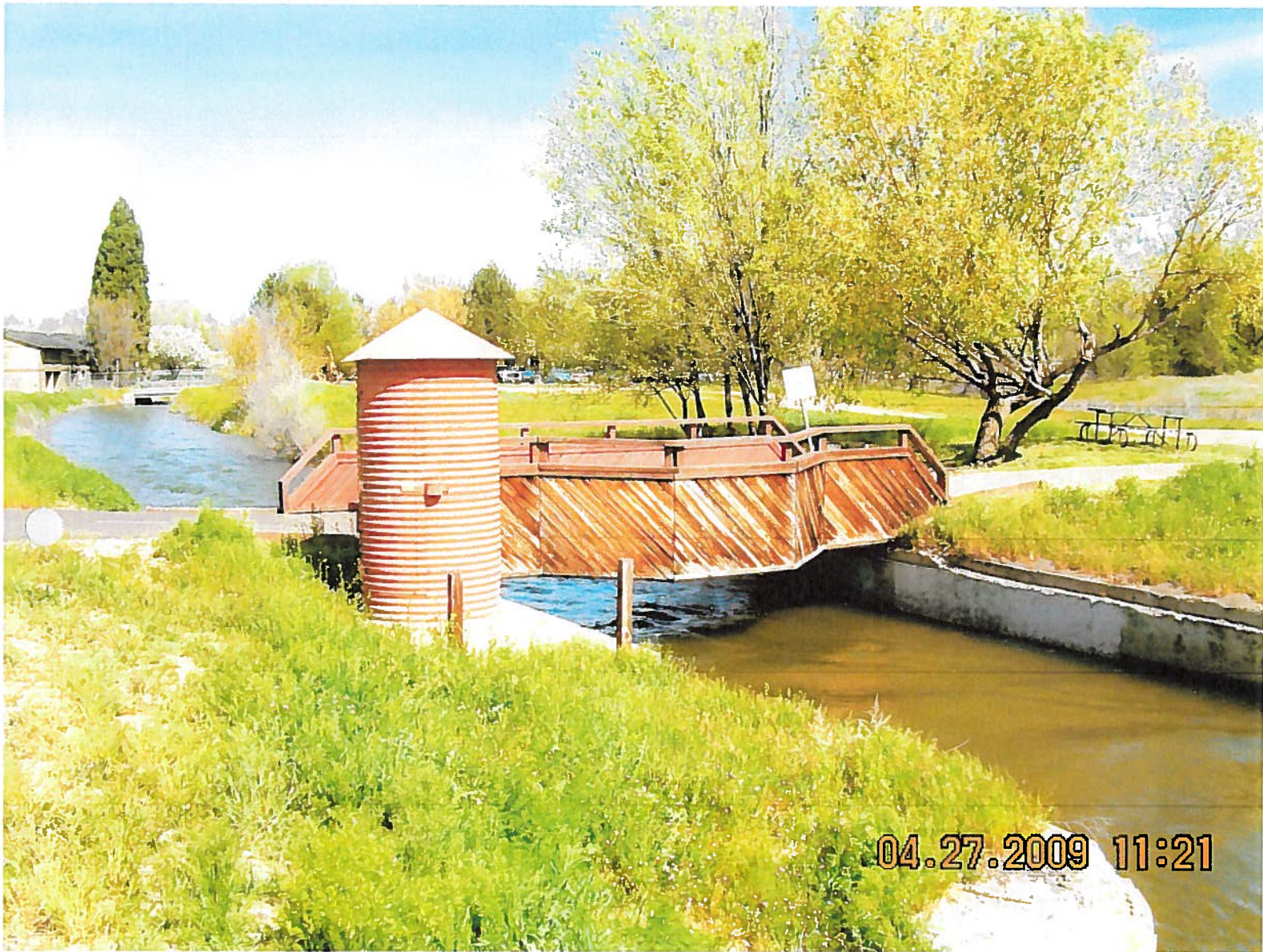

Rated Section

Farmers Union,2009/04/27 11:21:07



Hyway 44 to south on Willow Ln., 2nd canal.



04.27.2009 11:27

10' Cipolletti Weir

Boise Valley, 2009/04/27 11:28:03





**Capital View Pump Station,2009/04/16 11:29:50**

Eagle rd. to Beacon Light, west 1.5 miles to Farmers Union  
Canal, turn right on canal to pump

Flow Meter monitored by  
Farmers Union



Head of Eagle Island. Enter thru Idaho Concrete at the  
Hyway 44 / Hyway 55 junction. Stay on east side of lot to  
bridge over North channel. Cross over to south channel to  
Headgate.

Then upstream along south Channel.



Eagle Island,2009/04/03 11:38:14



Hyway 44 to Arney Ln., south to Riverside Dr., west thru gate  
Code # \*0911



24' Orifice

New Dry Creek, 2009/04/27 11:44:12





Woods H.O. Assoc.,2009/04/13 11:12:21

From New Dry Creek, Stay on Riverside Dr. to W. Pebble Brook Ln. proceed thru gate to left on Winter Wood Ln., then 1st right past brick house on corner, stay on road thru gate then left to headgate. Continue upstream to New Dry Creek POD.

Gate code \*9560

Rect. Weir





**Woods access,2009/04/27 11:54:09**

See Woods H.O. Assoc.

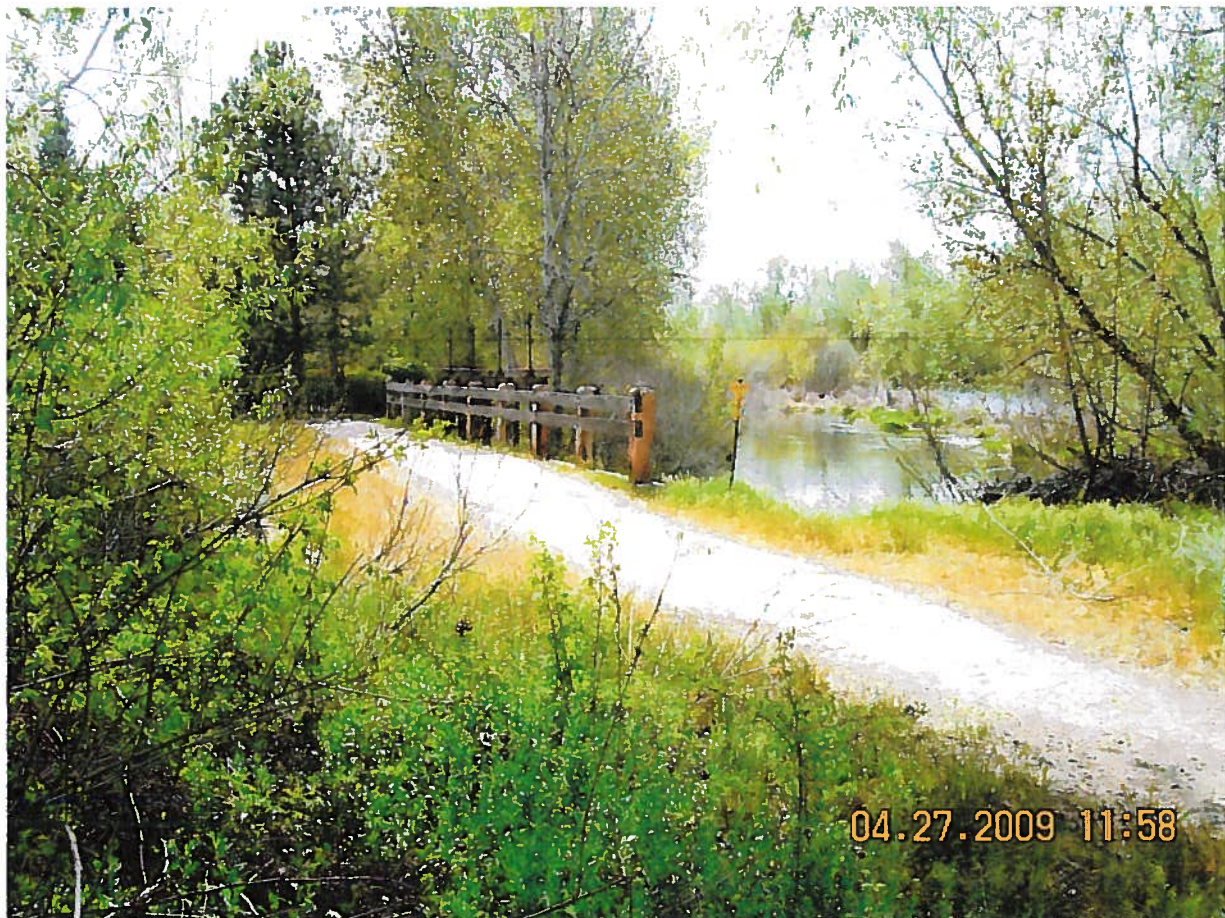

**New Dry Creek POD,2009/04/27 11:58:51**



Hyway 44 to south on Ulmer Ln., west on Charlie to entrance  
to church, right then left onto grass 200 yds to gage.



6' Fixed Orifice

New Union, 2009/04/27 12:10:21



Hyway 44 to Hyway 55. Turn into Idaho Concrete and stay to east side of yard, south to bridge on north channel, cross bridge to river. Headgate is by power pole.



4' rect. weir

Lemp Ditch, 2009/04/03 11:32:43



20/26 to North on Joplin, North on Aspen St. follow the dirt  
rd. past batch plant to river. Then west 100 yds



6' Rect. Weir

Warm Springs Gage,0000/00/00 00:00:00



Hyway 44 to South on Edgewood Ln., follow road to bike path, then west to gates.



2- 4' Square Orfice

Ballentyne Gates, 2009/04/03 11:21:38



Eagle Rd. To Island Wood, East to 1700 Riverchase, Spill is  
along Islandwood. Continue past spill to South on Rivers End  
Dr. South again on private drive to pedestrian path then left  
to head gate.



5' Rect. Weir

Conway Hamming Gate, 2009/04/03 11:07:37









Conway Hamming Spill, 2009/04/03 11:04:25



Eagle rd. to east on River Quarry, east to Lakemoor, right  
to 1845 then right to 335 River Quarry. Walk to back yard



Thomas Aiken,2009/04/17 15:43:21



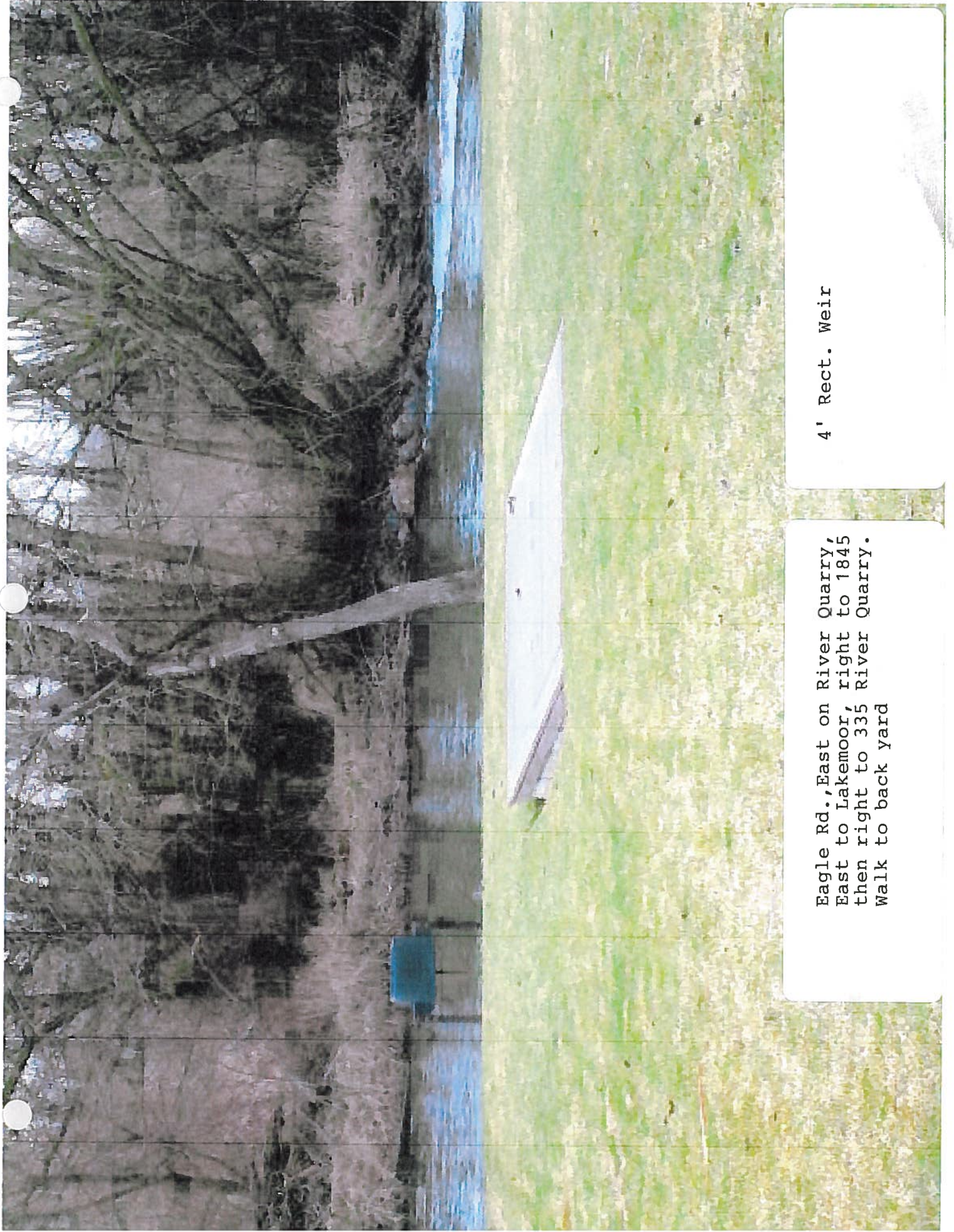

4' Rect. Weir

Eagle Rd., East on River Quarry,  
East to Lakemoor, right to 1845  
then right to 335 River Quarry.  
Walk to back yard



Eagle Rd. to east on River Quarry, east to Lakemoor, right  
to 1845 Lakemoor, walk to back yard.

Gage is under deck.



8' Flume

Mace Catlin, 2009/04/17 15:45:18





4' Rect. Weir

04.03.2009 11:14

**Mace Mace,2009/04/03 11:14:08**

Eagle Rd. & North channel, upstream on south side.



Weir to be installed by 4/01/2010  
South side of North Channel

N 43° 41' 06"  
W 116° 21' 10"

04.03.2009 11:14

**Mace Mace Gate,2009/04/03 11:14:57**



Hyway 44 to south on Linder, east to Eagle Island State Park,  
Site is located in northeast corner of property past old  
prison farm buildings.



6' Rect Weir

Hart Davis Ditch, 2009/04/21 08:52:08





Middleton Gage Station, 2009/04/13 12:04:24

Hyway 44 to south on Old Valley Rd, east on canal to gage.

15' Ramp Flume  
Installed 2/2011



20/26 to North on Locust Grove, left at S.Chipper Way sign, down  
the hill to left on dirt rd. pump is at end of road by river.



Hour Meter on Pump used  
with rating curve

Barber Pump,0000/00/00 00:00:00



Hyway 44 to South on Linder, East on Hatchery, South on Trout to Fish Hatchery. Proceed through compound to gate, then thru gate to canal, east to gage.



12" 45 degree Trapezoidal Flume

Seven Suckers, 2009/04/27 13:36:47



Hyway 44 to south on Linder, east at south channel on south side.  
Eueka #1 is first.



Rated Section

Phyliss Canal, 2009/04/28 09:15:42





5' Variable Orifice

Eureka #1, 2009/04/28 09:16:36



Hyway 44 to South on Linder, access is along north side of  
north channel, west of Linder



10 Square Foot Orfice

Little Pioneer, 2009/04/27 13:13:56



Hyway 44 to south on Star rd., east on Main St. Gage is on  
North Side of River 100 yds from Star Rd.



Rated Section

Canyon County Ditch, 0000/00/00 00:00:00



Star Rd. to West on Joplin, to North at 6622 Joplin Rd,  
North to canal, upstream to gage station.



4- 3.5 wide variable orifice's

Caldwell Highline, 2009/04/03 13:43:26



Hyway 19/ Simplot Blvd to Johnson Ln., then North to canal,  
west to gage Station.



Rated Section

Riverside Gage Station, 2009/04/03 15:40:02



Simplot Blvd./Hyway 19 West to Wagner Rd. then North to  
Riverside Canal, East on canal to headgates.



Un-used Section. 1/3 of  
Riverside is Charged to  
Pioneer Dixie

Pioneer Dixie Gage, 2009/04/03 15:48:23





Co-Op Diversion ,0000/00/00 00:00:00

Old Hyway 30 and River Rd.

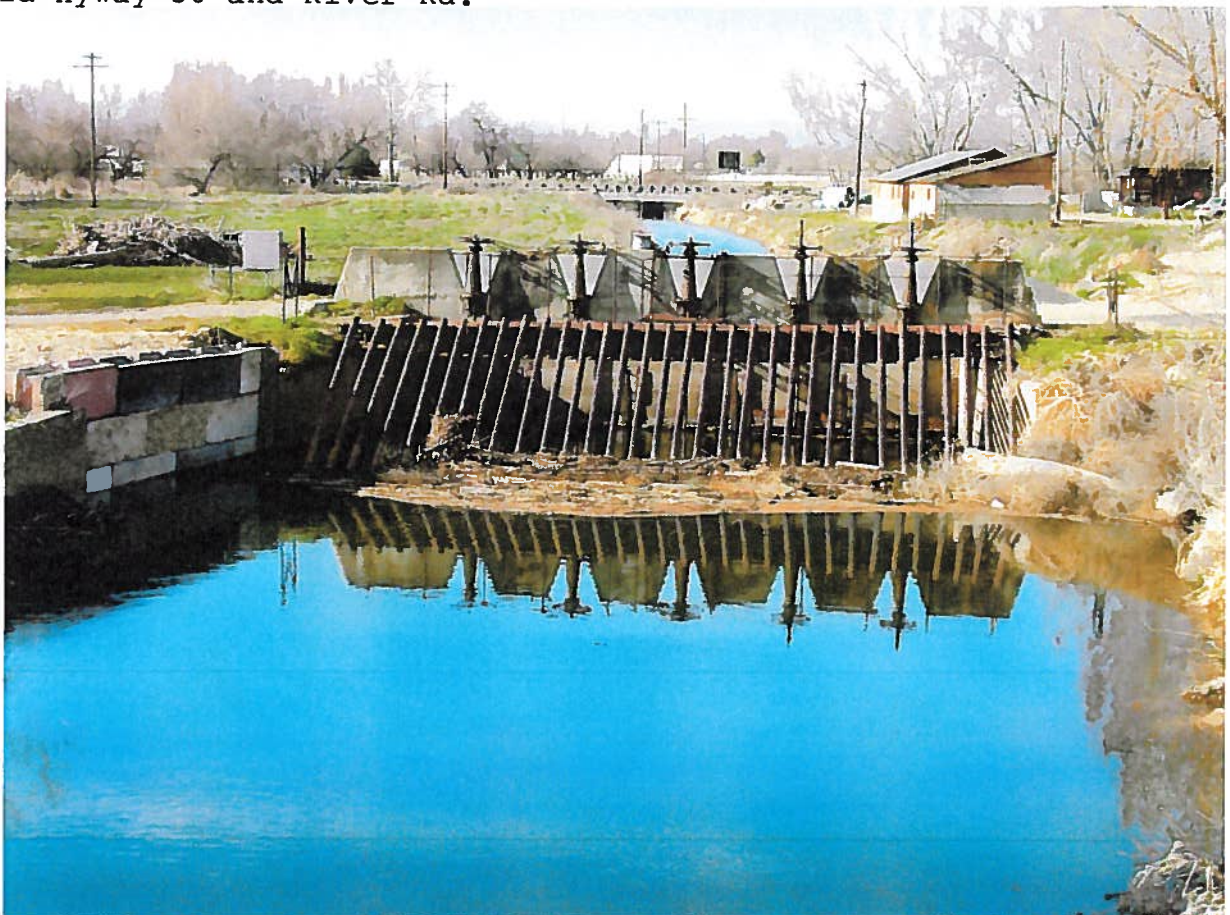

Farmers Co-Op Gates,0000/00/00 00:00:00



20/26 to east on Green Rd., South on canal under, freeway  
upstream to gage station.



RATed Section

Co-Op Gage Station,0000/00/00 00:00:00



Old Hyway 30 and River Rd.



2- 10 Square Foot orfices

Campbell Canal, 0000/00/00 00:00:00



Hyway 20/26 to Pond Rd., south to canal, east to gage.  
Access thru Centennial park also.



3' Parshall Flume

Siebenburg Ditch, 2009/04/21 10:34:43



Hyway 19 to North on Weitz Rd. , Straight on dirt, right then left to canal. Upper Center Point is next to Eureka #2.



10' Parshall Flume

Eureka #2,2009/04/03 15:59:38



See directions to Eureka #2.  
Note: Simplot pump is in Background.



4' Variable Orifice

Upper Center Point, 2009/04/03 16:00:04



Past Eureka # 2 cross bridge and bear right. Go to end of road  
gate is on corner. This is also access to Atwell Ditch.



Rated Section

McManus Teater Gage, 2009/04/03 16:09:07



See McManus Teater:



4 Square Foot Orifice

Atwell Ditch, 2009/04/03 16:07:52



Weitz road to Dixie River road, North to curve, go straight  
on farm road to canal, west to gage.



6 ' Variable orifice

Lower Center Point Gage Station, 2009/04/03 16:23:56



20/26 to Notus Rd., south to Boise River Rd., west to 21480  
Boise River Rd. Access is past house on farm road to canal  
then upstream



Rated Section

Bowman Swisher Gage, 2009/04/28 13:59:04



Hyway 20/26 to mile marker14, south thru ranch to canal, then  
upstream to gage.



4' Rated Section

Baxter Ditch,2009/04/29 10:36:39



Hyway 20/26 to Gotsch Rd., south thru feedlot, stay to the left on dirt road about 1/2 mile to gage.



5' Rect. Weir

Andrews Ditch, 2009/04/29 10:24:51



From Hass gage turn left on next road, proceed to house then left. Stay on road to headgate, then left to gage



8' Rated Section

Island Highline,2009/04/29 09:43:35



Hyway 20/26 to Wamstead Rd., south to Lee Ln. 1/2 mile to gate,  
then east up canal to gage.



4' Parshall Flume

Hass Ditch, 2009/04/20 16:31:11



Follow Hass ditch to upper Hass gate.



3' Rect. Weir

Upper Hass,2009/04/28 13:10:32



Hyway 95 and Tree Top Ranches. Enter on farm access road and proceed west to end of pavement then westerly to canal, then north to gage station.



10' Rated Section

Parma Ditch Gage, 0000/00/00 00:00:00





Crawforth Pump,2009/04/14 11:17:47

Wamstead to Hexon, 1/4 mile east of River bridge south side

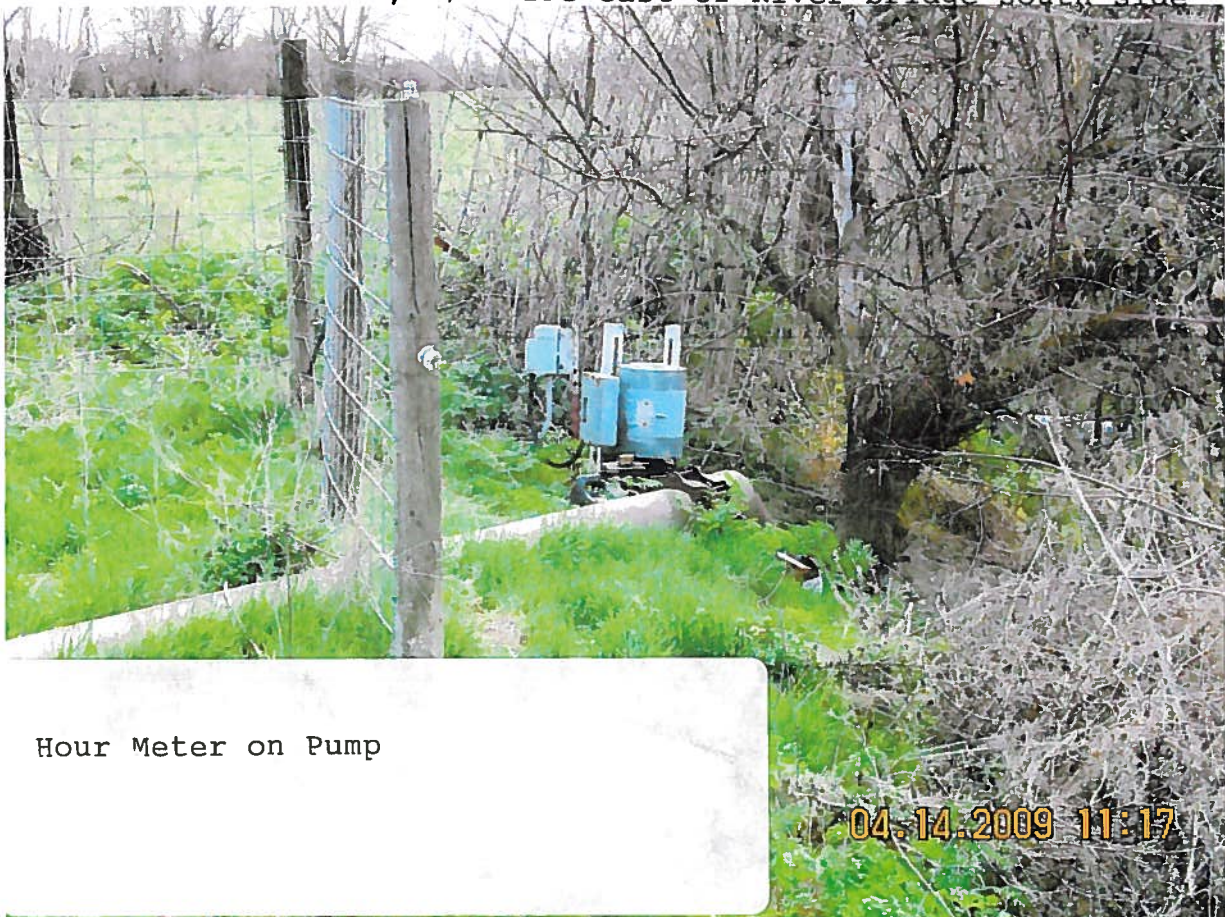

Hour Meter on Pump

Crawforth Pump,2009/04/14 11:18:03



Hyway 20/26 in Parma, south on Roswell Rd., west on Hexon Rd.  
Cross Boise River, then south to gates.



McConnell Island Gates, 0000/00/00 00:00:00





12' Rated Section

McConnell Island Gage, 0000/00/00 00:00:00



Located in the Southwest Corner of Ann Morrison Park



Drainage District #3,0000/00/00 00:00:00



(see Barber Pump) Gage is located 1/2 before pump station.



Thurman Drain, 2009/04/27 08:38:23





**Eagle Drain,2009/04/20 13:05:42**

Hyway 44 1/4 mile west of Eagle Rd.



**Eagle Drain Gage,2009/04/20 13:06:01**



Joplin Road to Lincoln, 1/2 mile east of Midland Blvd.



5 Mile Drain Gage, 2009/04/03 14:38:24



Middleton Road and Hyway 44, north side



North Middleton Drain, 2009/04/17 09:59:34



Hyway 44, 1/4 mile east of Duff Ln



Long Feeder, 2009/04/04 08:52:43



Hyway 44, 1/4 mile east of Duff ln.



Watts Check,2009/04/04 08:52:16



On Middleton Road 1/4 mile south of Hyway 44  
Gage is under old bridge



04.17.2009 09:57

South Middleton Drain, 2009/04/17 09:57:13



Hyway 44 to south on Wiffen Ln. drive thru City yard to get to site.



Willow Creek, 2009/04/17 10:07:31



Hyway 44 to south on Middleton Rd., west on Lincoln Rd., to north on Mason Rd., turn west at farm house then northwest to silo. Gage is downstream 100 yds.



Mason Creek Gage, 2009/04/21 10:17:32



From Mason Creek west on farm road to gage site.  
From Lincoln Rd., north on Teton, east on Polk.



Mason Drain, 2009/04/07 11:02:01



Hyway 44 to south on channel rd.,right to Curtis Park Ln.,  
south to drain



Hartley Drain (East),2009/04/17 10:15:26



Hyway 44 to south on Channel Rd., west to intersection of  
Channel and River, 1/4 mile west of intersection.



Hartley Gluch (West),2009/04/17 10:18:47



Hyway 19/ Simplot Blvd. to Johnson Ln, North to canal, east to Indian Creek. Gage is on downstream side, right bank. Gage is in lower center of picture.



Indian Creek Gage,2009/04/03 15:37:51



Hyway 20/26 one block past Black Canyon I.D. on North side



Conway Drain,0000/00/00 00:00:00





**Dixie Drain, 2009/04/08 11:15:22**  
4 miles west of Bowman Swisher turn off.



**Dixie Drain Gage, 2009/04/08 11:15:44**