

WATER DELIVERIES BY WATERMASTER

WATER SHORTAGES

Contact Watermaster to regulate diversions.

WATERMASTER

Delivers on priority basis, oldest right 100%, then next right 100% and so on until all water delivered.

BENEFICIAL USE

Must occur for water to delivered.

FUTILE CALL

Junior water called for by senior right must reach senior diversion point and then senior place of use or cannot be delivered.

TRIBUTARIES

Not regulated unless problem identified.

NOTE: in 57-B, all five creeks are covered as main sources so can be regulated by Watermaster. Example of a tributary source in this water district would be Little Hart Creek, not expected to be regulated unless problem occurs. IDWR will assist Watermaster in handling tributary issues.

The five source creeks are Bates, Browns, Catherine, Hart, and Pickett.

GUIDELINES

See handout "Water District Guidelines Established By IDWR" for more details about how a water district should work.

from old Decree plus licenses & permits

*MPOD: Y = Multiple Pts of Diversion, Pod Diversion Rate(s) is 0
 U = Multiple Pts of Diversion, Pod Diversion Rate(s) Not 0
 N = No Multiple Pts of Diversion (only 1)

WATER RIGHT NUMBER	OWNER NAME	PRIORITY DATE	POINT OF DIVERSION	TOTAL DIVERSION	POD DIVERSION NAME	*M P U O S D E
WATER SOURCE: BATES CREEK						
57-00047	LINEHAN, NORA	C 04/01/1876	D	1.364 CFS		N 01
57-02004	LINEHAN, NORA	C 03/15/1905	L 04S 01W 29 NWSW	0.800 CFS		N 01
57-00077	LINEHAN, NORA	C 04/01/1907	D	1.740 CFS		N 01
WATER SOURCE: BROWN CREEK						
57-00055	BROWN, G. F.	C 03/16/1885	D 05S 01W 24 NWNE	3.360 CFS		N 01
57-00072B	CAROTHERS, JAMES F.	C 10/01/1901	D 05S 01W 27 SWSW	0.500 CFS		N 01
57-00072A	CAROTHERS, JAMES	C 10/01/1901	D 05S 01W 24 NWNE	0.400 CFS		N 01
57-00074A	CAROTHERS, J. F.	C 04/01/1904	D 05S 01W 24 NWNE	0.800 CFS		N 01
57-00074B	CAROTHERS, JAMES F.	C 04/01/1904	D 05S 01W 27 SWSW	1.071 CFS		N 01
57-00079	KOEPPE, WILLIAM	C 03/11/1908	D 05S 01W 24 NWNE	1.840 CFS		N 01
57-00081	KOEPPE, WILLIAM	C 07/19/1908	D 04S 01E 31 SWSW	1.000 CFS		N 01
WATER SOURCE: CATHERINE CREEK						
57-00039	NEIL, J. M.	C 04/01/1868	D	3.180 CFS		N 01
57-00040A	HUNT, CORA MAUDE	C 10/01/1869	D 04S 01E 29 SWSE	2.880 CFS		N 01
57-00040B	NEIL, J. M.	C 10/01/1869	D	5.160 CFS		N 01
57-00049	NEIL, J. M.	C 01/14/1879	D	6.360 CFS		N 01
57-00050	NEIL, J. M.	C 04/05/1879	D	4.200 CFS		N 01
57-00054	NEIL, J. M.	C 01/08/1884	D	0.480 CFS		N 01
57-00058	HYDE, B. H.	C 04/01/1885	D	0.700 CFS		N 01
57-00069	NEIL, J. M.	C 04/01/1896	D	2.580 CFS		N 01
57-00070	NEIL, J. M.	C 04/01/1897	D	3.060 CFS		N 01
57-02010	DAVIES, HERBERT H.	C 12/02/1907	L 04S 01E 27 NESW	0.900 CFS		N 01
57-00078	HENDERSON, THOMAS	C 05/22/1908	D 04S 01E 26 SWNW	0.320 CFS		N 01
57-00080	HENDERSON, THOMAS	C 05/22/1908	D 04S 01E 26 SWNW	0.380 CFS		N 01
57-02259	COX, WILLIAM E.	C 01/09/1963	L 04S 01E 23 NESE	10.400 CFS		Y 01
57-02259	COX, WILLIAM E.	C 01/09/1963	L 04S 01E 26 NWNW	10.400 CFS		Y 01
57-02259	COX, WILLIAM E.	C 01/09/1963	L 04S 01E 26 SWNW	10.400 CFS		Y 01
* WATER SOURCE: GROUNDWATER						
57-07564	MURDOCH, DENNIS	C 09/01/1992	P 04S 01E 24 NWSW	3.370 CFS		Y 01
57-07564	MURDOCH, DENNIS	C 09/01/1992	P 04S 01E 26 NWNE	3.370 CFS		Y 01
57-07564	MURDOCH, DENNIS	C 09/01/1992	P 04S 01E 24 SWNW	3.370 CFS		Y 01
57-07585	JONES, JOHN W	C 02/23/1993	P 04S 01E 30 SWSWNW 2	0.400 CFS		N 01
57-07582	JOHNSTON, J SHERAL	C 12/22/1993	P 04S 01W 24 SESE	0.200 CFS		N 01

DELIVERABLE WATER RIGHTS

** ground water (wells) - unlikely to be regulated by watermaster*

*MPOD: Y = Multiple Pts of Diversion, Pod Diversion Rates) is 0
 U = Multiple Pts of Diversion, Pod Diversion Rates) Not 0
 N = No Multiple Pts of Diversion (1 or less)

*Recommended
 w SRBA
 - Not yet decreed -*

WATER RIGHT NUMBER	CURRENT OWNER NAME	PRIORITY DATE	S T G	POINT OF DIVERSION	F L G	TOTAL DIVERSION	POD DIVERSION NAME	M P O S D E
--------------------	--------------------	---------------	-------	--------------------	-------	-----------------	--------------------	-------------

WATER SOURCE: BATES CREEK

57-00047	PARKINSON, JOSEPH L	04/01/1876	D	04S 01W 29	NWSM	1.050 CFS		N 01
57-00077	PARKINSON, JOSEPH L	04/01/1907	D	04S 01W 29	NWSM	0.700 CFS		N 01

WATER SOURCE: BROWNS CREEK

57-00055	COX, SHIRLEY	03/16/1885	D	05S 01W 24	NEWNE	3.360 CFS		N 01
57-00072	COX, SHIRLEY	10/01/1901	D	05S 01W 24	NEWNE	0.900 CFS		N 01
57-00074	COX, SHIRLEY	04/01/1904	D	05S 01W 24	NEWNE	1.870 CFS		N 01
57-00079	COX, SHIRLEY	03/11/1908	D	05S 01W 24	NEWNE	1.840 CFS		N 01
57-00081	COX, SHIRLEY	07/19/1908	D	05S 01W 24	NEWNE	0.810 CFS		N 01

WATER SOURCE: CATHERINE CREEK

57-00039	WHITE, WILLIAM	04/01/1868	D	04S 01E 30	NWWSM	0.610 CFS		N 01
57-00078	MURDOCH, DENNIS	05/22/1907	D	04S 01E 26	NESEMU	0.320 CFS		N 01
57-00080	MURDOCH, DENNIS	05/22/1908	D	04S 01E 26	NESEMU	0.380 CFS		Y 01
57-02259	MURDOCH, DENNIS	05/22/1908	D	04S 01E 23	SWNESE	0.380 CFS		Y 01
57-02259	MURDOCH, DENNIS	01/09/1963	L	04S 01E 23	SWNESE	0.780 CFS		Y 01
57-02259	MURDOCH, DENNIS	01/09/1963	L	04S 01E 26	NESEMU	0.780 CFS		Y 01

WATER SOURCE: HART CREEK

57-00038	WHITE, BEVERLY	04/01/1866	D	04S 01W 35	NENENE	2.840 CFS		N 01
57-00059	COX, SHIRLEY	03/01/1886	D	05S 01W 5	NESESE	0.290 CFS		N 01
57-00071	BACHMAN, HELEN JOAN	04/01/1901	D	05S 01W 19	SENWNU	0.850 CFS		N 01
57-00073	JESS, GEORGE W	04/01/1902	D	05S 01W 4	SWMENE	0.260 CFS		N 01
57-00075	COX, SHIRLEY	04/01/1905	D	05S 02W 24	NESW	0.320 CFS		N 01
57-02199	GIUSTI, ELVA MARIE	04/20/1951	L	04S 01W 35	MENE	1.000 CFS		N 01

WATER SOURCE: PICKETT CREEK

57-00046A	PARKINSON, JOSEPH L	03/31/1868	D	04S 01W 28	SENU	0.540 CFS		Y 01
57-00046A	PARKINSON, JOSEPH L	03/31/1868	D	04S 01W 21	SESE	0.540 CFS		Y 01
57-00047B	WHITE, WILLIAM	02/14/1870	D	04S 01W 24	SESESM	0.540 CFS		N 01
57-00047A	JONES, JOHN WILLIAM	02/14/1870	D	04S 01W 24	NESESM	0.400 CFS		N 01
57-00046B	PARKINSON, JOSEPH L	08/28/1875	D	04S 01W 28	SENU	0.700 CFS		Y 01
57-00046B	PARKINSON, JOSEPH L	08/28/1875	D	04S 01W 21	SESE	0.700 CFS		Y 01
57-00051	PARKINSON, JOSEPH L	04/01/1880	D	04S 01W 31	NESE	1.520 CFS		N 01
57-00053	STAHL, ELMER	04/01/1882	D	04S 01W 25	NEWNE	1.390 CFS		Y 01
57-00053	STAHL, ELMER	04/01/1882	D	04S 01W 24	SESESM	1.390 CFS		Y 01

*RECOMMENDED RIGHTS SRBA - DO NOT
 USE TO DELIVER - FOR INFO.
 USE ONLY*

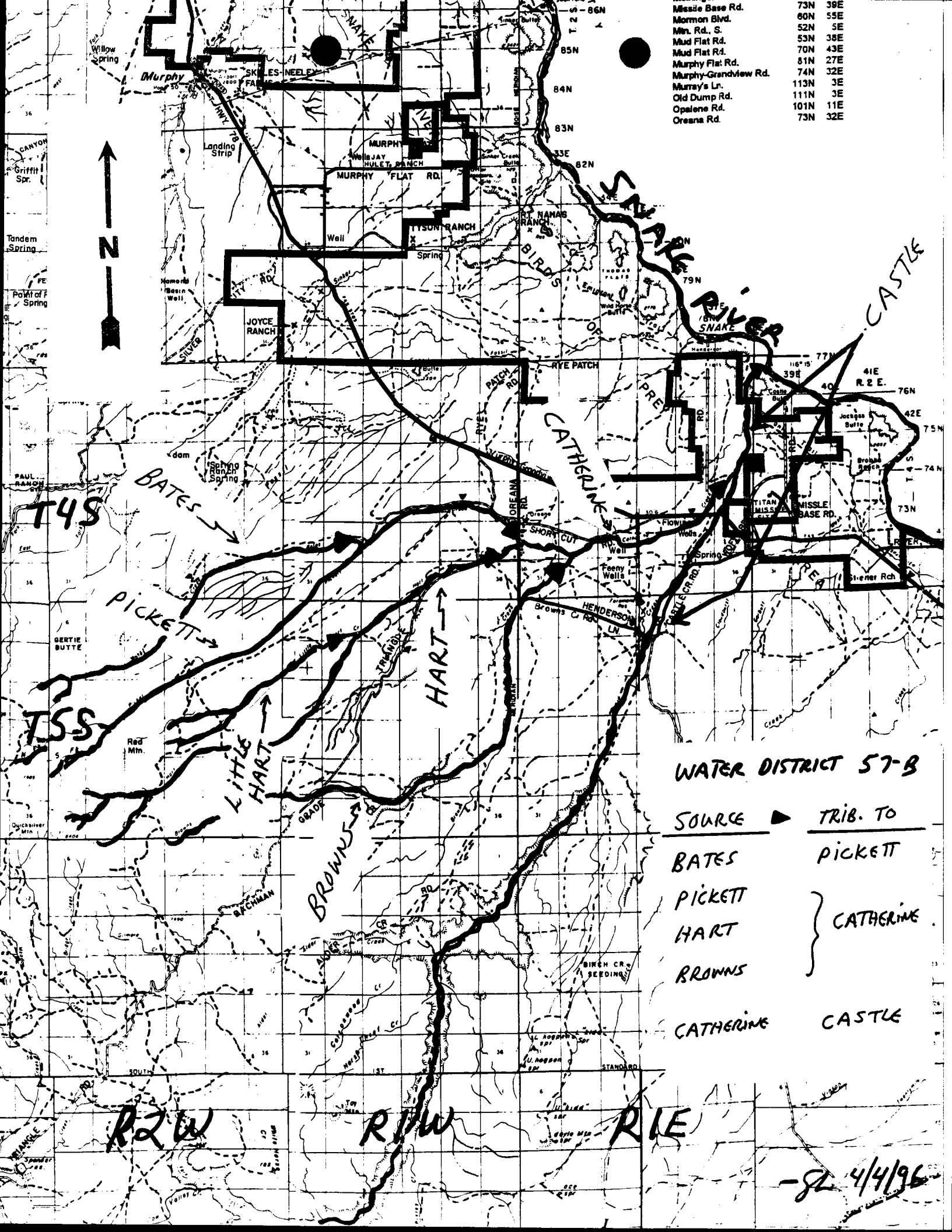

- Missile Base Rd. 73N 39E
- Mormon Blvd. 60N 55E
- Mn. Rd. S. 52N 5E
- Mud Flat Rd. 55N 38E
- Mud Flat Rd. 70N 43E
- Murphy Flat Rd. 81N 27E
- Murphy-Grandview Rd. 74N 32E
- Murray's Ln. 113N 3E
- Old Dump Rd. 111N 3E
- Opalene Rd. 101N 11E
- Oreana Rd. 73N 32E



T4S

T5S

R2W

R1W

R1E

WATER DISTRICT 57-B

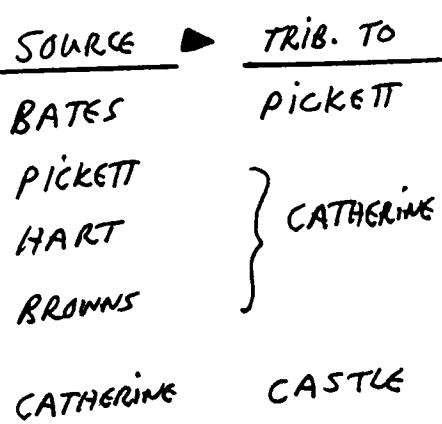

-82 4/4/96

*MPOD: Y = Multiple Pts of Diversion, Pod Diversion Rate(s) Is 0
 U = Multiple Pts of Diversion, Pod Diversion Rate(s) Not 0
 N = No Multiple Pts of Diversion (1 or less)

WATER RIGHT NUMBER	CURRENT OWNER NAME	PRIORITY DATE	T	G	POINT OF DIVERSION	F	L	TOTAL DIVERSION	POD DIVERSION NAME	D	S	U
57-00060	WHITE, WILLIAM	04/01/1886	D	04S	01W 24	SESESW		3.350 CFS				N 01
57-00063	PARKINSON, JOSEPH L	04/15/1886	D	04S	01W 22	SENESSW		2.190 CFS				Y 01
57-00063	PARKINSON, JOSEPH L	04/15/1886	D	04S	01W 22	SNNESSW		2.190 CFS				Y 01
57-00064	ROBINSON, MERVILLE A	05/01/1886	D	04S	01W 23	NENESSW		0.940 CFS				N 01
57-00067	ROBINSON, MERVILLE A	03/01/1889	D	04S	01W 23	NENESE		0.420 CFS				N 01