

STATE OF IDAHO
DEPARTMENT OF WATER RESOURCES
APPLICATION FOR PERMIT
To appropriate the public waters of the State of Idaho

RECEIVED
JUL 10 2002
WATER RESOURCES
WESTERN REGION

1. Name of Applicant McCall River Ranch Company Phone 208-342-7883
Mailing address P.O. Box 886, McCall, ID 83638

2. Source of water supply ground water which is a tributary of NA

3. Location of point of diversion is Township 18N Range 3E Sec. 20, in the 1/4,
NE 1/4, NE 1/4, Govt. Lot _____, B.M., Valley County;
additional points of diversion if any: SWNE, SENE, SESW, NWSE, SWSE Sec. 20, NENW, SWNW Sec

4. Water will be used for the following purposes:
Amount 6.00 for irrigation purposes from 4/15 to 10/15 (both dates inclusive)
(cfs or acre-feet per annum)
Amount 2.00 for recreation purposes from 1/1 to 12/31 (both dates inclusive)
(cfs or acre-feet per annum)
Amount 2.00 for aesthetic purposes from 1/1 to 12/31 (both dates inclusive)
(cfs or acre-feet per annum)
Amount 250.0 for irrigation storage purposes from 1/1 to 12/31 (both dates inclusive)
(cfs or acre-feet per annum) aesthetic storage
Amount 250.00 for recreation storage purposes from 1/1 to 12/31 (both dates inclusive)
(cfs or acre-feet per annum)
Amount 250.0 for irrigation from storage purposes from 4/15 to 10/15 (both dates inclusive)
(cfs or acre-feet per annum) 6.0 cfs DEV to STOR 1/1 12/31

5. Total quantity to be appropriated is (a) 6.00 and/or (b) 250
cubic feet per second acre feet per annum

6. Proposed diverting works:
a. Describe type and size of devices used to divert water from the source wells with electric submer-
sible pumps
b. Height of storage dam 10 feet; active reservoir capacity 250 acre-feet; total
reservoir capacity 250 acre-feet
c. Proposed well diameter is 16 inches; proposed depth of well is 500 feet
d. Is ground water with a temperature of greater than 85°F being sought? no
e. If well is already drilled, when? _____; Drilling firm _____;
Well was drilled for (well owner) _____; Drilling Permit No. _____

7. Time required for completion of works and application of water to proposed beneficial use is 5 years (minimum 1 year)

8. Description of proposed uses (if irrigation only, go to item 9):
a. Hydropower; show total feet of head and proposed capacity in KW. _____
b. Stockwatering; list number and kind of livestock. _____
c. Municipal; show name of municipality. _____
d. Domestic; show number of households. _____
e. Other; describe fully. aesthetic and recreation uses will be for a series of ponds
with a total capacity of 250 acre feet; recreation use will include fishing

9. Description of place of use:

a. If water is for irrigation, indicate acreage in each subdivision in the tabulation below.

b. If water is used for other purposes, place a symbol of the use (example: D for Domestic) in the corresponding place of use below. See instructions for standard symbols.

TWP	RGE	SEC	NE				NW				SW				SE				TOTAL
			NE	NW	SW	SE	NE	NW	SW	SE	NE	NW	SW	SE	NE	NW	SW	SE	
18N	3E	20	12	5	24	30					25		25	38	10	38	30		237
		29		10			35	32	35	28	3	20							163
		20	J,R	J,R	J,R	J,R					J,R		J,R	J,R	J,R	J,R	J,R		
		29		J,R			J,R	J,R	J,R	J,R	J,R	J,R							

Total number of acres to be irrigated 400

10. Describe any other water rights used for the same purposes as described above. Lake Irrigation District

11. a. Who owns the property at the point of diversion? Applicant

b. Who owns the land to be irrigated or place of use? Applicant

c. If the property is owned by a person other than the applicant, describe the arrangement enabling the applicant to make this filing: _____

12. Remarks: Applicant proposes constructing a series of ponds for irrigation, recreation and aesthetic purposes. The ponds will receive water from the Lake Irrigation District during the irrigation season. Groundwater from wells will be used to maintain pond levels during the non irrigation season. Water will be pumped from the ponds for irrigation of the property. Groundwater will be supplemental to Irrigation District water for irrigation.

13. MAP OF PROPOSED PROJECT REQUIRED - Attach an 8 1/2"x11" map clearly identifying the proposed point of diversion place of use, section #, township & range. (A photocopy of a USGS 7.5 minute topographic quadrangle map is preferred.)

BE IT KNOWN that the undersigned hereby makes this application for permit to appropriate the public waters of the State of Idaho as herein set forth.

*Judith L. Brown, President
McCall River Ranch Company*

Signature of Applicant (and title, if applicable)

Received by KH Date 7/10/02 Time 11:32 Preliminary check by ly
 Fee \$ 450.00 Received by KH # W029437 Date 7/10/02
 Publication prepared by AT Date 8-28-02 Published in STAR NEWS
 Publication approved AT Date 9-30-02

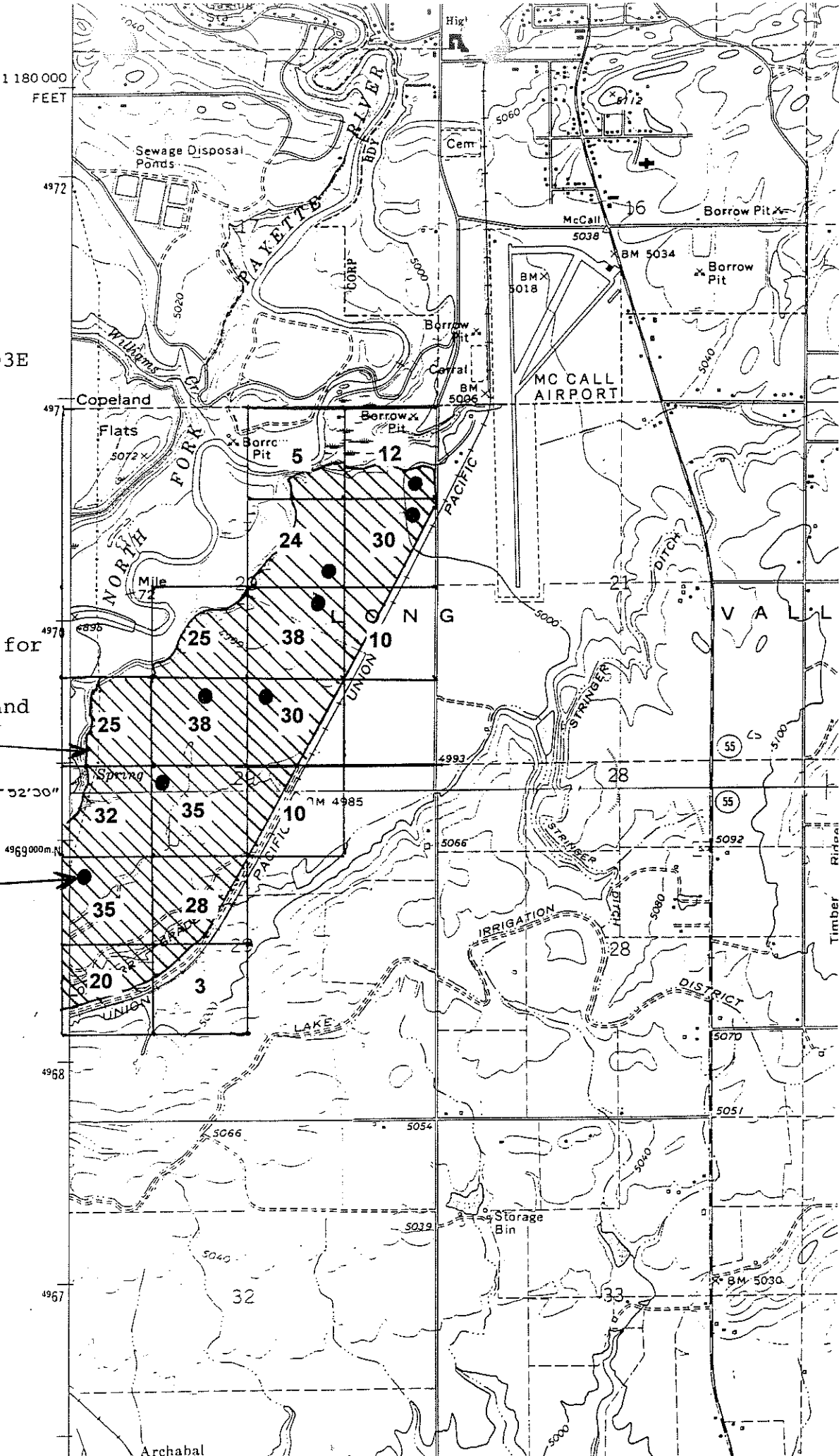

1 180 000
FEET

T18N, R03E

Place of Use for
irrigation,
recreation, and
aesthetic

44° 52' 30"

point of
diversion
(typ)

4969 000 m N

4958

4967

Archabal

SCANLAN ENGINEERING

Groundwater and Environmental Engineering

August 3, 2002

RECEIVED

AUG 05 2002

WATER RESOURCES
WESTERN REGION

Lori Graves
Idaho Department of Water Resources
2735 Airport Way
Boise, ID 83705-5082

Subject: McCall River Ranch Company Application for Permit

Dear Lori:

This letter provides a partial response to the items in your letter of July 22, 2001.

Item 1 – Original Form. I suspect that you have the form with the original signature. The forms in my files are copies. However, it is possible that the form sent to me by the applicant was a copy. Take another look at the signature. If you are sure it is a copy, I can arrange for the form to be signed again.

Item 2 – Company Officers. I have enclosed a list of company officers for McCall River Ranch Company.

Item 3 – Lake Irrigation District Water Right Transfer. We question whether a transfer of the Lake Irrigation District water right is necessary for this project. Our reasons are listed below.

1. The applicant proposes to take delivery of Lake Irrigation District water into these ponds and pump the water from the ponds for irrigation purposes. The ponds will be maintained throughout the non-irrigation season in a full condition from the groundwater source, so that Lake Irrigation District water will not be needed for pond filling at the beginning of the irrigation season. We believe that if the ponds are maintained in a filled condition at the beginning of the irrigation season, then any storage of the Lake Irrigation District will be short-term (i.e., meeting the Department's 24-hour criteria).
2. Very little Irrigation District water will be lost to seepage from the ponds because the ponds will be lined. Any losses should be considered reasonable conveyance loss associated with the irrigation delivery system.
3. Water diverted from the groundwater source will be adequate to offset annual evaporation losses. The applicant can add groundwater to the pond system during the irrigation season if necessary for this purpose.
4. Some currently irrigated land within the Irrigation District will be removed from irrigation through construction of ponds, roads, and homes associated with the project. However, the