



State of Idaho

Department of Water Resources

322 East Front St, PO Box 83720, Boise, ID 83720-0098 • 208-287-4800 • www.idwr.idaho.gov

# *Certificate of Appointment*

This is to certify that I have appointed Eric Herr as *Watermaster* of *Water District* 65A, from this day until the 2016 annual meeting or until his/her successor is appointed and qualified under the provisions of Idaho Code Section 42-605, at such rate of compensation as established by applicable law.

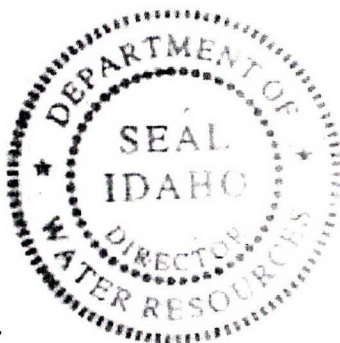

This certificate has been issued and the seal of the Director fixed at Boise, Idaho, this day, June 3rd, 2015.

Gary Spackman  
Gary Spackman  
IDWR Director

SCANNED  
JUN 05 2015



State of Idaho

Department of Water Resources

322 East Front St, PO Box 83720, Boise, ID 83720-0098 • 208-287-4800 • www.idwr.idaho.gov

# *Certificate of Appointment*

This is to certify that I have appointed Amanda Poole as *Treasurer* of *Water District 65A*, from this day until the 2016 annual meeting or until his/her successor is appointed and qualified under the provisions of Idaho Code Section 42-605, at such rate of compensation as established by applicable law.

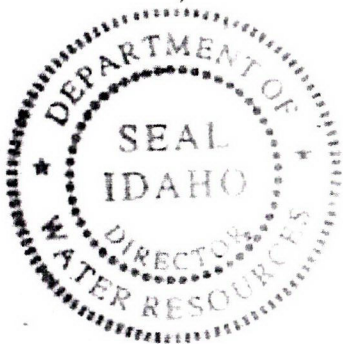

This certificate has been issued and the seal of the Director fixed at Boise, Idaho, this day, June 3rd, 2015.

Gary Spackman  
IDWR Director

SCANNED  
JUN 05 2015

# WATERMASTER REQUIREMENT SHEET

WATER DISTRICT: 65A

2015

Date/Time of Meeting: March 2nd 2015

Place of Meeting:

<u>Watermaster</u> Name: <u>Eric Herr</u> Address: Phone:	<u>Assistant Watermaster</u> Name: Address: Phone:
<u>Secretary/Treasurer</u> Name: <u>Amanda Poole</u> Address: Phone:	<u>Chairman</u> Name: <u>Butch Biggers</u> Address: Phone:

## Sent

- 
- ☒ Certificate of Appointment
    - ☒ Watermaster
    - ☐ Assistant Watermaster
    - ☒ Secretary/Treasurer
  - ☐ Daily Record books and instructions

## Received

- 
- ☒ Annual Meeting Minutes
  - ☒ Adopted Budget
  - ☒ Oath(s)
    - ☒ Watermaster
    - ☒ Assistant Watermaster
    - ☒ Secretary/Treasurer
  - ☐ Watermaster Report
  - ☐ Daily Record Books



State of Idaho

## DEPARTMENT OF WATER RESOURCES

Western Region, 2735 Airport Way • Boise, Idaho 83705-5082

Phone: (208) 334-2190 • Fax: (208) 334-2348 • Web Site: [www.idwr.idaho.gov](http://www.idwr.idaho.gov)

C. L. "BUTCH" OTTER  
Governor

GARY SPACKMAN  
Director

June 9, 2015

ERIC HERR  
8917 BUTTE RD  
SWEET ID 83670

RE: Information Request – Water District 65A

Dear Watermaster:

The Department has not yet received the following information from your Water District. The referenced form has been enclosed for your convenience.

- Watermaster report for 2014 (Watermaster's Report form enclosed).

Please submit the requested information as soon as possible. Feel free to contact me at 208-334-2190 if you have any questions or need assistance during the irrigation season.

Sincerely,

Rachel Neely  
Administrative Assistant 1

Enclosure

SCANNED  
JUN 08 2015



State of Idaho

## DEPARTMENT OF WATER RESOURCES

Western Region, 2735 Airport Way • Boise, Idaho 83705-5082

Phone: (208) 334-2190 • Fax: (208) 334-2348 • Web Site: [www.idwr.idaho.gov](http://www.idwr.idaho.gov)

June 5, 2015

C. L. "BUTCH" OTTER  
Governor

GARY SPACKMAN  
Director

ERIC HERR  
8917 BUTTE RD  
SWEET ID 83670

Dear Mr. Herr,

Enclosed is your certificate of appointment as watermaster of Water District 65A Squaw Creek. Per Idaho Code Section 42-608(1), the watermaster's term of service "*...is throughout the year, extending until the annual meeting for the ensuing year, or until a successor is appointed.*" Based on the code, the watermaster's appointment is from one annual meeting to the next, generally speaking.

Thank you for serving the State of Idaho and your community. Feel free to contact this office with any questions or concerns.

Sincerely,

A handwritten signature in black ink, appearing to read 'Rachel Neely', is written over a horizontal line.

Rachel Neely  
Administrative Assistant I

SCANNED  
JUN 05 2015



State of Idaho

DEPARTMENT OF WATER RESOURCES

Western Region, 2735 Airport Way • Boise, Idaho 83705-5082

Phone: (208) 334-2190 • Fax: (208) 334-2348 • Web Site: [www.idwr.idaho.gov](http://www.idwr.idaho.gov)

June 5, 2015

C. L. "BUTCH" OTTER  
Governor

GARY SPACKMAN  
Director

AMANDA POOLE  
19557 BUTLER LN  
OLA ID 83657

Dear Ms. Poole,

Enclosed is your certificate of appointment as treasurer of Water District 65A Squaw Creek. The treasurer's terms of service follows that of the watermaster: *"throughout the year, extending until the annual meeting for the ensuing year, or until a successor is appointed"* (Idaho Code §42-608(1)). Based on the code, the treasurer's appointment is from one annual meeting to the next, generally speaking.

Thank you for serving the State of Idaho and your community. Feel free to contact this office with any questions or concerns.

Sincerely,

Rachel Neely  
Administrative Assistant I

SCANNED

JUN 05 2015

## Grimm, Angie

---

**From:** Shaul, Sarah  
**Sent:** Monday, March 09, 2015 9:01 AM  
**To:** Grimm, Angie  
**Subject:** FW: Water district 65a

Angie,  
Here's some more water district info/paperwork for Western. See below.

*Best Regards,*  
*Sarah Shaul*  
Technical Records Specialist  
sarah.shaul@idwr.idaho.gov  
208-287-4958

Idaho Department of Water Resources (IDWR)  
322 E. Front Street  
P.O. Box 83720  
Boise, ID 83720-0098  
208-287-4800  
www.idwr.idaho.gov

SCANNED

MAY 14 2015

---

**From:** Amanda Poole [mailto:mandiepoole@gmail.com]  
**Sent:** Saturday, March 07, 2015 11:23 AM  
**To:** Clerk@co.gem.id.us; Shaul, Sarah  
**Subject:** Water district 65a

To Whom it may concern:

Here are the adopted budget and the annual meeting minutes for Water Dist. 65-A. If you have any questions please let me know.

Sincerely,  
Amanda Poole  
Water Dist. 65-A Secretary.  
mandiepoole@gmail.com  
280-584-3284

BUDGET ADOPTED AT THE ANNUAL MEETING

OF THE WATER USERS

Water  
District 65-A  
NO. \_\_\_\_\_

SCANNED

MAY 14 2015

Estimated Amount for Watermaster's Salary		\$	600.00
Estimated Amount for Secretary Wages		\$	60.00
Estimated Amount for State Insurance Fund		\$	300.00
Total Expenses for	2015	\$	960.00

DISTRIBUTION OF THE BUDGET AMONG  
USERS

Individual, Ditch or Canal CO. assessed	Water Right Ident. No.	Address	Amount of Budget
Kerstein, Joann	RP0040300	2100 S Artesian Rd. Eagle Id 83616	\$ 28.00
Herr, Rodney	RP00403301	400 Coston St. Boise, Id 83712	\$ 30.00
Highland Livestock	RP00510400	Box 488 Emmett, Id 83617	\$ 5.00
Young, Michael	RP00515003	11600 Ola Rd Sweet, Id 83670	\$ 2.04
Young, Michael	RP00515005	11601 Ola Rd Sweet, Id 83670	\$ 3.44
Squaw Creek Ditch Co.	RP00558401	PO BOX 60 Sweet, Id 83670	\$ 239.00
McDermott Roe, Steven	RP00521000	PO Box 34 Sweet, Id 83670	\$ 27.00
Hale, Melvin Family Trust	RP00519000	8575 Sweet Ola Hwy Sweet, Id 83670	\$ 50.00
Macaw, Chris	RP00527201	19200 Sweet Ola Hwy Ola, Id 83657	\$ 1.16
Macaw, Chris	RP00527202	19201 Sweet Ola Hwy Ola, Id 83657	\$ 9.84
Coburn, Allen & Marsha	RP00531805	17800 Sweet-Ola Hwy Ola, Idaho 83657	\$ 32.00
Poole, Ellen Katie	RP00527703	19509 Jacknife Lane, Ola, Id 83657	\$ 12.00
Carr, Linden	RP00531806	Po Box 52 Ola, Id 83657	\$ 6.00
Perkins, William	RP00532400	16575 Sweet Ola Hwy, Ola, Id 83657	\$ 22.00
M&T Ranches LLC	RP00536100	PO Box 30 Ola, Id 83657	\$ 80.00
M&T Ranches LLC	RP00544404	PO Box 30 Ola, Id 83657	\$ 45.88
M&T Ranches LLC	RP00544406	PO Box 30 Ola, Id 83657	\$ 8.14
Strickland, Kathy	RP00538800	3605 Van Deusen Rd Emmett, Id 83617	\$ 1.00
Sutton Circle Arrow Ranch	RP00540201	PO BOX 25 Ola, Id 83657	\$ 16.00
Sutton Circle Arrow Ranch	RP00538900	PO BOX 25 Ola, Id 83657	\$ 42.00
Biggers, Leslie	RP00541100	PO BOX 55 Ola, Id 83657	\$ 16.00
Self, Lee	RP00541300	23000 2nd Fork rd. Ola, Id 83657	\$ 3.00
Mackenzie, Charles	RP00541800	PO BOX 1005 Caldwell, Id 83605	\$ 29.00
Spiker, Vaughn	RP00542100	HC 78 Box 3815 Ola, Id 83657	\$ 64.00
Canaday Properties LLC	RP00543300	9747 E Gatfield Rd Emmett, Id 83617	\$ 180.00
Mccaulou, Harry	RP00543501	PO Box 45 Ola, Id 83657	\$ 11.00
Carlock, Carroll	RP00547201	Po Box 108 Sweet, Id 83670	\$ 2.00



			\$1,220.00

# ADOPTED BUDGET AND RESOLUTIONS

PERTAINING TO THE COLLECTION  
THEREOF

FOR 2014

WATER DISTRICT NO 65-A

STREAM Squaw Creek

COUNTY Gem

NAME OF  
SECRETARY Amanda Poole

ADDRESS OF  
SECRETARY 19557 Butler Lane Ola, Id 83657

## COLLECTION AND HOLDING OF WATER DISTRICT FUNDS

Please check the appropriate box regarding the collection and holding of Water District funds.

☐ The Water District collects and holds its own funds.

☒ Gem County collects and holds funds for the Water District.  
(County Name)

☐ \_\_\_\_\_ County collects the Water District's funds and deposits the funds in an account held by the Water District.  
(County Name)

( This report must be certified and made in duplicate, one copy to be forwarded to the appropriate regional office of the Idaho Department of Water Resources., and one copy to the

SCANNED<sub>4</sub>

MAY 14 2015

Secretary of the Annual Water User's Meeting of the Water District. If a designated county collects funds for the water, then a third copy must be sent to the auditor of the designated county. )

Ola, Idaho March 2, 2015

I HEREBY CERTIFY that the within is true and correct copy of the budget as adopted at the annual Water User's Meeting of Water District No. 65-A, held at Ola, Id on the 2nd day of March 2015, and all resolutions adopted at said meeting pertaining to the time and the manner of collecting the amounts provided for in said budget.

SCANNED

MAY 14 2015

Secretary, Water District No.

65-A

minutes

Water Dist. 65-A Annual Meeting March 2<sup>nd</sup>, 2015

Meeting Opened by chairman Butch Biggers.

Nominations for Chairman, Vaughn Spiker nominates Butch Biggers. Jim Bier Seconded. Butch Biggers will remain as Chairman.

Amanda Poole was asked if she would remain Secretary, she said she would.

Eric Herr was asked if he would be Water Master, he said he would.

Eric reported that the water was turned on Jun 12<sup>th</sup> and off by Oct 12th.

Raising the water in Sagehen was discussed. Also the inspection of the dam. It was decided to see what the state engineer had come up with during his inspection.

The screw that opens the gate is showing wear, should be replaced soon.

Rocks were cleaned out of the bottom of the dam.

The Credential committee was voted to be kept the same, Eric Herr. Vaughn Spiker, Roy Moses.

It was decided that the Advisory Committee would be kept the same. Chuck Mackenzie, Roy Moses, Vaughn Spiker, Harry McCaulou.

It was decided that the Budget would remain the same.

SCANNED

MAY 14 2015

Next Meeting will be held the first Monday in March at 1pm at the Ola Community Hall.  
Meeting Adjourned.

SCANNED

MAY 14 2015

**State of Idaho****DEPARTMENT OF WATER RESOURCES**

Western Region, 2735 Airport Way, Boise, Idaho 83705-5082

PHONE: (208) 334-2190 FAX: (208) 334-2348 [www.idwr.idaho.gov](http://www.idwr.idaho.gov)

C.L. "BUTCH" OTTER, Governor

GARY SPACKMAN, Director

February 27, 2015

To: Eric Herr, Watermaster 65A

Re: Your telephone questions today

Young received approved Transfer 74880 to dry up acres next to creek and move that use uphill towards highway.

Transfer 74880 allows diversion of 0.15 cfs from Squaw Creek under 1889 and 1966 priorities, same amount for each and total is not additive. Note the same diversion is also authorized for use by Probst and the Squaw Creek Ditch Company.

This required moving some Squaw Creek Ditch Company water away from same acres by creek to prevent an expansion of use for Young. Ditch Company received approved Transfer 76301 for that. That relocated ditch shares away from creek to be used uphill on Young's place.

I've enclosed some maps and printouts about this situation.

Land retired from irrigation under Transfers 74880 and 76310 cannot be irrigated under any water rights. Irrigating that retired land could result in IDWR rescinding approval of Transfer 74880, which would probably result in same thing for ditch company transfer since they are a package deal.

Additional results could include a Notice of Violation for illegal diversion of water by the irrigator.

As Watermaster, you are not obligated to deliver water you know will be used on unauthorized land. Should you have any problems in this regard, please call this office for assistance in enforcing diversion and use of water. It's probably better for IDWR to assume the enforcement role to give you more "elbow room" to do the job.

Best regards,

A handwritten signature in black ink, appearing to read 'Steve Lester'.

Steve Lester  
Interim Western Region Manager

Enclosure

CC → WO 65A, 2015 file

SCANNED

JUN 12 2015



# Idaho Department of Water Resources

**Water Right**  
**65-23364**  
**(IRRIGATION)**

● Point of Diversion

Place of Use

State Outline

Townships

PLS Sections

Quarter Quarters

Taxlots

*After Transfer 7/88  
approved*

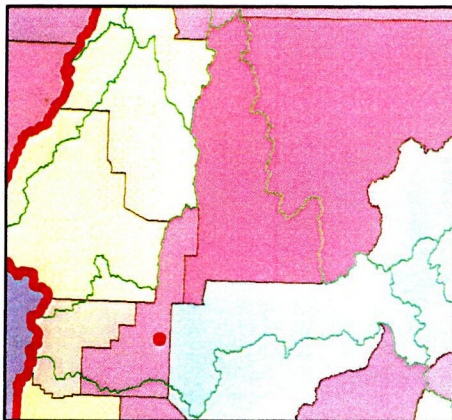

Gem County  
IDWR Basin 65

Prepared by Lester, Steve  
On February 27, 2015

Background: 2009 Aerial Photography



0 0.1 0.2 0.4 Miles

Owner: Michael Young

NOTE: Only one owner is listed. There may or may not be more than this in the IDWR database.

SCANNED  
JUN 12 2015



# Idaho Department of Water Resources

Water Right  
65-23367

(IRRIGATION)

● Point of Diversion

□ Place of Use

□ State Outline

□ Townships

□ PLS Sections

□ Quarter Quarters

Taxlots

Same as  
63-23364

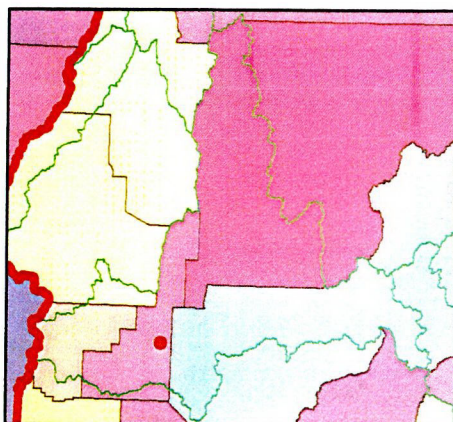

Gem County  
IDWR Basin 65



0 0.1 0.2 0.4 Miles

Owner: Michael Young

NOTE: Only one owner is listed. There may or may not be more than this in the IDWR database.

Prepared by Lester, Steve

On February 27, 2015

Background: 2009 Aerial Photography

JUN 12 2015

SCANNED

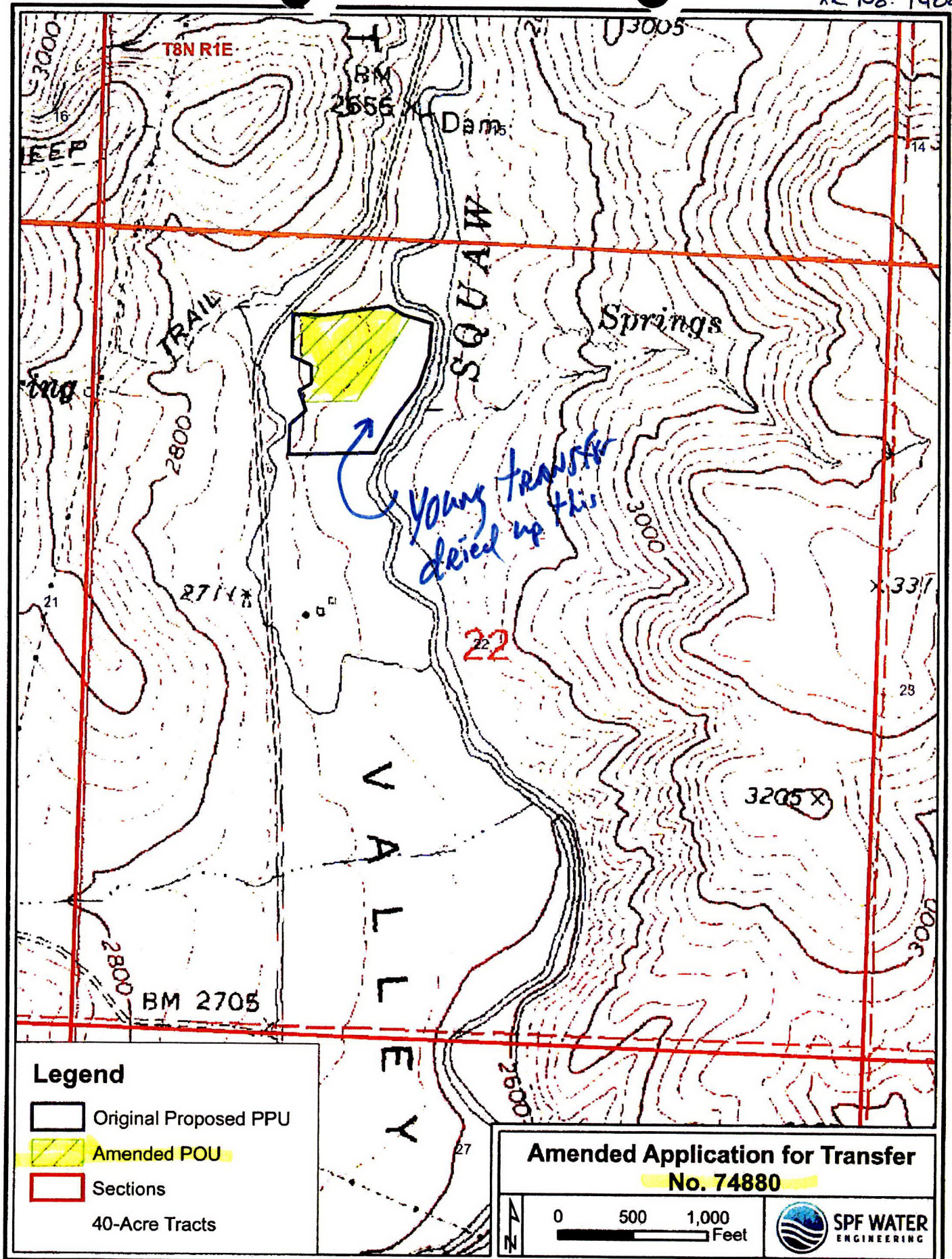

ATTACHMENT AC

## 65-3045X & 65-11217 YOUNG/PROBST SPLIT TREE

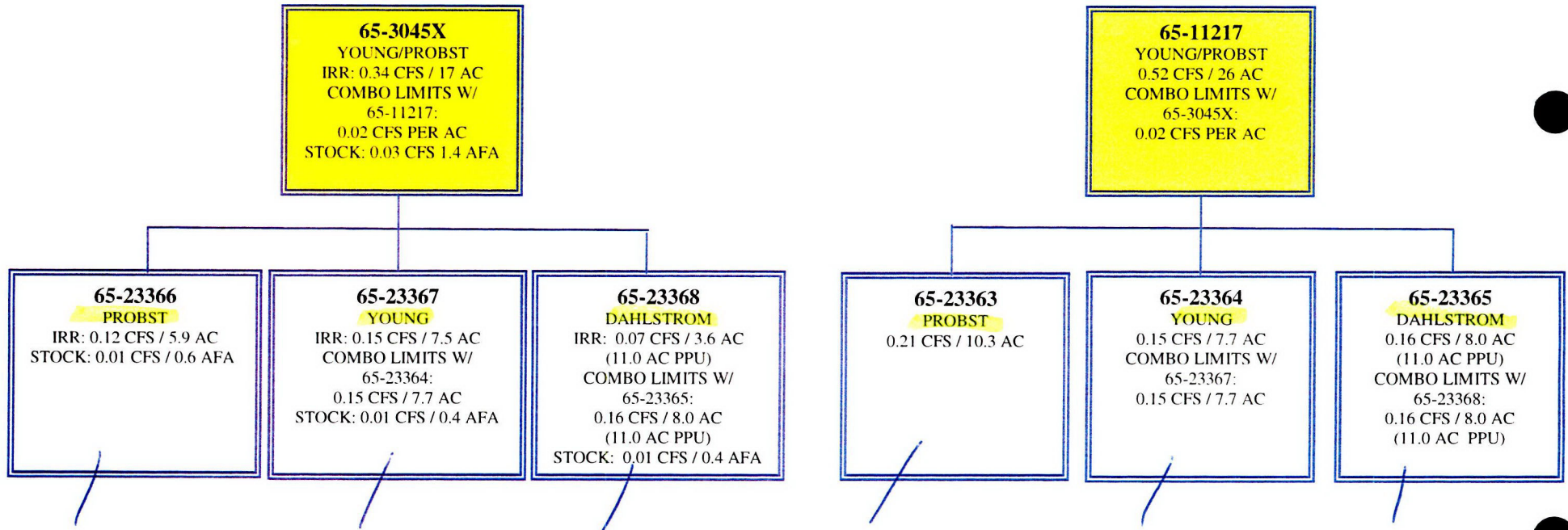

*Leftover  
AFA  
2  
transfer*

*Transfer  
74480 \**

*Transfer  
75363*

*Leftover  
AFA  
2  
transfer*

*Transfer  
74480 \**

*Transfer  
75363*

*\* Ditch company transfer 73601 moved  
Young's ditch shares to some acres  
in transfer 74480 some of  
(some from creek)*

**RIGHTS HAVE BEEN SPLIT  
AND ARE NO LONGER ACTIVE**

JUN 12 2015  
SCANNED

STATE OF IDAHO  
DEPARTMENT OF WATER RESOURCES

**TRANSFER OF WATER RIGHT**

**TRANSFER NO. 74880**

This is to certify that: **MICHAEL YOUNG** And/Or  
**MARY H YOUNG**  
11600 OLA RD  
SWEET ID 83670  
208-584-3747

has requested a change to the water right(s) listed below. This change in water right(s) is authorized pursuant to the provisions of Section 42-222, Idaho Code. A summary of the changes is also listed below. The authorized change for each affected water right, including conditions of approval, is shown on the following pages of this document.

**Summary of Water Rights Before the Proposed Change**

Right	Origin/Basis	Priority	Rate	Volume	Acre Limit	Total Acres	Source
65-23364	WR/Decreed	06/23/1966	0.15 cfs	N/A	N/A	7.7	SQUAW CREEK
65-23367	WR/Decreed	02/16/1889	0.15 cfs	N/A	N/A	7.5	SQUAW CREEK

**Purpose of Transfer (Changes Proposed)**

Current Number	Split	POD	POU	Add POD	Period of Use	Nature of Use
65-23364	NO	NO	YES	NO	NO	NO
65-23367	NO	NO	YES	NO	NO	NO

**Summary of Water Rights After the Approved Change**

Existing Right	New No. (changed portion)	Transfer Rate	Transfer Volume	Acre Limit	Total Acres	New No. (remaining portion)	Remaining Rate	Remaining Volume	Remaining Acre Limit	Remaining Total Acres
65-23364	<b>65-23364</b>	0.15 cfs	N/A	7.7	8.0		N/A	N/A	N/A	N/A
65-23367	<b>65-23367</b>	0.15 cfs	N/A	7.5	8.0		N/A	N/A	N/A	N/A
<b>COMBINED TOTALS</b>		<b>0.15 cfs</b>	<b>N/A</b>	<b>7.7</b>	<b>8.0</b>		<b>N/A</b>	<b>N/A</b>	<b>N/A</b>	<b>N/A</b>

*irrigated 7.7 w 8 acres*

Detailed Water Right Description(s) attached

Dated this 4<sup>th</sup> day of May, 20 10

*John Westra*  
John Westra, Western Regional Manager

**SUPPORT DATA**

IN FILE # 65-23364

*Scanned documents on website*

SCANNED  
JUN 12 2015

**WATER RIGHT NO. 65-23364**  
**As Modified by Transfer No. 74880**

In accordance with the approval of Transfer No. 74880, Water Right No. 65-23364 is now described as follows.

**Right Holder:** MICHAEL YOUNG And  
MARY H YOUNG  
11600 OLA RD  
SWEET ID 83670

**Priority Date:** June 23, 1966

**Source:** SQUAW CREEK

**Tributary:** PAYETTE RIVER

<u>BENEFICIAL USE</u>	<u>From</u>	<u>To</u>	<u>Diversion Rate</u>
IRRIGATION	04/01	to 11/01	0.15 CFS
			0.15 CFS

**LOCATION OF POINT(S) OF DIVERSION:**

SQUAW CREEK      SENW      Sec. 22 Twp 08N Rge 01E GEM County

**PLACE OF USE:** IRRIGATION

Twp	Rge	Sec	NE	NW	SW	SE	Totals
08N	01E	22	8.0				8.0

Total Acres: 8

**CONDITIONS OF APPROVAL**

1. The right holder shall accomplish the change authorized by this transfer within one year of the date of this approval.
2. Failure of the right holder to comply with the conditions of this transfer is cause for the Director to rescind approval of the transfer.
3. Pursuant to Section 42-1412(6), Idaho Code, this water right is subject to such general provisions necessary for the definition of the rights or for the efficient administration of water rights as may be determined by the Snake River Basin Adjudication court at a point in time no later than the entry of the final unified decree.
4. This right is limited to the irrigation of 7.7 acres within the authorized place of use in a single irrigation season.
5. Rights 65-23364 and 65-23367 when combined shall not exceed a total diversion rate of 0.15 cfs and the irrigation of 7.7 acres.
6. This right when combined with all other rights shall provide no more than 0.02 cfs per acre nor more than 4.5 afa per acre at the field headgate for irrigation of the lands above.

SCANNED  
JUN 12 2015

**WATER RIGHT NO. 65-23364**  
**As Modified by Transfer No. 74880**

**CONDITIONS OF APPROVAL**

7. Use of water under this right will be regulated by a watermaster with responsibility for the distribution of water among appropriators within a water district. At the time of this approval, this water right is within State Water District No. 65A Squaw Creek.
8. A lockable device subject to the approval of the Department shall be maintained on the diverting works in a manner that will provide the watermaster suitable control of the diversion.
9. Basin 65 General Provisions No. 3, the Separate Streams General Provision, does not apply to appropriations of water after October 18, 1977.  
This water right shall be administered as being from a separate source pursuant to Basin 65 General Provision No. 3. If the holder of this right seeks to change the right pursuant to Idaho Code § 42-222 or successor statute, nothing in this general provision shall preclude any other person or entity from demonstrating that such change in use would cause injury to its water right or from receiving any relief provided by law in the event of injury.
10. The period of use for the irrigation described in this approval may be extended to a beginning date of 3/1 and an ending date of 11/1 provided that beneficial use of the water can be shown and other elements of the right are not exceeded. The use of water before 4/1 and after 11/1 is subordinate to all water rights having no subordinated early or late irrigation use and a priority date earlier than the date of this approval.
- \* 11. The following rights are diverted through point of diversion described above: 65-2379, 65-3043, 65-3044, 65-23363, 65-23364, 65-23366, and 65-23367.

This water right is subject to all prior water rights and shall be administered in accordance with Idaho law and applicable rules of the Department of Water Resources.

Dated this 4<sup>th</sup> day of May, 20 10

  
John Westra, Western Regional Manager

\* Young 65-23364 + 23367 15 cfs  
Puduh - 23363 + 23366 33 cfs  
Ditch company - 2379 + 3043 + 3044 28.99 cfs

decrease main canal by any amount ditch company  
diverts from creek downstream from main canal

**WATER RIGHT NO. 65-23367**

**As Modified by Transfer No. 74880**

In accordance with the approval of Transfer No. 74880, Water Right No. 65-23367 is now described as follows.

**Right Holder:** MICHAEL YOUNG And  
MARY H YOUNG  
11600 OLA RD  
SWEET ID 83670

**Priority Date:** February 16, 1889

**Source:** SQUAW CREEK

**Tributary:** PAYETTE RIVER

**BENEFICIAL USE**

	<b><u>From</u></b>	<b><u>To</u></b>	<b><u>Diversion Rate</u></b>	<b><u>Volume</u></b>
STOCKWATER	01/01	to 12/31	0.01 CFS	0.4 AF
IRRIGATION	04/01	to 11/01	0.15 CFS	
			0.15 CFS	

**LOCATION OF POINT(S) OF DIVERSION:**

SQUAW CREEK SENW Sec. 22 Twp 08N Rge 01E GEM County

**PLACE OF USE:** STOCKWATER

Twp Rge Sec	NE	NW	SW	SE	Totals
08N 01E 22					

**PLACE OF USE:** IRRIGATION

Twp Rge Sec	NE	NW	SW	SE	Totals
08N 01E 22					8.0

Total Acres: 8

**CONDITIONS OF APPROVAL**

1. The right holder shall accomplish the change authorized by this transfer within one year of the date of this approval.
2. Failure of the right holder to comply with the conditions of this transfer is cause for the Director to rescind approval of the transfer.
3. Pursuant to Section 42-1412(6), Idaho Code, this water right is subject to such general provisions necessary for the definition of the rights or for the efficient administration of water rights as may be determined by the Snake River Basin Adjudication court at a point in time no later than the entry of the final unified decree.
4. The quantity of water under this right for stockwater use shall not exceed 13,000 gallons per day.
5. The quantity of water decreed for this water right for stockwater use is not a determination of historical beneficial use.

SCANNED

JUN 12 2015

**WATER RIGHT NO. 65-23367**  
**As Modified by Transfer No. 74880**

**CONDITIONS OF APPROVAL**

6. This right is limited to the irrigation of 7.5 acres within the authorized place of use in a single irrigation season.
7. Rights 65-23364 and 65-23367 when combined shall not exceed a total diversion rate of 0.15 cfs and the irrigation of 7.7 acres.
8. This right when combined with all other rights shall provide no more than 0.02 cfs per acre nor more than 4.5 afa per acre at the field headgate for irrigation of the lands above.
9. Use of water under this right will be regulated by a watermaster with responsibility for the distribution of water among appropriators within a water district. At the time of this approval, this water right is within State Water District No. 65A Squaw Creek.
10. A lockable device subject to the approval of the Department shall be maintained on the diverting works in a manner that will provide the watermaster suitable control of the diversion.
11. Measuring devices of a type approved by this Department shall be permanently installed and maintained at the point of diversion from Squaw Creek and at the points where Big and Little Cottonwood, Rattlesnake, and Brush Creeks are tributary to Squaw Creek. Water diverted under this right from Squaw Creek shall not exceed water flow reaching Squaw Creek from said tributaries.
12. Basin 65 General Provisions No. 3, the Separate Streams General Provision, does not apply to appropriations of water after October 18, 1977.  
This water right shall be administered as being from a separate source pursuant to Basin 65 General Provision No. 3. If the holder of this right seeks to change the right pursuant to Idaho Code § 42-222 or successor statute, nothing in this general provision shall preclude any other person or entity from demonstrating that such change in use would cause injury to its water right or from receiving any relief provided by law in the event of injury.
13. The period of use for the irrigation described in this approval may be extended to a beginning date of 3/1 and an ending date of 11/15 provided that beneficial use of the water can be shown and other elements of the right are not exceeded. The use of water before 4/1 and after 11/1 is subordinate to all water rights having no subordinated early or late irrigation use and a priority date earlier than the date of this approval.
14. Stockwater use is for 50 range cattle.
15. The following rights are diverted through point of diversion described above: 65-2379, 65-3043, 65-3044, 65-23363, 65-23364, 65-23366, and 65-23367.

This water right is subject to all prior water rights and shall be administered in accordance with Idaho law and applicable rules of the Department of Water Resources.

Dated this 4<sup>th</sup> day of May, 2010

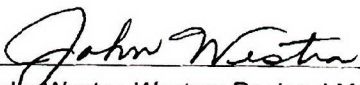
  
John Westra, Western Regional Manager

RECEIVED

JUL 16 2014

WM & C



SQUAW CREEK IRRIGATION DISTRICT  
2254 PLUM STREET  
EMMETT, IDAHO 83617

July 15, 2014

William D. Collins  
Westberg, McCabe & Collins, CTD  
1520 W. Washington Street  
P O Box 2836  
Boise, Idaho 83701-2836

RECEIVED

MAR 10 2015

WATER RESOURCES  
WESTERN REGION

RE: Sagehen Water Rights

Dear Mr. Collins:

When the Sagehen Reservoir was constructed in 1938, DeMasters, the original owner of the land, purchased 32.36 acres in the Sagehen Reservoir storage. Upon checking with the Idaho Department of Water Resources records, it shows Michael Young has 7.7 irrigated acres of the original acres.

Your inquiry about documents/records to show the land owned by Mr. Young is entitled to storage water from the Sagehen Reservoir are enclosed, along with a copy of the records obtained from Idaho Department of Water Resources showing that Mr. Young has filed and was granted water rights on said acres.

If you have any questions feel free to address them to the Squaw Creek Irrigation District Board. Our current Board members are; Harry McCaulou, 584-3546; Butch Biggers, 584-3334; Roy Moses, 584-3436; Daryl Morgan, 584-3493; Deborah Carlock-Newton, 365-3369 or to me, 365-3533. If you would like to attend a board meeting please call for meeting times and dates.

Sincerely yours,

Squaw Creek Irrigation District  
Sheryl Stelling, Administrative Assistant

Cc: Squaw Creek Irrigation District Board of Supervisors

SCANNED

JUN 12 2015

[Close](#)IDAHO DEPARTMENT OF WATER RESOURCES  
Water Right Report

10/30/2013

WATER RIGHT NO. 65-23364

<u>Owner Type</u>	<u>Name and Address</u>
Current Owner	MARY H YOUNG
Current Owner	MICHAEL YOUNG 11600 OLA RD SWEET, ID 83670 (208) 584-3747
Original Owner	HARRY GANSBERGER 21929 DELORES ST CASTRO VALLEY, CA 94546 (415)581-9048
Original Owner	JOE DE MASTERS 21929 DELORES ST SWEET, ID 83670
Original Owner	VIOLA M DE MASTERS HC 78 BOX 2568 SWEET, ID 83670 (208)584-3332

Priority Date: 06/23/1966

Basis: Decreed

Status: Active

<u>Source</u>	<u>Tributary</u>
SQUAW CREEK	PAYETTE RIVER

<u>Beneficial Use</u>	<u>From</u>	<u>To</u>	<u>Diversion Rate</u>	<u>Volume</u>
IRRIGATION	04/01	11/01	0.15 CFS	

SCANNED  
JUN 12 2015

		diversion.
9.	C20	Basin 65 General Provisions No. 3, the Separate Streams General Provision, does not apply to appropriations of water after October 18, 1977. This water right shall be administered as being from a separate source pursuant to Basin 65 General Provision No. 3. If the holder of this right seeks to change the right pursuant to Idaho Code § 42-222 or successor statute, nothing in this general provision shall preclude any other person or entity from demonstrating that such change in use would cause injury to its water right or from receiving any relief provided by law in the event of injury.
10.	X61	The period of use for the irrigation described in this approval may be extended to a beginning date of 3/1 and an ending date of 11/15 provided that beneficial use of the water can be shown and other elements of the right are not exceeded. The use of water before 4/1 and after 11/1 is subordinate to all water rights having no subordinated early or late irrigation use and a priority date earlier than the date of this approval.
11.	F06	The following rights are diverted through point of diversion described above: 65-2379, 65-3043, 65-3044, 65-23363, 65-23364, 65-23366, and 65-23367.

## Dates:

Licensed Date:

Decreed Date: 01/14/2003

Enlargement Use Priority Date:

Enlargement Statute Priority Date:

Water Supply Bank Enrollment Date Accepted:

Water Supply Bank Enrollment Date Removed:

Application Received Date:

Protest Deadline Date:

Number of Protests: 0

## Other Information:

State or Federal: S

Owner Name Connector: And

Water District Number: 65A

Generic Max Rate per Acre: 0.02

Generic Max Volume per Acre: 4.5

Combined Acres Limit: 7.7

Combined Volume Limit:

Combined Rate Limit: 0.15

Civil Case Number:

Old Case Number:

Decree Plaintiff:

Decree Defendant:

Swan Falls Trust or Nontrust:

Swan Falls Dismissed:

DLE Act Number:

Cary Act Number:

Mitigation Plan: False

Close

SCANNED  
JUN 17 2015

STOCKWATER	01/01	12/31	0.01 CFS	0.4 AFA
Total Diversion			0.15 CFS	

Location of Point(s) of Diversion:

SQUAW CREEK	SENW	Sec. 22	Township 08N	Range 01E	GEM County
-------------	------	---------	--------------	-----------	------------

IRRIGATION Use:

Acre Limit: 7.5

Place(s) of use:

Place of Use Legal Description: IRRIGATION GEM County

Township	Range	Section	Lot	Tract	Acres	Lot	Tract	Acres	Lot	Tract	Acres	Lot	Tract	Acres
08N	01E	22		NENW	8									

Place of Use Legal Description: STOCKWATER GEM County

Township	Range	Section	Lot	Tract	Acres	Lot	Tract	Acres	Lot	Tract	Acres	Lot	Tract	Acres
08N	01E	22		NENW										

Total Acres: 8

Conditions of Approval:

1.	T07	The right holder shall accomplish the change authorized by this transfer within one year of the date of this approval.
2.	T08	Failure of the right holder to comply with the conditions of this transfer is cause for the Director to rescind approval of the transfer.
3.	T19	Pursuant to Section 42-1412(6), Idaho Code, this water right is subject to such general provisions necessary for the definition of the rights or for the efficient administration of water rights as may be determined by the Snake River Basin Adjudication court at a point in time no later than the entry of the final unified decree.
4.	N05	The quantity of water under this right for stockwater use shall not exceed 13,000 gallons per day.
5.	N08	The quantity of water decreed for this water right for stockwater use is not a determination of historical beneficial use.

SCANNED

JUN 12 2015

Owner Name Connector: And  
Water District Number: 65A  
Generic Max Rate per Acre: 0.02  
Generic Max Volume per Acre: 4.5  
Combined Acres Limit: 7.7  
Combined Volume Limit:  
Combined Rate Limit: 0.15  
Civil Case Number:  
Old Case Number:  
Decree Plaintiff:  
Decree Defendant:  
Swan Falls Trust or Nontrust:  
Swan Falls Dismissed:  
DLE Act Number:  
Cary Act Number:  
Mitigation Plan: False

Close

SCANNED  
JUN 12 2015

CERTIFICATE.

THE UNDERSIGNED, E. L. NEWELL and J. HOWARD GOODWIN, President and Secretary, respectively, of the Board of Directors of Squaw Creek Irrigation District, Gem County, State of Idaho, do hereby certify that the attached is the original Determination of the Board of Directors of Squaw Creek Irrigation District of the benefits which will accrue to each of the several tracts or subdivisions of land within such irrigation District from the issuance of the bonds of Squaw Creek Irrigation District in the principal amount of \$25,000.00, par or face value, as authorized by qualified electors of said district at an election held in said District on the 10th day of May, 1937, and the original list of the apportionment or distribution of such bond issue over such tracts or subdivisions in proportion to such benefits.

WE FURTHER CERTIFY, That said list contains a complete description of each tract or subdivision of land within said District, with the amount and rate per acre of such apportionment or distribution of benefits, and the name of the owner thereof, if known to said board; and that the whole amount of the assessment of benefits as set forth in said list equals the amount of such bonds authorized at said election aforesaid.

WE FURTHER CERTIFY, That said list was made, prepared, approved, confirmed and adopted by said Board of Directors of Squaw Creek Irrigation District at a duly and regularly called meeting of said Board held on the 21st day of January, 1938, after due and legal notice of said meeting had been given in

SCANNED  
JUN 12 2015

the manner provided by law.

IN WITNESS WHEREOF, We have hereunto set our hands  
and affixed the official seal of said Squaw Creek Irriga-  
tion District, this 21st day of January, 1938. .

E. H. Muell  
President, Board of Directors of  
Squaw Creek Irrigation District.

ATTEST:

J. Howard Goodwin  
Secretary.

DETERMINATION OF BENEFITS AND LIST OF APPORTIONMENT  
OR DISTRIBUTION OF COST UNDER SQUAW CREEK IRRIGATION  
DISTRICT CONSTRUCTION BONDS (1937)

No.	Name of Owner	Description of Tract or Subdivision	Acreage Benefitted and Assessed	Benefits Deter- mined and Rate Per Acre of Cost Apportioned or Distributed
1.	Henry Leisy	N. 184 $\frac{1}{2}$ ft. Lot 1, Sweet Townsite		.46 6.90
2.	Charles St. John	N. 10 ft. of S. 40 ft. Lot 1, Sweet Townsite	None	6.90
3.	Modern Woodmen of America, Camp #6701, Sweet, Idaho	S. 30 ft. of Lot 1 & Lot 2, and Lot 26, Sweet Townsite		.25 6.90
4.	W. A. Talley	Lot 3	" "	.14 6.90
5.	Florence Darrah	Lots 4, 5, 6, 7, 8, 9, S. 37 ft. of Lot 18 (19?) N. 36 ft. Lot 20, Lots 29, 30, 39, 40, 41, 42, Sweet Townsite		1.98 6.90
6.	Sarah R. Peck	Lots 10 and 11,	" "	.28 6.90
7.	Lee W. Powell	Lot 12,	" "	.14 6.90
8.	Mary J. Clarkson	Lot 13,	" "	.14 6.90
9.	Swan Dahlberg	Lots 14 & 15,	" "	.28 6.90
10.	Lawson Hill	Lots 16 & 17, N. 13 ft. Lot 18, Lot 20 less N. 36 ft., Lots 21, 22, 23 and 27, Sweet Town- site		.87 6.90
11.	Rosa Goin	Lot 24 and S. 17 ft. of Lot 25, Sweet Townsite.		.08 6.90
12.	Gilbert Talley & N. 33 ft. (and 9 In.?) of Lot 25,	" "		.10 6.90
13.	William Talley Wescott-Allen	Lot 28,	" "	.14 6.90
14.	Oil Co. Lafayette Knowlton	Lots 31, 38 and 47,	" "	.14 6.90
15.	Nell Geneva Talley	Lots 32, 33, 34 and 35,	" "	.56 6.90
16.	Ezekiel Sweet and Harry Sweet	Lots 36 and 37,	" "	.28 6.90
17.	Minnie E. Whipple	Lots 43, 44 and 45,	" "	.42 6.90
18.	Walter Herbert Day	Lot 46,	" "	.14 6.90
19.	Federal Land Bank of Spokane	Lot 48,	" "	.14 6.90
20.	A. W. Jordan	Lots 49 and 50,	" "	.28 6.90

SCANNED

JUN 12 2015

less 28 acres lying West of the center line of the public road, described as follows: Commencing at the NW corner of said Sec. 10, run South on section line to the SW corner of said NW 1/4 of NW 1/4 of said Sec. 10; thence east on the 1/4 1/4 section line 44 rods to the center of the road; thence northeasterly along center of road to a point on section line which is 68 rods east of the place of beginning; thence West 68 rods to place of beginning.

		12.00	6.90
61.	George D. Gardner	W 1/2 of SW 1/4 of NE 1/4, Sec. 10, T. 7 N.R. 1 E.B.M. 20.00	6.90
		SE 1/4 of NW 1/4, Sec. 10, T. 7 N.R. 1 E.B.M. 40.00	6.90
		SW 1/4 of NW 1/4, Sec. 10, T. 7 N.R. 1 E.B.M. 40.00	6.90
		W 1/2 of NW 1/4 of SE 1/4, Sec. 10, T. 7 N.R. 1 E.B.M. 8.89	6.90
		W 1/2 of SW 1/4 of SE 1/4, Sec. 10, T. 7 N.R. 1 E.B.M. 15.04	6.90
62.	Union Central Life Insurance Co.	NE 1/4 of SW 1/4, Sec. 10, T. 7 N.R. 1 E.B.M. 40.00	6.90
		NW 1/4 of SW 1/4, Sec. 10, T. 7 N. R. 1 E.B.M. 40.00	6.90
		W 1/2 of SE 1/4 of SW 1/4, Sec. 10, T. 7 N. R. 1 E.B.M. 20.00	6.90
63.	A. Belle Boynton	E 1/2 of SE 1/4 of SW 1/4, Sec. 10, T. 7 N.R. 1 E.B.M. 20.00	6.90
64.	Harve Douglas	NE 1/4 of NE 1/4, Sec. 10, T. 7 N.R. 1 E.B.M. 37.56	6.90
		W 1/2 of NW 1/4 of NW 1/4, Sec. 11, T. 7 N.R. 1 E.B.M. 2.44	6.90
65.	Federal Land Bank of Spokane	SE 1/4 of NE 1/4, Sec. 3, T. 8 N.R. 1 E.B.M. 5.00	6.90
		NE 1/4 of SE 1/4, Sec. 3, T. 8 N.R. 1 E.B.M. 8.00	6.90
66.	Flora Demasters	NE 1/4 of NW 1/4, Sec. 22, T. 8 N.R. 1 E.B.M. 9.16	6.90
		SE 1/4 of NW 1/4, Sec. 22 T. 8 N. R. 1 E.B.M. 7.00	6.90
		NE 1/4 of SW 1/4, Sec. 22, T. 8 N.R. 1 E.B.M. 16.2	6.90
67.	Juad Harris	E 1/2 of SE 1/4 of SW 1/4, Sec. 22, T. 8 N.R. 1 E.B.M. None	6.90
68.	Charles F. Bean	E 1/2 of NE 1/4 of NW 1/4, Sec. 27, T. 8 N.R. 1 E.B.M. None	
		E 1/2 of SW 1/4 of NW 1/4, Sec. 27, T. 8 N.R. 1 E.B.M. 7.30	6.90
		E 1/2 of NW 1/4 of SW 1/4, Sec. 27, T. 8 N. R. 1 E.B.M. 11.80	6.90
		SE 1/4 of NW 1/4, excepting therefrom: Beginning at the SE corner of said SE 1/4 of NW 1/4, run thence West 960 feet; thence North 350 feet to the bank of Squaw Creek; thence following the SErly side of said Creek to the Ireton Dam or headgate; thence East 228 feet to the East line of said SE 1/4 of NW 1/4; thence South on said line 1104 feet to the point of beginning, all in Sec. 27, Twp. 8 N.R. 1 E.B.M. 4.21	6.90
69.	C. F. Bean	NE 1/4 of SW 1/4, Sec. 27, T. 8 N.R. 1 E.B.M. 14.90	6.90
70.	Fred Orr	Beginning at the SE corner of the SE 1/4 of NW 1/4, Section 27, Twp. 8 N. R. 1 E.B.M., run thence West 960 feet; thence North 350 feet to the bank of Squaw Creek; thence following the SErly side of said Creek to the Ireton dam or headgate; thence East 228 feet to the East line of said SE 1/4 of NW 1/4; thence South on said line 1104 feet to the point of beginning. (Tax 1) 2.00	6.90
71.	Fred T. Smith	SE 1/4 of SW 1/4, Sec. 27, T. 8. N. R. 1 E. B. M. 20.80	6.90
		SW 1/4 of SW 1/4, Sec. 27, T. 8 N. R. 1 E. B. M. 22.26	6.90
		E 1/2 of SE 1/4 of NE 1/4, Sec. 33, T. 8 N.R. 1 E.B.M. 7.82	6.90
		NE 1/4 of NW 1/4, Sec. 34, T. 8 N. R. 1 E.B.M. 40.00	6.90
		NW 1/4 of NW 1/4, Sec. 34, T. 8 N. R. 1 E.B.M. 26.12	6.90
72.	Owen J. Dix	E 1/2 of SE 1/4 of SW 1/4, Sec. 33, T. 8 N. R. 1 E.B.M. 15.36	6.90
		SE 1/4 of NW 1/4, Sec. 34, T. 8 N. R. 1 E.B.M. 7.00	6.90
		SW 1/4 of NW 1/4, Sec. 34, T. 8 N. R. 1 E.B.M. 40.00	6.90
		NE 1/4 of SW 1/4, Sec. 34, T. 8 N. R. 1 E. B. M. 22.27	6.90
		NW 1/4 of SW 1/4, Sec. 34, T. 8 N. R. 1 E.B.M. 40.00	6.90

SCANNED

11/11/2018