

8. Description of proposed uses (if irrigation only, go to item 9):

- a. Hydropower; show total feet of head and proposed capacity in KW. _____
- b. Stockwatering; list number and kind of livestock. _____
- c. Municipal; show name of municipality. _____
- d. Domestic; show number of households. _____
- e. Other; describe fully. _____

9. Description of place of use:

- a. If water is for irrigation, indicate acreage in each subdivision in the tabulation below.
- b. If water is used for other purposes, place a symbol of the use (example: D for Domestic) in the corresponding place of use below. See instructions for standard symbols.

TWP	RANGE	SEC.	NE¼				NW¼				SW¼				SE¼				TOTALS
			NE¼	NW¼	SW¼	SE¼	NE¼	NW¼	SW¼	SE¼	NE¼	NW¼	SW¼	SE¼	NE¼	NW¼	SW¼	SE¼	
15S	36E	4	20	40	40	20					10	20			10	20			150

Total number of acres to be irrigated 150

10. Describe any other water rights used for the same purposes as described above. Claim 15-04147

- 11. a. Who owns the property at the point of diversion? Applicant
- b. Who owns the land to be irrigated or place of use? Applicant
- c. If the property is owned by a person other than the applicant, describe the arrangement enabling the applicant to make this filing. _____

12. Remarks: _____

13. Map of proposed project: show clearly the proposed point of diversion, place of use, section number, township and range number.

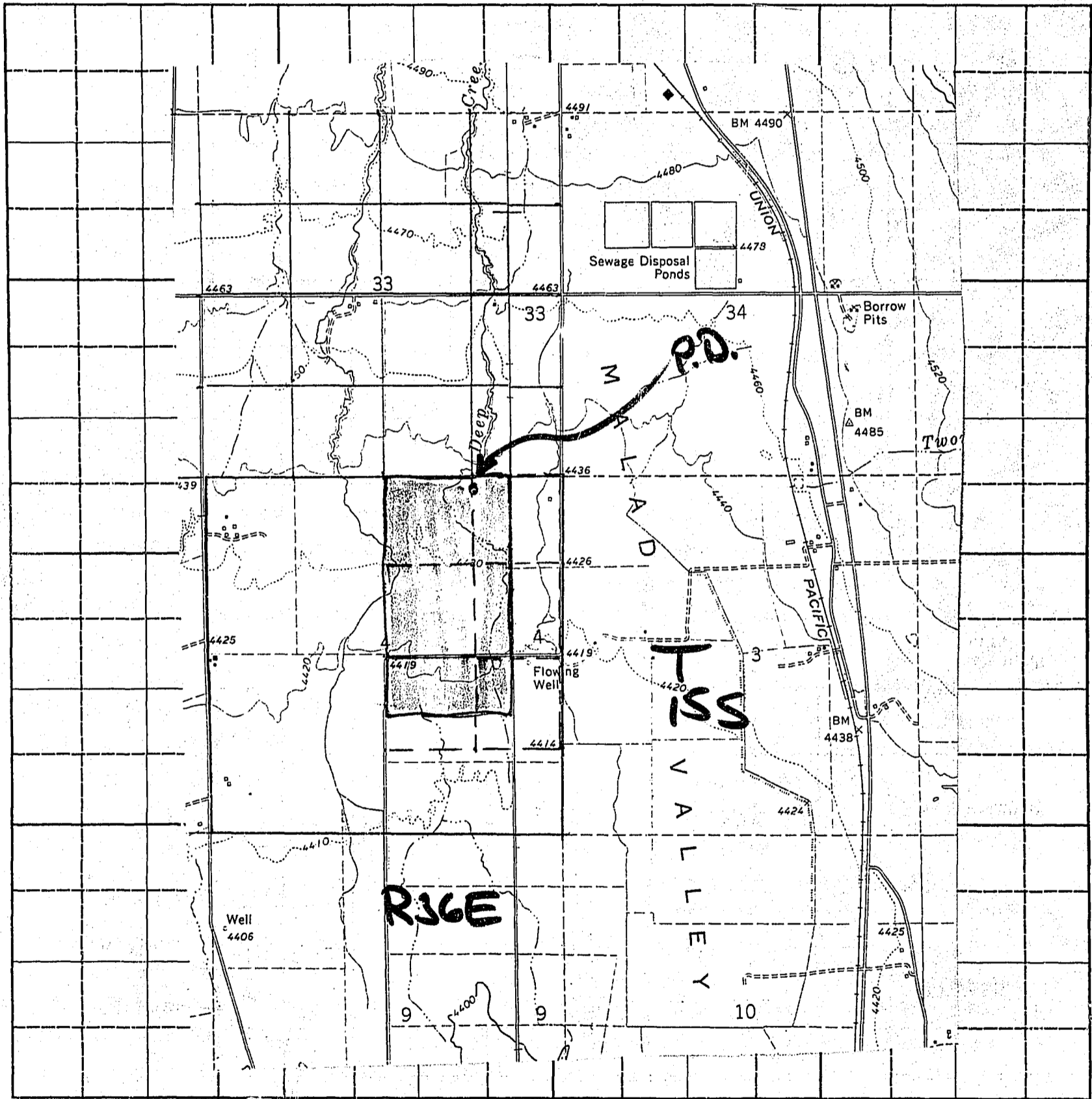

Scale: 2 inches equal 1 mile.

BE IT KNOWN that the undersigned hereby makes application for permit to appropriate the public waters of the State of Idaho as herein set forth.

Jennie Alder *Jeff Alder*
 (Applicant)

Received by CW Date 1-19-90 Time 12:15p Preliminary check by _____

Fee \$ 85.00 Received by HLS # E011796 Date 1-19-90

Publication prepared by RB Date 4-19; 26-90 Published in ID Enterprise
7-19; 26-90 9-6; 13-90

Publication approved RB RB Date 6-5-90 10-12-90

ACTION OF THE DIRECTOR, DEPARTMENT OF WATER RESOURCES

This is to certify that I have examined Application for Permit to appropriate the public waters of the State of Idaho No. _____, and said application is hereby _____.

1. Approval of said application is subject to the following limitations and conditions:

- a. SUBJECT TO ALL PRIOR WATER RIGHTS.
- b. Proof of construction of works and application of water to beneficial use shall be submitted on or before _____, 19 ____.
- c. The rate of diversion, if water is to be used for irrigation under this permit, when combined with all other water rights for the same land shall not exceed 0.02 cubic feet per second for each acre of land.
- d. The water right acquired under this permit if for hydropower purposes shall be junior and subordinate to all rights to the use of water, other than hydropower, within the State of Idaho that are initiated later in time than the priority of this permit and shall not give rise to any right or claim against any future rights to the use of water, other than hydropower, within the State of Idaho initiated later in time than the priority of this permit.
- e. Other:

No 1260

AFFIDAVIT OF PUBLICATION

RECEIVED

STATE OF IDAHO, }
County of Oneida } ss.

OCT 4 1990

Department of Water Resources
Eastern District Office

Sandra Struhs
being duly sworn,

deposes and says: That she is the secretary of THE IDAHO ENTERPRISE, a weekly newspaper published at Malad, in the County of Oneida and State of Idaho; that said paper has been and is in general circulation in the county aforesaid, and in the vicinity of Malad; that the advertisement, a copy of which is attached hereto, was published in said newspaper once a week for 2 consecutive weeks in the regular and entire issue of said paper during the period of time of publication, and was published in the newspaper proper and not a supplement; that said paper has been established and regularly published for more than seventy-eight consecutive weeks prior to the date of first publication of said advertisement.

Such notice was published in the issue beginning with

September 6, 19 90, and ending with the issue of September 13, 19 90

Sandra Struhs

Fee \$ 65.84

Subscribed and sworn to before me this 3rd day

of October, 19 90

Susan J. Wittman
Notary Public Residing at Malad, Idaho

My Commission Expires 2.9, 19 94

NOTICE OF APPLICATION FOR WATER RIGHT

The Following application(s) have been filed to appropriate the public waters of the State of Idaho:

15-07117

ALDER, JENNIE
ALDER, JEFF
440 S. MAIN
MALAD, ID 83252
Source: GROUNDWATER
Diversion Pt:

NENE Sec 4 T 15S R 36E
Use: IRRIGATION (3.000 CFS)
Total Diversion: (3.000 CFS)

Date Filed: 1/19/1990
In: T15S R36E S04
NENE NWNE SWNE SENE
NESE NWSE
150.0 ACRES TOTAL
15-07122

JONES, CAROL D.
JONES, DEON D.
RT. 1 BOX 133
MALAD CITY, ID 83252
Source: SPRING Tributary: SINKS
Diversion Pt:

SESENW Sec 8 T 14S R 36E
Use: IRRIGATION (.100 CFS)
STOCKWATER (.030 CFS)
Total Diversion: (.100 CFS)

Date Filed: 4/17/1990
In: T14S R36E S08 NESW
5.0 ACRES TOTAL
15-07123

EVANS, DAVID E
519 FRUITVALE ROAD
VACAVILLE, CALIFORNIA 95688
Source: GROUNDWATER
Diversion Pt:

NWNE Sec 15 T 14 S R 36E
Use: STOCKWATER (.030 CFS)
Total Diversion: (.030 CFS)

Date Filed: 6/25/1990
In: T14S R36E S15 NWNE

The permit(s) will be subject to all prior water rights. Protests must be filed with the Director, Dept. of Water Resources, Eastern Region, 150 Shoup Avenue, Suite 15, Idaho Falls, Idaho 83402 on or before SEPTEMBER 24, 1990.

R. KEITH HIGGINSON,
Director

No. 1260
9-6-13 T2

No 1245

AFFIDAVIT OF PUBLICATION

RECEIVED

STATE OF IDAHO, }
County of Oneida } ss.

AUG - 6 1990

Department of Water Resources
Eastern District Office

Sandra Strub

being duly sworn,
deposes and says: That she is the secretary of THE IDAHO ENTERPRISE, a weekly newspaper published at Malad, in the County of Oneida and State of Idaho; that said paper has been and is in general circulation in the county aforesaid, and in the vicinity of Malad; that the advertisement, a copy of which is attached hereto, was published in said newspaper once a week for 2 consecutive weeks in the regular and entire issue of said paper during the period of time of publication, and was published in the newspaper proper and not a supplement; that said paper has been established and regularly published for more than seventy-eight consecutive weeks prior to the date of first publication of said advertisement.

Such notice was published in the issue beginning with July 19, 1990, and ending with the issue of July 26, 1990
Sandra Strub

Fee \$ 54.46

Subscribed and sworn to before me this 27th day of July, 1990.

Susan J. Wittman

Notary Public, Residing at Malad, Idaho

My Commission Expires Feb. 9, 1994

Application Notice

NOTICE OF APPLICATION FOR WATER RIGHT

The Following application(s) have been filed to appropriate the public waters of the State of Idaho:

15-07117

ALDER, JEFF
ALDER, JENNIE
440 S. MAIN
MALAD, ID 83252
Source: GROUNDWATER
Diverson Pt: NENE

Sec 4 T 15S R 36E

Use: IRRIGATION (3,000 CFS)

Total Diverson: (3,000 CFS)

Date Filed: 1/19/1990

In: T15S R36E S04

NENE NWNE SWNE SENE

NESW NWSW

150.0 ACRES TOTAL

15-07122

JONES, CAROL D.
JONES, DEON D.
RT. 1, BOX 133
MALAD CITY, IDAHO 83252
Source: SPRING Tributary: SINKS
Diverson Pt: SESENW
Sec 8 T 14S R 36E S08 NESW
5.0 ACRES TOTAL

The permit(s) will be subject to all prior water rights. Protests must be filed with the Director, Dept. of Water Resources, Eastern Region, 150 Shoup Avenue, Suite 15, Idaho Falls, Idaho 83402 on or before AUGUST 26, 1990.

R. KEITH HIGGINSON,
Director

No. 1245
7-18-26 T2

Nº 1211

AFFIDAVIT OF PUBLICATION

RECEIVED

MAY 10 1990

STATE OF IDAHO, }
County of Oneida } ss.

Department of Water Resources
Eastern District Office

Sandra Struhs

being duly sworn,
deposes and says: That she is the secretary of THE IDAHO ENTERPRISE, a weekly newspaper published at Malad, in the County of Oneida and State of Idaho; that said paper has been and is in general circulation in the county aforesaid, and in the vicinity of Malad; that the advertisement, a copy of which is attached hereto, was published in said newspaper once a week for 2 consecutive weeks in the regular and entire issue of said paper during the period of time of publication, and was published in the newspaper proper and not a supplement; that said paper has been established and regularly published for more than seventy-eight consecutive weeks prior to the date of first publication of said advertisement.

Such notice was published in the issue beginning with April 19, 19 90, and ending with the issue of April 26, 19 90

Sandra Struhs

Fee \$ 144.23

Subscribed and sworn to before me this 7th day of May, 19 90

Susan J. Wittman

Notary Public, Residing at Malad, Idaho

My Commission Expires February 9, 19 94

Water Right Notice

NOTICE OF APPLICATION FOR WATER RIGHT

The Following applications(s) have been filed to appropriate the public waters of the State of Idaho:

15-07114
COUCH, GERALD
COUCH, CONSTANCE
405 CHERRY CREEK WOODRUFF RD.
MALAD, ID 83252
Source: GROUNDWATER
Diversion Pt: SENE
Sec 14 T 15S R 36 E
SWNW Sec 15 T 15S R 36E
Use: IRRIGATION(6.800 CFS)
Total Diversion: (6.800 CFS)

Date Filed: 12/21/1989
In: T15S R36E S14
NENE NWNE SWNE SENE
NESE NWSE SESE
S15 SWNW NWSW SWSW
330.0 ACRES TOTAL
15-07115

MC BRIDE, REED
86 E. 155 S.
MALAD, ID 83252
Source: GROUNDWATER
Diversion Pt: SENE
Sec 3 T 15S R 36E
Use: IRRIGATION(.400 CFS)
STOCKWATER(.020 CFS)
DOMESTIC(.040 CFS)
Total Diversion: (.460 CFS)

Date Filed: 12/13/1989
In: T15S R36E S03SENE
24.0 ACRES TOTAL
15-07117

ALDER, JEFF
ALDER, JENNIE
440 S. Main
MALAD, ID 83252
Source: GROUNDWATER
Diversion Pt:
NENE Sec 4 T 15S R 36E
Use: IRRIGATION(3.000 CFS)
Total Diversion: (3.000 CFS)

Date Filed: 1/19/1990
In: T15S R36E S04
NENE NWNE SWNE SENE
NESW NWSW
150.0 ACRES TOTAL
15-07118

ALDER, JEFF
ALDER, JENNIE
440 S. Main
MALAD, ID 83252
Source: TWO MILE CREEK
Tributary: SINKS
Diversion Pt: SWSE
Sec 35 T 14S R 36E
Use: IRRIGATION(3.220 CFS)
Total Diversion: (3.220 CFS)

Date Filed: 1/19/1990
In: T15S R36E S03
NWNE SENE NENW NWNW
SWNW SENW
161.0 ACRES TOTAL
15-07119

ALDER, JEFF
ALDER, JENNIE
440 S. MAIN

State of Idaho
Department of Water Resources

Permit To Appropriate Water

NO. 15-07117

Proposed Priority: January 19, 1990 Maximum Diversion Rate: 3.00 CFS

This is to certify, that JENNIE ALDER
JEFF ALDER
440 S. MAIN
MALAD, ID 83252

has applied for a permit to appropriate water from: GROUNDWATER
and a permit is APPROVED for development of water as follows:

<u>BENEFICIAL USE</u>	<u>PERIOD OF USE</u>	<u>RATE OF DIVERSION</u>
-----------------------	----------------------	--------------------------

IRRIGATION	04/01 to 11/01	3.00 CFS
------------	----------------	----------

LOCATION OF POINT(S) OF DIVERSION: NENE Sec. 4, Township 15S, Range 36E
ONEIDA County

PLACE OF USE: IRRIGATION

<u>TWN</u>	<u>RGE</u>	<u>SEC</u>	<u>ACRES</u>	<u>ACRES</u>	<u>ACRES</u>	<u>TOTAL</u>
15S	36E	4	NENE 20	NWNE 40	SWNE 40	150
			SENE 20	NESE 10	NWSE 20	

Total number of acres irrigated: 150

CONDITIONS/REMARKS:

1. Proof of construction of works and application of water to beneficial use shall be submitted on or before November 1, 1992.
2. Subject to all prior water rights.
3. Project construction shall commence within one year from the date of permit issuance and shall proceed diligently to completion unless it can be shown to the satisfaction of the Director of the Department of Water Resources that delays were due to circumstances over which permit holder had no control.
4. Permit holder shall comply with the drilling permit requirements of Section 42-235, Idaho Code.

This permit is issued pursuant to the provisions of Section 42-204, Idaho Code.
Witness the seal and signature of the Director, affixed at Boise, this

6th day of November, 1990.

R. Keith Higginson
for R. Keith Higginson, Director

The permit(s) will be subject to all prior water rights. Protests must be filed with the Director, Dept. of Water Resources, Eastern Region, 150 Shoup Avenue, Suite 15, Idaho Falls, Idaho 83402 on or before AUGUST 26, 1990.

R. KEITH HIGGINSON, Director

Published 7/19/1990 & 7/26/1990

15-07117

ALDER, JEFF
ALDER, JENNIE
440 S. MAIN
MALAD, ID 83252

Source: GROUNDWATER

Diversion Pt: NENE Sec 4 T 15S R 36E

Use: IRRIGATION (3.000 CFS)
Total Diversion: (3.000 CFS)

Date Filed: 1/19/ 1990

In: T15S R36E S04 NENE NWNE SWNE SENE
NESW NWSW

150.0 ACRES TOTAL

NOTICE OF APPLICATION FOR WATER RIGHT

The Following application(s) have been filed to appropriate the public waters of the State of Idaho:

S T A T E O F I D A H O
DEPARTMENT OF WATER RESOURCES
Eastern Region
150 Shoup Ave., Suite 15

Idaho Falls, Idaho 83402
(208) 525-7161

JULY 11, 1990

THE IDAHO ENTERPRISE
P.O. BOX 205
MALAD CITY, ID 83252

Gentlemen:

Enclosed you will find a legal notice which we wish to have published on the dates indicated (once a week for two consecutive weekly issues) in your newspaper. If you cannot publish the notice on the proposed dates, please contact us immediately.

An affidavit of publication must be submitted to the Department along with the publication bill. Your cooperation is appreciated.

Please send the affidavit of publication and publication billing to this office before AUGUST 26, 1990.

Yours truly,

Rita Bodell
Secretary

Encl.

15-07117

ALDER, JEFF
ALDER, JENNIE
440 S. MAIN
MALAD, ID 83252

Source: GROUNDWATER

Diversion Pt: NENE Sec 4 T 15S R 36E

Use: IRRIGATION (3.000 CFS)
Total Diversion: (3.000 CFS)

Date Filed: 1/19/ 1990

In: T15S R36E S04 NENE NWNE SWNE SENE
NESW NWSW

150.0 ACRES TOTAL

19-Apr-1990

Jennie or Jeff Alder
440 S. Main
Malad, ID 83252

RE: Application for Permit No. 15-7117, 15-7118, 15-7119,
15-7120, & 15-7121

Dear Water Right Applicant:

The Department of Water Resources acknowledges receipt of your water right permit. This office is currently in the process of advertising the application in the Idaho Enterprise on April 19 & 26, 1990. The advertisement will be published for two consecutive weeks, and a period of ten days following the second publication will be allowed for the submittal of protests.

If the application is protested, you will be sent a copy of the protest. The protest must be resolved before the application is approved or denied. If the protest is not resolved voluntarily, this Department will conduct a conference and/or hearing on the matter.

If the application is not protested, it will be forwarded to our state office in about five weeks. State office personnel will conduct a complete review prior to final processing of the application and will notify you of the outcome of this review. When a permit is issued, you will be sent a copy. A typical processing time for an unprotested application is about eight weeks.

Please feel free to contact this office if you have any questions regarding this procedure.

Sincerely,

HAROLD W. JONES
Water Rights Supervisor

15-07117

ALDER, JENNIE
ALDER, JEFF
440 S. MAIN
MALAD, ID 83252

Source: GROUNDWATER

Diversion Pt: NENE Sec 4 T 15S R 36E

Use: IRRIGATION (3.000 CFS)
Total Diversion: (3.000 CFS)

Date Filed: 1/19/ 1990

In: T15S R36E S04	NENE	NWNE	SWNE	SENE
	NESE	NWSE		

150.0 ACRES TOTAL

NOTICE OF APPLICATION FOR WATER RIGHT

The Following applica on(s) have been filed to appropriate the public waters of the State of Idaho:

STATE OF IDAHO
DEPARTMENT OF WATER RESOURCES
Eastern Region
150 Shoup Ave., Suite 15

Idaho Falls, Idaho 83402
(208) 525-7161

AUGUST 21, 1990

THE IDAHO ENTERPRISE
P.O. BOX 205
MALAD CITY, ID 83252

Gentlemen:

Enclosed you will find a legal notice which we wish to have published on the dates indicated (once a week for two consecutive weekly issues) in your newspaper. If you cannot publish the notice on the proposed dates, please contact us immediately.

An affidavit of publication must be submitted to the Department along with the publication bill. Your cooperation is appreciated.

Please send the affidavit of publication and publication billing to this office before SEPTEMBER 24, 1990.

Yours truly,

Rita Bodell
Secretary

Encl.

MEMORANDUM

TO: EASTERN REGION
FROM: KAY WALKER *Kay*
RE: APPLICATION FOR PERMIT NO. 15-7117
DATE: 26-JUN-1990

=====

There is an error on the place of use description. The map shows the p/u in the NE1/4 and N1/2SE1/4. The legal description describes use in the SW1/4. Please correct and re-advertise this one. Thanks!! Kay

Rita, re-ad at our expense

Dave - HWT 10-12-90

RECEIVED

JUN 28 1990

Department of Water Resources
Eastern District Office



State of Idaho
DEPARTMENT OF WATER RESOURCES

1301 North Orchard Street, Statehouse Mail, Boise, Idaho 83720 -(208) 327-7900

CECIL D. ANDRUS

GOVERNOR

R. KEITH HIGGINSON

DIRECTOR

November 7th, 1990

JENNIE ALDER
JEFF ALDER
440 S. MAIN
MALAD, ID 83252

PERMIT APPROVAL NOTICE

RE: PERMIT NO. 15-07117

Dear Permit Holder:

Enclosed is a copy of your approved application for permit. We direct your attention to the conditions of approval on the final page.

As a permit owner you must commence the excavation or construction of the diverting works within one year of the date the permit was issued, and you must proceed diligently until the project is completed. The date shown under condition no. 1 is the date when the project must be completed. You will receive a "Proof Due Notice" from this Department approximately 60 days prior to the completion date requiring you to file either a Proof of Beneficial Use form stating that the project has been completed or file a Request for an Extension of Time in which to file the proof statement.

Section 42-235, Idaho Code, requires that a "drilling permit" must be obtained from the department for all wells constructed after July 1, 1987. A drilling permit is a separate permit that must be issued in addition to your permit to appropriate water. Commencement of well construction or diversion of water under your permit to appropriate water is prohibited unless a drilling permit is obtained.

Be sure to note the special condition requiring you to install a measuring device. Enclosed, for your reference, is a list of measuring device options.

Sincerely,

JIM JOHNSON
Water Rights Supervisor

JJ:blm

Enclosures

RECEIVED

OCT 26 1992

For Office Use Only
\$15 Fee Received by HWS
Date 10-26-92
Receipt No. E018051

STATE OF IDAHO Department of Water Resources
DEPARTMENT OF WATER RESOURCES Eastern District Office

REQUEST FOR EXTENSION OF TIME
TO PROVIDE ADDITIONAL TIME IN WHICH TO SUBMIT PROOF OF
BENEFICIAL USE FOR A WATER RIGHT PERMIT

The Idaho Department of Water Resources will consider this form as a request that the permit holder(s) be granted an additional period of time in which to complete development of water right under the provisions of Section 42-204, Idaho Code.

Permit No. 15 - 07117

Name(s) of Permit Holder: Jennie Alder + Jeff Alder

Mailing Address: 215 Cherry Creek Road Malad, Idaho 83252

Date Proof is Due Nov. 1, 1992 Telephone No. 208 - 766 - 4946

Describe what work has been completed toward the development of this water right:
(This must be filled out! If no work has been completed, show "none".)

The well has been drilled to 233 feet with 16 inch well casing but needs to be perforated again.

Costing \$ 15,000⁰⁰

The permit holder(s) has been unable to complete the remainder of the work for the following reasons:

We are now waiting for the well driller to come back and perforate the casing again; because it was not done right the first time. Then we will install a pump to complete the project.

Permit holder(s) request an extension to June, 19 93.

FEE: \$15.00

(Signature)* Jeff Alder
*If other than permit holder, Power of Attorney must be supplied.

ACTION OF THE DEPARTMENT OF WATER RESOURCES

IT IS HEREBY ORDERED that the above request for extension of time be APPROVED and the time within which to submit proof of beneficial use is extended to June 1, 1993.

Signed this 3rd day November, 19 92

J. Glen Taylor
Chief, Water Allocation Bureau

August 31, 1992

JENNIE ALDER
JEFF ALDER
440 S. MAIN
MALAD ID 83252

PROOF DUE NOTICE

RE: PERMIT NO. 15-07117

Dear Permit Holder:

One of the conditions of approval of the above referenced water permit was that proof of the extent of your beneficial use must be submitted to this office on or before November 1, 1992. (See last page of your approved permit or your last approved extension request.) Enclosed is a form which when accompanied by the license examination fee or a complete field examination report prepared by a certified water right examiner may be used to submit the required proof.

If you have not fully completed your project, and you or a previous owner of this permit have not received a prior extension of time, you may request an extension of time if the delay is for reasonable cause as provided in Section 42-204, Idaho Code. If you have been prevented from proceeding by a governmental agency or by litigation which might bring title to the water in question, more than one extension of time can be granted. An extension of time request form is enclosed for your convenience.

Either an acceptable proof of beneficial use submittal or an acceptable request for an extension of time must be received by this department on or before the above described proof due date. If neither is received, the department will send you a lapse notice. Within sixty (60) days of the mailing of the lapse notice, the permit will no longer be of any force nor effect.

SINCERELY,

Karen L. Gustafson
Secretary/Records Manager

Enclosures

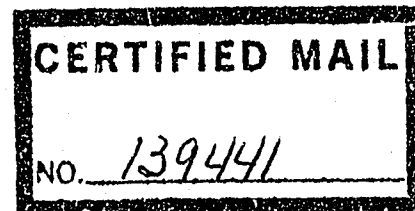



State of Idaho

DEPARTMENT OF WATER RESOURCES

1301 North Orchard Street, Statehouse Mail, Boise, Idaho 83720-9000

Phone: (208) 327-7900 FAX: (208) 327-7866

CECIL D. ANDRUS
GOVERNOR

R. KEITH HIGGINSON
DIRECTOR

November 3, 1992

Jennie and Jeff Alder
440 South Main
Malad, ID 83252

Re: Permit No. 15-07117

Dear Permit Holder:

Enclosed is a copy of the approved request for extension of time. The time within which to submit proof of beneficial use is extended to June 1, 1993. Please note that the department has granted this extension based on due diligence. It is important that you work diligently toward the completion of this project during the construction period allowed. The department may not be able to grant additional requests.

If you have any questions or if I can be of any further assistance, please feel free to contact this office.

Sincerely,

Karen L. Gustafson
Secretary/Records Manager

Enclosure

C: IDWR-Regional Office

BEFORE THE DEPARTMENT OF WATER RESOURCES
OF THE
STATE OF IDAHO

IN THE MATTER OF PERMIT NO. 15-07117) ORDER EXTENDING
IN THE NAME OF JENNIE AND JEFF ALDER) PROOF OF
BENEFICIAL USE

WHEREAS, the Department has issued the above-captioned permit with the condition that proof of construction of works and application of water to beneficial use be submitted on or before June 1, 1993; and,

WHEREAS, notice was not given to the permit holder sixty days prior to the date that proof of beneficial use of water was due as required by Section 42-204, Idaho Code;

IT IS THEREFORE HEREBY ORDERED that the time within which to submit the proof of beneficial use of water under Permit No. 15-07117 be extended to November 1, 1993.

Dated this 13th day of August, 1993.

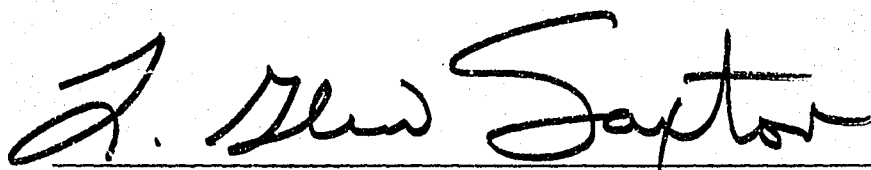
L. GLEN SAXTON
Chief, Water Allocations Bureau

RECEIVED

OCT 29 1993

Department of Water Resources

OFFICE USE ONLY

Amt. of Fee \$ 150.00

Date 10-29-93

Receipt No. C028889

Receipt by _____

STATE OF IDAHO
DEPARTMENT OF WATER RESOURCES

PROOF OF BENEFICIAL USE

The Idaho Department of Water Resources considers this form a statement that the permit holder(s) has/have completed all development that will occur under this permit and that water has been applied according to the provisions of the permit for the beneficial use(s) described below. This form must be accompanied by a license examination fee, when necessary, or a completed field examination report prepared by a certified water right examiner who has been appointed by the department.

- 1. Permit No. 15 - 07117 Telephone No. 208 - 766 - 4946
- 2. Name(s) of Permit Holder(s): Jeff Alder and Jennie Alder
- 3. Mailing Address: 215 Cherry Creek Rd. Malad, Idaho 83252
- 4. Source of Water: Groundwater - Well

If GROUNDWATER, Well Driller's Name: Arnold Lundstrom Date Drilled: 1991

OPTIONAL:

Pump horsepower: 50 HP Pressure (psi): _____ Dynamic pumping level (ft.): _____

- 5. Extent of Use (as authorized by the permit):

Domestic _____ (No. of households) Stockwater _____ (No. and type of stock)

Irrigation 150 (No. of acres) Other _____

- 6. Total rate and/or volume for which proof is submitted 3.00 cfs OR _____ acre/feet

- 7. Refer to the approval conditions on your permit and respond accordingly:

Measuring device: Required? ___ Yes ___ NO Installed? ___ Yes ___ No

OR
Flow Measurement Port: Required? ___ Yes ___ NO Installed? ___ Yes ___ No

- 8. Fee Enclosed: \$ 150.00 (See License Fee Schedule on back of Instruction Sheet)

- 9. Person to contact to accompany the Department representative during field examination of the water system.

Jeff Alder 208 - 766 - 4946
Name Telephone No.

215 Cherry Creek Rd. Malad, Id. 83252
Address

- 10. The above information is my true statement of the extent to which the above numbered permit has been developed and I relinquish any undeveloped portion of the permit to the state of Idaho.

10/24/93 Jeff Alder
Date Signature (and title, if on behalf of a company or organization)



State of Idaho
DEPARTMENT OF WATER RESOURCES

1301 North Orchard Street, Statehouse Mail, Boise, Idaho 83720-9000
Phone: (208) 327-7900 FAX: (208) 327-7866

CECIL D. ANDRUS
GOVERNOR

R. KEITH HIGGINSON
DIRECTOR

August 31, 1993

Jeff and Jennie Alder
440 S Main
Malad, ID 83252

PROOF DUE NOTICE

RE: Permit No. 15-07117

Dear Permit Holder:

One of the conditions of approval of the above referenced water permit was that proof of the extent of your beneficial use must be submitted to this office on or before November 1, 1993. (See last page of your approved permit or your last approved extension request.) Enclosed is a form which when accompanied by the license examination fee or a complete field examination report prepared by a certified water right examiner may be used to submit the required proof.

If you have not fully completed your project, and you or a previous owner of this permit have not received a prior extension of time, you may request an extension of time if the delay is for reasonable cause as provided in Section 42-204, Idaho Code. If you have been prevented from proceeding by a governmental agency or by litigation which might bring title to the water in question, more than one extension of time can be granted. An extension of time request form is enclosed for your convenience.

Either an acceptable proof of beneficial use submittal or an acceptable request for an extension of time must be received by this department on or before the above described proof due date. If neither is received, the department will send you a lapse notice. Within sixty days of the mailing of the lapse notice, the permit will no longer be of any force nor effect.

Sincerely,

Karen L. Gustafson
Secretary/Records Manager

Enclosures

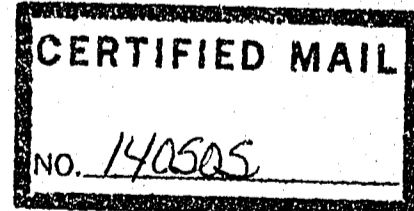



State of Idaho
DEPARTMENT OF WATER RESOURCES

1301 North Orchard Street, Statehouse Mail, Boise, Idaho 83720-9000
Phone: (208) 327-7900 FAX: (208) 327-7866

CECIL D. ANDRUS
GOVERNOR

R. KEITH HIGGINSON
DIRECTOR

November 1, 1993

Jeff and Jennie Alder
215 Cherry Creek Rd
Malad, ID 83252

Re: Permit No. 15-07117

Dear Permit Holder:

In the department's review of the proof of beneficial use submitted in connection with the above referenced permit, the department was not able to locate a drilling permit which should have been applied for before the opening of your well began. We have also been unable to locate a well log which should have been submitted by your well driller 30 days after completion of the construction of your wells. You have indicated on the proof of beneficial use that the well was drilled in 1991.

If you have a drilling permit or a copy of the well log, please provide this office with a copy of each. If you do not have a copy of the well log, please contact your driller and ask that he submit a copy. In your return letter, please be sure to show the above referenced permit number on any documents. Also, please address any correspondence directly to me. Your response, with both forms attached, should be received within 30 days of the date of this mailing.

This information is needed before the department can proceed further with the examination of your system and the eventual issuance of a license of water right.

If you have any questions or if I can be of any further assistance, please feel free to contact me.

Sincerely,

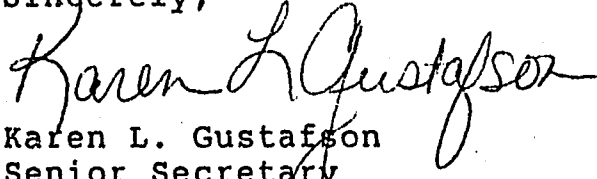

Karen L. Gustafson
Senior Secretary

Form 238-7
11/91

STATE OF IDAHO
DEPARTMENT OF WATER RESOURCES
WELL DRILLER'S REPORT

USE TYPEWRITER OR
BALLPOINT PEN

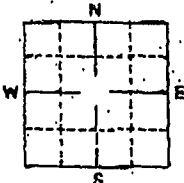
State law requires that this report be filed with the Director, Department of Water Resources
within 30 days after the completion or abandonment of the well.

<p>1. WELL OWNER</p> <p>Name <u>Jeff Alder</u></p> <p>Address <u>4405 Mountain Road Idaho</u></p> <p>Drilling Permit No. <u>15-92 E0030</u></p> <p>Water Right Permit No. <u>15-07-1107</u></p>	<p>7. WATER LEVEL</p> <p>Static water level _____ feet below land surface.</p> <p>Flowing? <input type="checkbox"/> Yes <input type="checkbox"/> No G.P.M. flow _____</p> <p>Artesian closed-in pressure _____ p.s.i.</p> <p>Controlled by: <input type="checkbox"/> Valve <input type="checkbox"/> Cap <input type="checkbox"/> Plug</p> <p>Temperature _____ °F Quality _____</p> <p><small>Describe artesian or temperature zones below.</small></p>																																																																																		
<p>2. NATURE OF WORK</p> <p><input checked="" type="checkbox"/> New well <input type="checkbox"/> Deepened <input type="checkbox"/> Replacement</p> <p><input type="checkbox"/> Well diameter increase <input type="checkbox"/> Modification</p> <p><input type="checkbox"/> Abandoned (describe abandonment or modification procedures such as liners, screen, materials, plug depths, etc. in lithologic log, section 9.)</p>	<p>8. WELL TEST DATA</p> <p><input type="checkbox"/> Pump <input type="checkbox"/> Baller <input type="checkbox"/> Air <input type="checkbox"/> Other _____</p> <table border="1" style="width:100%; border-collapse: collapse;"> <thead> <tr> <th>Discharge G.P.M.</th> <th>Pumping Level</th> <th>Hours Pumped</th> </tr> </thead> <tbody> <tr> <td></td> <td style="text-align: center;"><u>None</u></td> <td></td> </tr> </tbody> </table>	Discharge G.P.M.	Pumping Level	Hours Pumped		<u>None</u>																																																																													
Discharge G.P.M.	Pumping Level	Hours Pumped																																																																																	
	<u>None</u>																																																																																		
<p>3. PROPOSED USE</p> <p><input type="checkbox"/> Domestic <input checked="" type="checkbox"/> Irrigation <input type="checkbox"/> Monitor</p> <p><input checked="" type="checkbox"/> Industrial <input checked="" type="checkbox"/> Stock <input type="checkbox"/> Waste Disposal or Injection</p> <p><input type="checkbox"/> Other _____ (specify type)</p>	<p>9. LITHOLOGIC LOG</p> <table border="1" style="width:100%; border-collapse: collapse;"> <thead> <tr> <th rowspan="2">Bore Diam.</th> <th colspan="2">Depth</th> <th rowspan="2">Material</th> <th colspan="2">Water</th> </tr> <tr> <th>From</th> <th>To</th> <th>Yes</th> <th>No</th> </tr> </thead> <tbody> <tr> <td>20</td> <td>0</td> <td>20</td> <td>Clay</td> <td></td> <td><input checked="" type="checkbox"/></td> </tr> <tr> <td>16</td> <td>20</td> <td>51</td> <td>Clay</td> <td></td> <td><input checked="" type="checkbox"/></td> </tr> <tr> <td></td> <td>51</td> <td>60</td> <td>Green clay</td> <td></td> <td><input checked="" type="checkbox"/></td> </tr> <tr> <td></td> <td>60</td> <td>79</td> <td></td> <td></td> <td><input checked="" type="checkbox"/></td> </tr> <tr> <td></td> <td>79</td> <td>89</td> <td>White clay</td> <td></td> <td><input checked="" type="checkbox"/></td> </tr> <tr> <td></td> <td>89</td> <td>90</td> <td>Blue clay + rocks</td> <td></td> <td><input checked="" type="checkbox"/></td> </tr> <tr> <td></td> <td>90</td> <td>133</td> <td>Blue clay with some rocks</td> <td></td> <td><input checked="" type="checkbox"/></td> </tr> <tr> <td></td> <td>133</td> <td>160</td> <td>Blue clay - sandstone</td> <td></td> <td><input checked="" type="checkbox"/></td> </tr> <tr> <td></td> <td>160</td> <td>205</td> <td>tan clay + rocks</td> <td></td> <td><input checked="" type="checkbox"/></td> </tr> <tr> <td></td> <td>205</td> <td>217</td> <td>sand gravel + sandstone</td> <td></td> <td><input checked="" type="checkbox"/></td> </tr> <tr> <td></td> <td>217</td> <td>233</td> <td>blue sandstone</td> <td></td> <td><input checked="" type="checkbox"/></td> </tr> <tr> <td></td> <td>233</td> <td>240</td> <td>blue sandstone</td> <td></td> <td><input checked="" type="checkbox"/></td> </tr> </tbody> </table>	Bore Diam.	Depth		Material	Water		From	To	Yes	No	20	0	20	Clay		<input checked="" type="checkbox"/>	16	20	51	Clay		<input checked="" type="checkbox"/>		51	60	Green clay		<input checked="" type="checkbox"/>		60	79			<input checked="" type="checkbox"/>		79	89	White clay		<input checked="" type="checkbox"/>		89	90	Blue clay + rocks		<input checked="" type="checkbox"/>		90	133	Blue clay with some rocks		<input checked="" type="checkbox"/>		133	160	Blue clay - sandstone		<input checked="" type="checkbox"/>		160	205	tan clay + rocks		<input checked="" type="checkbox"/>		205	217	sand gravel + sandstone		<input checked="" type="checkbox"/>		217	233	blue sandstone		<input checked="" type="checkbox"/>		233	240	blue sandstone		<input checked="" type="checkbox"/>
Bore Diam.	Depth		Material	Water																																																																															
	From	To		Yes	No																																																																														
20	0	20	Clay		<input checked="" type="checkbox"/>																																																																														
16	20	51	Clay		<input checked="" type="checkbox"/>																																																																														
	51	60	Green clay		<input checked="" type="checkbox"/>																																																																														
	60	79			<input checked="" type="checkbox"/>																																																																														
	79	89	White clay		<input checked="" type="checkbox"/>																																																																														
	89	90	Blue clay + rocks		<input checked="" type="checkbox"/>																																																																														
	90	133	Blue clay with some rocks		<input checked="" type="checkbox"/>																																																																														
	133	160	Blue clay - sandstone		<input checked="" type="checkbox"/>																																																																														
	160	205	tan clay + rocks		<input checked="" type="checkbox"/>																																																																														
	205	217	sand gravel + sandstone		<input checked="" type="checkbox"/>																																																																														
	217	233	blue sandstone		<input checked="" type="checkbox"/>																																																																														
	233	240	blue sandstone		<input checked="" type="checkbox"/>																																																																														
<p>4. METHOD DRILLED</p> <p><input type="checkbox"/> Rotary <input type="checkbox"/> Air <input type="checkbox"/> Auger <input type="checkbox"/> Reverse rotary</p> <p><input checked="" type="checkbox"/> Cable <input type="checkbox"/> Mud <input type="checkbox"/> Other _____ (backhoe, hydraulic, etc.)</p>	<p>10.</p> <p>Work started <u>Oct 29</u> finished <u>Nov 29</u></p>																																																																																		
<p>5. WELL CONSTRUCTION</p> <p>Casing schedule: <input checked="" type="checkbox"/> Steel <input type="checkbox"/> Concrete <input type="checkbox"/> Other _____</p> <p>Thickness _____ inches Diameter _____ inches From _____ feet To _____ feet</p> <p>Was casing drive shoe used? <input checked="" type="checkbox"/> Yes <input type="checkbox"/> No</p> <p>Was a packer or seal used? <input type="checkbox"/> Yes <input checked="" type="checkbox"/> No</p> <p>Perforated? <input checked="" type="checkbox"/> Yes <input type="checkbox"/> No</p> <p>How perforated? <input checked="" type="checkbox"/> Factory <input type="checkbox"/> Knife <input type="checkbox"/> Torch <input type="checkbox"/> Gun</p> <p>Size of perforation? <u>1/2</u> inches by _____ inches</p> <table border="1" style="width:100%; border-collapse: collapse;"> <thead> <tr> <th>Number</th> <th>From</th> <th>To</th> </tr> </thead> <tbody> <tr> <td>40</td> <td>84</td> <td>90</td> </tr> <tr> <td>135</td> <td>135</td> <td>160</td> </tr> <tr> <td>135</td> <td>205</td> <td>232</td> </tr> </tbody> </table> <p>Well screen installed? <input type="checkbox"/> Yes <input checked="" type="checkbox"/> No</p> <p>Manufacturer _____ Type _____</p> <p>Top Packer or Headpipe _____</p> <p>Bottom of Tailpipe _____</p> <p>Diameter _____ Slot size _____ Set from _____ feet to _____ feet</p> <p>Gravel packed? <input type="checkbox"/> Yes <input type="checkbox"/> No <input type="checkbox"/> Size of gravel _____</p> <p>Placed from _____ feet to _____ feet</p> <p>Surface seal depth <u>20</u> Material used in seal: <input checked="" type="checkbox"/> Cement grout <input type="checkbox"/> Bentonite <input type="checkbox"/> Puddling clay</p> <p>Sealing procedure used: <input type="checkbox"/> Slurry pit <input type="checkbox"/> Temp. surface casing <input type="checkbox"/> Overbore to seal depth</p> <p>Method of joining casing: <input type="checkbox"/> Threaded <input type="checkbox"/> Welded <input type="checkbox"/> Solvent Weld <input type="checkbox"/> Cemented between strata</p> <p>Describe access port _____</p>	Number	From	To	40	84	90	135	135	160	135	205	232	<p>11. DRILLER'S CERTIFICATION</p> <p>I/We certify that all minimum well construction standards were complied with at the time the rig was removed.</p> <p>Firm Name <u>Landman Drilling</u> Firm No. _____</p> <p>Address <u>Idaho</u> Date <u>11-29-93</u></p> <p>Signed by Drilling Supervisor <u>Wendell Landman</u></p> <p>and _____ (Operator)</p> <p>(if different than the Drilling Supervisor)</p>																																																																						
Number	From	To																																																																																	
40	84	90																																																																																	
135	135	160																																																																																	
135	205	232																																																																																	
<p>6. LOCATION OF WELL</p> <p>Sketch map location must agree with written location.</p> <div style="display: flex; align-items: center;"> <div style="margin-right: 20px;">  </div> <div> <p>Subdivision Name _____</p> <p>Lot No. _____ Block No. _____</p> <p>County _____</p> <p>_____ 1/4 _____ 1/4 Sec. _____ T. _____ S. _____ R. _____ W. _____</p> </div> </div>	<p>11. DRILLER'S CERTIFICATION</p> <p>I/We certify that all minimum well construction standards were complied with at the time the rig was removed.</p> <p>Firm Name <u>Landman Drilling</u> Firm No. _____</p> <p>Address <u>Idaho</u> Date <u>11-29-93</u></p> <p>Signed by Drilling Supervisor <u>Wendell Landman</u></p> <p>and _____ (Operator)</p> <p>(if different than the Drilling Supervisor)</p>																																																																																		

Form 235-1
7/90

Drilling Permit No. 15-92E-0030-
Water Right Permit No. 15-07117
Injection Permit No. _____

State of Idaho
Department of Water Resources

APPLICATION FOR DRILLING PERMIT

SEP 23 1992
Department of Water Resources
Eastern District Office 5

1. Applicant (please print) Jeff Alder
2. Mailing Address 215 Cherry Creek Road
City & State Malad, Idaho Zip Code 83252 Telephone 208-766-4946
 Well Owner (Well Operator (Other, specify _____)
3. Proposed well location SE NE 20 1/8 NE NE 40 1/8 SE NE 40 1/8 or Gov't Lot No. NE 1/4 NE 1/4
Sec. 4 Twp. T5 S Rge. 36 E County Oneida
Street Address of Well Site Hayland Road
Lot, block and subdivision _____

4. Proposed use of well:

() Domestic: The use of water for homes, organization camps, public campgrounds, livestock and for any other purpose in connection therewith, including irrigation of up to 1/2 acre of land, if the total use is not in excess of 13,000 gpd; any other uses, if the total use does not exceed a diversion rate of 0.04 cfs and a diversion volume of 2500 gpd.

Domestic does not include water for multiple ownership subdivisions, mobile home parks, commercial, or business establishments, unless the use does not exceed a diversion rate of 0.04 cfs and a diversion volume of 2500 gpd.

Non-Domestic: Any beneficial use not included within the definition of domestic.

() Injection

() Monitoring - A well bore schematic and map is required for each well.
No. of proposed wells: _____

() Other _____
(Describe)

5. Well construction information:

A. New well (Deepen (Enlarge (Replace - See Condition 9

B. Proposed Surface Diameter 16" Proposed Maximum Depth 200' - 250'

C. Anticipated bottom hole temperature:

- 85°F or less (Cold water well)
- () 85°F to 212°F (Low temp. geothermal well)
- () 212° or more (Geothermal well)

Construction Start Date Oct. 92

Anticipated Well Driller Arnold Lundstrom

NOTE: The actual well driller must be identified prior to drilling.

Applicant's signature Jeff Alder Date Sept. 25, 1992

ACTION OF THE DEPARTMENT OF WATER RESOURCES

This Permit is Approved Date 10-6-92

If approved, this permit authorizes the construction or modification of a well subject to the following conditions. **READ CAREFULLY!**

GENERAL CONDITIONS:

1. The well must be constructed in compliance with the applicable statutes, specific conditions of approval shown on the water right permit, injection well permit, transfer or amendment and the rules and regulations of the Department for water appropriation, injection wells and well construction standards.
2. This drilling permit is valid for two (2) months from the above approval date for the start of construction and is valid for one (1) year from the approval date for completion of the well unless an extension has been granted.
3. This permit does not constitute an approval of the District Health Department or the Idaho Department of Health and Welfare which may be required before construction of this well. All wells must be drilled a minimum distance of 100 feet from a drain field. Domestic and Public Water Supply wells must be drilled a minimum distance of 50 feet and 100 feet respectively from a septic tank.
4. The well shall be constructed by a driller currently licensed in the State of Idaho who must maintain a copy of the drilling permit at the drilling site.
5. Approval of this drilling permit does not authorize trespass on the land of another party.
6. This permit does not constitute other local, county, state or federal approvals which may be required for construction of a well.
7. This drilling permit does not represent a right to divert and use the water of the State of Idaho.
8. If a bottom hole temperature of 85° or greater is encountered, well construction shall cease and the well driller and the well owner shall contact the Department immediately.
9. If this permit is for a replacement well, the well being replaced must be abandoned in accordance with Department Rules and Regulations.

SPECIFIC CONDITIONS:

[Signature]
Signature of Authorized Department Representative

[Signature]
Title

Receipt No. E017953 Received by [Signature] Fee ADD Date 10-6-92

EXTENSION OF DRILLING PERMIT

Extension approved by _____ Approval Date _____

This extension is good for 60 days beyond the above extension approval date.



State of Idaho

DEPARTMENT OF WATER RESOURCES

1301 North Orchard Street, Statehouse Mail, Boise, Idaho 83720-9000

Phone: (208) 327-7900 FAX: (208) 327-7866

Att: Julie

CECIL D. ANDRUS
GOVERNOR

R. KEITH HIGGINSON
DIRECTOR

November 1, 1993

Jeff and Jennie Alder
215 Cherry Creek Rd
Malad, ID 83252

Re: Permit No. 15-07117

Dear Permit Holder:

In the department's review of the proof of beneficial use submitted in connection with the above referenced permit, the department was not able to locate a drilling permit which should have been applied for before the opening of your well began. We have also been unable to locate a well log which should have been submitted by your well driller 30 days after completion of the construction of your wells. You have indicated on the proof of beneficial use that the well was drilled in 1991.

If you have a drilling permit or a copy of the well log, please provide this office with a copy of each. If you do not have a copy of the well log, please contact your driller and ask that he submit a copy. In your return letter, please be sure to show the above referenced permit number on any documents. Also, please address any correspondence directly to me. Your response, with both forms attached, should be received within 30 days of the date of this mailing.

This information is needed before the department can proceed further with the examination of your system and the eventual issuance of a license of water right.

If you have any questions or if I can be of any further assistance, please feel free to contact me.

Sincerely,

Karen L. Gustafson
Senior Secretary

December 1, 1993

JENNIE ALDER
JEFF ALDER
215 CHERRY CREEK RD
MALAD ID 83252

PROOF ACKNOWLEDGMENT LETTER

RE: PERMIT NO. 15-07117

Dear Permit Holder:

The department acknowledges receipt of the proof of beneficial use form submitted for the above referenced permit. The next step in the process of developing a water right is for the department to conduct a field examination to determine and confirm the use being made of the water.

If you have questions concerning this matter, please feel free to contact the EASTERN Regional Office in Idaho Falls at (208)525-7161.

Sincerely,

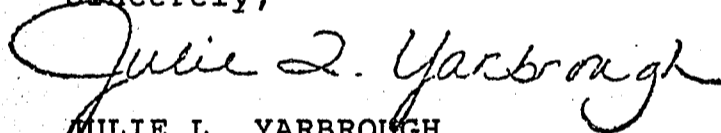

JULIE L. YARBROUGH
Senior Secretary

c: IDWR - Region