

R 7 E

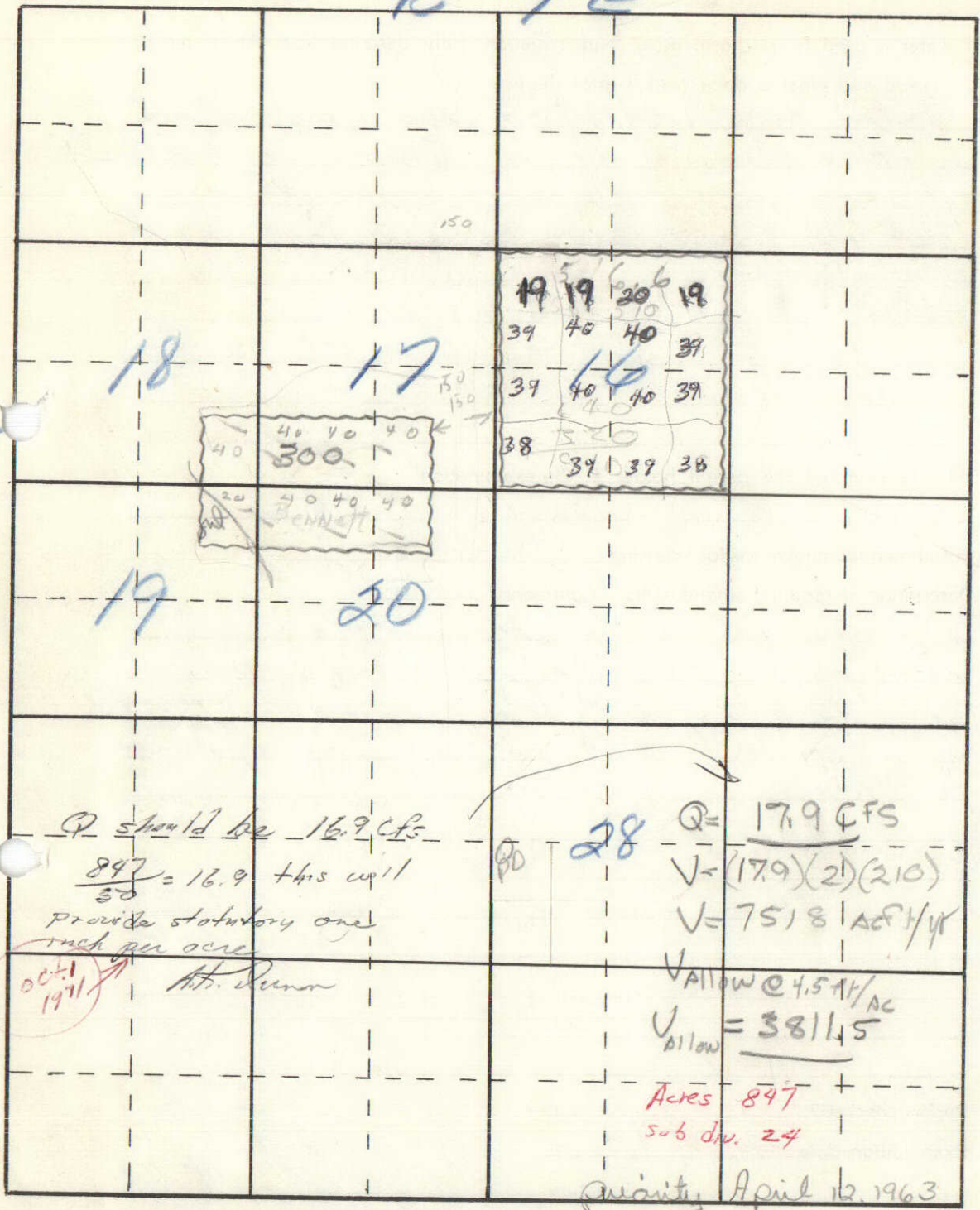

Q should be 16.9 cfs
 $\frac{897}{50} = 16.9$ this will provide statutory one inch per acre

28 Q = 17.9 cfs
 $V = (17.9)(2)(210)$
 $V = 7518 \text{ ACF/yr}$
 $V_{\text{allow}} @ 4.5 \text{ ACF/AC}$
 $V_{\text{allow}} = 38145$

Acres 897
 sub div. 24

Priority April 12 1963

62-2210
 Permit No. 31093
 Name of Applicant South Elmore Irrigation Company, Box 1201, Boise, Idaho
 Source of Water Snake River
 a tributary of Columbia
 Location of P.D. NW 1/4 SW 1/4, sec. 28, T. 5 S, R. 7 E, E.M., Elmore County

Water is used for irrigation
 Quantity of water claimed: Permit 18.7 c.f.s. Depositions 20.0 c.f.s.
 Type of measuring device installed or method of measurement and general description of diversion works gas engines, turbine pumps, buried mainline, and sprinklers 1650 - 5/32

Land to be irrigated or place of use:			Description
TWP.	RGE.	SEC.	
5 S	7 E	16	all
		17	S 1/2 SW 1/4, SW 1/4 SE 1/4
		18	SE 1/4 SE 1/4
		19	NE 1/4 NE 1/4
		20	NW 1/4 NE 1/4, N 1/2 NW 1/4

Total acreage 935 - Permit

Filed - April 12, 1963 Made - March 29, 1968
 Due - May 2, 1968 (c/w only) Priority - April 12, 1963

Other rights and acreage covered: (Indicate amounts, source, licensed or decreed, and acreage covered by subdivision; also show land covered on the map.)
 none

31802
 32291

Plot v

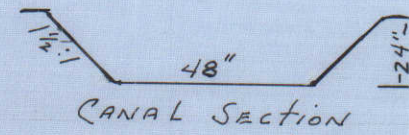
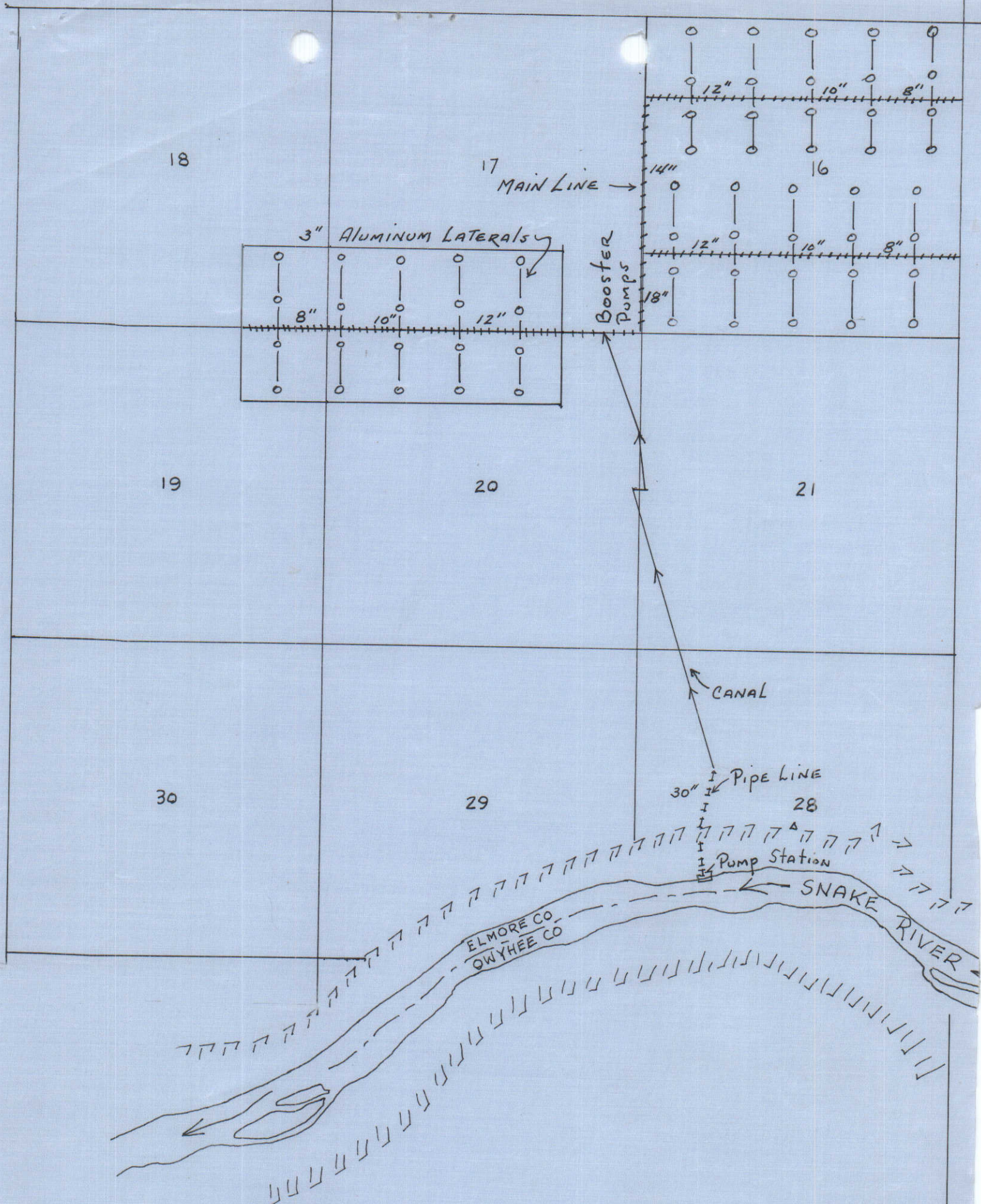

T.5 S. R.7 E.
 T.6 S. R.7 E.

Map of proposed irrigation system for
 GEORGE R. GREER
 Scale 1:24000

Permit Map No. 31083
 As Approved MAY 2 1963
 GEO. N. CARTER
 Reclamation Engineer

2 2210

31093

NOTICE OF PROOF OF COMPLETION OF WORKS

Notice is hereby given that on March 29, 1968 at Boise, County of Ada, State of Idaho, before notary public (name & address) W. P. Reser, 218 Idaho Building, Boise, Idaho, proof will be submitted of the completion of works for the diversion of 18.7 c.f.s. of the waters of Snake River, in accordance with the terms and conditions of permit 31093, heretofore issued by the Department of Reclamation of the State of Idaho.

1. The name and address of permit holder is South Elmore Irrigation Co., an Idaho corporation, P. O. Box 1201, Boise, Idaho 83701.
2. Said works of diversion will be fully completed on the date for such completion, and the amount of water which said works are capable of conveying to the place of use is 18.7 cubic feet per second.
3. The use to which said water will be applied is irrigation purposes, and the amount applied to beneficial use will be 18.7 c.f.s.
4. The point of diversion of said water is NW $\frac{1}{4}$ SW $\frac{1}{4}$, Sec. 28, T. 5 S., R. 7 E., B.M., Elmore County.
5. The place where said water will be used is all of Section 16, S $\frac{1}{2}$ SW $\frac{1}{4}$, SW $\frac{1}{4}$ SE $\frac{1}{4}$, Sec. 17; SE $\frac{1}{4}$ SE $\frac{1}{4}$, Sec. 18; NE $\frac{1}{4}$ NE $\frac{1}{4}$, Sec. 19; NW $\frac{1}{4}$ NE $\frac{1}{4}$, N $\frac{1}{2}$ NW $\frac{1}{4}$, Sec. 20, T. 5 S., R. 7 E., B.M.
6. The date of priority which said user is prepared to establish is April 12, 1963.

R. KEITH HIGGINSON
State Reclamation Engineer
First publication February 22, 1968
Last publication March 14, 1968

df

Affidavit of Publication

County of Elmore }
STATE OF IDAHO } ss.

I, *Lloyd S. Waters* do solemnly swear that I am the foreman, or publisher of the

MOUNTAIN HOME NEWS

a weekly newspaper of general circulation, published once a week at MOUNTAIN HOME, IDAHO, that the notice attached hereto and which is a part of the proof of publication thereof, was published in said newspaper for

4 consecutive weeks, the first publication having been made on the *22* day of *February*, 19*68*, and the last publication having been made on the *14* day of *March*, 19*68*; every Thursday issue of the paper during the period and time of publication and that the notice was published in the newspaper proper and not in a supplement thereof.

And I further swear that the said MOUNTAIN HOME NEWS has been continuously and uninterruptedly published in said Elmore County during a period of 78 consecutive weeks prior to the first publication of the attached notice.

Lloyd S. Waters

Subscribed and sworn to me this *14* day of *March*, 19*68*.

Vivian M. Waters
Notary Public

RECEIVED

MAR 15 1968

Department of Reclamation



31093

State of Idaho
Department of Water Administration

LICENSE OF WATER RIGHT

License of Water Right No. 02-2210 Priority 4-12-63 Amount 17.9 c.f.s.

THIS IS TO CERTIFY, that South Elmore Irrigation Company
of Boise, Idaho, has complied with the terms and conditions of Permit
No. 02-2210 issued pursuant to Application for Permit dated April 12, 1963,
and has submitted proof to the Department of Water Administration on March 29, 1968,
that he has applied water to a beneficial use; an examination by the Department indicates that the
works have a capacity of 19.7 c.f.s., and that the water has in fact been applied to a
beneficial use; a right to the use of water from Snake River
tributary of Columbia River, is hereby confirmed in the following amounts:
Amount 17.9 c.f.s. for Irrigation from March 15 to Nov. 15 (both dates inclusive)
Amount _____ for _____ from _____ to _____ (both dates inclusive)
Amount _____ for _____ from _____ to _____ (both dates inclusive)
Subject, however, to the condition that no more than 17.9 c.f.s. of water be diverted at
any one time, said waters to be diverted within the NW $\frac{1}{2}$ SW $\frac{1}{2}$ of Sec. 28, T. 5S, R. 7E,
B.M.

in the county of Elmore; and that the amount of water so diverted and to which such
right is entitled and confirmed is for the purposes aforesaid and is limited to the amount which can
actually be beneficially used and shall not exceed 3811.5 acre feet per year or _____
4.5 acre feet per acre.

Description and location of place of use:

TWP.	RANGE	SEC.	NE $\frac{1}{4}$				NW $\frac{1}{4}$				SW $\frac{1}{4}$				SE $\frac{1}{4}$				TOTALS
			NE $\frac{1}{4}$	NW $\frac{1}{4}$	SW $\frac{1}{4}$	SE $\frac{1}{4}$	NE $\frac{1}{4}$	NW $\frac{1}{4}$	SW $\frac{1}{4}$	SE $\frac{1}{4}$	NE $\frac{1}{4}$	NW $\frac{1}{4}$	SW $\frac{1}{4}$	SE $\frac{1}{4}$	NE $\frac{1}{4}$	NW $\frac{1}{4}$	SW $\frac{1}{4}$	SE $\frac{1}{4}$	
5 S	7 E	16	19	20	40	39	19	19	39	40	40	39	38	39	39	40	39	38	547
		17											40	40			40		120
		18																40	40
		19	20																20
		20	40				40	40											120
																		847	

Total number of acres irrigated _____

The right to the use of the water hereby confirmed is restricted and appurtenant to the lands
or place of use herein described, as provided by the laws of Idaho.

Witness the seal and signature of the Director, affixed at Boise, Idaho, this 16th day of
July, 1971.

Director

0528 2

Thomas Green

02-2210

Application For Permit To Appropriate the Public Waters of the State of Idaho

APPLICATION No. 39184
PERMIT No. 31093
DISTRICT No.

assigned
South to ...
2105
Joice, Oct 10

1. Name of Applicant: George R. Greer
Postoffice address: Twin Falls
828 Mountain View Dr.

County: Twin Falls

State: Idaho

- I. If applicant is a corporation, give:
 - (a) Date and place of incorporation:
 - (b) Amount of capital stock:
 - (c) Amount paid in:
 - (d) Names and addresses of directors:

Power of Attorney:
M. O. "Pete" Clements
Route #4, Nampa, Idaho

II. The financial resources of the applicant are:

- (a) Cash on hand:
- (b) Treasury stock:
- (c) Bond to be issued:
- (d) Other resources:

2. Quantity of water claimed: 18.7 cubic feet per second.

3. Source of water supply: Snake River which is a tributary of

4. Location of point of diversion: feet distant from the

corner of Section , T. , R. , B.M., and is in the NW $\frac{1}{4}$ SW $\frac{1}{4}$

of section 28 , T. 5 S , R. 7 E , B. M., County of Elmore

5. Water is to be used for Irrigation

6. If for mining, milling, power or manufacturing purposes, give:

(a) Point of use of water: feet distant from corner of Section
T. , R. , B.M., in the of Section of , T. , R. , B.M.

(b) Amount of power generated: H.P., under feet head.

(c) Water is to be returned to at a point feet
distant from the corner of Section , T. , R. , B.M., in the
of Section , T. , R. , B.M.

7. Estimated cost of works: \$ 210,000

8. Kind of works: Pumps, pipeline, canal

9. Height of dam feet; length of dam at top feet; length of dam at bottom
feet; material used in dam:

10. Size of headgate: Width 6 feet; height 8 feet.

11. Ditch: Width at bottom 4 feet; width at water line 5 feet; depth of water 2 feet;
dimensions of flume: None

Diameter of pipe 30 inches; length of conduit 1/2 miles.

Average grade per mile 5.0 feet.

12. The time required for the completion of such work is 5 years.

13. The time required for the complete application of the water to the proposed use is 6 additional years.

14. The land to be irrigated is described in the following tabulation: See remarks.

15. Existing water rights and/or valid permits appurtenant to the lands to be irrigated are: None

16. (a) Is reservoir to be used? No If so, fill in (b) and (c) below:
 (b) Name of Reservoir and number of Storage Permit:
 (c) Date of filing of Application for Storage Permit and Name of Applicant:

BE IT KNOWN THAT The undersigned hereby makes application for permit to appropriate the public water of the State of Idaho as herein set forth.

s/ George R. Greer Applicant.

By Agent.

Date of first receipt at Department of Reclamation: 3:00 P.M. April 12, 1963

Returned to applicant for correction:

Corrected application received:

Approval of State Reclamation Engineer

The number of this permit is 31093
 Recorded in Book 109 Page 31093 Approved May 2, 1963
 This is to certify that I have examined the within application for a permit to appropriate the public waters of the State of Idaho, and hereby approve the same, subject to the following limitations and conditions:
 Bond in the sum of \$ to be filed on or before
 Work to begin on or before July 2, 1963 and to continue diligently and uninterruptedly to completion, unless temporarily interrupted by circumstances over which permit holder has no control.
 One-fifth of the work above specified to be completed on or before November 2, 1965
 The whole of said work to be completed on or before May 2, 1968
 Beneficial use of water appropriated in accordance herewith, to be made on or before May 2, 1974

WITNESS My hand this 2 day of May, 1963

s/ CARL E. TAPPAN
 Ass't. State Reclamation Engineer.

IN TESTIMONY WHEREOF, WE, ROBERT E. SMYLLIE, Governor of the State of Idaho, and ARNOLD WILLIAMS, Secretary of State of the State of Idaho, have caused this instrument to be executed in the name of the State of Idaho, and caused the Great Seal of the State of Idaho to be hereunto affixed, this 2 day of May, 1963.

STATE OF IDAHO

Countersigned:

(SEAL) By s/ ARNOLD WILLIAMS Secretary of State.

By s/ ROBERT E. SMYLLIE Governor.

REMARKS:

14.

Twp.	Range	Sec.	NE ¹ / ₄				NW ¹ / ₄				SW ¹ / ₄				SE ¹ / ₄				Totals
			NE ¹ / ₄	NW ¹ / ₄	SW ¹ / ₄	SE ¹ / ₄	NE ¹ / ₄	NW ¹ / ₄	SW ¹ / ₄	SE ¹ / ₄	NE ¹ / ₄	NW ¹ / ₄	SW ¹ / ₄	SE ¹ / ₄	NE ¹ / ₄	NW ¹ / ₄	SW ¹ / ₄	SE ¹ / ₄	
5 S	7 E	16	20	35	40	40	40	40	40	40	40	40	40	40	40	40	40	615	
		17																120	
		18																40	
		19	40															40	
		20		40			40	40										120	
Total Number of Acres to be Irrigated																	935		

A S S I G N M E N T ✓

For value received, we hereby assign all our right, title and interest in and to Permit to Appropriate the Public Waters of the State of Idaho, No. 31093 to South Elmore Irrigation Co., an Idaho corporation.

/s/ GEORGE R. GREER, Permit Holder

JESSIE L. GREER, Spouse of Permit Holder

M. O. CLEMENTS, Permit Holder

M. L. CLEMENTS, Permit Holder

State of Idaho,)
) ss.
County of Twin Falls)

On this 29th day of January, 1966, before me, a Notary Public for the State of Idaho personally appeared George R. Greer, and Jessie L. Greer, husband and wife, known to me to be the persons whose names are subscribed to the within instrument and duly acknowledged to me that they executed the same.

In witness whereof, I have hereunto set my hand and affixed my official seal, the day and year in this certificate first above written.

/s/ KENNETH MITCHELL
Notary Public residing at Twin Falls, Idaho.

My commission expires: May 10, 1969

(S E A L)

State of Idaho)
) ss
County of Canyon)

On this 15th day of February, 1966, before me, the undersigned a Notary Public for Idaho, personally appeared M. O. Clements and M. L. Clements known to me to be the persons whose names are subscribed to the foregoing instrument and acknowledged to me that they executed the same.

In witness whereof, I have hereunto set my hand and affixed my official seal the day and year in this certificate first above written.

/s/ JERRY MABBOTT, Notary Public for the State of
Idaho. My commission expires: 9-20-69

(S E A L)

LICENSE ISSUED FOR 17.9 SEC. FT.
LICENSE PAGE NO.



STATE OF IDAHO
DEPARTMENT OF WATER RESOURCES
WESTERN DISTRICT — ANNEX 3

Cecil D. Andrus
Governor

Statehouse
Boise, Idaho 83720
(208) 384-2190

F. Keith Higginson
Director

December 11, 1975

Emel Clements
South Elmore Irrigating Co.
2105 Commerce Ave.
Boise, ID 83705

RE License No. 02-2210

Dear Mr. Clements:

I have reviewed the above license and find that the original application was made for 18.7 c.f.s. of water from Snake River for use of in irrigating 847 acres of land. When our examiner examined the distribution system and irrigated lands, he licensed your permit giving 1 inch of water per acre for 935 acres he found being irrigated at the time.

I know of no way in which the licensed water right could be changed now to include additional land or the use of additional water. It will be necessary to file a new application to include the lands put under the system since our examiner's inspection. The amount of water pumped at the time did not seem to be the factor which limited the amount of water shown on the license, but the amount of land being irrigated did not come up to the acreage applied for on the permit.

We are enclosing an application form and a set of instructions for use in filing for the additional water your are using.

Sincerely,

Robert W. Hamilton
ROBERT W. HAMILTON
Supervisor of Water Distribution

RWH:cls

Enclosure

MICROFILMED

R 7 E

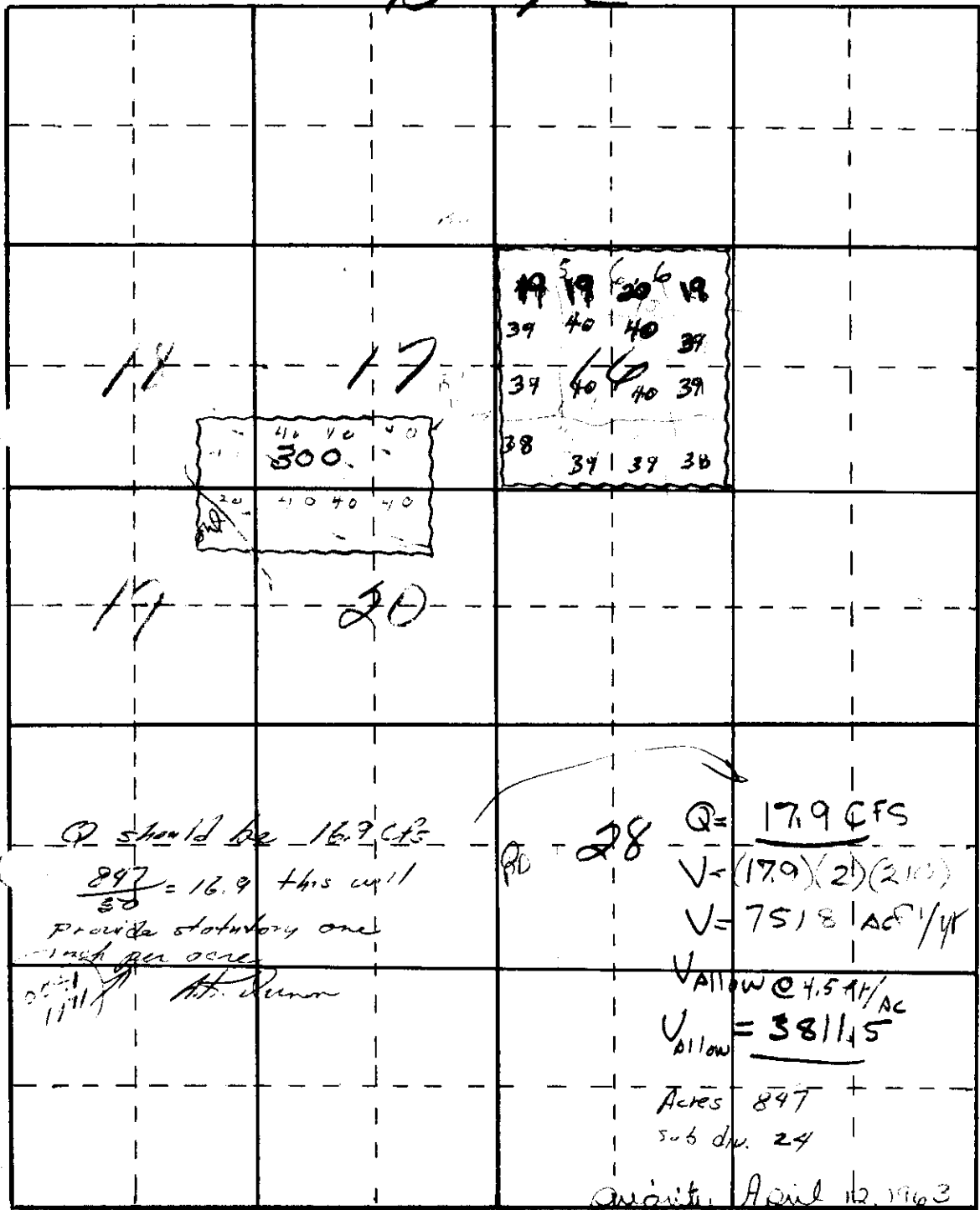

02-2210
 Permit No. 31093
 Name of Applicant South Elmore Irrigation Company, Box 1201, Boise, Idaho
 Source of Water Snake River
 a tributary of Columbia
 Location of P.D. NW 1/4 SW 1/4, sec. 28, T. 5 S, R. 7 E, E.M., Elmore County

Water is used for irrigation
 Quantity of water claimed: Permit 18,7 c.f.s. Depositions 20.0 c.f.s.
 Type of measuring device installed or method of measurement and general description of diversion works gas engines, turbine pumps, buried mainline, and sprinklers 1650 - 5/32

Land to be irrigated or place of use:

TWP.	RGE.	SEC.	Description
5 S	7 E	16	all
		17	S 1/2 SW 1/4, SW 1/4 SE 1/4
		18	SE 1/4 SE 1/4
		19	NE 1/4 NE 1/4
		20	NW 1/4 NE 1/4, N 1/2 NW 1/4

Total acreage 935 - Permit
 1060 - Depositions
 Filed - April 12, 1963 Made - March 29, 1968
 Due - May 2, 1968 (c/w only) Priority - April 12, 1963
 Other rights and acreage covered: (Indicate amounts, source, licensed or decreed, and acreage covered by subdivision; also show land covered on the map.)
 none

Q should be 16.9 CFS
 $\frac{897}{50} = 16.9$ this will
 provide statutory one
 inch per acre

Q = 17.9 CFS
 $V = (17.9)(2)(2100)$
 $V = 7518 \text{ AC}^1/4\text{R}$
 $V_{\text{allow}} @ 4.5 \text{ AF/AC}$
 $V_{\text{allow}} = 38145$
 Acres 897
 sub div. 24
 Priority April 12, 1963

31802
 32291

22-14

Source of supply South Elmore Irrig Canal
a tributary of Snake River

Location of P.D.(s) Water is taken from Snake at NWSW Sec 28
R 7 E T 5 S From Canal at NENE Sec 20 +
SE SE Sec 17

Water is used for Irrigation

Quantity of water found _____

How was the measurement made? Pres gauge + McCrometer

Measurement calculations _____

471 9/64" Heads @ 40 lbs = (471)(3.61) = 1700 gpm

460 5/32" Heads @ 50 lbs = (460)(4.95) = 2277

313 3/16" Heads @ 45 lbs = (313)(6.27) = 1963

#4 Reading 2500 gpm McCrometer

1700 + 2277 + 1963 + 2500 = 8840

8840 = 19.7 CFS
448

Diversion works description and diagram

250 HP Nat. Gas Engines

#4 Read 2500 gpm (McCrometer Meter)

Pump Nos - Jx 14033 + Jx 14037 + OW + 14036

Robinson pumps & US Motors Gear drives
on all.

Rainbirds

38 lines with 33 Heads each

313 - 3/16" Heads averaged 40 lbs 9/64 heads averaged 40 lbs

460 - 5/32" Heads averaged 50 lbs 471

Indicate area irrigated in each subdivision on the map.

Total acreage irrigated 846.6

If water is used for purposes other than irrigation, fully describe how the water is used and what is done with it after the use.

Total area irrigated was calculated
with a planimeter at Elmore Co ASCS office
Total area is 1032 Acres some of this
land is fringe area around the land
described in permit which has an
Actual total of 846.6 Acres
596.6 Acres in Sec 16 + 300 in Sec
17, 18, 19 + 20 Total 846.6

Who represented the permit holder at the examination?

Talked to Mr Clements in Nampa

Recommended allowance for licensing 17.9 CFS

Description of required amendments. Comments.

Company (Gen State Farms) is actually
irrigating considerably more land than
they have applied for. They have cultivated
as much land as they can - right up to the
hillsides

Report checked? _____

Examination date 22/5/70

Signature James Parker

APD 7/6/70

Attach to exam :

Dep. state 1060 A.
Permit states 935 A.

STATE OF IDAHO
DEPARTMENT OF RECLAMATION

Boise, Idaho

Permit No. 31093

Department of Reclamation

APR 1 1963

PROOF OF APPLICATION OF WATER TO BENEFICIAL USE

~~and~~ **Completion of Works**
DEPOSITION OF HOLDER

Ques. 1. State your name, residence occupation and postoffice address: _____

Mr. Clements At 4 Nampa Idaho

Ques. 2. If acting in behalf of corporation, state its name, principal place of business (if foreign corporation, give name of postoffice of statutory agent), your position with reference to same, and your authority for appearing in its behalf:

Gem Mountain Farms Inc At 4 Nampa Id. Mr. Clements (Sec)

Ques. 3. State number, approval date of permit, and date of priority: # 31093

Approved May 2, 1963 Priority April 12, 1963

Ques. 4. State source of water supply: Sawto River Sec 28 NW 1/4
Give location of point of diversion, showing subdivision, section, township and range

Township 5 South Range 7E B.M.

Ques. 5. Describe your works of diversion: Gas Engines, Turbine pumps,

buried mainline and sprinklers; state amount of water they are capable of conveying from point of diversion to place of use: 20 c.f.s; Give name of canal or ditch

or other works by which water is conducted to such place of use: South Elmore

Canal; if a well, state depth of well _____; depth and size of casing _____; depth to water _____; if pump is used,

state discharge of pump: _____; tell how it was measured or determined _____

_____; if sprinkler irrigation, give number and size of nozzles and operating pressure: 1650 x 5/32

Ques. 6. State for what purpose water is used: Irrigation
(If for irrigation, name each subdivision in which used and number of acres in each subdivision that have actually been irrigated with said water:

Section 16 S 1/2, NW 1/4, NE 1/4 less 20 acres, Section 17, SW 1/4 less 10 acres

N 1/2 SE 1/4, Section 18, E 1/2 SE 1/4 60 acres, Section 19, NE 1/4 NE 1/4 40 acres

Section 20 N 1/2 NW 1/4, NW 1/4 NE 1/4 120 acres all in Township 5 S Range 7 E B.M.

Totally 1060 acres in Elmore County

Too much land

State nature of all improvements which have been made as a direct result of said use:

1060 acres of ground irrigated farm land, Potato Celler - L. Train Dr.

Ques. 6-a: If this is a ground water permit, give name and address of person that drilled the well: _____

Ques. 7. If for other than irrigation purposes, show full legal description of place of use and state purpose for which water is used:

Ques. 8: If you are not the person or representative of the corporation to whom above mentioned permit was originally issued, please state how ownership was acquired by present holder:

M. Rex Green & M. Clement own this land as tenants in common. He is President & Secretary. 11111 N. 10th E. Farm Dev.

Quest. 9: State when and in what amount the water diverted under above mentioned permit has been first used: MARCH 1965 - Time used since first use:

20 cfs. used from march 1965 and each crop year since

Ques. 10. Describe all other water rights appurtenant to same place of use: _____

None

(sign) M. C. Clement (Sec.)

I hereby certify that the foregoing testimony was read to the above subscribed, before its signing, that I believe him to be the person he represents himself to be, and that said testimony was subscribed and sworn to before me, at my office in

Boise, County of Ada

State of Idaho, on this 29th day of March, A. D. 1968.

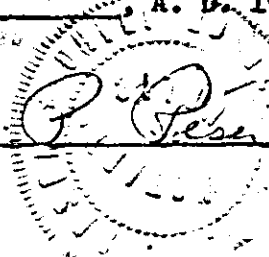
W. P. Jensen

My commission expires: Jan 20, 1969

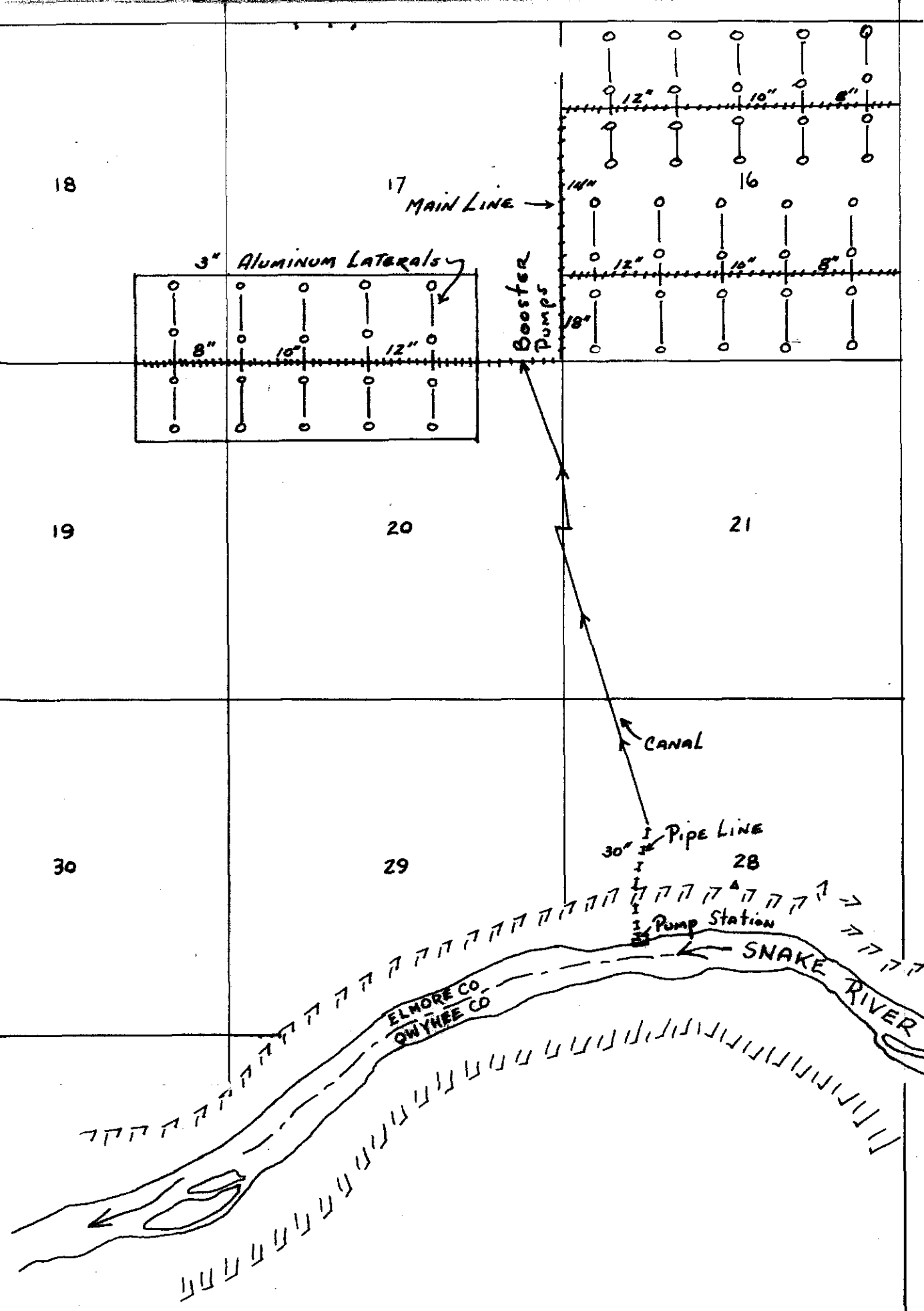

T.5 S. R.7 E.
T.6 S. R.7 E.

Map of proposed irrigation
system for
GEORGE R. GREER
Scale 1:24000

31083
MAY 2 1963

2 2 10

31093

STATE OF IDAHO
DEPARTMENT OF WATER ADMINISTRATION

Statehouse - Annex 2
Boise, Idaho 83707
(208) 384-2215



R. Keith Higginson
Director

Water Rights Administration
Water Resource Investigations
Dam and Reservoir Safety
Water Well Drilling
Flood Plain Management
Irrigation and
Flood Control Districts

July 16, 1971

Re: License No. 02-2210 - South Elmore Irrigation Company

South Elmore Irrigation Company
2105 Commerce Avenue
Boise, Idaho

Gentlemen:

Please find enclosed the above referenced license.

Very truly yours,

BOBBY D. FLEENOR
Assistant Director

BDF:cr

Enclosure

2 2210

PLEASE FURNISH SERVICE(S) INDICATED BY CHECKED BLOCK(S).
REQUIRED FEE(S) PAID.

Show to whom, date and address
where delivered

Deliver ONLY
to addressee

RECEIPT

Received the numbered article described below.

REGISTERED NO.

SIGNATURE OR NAME OF ADDRESSEE (*Must always be filled in*)

CERTIFIED NO.

31215

1

James L. Clements

2

SIGNATURE OF ADDRESSEE'S AGENT, IF ANY

INSURED NO.

DATE DELIVERED

MAR 26 1971

SHOW WHERE DELIVERED (*only if requested*)

2 2 10

02-2210

POST OFFICE DEPARTMENT
OFFICIAL BUSINESS

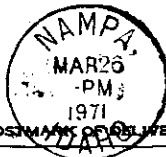

POSTMARK OF DELIVERING OFFICE

SAVE
YOUR VISION
WEEK

PENALTY FOR PRIVATE USE TO AVOID
PAYMENT OF POSTAGE, \$300

Print your name and address below. If you want to restrict delivery, or to have the address of delivery shown on this receipt, check block(s) on other side. Moisten gummed ends and attach this card to back of article.



**RETURN
TO**

POD Form 3811 Apr. 1969 c55-16-71548-11

March 22, 1971 CERTIFIED MAIL #31215

Re: Permit No. 31093/02-2210

South Elmore Irrigation Company
c/o Mr. M. O. Clements
Route 4
Nampa, Idaho 83651

Dear Mr. Clements:

It appearing to the Department of Water Administration that the terms and conditions of Permit 31093/02-2210 to appropriate the public waters of the State of Idaho have not been complied with as to failure to submit licensing fee of \$53.00

you are hereby notified that under the provisions of Section 42-311, Idaho Code, as amended, said permit is hereby held for cancellation, and you are required to show cause before the Director of the Department of Water Administration on or before May 1, 1971, why said permit should not be cancelled.

Permit 31093/02-2210 claims the use of 18.7 cubic feet per second of water, the point of diversion was to be located within the NW¹/SW¹, Sec. 28, T. 5S, R. 7E, B.M. and the permit was approved May 2, 1963.

R. Keith Higginson

R. KEITH HIGGINSON
Director

January 29, 1971

Re: Permit No. 02-2210 (31093)

South Elmore Irrigation Company
c/o Mr. M. O. Clements
Route 4
Nampa, Idaho 83651

Permit # 5963
given

Dear Mr. Clements:

A representative of this department has made an examination of the works covered by your Permit No. 02-2210 and has found the following:

Quantity of water diverted: 17.9 c.f.s.

Amount of water that can be recognized as beneficially used under Idaho law: 17.9 c.f.s.

The maximum quantity of water diverted shall not exceed 3,811.5 acre feet per season.

Beneficial Use: Irrigation of 847 acres within entire Sec. 16; S $\frac{1}{2}$ SW $\frac{1}{4}$, SW $\frac{1}{4}$ SE $\frac{1}{4}$ Sec. 17; SE $\frac{1}{4}$ SE $\frac{1}{4}$ Sec. 18; NE $\frac{1}{4}$ NE $\frac{1}{4}$ Sec. 19; NW $\frac{1}{4}$ NE $\frac{1}{4}$, N $\frac{1}{2}$ NW $\frac{1}{4}$ Sec. 20, Twp. 5 S., Rge. 7 E., B.M.

The priority date established is : April 12, 1963

A fee totaling \$ 53.00 must be received within 30 days from the date of this letter in order that we can issue you a Water License as set forth in this letter.

Very truly yours,

BOBBY D. FLEENOR
Assistant Director

BDF:kh

20 10 10

July 23, 1968

Re: Permit No. 31093
South Elmore Irrigation Co.

M. O. Clements
Route 4
Nampa, Idaho 83651

Dear Mr. Clements:

We acknowledge receipt of the depositions and affidavit of publication in the
Mountain Home News submitted as proof of com-
pletion of work ~~and beneficial use~~ on Permit 31093.

Before a certificate ~~and license of water right~~ can be issued, a field
examination must be made by a representative from this department. We
cannot tell just when this examination will be made, but our field examiner
will try to contact you at the time he makes the examination so that you
may show him the system.

Very truly yours,

Donald W. McEldowney
Appropriation Examiner

DWM:dj

P 31093

STATE OF IDAHO
OFFICE OF STATE RECLAMATION ENGINEER
POWER OF ATTORNEY

RECEIVED
JUL 15 1968
RECLAMATION

The undersigned owner (s) of Permit (Application) No. 31093
of the State Reclamation Engineer of the State of Idaho hereby nominates
and appoints M.O. "Pete" Clements, whose address is
Rte 4, Nampa, Idaho, as attorney-in-fact with full author-
ity to act for and on behalf of the undersigned in all matters pertaining
to Application or Permit. Such acts shall include, but not be limited to
the filing of applications, receiving of all notices, the signing and
filing of applications for extension of time and for amendment of said
Permit, and the submission of proofs of completion of works and beneficial
use of water.

Dated this 11th day of July, 1968.

_____ South Elmore Irrigation Co.
by B. E. Miller, Secretary

State of Idaho)
) : ss
County of Ada)

On this 11th day of July 1968,
personally appeared before me the signer (s) of the above instrument, who
duly acknowledged to me that he (she)(they) executed the same.

W. P. Reser
Notary Public

My commission expires:
Jan. 20, 1969

B 31093

Farm Development Corporation

MAIN OFFICE: ROOM 218 IDAHO BLDG. PHONE (208) 342-6524
P.O. BOX 1201 BOISE, IDAHO 83701

July 11, 1968

RECEIVED
JUL 12 1968
Department of Reclamation

State of Idaho
Dept. of Reclamation
Statehouse Annex #2
Boise, Idaho 83707
Attn: Don McEldowney

Re: Permit # 31093

Dear Don:

Please find enclosed an executed copy of a "Power of Attorney" signed by an officer of the South Elmore Irrigation Company.

I promised Mr. Clements that I would take care of this, since it was my goof at the onset. If there is any other problem concerning this permit, please let me know and I will be glad to help.

Thank you.

Sincerely



BILL RESER

wpr/h
Encl.

31093

July 5, 1968

Re: Permit No. 31093
South Elmore Irrigation Company

M. O. Clements
Route 4
Nampa, Idaho 83651

Dear Mr. Clements:

Sometime ago you were in our office and we advised you that the depositions of holder submitted April 4, 1968, were not acceptable as you are not an elected official of South Elmore Irrigation Company, and you had indicated that you were appearing in behalf of Gem Mountain Farms, Inc., a party that does not have ownership interest at face value in Permit No. 31093.

At the time you were in our office you stated that you would obtain a power of attorney in order that you could act in behalf of South Elmore Irrigation Company and return it at once to the department. As of this date we have not had a reply.

We must therefore have one of two things: First a power of attorney designating you as attorney in fact for South Elmore Irrigation Company. If we do not have this then second, we must have the proof submitted denied and the permit held for cancellation or until such time as a new intent to make proof is submitted to the department, published again for four weeks, a new hearing held by an elected official of the company, new depositions taken and submitted to the department.

We would very much like your assistance in clarifying this matter. Thank you for your assistance.

Very truly yours,

Donald W. McEldowney
Appropriation Examiner

DWM:dj

Enc: Power of attorney form

31093

May 27, 1968

Re: Permit No. 31093
South Elmore Irrigation Company

M. O. Clements
Route 4
Nampa, Idaho 83651

Dear Mr. Clements:

Enclosed is a copy of our letter to you of April 25, 1968, to which we have not received a reply.

Please be advised that Permit 31093 will be held for cancellation if the problems stated in the enclosed letter are not resolved by June 7, 1968.

Very truly yours,

Donald W. McEldowney
Appropriation Examiner

DWM:DJ

Enc: Copy of our 4-25-68 letter

31093

April 25, 1968

Re: Permit No. 31093
South Elmore Irrigation Company,
an Idaho corporation

M. O. Clements
Route 4
Nampa, Idaho 83651

Dear Mr. Clements:

Please find enclosed your depositions of holder and witnesses submitted to our office in connection with proof of completion of works on the above referenced permit.

We would appreciate clarification as to the holder of Permit No. 31093. The permit is in the name of South Elmore Irrigation Company; however, the depositions were made by Gem Mountain Farms.

If Gem Mountain Farms is the present owner, we will need an assignment from South Elmore Irrigation Company.

Please be advised also that although your depositions state that the water is being used to irrigate 1060 acres in Elmore County, the maximum that can be licensed is 935, the amount of land covered by your permit.

We would appreciate a prompt explanation of the above so that we may continue with the licensing of this permit.

Very truly yours,

Donald W. McEldowney
Appropriation Examiner

DWM:dj

Enc: Returning depositions

31093

STATE OF IDAHO

DEPARTMENT OF RECLAMATION

Boise, Idaho

Permit No. 31093

Department of Reclamation

MAY 1 1963

PROOF OF APPLICATION OF WATER TO BENEFICIAL USE

RECEIVED

~~and~~ **Completion of Works**

DEPOSITION OF HOLDER

Ques. 1. State your name, residence occupation and postoffice address: _____

Mr. Clements Rt 4 Nampa Idaho

Ques. 2. If acting in behalf of corporation, state its name, principal place of business (if foreign corporation, give name of postoffice of statutory agent), your position with reference to same, and your authority for appearing in its behalf:

Gem Mountain Farms Inc. Rt. 4 Nampa Id. Mr. Clements (Sec)

Ques. 3. State number, approval date of permit, and date of priority: # 31093

Approved May 2, 1963 Priority April 12, 1963

Ques. 4. State source of water supply: Sawka River Sec 28 NW 1/4

Give location of point of diversion, showing subdivision, section, township and range

Township 5 South Range 7E. B.M.

Ques. 5. Describe your works of diversion: Gas Engines, Turbine pumps,

buried mainline and sprinklers; state amount of water they are capable of conveying from point of diversion to place of use: 20 c.f.s

; Give name of canal or ditch or other works by which water is conducted to such place of use: South Elmore

Canal; if a well, state depth of well _____; depth and size of casing _____; depth to water _____; if pump is used, state discharge of pump: _____; tell how it was measured or determined _____; if sprinkler irrigation, give number and size of nozzles and operating pressure: 1650 x 3/32

31093

State nature of all improvements which have been made as a direct result of said use:

1060 acres of ground irrigated farm land. Potato Celler - L. Train Bins

Ques. 6-a: If this is a ground water permit, give name and address of person that drilled the well: _____

Ques. 7. If for other than irrigation purposes, show full legal description of place of use and state purpose for which water is used:
20 cfs. used from March 1965 and each crop year since.

Ques. 8: If you are not the person or representative of the corporation to whom above mentioned permit was originally issued, please state how ownership was acquired by present holder:

By Rex Green & M.O. Clements own this land as Mt. Mountain Farms Inc. He is President & I Secretary.

Quest. 9: State when and in what amount the water diverted under above mentioned permit has been first used: March 1965 - Time used since first use:

20 cfs. used from March 1965 and each crop year since.

Ques. 10. Describe all other water rights appurtenant to same place of use: _____

None

(sign) M.O. Clements (Sec.)

I hereby certify that the foregoing testimony was read to the above subscribed, before its signing, that I believe him to be the person he represents himself to be, and that said testimony was subscribed and sworn to before me, at my office in

Boise, County of Ada

State of Idaho, on this 29th day of March, A. D. 1968.

W.P. Pese

My commission expires: Jan 20, 1969

STATE OF IDAHO
DEPARTMENT OF RECLAMATION

Boise, Idaho

Permit No. 31093

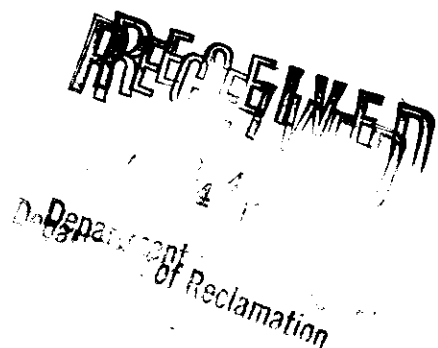

~~PROOF OF APPLICATION OF WATER TO BENEFICIAL USE~~

and Completion of Works

DEPOSITION OF WITNESS

The deposition of two witnesses on this form, taken separately, required in each case.

Ques. 1 State your name, age, residence, occupation and postoffice address:

W. H. Reynolds, 33 years old, 6517 Grandview Dr, Boise, Idaho
Treasurer Farm Development Corp; Postoffice Address Same as Residence

Ques. 2 Are you acquainted with Mr. Clements and Rex Green, the holder of Permit No. 31093? How long have you known him and where does he reside?

Clements - 4 yrs; Rex - 4; Nampa, Ida. / Green 10 yrs; Pasco, Wash.

Ques. 3. Have you read or heard said Permit No. 31093 read, and are you familiar with its provisions and conditions: Yes X No.

Ques. 4. State source of water supply: SNAKE RIVER

Give location of place of diversion, showing subdivision, section, township and range

Sec 28 NW 1/4 SW 1/4 T 5 S R 7 E B M.

Describe works for conveying water to place of use: GAS ENGINES, TURBINE PUMPS,

STEEL PIPELINE, & CONCRETE DITCH

Ques. 5. How many second feet of water do you estimate said works will safely conduct to place of use: 20 CFS How much water have you seen being so

conveyed? 20 CFS

Ques. 6 If for irrigation, show number of acres irrigated in each subdivision, giving full legal description:

SECTION 16, S 1/2, NW 1/4, NE 1/4 620 ACRES Sec. 17 SW 1/4 150 ACRES
W 1/2 SE 1/4 80 ACRES, SEC 18 E 1/2 SE 1/4 60 ACRES, SEC 19 NE 1/4
NE 1/4 40 ACRES SEC 20 N 1/2 NW 1/4, NW 1/4 (NW 1/4) 120 ACRES E 1/2 NW 1/4
COUNTY T 5 S R 7 E, B M TOTAL 1060 ACRES MORE OR LESS

31093

Ques. 7. If for other than irrigation purposes, show full legal description of place of use, and state purpose for which water is used.

Ques. 8. (If for irrigation) state character of land that has been reclaimed, and give your estimate of the amount of water required for its profitable cultivation.

FIRST CLASS SILT LOAM FINE SOIL WITH WATER FOR ROW CROPPING
LAND SHOULD HAVE ABOUT 3/4" PER ACRE

Ques. 9. Have you any ownership interest in the works, water or lands above mentioned? If so, in what way and to what extent? NONE

Ques. 10. When did you first see this water used? MARCH 1965
Other times you have seen such use: _____

(Signed):

[Handwritten Signature]

I hereby certify that the foregoing testimony was read to the above subscriber before its signing, that I believe him to be the person he represents himself to be, and that said testimony was subscribed and sworn to before me in _____

Boise, County of Ada, State of Idaho, on this 29th day of March, A. D. 1968

[Handwritten Signature]

Notary Public for the State of Idaho

Residing Boise

My commission expires Jan 20, 1969

STATE OF IDAHO
DEPARTMENT OF RECLAMATION

Boise, Idaho

Permit No. 31093

RECEIVED
APR 4 1968
Department of Reclamation

~~PROOF OF APPLICATION OF WATER TO BENEFICIAL USE~~

and Completion of Works

DEPOSITION OF WITNESS

The deposition of two witnesses on this form, taken separately, required in each case.

Ques. 1 State your name, age, residence, occupation and postoffice address:

Allan T. Noble, 39 yrs. President Farm Development Corp and farming, 105 Crestline Drive Boise, Idaho

Ques. 2 Are you acquainted with Rex Green and M.O. Clements, the holder of Permit No. 31093? How long have you known him and where does he reside?

Clements all my life, Green 10 yrs, Clements Rt 4 Nampa Green Reservoir.

Ques. 3. Have you read or heard said Permit No. 31093 read, and are you familiar with its provisions and conditions: Yes yes No. _____

Ques. 4. State source of water supply: Snake River

Give location of place of diversion, showing subdivision, section, township and range

Sec. 28 NW 1/4 SW 1/4, Township 5 South Range 7 E.B.M.

Describe works for conveying water to place of use: Gas Engines, Turbine pumps, Pipelines, and concrete ditch.

Ques. 5. How many second feet of water do you estimate said works will safely conduct to place of use: 20 c.f.s. How much water have you seen being so conveyed? 20 c.f.s.

Ques. 6 If for irrigation, show number of acres irrigated in each subdivision, giving full legal description:

Section 16 S 1/2, NW 1/4, NE 1/4 600 acres, Sec 17 SW 1/4 150 acres W 1/2 SE 1/4 80 acres, Section 18 E 1/2 SE 1/4 60 acres, Section 19, NE 1/4 NE 1/4 40 acres Section 20 N 1/2 NW 1/4, NW 1/4 NW 1/4 NE 1/4 120 acres All in Blaine County Township 5 South Range 7 E.B.M. Totaling 1060 acres more or less

31093

Ques. 7. If for other than irrigation purposes, show full legal description of place of use, and state purpose for which water is used.

Ques. 8. (If for irrigation) state character of land that has been reclaimed, and give your estimate of the amount of water required for its profitable cultivation.

First class silt loam type soil well suited for
row cropping land should have about 3/4" per acre

Ques. 9. Have you any ownership interest in the works, water or lands above mentioned? If so, in what way and to what extent? None

Ques. 10. When did you first see this water used? March 1965

Other times you have seen such use: _____

(Signed): Albert D. Nelson

I hereby certify that the foregoing testimony was read to the above subscriber before its signing, that I believe him to be the person he represents himself to be, and that said testimony was subscribed and sworn to before me in _____

Boise, County of Ada, State of Idaho, on this 29th day of March, A. D. 1968

W. P. Peterson
Notary Public for the State of Idaho
Residing Boise

My commission expires Jan 30, 1969



Affidavit of Publication

County of Elmore }
STATE OF IDAHO } ss.

I, *Lloyd S. Waters*..... do
solemnly swear that I am the foreman, or
publisher of the

MOUNTAIN HOME NEWS

a weekly newspaper of general circulation,
published once a week at MOUNTAIN HOME,
IDAHO, that the notice attached hereto and
which is a part of the proof of publication
thereof, was published in said newspaper for

.....*4*..... consecutive weeks, the first publica-
tion having been made on the ..*23*.. day
of ..*February*....., 19*68*., and
the last publication having been made on the
.....*14*..... day of ..*March*.....
19.*68*....; every Thursday issue of the paper

during the period and time of publication and
that the notice was published in the newspaper
proper and not in a supplement thereof.

And I further swear that the said MOUN-
TAIN HOME NEWS has been continuously and
uninterruptedly published in said Elmore County
during a period of 78 consecutive weeks prior
to the first publication of the attached notice.

Lloyd S. Waters.....

Subscribed and sworn to me this ..*14*.....
day of ..*March*....., 19*68*..

Vivian M. Waters
Notary Public

31093

March 19, 1968

Re: Permit No. 31093
South Elmore Irrigation Co.,
an Idaho corporation

Mountain Home News
Mountain Home, Idaho 83647

Gentlemen:

Enclosed please find an advertising bill recently submitted to this department and a copy of our letter to you of February 16, 1968.

Please note that the letter specifically instructs you to bill B. G. Miller, Secretary, South Elmore Irrigation Company, P. O. Box 1201, Boise, Idaho 83701, for the publication.

When you send Mr. Miller the bill, we would appreciate your informing him that you have sent the affidavit of publication to the Department of Reclamation in Boise, Idaho. Thank you.

Very truly yours,

Donald W. McEldowney
Appropriation Examiner

DWM:dj

Enc: Adv. bill
Copy of our 2-16-68 letter

31093

Re: Permit No. 31093
South Elmore Irrigation Co.,
an Idaho corporation

February 16, 1968

B. G. Miller, Secretary
P. O. Box 1201
Boise, Idaho

Dear Mr. Miller:

This acknowledges receipt of the notice of intent to make proof of completion of works and application of water to beneficial use for permit No. 31093.

We have mailed the notice to the Mountain Home News to be published once a week for four consecutive weeks prior to March 29, 1968, which is the hearing date when the permit holder South Elmore Irrigation Co., an Idaho corporation and two disinterested witnesses must appear before W. P. Reser, notary public, to complete the enclosed depositions. The witnesses must be familiar with the works and permit.

After the hearing, the depositions and an affidavit of publication must be submitted to this office. The affidavit may be obtained from the newspaper when the advertising bill is paid by South Elmore Irrigation Company. Be sure all the forms have the notary's seal and are signed. Please feel free to contact us if we may be of any assistance.

Very truly yours,

Donald W. McEldowney
Appropriation Examiner

DWM:dj

Enc: Depositions

cc: Notary

31093

1968 FEB 12 10 17 AM
BOISE

(This completed form authorizes the Department of Reclamation to publish the required notice at your expense.)

State Reclamation Engineer:

You are hereby authorized to have the attached notice published at my expense in the Mountain Home, News of Mountain Home, Idaho; published in the county in which the works are situated.

SOUTH ELMORE IRRIGATION CO.

By B. Mueller
(signature)

Secretary

P. O. Box 1201, Boise, Idaho
(address)

February 12, 1968
(date)

In case of canals or other works designed to divert and carry more than 50 cubic feet of water per second, the following certificate must be signed by a well known and competent engineer when proof is for completion of works.

I hereby certify that the facts set forth in the attached notice are true.

Engineer

31093

RECEIVED
Department of Reclamation

NOTICE OF PROOF OF COMPLETION OF WORKS AND
APPLICATION OF WATER TO BENEFICIAL USE

Notice is hereby given that on March 29, 1968 at Boise,
County of Ada, State of Idaho, before notary public (name & address) _____
W. P. Reser, 218 Idaho Building, Boise, Idaho, proof will be
submitted of the completion of works for the diversion of 18.7 c.f.s. of the waters
of Snake River, and the application to beneficial use of said water,
in accordance with the terms and conditions of permit 31093, heretofore issued by
the Department of Reclamation of the State of Idaho.

1. The name and address of permit holder is South Elmore Irrigation Co.,
an Idaho corporation, P. O. Box 1201, Boise, Idaho 83701

2. Said works of diversion will be fully completed on the date for such completion,
and the amount of water which said works are capable of conveying to the place of use is
18.7 cubic feet per second.

3. The use to which said water ^{will be} ~~has been~~ applied is _____
^{will be} ~~is~~ irrigation purposes, and the amount applied to beneficial
uses ^{is} ~~is~~ 18.7 c.f.s.

4. The point of diversion of said water is NW¹/₄SW¹/₄, Sec. 28, T. 5 S,
R. 7 E, B.M., Elmore County
^{will be}

5. The place where said water ^{is} ~~is~~ used is all of Section 16; S¹/₂SW¹/₄, SW¹/₄SE¹/₄,
Sec. 17; SE¹/₄SE¹/₄, Sec. 18; NE¹/₄NE¹/₄, Sec. 19; NW¹/₄NE¹/₄, N¹/₂NW¹/₄, Sec. 20,
T. 5 S, R. 7 E, B.M.

6. The date of priority which said user is prepared to establish is _____
April 12, 1963

R. KEITH HIGGINSON
State Reclamation Engineer

31093 *dr*

February 16, 1968

Re: Permit No. 31093
South Elmore Irrigation Co.,
an Idaho corporation

Mountain Home News
Mountain Home, Idaho 83647

Gentlemen:

Enclosed is a legal notice which we wish to have published for four consecutive weeks prior to March 29, 1968. The expense of the publication is to paid by B. G. Miller, Secretary, South Elmore Irrigation Company, P. O. Box 1201, Boise, Idaho 83701, to whom you should furnish the affidavit of publication on or before the above date. Please acknowledge receipt of this notice by furnishing this office with a tear sheet for checking prior to the first publication.

Very truly yours,

Donald W. McEldowney
Appropriation Examiner

DWM:dj

Enc: Legal Notice

31093

Galley Proof

NOTICE OF PROOF OF COM- PLETION OF WORKS

Notice is hereby given that on March 29, 1968 at Boise, County of Ada, State of Idaho, before notary public (name & address) W. P. Reser, 218 Idaho Building, Boise, Idaho, proof will be submitted of the completion of works for the diversion of 18.7 c.f.s. of the waters of Snake River, in accordance with the terms and conditions of permit 31093, heretofore issued by the Department of Reclamation of the State of Idaho.

1. The name and address of permit holder is South Elmore Irrigation Co., an Idaho corporation, P. O. Box 1201, Boise, Idaho 83701.

2. Said works of diversion will be fully completed on the date for such completion, and the amount of water which said works are capable of conveying to the place of use is 18.7 cubic feet per second.

3. The use to which said water will be applied is irrigation purposes, and the amount applied to beneficial use will be 18.7 c.f.s.

4. The point of diversion of said water is NW $\frac{1}{4}$ SW $\frac{1}{4}$, Sec. 28, T. 5 S, R. 7 E, B.M., Elmore County.

5. The place where said water will be used is all of Section 16: S $\frac{1}{2}$ SW $\frac{1}{4}$, SW $\frac{1}{4}$ SE $\frac{1}{4}$, Sec. 17; SE $\frac{1}{4}$ SE $\frac{1}{4}$, Sec. 18; NE $\frac{1}{4}$ NE $\frac{1}{4}$, Sec. 19; NW $\frac{1}{4}$ NE $\frac{1}{4}$, N $\frac{1}{2}$ NW $\frac{1}{4}$, Sec. 20, T. 5 S, R. 7 E, B.M.

6. The date of priority which said user is prepared to establish is April 12, 1963.

R. KEITH HIGGINSON
State Reclamation Engineer
First publication February 22, 1968
Last publication March 14, 1968

ANDERSON, KAUFMAN, ANDERSON AND RINGERT
LAWYERS

EUGENE H. ANDERSON
SAMUEL KAUFMAN
RICHARD ANDERSON
WILLIAM F. RINGERT

IDAHO BUILDING
BOISE, IDAHO 83701

AREA CODE 208
TELEPHONE 342-4591
POST OFFICE BOX 2773

February 14, 1968

RECEIVED

FEB 15 1968

Department of Reclamation

Mr. R. Keith Higginson
State Reclamation Engineer
State House
Boise, Idaho 83701

Re: Permit No. 31093

Dear Mr. Higginson:

Herewith is form of Notice of Proof of Completion of Works with respect to the above numbered permit together with a letter on your department Form 11, signed by B. G. Miller, as secretary of South Elmore Irrigation Co., authorizing publication of the notice.

Please sign the notice and forward it for publication.

Yours very truly,

ANDERSON, KAUFMAN, ANDERSON & RINGERT

By

William F. Ringert
William F. Ringert

WFR:b
Encls.

cc: Wayne P. Fuller, Lawyer

31093

January 31, 1968

Re: Permit No. 31093
South Elmore Irrigation Co.,
an Idaho corporation

Wayne P. Fuller, Attorney At Law
P. O. Box 130
Caldwell, Idaho 83605

Dear Mr. Fuller:

Please be advised that since your permit is for water in excess of 6.4 c.f.s., you are required under the conditions of your permit to advertise the proof of completion of works as indicated in the enclosed form letter.

You should be aware that if you have applied all of the water under this permit to beneficial use, you can at this time file proof of beneficial use also. If you so desire, please advise us. If you intend to submit proof of completion of works only, then at a later date you will be required to advertise the proof of beneficial use also.

Please contact us if you have any questions.

Very truly yours,

Donald W. McEldowney
Water Rights Clerk

DWM:dj

Enc: Forms 36, 11, & 36A

P. S. We will need a written statement as to the current address of the South Elmore Irrigation Co.

31093

January 31, 1968

Re: Permit 31093- South Elmore Irrigation Co., an Idaho corporation

Wayne P. Fuller, Attorney At Law
P. O. Box 130
Caldwell, Idaho 83605

Proof of completion of works ~~and application of water to beneficial use~~ for the above referenced permit is due not later than May 2, 1968.

Under the terms of your permit, it is required that a notice be published once a week for four consecutive weeks in a local newspaper showing your intent to submit proof. The proof will consist of depositions which the permit holder and two disinterested witnesses must complete before the listed notary public, and must be accompanied by an affidavit of publication of the legal notice.

We have prepared the enclosed notice from the information on your permit. The complete name and address of a notary public of the State of Idaho must be entered together with a date for you to appear before the notary. Allow at least 40 days from the date the notice is mailed to this department for your appearance before the notary.

If you find any discrepancy in the notice or have made any changes, please advise this department and we will assist you in doing whatever may be necessary to assure correct publication.

If the enclosed notice is correct, complete the blank spaces and sign the form authorizing us to publish the notice at your expense and return all forms. At the time we send the notice to the newspaper, you will be supplied with further instructions.

If you do not desire to complete the proofs and obtain a license of water right, you are requested to complete the relinquishment portion of this form below and return it to the Department of Reclamation.

State Reclamation Engineer

RELINQUISHMENT

I hereby relinquish to the State of Idaho, all my right, title and interest in and to Permit to Appropriate the Public Waters of the State of Idaho, No. _____.

Dated _____.

permit holder

31093

BRAUNER, FULLER & DOOLITTLE

ATTORNEYS AND COUNSELORS AT LAW
POST OFFICE BOX 130
CALDWELL, IDAHO 83605

11TH & BLAINE
TELEPHONE 459-1681

WM. J. BRAUNER
WAYNE P. FULLER
JIM R. DOOLITTLE

August 4, 1967

Department of Reclamation
State House
Boise, Idaho

Attention: Russell M. Bosch

Re: Travelers Loan #P-344
Gem Mountain Farms, Inc.

Gentlemen:

Previously we wrote to you on July 17 to make an inquiry about certain land and certain water permits in connection with three Travelers loans.

This letter is to inform you that Travelers Insurance Co. has acquired an interest in and to the water permit hereinafter listed and hereby requests that the Department notify Travelers Insurance Company, 421 S. W. Sixth Avenue, Portland, Oregon, before any assignment or alteration or modification of the permit is allowed. This does not intend to prevent any assignment of the permit which would place it in the name of South Elmore Irrigation Company. The permit Travelers has acquired an interest in is permit no. 31093. This permit relates to a loan made to Gem Mountain Farms, Inc.

Very truly yours,

BRAUNER, FULLER & DOOLITTLE

Wayne P. Fuller
Wayne P. Fuller

WPF/lg

31093

August 17, 1967

RE: Permit 31093
South Elmore Irrigation Co.

Wayne P. Fuller
Brauner, Fuller & Doolittle
Attorneys at Law
P.O. Box 130
Caldwell, Idaho 83605

Dear Mr. Fuller:

Enclosed herewith is a copy of the assignment you mailed to us August 16, 1967. Please be advised this assignment has been recorded in this office under the above referenced permit.

If we can be of further assistance please let us know.

Very truly yours,

M. RUSSELL BOSCH
Office Manager

MRB:ejw

Enc: Assignment copy

31093

ACKNOWLEDGEMENT

STATE OF IDAHO,

County of Canyon

} ss.

On this 15th day of February, 1966, before me, the undersigned, a Notary Public in and for Idaho, personally appeared

M. O. Clements and M. L. Clements

INDIVIDUAL { known to me to be the persons whose name S. are subscribed to the foregoing instrument and acknowledged to me that they executed the same.

~~PARTNERSHIP~~ { known to me to be the partners in the partnership of who subscribed the partnership name to the foregoing instrument and acknowledged that he executed the same in the partnership name.

~~CORPORATE~~ { the of the corporation that executed the foregoing instrument and acknowledged to me that said corporation executed the same.

IN WITNESS WHEREOF, I have hereunto set my hand and affixed my official seal the day and year first above written.

[Handwritten Signature]

Notary Public for Idaho, Residing at Nampa, Idaho

My commission expires: 9-20-69

*Strike out acknowledgements not applicable.

31093

WM. J. BRAUNER
WAYNE P. FULLER
JIM R. DOOLITTLE

BRAUNER, FULLER & DOOLITTLE
ATTORNEYS AND COUNSELORS AT LAW
POST OFFICE BOX 130
CALDWELL, IDAHO 83605

31093
11TH & BLAINE
TELEPHONE 459-1681

August 16, 1967

RECEIVED
AUG 17 1967
Department of Reclamation

Department of Reclamation
State House
Boise, Idaho

Attention: Mr. Russel M. Bosch

Re: Travelers Loan #P-344
Gem Mountain Farms, Inc.

Gentlemen:

We enclose Assignment by which permit no. 31093 is assigned by George R. Greer and his wife and M. O. Clements and his wife to South Elmore Irrigation Company, an Idaho corporation.

Very truly yours,

BRAUNER, FULLER & DOOLITTLE

Wayne P. Fuller
Wayne P. Fuller

WPF/lg
Enclosure

gk
N

31093

May 15, 1963

Re: Permit No. 31093

Mr. George R. Greer,
828 Mountain View Dr.,
Twin Falls, Idaho.

Dear Mr. Greer:

We enclose Permit No. 31093 in which we direct your attention to the limitations and conditions as given on the fourth page under approval of the State Reclamation Engineer.

We also enclose Departmental Receipt No. 31534 which was issued covering payment in the amount of \$9.50 for the filing fee of the above mentioned permit.

Very truly yours,

GEO. N. CARTER
State Reclamation Engineer
By

(Mrs.) Edna P. Rule
Chief Clerk

EPR:pmk
Encl. ...

(G Permit)

((Original application, which was received on a Form 3, was returned with this letter)

31093

Address Change

South Calmore
Irrigation Co.

2105 Commerce Ave.

Boise, Idaho

6 31093
