

State of Idaho  
Department of Water Resources

**WATER RIGHT LICENSE**

License of Water Right No. 45-7451 Priority October 1, 1980 Amount 0.16 cfs

THIS IS TO CERTIFY, that Morris W. Mitchell

of Oakley, Idaho, has complied with the terms and conditions of Permit No. 45-7451 issued pursuant to Application for Permit dated October 1, 1980, and has submitted proof to the Department of Water Resources on July 15, 1982, that he has applied water to a beneficial use; an examination by the Department indicates that the works have a capacity for the diversion of 0.16 cfs of water from a groundwater source, tributary to \_\_\_\_\_, and that the permit holder has applied to a beneficial use and established a right to use water as follows:

| Beneficial Use | Period of Use   | Rate of Diversion   | Annual Volume |
|----------------|---|---------------------|---------------|
| <u>Heating</u> | from <u>January 1</u> to <u>December 31</u> at <u>0.16</u> cfs and <u>n/a</u> |                     |               |
|                | from _____  | _____ cfs and _____ | _____         |
|                | from _____  | _____ cfs and _____ | _____         |

Subject, however, to the condition that no more than 0.16 cfs of water be diverted at any one time, and that the amount of water so diverted and to which such right is entitled and confirmed is for the purpose aforementioned and is limited to the amount which can actually be beneficially used and shall not exceed n/a acre feet per-year, said waters to be diverted within the SW $\frac{1}{2}$ SE $\frac{1}{4}$  Section 25, Twp 15S, Rge 21E in the County of Cassia

Description and location of place of use:

| Twp. | Range | Sec. | NEW              |                  |                  |                  |                  |                  |                  |                  |                  |                  |                  |                  | Totals |  |  |
|------|-------|------|------------------|------------------|------------------|------------------|------------------|------------------|------------------|------------------|------------------|------------------|------------------|------------------|--------|--|--|
|      |       |      | NE $\frac{1}{4}$ | NW $\frac{1}{4}$ | SW $\frac{1}{4}$ | SE $\frac{1}{4}$ | NE $\frac{1}{4}$ | NW $\frac{1}{4}$ | SW $\frac{1}{4}$ | SE $\frac{1}{4}$ | NE $\frac{1}{4}$ | NW $\frac{1}{4}$ | SW $\frac{1}{4}$ | SE $\frac{1}{4}$ |        |  |  |
| 15S  | 21E   | 25   |                  |                  |                  |                  |                  |                  |                  |                  |                  |                  |                  |                  |        |  |  |
|      |       |      |                  |                  |                  |                  |                  |                  |                  |                  |                  |                  |                  |                  |        |  |  |
|      |       |      |                  |                  |                  |                  |                  |                  |                  |                  |                  |                  |                  |                  |        |  |  |
|      |       |      |                  |                  |                  |                  |                  |                  |                  |                  |                  |                  |                  |                  |        |  |  |

Total number of acres irrigated \_\_\_\_\_

**NOTE:** Modifications to or variance from this license must be made within the limits of Section 42-222, Idaho Code, or the applicable Idaho Law. This right may be forfeited by five years of non-use.

The right to the use of the water hereby confirmed is restricted and appurtenant to the lands or place of use herein described, and is subject to all prior water rights, as provided by the laws of Idaho.

Witness the seal and signature of the Director, affixed at Boise, Idaho, this 26<sup>TH</sup> day of MARCH, 19 84.

Acting for the Director Norman C. Goering

MICROFILMED

STATE OF IDAHO  
DEPARTMENT OF WATER RESOURCES  
APPLICATION FOR PERMIT

**APPROVED**

To appropriate the public waters of the State of Idaho

1. Name of applicant Morris W. Mitchell Phone 436-4839 (mobile)  
862-3816

Post office address Box 48 Oakley, ID, 83346

2. Source of water supply Groundwater which is a tributary of \_\_\_\_\_

3. Location of point of diversion is SW ¼ of SE ¼ of Section 25 Township 15S

Range 21E B.M. Cassia County, additional points of diversion if any: \_\_\_\_\_

4. Water will be used for the following purposes:

Amount 0.20 for Heating purposes from 1-1 to 12-31 (both dates inclusive)  
(cfs or acre-feet per annum)

Amount 0.20 for Commercial purposes from 1-1 to 12-31 (both dates inclusive)  
(cfs or acre-feet per annum)

Amount \_\_\_\_\_ for \_\_\_\_\_ purposes from \_\_\_\_\_ to \_\_\_\_\_ (both dates inclusive)  
(cfs or acre-feet per annum)

Amount \_\_\_\_\_ for \_\_\_\_\_ purposes from \_\_\_\_\_ to \_\_\_\_\_ (both dates inclusive)  
(cfs or acre-feet per annum)

5. Total quantity to be appropriated:

a. 0.20 cubic feet per second and/or b. \_\_\_\_\_ acre-feet per annum.

6. Proposed diverting works:

a. Description of ditches, flumes, pumps, headgates, etc. Existing flowing well and pipelines

b. Height of storage dam \_\_\_\_\_ feet, active reservoir capacity \_\_\_\_\_ acre-feet; total reservoir capacity \_\_\_\_\_ acre-feet, materials used in storage dam: \_\_\_\_\_

Period of year when water will be diverted to storage \_\_\_\_\_ to \_\_\_\_\_ inclusive.  
(Month/Day) (Month/Day)

c. Proposed well diameter is 10 inches; proposed depth of well is 2600 feet.

7. Time required for the completion of the works and application of the water to the proposed beneficial

use is 5 years (minimum 1 year - maximum 5 years).

8. Description of proposed uses:

a. If water is not for irrigation:

(1) Give the place of use of water: SW ¼ of SE ¼ of Section 25 Township 15S

Range 21E B.M.

(2) Amount of power to be generated: \_\_\_\_\_ horsepower under \_\_\_\_\_ feet of head.

(3) List number of each kind of livestock to be watered \_\_\_\_\_

(4) Name of municipality to be served \_\_\_\_\_, or number of families to be supplied with domestic water \_\_\_\_\_.

(5) If water is to be used for other purposes describe: Heating: heating home, greenhouse,  
and swimming pool. Commercial: Alcohol production.

MICROFILMED



11. Map of proposed project: show clearly the proposed point of diversion, place of use, section number, township and range number.

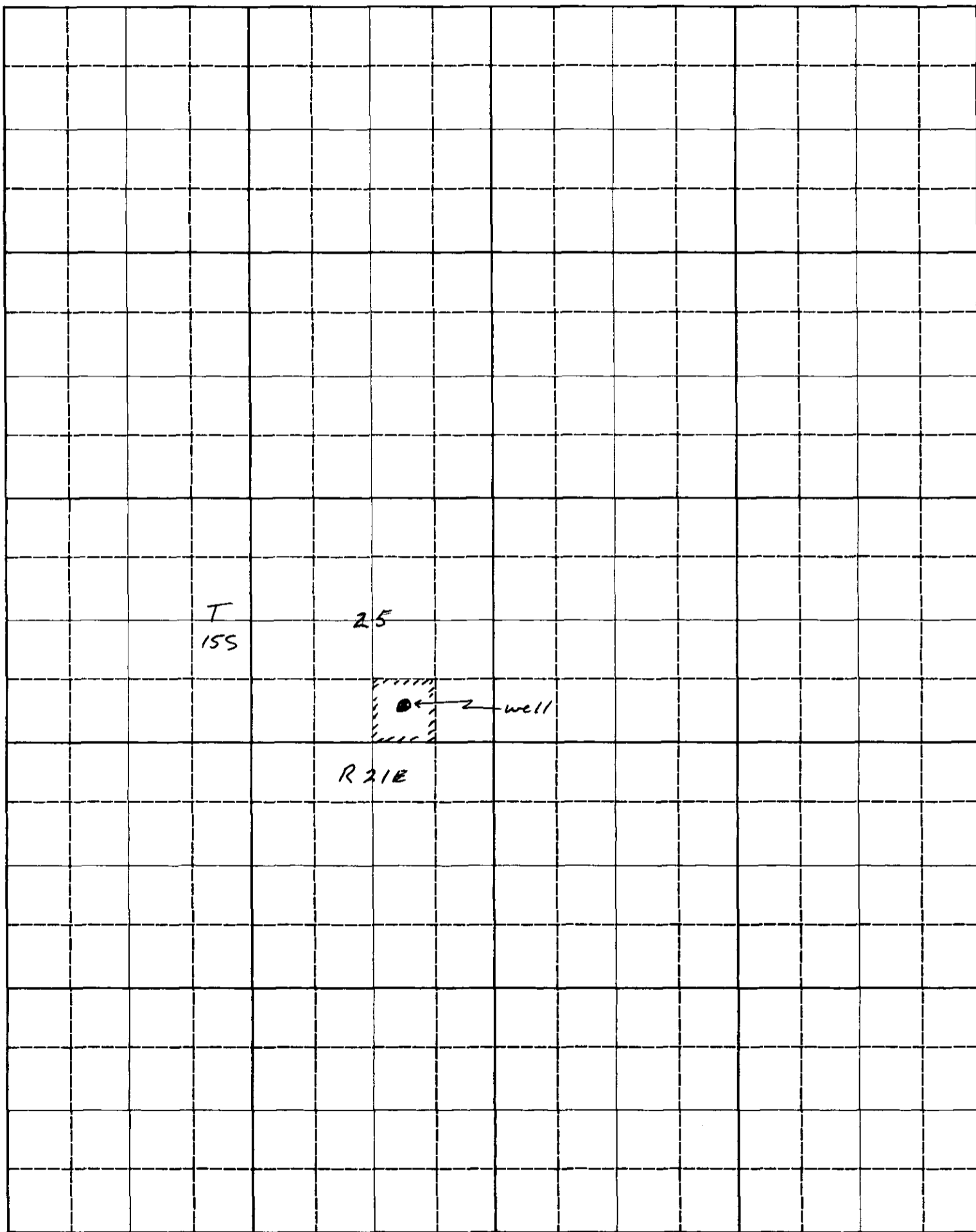

Scale: 2 inches equal 1 mile.

BE IT KNOWN that the undersigned hereby makes application for permit to appropriate the public waters of the State of Idaho as herein set forth.

*Dennis J. [Signature]*  
(Applicant)

Proposed Priority 10/1/80

Received by LHB Date 10-1-80 Time 10-1-80

Preliminary check by ADM Fee \$ 30<sup>00</sup>/<sub>100</sub>

Receipted by LHB Date 10-1-80 # 16612

Publication prepared by manga Date 10/2/80

Published in smith edels press

Publication dates 10/14 + 10/21/80

Publication approved manga Date 10/4/80

Protests filed by: None

Copies of protests forwarded by \_\_\_\_\_

Hearing held by \_\_\_\_\_ Date \_\_\_\_\_

Recommended for approval denial by LH RL

**ACTION OF THE DIRECTOR, DEPARTMENT OF WATER RESOURCES**

This is to certify that I have examined Application for Permit to appropriate the public waters of the State of Idaho No. 45-7451, and said application is hereby approved.

1. Approval of said application is subject to the following limitations and conditions:

- a. SUBJECT TO ALL PRIOR WATER RIGHTS.
- b. Proof of construction of works and application of water to beneficial use shall be submitted on or before January 1, 19 86.
- c. The rate of diversion, if water is to be used for irrigation under this permit, when combined with all other water rights for the same land shall not exceed 0.02 cubic feet per second for each acre of land.
- d. Other: Return flow if discharged to a subsurface system must be authorized by a separate injection well permit, and return flow if discharged to a surface water system shall meet Idaho Water Quality Standards.

Witness my hand this 7<sup>th</sup> day of January, 19 81.

L. Glen Saxton  
Director

SOUTH IDAHO PRESS  
BURLEY, IDAHO

AFFIDAVIT OF PUBLICATION

County of Cassia, )  
 ) ss.  
STATE OF IDAHO )

*Mary Summers* being first  
duly sworn, deposes and says that she is the

*Clark* of the South Idaho  
Press, a daily newspaper published at Bur-  
ley Idaho, in the county aforesaid and that  
the paper is of general circulation therein.  
Deponent further states that the printed no-  
tice attached hereto was duly published  
according to law in the regular editions of

The South Idaho Press for *two*  
consecutive weeks, commencing with the issue  
dated *Oct 14* 19*80*, and ending  
with the issue dated *Oct 21* 19*80*.

*Mary Summers*

Subscribed and sworn to before me  
this *6<sup>th</sup>* day of *Nov*  
19*80*.

*James M. Peterson* Notary Public  
Cost of Publication *19.26*  
Notary Fee \_\_\_\_\_  
Total Cost *\$ 19.26*

NOTARY PUBLIC RESIDING AT  
RUPERT, IDAHO. MY COMMISSION  
EXPIRES JUNE 21, 1981

RECEIVED

NOV 7

Department of Resources  
Southern District Office

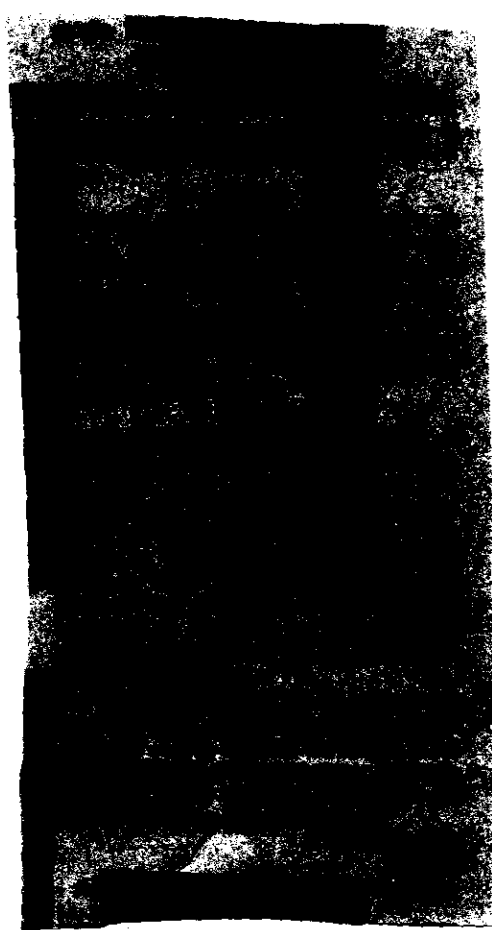

MICROFILMED

11/7/80

SOUTH IDAHO PRESS

BURLEY, IDAHO

AFFIDAVIT OF PUBLICATION

County of Cassia, )  
 ) ss.  
STATE OF IDAHO )

*Mary Summers* being first  
duly sworn, deposes and says that she is the

*Clerk* of the South Idaho  
Press, a daily newspaper published at Bur-  
ley Idaho, in the county aforesaid and that  
the paper is of general circulation therein.  
Deponent further states that the printed no-  
tice attached hereto was duly published  
according to law in the regular editions of

The South Idaho Press for *two*  
consecutive weeks, commencing with the issue  
dated *Oct 14* 19*80*, and ending  
with the issue dated *Oct 21* 19*80*.

*Mary Summers*

Subscribed and sworn to before me  
this *6<sup>th</sup>* day of *Nov*

19*80*.

*Thomas M. Stinson* Notary Public

Cost of Publication *19.26*  
Notary Fee  
Total Cost *\$ 19.26*

NOTARY PUBLIC RESIDING AT  
RUPERT, IDAHO. MY COMMISSION  
EXPIRES JUNE 21, 1981

80-378

NOTICE OF APPLICATION  
FOR WATER RIGHT

Notice is hereby given that the following ap-  
plication(s) have been submitted for permit to  
appropriate the public waters of the State of  
Idaho:

45-7451

MITCHELL, MORRIS W., BOX 48, OAKLEY, ID  
83346. Source: GROUNDWATER. Date Filed:  
10/01/1980. Amount: 0.20 CFS. Diversion Point:  
SWSE Sec 25 T 155 R 21E, CASSIA Co., Use:  
COMMERCIAL (0.20 CFS) from 01/01 to 12/31,  
HEATING (0.20 CFS) from 01/01 to 12/31, Place  
of Use: SWSE Sec 25 T 155 R 21E, Diversion  
Means: WELL AND PIPELINE

45-7452

MITCHELL, MORRIS W., BOX 48, OAKLEY, ID  
83346. Source: SPRINGS tributary to CAVE GULCH,  
Date Filed: 10/01/1980. Amount: 0.13 CFS.  
Diversion Point: NENE SWNE SWNW SENW Sec 22 T  
155 R 21E, SWSW NWSW Sec 14 T 155 R 21E,  
CASSIA Co., Use: STOCKWATER (0.13 CFS) from  
01/01 to 12/31, DOMESTIC (0.02 CFS) from  
01/01 to 12/31, Place of Use: NESW NWSW SWSW  
SESW NWSE Sec 14 T 155 R 21E, NENE SWNE SENE  
SWNW SENW Sec 22 T 155 R 21E, Diversion Means:  
HEADBOX AND TROUGH

If issued the permit(s) will be subject to all  
prior water rights. Protests against the granting of  
any permit must be filed with the Director of the  
Idaho Department of Water Resources, 1041 Blue  
Lakes Blvd. North, Twin Falls, Idaho 83301 and  
received on or before OCTOBER 31, 1980.

C. STEPHEN ALLRED  
Director

Published in the South Idaho Press on October  
14, 21 1980.

MICROFILMED

March 26, 1984

RE: Permit No. 45-7451

Morris W. Mitchell  
Box 48  
Oakley, ID 83346

Dear Mr. Mitchell:

Enclosed herewith is a copy of the Water Right License issued on the above referenced Permit.

Sincerely,



JIM JOHNSON  
Water Distribution Supervisor

JJ:kw  
Enclosure

**MICROFILMED**



State of Idaho  
**DEPARTMENT OF WATER RESOURCES**  
STATE OFFICE, 450 W. State Street, Boise, Idaho

JOHN V. EVANS  
Governor

A. KENNETH DUNN  
Director

Mailing address:  
Statehouse  
Boise, Idaho 83720  
(208) 334-4440

February 13, 1984

RE: Permit No. 45-7451

Morris W. Mitchell  
Box 48  
Oakley, ID 83346

Dear Mr. Mitchell:

A representative of this Department has made an examination of the works covered by your Permit No. 45-7451, and has found the following:

Amount of water that can be recognized as beneficially used under Idaho law: 0.16 cfs Source: groundwater

The maximum quantity diverted shall not exceed 115.8 acre feet per year.

Point(s) of diversion: SW $\frac{1}{4}$ SE $\frac{1}{4}$  Section 25, Twp 15S, Rge 21E

Beneficial use: Heating within SW $\frac{1}{4}$ SE $\frac{1}{4}$  Sec. 25, Twp 15S, Rge 21E

Priority date established: October 1, 1980

Conditions (if any):

If you do not concur with these findings please contact us within 10 days, otherwise a water license will be issued as set forth above.

Sincerely,

IM JOHNSON  
Water Distribution Supervisor

J:kw

MICROFILMED

**State of Idaho  
DEPARTMENT OF WATER RESOURCES  
FIELD REPORT**

45-7451  
Permit No.

**CONTACT WITH PERMIT HOLDER**

|  | DATE           | INITIALS | REMARKS   |
|--|----------------|----------|---|
| <input type="checkbox"/> Appointment letter mailed:                                      |                |          |   |
| <input type="checkbox"/> Telephone call made:<br>(List Telephone No. used)               |                |          |   |
| <input checked="" type="checkbox"/> Appointment scheduled for:<br>(Date, time, location) | 7/15/82 - 10AM | JS       | Owner called & Requested exam.<br>Will file Proof at exam time. |

**EXAMINATION**

Date 7/15/82 Accompanied by Morris Mitchell Total Q measured .16 cfs  
 If source is surface water, estimate total flow of source \_\_\_\_\_  
 Methods of measurement Volumetric Meets Permit requirements? Yes

Measurement calculations: Bucket Capacity: .728 Ft<sup>3</sup>  
3 measurements were made & total time accumulated. Time = 143 sec  

$$\frac{(.728)(3)}{14} = .16 \text{ cfs } \checkmark \text{OK}$$

$$\text{Volume} = (.16)(1.485)(365) \Rightarrow 85.8 \text{ AFA. } \checkmark \text{OK}$$

| WELL/DIVERSION* NO. | HP | MOTOR MAKE | MOTOR SERIAL NO. | PUMP MAKE | PUMP SERIAL NO. | MEASURING DEVICE TYPE | CONDITION OF MEAS. DEV. | REMARKS            |
|---------------------|----|------------|------------------|-----------|-----------------|-----------------------|-------------------------|--------------------|
|                     | NA | NA         |                  |           |                 |                       |                         | Attesian - Flowing |

System Description 10" dia well supplies 110°F water to house, pool, bathhouse, & greenhouse. Drinking water is supplied to house from a different well under permit 45-7173

\*Code with map on reverse side. Disregard code if only one.

**RECOMMENDED AMOUNTS**

| USE   | Irrigation requirement = _____ AFA/Acre |                 |                |                  |
|---|---|-----------------|----------------|------------------|
|   | Q (cfs)                                 | V (afa)         | FROM           | TO               |
| <input checked="" type="checkbox"/> Heating                               | .06                                     | <del>45.4</del> | 1/1 ✓          | 12/31 ✓          |
| <del>Recreation (pool)</del><br>(pool listed under heating use on permit) | <del>.10</del>                          | <del>72.4</del> | <del>1/1</del> | <del>12/31</del> |
| Total   | .16 ✓ OK                                | N/A ✓ OK        |                |                  |

Remarks

**MICROFILMED**

MAP (Attach Aerial Photo)

MICROFILMED

|  |  |  |  |  |  |  |  |  |  |  |  |  |  |  |  |  |  |  |  |
|--|--|--|--|--|--|--|--|--|--|--|--|--|--|--|--|--|--|--|--|
|  |  |  |  |  |  |  |  |  |  |  |  |  |  |  |  |  |  |  |  |
|  |  |  |  |  |  |  |  |  |  |  |  |  |  |  |  |  |  |  |  |
|  |  |  |  |  |  |  |  |  |  |  |  |  |  |  |  |  |  |  |  |
|  |  |  |  |  |  |  |  |  |  |  |  |  |  |  |  |  |  |  |  |
|  |  |  |  |  |  |  |  |  |  |  |  |  |  |  |  |  |  |  |  |
|  |  |  |  |  |  |  |  |  |  |  |  |  |  |  |  |  |  |  |  |
|  |  |  |  |  |  |  |  |  |  |  |  |  |  |  |  |  |  |  |  |
|  |  |  |  |  |  |  |  |  |  |  |  |  |  |  |  |  |  |  |  |
|  |  |  |  |  |  |  |  |  |  |  |  |  |  |  |  |  |  |  |  |
|  |  |  |  |  |  |  |  |  |  |  |  |  |  |  |  |  |  |  |  |

**SCHEMATIC DIAGRAM OF SYSTEM**

(Include distance from pump to measuring device, if applicable.)

See Attachment

Point(s) of diversion: SW<sup>1</sup>SE<sup>1</sup> Sec 25 T15S R21E

✓ Same as permit

Place(s) of Use

✓ Same as permit

| TWP. | RGE. | SEC. | NE <sup>1</sup> / <sub>4</sub> |                                |                                |                                | NW <sup>1</sup> / <sub>4</sub> |                                |                                |                                | SW <sup>1</sup> / <sub>4</sub> |                                |                                |                                | SE <sup>1</sup> / <sub>4</sub> |                                |                                |                                | TOTALS |
|------|------|------|--------------------------------|--------------------------------|--------------------------------|--------------------------------|--------------------------------|--------------------------------|--------------------------------|--------------------------------|--------------------------------|--------------------------------|--------------------------------|--------------------------------|--------------------------------|--------------------------------|--------------------------------|--------------------------------|--------|
|      |      |      | NE <sup>1</sup> / <sub>4</sub> | NW <sup>1</sup> / <sub>4</sub> | SW <sup>1</sup> / <sub>4</sub> | SE <sup>1</sup> / <sub>4</sub> | NE <sup>1</sup> / <sub>4</sub> | NW <sup>1</sup> / <sub>4</sub> | SW <sup>1</sup> / <sub>4</sub> | SE <sup>1</sup> / <sub>4</sub> | NE <sup>1</sup> / <sub>4</sub> | NW <sup>1</sup> / <sub>4</sub> | SW <sup>1</sup> / <sub>4</sub> | SE <sup>1</sup> / <sub>4</sub> | NE <sup>1</sup> / <sub>4</sub> | NW <sup>1</sup> / <sub>4</sub> | SW <sup>1</sup> / <sub>4</sub> | SE <sup>1</sup> / <sub>4</sub> |        |
| 15 S | 21 E | 25   |                                |                                |                                |                                |                                |                                |                                |                                |                                |                                |                                |                                |                                |                                | X                              |                                |        |
|      |      |      |                                |                                |                                |                                |                                |                                |                                |                                |                                |                                |                                |                                |                                |                                |                                |                                |        |
|      |      |      |                                |                                |                                |                                |                                |                                |                                |                                |                                |                                |                                |                                |                                |                                |                                |                                |        |
|      |      |      |                                |                                |                                |                                |                                |                                |                                |                                |                                |                                |                                |                                |                                |                                |                                |                                |        |
|      |      |      |                                |                                |                                |                                |                                |                                |                                |                                |                                |                                |                                |                                |                                |                                |                                |                                |        |
|      |      |      |                                |                                |                                |                                |                                |                                |                                |                                |                                |                                |                                |                                |                                |                                |                                |                                |        |
|      |      |      |                                |                                |                                |                                |                                |                                |                                |                                |                                |                                |                                |                                |                                |                                |                                |                                |        |
|      |      |      |                                |                                |                                |                                |                                |                                |                                |                                |                                |                                |                                |                                |                                |                                |                                |                                |        |

Recommended Amendments:

- Change P.D. as reflected above
- Add P.D. as reflected above
- Change P.U. as reflected above
- Add P.U. as reflected above
- None
- Other Add Recreation Use

Examiner's Signature Loren O Halmer  
 Checked by Terry A Blau  
 Approved by Ray Walker

Date 7/21/82  
 Date 7/22/82  
 Date 1-23-84

✓ swimming pool sited under heating use on permit.

Hot well

45-7451

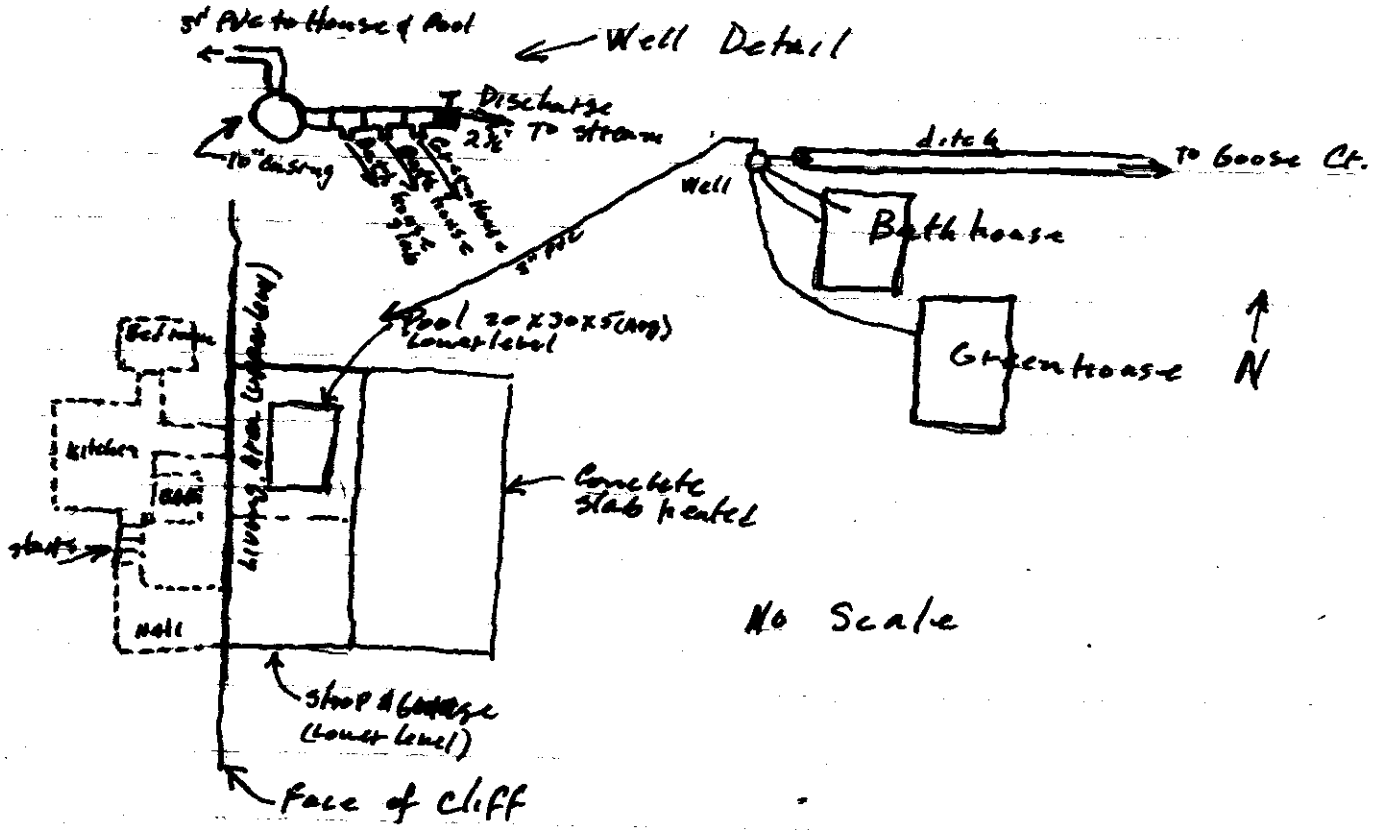

Water measurement: Total flow of well with discharge to stream open. Bucket Capacity = .728 ft<sup>3</sup>

$$\frac{(.728)(3)}{14 \text{ sec}} = \underline{\underline{.16 \text{ cfs VOK}}}$$

Home: 1000 ft<sup>2</sup> underground, 1600 ft<sup>2</sup> Brick & Concrete Construction

Pool: 20'x30'x5' (Avg) ⇒ 3000 ft<sup>3</sup>

Bathhouse: 12'x12' with 8'x8'x3' Pool

Greenhouse: Approx 20'x40'

45-7451 Calculation of water requirement.

Parameters for heating Requirement Calculations:

House:  $e = .28$  Area =  $2600 \text{ft}^2$

$S = 110^\circ\text{F}$

Outside design temp =  $-20^\circ\text{F}$  - Assumed  $\Rightarrow T = 90^\circ\text{F}$   
 inside " " =  $70^\circ\text{F}$

Design heat Load:  $E = eTA = (.28)(90)(2600) = 65520 \text{ Btu/hr}$

$\Delta t = 110 - 90 = 20^\circ\text{F}$

Flow Required:  $W = \frac{E}{500\Delta t} = \frac{65520}{(500)(20)} = 655 \text{ gpm} = 0.01 \text{ cfs}$

$$\begin{array}{r} .014 \\ 448 \overline{) 65500} \\ \underline{44800} \\ 20700 \end{array}$$

Allow .02 cfs  $\checkmark$  OK

Greenhouse:  $e = 1.11$  - poor insulation - Area =  $800 \text{ft}^2$

$E = (1.11)(90)(800) = 79920 \text{ Btu/hr}$

$W = \frac{79920}{(500)(20)} = 7.99 \text{ gpm} \Rightarrow \underline{.02 \text{ cfs}}$   $\checkmark$  OK

Bathroom: Allow .02 cfs  $\checkmark$  OK

Pool:  $3000 \text{ft}^3$ ; Assume 3 changes of water in 24 hrs

$\frac{(3000)(3)}{(24)(60)} = \underline{.10 \text{ cfs}}$   $\checkmark$   $\frac{9000}{86400}$

pool = 0.10

bathroom = 0.02

greenhouse = 0.02

house = 0.02

Total water Requirement = .16 cfs.

0.16

MICROFILMED

45-7473 & 45-7451  
Exam. 7/15/82  
Base Map Copied from  
Dunlap aerial photo  
17-64-88, 10/6/56 flight

2419  
2530

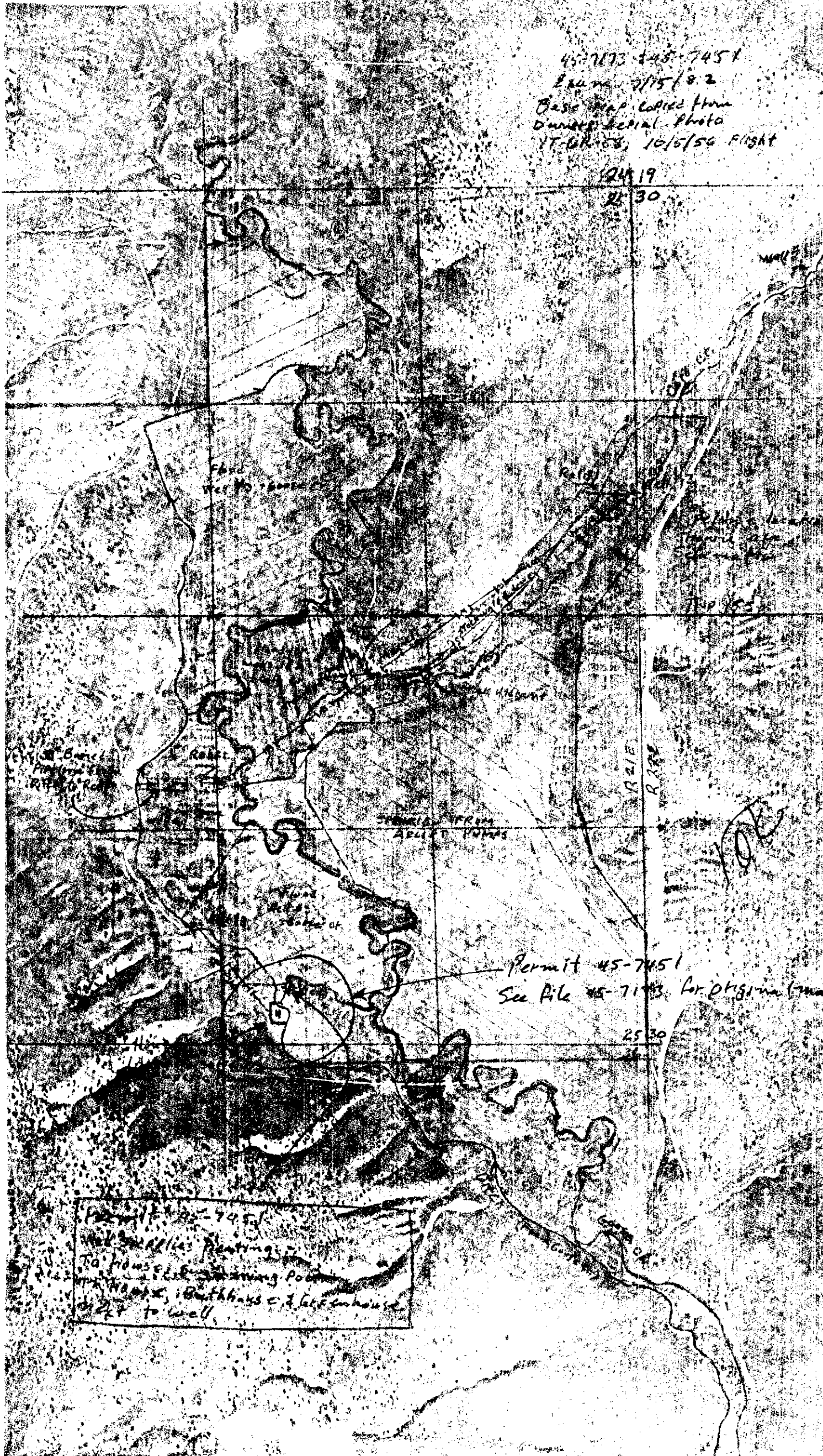

Field  
for No. 1000

Rd 10

Point of location  
shown on  
aerial photo

Map 165

Highway

Barrel  
Pond  
Rd 10

Rd 10

TRAIL FROM  
APL 1 PUMP

R 21 E  
R 22 E

Permit 45-7451  
See file 45-7143 for original map

2530

Permit 45-7451  
Well location pointing  
to house & swimming pool  
house, bathhouse & greenhouse  
next to well

August 10, 1982

Norris W. Mitchell  
P.O. Box 48  
Oakley, ID 83346

Dear Mr. Mitchell:

Re: Permit No. 45-7451

This office acknowledges receipt of the postcard as the statement of beneficial use.

It is the Department's understanding that a field exam has been conducted by one of our regional representatives. Based on his recommendations, a water right license will be issued.

If you have further questions concerning your permit, please feel free to contact me.

Sincerely,

RITA I. FLECK  
Sr. Secretary

cc: region

RECEIVED  
AUG 11 1982  
REGIONAL OFFICE

Recd 7/15/82 JH

DEPARTMENT OF WATER RESOURCES

The Idaho Department of Water Resources will consider this card as a statement that the permit holder(s) has completed development to the extent shown below of Permit No. 45-7451

Name(s) of Permit Holder: MORRIS W. MITCHELL

Post Office Address: P.O. Box 48 OAKLEY

Tel. No. 436-0939

Source of Water:

- Extent of Use:  Domestic (number of households)
- Stockwater (number and type of stock)
- Irrigation (acres)
- Other *hunting, pool, bathhouse, greenhouse*

Measuring Device: Required?  Yes  No Installed?  Yes  No

Access Port: Required?  Yes  No Installed?  Yes  No

The above information is a true statement of the extent to which the above numbered permit has been developed.

15 July 1982  
Date

*Morris W. Mitchell*  
Signature of Permit Holder

Form completed 7/15/82 JH

Department of Water Resources  
Sawtooth Branch Office

JUL 15 1982

RECEIVED



IDAHO DEPARTMENT OF WATER RESOURCES  
STATEHOUSE  
BOISE, IDAHO 83720

PLACE  
TEN CENT  
STAMP  
HERE

STATE OF IDAHO  
DEPARTMENT OF WATER RESOURCES

---

STATEHOUSE  
BOISE, IDAHO 83720  
(208) 334-4440

MITCHELL, MORRIS W.  
BOX 48  
OAKLEY, ID 83346

JANUARY 22, 1981

RE: PERMIT NO. 45-7451

DEAR PERMIT HOLDER:

ENCLOSED IS A COPY OF YOUR APPROVED APPLICATION FOR PERMIT. WE DIRECT YOUR ATTENTION TO THE CONDITIONS OF APPROVAL ON THE FOURTH PAGE.

WE HAVE ENCLOSED A FORM ENTITLED "MAKING PROOF OF BENEFICIAL USE". PLEASE READ THE INSTRUCTIONS CAREFULLY SINCE YOU MUST TAKE FURTHER ACTION TO DEVELOP THIS PERMIT INTO A LICENSE.

SINCERELY,

DAVID R. TOTHILL, JR., P.E.  
SUPERVISOR, WATER ALLOCATION SECTION

ENCLOSURE

MICROFILMED

RE: Application  
#45-7451

P.O. Box 48  
Oakley, Idaho 83346  
16 January 1981

RECEIVED

JAN 19 1981

Department of Water Resources

Mr. Paul M. Castelin  
State of Idaho Department of Water Resources  
State Office  
450 West State Street  
Boise, Idaho 83720

Dear Mr. Castelin:

In answer to your letter of 2 January 1981, the well in question is an old well being about 60 years old. The only information I have on it is second hand rumor including the depth of 2600 feet.

I have made a thorough search and all I can come up with is stories from people who are very old at this time and their stories contradict each other. I assume that a driller's log was not required by Idaho law at the time the drilling took place.

In reference to Permit #45-7452. The requirement is made for a lockable device to be installed on the diversion works. Can you furnish the information as to the type of device that will meet the approval of the Department? Is a gate valve installed in the pipe diverting the water sufficient?

Sincerely

  
Morris W. Mitchell

MICROFILMED



State of Idaho

**DEPARTMENT OF WATER RESOURCES**

STATE OFFICE, 450 W. State Street, Boise, Idaho

JOHN V. EVANS

Governor

C. STEPHEN ALLRED

Director

Mailing address:  
Statehouse  
Boise, Idaho 83720  
(208) 334-4440

January 2, 1981

Morris W. Mitchell  
Box 48  
Oakley, ID 83346

Dear Mr. Mitchell:

Your recent water right application No. 45-7451, indicated an existing 2600' deep flowing (hot?) well in the SW  $\frac{1}{4}$  SE  $\frac{1}{4}$  of section 25, T. 15 S., R. 21 E., B.M. as your source of water. We have no well driller's log on the construction of this well as required by Idaho law. Please supply us with 1) copy of the driller's log if you have one, or 2) the name of the driller, date of construction, and any other particulars you may have on the well and the driller so that he or his successors can be contacted.

As this information affects processing of your application your earliest response would be very much appreciated.

Sincerely,

PAUL M. CASTELIN, Supervisor  
Construction Permits Section

PMC:td

**MICROFILMED**

NOTICE OF APPLICATION FOR WATER RIGHT

Notice is hereby given that the following application(s) have been submitted for permit to appropriate the public waters of the State of Idaho:

45-7451

MITCHELL, MORRIS W.

BOX 48, OAKLEY, ID 83346

Source: GROUNDWATER

Date Filed: 10/01/1980

Amount: 0.20 CFS

Diversion Point: SWSE Sec 25 T 15S R 21E, CASSIA Co.

Use: COMMERCIAL (0.20 CFS) from 01/01 to 12/31  
HEATING (0.20 CFS) from 01/01 to 12/31

Place of Use: SWSE Sec 25 T 15S R 21E

Diversion Means: WELL AND PIPELINE

If issued, the permit(s) will be subject to all prior water rights. Protests against the granting of any permit must be filed with the Director of the Idaho Department of Water Resources, 1041 Blue Lakes Blvd. North, Twin Falls, Idaho 83301 and received on or before OCTOBER 31, 1980.

C. STEPHEN ALLRED

Director

Published 10/14 & 10/21/80.

MICROFILMED

80-378

**NOTICE OF APPLICATION  
FOR WATER RIGHT**

Notice is hereby given that the following application(s) have been submitted for permit to appropriate the public waters of the State of Idaho:

**45-7451**

MITCHELL, MORRIS W., BOX 48, OAKLEY, ID 83346, Source: GROUNDWATER, Date Filed: 10/01/1980, Amount: 0.20 CFS, Diversion Point: SWSE Sec 25 T 15S R 21E, CASSIA Co., Use: COMMERCIAL (0.20 CFS) from 01/01 to 12/31, HEATING (0.20 CFS) from 01/01 to 12/31, Place of Use: SWSE Sec 25 T 15S R 21E, Diversion Means: WELL AND PIPELINE

*ok  
mmp  
10/14/80*

STATE OF IDAHO  
DEPARTMENT OF WATER RESOURCES  
Southern Region

---

1041 Blue Lakes Blvd N.  
Twin Falls, Idaho 83301  
(208) 734-3578

OCTOBER 3, 1980

South Idaho Press  
P.O. Box 190  
Burley, Idaho 83318

Gentlemen:

Enclosed you will find a legal notice which we wish to have published on the dates indicated (once a week for two consecutive weekly issues) in your newspaper. We have allowed ample time for you to submit a galley proof to this office for review before the first publication date. If you cannot publish the notice on the proposed dates, please contact us immediately.

An affidavit of publication must be submitted to the Department along with the publication bill. Your cooperation is appreciated.

Please send the affidavit of publication and publication billing to this office before OCTOBER 31, 1980.

Yours truly,

Mary A. Hill  
Secretary

Encl.

**MICROFILMED**