

# Application For Permit To Appropriate the Public Waters of the State of Idaho

APPLICATION No. 37513  
PERMIT No. 29513  
DISTRICT No.

1. Name of Applicant: State of Idaho, Department of Fish and Game

Postoffice address: Boise

County:

State: Idaho

I. If applicant is a corporation, give:

(a) Date and place of incorporation:

(b) Amount of capital stock:

(c) Amount paid in:

(d) Names and addresses of directors:

II. The financial resources of the applicant are:

(a) Cash on hand:

(b) Treasury stock:

(c) Bond to be issued:

(d) Other resources:

2. Quantity of water claimed: 10.0 c.f.s.

cubic feet per second.

3. Source of water supply: Salmon River

which is a tributary of Snake  
River4. Location of point of diversion: S. 25° 0' W., 1910 feet distant from the northeast  
corner of Section 6, T. 21 N., R. 22 E., B.M., and is in the Lot 10  
of section 6, T. 21 N., R. 22 E., B. M., County of Lemhi

5. Water is to be used for Operation of a leuwer type fish screen

6. If for mining, milling, power or manufacturing purposes, give:

(a) Point of use of water: 600 feet distant from northeast corner of Section 6  
T. 21 N., R. 22 E., B.M., in the Lot 1 of Section of 6, T. 21 N., R. 22 E., B.M.

(b) Amount of power generated: H.P., under feet head.

(c) Water is to be returned to Salmon River at a point 570 feet  
east  
distant from the north/ corner of Section 6, T. 21 N., R. 22 E., B.M., in the Lot 1  
of Section 6, T. 21 N., R. 22 E., B.M.

7. Estimated cost of works: \$ 1,500.00

8. Kind of works: A fish screen within a canal known as "Wheeler Ditch"

9. Height of dam feet; length of dam at top feet; length of dam at bottom  
feet; material used in dam:

Wheeler Ditch headgate:

10. Size of headgate: Width 10 feet; height 7 feet.

11. Ditch: Width at bottom 8 feet; width at water line 12 feet; depth of water 4 feet;  
dimensions of flume:

Diameter of pipe inches; length of conduit miles.

Average grade per mile feet.

12. The time required for the completion of such work is one years.

13. The time required for the complete application of the water to the proposed use is one additional years.

14. The land to be irrigated is described in the following tabulation: See remarks.

15. Existing water rights and/or valid permits appurtenant to the lands to be irrigated are:

The Wheeler Canal has been in operation for approximately 40 years. If a water license or decree exists, the number of license or decision is unknown.





R-22E.

Wheeler ditch

Screen site

PD-Headgate

6

5

Salmon

SALMON

U.S. HWY. No. 93

Non Consumptive Use

Allow 10.0 cfs



John R. Robert L. Salter, Acting  
Director, Dept. of Fish and Game  
Boise, Idaho  
Sept 18-22 1962  
Permit No. 29513

Clarence Boggs - Eng. that  
designed dam

Completion of Works and  
Examination for Beneficial Use

County Lemhi  
Sec. 6 T. 21N R. 22E

Quantity: 10.0 a.c.s.

Source: Salmon River

P.D.: Lot 10, Sec. 6, T. 21N, R. 22E

Use: Lower type fish screen  
operation

Filed: Feb 21, 1961

Due: March 2, 1963

Extension:

Completion of Works:

Other Rights: none stated

## INSTRUCTIONS TO EXAMINERS

1. Always carefully note the location of the point of diversion and accurately plat same.
2. When proof is for beneficial use, carefully check up the number of acres actually irrigated in each forty and accurately plat same.
3. Make a map showing the correct location of streams and ditches, and the irrigated lands, and any adjacent permanent landmarks, such as towns, lakes, large streams and public roads.
4. If any unusual conditions are discovered, make plain statement of them under remarks.
5. Always see the holder, if possible, and go over the whole ground with him and make your report only upon actual existing facts and conditions.
6. Give general characteristics of soils, topography, and crops raised.

RECEIVED  
OCT 3 1962

Department of Reclamation



NOTICE OF PROOF OF COM-  
PLETION OF WORKS  
and  
APPLICATION OF WATER TO  
BENEFICIAL USE

NOTICE is hereby given that at 10:00 A. M., on the 26th day of February, 1962, at Boise, County of Ada, State of Idaho, before Anne Epeldi, Notary Public, at 518 Front Street, Boise, Idaho, proof will be submitted of the completion of works for the diversion of 10 c. f. s. cubic feet per second of the waters of Salmon River, and of the application to beneficial use of said water, in accordance with the terms and conditions of Permit No. 29513, heretofore issued by the Department of Reclamation of the State of Idaho.

1. The name and postoffice address of the person or corporation holding said permit is: State of Idaho, Department of Fish and Game, 518 Front St., Boise, Idaho.

2. Said works of diversion will be fully completed on the date set for such completion and the amount of water which said works are capable of conveying to the place of use is ten (10) cubic feet per second.

3. The use to which said water has been applied is operation of leuwer type fish screen purposes, and the amount applied to beneficial use is ten (10) cubic feet per second.

4. The point of diversion of said water is South 25°00' West 1910 feet distant from the northeast corner of Section 6, Township 21 North, Range 22 East, Boise Meridian, and is in Lot 10 of said Section 6.

5. The place where said water is used is within Lot 1, Section 6, Township 21 North, Range 22 East, Boise Meridian.

5. The date of priority which said user is prepared to establish is February 21, 1961.

GEO. N. CARTER

State Reclamation Engineer

No. 249 1-25 to 2-15 4 to

# Affidavit of Publication

STATE OF IDAHO }  
County of Lemhi } ss.

Larry H. Robinson

being first duly sworn, deposes and says that he is one of the printers (publisher) of the RECORDER HERALD, a newspaper published weekly at Salmon, Lemhi County, Idaho, and of general circulation therein,

That the Notice of Proof, Permit #29513

\_\_\_\_\_ a true  
printed copy of which is attached to the margin hereof, has been and was correctly printed and published in the regular and entire issue of every number of said newspaper and not in any supplement thereof or thereto for four (4)  
consecutive issues, commencing with the issue dated February Jan. 25 1962  
and ending with the issue dated February 15, 1962

Larry H. Robinson  
Subscribed and sworn to before me, this 9<sup>th</sup>

day of March, 1962

Anthony J. Miller  
Notary Public for the State of Idaho,  
Residing at Salmon, Idaho.

Publication Fee \$ 25.08

29513



State of Idaho Dept of Fish & Game

T22N  
T21N

R21E BM  
R22E BM

Whisper ditch

Screen Site

Headgate

6

Salmon

7

5

Permit Map No. 29513

As Approved

GEO. N. CARTER

Reclamation Engineer

MAR 2 1961

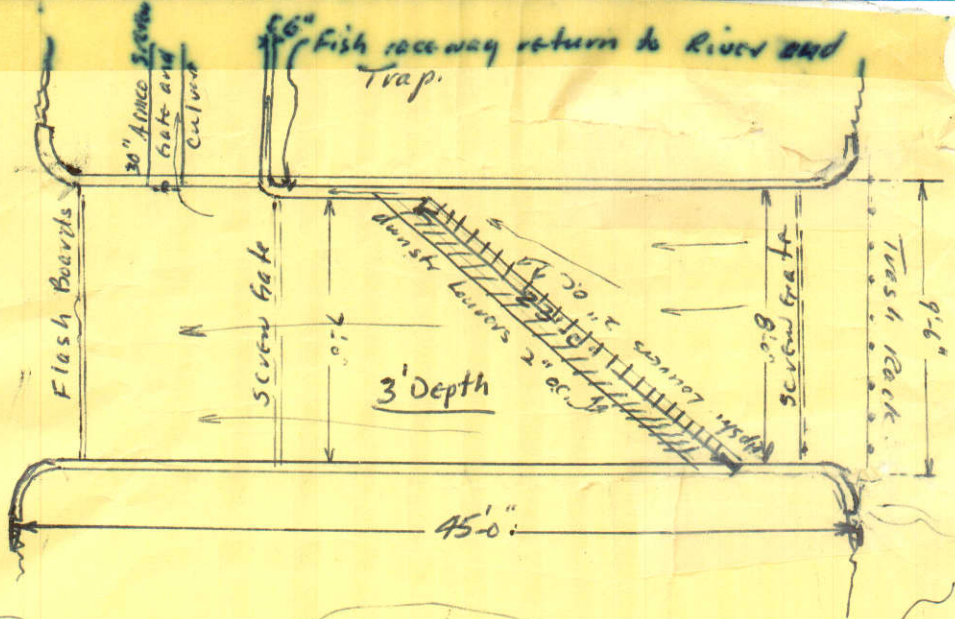

canal by Pass around screen  
(NOT TO SCALE)

29513



NAME OF APPLICANT

Charles Herndon

Form No. 0

T. 21 N. R. 22 E. B.M.  
NW 1/4 SW 1/4 - Sec 5

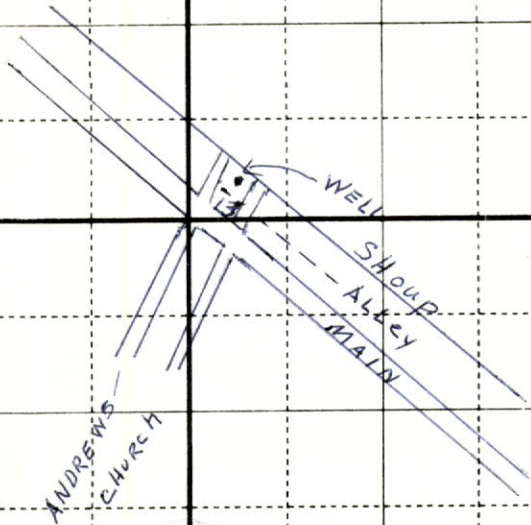

6 5  
7 8

Permit Map No. 29056  
As Approved SEP 28 1960  
GEO. N. CARTER

State of Idaho  
License and Certificate of Water Right

Water License No. 29513

Amount 10.0 c.f.s.

Water District No.

Priority February 21, 1961

THIS IS TO CERTIFY that DEPARTMENT OF FISH AND GAME, STATE OF IDAHO  
of Boise, Idaho, made application for a permit to appropriate the  
public waters of the State of Idaho, dated February 21, 1961; that Permit No. 29513  
was issued under said application; that Certificate of Completion of works, with a carrying capacity of  
10.0 second feet, was issued thereunder on October 10, 1962, showing that said works  
were completed on the 26th day of February, 1962; and that on the 26th  
day of February, 1962,

DEPARTMENT OF FISH AND GAME, STATE OF IDAHO  
of Boise, State of Idaho, made proof to the satisfaction of the  
State Reclamation Engineer of Idaho, of the right to use the waters of Salmon  
River, a tributary of Snake River, for the purpose of operation of leuwer type  
fish screen, under Use Permit No. 29513 of the Department of Reclamation  
and that said right to the use of said waters has been perfected in accordance with the laws of Idaho,  
and is hereby confirmed by the State Reclamation Engineer of Idaho and entered of record in Volume  
12 of Licenses at page 7489, on the 10th day of October, 1962;  
The right hereby confirmed dates from February 21, 1961;

The Point of Diversion is located Lot 10  
in the 1/4 1/4, Sec. 6, Tp. 21 N, R. 22 E., B. M. Lemhi County

That the amount of water to which such right is entitled and hereby confirmed, for the purposes  
aforesaid, is limited to an amount actually needed and beneficially used for said purposes, and shall  
not exceed 10.0 cubic feet per second.

Description and location of use:

Twp.	Range	Sec.	Forty-acre Tract	No. Acres Described in Permit	No. Acres Actually Irrigated
21 N	22 E	6	Lot 1 For operation of a leuwer type fish screen		

The right to the use of the water aforesaid hereby confirmed is restricted to the lands or place  
of use herein described, as provided by the laws of Idaho.

WITNESS the seal and signature of the State Reclamation Engineer, affixed at Boise, Idaho, this  
10th day of October, 1962.

RALPH W. THOMAS  
Deputy State Reclamation Engineer.

(SEAL)

75 2132



State of Idaho  
License and Certificate of Water Right

Water License No. 28803 Amount .24 c.f.s.  
Water District No. Priority June 20, 1960

THIS IS TO CERTIFY that FRED R. MOORE  
of Athol, Idaho, made application for a permit to appropriate the  
public waters of the State of Idaho, dated June 20, 1960; that Permit No. 28803  
was issued under said application; that Certificate of Completion of works, with a carrying capacity of  
.60 second feet, was issued thereunder on July 25, 1961, showing that said works  
were completed on the 20th day of July, 1961; and that on the 2nd  
day of September, 1961,

FRED R. MOORE  
of Athol, State of Idaho, made proof to the satisfaction of the  
State Reclamation Engineer of Idaho, of the right to use the waters of Lewellen  
Creek, a tributary of, for the purpose of irrigation  
, under Use Permit No. 28803 of the Department of Reclamation  
and that said right to the use of said waters has been perfected in accordance with the laws of Idaho,  
and is hereby confirmed by the State Reclamation Engineer of Idaho and entered of record in Volume  
12 of Licenses at page 7490, on the 12 day of October, 1962;  
The right hereby confirmed dates from June 20, 1960;

The Point of Diversion is located  
in the SE 1/4 SW 1/4, Sec. 24, Tp. 53N, R. 3 W., B. M. County Kootenai  
That the amount of water to which such right is entitled and hereby confirmed, for the purposes  
aforesaid, is limited to an amount actually needed and beneficially used for said purposes, and shall  
not exceed .24 cubic feet per second.

Description and location of use:

Twp.	Range	Sec.	Forty-acre Tract	No. Acres Described in Permit	No. Acres Actually Irrigated
53 N.	3 W.	24	NW 1/4 SE 1/4	13	13
			SW 1/4 SE 1/4	40	40
			SE 1/4 SW 1/4	31	31
			Total number of acres to be irrigated:		84

The right to the use of the water aforesaid hereby confirmed is restricted to the lands or place  
of use herein described, as provided by the laws of Idaho.

WITNESS the seal and signature of the State Reclamation Engineer, affixed at Boise, Idaho, this  
12th day of October, 1962.

RALPH W. THOMAS  
Deputy State Reclamation Engineer.

(SEAL)

75-2142

## Application For Permit To Appropriate the Public Waters of the State of Idaho

APPLICATION No. 37513  
PERMIT No. 29513  
DISTRICT No.

1. Name of Applicant: State of Idaho, Department of Fish and Game

Postoffice address: Boise

County:

State: Idaho

I. If applicant is a corporation, give:

(a) Date and place of incorporation:

(b) Amount of capital stock:

(c) Amount paid in:

(d) Names and addresses of directors:

II. The financial resources of the applicant are:

(a) Cash on hand:

(b) Treasury stock:

(c) Bond to be issued:

(d) Other resources:

2. Quantity of water claimed: 10.0 c.f.s.

cubic feet per second.

3. Source of water supply: Salmon River

which is a tributary of Snake River

4. Location of point of diversion: S. 25° 0' W., 1910

feet distant from the northeast

corner of Section 6, T. 21 N., R. 22 E., B.M., and is in ~~the~~ Lot 10

of section 6, T. 21 N., R. 22 E., B. M., County of Lemhi

5. Water is to be used for Operation of a leuver type fish screen

6. If for mining, milling, power or manufacturing purposes, give:

(a) Point of use of water: 600 feet distant from northeast corner of Section 6

T. 21 N., R. 22 E., B.M., in ~~the~~ Lot 1 of Section of 6, T. 21 N., R. 22 E., B.M.

(b) Amount of power generated: H.P., under feet head.

(c) Water is to be returned to Salmon River at a point 570 feet

east distant from the north/ corner of Section 6, T. 21 N., R. 22 E., B.M., in the Lot 1

of Section 6, T. 21 N., R. 22 E., B.M.

7. Estimated cost of works: \$ 1,500.00

8. Kind of works: A fish screen within a canal known as "Wheeler Ditch"

9. Height of dam feet; length of dam at top feet; length of dam at bottom

feet; material used in dam:

Wheeler Ditch headgate:

10. Size of headgate/ Width 10 feet; height 7 feet.

11. Ditch: Width at bottom 8 feet; width at water line 12 feet; depth of water 4 feet;

dimensions of flume:

Diameter of pipe inches; length of conduit miles.

Average grade per mile feet.

12. The time required for the completion of such work is one years.

13. The time required for the complete application of the water to the proposed use is one additional years.

14. The land to be irrigated is described in the following tabulation: See remarks.

15. Existing water rights and/or valid permits appurtenant to the lands to be irrigated are:

The Wheeler Canal has been in operation for approximately 40 years. If a water license or decree exists, the number of license or decision is unknown.

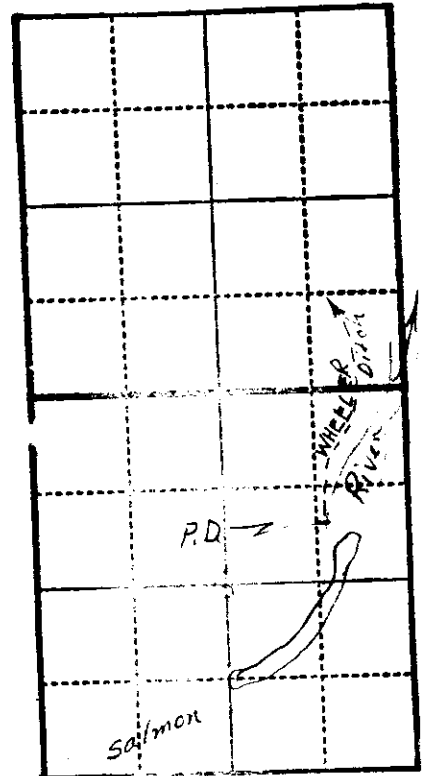



16. (a) Is reservoir to be used? no If so, fill in (b) and (c) below:  
 (b) Name of Reservoir and number of Storage Permit:  
 (c) Date of filing of Application for Storage Permit and Name of Applicant:

BE IT KNOWN THAT The undersigned hereby makes application for permit to appropriate the public water of the State of Idaho as herein set forth.

STATE OF IDAHO  
Department of Fish and Game *Applicant.*

By s/ Ross Leonard  
Director

*Agent.*

**Date of first receipt at Department of Reclamation: 1:00 P.M. February 21, 1961**

Returned to applicant for correction:

**Corrected application received:**

### Approval of State Reclamation Engineer

The number of this permit is 29513

Recorded in Book 104 Page 29513 Approved March 2, 1961

This is to certify that I have examined the within application for a permit to appropriate the public waters of the State of Idaho, and hereby approve the same, subject to the following limitations and conditions:

Bond in the sum of \$ \_\_\_\_\_ to be filed on or before \_\_\_\_\_

Work to begin on or before May 2, 1961

and to continue diligently and uninterruptedly to completion,

unless temporarily interrupted by circumstances over which permit holder has no control.

One-fifth of the work above specified to be completed on or before September 2, 1961

The whole of said work to be completed on or before March 2, 1962

Beneficial use of water appropriated in accordance herewith, to be made on or before March 2, 1963

WITNESS My hand this 2nd day of March, 1961

s/ GEO. N. CARTER  
State Reclamation Engineer.

IN TESTIMONY WHEREOF, We,.....ROBERT E. SMYLIE....., Governor of the State of Idaho,  
and .....ARNOLD WILLIAMS....., Secretary of State of the State of Idaho, have caused this instrument to  
be executed in the name of the State of Idaho, and caused the Great Seal of the State of Idaho to be hereunto affixed, this.....2nd.....

day of March, 19 61

STATE OF IDAHO

Countersigned:

(SEAL)

By s/ ARNOLD WILLIAMS

By s/ ROBERT E. SMYLLIE

*Governor.*

Secretary of State.

REMARKS: Waters of Salmon River will be diverted into the Wheeler Canal in the amount of 10 c.f.s. in excess of that water diverted and used for irrigation purposes. This excess water will operate a fish screen located within the canal approximately one-fourth mile below the Wheeler Ditch headgate. At the fish screen site the waters in the amount of 10 c.f.s. will be spilled back into the Salmon River and in so doing, will carry all of those fish which have been diverted from Salmon River with the irrigation waters at the canal's headgate. The ditch owners have granted their permission to the Department of Fish and Game to install said fish screen.

**14.**

Fish and Game to install said fish screen.																			
Twp.	Range	Sec.	NE $\frac{1}{4}$				NW $\frac{1}{4}$				SW $\frac{1}{4}$				SE $\frac{1}{4}$				Totals
			NE $\frac{1}{4}$	NW $\frac{1}{4}$	SW $\frac{1}{4}$	SE $\frac{1}{4}$	NE $\frac{1}{4}$	NW $\frac{1}{4}$	SW $\frac{1}{4}$	SE $\frac{1}{4}$	NE $\frac{1}{4}$	NW $\frac{1}{4}$	SW $\frac{1}{4}$	SE $\frac{1}{4}$	NE $\frac{1}{4}$	NW $\frac{1}{4}$	SW $\frac{1}{4}$	SE $\frac{1}{4}$	
✓			Permit No. 29513 ✓ CERTIFICATE OF COMPLETION OF WORKS																
			TO ALL WHOM IT MAY CONCERN:																
			This is to certify that DEPARTMENT OF FISH AND GAME, State of Idaho, of Boise, County of Ada, and State of Idaho, the holder of Permit No. 29513, issued upon Application No. 37513, bearing date of priority of February 21, 1961, authorizing the diversion of 10.0 second feet of waters of Salmon River, County of Lemhi, State of Idaho, for operation of a leuver type fish screen purposes, has fully complied with the provisions of the laws of the State of Idaho, relating to the proof of completion of the works of diversion set out and described in said Permit; that said works are adequate for diverting and conveying to the place of intended use 10.0 second feet of the waters of Salmon River, tributary of Snake River; that the point of diversion of said waters Lot 10, Sec. 6, T. 21 N., R. 22 E., B. 1 and that the lands proposed to be irrigated by the use of said water are described as follows, to-wit:																
			For operation of a leuver type fish screen in Lot 1, Sec. 6, Twp. 21 N., R. 22 E., E. M.																
			Witness my hand this 10th day of October, A. D. 1962																
			s/ RALPH W. THOMAS Deputy State Reclamation Engineer																
			Proof of Completion of Works Made: February 26, 1962																
			LICENSE ISSUED FOR 10.0 SEC. FT. page 7489																

WATER RIGHT NUMBER 75-2142

**VERIFIED LGS**

OWNER LAST NAME - STATE OF IDAHO FIRST NAME - ORIG OWNER -  
ADDRESS LINE 1 - DEPT. OF FISH & GAME ADDRESS LINE 2 - P.O. BOX 25  
ADDRESS LINE 3 - CITY - BOISE STATE - ID ZIP CODE - 83720  
SOURCE - SALMON RIVER TRIBUTARY OF - SNAKE RIVER  
STAGE - LICENSE STATUS - PRIORITY - 02-21-1961 COUNTY - LEMHI TOTAL DIV. RATE - 10.0000 -CFS  
TOTAL DIV. VOLUME - .00 AFA TRFR/AMEND - WATER DIST. - DLE/CAREY ACT - RIGHT BASIS -  
DIVERSION POINT - SENE 06 21N 22E LOT 10 REDIV - 272.0 92.0 0.0 0.0 0.0 0.0 0.0 0.0 0.0 259.2  
FROM - TO - USE - FISH PROP. USE DIV. RATE - 10.0000 CFS USE DIV. VOLUME - .00 AFA  
USE - FISH PROP. PLACE OF USE - TWN 21N RNG 22E SEC 06 TRACT LOT 01 AC  
DECREE NAME - DATE - TOTAL ACRES 0  
REMARKS -  
NON IRRIG USE - F/LEUVER TYPE FISH SCREEN.  
OTHER RIGHTS FOR SAME USE -  
PROOF DUE - PERMIT/DENIED - PROTESTED - HEARING - OLD NO. - 29513  
PROOF MADE - FLD EXAM - COND. OF APPROVAL -  
DIVERSION MEANS -

**201 ERMIV**



## ACTION

N OWNER LAST NAME - STATE OF IDAHO  
N ADDRESS LINE 1 - DEPT. OF FISH & GAME ADDRESS LINE 2 - P.O. BOX 25  
N CITY - BOISE STATE - ID ZIP CODE - 83720  
N SOURCE - SALMON RIVER TRIBUTARY OF - SNAKE RIVER  
N STAGE - LICENSE PRIORITY - 02-21-1961 COUNTY - LEMHI TOTAL DIV. RATE - 10.0000CFS  
N DIVERSION POINT - 06 21N 22E LOT 10  
N USE - FIRE PROTECTION USE DIV. RATE - 10.0000CFS  
N USE - FIRE PROTECTION PLACE OF USE - TWN 21N RNG 22E SEC 06 LOT 01  
N NON IRRIG USE - F/LEUVER TYPE FISH SCREEN.  
N OLD NO. - 29513

3/79

IDENT. NO. 75-2142

I D A H O   D E P A R T M E N T   O F   W A T E R   R E S O U R C E S

WATER RIGHT  
DATA ENTRY LOG

[illegible]



# WATER RIGHT ANALYSIS FORM

- DATA ENTRY -

Identification No. 29513 175-2142  
 Old No. New No.

## Record

1. Original Owner: State of Idaho

Present Owner: \_\_\_\_\_

2. Address: Dept. of Fish & Game, P.O. Box 25

3. City: Boise State: Id Zip: 83720

4. A. Source of Water: Salmon River

B. Tributary of: Snake River

5. A. Stage (A,P,L,D,S,J): L

B. Status (D,L,R,C,A,I,F - leave blank if valid):

C. Priority Date: 2-21-1961

D. County: 59

E. Total Diversion Rate: 10.

F. Total Diversion Volume:

G. Transfer/Amendment (P,T of A or blank):

H. Water District:

I. DLE/Carey Act (D,C or blank):

J. Right Basis (for adjudication claims A,B,C only):

	Tract	Sec.	Twp.	Rge.	Gov't Lot	Rediv.
6. A. Point of Diversion		<u>6</u>	<u>21N</u>	<u>22E</u>	<u>10</u>	

7. Period of Use, Use, Diversion Rate/Volume:

from \_\_\_\_\_ to \_\_\_\_\_ for F purposes. Amount 10.  
 (cfs or AC=FT/yr)

from \_\_\_\_\_ to \_\_\_\_\_ for \_\_\_\_\_ purposes. Amount \_\_\_\_\_

from \_\_\_\_\_ to \_\_\_\_\_ for \_\_\_\_\_ purposes. Amount \_\_\_\_\_

from \_\_\_\_\_ to \_\_\_\_\_ for \_\_\_\_\_ purposes. Amount \_\_\_\_\_

from \_\_\_\_\_ to \_\_\_\_\_ for \_\_\_\_\_ purposes. Amount \_\_\_\_\_

from \_\_\_\_\_ to \_\_\_\_\_ for \_\_\_\_\_ purposes. Amount \_\_\_\_\_

from \_\_\_\_\_ to \_\_\_\_\_ for \_\_\_\_\_ purposes. Amount \_\_\_\_\_

8. Use Code:  $\overline{f}$

[illegible]

9. A. Decree Name:

B. Decree Date:

10. Remarks: A.  
B.  
C.  
D.  
E.

11. Other Uses (Non-irrigation explanatory information):  
F/leaves type fish screen.

12. Other Rights for Same Use:

13. A. Proof Due Date:

B. Date Permit Approved or Denied:

C. Protested Date:

D. Hearing Date:

E. Old Number: 29513

F. Proof Made (P or blank):

G. Field Exam Made (P,R,F or blank):

H. Conditions of Approval: \_\_\_\_\_

14. Diversion Means (brief narrative):



October 10, 1962

RE: Permit No. 29513

John R. Woodworth  
Director  
Department of Fish and Game  
Building

Dear Mr. Woodworth:

Enclosed are the Certificate of Completion of Works and License  
and Certificate of Water Right on the above numbered permit.

Very truly yours,

GEO. H. CARTER  
State Reclamation Engineer  
By

(Mrs.) Edna P. Rule  
Chief Clerk

EPR:mf

Enc. license  
certificates

29513

STATE OF IDAHO  
DEPARTMENT OF RECLAMATION  
BOISE

REPORT OF ENGINEER

PERMIT NO. 29513

REPORT ON PROOF OF Completion of Works & Beneficial Use

Robert L. Salter, Acting Director  
Dept. of Fish and Game  
Boise, Idaho



R-22E.

T.  
21  
N.

PD

Screen site

6

5

U.S. HWY. NO. 93

Non Consumptive Use

Allow 10.0 cfs.

9-275  
January 1952

UNITED STATES  
DEPARTMENT OF THE INTERIOR  
GEOLOGICAL SURVEY  
WATER RESOURCES DIVISION

Date 9/22/62 DISCHARGE MEASUREMENT NOTES

Screen S-10

River at Salmon River at Salmon Falls

Angle coef- ficient	Dist. from initial point	Width	Depth	Observa- tion depth	Revo- lutions	Time in sec- onds	VELOCITY		Adjust- ed for hor. angle or	Area	Discharge
							At point	Mean in ver- tical			
	0	.75	2.6		70	48	2.5	1.92		.07	5.13
	.5	.75	2.6		60	48	2.72	2.74		1.95	5.34
					60	47	2.78				
	1.5	1	2.6		60	45	2.90	2.75		2.60	7.15
					50	42	2.60				
	2.5	1	2.6		60	41	3.19	3.01		2.60	7.83
					60	46	2.84				
	3.5	1	2.6		60	45	2.90	2.78		2.60	7.23
					50	41	2.60				
	4.5	1	2.55		60	47	2.78	2.63		2.55	6.71
					50	44	2.58				
	5.5	1	2.55		60	43	3.04	2.73		2.55	6.96
					50	45	2.42				
	6.5	1	2.55		60	44	2.97	2.81		2.55	7.16
					50	41	2.66				
	7.5	.82	2.55		60	45	2.90	2.78		2.14	5.95
					50	41	2.66				
	8.15	.33	2.55		50	48	2.28	2.03		.84	1.70
	8.15				40	49	1.79				
										56.16	

No. \_\_\_\_\_ of \_\_\_\_\_ Sheets. Comp. by \_\_\_\_\_ Chk. by \_\_\_\_\_

.0 .10 .20 .30 .40 .50 .60

29513

.75

## STATE OF IDAHO

## DEPARTMENT OF RECLAMATION

BOISE, IDAHO

## REPORT OF ENGINEER

Permit No. 29513

This proof is for Completion of Works &amp; Beneficial Use In Water District No. ....

1. Name of applicant Department of Fish and Game, Boise, Idaho

2. Source of water supply: Salmon River

3. Location of point of diversion: Is in the Lot 10 of Section 6

T. 21 N R. 22 E County of Lemhi

4. Describe works as they exist, giving dimensions and capacities of same: The leaver fish screen is constructed in an old established irrigation Canal that is 10' wide on bottom, 15' wide on top and 3 1/2' deep. The leaver is a Concrete structure 45' long 9 1/2' wide x 3 1/2' depth outside dimensions. Trash Rack on upper end and Screw gate 8' x 3'. The leavers are on a 23' support diagonally across structure leavers are at Right angle to support on upstream

5. Water is used for: operation of a leaver type fish screen

6. State whether or not water has been turned into works of diversion: yes

7. List legal subdivisions of lands to be irrigated. If proof is for beneficial use, give exact number of acres under cultivation in each forty-acre tract. (Describe manner and place of use if other than irrigation):

Lot 1, Sec. 6, T. 21 N., R. 22 E., B. M.

\* side and parallel to structure and stream flow on downside of leaver support. There is a 6" x 3" <sup>wide</sup> <sup>high</sup> <sup>Race</sup> sluiceway at lower end of leaver support so any fish might return to River.

The works is capable of allowing 60 cfs. to pass into Canal system. There is also a by pass canal around the leaver same size as canal that has a Screw Gate for Control.

(Submit map on attached plat, showing location and details of above description.)

8. What large stream would the water here appropriated finally reach? Snake River

Remarks: Mr. John Langenheder, Maint Foreman along.

Measured by Current Meter with a depth of 2.6'. The discharge of this water depth is 56.16 cfs.

This examination was made on the 22<sup>nd</sup> day of September, 1962

(Signed)

L. J. Johnson

Examiner.

29513



# INSTRUCTIONS TO EXAMINERS

1. Always carefully note the location of the point of diversion and accurately plat same.
2. When proof is for beneficial use, carefully check up the number of acres actually irrigated in each forty and accurately plat same.
3. Make a map showing the correct location of streams and ditches, and the irrigated lands, and any adjacent permanent landmarks, such as towns, lakes, large streams and public roads.
4. If any unusual conditions are discovered, make plain statement of them under remarks.
5. Always see the holder, if possible, and go over the whole ground with him and make your report only upon actual existing facts and conditions.
6. Give general characteristics of soils, topography, and crops raised.

RECEIVED  
OCT 3 1962

Department of Reclamation

Robert B. Salter, Acting  
Director, Dept. of Fish and Game  
Boise, Idaho  
Sept 18-2, 62  
Permit No. 29513

Completion of Works and  
Examination for Beneficial Use

County Lemhi

Sec. 6 T. 21N R. 22 E

Quantity: 10.0 cfs

Source: Salmon River

P.D.: Lot 10, Sec. 6, T. 21N. - R. 22E.

Use: Live Stock Grazing  
Cattle

Filed: Feb. 21, 1961

Due: March 2, 1963

Extension: -

Completion of Works: -

Other Rights: none stated

Clarence Rogers - Eng. -  
designated engineer

March 12, 1962

Re: Permit No. 29513

Robert L. Salter, Acting Director  
Dept. of Fish and Game  
Boise, Idaho

Gentlemen:

We acknowledge receipt of the depositions of holder and two witnesses, also affidavit of publication in the Recorder Herald, all submitted in proof of completion of works and beneficial use on Permit No.

Before final action is taken in the matter, the law requires that a field examination be made by an engineer from this department.

We cannot tell just when this examination will be made, but our field engineer will try and contact you at the time he makes the examination so that arrangements may be made to show him over the grounds.

Very truly yours,

GEO. N. CARTER  
State Reclamation Engineer

By:

(Mrs.) Edna P. Rule  
Chief Clerk

EPR:

29513

March 1, 1962

Re: Permit No. 29513  
Dept. of Fish and Game

Salmon Recorder-Herald  
Salmon, Idaho

Gentlemen:

Would you please mail an affidavit of publication to this office in connection with the Notice of Publication on the above numbered permit? The records of this office are not complete without such affidavit.

The Fish and Game Department have asked that we request two copies of the affidavit for their records also, and a statement of the cost of publication, as payment is to be made by them.

Very truly yours,

GEO. N. CARTER  
State Reclamation Engineer

By:

(Mrs.) Edna P. Rule  
Chief Clerk

EPR:ew



# STATE OF IDAHO

ROBERT E. SMYLLIE  
GOVERNOR

## COMMISSION

GLENN STANGER IDAHO FALLS  
R. J. HOLMES TWIN FALLS  
ARLIE JOHNSON BOISE  
TOM FELTON MOSCOW  
FRANK CULLEN COEUR D'ALENE

## Department of Fish and Game

518 FRONT STREET BOISE, IDAHO

February 26, 1962

Columbia River Program  
Fish Screen S-12

Mr. Geo. N. Carter  
State Reclamation Engineer  
State House  
Boise, Idaho

Dear Sir:

Enclosed herewith are depositions of holder and witnesses in the matter of Proof of Application of Water to Beneficial Use and Completion of Works, Permit No. 29513.

Very truly yours,

*Robert L. Salter*  
Robert L. Salter  
Acting Director

Enclosures



29513

STATE OF IDAHO  
DEPARTMENT OF RECLAMATION  
BOISE, IDAHO

Department of Reclamation

Permit No. 29513

Proof of Application of Water to Beneficial Use

Deposition of Holder and Completion of Works

Ques. 1. State your name, residence, occupation and postoffice address.

Ans. Robert L. Salter, Boise, Acting Director, Idaho Department of Fish and Game,  
acting for and on behalf of the State of Idaho, Department of Fish and Game.

Ques. 2. If acting in behalf of corporation, state its name, principal place of business (if a foreign corporation, give name of postoffice of statutory agent), your position with reference to same, and your authority for appearing in its behalf.

Ans.

Ques. 3. State number and date of permit, and date of priority you propose to establish under the permit.

Ans. Permit No. 29513, dated March 2, 1961, date of priority is March 2, 1961.

Ques. 4. State source of water supply and give exact location of point of diversion.

Ans. Source of water supply is the Salmon River. Point of diversion is S. 25°0' W.  
1910 feet distant from the northeast corner of Sec. 6, T. 21 N., R. 22 E., B.M., and  
is located in Lot 10 of said Section 6.

Ques. 5. Describe your works of diversion, and state amount of water they are capable of conveying from point of diversion to place of use, and give name of canal or ditch or other works by which water is conducted to such place of use. If a well, state depth of well, depth and size of casing and depth to water. If pump is used, state discharge of pump and tell how it was measured or determined. If sprinkler irrigation, give number and size of nozzles and operating pressure.

Ans. The diversion works are those of the Wheeler Ditch, being a headgate 10 feet in  
width and 7 feet in height and capable of diverting the 75 c.f.s., or more, and  
capable of carriage of 75 c.f.s.

Ques. 6. State for what purpose water is used and describe place of use. (If for irrigation, name each subdivision in which used, and number of acres in each subdivision that have actually been irrigated with said water.) State whether cultivated or natural meadow land and the nature of all improvements which have been made as a direct result of said use.

Ans. The water is used to operate a leuver type fish screen located in Lot 1 of  
Sec. 6, T. 21 N., R. 22 E., B.M. Water use is non-consumptive.

Ques. 6-a If this is a ground water permit, give name and address of person that drilled the well.

Ans.

Ques. 7. If for other than irrigation purposes; state how applied, amount of horse power generated, etc.

Ans. The permit water flows through the Wheeler Ditch to the leuwer type fish screen at which point it is diverted back into the Salmon River, carrying fish from the Wheeler Ditch back into Salmon River.

Ques. 8. What is the minimum amount of water required for the purpose specified above?

Ans. 10 c.f.s.

Ques. 9. If you are not the person or representative of the corporation to whom above mentioned permit was originally issued, please state how ownership was acquired by present holder.

Ans.

Ques. 10. State when, how, in what amount and to what extent the water diverted under above mentioned permit has been used.

Ans. Waters in the additional amount of 10 c.f.s. have been diverted through the Wheeler Ditch during the irrigation season of 1961 and have been used to operate a leuwer type fish screen.

Ques. 11. State when, how, in what amount and to what extent waters other than those diverted under the above mentioned permit have been diverted and applied to beneficial use upon the lands herein described. Give full particulars regarding such other appropriations and rights claimed thereunder.

Ans. The waters of the Wheeler Canal have been diverted from Salmon River through said canal for approximately 40 or more years and are used for irrigation. The water so diverted appears to be 65 c.f.s., more or less.

STATE OF IDAHO, Department of Fish and Game

(Sign) By

*Robert L. Salter*

Robert L. Salter, Acting Director

I hereby certify that the foregoing testimony was read to the above subscribed before its signing, that I believe him to be the person he represents himself to be, and that said testimony was subscribed and sworn to before me, at my office in Boise, County of Ada,

State of Idaho, on this 26th day of February, A. D. 1962.

My commission expires

*June 1, 1962*

STATE OF IDAHO  
DEPARTMENT OF RECLAMATION  
BOISE, IDAHO

PERMIT NO. 29513

**Proof of Application of Water to Beneficial Use**

**Deposition of Witness<sup>and</sup> Completion of Works**

The deposition of two witnesses, on this form, taken separately, required in each case.

Ques. 1. State your name, age, residence, occupation and postoffice address.

Ans. T. D. Biladeau, of legal age, residing at Boise, employed by the Idaho  
Department of Fish and Game, 518 Front Street, Boise, Idaho.

Ques. 2. Are you acquainted with Robert L. Salter, the acting holder of Permit No. 29513? How long have you known him and where does he reside?

Ans. I have known him for 12 years. He resides at Boise, Idaho.

Ques. 3. Have you read or heard read said Permit No. 29513, and are you familiar with its provisions and conditions?

Ans. Yes

Ques. 4. State source of water supply, place of diversion, and describe works for conveying water from point of diversion to place of use.

Ans. Water is diverted from Salmon River in Lot 10, Sec. 6, T. 21 N., R. 22 E., B.M.  
and flows through the Wheeler Canal to place of use in Lot 1 of said Section 6.

Ques. 5. How many second feet of water do you estimate said works will safely conduct to place of use, and how much water have you seen being so conveyed?

Ans. The canal will safely conduct water in the amount of 75 c.f.s. and may conduct more. I have observed 75 c.f.s. water flow.

Ques. 6. State for what purpose water is used and at what place. (If for irrigation, give each subdivision in which water has been used and number of acres irrigated in each subdivision.) State whether cultivated or natural meadow land and the nature of all improvements which have been made as a direct result of said use.

Ans. Water is used to operate a leuver type fish screen located in Lot 1 of  
Sec. 6, T. 21 N., R. 22 E., B.M.



Ques. 7. If for power or other purposes than irrigation, state how water has been applied and to what extent.

Ans. \_\_\_\_\_  
\_\_\_\_\_  
\_\_\_\_\_

Ques. 8. If for irrigation, state character of land that has been reclaimed, and give your estimate of the amount of water required for its profitable cultivation.

Ans. \_\_\_\_\_  
\_\_\_\_\_

Ques. 9. Have you any interest in the works, water or lands above mentioned? If so, in what way and to what extent?

Ans. No \_\_\_\_\_  
\_\_\_\_\_

Ques. 10. State when, how, in what amount and to what extent you have witnessed the application to beneficial use of water diverted under said permit.

Ans. Water in the additional amount of 10 c.f.s. was diverted into the Wheeler Canal during the irrigation season of 1961 and was used to operate a leuver type fish screen. \_\_\_\_\_

\_\_\_\_\_  
(Signed) J. E. Liles  
T. D. Liledeau

I hereby certify that the foregoing testimony was read to the above subscriber before its signing, that I believe him to be the person he represents himself to be, and that said testimony was subscribed and sworn to before me in Boise, County of Ada, State of Idaho, on this 26th day of February, A. D. 1962.

\_\_\_\_\_  
Notary Public.

My commission expires June 1, 1962.

STATE OF IDAHO  
DEPARTMENT OF RECLAMATION  
BOISE, IDAHO

PERMIT NO. 29513

**Proof of Application of Water to Beneficial Use**  
**Deposition of Witness and Completion of Works**

The deposition of two witnesses, on this form, taken separately, required in each case.

Ques. 1. State your name, age, residence, occupation and postoffice address.

Ans. Ivol Sies, of legal age, residing at Boise, employed by the Idaho Department of Fish and Game, 518 Front Street, Boise, Idaho.

Ques. 2. Are you acquainted with Robert L. Salter, the acting holder of Permit No. 29513? How long have you known him and where does he reside?

Ans. I have known him for 12 years. He resides at Boise, Idaho.

Ques. 3. Have you read or heard read said Permit No. 29513, and are you familiar with its provisions and conditions?

Ans. Yes

Ques. 4. State source of water supply, place of diversion, and describe works for conveying water from point of diversion to place of use.

Ans. Water is diverted from Salmon River in Lot 10, Sec. 6, T. 21 N., R. 22 E., B.M. and flows through the Wheeler Canal to place of use in Lot 1 of said Section 6.

Ques. 5. How many second feet of water do you estimate said works will safely conduct to place of use, and how much water have you seen being so conveyed?

Ans. The canal will safely conduct water in the amount of 75 c.f.s. and may conduct more. I have observed 75 c.f.s. water flow.

Ques. 6. State for what purpose water is used and at what place. (If for irrigation, give each subdivision in which water has been used and number of acres irrigated in each subdivision.) State whether cultivated or natural meadow land and the nature of all improvements which have been made as a direct result of said use.

Ans. Water is used to operate a leuver type fish screen located in Lot 1 of Sec. 6, Township 21 North, Range 22 East, Boise, Meridian.

Ques. 7. If for power or other purposes than irrigation, state how water has been applied and to what extent.

Ans. \_\_\_\_\_

Ques. 8. If for irrigation, state character of land that has been reclaimed, and give your estimate of the amount of water required for its profitable cultivation.

Ans. \_\_\_\_\_

Ques. 9. Have you any interest in the works, water or lands above mentioned? If so, in what way and to what extent?

Ans. No \_\_\_\_\_

Ques. 10. State when, how, in what amount and to what extent you have witnessed the application to beneficial use of water diverted under said permit.

Ans. Water in the additional amount of 10 c.f.s. was diverted into the Wheeler Canal during the irrigation season of 1961 and was used to operate a leuwer type fish screen.

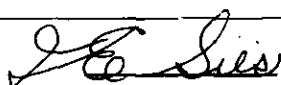

(Signed)

I hereby certify that the foregoing testimony was read to the above subscriber before its signing, that I believe him to be the person he represents himself to be, and that said testimony was subscribed and sworn to before me in Boise, County of Ada, State of Idaho, on this 26th day of February, A. D. 1962.



Notary Public.

My commission expires June 1, 1962.

STATE OF IDAHO } ss.  
County of Lemhi }

That the Notice of Proof, Permit #29513

printed copy of which is attached to the margin hereof, has been and was correctly printed and published in the regular and entire issue of every number of said newspaper and not in any supplement thereof or thereto for four (4) consecutive issues, commencing with the issue dated ~~February~~ Jan. 25 1962 and ending with the issue dated February 15 1962

Subscribed and sworn to before me, this

day of March 1962

Notary Public for the State of Idaho,  
Residing at Salmon, Idaho.

Publication Fee \$ 25.08

29.5/3



February 5, 1962

Re: Permit No. 29513  
Dept. of Fish & Game

Salmon-Recorder Herald  
Salmon, Idaho

Gentlemen:

On January 18th we mailed you a Notice of Publication on the above numbered permit, in the name of Dept. of Fish and Game, requesting a copy for checking purposes.

To date we have not received such copy and ask that one be mailed to this office as soon as possible.

Very truly yours,

GEO. N. CARTER  
State Reclamation Engineer

By:

H. PETRI  
Water Rights Clerk

HP:cw

January 18, 1962

Re: Permit No. 29513

Mr. Ross Leonard, Director,  
State of Idaho,  
Department of Fish and Game  
518 Front St.,  
Boise, Idaho.

Dear Mr. Leonard:

This acknowledges the Notice of Proof of Completion of Works and Application of Water to Beneficial Use under Permit No. 29513. The proofs are to be made at 10:00 o'clock A.M., on the 26th day of February, 1962, before Anne Epaldi, 518 Front St., Boise, Idaho, Notary Public.

As of this date we have mailed the Notice to the Salmon Recorder-Herald Salmon, Idaho, with instructions to publish it once a week for four consecutive weeks prior to the date set for final proof then mail the affidavit of publication and statement of costs to you.

It is important that the enclosed depositions be executed by you and two disinterested witnesses who are familiar with the terms of the permit and the work done thereunder, at the place, on the date, and at the time and before the Notary, as advertised. It is very important and necessary that each question be answered in detail.

In returning the depositions to this office, be sure that all copies have been signed, the Notary's seal has been placed on each and that all depositions, (holder and two witnesses) are being returned. Also be sure to enclose the Affidavit of Publication.

Very truly yours,

GEO. N. CARTER  
State Reclamation Engineer

By:

(Mrs.) Edna P. Rule  
Chief Clerk

Enc.  
EPR:pmk  
cc: Notary

29513

1200  
6-28-61

STATE OF IDAHO  
DEPARTMENT OF RECLAMATION  
Boise, Idaho

Re: Permit No. 29513  
State of Idaho  
Department of Fish and Game

Date: Jan. 18, 1962

Salmon Recorder-Herald,  
Salmon, Idaho.

Gentlemen:

Enclosed you will find notice for publication, once a week for four consecutive weeks prior to **February 26, 1962** the date set for proof;

the expense of the publication is to be paid by the applicant

**State of Idaho, Department of Fish and Game of 518 Front St., Boise, Idaho**

to whom you should furnish proof of publication on or prior to the date set for proof.

Please acknowledge receipt of this notice and furnish this office with a copy or tear sheet of the first publication.\*\*

Very truly yours,



GEO. N. CARTER  
State Reclamation Engineer

\*\* If the first copy is not received in this office for checking purposes and errors appear in subsequent issues, it is possible that re-publication of corrected copy will be at your own expense.

**P.S. Please submit two certified copies of the publication costs to the Department of Fish and Game.**

Encl.

29513

# STATE OF IDAHO

ROBERT C. SMITH  
GOVERNOR

COMMISSION  
GLENN STANGER IDAHO FALLS  
R. J. HOLMES TWIN FALLS  
ARLIE JOHNSON BOISE  
TOM FELTON MOSCOW  
FRANK CULLEN COEUR D'ALENE

*Department of Fish and Game*

518 FRONT STREET BOISE, IDAHO

ROSS LEONARD  
DIRECTOR

January 12, 1962

JAN 15 1962

Department of Reclamation

Columbia River Program  
Fish Screen S-12

Mr. Geo. N. Carter  
State Reclamation Engineer  
State House  
Boise, Idaho

Dear Mr. Carter:

Enclosed herewith is form 36-A, notice of proof of completion of works and application of water to beneficial use, in connection with Permit No. 29513.

The enclosed notice should replace the notice of proof of completion of works recently forwarded to your office.

Very truly yours,

*Ross Leonard*  
Ross Leonard  
Director

Enclosure

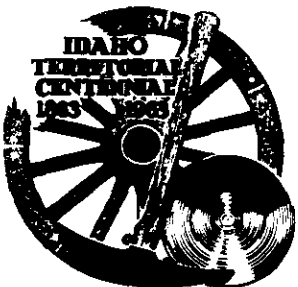

29513

NOTICE OF PROOF OF COMPLETION OF WORKS  
and  
APPLICATION OF WATER TO BENEFICIAL USE

NOTICE is hereby given that at 10:00 A. M., on the 26th day of February 1962, at Boise, County of Ada, State of Idaho, before Anne Epeldi, Notary Public, at (address) 518 Front Street, Boise, Idaho, proof will be submitted of the completion of works for the diversion of 10 c.f.s. cubic feet per second of the waters of Salmon River, and of the application to beneficial use of said water, in accordance with the terms and conditions of Permit No. 29513, heretofore issued by the Department of Reclamation of the State of Idaho.

1. The name and postoffice address of the person or corporation holding said permit is: State of Idaho, Department of Fish and Game, 518 Front St., Boise, Idaho
2. Said works of diversion will be fully completed on the date set for such completion and the amount of water which said works are capable of conveying to the place of use is ten (10) cubic feet per second.
3. The use to which said water has been applied is operation of leaver type fish screen purposes, and the amount applied to beneficial use is ten (10) cubic feet per second.
4. The point of diversion of said water is South 25°00' West 1910 feet distant from the northeast corner of Section 6, Township 21 North, Range 22 East, Boise Meridian, and is in Lot 10 of said Section 6.
5. The place where said water is used is within Lot 1, Section 6, Township 21 North, Range 22 East, Boise Meridian.

6. The date of priority which said user is prepared to establish is March 2, 1961. Total Feb 21 acres

G. H. Carter

State Reclamation Engineer

29513



E200  
6-28-61

STATE OF IDAHO  
DEPARTMENT OF RECLAMATION

Boise, Idaho

Re: Permit No. 29513  
State of Idaho  
Department of Fish and Game

Date: Jan. 9, 1962

Salmon Recorder-Herald  
Salmon, Idaho.

Gentlemen:

Enclosed you will find notice for publication, once a week for four consecutive weeks prior to **February 19, 1962** the date set for proof;

the expense of the publication is to be paid by the applicant

State of Idaho, Department of Fish & Game of 518 Front St., Boise, Idaho

to whom you should furnish proof of publication on or prior to the date set for proof.

Please acknowledge receipt of this notice and furnish this office with a copy or tear sheet of the first publication.\*\*

Very truly yours,



GEO. N. CARTER  
State Reclamation Engineer

\*\* If the first copy is not received in this office for checking purposes and errors appear in subsequent issues, it is possible that re-publication of corrected copy will be at your own expense.

P.S. Please submit two certified copies of the publication costs to the Department of Fish and Game.

29513

# STATE OF IDAHO

ROBERT E. SMYLLIE  
GOVERNOR

COMMISSION  
GLENN STANGER IDAHO FALLS  
R. J. HOLMES TWIN FALLS  
ARLIE JOHNSON BOISE  
TOM FELTON MOSCOW  
FRANK CULLEN COEUR D'ALENE

*Department of Fish and Game*

518 FRONT STREET BOISE, IDAHO

ROSS LEONARD  
DIRECTOR

January 5, 1962

RECEIVED  
JAN 11 1962

Department of Reclamation

Columbia River Program  
Fish Screen S-12

Mr. Geo. N. Carter  
State Reclamation Engineer  
State House  
Boise, Idaho

Dear Sir:

Enclosed herewith is notice for publication of completion of works, as well as authorization to have said notice published in The Salmon Recorder-Herald, in connection with Permit No. 29513.

Very truly yours,

*Ross Leonard*  
Ross Leonard  
Director

Enclosure

P. S. Please request the publisher of the Salmon Recorder-Herald to submit two certified copies of the publication costs to the Department of Fish and Game.



29513

# Notice for Publication

## COMPLETION OF WORKS

Notice is hereby given that at 10:00 A.M., on the 19th day of February, 1962, at 518 Front St., Boise, County of Ada, State of Idaho, before Anne Epeldi, a Notary Public. proof will be submitted of the completion of works for the diversion of 10 cubic feet per second of the waters of Salmon River in accordance with the terms and conditions of a certain permit heretofore issued by the State Reclamation Engineer of the State of Idaho.

1. The name of the person or corporation holding said permit is State of Idaho,  
Department of Fish and Game.

2. The postoffice address of such person or principal place of business of such corporation is 518 Front Street, Boise, County of Ada, State of Idaho.

3. The number of such permit is 29513, and the date set for the completion of such work is ~~February 2, 1962~~ March 2, 1962

4. Said water is to be used for operation of a leuwer type fish screen. purposes.

5. Said works of diversion will be fully completed on the date set for such completion, and the amount of water which said works are capable of conducting to the place of intended use, in accordance with the plans accompanying the application for such permit, is 10 cubic feet per second.

6. The amount of lands for which said water is available is none acres, particularly described as follows:  
Water use is non-consumptive.

GEO. N. CARTER

**STATE RECLAMATION ENGINEER**

29513

# Notice for Publication

## COMPLETION OF WORKS

Notice is hereby given that at 10:00 A.M., on the 19th day of February, 1962, at 518 Front St., Boise, County of Ada, State of Idaho,

before Anne Epeldi, a Notary Public. proof will be submitted of the completion of works for the diversion of 10 ☒ cubic feet per second of the waters of Salmon River

in accordance with the terms and conditions of a certain permit heretofore issued by the State Reclamation Engineer of the State of Idaho.

1. The name of the person or corporation holding said permit is State of Idaho,  
Department of Fish and Game

2. The postoffice address of such person or principal place of business of such corporation is 518 Front Street, Boise, County of Ada, State of Idaho.

3. The number of such permit is 29513, and the date set for the completion of such work is February 2, 1962

4. Said water is to be used for operation of a lever type fish screen. purposes.

5. Said works of diversion will be fully completed on the date set for such completion, and the amount of water which said works are capable of conducting to the place of intended use, in accordance with the plans accompanying the application for such permit, is 10 cubic feet per second.

6. The amount of lands for which said water is available is none acres, particularly described as follows:  
Water use is non-consumptive.

*Leo H. Carter*

STATE RECLAMATION ENGINEER

29513

RECEIVED  
JAN 8 1962  
Department of Reclamation

NOTICE TO ACCOMPANY THIS LETTER MUST BE MADE IN DUPLICATE

(Date) January 5, 1962  
(P. O.) 518 Front Street, Boise, Idaho

TO THE STATE RECLAMATION ENGINEER:

Boise, Idaho

Dear Sir:

You are hereby authorized to have the attached notice published at my expense in the  
Salmon Recorder-Herald of Salmon, Idaho published in  
the county in which the works are situated.

STATE OF IDAHO, Department of Fish and Game  
By Ross Leonard  
Ross Leonard, Director

(In case of canals or other works designed to divert and carry more than 50 cubic feet of water per second, the following certificate must be signed by a well known and competent engineer.)

I hereby certify that the facts set forth in the attached notice are true.

\_\_\_\_\_  
Engineer.

29513



**State of Idaho**  
**DEPARTMENT OF RECLAMATION**  
**BOISE**

**INSTRUCTIONS**

**Re: Permit 29513**

**PROOF OF COMPLETION OF WORKS**

**Dept. of Fish and Game**  
**Boise, Idaho**

Boise, Idaho,

**Jan. 3, 1962**

Dear Sir:—

I enclose herewith blank form upon which to give notice that you are prepared and desire to submit proof of completion of works under your permit No. 29513.

This form should be filled out and mailed to the Department of Reclamation, at least 60 days before the date upon which proof is to be submitted, which proof **MUST** be on or before March 2, 1962. Upon receipt of the blank properly filled out, notice of publication will be sent to the paper direct from this office, which notice must be published a period of four weeks prior to the date of proof.

The proof may be submitted at any place convenient to you and two witnesses, where there is a notary public or other officer authorized to administer oaths.

The certificate that shall be issued under this proof does not give you a perpetual right to the use of the water for which application is made, as it only confirms the completion of the works of a capacity to divert and convey to the place of intended use a certain amount of water. The law requires that another proof be submitted when the water has been fully applied to a beneficial use, at which time license is issued for the amount of water actually in use. Information in regard to this last proof will be furnished on request.

Very truly yours,

\_\_\_\_\_  
State Reclamation Engineer

29513

March 15, 1961

Re: Permit No. 29513

Mr. Ross Leonard, Director,  
Department of Fish and Game,  
State of Idaho,  
518 Front St.,  
Boise, Idaho.

Dear Mr. Leonard:

We enclose Permit No. 29513 in which we direct  
your attention to the limitations and conditions as given  
on the fourth page under approval of the State Reclamation  
Engineer.

Very truly yours,

GEO. N. CARTER  
State Reclamation Engineer  
By

(Mrs.) Edna P. Rule  
Chief Clerk

Encl.  
EPR:pmk

29513

State of Idaho Dept of Fish & Game

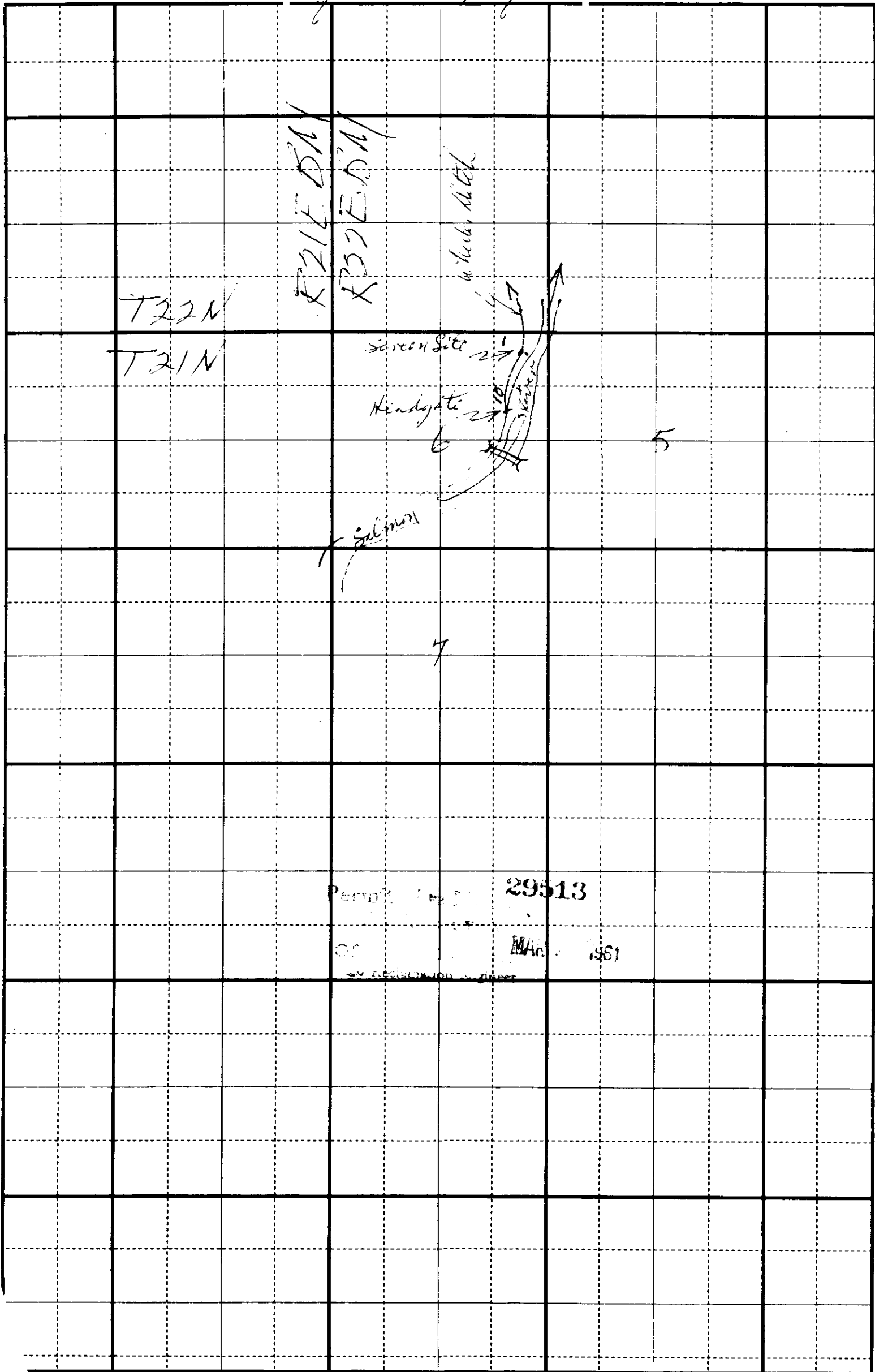

RECEIVED  
FEB 21 1961

**STATE OF IDAHO**

ROBERT E. SMYLYE  
GOVERNOR

Department of Reclamation

*Department of Fish and Game*

COMMISSION  
GLENN STANGER IDAHO FALLS  
R. J. HOLMES TWIN FALLS  
ARLIE JOHNSON BOISE  
TOM FELTON MOSCOW  
FRANK CULLEN COEUR D'ALENE

ROSS LEONARD  
DIRECTOR

February 20, 1961

Columbia River Project  
Fish Screen Installation

Mr. Geo. N. Carter  
State Reclamation Engineer  
State House  
Boise, Idaho

Dear Sir:

Enclosed herewith is an application for permit to appropriate  
the public waters of the State of Idaho.

Very truly yours,

*Ross Leonard*  
Ross Leonard, Director

Enclosure

29513

29513

(NOT TO SCALE)

Call 1 by Mass Ground Screen

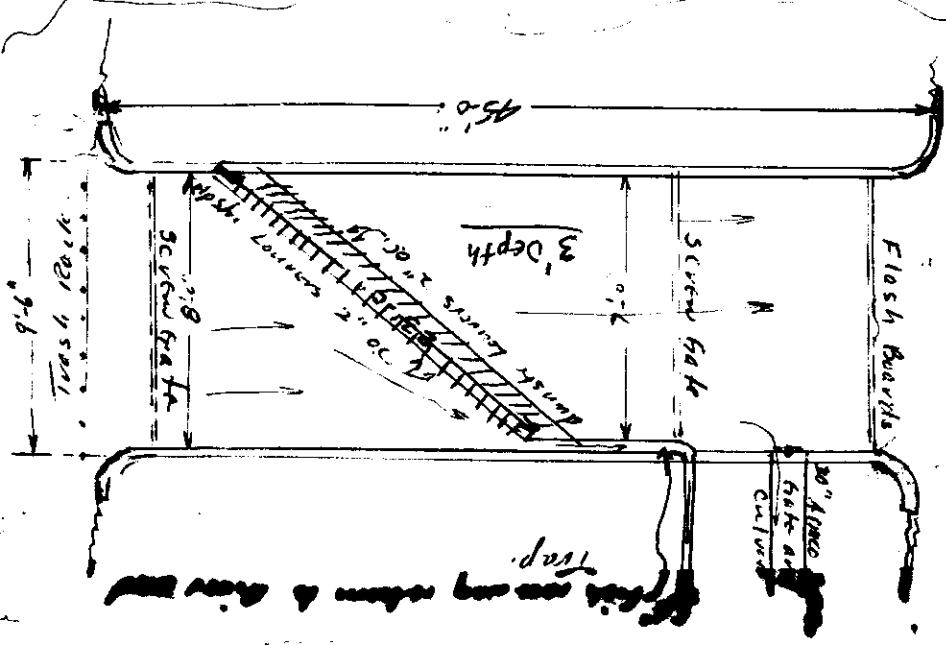

**NOTICE OF PROOF OF COM-  
PLETION OF WORKS**

**and  
APPLICATION OF WATER TO  
BENEFICIAL USE**

NOTICE is hereby given that at 10:00 A. M., on the 26th day of February, 1962, at Boise, County of Ada, State of Idaho, before Anne Epeldi, Notary Public, at 518 Front Street, Boise, Idaho, proof will be submitted of the completion of works for the diversion of 10 c. f. s. cubic feet per second of the waters of Salmon River, and of the application to beneficial use of said water, in accordance with the terms and conditions of Permit No. 29513, heretofore issued by the Department of Reclamation of the State of Idaho.

1. The name and postoffice address of the person or corporation holding said permit is: State of Idaho, Department of Fish and Game, 518 Front St., Boise, Idaho.

2. Said works of diversion will be fully completed on the date set for such completion and the amount of water which said works are capable of conveying to the place of use is ten (10) cubic feet per second.

3. The use to which said water has been applied is operation of leuwer type fish screen purposes, and the amount applied to beneficial use is ten (10) cubic feet per second.

4. The point of diversion of said water is South 25°00' West 1910 feet distant from the northeast corner of Section 6, Township 21 North, Range 22 East, Boise Meridian, and is in Lot 10 of said Section 6.

5. The place where said water is used is within Lot 1, Section 6, Township 21 North, Range 22 East, Boise Meridian.

5. The date of priority which said user is prepared to establish is February 21, 1961.

GEO. N. CARTER

State Reclamation Engineer  
No. 249 1-25 to 2-15 4 to

29513

**Do You Want**