

17076

Affidavit of Publication

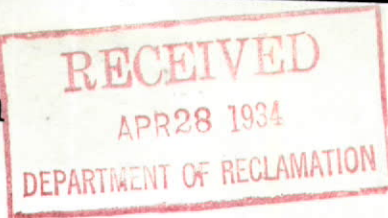

State of Idaho, }
County of Lemhi } ss.

RALPH B. KNEPPER, being duly sworn, upon oath deposes and says: I am the printer, publisher, and sole proprietor of the RECORDER HERALD, a newspaper published weekly at Salmon, Lemhi County, Idaho, and of general circulation therein.

NOTICE FOR PUBLICATION

Notice of Proof Application of Water to Beneficial Use.

Notice is hereby given that at 10:00 a. m. on the 26th day of April, 1934, at Salmon, County of Lemhi, State of Idaho, before W. W. Simmonds, Clerk of the District Court, proof will be submitted of the application to beneficial use of ten cubic feet per second of the waters of North Fork Salmon River in accordance with the terms and conditions of Permit No. 17076 heretofore issued by the Commissioner of Reclamation of the State of Idaho.

The name and postoffice address of the person or corporation holding said permit are Amos D. Burrow and Roy L. Shaw, Gibbonsville, Idaho.

The use to which said water has been applied is Mining, Milling or Power.

The amount applied to beneficial use is ten cubic feet per second.

The place where said water is used: Sundown Placer, 2½ miles south of confluence of Hammerien Creek and North Fork Salmon River.

The name of the canal or ditch or other works by which said water is conducted to such place of use is Sundown Placer Ditch.

The right to take water from such works is based upon Permit No. 17076.

The source of supply from which such water is diverted is North Fork Salmon River.

The date of the priority which said user is prepared to establish is April 20, 1929.

R. W. FARIS,
Commissioner of Reclamation.
Mch. 7 to 28—4t.

Publication Fee \$ 10.75

That the Notice of Proof Application of Water to Beneficial Use a true printed copy of which is attached to the margin hereof, has been and was correctly printed and published in the regular and entire issue of every number of said newspaper and not in any supplement thereof or thereto for four consecutive issues, commencing with the issue dated March 7, 1934 and ending with the issue dated March 28, 1934.

Ralph B. Knepper

before me, this 26th day of April, 1934

James A. Gordon

Notary Public for the State of Idaho,
Residing at Salmon, Idaho.

17076

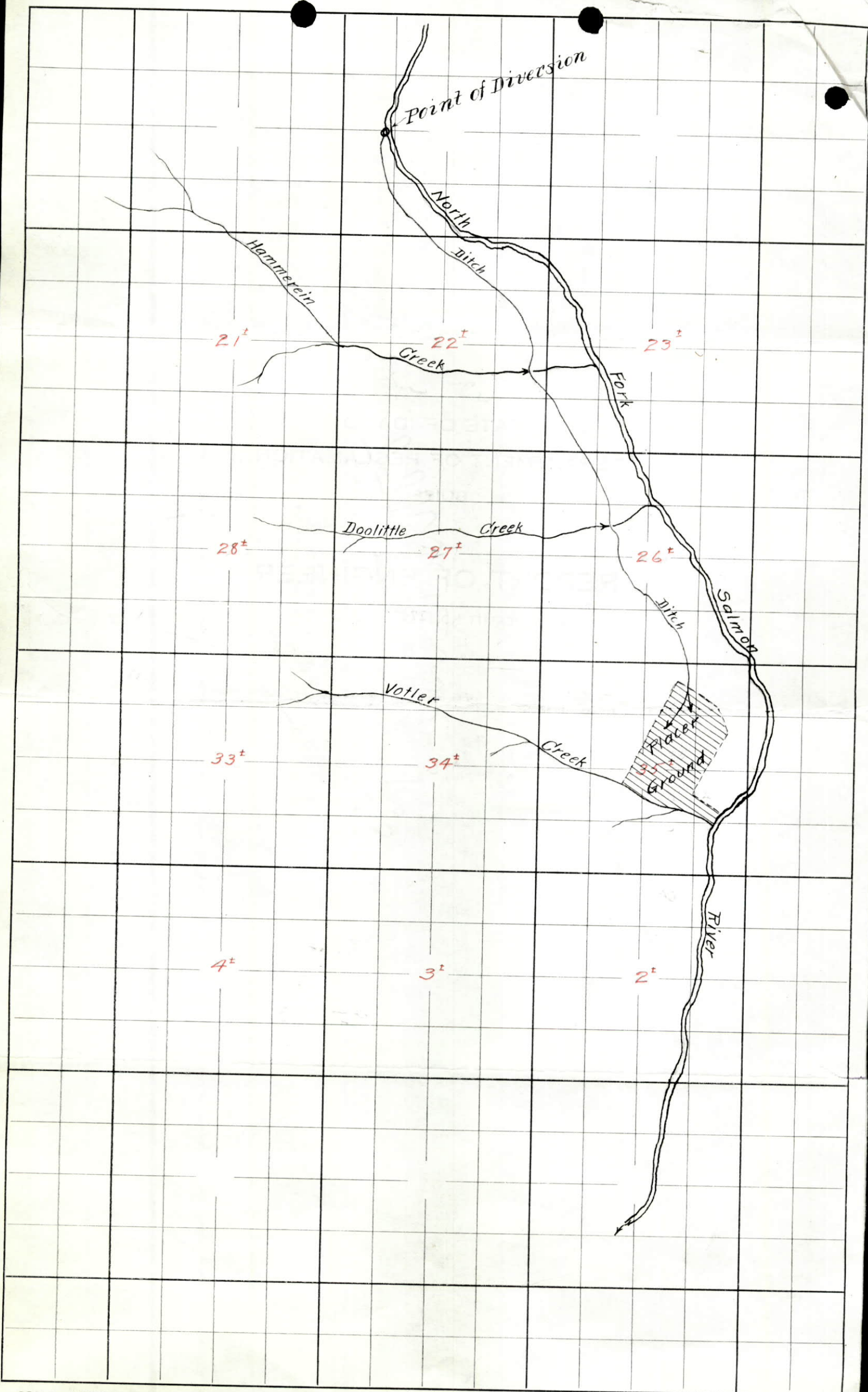

Name of Applicant: - PERCY ANDERSON.

17076

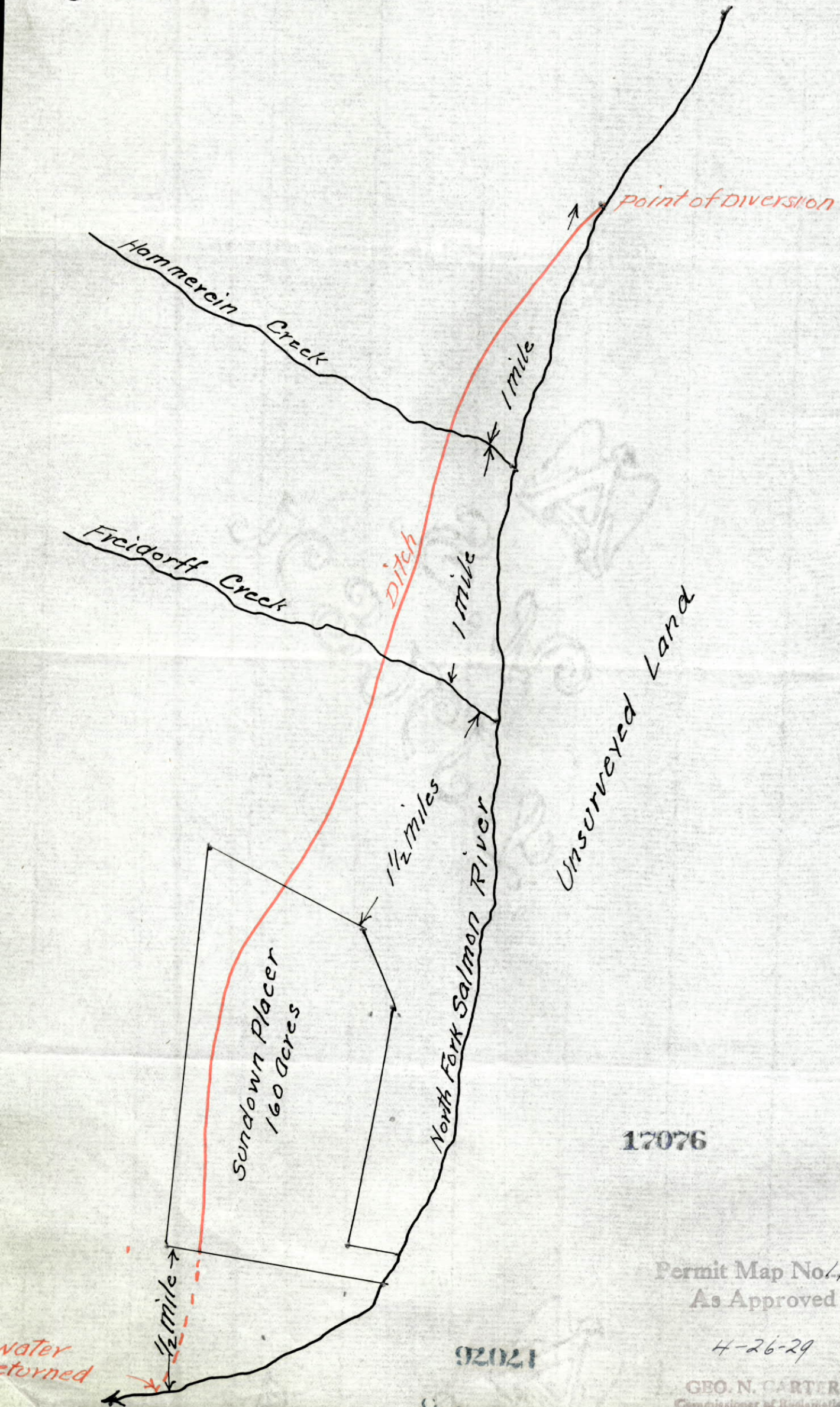

17076

Permit Map No. 17076
As Approved

4-26-29

GEO. N. CARTER
Commissioner of Reclamation

92021

INTER-DEPARTMENT MEMO — 1

FROM *Glen*

DATE *11-7-84*

TO *File*

SUBJECT *P.d. & Pl. u. determined from
quad sheets & field exam.*



SIGNATURE

State of Idaho
License and Certificate of Water Right

Water License No. 17076

Amount 10 Sec. Ft.

Water District No.

Priority April 20, 1929

THIS IS TO CERTIFY that PERCY ANDERSON of Salmon, Idaho, made application for a permit to appropriate the public waters of the State of Idaho, dated April 20, 19 29 ; that Permit No. 17076 was issued under said application; that Certificate of Completion of works, with a carrying capacity of 10 second feet, was issued thereunder on April 12, 19 33, showing that said works were completed on the 26th day of April, 19 32 ; and that on the 26th day of April, 19 34 ,

A. D. BURROW, Assignee

of Gibbonsville, State of Idaho, made proof to the satisfaction of the Commissioner of Reclamation of Idaho, of the right to use the waters of North Fork Salmon River, a tributary of Salmon River, for the purpose of mining and milling, under Use Permit No. 17076 of the Commissioner of Reclamation and that said right to the use of said waters has been perfected in accordance with the laws of Idaho, and is hereby confirmed by the Commissioner of Reclamation of Idaho and entered of record in Volume 7 of Licenses, at page 3823, on the 21st day of March, 19 36 ;

The right hereby confirmed dates from April 20, 19 29 ;

The Point of Diversion is located Approx. 1 mile above confluence of Hammerin Creek & North Fork Salmon River (Unsurveyed land) / Lemhi County.

That the amount of water to which such right is entitled and hereby confirmed, for the purposes aforesaid, is limited to an amount actually needed and beneficially used for said purposes, and shall not exceed 10 cubic feet per second.

Description and location of use: On Applicant's placer mining claims on Salmon River.

| Twp. | Range | Sec. | Forty-acre Tract | No. Acres Described in Permit | No. Acres Actually Irrigated |
|------|-------|------|------------------|-------------------------------|------------------------------|
| | | | | | |

The right to the use of the water aforesaid hereby confirmed is restricted to the lands or place of use herein described, as provided by the laws of Idaho.

WITNESS the seal and signature of the Commissioner of Reclamation, affixed at Boise, Idaho, this 21st day of March, 19 36.

R. W. FARIS
Commissioner of Reclamation

(SEAL)

74 2250
75-2184

APPLICATION FOR PERMIT TO APPROPRIATE THE PUBLIC WATERS OF THE STATE OF IDAHO

~~73-2128~~
74-2349

Application No. 24079
Permit No. 17076
District No.

1. Name of Applicant: Percy Anderson,

Postoffice address: Salmon, Idaho, County: Lemhi, State: Idaho

I. If applicant is a corporation, give:

- (a) Date and place of incorporation:
- (b) Amount of capital stock:
- (c) Amount paid in:
- (d) Names and addresses of directors:

II. The financial resources of the applicant are:

- (a) Cash on hand:
- (b) Treasury stock:
- (c) Bonds to be issued:
- (d) Other resources:

2. Quantity of water claimed: Ten cubic feet per second.

3. Source of water supply: North Fork Salmon River which is a tributary of Salmon River

4. Location of point of diversion: On unsurveyed land, ^{one mile above the} ~~feet distant from the~~ confluence of
Hammerein Creek and North Fork of the Salmon River
corner of Section , T. , R. , B. M., and is in the
of Section , T. , R. , B. M., County of Lemhi.

5. Water is to be used for: Mining, milling or power

6. If for mining, milling, power or manufacturing purposes, give:

(a) Point of use of water: On the Sun- ^{down placer claim, 3½ miles below the point} ~~feet distant from~~ corner of Section
of diversion.
T. , R. , B. M., in the of Section , T. , R. , B. M.

(b) Amount of power generated: 20 H. P., under 50 feet head.

(c) Water is to be returned to North Fork Salmon River ~~at a point~~ one-half mile below the Sun- ~~feet~~
down Placer Claim, on unsurveyed land.
distant from the corner of Section , T. , R. , B. M., in the
of Section , T. , R. , B. M.

7. Estimated cost of works: \$ 5000.00

8. Kind of works: Diversion dam and ditch

9. Height of dam 3 feet; length of dam at top 40 feet; length of dam at bottom 30
feet; material used in dam: stone and earth

10. Size of headgate: Width 4 feet; height 4 feet.

11. Ditch: Width at bottom 3 feet; width at water line 6 feet; depth of water 2.5
feet; dimensions of flume

Diameter of pipe inches; length of conduit 4½ miles.

Average grade per mile 10 feet.

12. The time required for the completion of such work is three years.

13. The time required for the complete application of the water to the proposed use is two additional years.

14. The land to be irrigated is described in the following tabulation: See remarks.

15. (a) Is reservoir to be used? **No.** If so, fill in (b) and (c) below.
 (b) Name of Reservoir and number of Storage Permit:
 (c) Date of filing of Application for Storage Permit and Name of Applicant:

BE IT KNOWN THAT The undersigned hereby makes application for permit to appropriate the public waters of the State of Idaho as herein set forth.

Percy Anderson Applicant.

By

Agent.

Date of first receipt at Department of Reclamation: 9 A. M., April 20, 1929

Returned to applicant for correction:

Corrected application received:

APPROVAL OF COMMISSIONER OF RECLAMATION

The number of this permit is 17076
Recorded in Book 61 Page 17076 Approved April 26, 1929
This is to certify that I have examined the within application for a permit to appropriate the public waters of the State of Idaho, and
hereby approve the same, subject to the following limitations and conditions:
Bond in the sum of \$ to be filed on or before
Work to begin on or before June 25, 1929 and to continue diligently and uninterruptedly to completion,
unless temporarily interrupted by circumstances over which permit holder has no control.
One-fifth of the work above specified to be completed on or before October 26, 1930
The whole of said work to be completed on or before April 26, 1932
Beneficial use of water appropriated in accordance herewith, to be made on or before April 26, 1934

Witness my hand this 26th day of April, 1929.

GEO. N. CARTER
Commissioner of Reclamation.

Remarks: The Sundown Placer Claim is owned by applicant.

14.

| Twp. | Range | Sec. | NE¼ | | | | NW¼ | | | | SW¼ | | | | SE¼ | | | | Totals |
|------|-------|------|---|-----|-----|-----|-----|-----|-----|-----|-----|-----|-----|-----|-----|-----|-----|-----|--------|
| | | | NE¼ | NW¼ | SW¼ | SE¼ | NE¼ | NW¼ | SW¼ | SE¼ | NE¼ | NW¼ | SW¼ | SE¼ | NE¼ | NW¼ | SW¼ | SE¼ | |
| | | | <p>ASSIGNMENT</p> <p>For value received, I hereby assign all my right, title and interest in and to permit to appropriate the public waters of the state of Idaho No. 17076 to Amos D. Burrow and Roy L. Shaw of Gibbonsville, Idaho.</p> <p style="text-align: right;"><u>Percy Anderson</u></p> <p>Subscribed and sworn to before me this 1st day of June, 1929.</p> <p>(SEAL)</p> <p style="text-align: right;"><u>Charles H. Heidner</u> Notary Public residing at Salmon, Idaho</p> <p>Received and filed for record in the Department of Reclamation at Boise, Idaho at 11:00 A. M., February 19, 1932.</p> <p style="text-align: right;"><u>R. W. FARIS</u> Commissioner of Reclamation</p> <p style="text-align: center;">PERMIT NO. 17076 CERTIFICATE OF COMPLETION OF WORKS</p> <p>To All Whom It May Concern:</p> <p>This is to certify that Amos D. Burrow and Roy L. Shaw of Gibbonsville, County of Lemhi, and State of Idaho, the holders of Permit No. 17076, issued upon Application No. 24079 bearing date of priority of April 20, 1929, authorizing the diversion of 10.0 second feet of the waters of North Fork Salmon River County of Lemhi, State of Idaho, for mining and power purposes, have fully complied with the provisions of the laws of the State of Idaho relating to the proof of completion of the works of diversion set out and described in said Permit; that said works are adequate for diverting and conveying to the place of intended use 10.0 second feet of the waters of North Fork Salmon River; that the point of diversion of said waters is one mile above the confluence of Hammerein Creek and North Fork of Salmon River.</p> <p>Witness my hand this 12th day of April, A. D. 1933.</p> <p style="text-align: right;">R. W. FARIS Commissioner of Reclamation</p> <p>Proof of completion of works made April 26, 1932. Certificate of completion issued April 12, 1933.</p> | | | | | | | | | | | | | | | | |

PERMIT NO. 17076

ASSIGNMENT

For value received, I hereby assign all of my right, title and interest in and to that certain permit to appropriate the public waters of the State of Idaho, No. 17076 to Amos D. Burrow.

Dated this 23rd day of May, 1934.

Roy L. Shaw

Subscribed and sworn to before me this 23rd day of May, 1934.

(SEAL)

W. W. Simmonds,
Clerk of the District Court.

By Margaret Shoup
Deputy.

Received and filed for record in the Department of Reclamation at Boise, Idaho, at 9:00 A. M., May 28, 1934.

R. W. FARIS
Commissioner of Reclamation
By PIH

LICENSE ISSUED FOR 10 SEC. FT.

Vol. 7 Page 3823

WATER RIGHT NUMBER 75-2184

OWNER LAST NAME - ANDERSON

FIRST NAME - PERCY

ORIG OWNER - 0

OWNER LAST NAME - BURROW

FIRST NAME - A. D.

ORIG OWNER -

ADDRESS LINE 1 -

ADDRESS LINE 2 -

ADDRESS LINE 3 -

CITY - GIBBONSVILLE

STATE - ID ZIP CODE -

SOURCE - SALMON RIVER, NORTH FORK

TRIBUTARY OF - SALMON RIVER

STAGE - LICENSE

STATUS -

PRIORITY - 04-20-1929 COUNTY - LEMHI

TCTAL DIV. RATE - 10.0000 -CFS

TOTAL DIV. VOLUME -

.00 AFA

TRFR/AMEND -

WATER DIST. -

DLE/CAREY ACT -

RIGHT BASIS -

DIVERSION POINT - NESW 15 26N 21E LOT

REDIV -

0.0 0.0 0.0 0.0 0.0 0.0 0.0 0.0 0.0 0.0

FROM - TO -

USE - MINING

USE DIV. RATE -

10.0000

CFS

USE DIV. VOLUME -

.00 AFA

FROM - TO -

USE - INDUSTRIAL

USE DIV. RATE -

.0000

CFS

USE DIV. VOLUME -

.00 AFA

USE - MINING

PLACE OF USE - TWN 26N RNG 21E SEC 36 TRACT SWSW LOT

AC

TRACT NWSW LOT

AC

DECREE NAME -

DATE -

TOTAL ACRES

0

REMARKS - P/D & P/U INCOMPLETE. SEE FILE:

NON IRRIG USE - X/MINING & MILLING.

OTHER RIGHTS FOR SAME USE -

PROOF DUE -

PERMIT/DENIED -

PROTESTED -

HEARING -

OLD NO. - 17076

PROOF MADE -

FLD EXAM -

COND. OF APPROVAL -

DIVERSION MEANS -

DECEMBER 1984

June 17, 1980

Les Usher
Box 7
Gibbonsville, Idaho 83463

Dear Mr. Usher,

In response to your letter of June 5, 1980, we checked our records and confirmed that the water rights you mentioned are still in effect. These rights are licensed water rights and can only be lost through non-use over a five (5) year period.

The radio announcements that you have been hearing are aimed at those people who have been using water, but have not filed for a water right.

If you have any further questions please don't hesitate to contact us.

Sincerely,

JIM JOHNSON
Water Distribution Supervisor

JJ:mr

June 5, 1980

Department of Water Resources
Statehouse, Annex 2
Boise, Idaho 83707

Gentlemen:

In connection with recent radio announcements concerning renewal of water rights, etc., we have the following question:

We hold Water license No. 17076, priority April 20, 1929, amount 10 sec. feet., and Water license No. 17724, priority Sept. 8, 1932, amount 3 sec. ft., for use on mining claims on the North Fork of the Salmon River at Gibbonsville, Idaho.

Are these affected now, and if so, what is necessary to keep these in force?

Very truly yours,

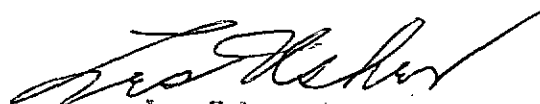

Les Usher
Box 7, Gibbonsville, Ida.
83463

RECEIVED

JUN 6 1980

Department of Water Resources

L. USHER
BX 7
GIBBONSVILLE, IDA.
83463



Department of Water Resources
Statehouse, Annex 2
Boise, Idaho
83707

IDENT. NO. 15-2184

WATER RIGHT
DATA ENTRY LOG

[illegible]

WATER RIGHT ANALYSIS FORM

- DATA ENTRY -

Identification No.

17076

75-2184

Old No.

New No.

Record

1. Original Owner: Bercy Anderson

Present Owner: A. D. Burrow

2. Address:

3. City: Gibbonsville State: Id Zip:

4. A. Source of Water: Salmon River, North Fork

B. Tributary of: Salmon River

5. A. Stage (A,P,L,D,S,J): L

B. Status (D,L,R,C,A,I,F - leave blank if valid):

C. Priority Date: 4-20-1929

D. County: 59

E. Total Diversion Rate: 10.

F. Total Diversion Volume:

G. Transfer/Amendment (P,T of A or blank):

H. Water District:

I. DLE/Carey Act (D,C or blank):

J. Right Basis (for adjudication claims A,B,C only):

| | Tract | Sec. | Twp. | Rge. | Gov't Lot | Rediv. |
|--------------------------|-------------------|------|------|------|-----------|--------|
| 6. A. Point of Diversion | <u>see remark</u> | | | | | |
| | | | | | | |
| | | | | | | |
| | | | | | | |
| | | | | | | |

7. Period of Use, Use, Diversion Rate/Volume:

from _____ to _____ for X purposes. Amount 10.
(cfs or AC-FT/yr)

from _____ to _____ for _____ purposes. Amount _____

from _____ to _____ for _____ purposes. Amount _____

from _____ to _____ for _____ purposes. Amount _____

from _____ to _____ for _____ purposes. Amount _____

from _____ to _____ for _____ purposes. Amount _____

from _____ to _____ for _____ purposes. Amount _____

March 24, 1936

Re: Permits Nos. 17076 & 17724

MR. A. D. BURROW
Gibbonsville,
Idaho

Dear Sir:

We are enclosing herewith Water Licenses, issued under the above numbered permits, together with our office receipts in the amounts of \$5.00, each, which amounts were the fees due in connection with final proofs under these permits.

Very truly yours,

R. W. FARIS
Commissioner of Reclamation

By _____
Assistant Chief Clerk

G
Encls.

17076

Gibberville Idaho
March 3rd 1936

H W Faris - Commissioner Recla-
mation - Idaho

Dear Sir:-

You will find enclosed money
order for \$10.00 due on Water rights 17076
and 17724 at \$5.00 each

Yours Respectfully

A D Burrows
Gibberville
Idaho

17076

17076

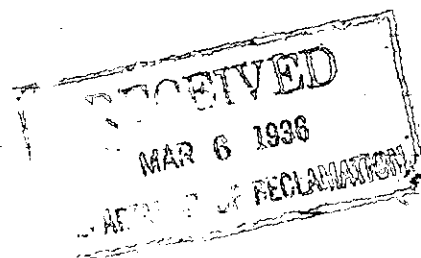

February 5, 1936

Re: Permit No. 17076

MR. A. D. BURROW
Gibbonsville,
Idaho

Dear Sir:

On the 22nd day of June, 1935, Mr. Fred A. Tolman, Field Engineer for this department, made an examination in relation to final proof under the above permit.

This permit, as you know, claims water from the North Fork of Salmon River. The certificate of completion of works was issued for 10 second feet, the total quantity claimed, and the license will, likewise be issued for this amount upon receipt of a \$5.00 fee.

Very truly yours,

R. W. FARIS
Commissioner of Reclamation

By _____
Chief Clerk & Office Engr.

PLH/rg

17076

STATE OF IDAHO
DEPARTMENT OF RECLAMATION
BOISE

REPORT OF ENGINEER

PERMIT NO. 17076

REPORT ON PROOF OF BENEFICIAL USE

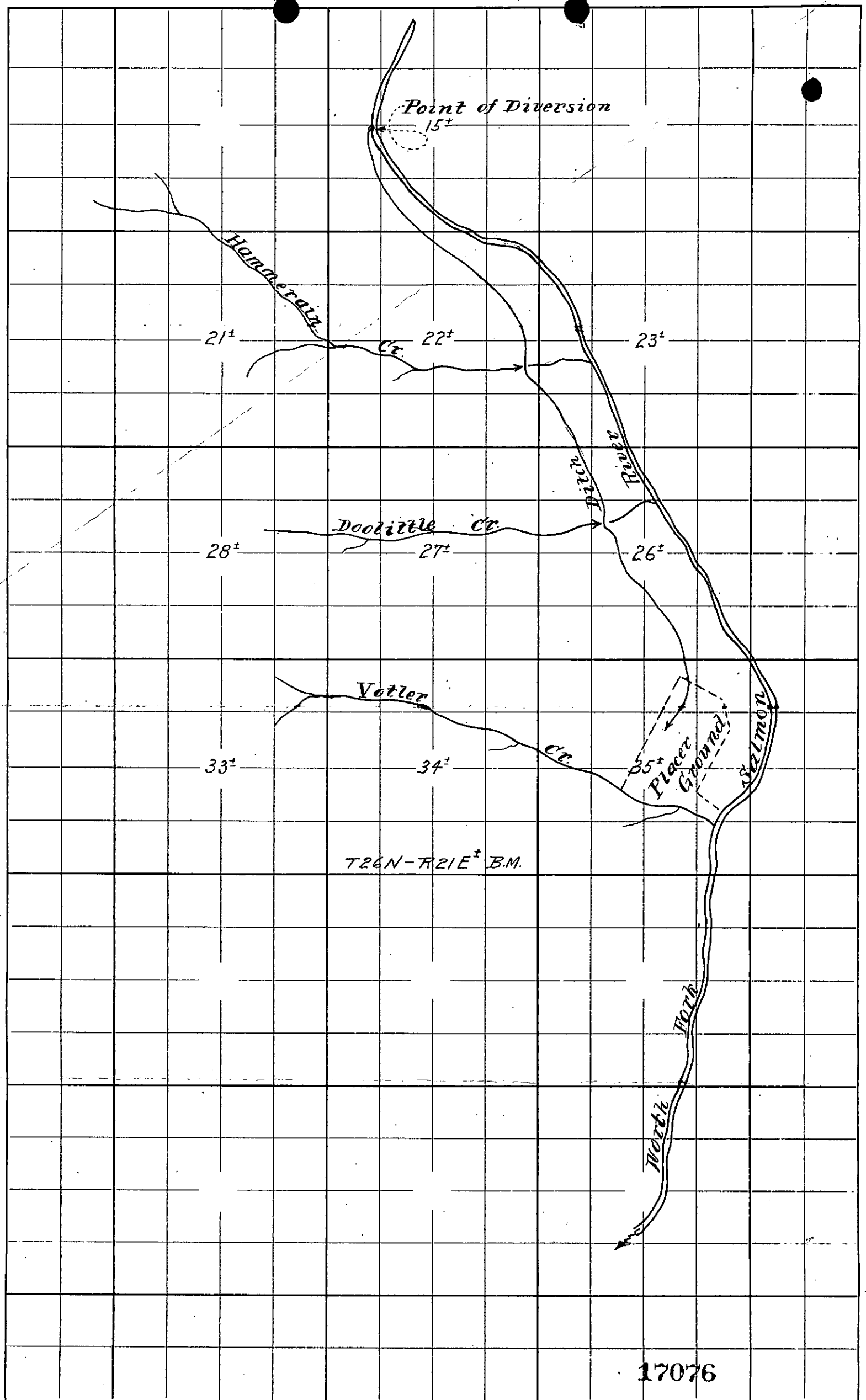

STATE OF IDAHO
DEPARTMENT OF RECLAMATION
BOISE, IDAHO

REPORT OF ENGINEER

Permit No. 17076This proof is for BENEFICIAL USE

In Water District No.

1. Name of applicant A. D. BURROW, Gibbonsville, Idaho2. Source of water supply: NORTH FORK of SALMON RIVER3. Location of point of diversion: Is in the (Unsurveyed land) 1 mile above ^{confluence of} of Section Hammerin Creek & North Fork of Salmon River.T. R. County of Lemhi

4. Describe works as they exist, giving dimensions and capacities of same: *Diversion dam of rock and earth 3' high x 40' long. Head gate 4' wide x 4' high x 10' long. Canal 3' wide x 25' deep. Penstock 20' long x 6' high x 4' wide. Riveted steel pipe line 1625' long x 16" to 8" diameter discharges thru 4" Giant under 12.5 ft. static head. A waste gate 10 ft long x 3 ft wide x 2 ft. deep is installed in the main canal 300 ft. above penstock*

5. Water is used for: Mining, milling and power purposes.6. State whether or not water has been turned into works of diversion: yes

7. List legal subdivisions of lands to be irrigated. If proof is for beneficial use, give exact number of acres under cultivation in each forty-acre tract. (Describe manner and place of use if for other than irrigation):

(Submit map on attached plat, showing location and details of above description.)

8. What large stream would the water here appropriated finally reach? Salmon River

Remarks: *Intercepting works are installed in Hammerin and Doolittle Creeks for supplemental water supply as needed*

17076This examination was made on the 22nd day of June, 1935

(Signed)

Frederick L. Loman
Examiner.

A. D. BURROW
Gibbonsville, Idaho

74

Permit No. 17076

Examination for BENEFICIAL USE PROOF

County

INSTRUCTIONS TO EXAMINERS

1. Always carefully note the location of the point of diversion and accurately plat same.
 2. When proof is for beneficial use, carefully check up the number of acres actually irrigated in each forty and accurately plat same.
 3. Make a map showing the correct location of streams and ditches, and the irrigated lands, and any adjacent permanent landmarks, such as towns, lakes, large streams and public roads.
 4. If any unusual conditions are discovered, make a plain statement of them under remarks.
 5. Always see the holder, if possible, and go over the whole ground with him and make your report only upon actual existing facts and conditions.
-

May 29, 1934

Re: Permit No. 17076

MR. A. D. BURROW
Gibbonsville,
Idaho

Dear Sir:

This will acknowledge receipt of the deposition of the holder, deposition of two witnesses and the affidavit of publication from the newspaper, all in connection with beneficial use proof under the above permit.

Before final action can be taken in this matter, the law requires that a field examination be made by an engineer from this department. We are unable to say just when this examination will be made since the department has but one field engineer who makes examinations all over the state. However, Mr. Tolman, Field Engineer for this department, will contact you at the time set for examination so that you may show him over the grounds. After his report is on file in this office you will be further notified as to fees due before the issuance of your license.

Very truly yours,

R. W. FARIS
Commissioner of Reclamation

By _____
Chief Clerk & Office Engr.

PLH:RG

17076

May 28, 1934

Re: Permit No. 17076

MR. AMOS D. BURROW
Gibbonsville,
Idaho

Dear Sir:

We are enclosing herewith Assignment of Roy L. Shaw,
executed under the above numbered permit, which has been made
a matter of record in this department.

Very truly yours,

R. W. ERIS
Commissioner of Reclamation

By _____
Assistant Chief Clerk

G
Encl.

17076

XXXXXX
COUNTY SURVEYOR, LEMHI COUNTY
U. S. DEPUTY MINERAL SURVEYOR
STATE LICENSED ENGINEER
SALMON, IDAHO

May 25, 1934.

Mr. R. W. Faris,
Commissioner of Reclamation,
Boise, Idaho.

Dear Sir:

Enclosed please find assignment of Mr. Roy L. Shaw of his ~~tax~~
interests in Permit No. 17076, to Mr. Amos D. Burrow.

Yours very truly,

A. E. Ferguson

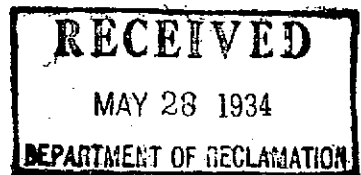

17076

May 10, 1934

Re: Permit No. 17076
Amos D. Burrow & Roy L. Shaw

MR. A. B. FERGUSON, Agent
Salmon,
Idaho

Dear Sir:

Under date of April 28, 1934, we received depositions which had been executed by Mr. Burrow and his two witnesses on the 28th day of April and also the affidavit of publication from the newspaper in connection with final proof under the above permit.

Accompanying these papers was an instrument conveying all of Mr. Shaw's interest in a certain mining claim to Mr. Burrow. Presumably, Mr. Shaw intended to convey his interest in Permit No. 17076 to Mr. Burrow but there is nothing in this instrument to indicate as much since there is no mention made of the permit or of any water rights. Therefore, we cannot accept it as a conveyance and for that reason we are enclosing a short form of Assignment which we suggest you have Mr. Shaw sign and return to this department. The permit can then be assigned on the department records and a license issued to Mr. Burrow. Since proof was made only in the name of Mr. Burrow it probably would be advisable to date the Assignment prior to the date when proof was offered. I think that there is no question but what this would be proper since there is little doubt but what Mr. Shaw intended to assign his interest in the permit at the time when he executed the instrument in question, which was the 4th of December, 1933.

We are returning the deed of mining claim.

Very truly yours,

R. W. FARIS
Commissioner of Reclamation

By _____
Chief Clerk & Office Engr.

PLH:RG
Encls. 2

17076

XXXXXXXXXXXXXXXXXXXX
COUNTY SURVEYOR, LEMHI COUNTY
U. S. DEPUTY MINERAL SURVEYOR
STATE LICENSED ENGINEER
SALMON, IDAHO

April 26, 1934.

Mr. R. W. Faris,
Commissioner of Reclamation,
Boise, Idaho.

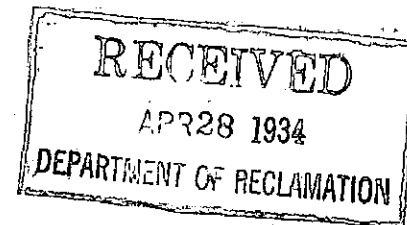

Dear Sir:

Enclosed please find proof of application of water to beneficial use under Permit no. 17076, A. D. Barrow and Roy L. Shaw applicants. As Mr. Shaw has sold his interests in the Sindown Placer claim to Mr. Barrow, only Mr. Burrow's name appears on these papers.

Papers contain the following:

Deposition of holder.

" of two witnesses.

Certified copy of deed, Shaw to Barrow.

Affidavit of publication, and receipt.

I trust that you will find everything as they should be.

Yours very truly,

A handwritten signature in cursive script, appearing to read "A. E. Ferguson".

17076

Affidavit of Publication

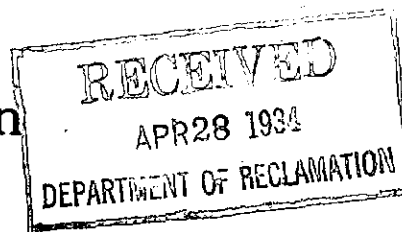

State of Idaho, }
County of Lemhi } ss.

RALPH B. KNEPPER, being duly sworn, upon oath deposes and says: I am the printer,

NOTICE FOR PUBLICATION
Notice of Proof Application of Water
to Beneficial Use.

Notice is hereby given that at 10:00 a. m. on the 26th day of April, 1934, at Salmon, County of Lemhi, State of Idaho, before W. W. Simmonds, Clerk of the District Court, proof will be submitted of the application to beneficial use of ten cubic feet per second of the waters of North Fork Salmon River in accordance with the terms and conditions of Permit No. 17076 heretofore issued by the Commissioner of Reclamation of the State of Idaho.

The name and postoffice address of the person or corporation holding said permit are Amos D. Burrow and Roy L. Shaw, Gibbonsville, Idaho.

The use to which said water has been applied is Mining, Milling or Power.

The amount applied to beneficial use is ten cubic feet per second.

The place where said water is used: Sundown Placer, 2½ miles south of confluence of Hammerien Creek and North Fork Salmon River.

The name of the canal or ditch or other works by which said water is conducted to such place of use is Sundown Placer Ditch.

The right to take water from such works is based upon Permit No. 17076.

The source of supply from which such water is diverted is North Fork Salmon River.

The date of the priority which said user is prepared to establish is April 20, 1929.

R. W. FARIS,
Commissioner of Reclamation.
Mch. 7 to 28—4t.

Publication Fee \$-10.75

publisher, and sole proprietor of the RECORDER HERALD, a newspaper published weekly at Salmon, Lemhi County, Idaho, and of general circulation therein.

That the Notice of Proof Application of Water to Beneficial Use

a true printed copy of which is attached to the margin hereof, has been and was correctly printed and published in the regular and entire issue of every number of said newspaper and not in any supplement thereof or thereto for four

consecutive issues, commencing with the issue dated March 7, 1934 and ending with the issue dated

March 28, 1934

Ralph B. Knepper

before me, this 26th day of April, 1934

James A. Hendon

Notary Public for the State of Idaho,
Residing at Salmon, Idaho.

17076

STATE OF IDAHO
DEPARTMENT OF RECLAMATION
BOISE, IDAHO

Permit No. 17076

Proof of Application of Water to Beneficial Use

Deposition of Holder

Ques. 1. State your name, residence, occupation and postoffice address.

Ans. A. D. Burrow, Gibbonsville, Lemhi County, Idaho

Ques. 2. If acting in behalf of corporation, state its name, principal place of business (if a foreign corporation, give name of postoffice of statutory agent), your position with reference to same, and your authority for appearing in its behalf.

Ans.

Ques. 3. State number and date of permit, and date of priority you propose to establish under the permit.

Ans. 17076, April 26, 1929, date of priority same. Apr. 20, 1929

Ques. 4. State source of water supply and give exact location of point of diversion.

Ans. North Fork Salmon River; point of diversion on unsurveyed land, one mile above confluence of Hammerein Creek and North Fork of Salmon River.

Ques. 5. Describe your works of diversion, and state amount of water they are capable of conveying from point of diversion to place of use, and give name of canal or ditch or other works by which water is conducted to such place of use.

Ans. Diversion dam and ditch; dam 3 feet high, length at top 40 feet; length at bottom 30 feet; material earth and stone. Sundown Ditch.

Ques. 6. State for what purpose water is used and describe place of use. (If for irrigation, name each subdivision in which used, and number of acres in each subdivision that have actually been irrigated with said water.) State whether cultivated or natural meadow land and the nature of all improvements which have been made as a direct result of said use.

Ans. Mining, milling or power. On Sundown Placer Claim, $3\frac{1}{2}$ miles below point of diversion.

Ques. 7. If for other than for irrigation purposes; state how applied, amount of horse power generated, etc.

Ans. Water applied through hydraulic nozzle.

Ques. 8. What is the minimum amount of water required for the purpose specified above?

Ans. Ten cuft. per second

Ques. 9. If you are not the person or representative of the corporation to whom above mentioned permit was originally issued, please state how ownership was acquired by present holder.

Ans. A. D. Burrow purchased interests of Roy L. Shaw.

Ques. 10. State when, how, in what amount and to what extent the water diverted under above mentioned permit has been used.

Ans. From June to October, 1933; 40 days hydraulicing and balance of time ground sluicing; 10 cuft. per second; moving 2500 cuys. of gravel.

Ques. 11. State when, how, in what amount and to what extent waters other than those diverted under the above mentioned permit have been diverted and applied to beneficial use upon the lands herein described. Give full particulars regarding such other appropriations and rights claimed thereunder.

Ans. In 1933 waters of Hammerein Creek to the extent of 3 cuft. per sec. were used in these operations. 10 cuft. per sec. actually reached the placer claim. Permit No. 24843, waters of Hammerein Creek, filing of 3 cuft. per second.

(Sign)

A. D. Burrow

I hereby certify that the foregoing testimony was read to the above subscribed before its signing, that I believe him to be the person he represents himself to be, and that said testimony was subscribed and sworn to before me, at my office in Salmon, County of Lemhi, State of Idaho, on this 26th. day of April, A. D. 19 34.

W. W. Harrison
Clerk of the District Court
in and for Lemhi County, State of Idaho.

My commission expires _____

17076

STATE OF IDAHO
DEPARTMENT OF RECLAMATION
BOISE, IDAHO

PERMIT NO. 17076

Proof of Application of Water to Beneficial Use
Deposition of Witness

The deposition of two witnesses, on this form, taken separately, required in each case.

Ques. 1. State your name, age, residence, occupation and postoffice address.

Ans. William Preacott; 24 years; Gibbonsville, Idaho; Laborer;
Gibbonsville, Idaho.

Ques. 2. Are you acquainted with A. D. Burrow, the holder of Permit No. 17076? How long have you known him and where does he reside?

Ans. Yes; one year. Gibbonsville, Idaho.

Ques. 3. Have you read or heard read said Permit No. 17076, and are you familiar with its provisions and conditions?

Ans. Yes

Ques. 4. State source of water supply, place of diversion, and describe works for conveying water from point of diversion to place of use.

Ans. North Fork of Salmon River, one mile above Hammerein Creek.
Diversion dam in North Fork, and earth ditch about 4 miles long, with
300 feet of flume. Ditch about 3' wide and carries water about 2 feet
in depth.

Ques. 5. How many second feet of water do you estimate said works will safely conduct to place of use, and how much water have you seen being so conveyed?

Ans. 10 cuft. per second; 10 cuft. per second.

Ques. 6. State for what purpose water is used and at what place. (If for irrigation, give each sub-division in which water has been used and number of acres irrigated in each subdivision.) State whether cultivated or natural meadow land and the nature of all improvement which have been made as a direct result of said use.

Ans. Mining, placer. At Sundown Placer Claim.

Ques. 7. If for power or other purposes than irrigation, state how water has been applied and to what extent

Ans. By hydraulicing and ground sluicing.

Ques. 8. (If for irrigation) state character of land that has been reclaimed, and give your estimate of the amount of water required for its profitable cultivation.

Ans.

Ques. 9. Have you any interest in the works, water or lands above mentioned? If so, in what way and to what extent?

Ans. None.

Ques. 10. State when, how, in what amount and to what extent you have witnessed the application to beneficial use of water diverted under said permit.

Ans. From July 1 to October 1, 1933; by hydraulicing and ground sluicing; about 2500 cu yds. of gravel moved.

(Signed)

William Prescott

I hereby certify that the foregoing testimony was read to the above subscriber before its signing, that I believe him to be the person he represents himself to be, and that said testimony was subscribed and sworn to before me in Salmon, County of Lemhi, State of Idaho, on this 26th day of April, A. D. 1934.

My commission expires

W. W. [Signature]
Clerk of the District Court in and for Lemhi County,
State of Idaho.

STATE OF IDAHO
DEPARTMENT OF RECLAMATION
BOISE, IDAHO

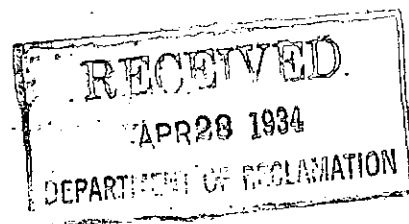

PERMIT NO. 17076

Proof of Application of Water to Beneficial Use

Deposition of Witness

The deposition of two witnesses, on this form, taken separately, required in each case.

Ques. 1. State your name, age, residence, occupation and postoffice address.

Ans. Jay Heidt; 26 years; Gibbonsville, Idaho; miner;
Gibbonsville, Idaho.

Ques. 2. Are you acquainted with A. D. Burrow, the holder of Permit No. 17076? How long have you known him and where does he reside?

Ans. Yes; 26 months; Gibbonsville, Idaho.

Ques. 3. Have you read or heard read said Permit No. 17076, and are you familiar with its provisions and conditions?

Ans. Yes.

Ques. 4. State source of water supply, place of diversion, and describe works for conveying water from point of diversion to place of use.

Ans. North Fork of Salmon, River; One mile above Hammerin Creek;
diversion dam in North Fork. and earth ditch about 4 miles long, with
300 feet of flume. Ditch about 3 feet wide and carries water about 2
feet in depth.

Ques. 5. How many second feet of water do you estimate said works will safely conduct to place of use, and how much water have you seen being so conveyed?

Ans. 10 cuft. per sec., 10 cuft. per second.

Ques. 6. State for what purpose water is used and at what place. (If for irrigation, give each sub-division in which water has been used and number of acres irrigated in each subdivision.) State whether cultivated or natural meadow land and the nature of all improvement which have been made as a direct result of said use.

Ans. Hydraulic mining, at Sundown Placer Claim.

17076

Ques. 7. If for power or other purposes than irrigation, state how water has been applied and to what extent

Ans. By hydraulicing and ground sluicing.

Ques. 8. (If for irrigation) state character of land that has been reclaimed, and give your estimate of the amount of water required for its profitable cultivation.

Ans. _____

Ques. 9. Have you any interest in the works, water or lands above mentioned? If so, in what way and to what extent?

Ans. None

Ques. 10. State when, how, in what amount and to what extent you have witnessed the application to beneficial use of water diverted under said permit.

Ans. From July 1 to October 15, 1933; by hydraulicing and ground sluicing; about 2500 cuys. of gravel moved.

(Signed) Jay Heidt

I hereby certify that the foregoing testimony was read to the above subscriber before its signing, that I believe him to be the person he represents himself to be, and that said testimony was subscribed and sworn to before me in Salmon, County of Lemhi, State of Idaho, on this ~~day of~~ 26th day of April, A. D. 1934.

My commission expires _____

W. W. Harrison
Clerk of the District ~~Notary Public~~
Court in and for Lemhi County, State of Idaho.

Instrument No. 41620
DEED OF MINING CLAIM.

THIS INDENTURE, Made the 1st. day of December in the year of our Lord one thousand nine hundred and thirty-three between ROY L. SHAW and ETHEL E. SHAW, husband and wife, the parties of the first part, and AMOS D. BURROW, the party of the second part, Witnesseth, that the said parties of the first part, for and in consideration of the sum of ONE AND NO/100 DOLLARS, and other valuable considerations, of the United States of America, to them in hand paid by the said party of the second part, the receipt whereof is hereby acknowledged, have GRANTED, BARGAINED, SOLD, REMISED, RELEASED and FOREVER QUITCLAIMED, and by these presents do grant, bargain, sell, remise, release and forever quitclaim unto the said party of the second part, and to his heirs and assigns,

All of the SUNDOWN PLACER MINING CLAIM containing One Hundred Sixty Acres, more or less, situate in the Dahlonega Mining District, Lemhi County, State of Idaho, and recorded in Book "W" of Mining Claims, at page 40, official records of Lemhi County, State of Idaho, reference to which book and page of said Book "W" of Mining Claims is hereby made for a more complete description of the above mentioned Sundown Placer Mining Claim.

The above mentioned Sundown Placer Mining Claim is Joined on the Southeast by Homestead Entry Sur. #98, and on the Southeast and South by Homestead Entry Sur. #649.

Together with all the dips, spurs and angles, and also all the metals, ores, gold and silver bearing quartz, rocks and earth therein; and all rights, privileges and franchises thereto incident, appendant and appurtenant, or therewith usually had and enjoyed; and also, all and singular the tenements, hereditaments and appurtenances thereto belonging or in anywise appertaining, and the rents, issues and profits thereof, and, also all the estate, right, title, interest, property, possession, claim and demand whatsoever, as well in law as in equity, of the said parties of the first part, of, in or to the said premises, and every part and parcel thereof, with the appurtenances.

TO HAVE AND TO HOLD, all and singular the said premises, together with the appurtenances and privileges thereto incident, unto the said party of the second part, his heirs and assigns forever. It is expressly covenanted that it is intended hereby to convey any and all right, title, interest and estate which may hereafter be acquired to said premises, or any part thereof, by virtue of any patent which may hereafter be issued by the United States Government therefor under proceedings heretofore instituted in that behalf by the said parties of the first part or their grantors.

IN WITNESS WHEREOF, the said parties of the first part have hereunto set their hands and seals the day and year first above written.

Signed, Sealed and Delivered in
the presence of:
F.A. McCall.

ROY L. SHAW (SEAL)
ETHEL E. SHAW (SEAL)

STATE OF IDAHO,)
COUNTY OF LEMHI.) ss.

On this 4th. day of December, 1933, before me, F.A. McCall, a Notary Public in and for said County and State, personally appeared Roy L. Shaw and Ethel E. Shaw, known to me to be the persons whose names are subscribed to the within instrument, and acknowledged to me that they executed the same.

IN WITNESS WHEREOF, I have hereunto set my hand and affixed
my official seal the day and year in this certificate first above written.

(Seal) F. A. McCall,
Notary Public

STATE OF IDAHO,)
COUNTY OF LEMHI.) ss.

17076

I hereby certify that this instrument was filed for record at

the request of A. D. Burrow, at - minutes past 2 o'clock P.M., this 4th day of December, A.D. 1933, in my office, and duly recorded in Book 30 of Deeds, at page 408.

W. W. Simmonds,
County Recorder.
By Margaret Shoup,
Deputy.

STATE OF IDAHO,)
 : ss.
COUNTY OF LEMHI.)

I, W. W. Simmonds, County Recorder in and for the County aforesaid, do hereby certify that the foregoing is a full, true and complete copy of a deed, as the same appears on record in my office, in Book 30 of Deeds, page 408, Official Records of Lemhi County, Idaho.

IN WITNESS WHEREOF, I have hereunto set my hand and affixed my official seal this 26th day of April, 1934.

By

Margaret Shoup
Deputy.

W. W. Simmonds,
County Recorder.

~~Received and filed for record in the Department
of Information at Boise, Idaho, at~~

~~11:30 A. APR 28 1934~~

~~R. W. Jones~~

~~By R. W. Jones~~

State of Idaho

DEPARTMENT OF RECLAMATION

BOISE

INSTRUCTIONS

PROOF OF BENEFICIAL USE OF WATER

BOISE, IDAHO, April 18, 1934

W. W. SIMMONDS, Clerk of District Court
Salmon, Idaho

DEAR SIR:

I enclose herewith the following forms to be used in connection with proof of beneficial use of water under Permit No. 17076

DEPOSITION OF PERMIT HOLDER, DEPOSITIONS OF TWO WITNESSES.

In submitting this proof the following instructions should be CAREFULLY followed out, since failure to do so may result in the loss of rights:

1. On April 26, 1934, the date set for proof, the enclosed forms (one for permit holder and one each for two disinterested witnesses) should be filled out and sworn to, at Salmon, Idaho before W. W. Simmonds

2. When the depositions have been taken, they should be mailed to this office, together with affidavit of publication of notice.

When these have been received, together with report of the examining engineer, if everything is properly executed, you will be further advised as to fees due, etc., before certificate is issued.

Yours truly,

R. W. FARIS

Commissioner of Reclamation.

17076

March 12, 1934

Re: Permit No. 17076
Amos D. Burrows & Roy L. Shaw

EDITOR RECORDER HERALD
Salmon,
Idaho

Dear Sir:

We are in receipt of a letter from A. D. Burrows, one of the holders of the above permit, accompanied by a copy of the notice which appeared in your issue of March 7th, with reference to beneficial use proof under the above permit.

Mr. Burrows calls our attention to the fact that the notice states that on such and such a date proof will be submitted of the application to beneficial use of "10 cubic inches per second" of the waters of the North Fork of SALMON RIVER in accordance with the terms of Permit No. 17076. This is a mistake since the notice should read "10 cubic feet per second".

In checking the duplicate of the notice which was mailed to you, we find that it is correct, therefore, the mistake is on the part of the newspaper and it is requested that you correct this notice so that it will appear in proper form in the remaining issues.

Very truly yours,

R. W. FARIS
Commissioner of Reclamation

By _____
Chief Clerk & Office Engr.

PLH:RG
C. C. to A. D. Burrows, Fairfax, California.

17076

said administrator, at Salmon,
County of Lemhi, State of Idaho, this
being the place fixed for the transac-
tion of the business of said estate.

Dated February 3rd 1934.

CLARENCE SMITH,
Administrator.

Feb. 14 to Mch. 7--4t.

NOTICE FOR PUBLICATION

Notice of Proof Application of Water
to Beneficial Use.

Notice is hereby given that at 10:00
a. m. on the 26th day of April, 1934,
at Salmon, County of Lemhi, State of
Idaho, before W. W. Simmonds, Clerk
of the District Court, proof will be
submitted of the application to bene-
ficial use of ten cubic inches per sec-
ond of the waters of North Fork Sal-
mon River in accordance with the
terms and conditions of Permit No.
17076 heretofore issued by the Com-
missioner of Reclamation of the State
of Idaho.

The name and postoffice address of
the person or corporation holding said
permit are Amos D. Burrow and Roy
L. Shaw, Gibbonsville, Idaho.

The use to which said water has
been applied is Mining, Milling or
Power.

The amount applied to beneficial
use is ten cubic feet per second.

The place where said water is used:
Sundown Placer, 2½ miles south of
confluence of Hammerien Creek and
North Fork Salmon River.

The name of the canal or ditch or
other works by which said water is
conducted to such place of use is Sun-
down Placer Ditch.

The right to take water from such
works is based upon Permit No. 17076.

The source of supply from which
such water is diverted is North Fork
Salmon River.

The date of the priority which said
user is prepared to establish is April
20, 1929.

R. W. FARIS,
Commissioner of Reclamation.
Mch. 7 to 28--4t.

ANOT 57 MONS

ti
C/
fa
se
Un
tu
se
th
aj
fo
go
pr
in
ing
uatic
critic
heart
price
\$1 a b
ers
T
the
so
st
o'
n
E
th
fi
"

... be the cause of
trouble.

By means of the ophthalmoscopic test, recently improved by science, the cause of many of these disorders is revealed. Dr. H. H. Scarborough who visits the Shenon Hotel Wednesday and Thursday, March 14 and 15, has used this form of eye examination for many years, with pronounced success.

IDAHO OFFERS UNIQUE OPPORTUNITY

(Continued from page one)

the United States senate and Pennsylvania, one of the seven states that pay all the federal taxes on a "net" basis, has one worth talking about—a lawyer for Mellon and a banjo player for the Moose.

A clear majority of all now sheltered in Idaho is emigrant. Only 46.6 being native — mostly minors.

The active participants in the 2000 recent strikes could move right into Idaho and through control of the next legislature, vote to hang all employers of labor — in Idaho when, as and if any.

On to Idaho!

Idaho the name being Indian means "gam of the mountains" is situated between 42 degrees and 49 degrees N. latitude, and mainly between 111 degrees and 117 degrees W. longitude.

Its maximum length is about 490 miles; its breadth varies from about 42 miles in the north to 300 miles in the south. Area, 84,313 square miles.

One of the main ranges of the Rocky mountains, called variously the Cabinet, Coeur d'Alene and Bitter Root mountains, forms the northeastern boundary between Idaho and Montana. Spurs of the range traverse the state from east to west. The Sal-

Fairfax Cal.
March 10th 1934

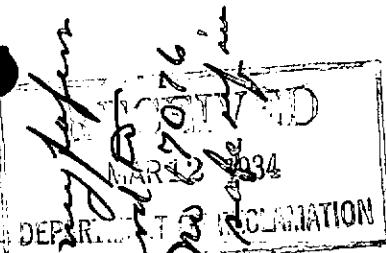

● R.W. Farris

Commissioner of Reclamation
Boise - Idaho

● Dear Sir:-

Regarding the published notice of Proof of Application of water to beneficial use of 10 cubic inches of water from the North fork of the Salmon River. You have undoubtedly made a mistake and have already made proof on permit No 17076 for 10 cubic feet per second and have received the certificate. Also I have permit No 17724 for 3 cubic feet per second. Proof on this was due in 1933 but I received an extension to Sept 21 - 1934. Now in case the certificate in 17076 is not final I wish to know about it and also get the 10 cubic inches changed to feet in the publication in the Recorder - Herald at Salmon - Idaho. I am down here for the winter but will be back there by April 15th at Gibbonsville. I will receive mail here till April 4th.

Yours Truly

A.D. Burrow

% Young 24 Creek Road

Fairfax (Marine Co)

California

17076

Answer A.D. Burrow

STATE OF IDAHO
DEPARTMENT OF RECLAMATION
BOISE, IDAHO

Date February 27, 1934

EDITOR, RECORDER HERALD
Salmon,
Idaho

DEAR SIR:

Enclosed you will find notice for publication once a week for four consecutive weeks prior to April 26, 1934, the date set for proof, the expense of the publication to be paid by the applicant.

Amos D. Burrow and Roy L. Shaw, Gibbonsville, Idaho.

to whom you should furnish proof of publication on or prior to the date set for proof.

Please acknowledge receipt of this notice and furnish this office with a copy of the first publication.

Very truly yours,

R. W. FARIS

Commissioner of Reclamation

17076

February 27, 1934

Re: Permit No. 17076
Amos D. Burrows & Roy L. Shaw

MR. A. E. FERGUSON, Agent
Salmon,
Idaho

Dear Sir:

Under date of February 23rd, 1934, we received your papers in connection with the offering of proof of beneficial use of water under the above permit and we find that they are in proper form.

A copy of the notice has been mailed to the Recorder Herald, Salmon, Idaho, with instructions for publication once a week for four consecutive weeks prior to the 26th day of April. Proof will be offered at 10:00 A. M. on this date before Mr. W. W. Simmonds, Clerk of the District Court. Will you please advise Mr. Burrows and Mr. Shaw that they should appear at Mr. Simmonds' office, on the date designated, with two witnesses who are familiar with the works constructed under the above permit, to execute the depositions which will be mailed from this office to Mr. Simmonds in ample time for the proof.

Very truly yours,

R. W. FARIS
Commissioner of Reclamation

By _____
Chief Clerk & Office Engr.

PLH:RG

17076

Salmon, Idaho.
February 21, 1934.

Mr. R. W. Faris,
Commissioner of Reclamation,
Boise, Ida.

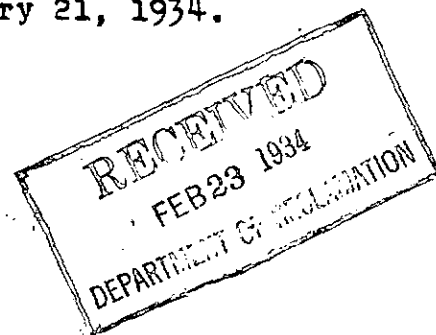

Dear Sir:

Enclosed please find papers in connection with proof of ~~hsh~~
beneficial use, Permit No. 17076, Amos D. Burrow and Roy L. Shaw.

Yours truly,

A. E. Ferguson

17076

8

NOTICE TO ACCOMPANY THIS LETTER MUST BE MADE IN DUPLICATE

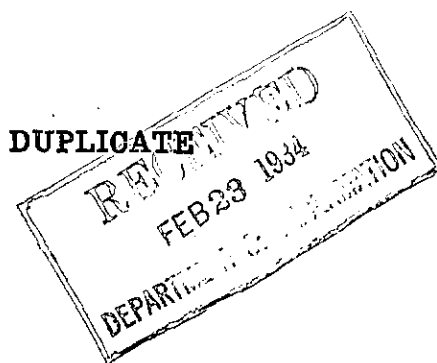

(Date) February 21, 1934

(P. O.) Salmon, Idaho

TO THE COMMISSIONER OF RECLAMATION:

Boise, Idaho.

Dear Sir:

You are hereby authorized to have the attached notice published at my expense in the Recorder Herald of Salmon, Idaho, published in the county in which the works are situated.

Amos D. Burrow and Roy L. Shaw

By A. E. Ferguson
Agent

(In case of canals or other works designed to divert and carry more than 50 cubic feet of water per second, the following certificate must be signed by a well-known and competent engineer)

I hereby certify that the facts set forth in the attached notice are true.

Engineer.

NOTICE FOR PUBLICATION

NOTICE OF PROOF APPLICATION OF WATER TO BENEFICIAL USE

Notice is hereby given that at 10:00 a. m. on the 25th day of April, 1934,
at Salmon, County of Lemhi, State of Idaho,
before M. M. Simmonds, Clerk of the District Court, proof will be submitted
of the application to beneficial use of ten cubic feet per second of the
waters of North Fork Salmon River in accordance with the terms and conditions of
Permit No. 17076 heretofore issued by the Commissioner of Reclamation
of the State of Idaho.

The name and postoffice address of the person or corporation holding said permit are.....

Amos D. Burrow and Roy L. Shaw, Gibbonsville, Idaho.

The use to which said water has been applied is mining, milling or power

The amount applied to beneficial use is ten cuft. per sec.

The place where said water is used (if for irrigation, give full and accurate description of the
lands irrigated) Sundown Placer, 2 1/2 miles south of confluence of Hammerien
Creek and North Fork Salmon River

The name of the canal or ditch or other works by which said water is conducted to such place of use
is Sundown Placer Ditch

The right to take water from such works is based upon Permit No. 17076

The source of supply from which such water is diverted is North Fork Salmon River

The date of the priority which said user is prepared to establish is 20,
April 25, 1929

R. W. FARIS

Commissioner of Reclamation.

17076

Form No. 9

STATE OF IDAHO
DEPARTMENT OF RECLAMATION
BOISE

AMOS D. BURROW & ROY L. SHAW
Gibbonsville, Idaho

February 5, 1934

Dear Sir:—

I enclose herewith blank notice of proof of application of water to beneficial use under your permit No. 17076, which should be filled out and returned to this office at least 60 days before the date upon which you wish to make proof. The date for proof, as set out in your permit, is April 28, 1934, and, if proof is submitted subsequent to said date, your priority will be brought down a length of time equal to the time elapsing between the date proof should have been made and the date proof is actually made.

Yours truly,

R. W. FARIS

~~XXXXXXXXXXXX~~

Commissioner of Reclamation.

17076

April 12, 1933

RE: PERMIT NO. 17076
Amos D. Burrow and Roy L. Shaw

MR. AMOS D. BURROW
Gibbonsville,
Idaho

Dear Sir:

We are herewith enclosing CERTIFICATE OF COMPLETION OF WORKS issued today under the above permit. This certificate covers works constructed in connection with the diversion of ten cubic feet per second of the waters of North Fork of Salmon River for mining and power purposes. It has been made a matter of record in this department.

We also are enclosing office receipt in the sum of \$5.00 covering fees paid by you in connection with proof of Completion of Works under this permit.

Very truly yours,

R. W. FARIS
Commissioner of Reclamation

By _____
Chief Clerk & Office Engineer

PLH:MC
Encls.2

17076

Gibbonsville Id
March 16th 1933

Department of Reclamation
Boise - Idaho
R. F. Harris

Dear Sir:-

I am in receipt of your
letter of March 7th I will
take up the Certificate of
Completion (permit No 17076)
just as soon as I can
get hold of the money -
The Economy Bill mayering
me for cash temporarily
till I can make a cleanup
I been depending on my
pension for spending money
I am a U.S.W. Veteran of
the 1st Idaho - 17076

2
Anyway we will know
more about the effects of
it a month or two from
now. If any new laws in
regard to Water Rights
was passed & signed I would
like a copy of it - At
your convenience

Yours Truly
A D Brown
Gibbonsville
Idaho

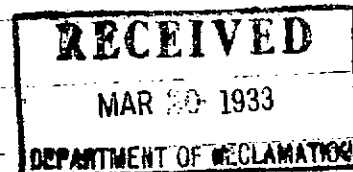

17076

Gibbonsville Id
April 6th 1933

State of Idaho
Dept of Reclamation
Boise - Id

R-W- Faris - Commissioner

Dear Sir:-

you will find enclosed \$5.00
for Certificate of completion
Permit 17076

Yours Respectfully
A. D. Burrows
Gibbonsville
Idaho

17076

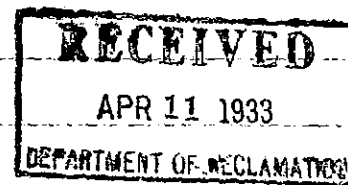

March 20, 1933

Re: PERMIT No. 17076

Mr. A. D. BURROW,
Gibbonsville,
Idaho

Dear Sir:

We have your letter of the 18th inst. in response to our letter of recent date informing you that upon receipt of a fee in the sum of \$5.00 Certificate of Completion of Works would be issued under the above permit for a total capacity of 10 second feet. You say that you will take care of this matter as quickly as possible. Therefore, action on the Certificate will be postponed until such time as the fee is received.

Very truly yours,

R. W. FARIS,
Commissioner of Reclamation

By Chief Clerk & Office Engineer

PLH/mt

17076

March 7, 1933

RE: PERMIT NO. 17076
Roy L. Shaw, Amos D. Burrow

MR. AMOS D. BURROW
Gibbonsville, Idaho

Dear Sir:

The Engineer's Report covering his examination made in connection with proof of Completion of Works under the above permit is now on file in this office.

Upon receipt of a statutory fee in the sum of \$5.00 we will issue the CERTIFICATE OF COMPLETION OF WORKS.

Very truly yours,

R. W. FARIS
Commissioner of Reclamation

By _____
Chief Clerk & Office Engr.

FLH:MC

17076

STATE OF IDAHO
DEPARTMENT OF RECLAMATION
BOISE

REPORT OF ENGINEER

PERMIT NO. 17076

~~REPORT ON PROOF OF COMPLETION OF WORKS~~

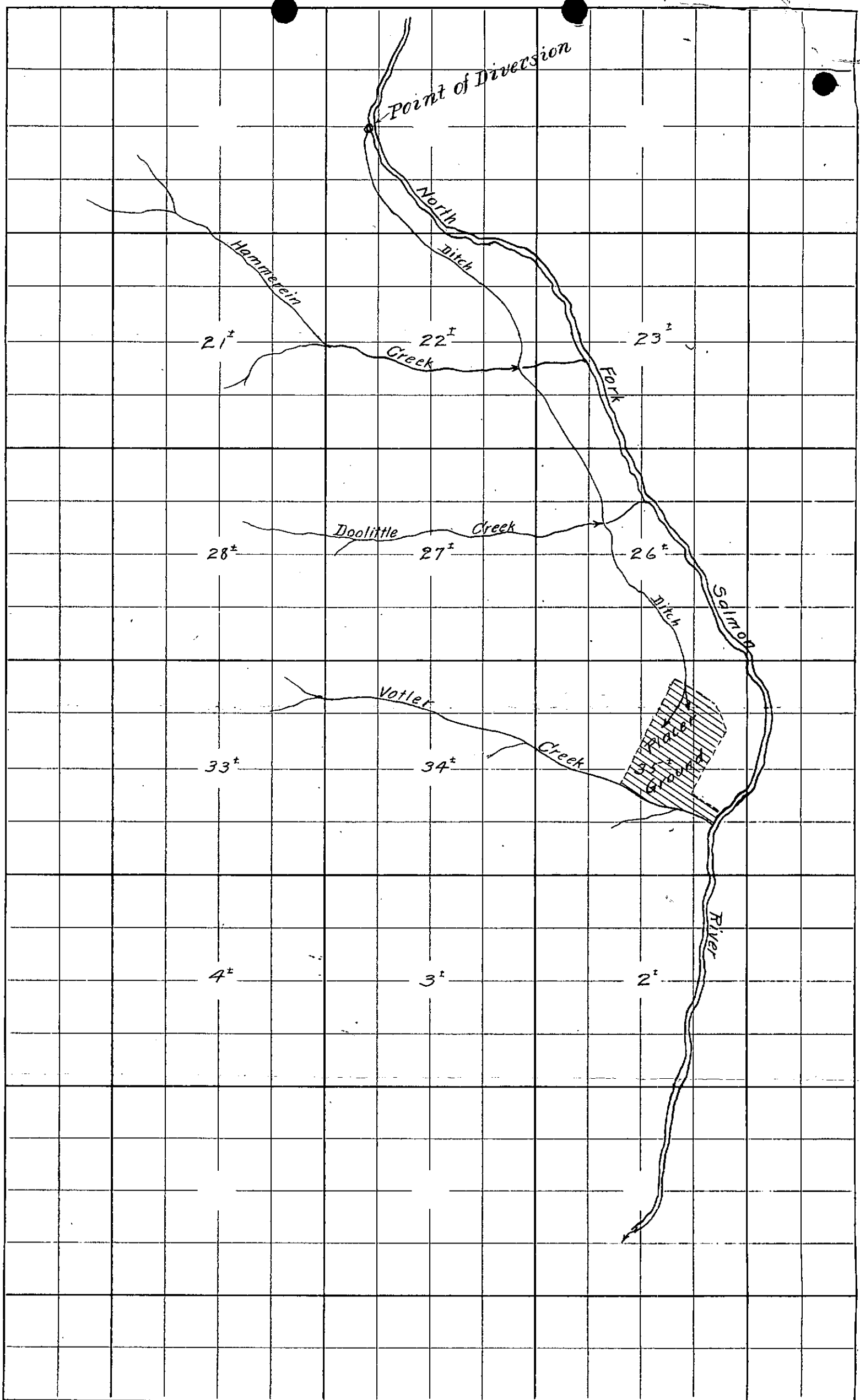

STATE OF IDAHO
DEPARTMENT OF RECLAMATION
BOISE, IDAHO

REPORT OF ENGINEER

Permit No. 17076

This proof is for COMPLETION OF WORKS

In Water District No. _____

1. Name of applicant A. D. Burrow and Roy L. Shaw
2. Source of water supply: North Fork of Salmon River
3. Location of point of diversion: Is in one mile above confluence of Hammerein Creek and
North Fork of Salmon River, unsurveyed of Section _____
T _____ R _____ County of Lemhi

4. Describe works as they exist, giving dimensions and capacities of same: Diversion dam of
rocks & earth 3 ft. high & 40 ft. long. Headgate 4 ft. wide.
4 ft. high & 10 ft. long. Canal 3 ft. wide & 2.5 ft. deep
Capacity 10 Second feet
Head flume and steel pipe at lower end of ditch
on mining claim

5. Water is used for: Mining and Power
6. State whether or not water has been turned into works of diversion: yes

7. List legal subdivisions of lands to be irrigated. If proof is for beneficial use, give exact number of acres
under cultivation in each forty-acre tract. (Describe manner and place of use if for other than irriga-
tion): _____

(Submit map on attached plat, showing location and details of above description.

8. What large stream would the water here appropriated finally reach? Salmon River

Remarks: The waters of two small creeks are interrupted
by the main canal and at times of water shortage
may be picked up and used as a supplement
to the North Fork diversion

17076

This examination was made on the 15th day of July, 1932

(Signed) Fred W. Johnson
Examiner.

Amos D. Burrow, and
Roy L. Shaw, Gibbonsville,
Idaho.
Permit No.....17076.....

77

Examination for.....Completion of Works.....

County.....Lemhi.....

INSTRUCTIONS TO EXAMINERS

1. Always carefully note the location of the point of diversion and accurately plat same.
 2. When proof is for beneficial use, carefully check up the number of acres actually irrigated in each forty and accurately plat same.
 3. Make a map showing the correct location of streams and ditches, and the irrigated lands, and any adjacent permanent landmarks, such as towns, lakes, large streams and public roads.
 4. If any unusual conditions are discovered, make a plain statement of them under remarks.
 5. Always see the holder, if possible, and go over the whole ground with him and make your report only upon actual existing facts and conditions.
-

May
11th
1932

RE: PERMIT No. 17076
Amos D. Burrow -
Roy L. Shaw

MR. A. E. FERGUSON
Salmon, Idaho

Dear Sir:

Deposition of the holder and depositions of two witnesses in connection with proof of COMPLETION OF WORKS on the above permit have been received; also the affidavit of publication. The depositions are satisfactory. These papers will be placed on file until the time when a field engineer from this Department can make a field examination of the diversion works. At such time you will be further notified as to fees due before the certificate of COMPLETION OF WORKS is issued.

Very truly yours,

R. W. FARIS
Commissioner of Reclamation

By _____
Chief Clerk

PH/LP

17076

PERMIT NO. 17076

Proof of Completion of Works

DEPOSITION OF HOLDER

Ques. 1. State your name, residence, occupation and postoffice address.

Ans. A. D. Burrow, Gibbonville, Idaho; Miner, Gibbonville, Ida.
Roy L. Shaw, North Fork, Idaho; Rancher, North Fork, Idaho.

Ques. 2. If acting in behalf of a corporation, state its name, principal place of business, your position with reference to same, and your authority for appearing in its behalf.

Ans. _____

Ques. 3. State number and date of permit, amount of water you are authorized to divert, source, and point of diversion.

Ans. No. 17076, April 26, 1929, 10 second feet, North Fork of
Salmon River, one mile above confluence of Hammerin Creek and North
Fork of Salmon River.

Ques. 4. State purpose for which water is to be used, and, if for irrigation, state the number of acres and give description of the land you intend to reclaim.

Ans. Mining and Power, Sundown Placer Claim.

Ques. 5. State whether or not the water has been turned into your works of diversion, and, if so, when and to what extent.

Ans. Yes; September 1931; approximately 2 second feet.

Ques. 6. State whether or not the works of diversion are fully completed, and whether or not they comply in all respects with the terms of the permit.

Ans. Yes; Yes.

Ques. 7. If the works of diversion do not comply with all the terms of your permit, state fully those particulars in which there is any variance.

Ans. _____

Ques. 8. Give description of works, state dimensions and capacity of each part, and give cost of same.

Ans. Earth and stone dam 3ft. high, 40' length on top, 30' at base;
headgate 4' width, 4' height; earthen canal 4½ miles in length with
width 3' at bottom, 6' at water line, depth of water 2.5', and grade
10' per mile, capacity 10 second feet.

(Sign here.)

A. D. Burrow
Roy L. Shaw

I hereby certify that the foregoing testimony was read to the above subscriber before its signing, that I believe ^{them} to be the persons ^{themselves} he represents himself to be, and that said testimony was subscribed and sworn to before me, in Salmon

County of Lemhi, State of Idaho, on this 26th.
day of April, A. D. 1932.

My Commission expires _____
Clerk of the District *W. W. Simmons*
Court in and for Lemhi County, State of, Idaho. 17076

The Depositions of two Witnesses, in this form, taken separately, required in each case.

Permit No. 17076

Proof of Completion of Works**DEPOSITION OF WITNESS**

Ques. 1. State your name, residence, occupation and postoffice address.

Ans. Charles Trowbridge, Gibbonsville, Ida., Service Sta.,
Gibbonsville, Ida.Ques. 2. Are you acquainted with A. D. Burrow & Roy L. Shaw, the
holders of Permit No. 17076, authorizing the diversion of 10 second-feet of the
waters of North Fork of Salmon River, at Gibbons-
ville, Ida.
for Mining & Power purposes? How long have you known them, and where does he reside?Ans. Yes; A. D. Burrow, 8 yrs., Gibbonsville, Ida. Roy L. Shaw,
3 Yrs., North Fork, Ida.Ques. 3. Have you read or heard read said Permit No. 17076, and are you familiar
with its terms and conditions?

Ans. Yes; Yes.

Ques. 4. (If for irrigation purposes). Are you acquainted with the land proposed to
be irrigated under said permit? If so, describe same, state its character, and give your
estimate of the amount of water required for its profitable cultivation.

Ans.

Ques. 5. Are the works of diversion fully completed and of sufficient capacity to con-
vey the entire amount of water set out in the permit from point of diversion to place of use?

Ans. Yes.

Ques. 6. Describe the works of diversion as they now exist, and give your estimate of
their capacity.Ans. Earth and stone dam, earthen canal $4\frac{1}{2}$ miles in length,
10 second feet.(Sign here.) *Charles Trowbridge*

I hereby certify that the foregoing testimony was read to the above subscriber before
its signing, that I believe him to be the person he represents himself to be, and that said
testimony was subscribed and sworn to before me, at my office in Salmon,
County of Lemhi, State of Idaho, on this 26th
day of April, A. D. 1932.

17076

W. W. Simmons
Clerk of the District Court in and
for Lemhi County, State of Idaho.

The Depositions of two Witnesses, in this form, taken separately, required in each case.

Permit No. 17076

Proof of Completion of Works**DEPOSITION OF WITNESS**

Ques. 1. State your name, residence, occupation and postoffice address.

Ans. Edgar E. Suydam, North Fork, Ida., Rancher, North Fork, Ida.

Ques. 2. Are you acquainted with A. D. Burrow & Roy L. Shaw, the holders of Permit No. 17076, authorizing the diversion of 10 second-feet of the waters of North Fork of Salmon River, at Gibbonsville, Ida. for Mining & Power purposes? How long have you known him, and where does he reside?

Ans. Yes; A. D. Burrow, 8 yrs. Gibbonsville, Ida.; Roy L. Shaw, 3 yrs., North Fork, Ida.

Ques. 3. Have you read or heard read said Permit No. 17076, and are you familiar with its terms and conditions?

Ans. Yes; Yes.

Ques. 4. (If for irrigation purposes). Are you acquainted with the land proposed to be irrigated under said permit? If so, describe same, state its character, and give your estimate of the amount of water required for its profitable cultivation.

Ans.

Ques. 5. Are the works of diversion fully completed and of sufficient capacity to convey the entire amount of water set out in the permit from point of diversion to place of use?

Ans. Yes.

Ques. 6. Describe the works of diversion as they now exist, and give your estimate of their capacity.

Ans. Earth and stone dam, earthen canal $4\frac{1}{2}$ miles in length, 10 second feet.

(Sign here.)

Edgar E. Suydam

I hereby certify that the foregoing testimony was read to the above subscriber before its signing, that I believe him to be the person he represents himself to be, and that said testimony was subscribed and sworn to before me, at my office in Salmon County of Lemhi, State of Idaho, on this 26th day of April, A. D. 1932.

17076

W. W. Simmons
Clerk of the District Court in and for the County of Lemhi, State of Idaho.

Post Office Department

OFFICIAL BUSINESS

REGISTERED ARTICLE

No.

32138

INSURED PARCEL

No.

FEELTY FOR PRIVATE USE TO AVOID PAYMENT OF POSTAGE, \$300

RECEIVED

FEB 13 1932

DEPARTMENT OF RECLAMATION

POSTMAN DELIVERING
OFFICE

932

AND DATE OF DELIVERY

COMMISSIONER OF RECLAMATION

Return to

(NAME OF SENDER)

Street and Number,
or Post Office Box,

BOISE,

IDAHO.

RETURN RECEIPT

Received from the Postmaster the Registered or Insured Article, the original number of which appears on the face of this Card.

(Signature or name of addressee.)

Gregory Anderson admiral
(Signature of addressee's agent.)
Percy Anderson

Date of delivery, *2 - 11 -*, 193*7*

Form 3811

17076

April 28, 1932

Re: PERMIT NO. 17076

Mr. A. E. PERCUSON
Salmon City, Idaho

Dear Sir:

We are herewith returning depositions for BENEFICIAL USE with the request that the depositions be taken on the enclosed blanks for COMPLETION OF WORKS. As you will note the proof which was due on April 26th was for COMPLETION OF WORKS rather than for BENEFICIAL USE. The proper publication was made, so please return the affidavit of the publisher with the depositions for Completion of Works.

The permit holders will not lose any rights since the wrong depositions were mailed from this Department. When the depositions are taken please have them dated as of April 26th.

It is noted that you refer to a deed to the Sundown Mining Claim which is supposed to be in this office. It is quite evident that this deed does not refer to the above mentioned permit, since the application was made by Percy Anderson and later assigned to Amos D. Burrows and Roy L. Shaw. If you will give us some further information concerning this deed, we will attempt to locate it for you.

Very truly yours,

R. W. FARIS
Commissioner of Reclamation

By _____
Chief Clerk

PH/LP
Encls.

17076

~~FRED GRANSALL, C. E.~~
COUNTY SURVEYOR, LEMHI COUNTY
U. S. DEPUTY MINERAL SURVEYOR
STATE LICENSED ENGINEER
SALMON, IDAHO

April 26, 1932.

Mr. R. W. Faria,
Commissioner of Reclamation,
Boise, Idaho.

Dear Sir:-

Enclosed please find papers in connection with proof of beneficial use of Permit NO. 17076, deposition of permit holder, deposition of two witnesses, and affidavit of publication. Also I wish to call your attention to the deed to the "Sundown" Mining Claim, which the permit holders informs me is now in your charge.

I trust that everything is entered as it should be.

Very truly yours,

A. E. Ferguson

B. U. — 4-26-34

17076

17076

Affidavit of Publication

State of Idaho, }
County of Lemhi } ss.

RALPH B. KNEPPER, being duly sworn, upon oath deposes and says: I am the printer,

NOTICE FOR PUBLICATION

Notice is hereby given that at 2 p. m., on the 26 day of April 1932, at Salmon City, County of Lemhi, State of Idaho, before W. W. Simmonds proof will be submitted of the completion of work for the diversion of 10 cubic feet per second of the waters of North Fork of Salmon River, in accordance with the terms and conditions of a certain permit heretofore issued by the Commissioner of Reclamation of the State of Idaho.

1. The name of the person or corporation holding said permit is Amos D. Burrow and Roy L. Shaw.

2. The postoffice address of such person or principle place of business of such corporation in Gibbonsville, County of Lemhi.

3. The number of such Permit is 17076.

4. Said works of diversion will be fully completed on the date set for such completion, and the amount of water which said works are capable of conducting to the place of intended use, in accordance with the plans accompanying the application for such permit, is 10 cubic feet per second.

R. W. FARIS,
Commissioner of Reclamation.
AMOS D. BURROW,
ROY L. SHAW,
MARGARET B. ANDERSON,
Postmaster.
Mch. 16 to April 6-4t.

publisher, and sole proprietor of the RECORDER HERALD, a newspaper published weekly at Salmon, Lemhi County, Idaho, and of general circulation therein.

That the Notice for Publication

----- a true printed copy of which is attached to the margin hereof, has been and was correctly printed and published in the regular and entire issue of every number of said newspaper and not in any supplement thereof or thereto for

Four consecutive issues, commencing with the issue dated March 16, 19 32

and ending with the issue dated -----
April 5, 19 32

Ralph B. Knepper

Subscribed and sworn to before me, this 26th day of April, 19 32

17076

Ernest H. Heston
Notary Public for the State of Idaho,
Residing at Salmon, Idaho.

Publication Fee \$ 9.00

State of Idaho

DEPARTMENT OF RECLAMATION

BOISE

INSTRUCTIONS

PROOF OF BENEFICIAL USE OF WATER

BOISE, IDAHO,

April 18, 1932

W. W. Simmonds, N. P.
SALMON CITY, IDAHO
DEAR SIR:

I enclose herewith the following forms to be used in connection with proof of beneficial use of water under Permit No. 17076

DEPOSITION OF PERMIT HOLDER, DEPOSITIONS OF TWO WITNESSES.

In submitting this proof the following instructions should be CAREFULLY followed out, since failure to do so may result in the loss of rights:

1. On April 26, 1932, the date set for proof, the enclosed forms (one for permit holder and one each for two disinterested witnesses) should be filled out and sworn to, at

Salmon City, Idaho before W. W. Simmonds, N. P.

2. When the depositions have been taken, they should be mailed to this office, together with affidavit of publication of notice.

When these have been received, together with report of the examining engineer, if everything is properly executed, you will be further advised as to fees due, etc., before certificate is issued.

Yours truly,

R. W. FARIS
Commissioner of Reclamation.

17076

STATE OF IDAHO
DEPARTMENT OF RECLAMATION
BOISE, IDAHO

Date March 9, 1932

RECORDER-HERALD
Salmon, Idaho

DEAR SIR:

Enclosed you will find notice for publication once a week for four consecutive weeks prior to April 26, 1932, the date set for proof, the expense of the publication to be paid by the applicant, Roy L. Shaw and Amos D. Burrow of Gibbonsville, Idaho

to whom you should furnish proof of publication on or prior to the date set for proof.

Please acknowledge receipt of this notice and furnish this office with a copy of the first publication.

Very truly yours,

R. W. PARIS
Commissioner of Reclamation

17076

March 9, 1932

Re: PERMIT NO. 17076

MR. AMOS D. BURROWS
Gibbonsville, Idaho

Dear Sir:

Your notice in duplicate for publication of the application of water to BENEFICIAL USE on the above mentioned permit has been received. A copy of the notice has been mailed to the newspaper for publication. Depositions will be mailed April 19th to W. W. Simmonds, Notary Public at Salmon City, Idaho. When you return the depositions, please send the affidavit of publication from the newspaper.

Very truly yours,

R. W. FARIS
Commissioner of Reclamation

By _____
Chief Clerk

RE/LP

17076

NOTICE TO ACCOMPANY THIS LETTER MUST BE MADE IN DUPLICATE

(Date) Feb 26 - 1932
(P. O.) Gibbonsville

TO THE COMMISSIONER OF RECLAMATION:

Boise, Idaho.

Dear Sir:

You are hereby authorized to have the attached notice published at my expense in the
Recorder-Herald of Salmon-Idaho, published in
the county in which the works are situated.

Amos D Burrow
Roy L Shaw

(In case of canals or other works designed to divert and carry more than 50 cubic feet
of water per second, the following certificate must be signed by a well-known and compe-
tent engineer.)

I hereby certify that the facts set forth in the attached notice are true.

Engineer.

Margaret B Anderson
Postmaster

17076

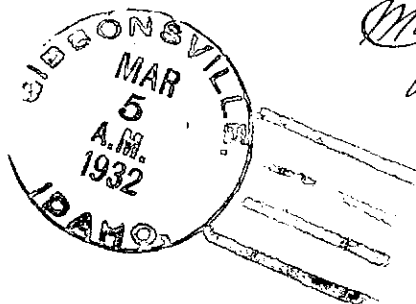

Notice for Publication

Notice is hereby given that at 2 P M., on the 26 day of April, 1932, at Salmon City, County of Lemhi, State of Idaho, before W W Simmonds proof will be submitted of the completion of works for the diversion of 10 cubic feet per second of the waters of North Fork of Salmon River in accordance with the terms and conditions of a certain permit heretofore issued by the Commissioner of Reclamation of the State of Idaho.

1. The name of the person or corporation holding said permit is Amos D Burrow and Roy L Shaw

2. The postoffice address of such person or principal place of business of such corporation is Gibbonsville, County of Lemhi, State of Idaho.

3. The number of such Permit is 17076, and the date set for the completion of such work is April 26 - 1932

4. Said water is to be used for Mining - Milling or Power purposes.

5. Said works of diversion will be fully completed on the date set for such completion, and the amount of water which said works are capable of conducting to the place of intended use, in accordance with the plans accompanying the application for such permit, is 10 cubic feet per second.

6. The amount of lands for which said water is available is _____ acres, particularly described as follows:

Amos D Burrow
Roy L Shaw

17076

R. W. FARIS

Commissioner of Reclamation.



Margaret B. Anderson
Postmaster

Gibbonsville - Id

1076 March 5th 1932

Commissioner of Reclamation
Boise - Idaho

Dear Sir:-

You will find enclosed Notice for Publication
which I hope you will find correct -

So far as the engineer is concerned
Fred Crandell of Salmon who tended
to all the work done in connection with
survey and etc in connection with this permit
is now dead - And another A E Ferguson is
now County Surveyor -

Yours Respectfully

Anna D Burrow
Gibbonsville
Idaho.

March 1, 1932

Re: Permit No. 17076

MR. AMOS D. BURROWS
Gibbonsville, Idaho

Dear Sir:

We are herewith returning Notice for Publication, in order that it may be corrected. We are also enclosing blank notice for publication in duplicate with the suggestion that you make a new notice rather than attempt to revise the old one. Please write in the name of the Notary Public before whom proof will be offered, where you have written County Recorder. It is not necessary to give your land list, since your permit is not for irrigation purposes.

After you have completed the notice, please mail it with the form # 11 which is a letter of authorization from you to the Department to have the Notice published at your expense.

Very truly yours,

R. W. FARIS
Commissioner of Reclamation

By _____
Chief Clerk

PH/lp

17076

Gibbonsville Id

Feb 26th 1932

State of Idaho

Department of Reclamations
Boise - Idaho

Dear Sirs:

You will find enclosed notice of Publication
which I hope is filled out correctly
Not having heard from you since I sent
the deed I got the papers you sent to
Percy Anderson - I got them from
Gregor Anderson the administrator
of the estate. - If I have made any
mistakes please correct them
I have to mail this today to be
inside the 60 days required

Yours Truly

Ann O'Brien
Gibbonsville
Id

February 12th
1932

Re: Permit No. 17076

Mr. A. D. Burrow
Gibbonsville, Idaho

Dear Sir:

This is to inform you that there are two proofs to be made in the process of obtaining a license on any permit. The first proof is for completion of works, and is for the purpose of showing that the permit holder has completed his diversion works according to the terms of his permit. The second proof is to show that the water has been put to a beneficial use whether that use may be for mining, irrigation, etc.

Proof of completion of works is due on the above permit on April 26, 1932. The necessary papers are mailed out from this Department about 60 days prior to the date when the proof is due, and the papers for the above numbered permit were mailed sometime ago to Mr. Percy Anderson.

Since you are now the holder of Permit No. 17076, you should mail us your deed or contract showing the purchase of the above permit so that an assignment to you can be effected upon our records. Proof of beneficial use isn't due on this permit until April 26, 1934. The necessary papers for making your proof will be mailed in due time.

Very truly yours,

R. W. FARIS
Commissioner of Reclamation

By _____
Chief Clerk

PH/LP

17076

Gibberville Id

Feb 8th - 1932

17076

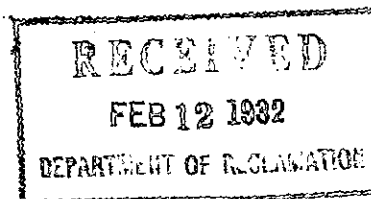

Commissioner of Reclamation
Boise - Idaho

Dear Sir:-

I have here the Sundown Placer and
waterright Permit No 17076- Approved April
6th, 1929 Which I purchased from
Percy Anderson (now deceased)

I have finished the ditch this last fall
and put water through it-

I havent set up my Giants yet and it will
probably be July before I get them working-

I dont really understand whether I have
to make one proof or two proofs

one June 1st and one 2 year later or not

How is the proof to be made and when and
etc- Please explain all this to me

Yours Truly

P.S.

A D Burrow

I have to build some waste ditcher to take care of
waste water and build penstocks + etc-

I have five Giants on the ground not set up-

17076

Form No. 7

REGISTERED
RETURN RECEIPT REQUESTED

STATE OF IDAHO

DEPARTMENT OF RECLAMATION

BOISE

INSTRUCTIONS

PROOF OF COMPLETION OF WORKS

Percy Anderson
Salmon, Idaho

Boise, Idaho

February 6, 1932

DEAR SIR:

I enclose herewith blank form upon which to give notice that you are prepared and desire to submit proof of completion of works under your permit No. 17076

This form should be filled out and mailed to the Department of Reclamation, at least 60 days before the date upon which proof is to be submitted, which proof MUST be on or before April 26, 1932. Upon receipt of the blank properly filled out, notice for publication will be sent to the paper direct from this office, which notice must be published a period of four weeks prior to the date of proof.

The proof may be submitted at any place convenient to you and two witnesses, where there is a notary public or other officer authorized to administer oaths.

The certificate that shall be issued under this proof does not give you a perpetual right to the use of the water for which application is made, as it only confirms the completion of the works of a capacity to divert and convey to the place of intended use a certain amount of water. The law requires that another proof be submitted when the water has been fully applied to a beneficial use, at which time license is issued for the amount of water actually in use. Information in regard to this last proof will be furnished on request.

Very truly yours,

R. W. FARIS

Commissioner of Reclamation.

17076

State of Idaho
DEPARTMENT OF RECLAMATION
BOISE

Permit No. 17076-Percy Anderson

Mr. Fred Crandall
Salmon, Idaho

Boise, Idaho, April 26, 1929.

Dear Sir:

I enclose herewith above numbered permit. BE SURE AND
NOTE LIMITATIONS AND CONDITIONS OF SAME as
given under approval of the Commissioner of Reclamation on
the third page.

GEO. N. CARTER
Commissioner of Reclamation.

17076

Name of Applicant: PERCY ANDERSON. 17076

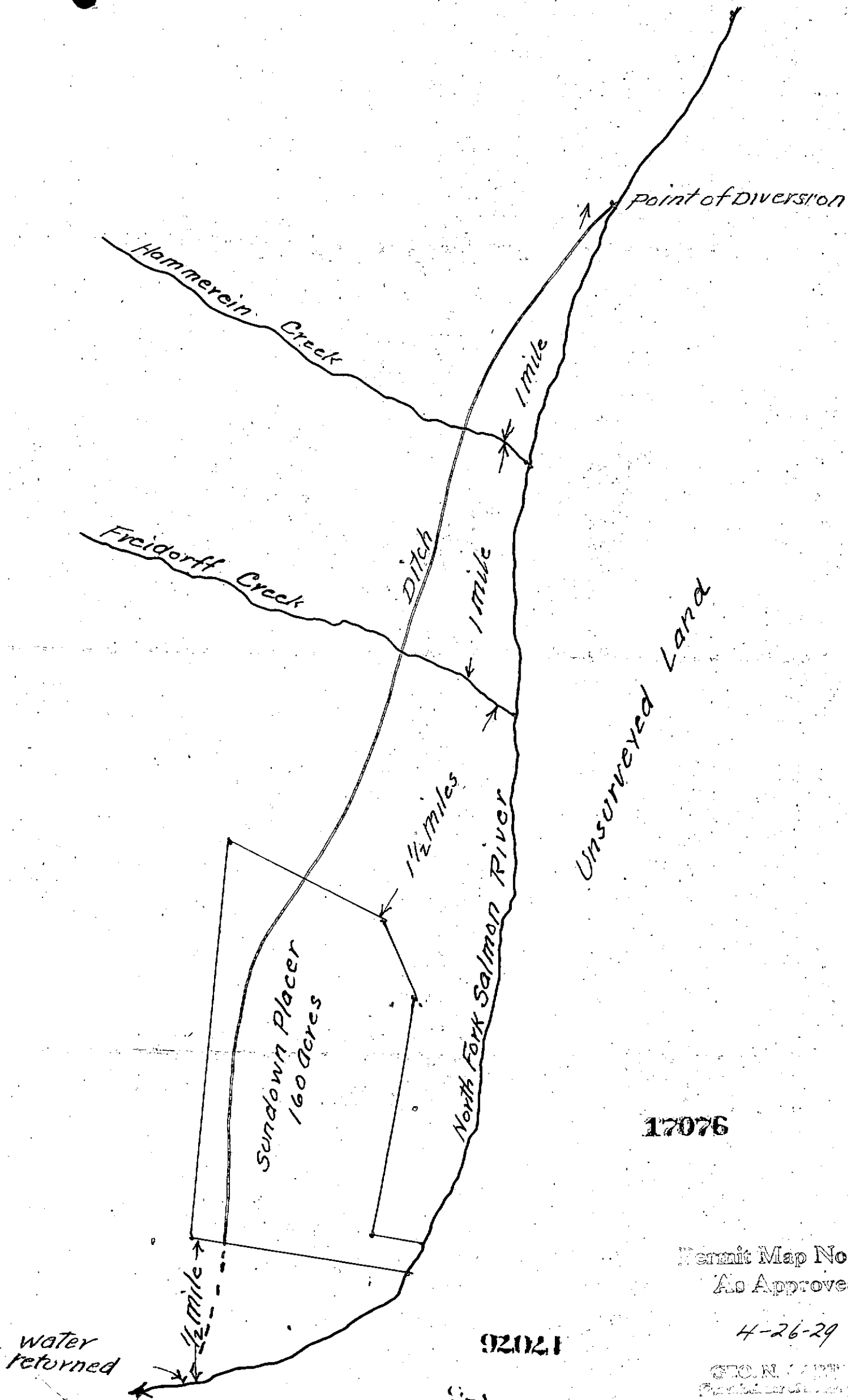

17076

Hermit Map No. 17076

As Approved

4-26-29

GEO. N. SMITH
San Francisco, Calif.

92021

State of Idaho
H. C. BALDRIDGE, GOVERNOR
DEPARTMENT OF RECLAMATION
GEO. N. CARTER, COMMISSIONER
BOISE

17076

April 8, 1929

MR. FRED CRANDALL
Salmon, Idaho

Dear Sir:

This is to advise you that the recent session of the Legislature enacted a law, known as House Bill No. 305, increasing the filing fees on applications for permits to \$5.00 for the first second feet of water and \$0.25 for each additional second foot or fraction.

We are, therefore, returning the application of Percy Anderson for fees in the amount of \$7.25. The Money Order for \$1.90 is also returned.

Very truly yours,

GEO. N. CARTER
Commissioner of Reclamation

By *Samuel Lane*

Encs-2

Percy:-

This is a new one, do you want to go this strong? If so add additional P.O.

F.C.

17076