

11. Map of proposed project: show clearly the proposed point of diversion, place of use, section number, township and range number.

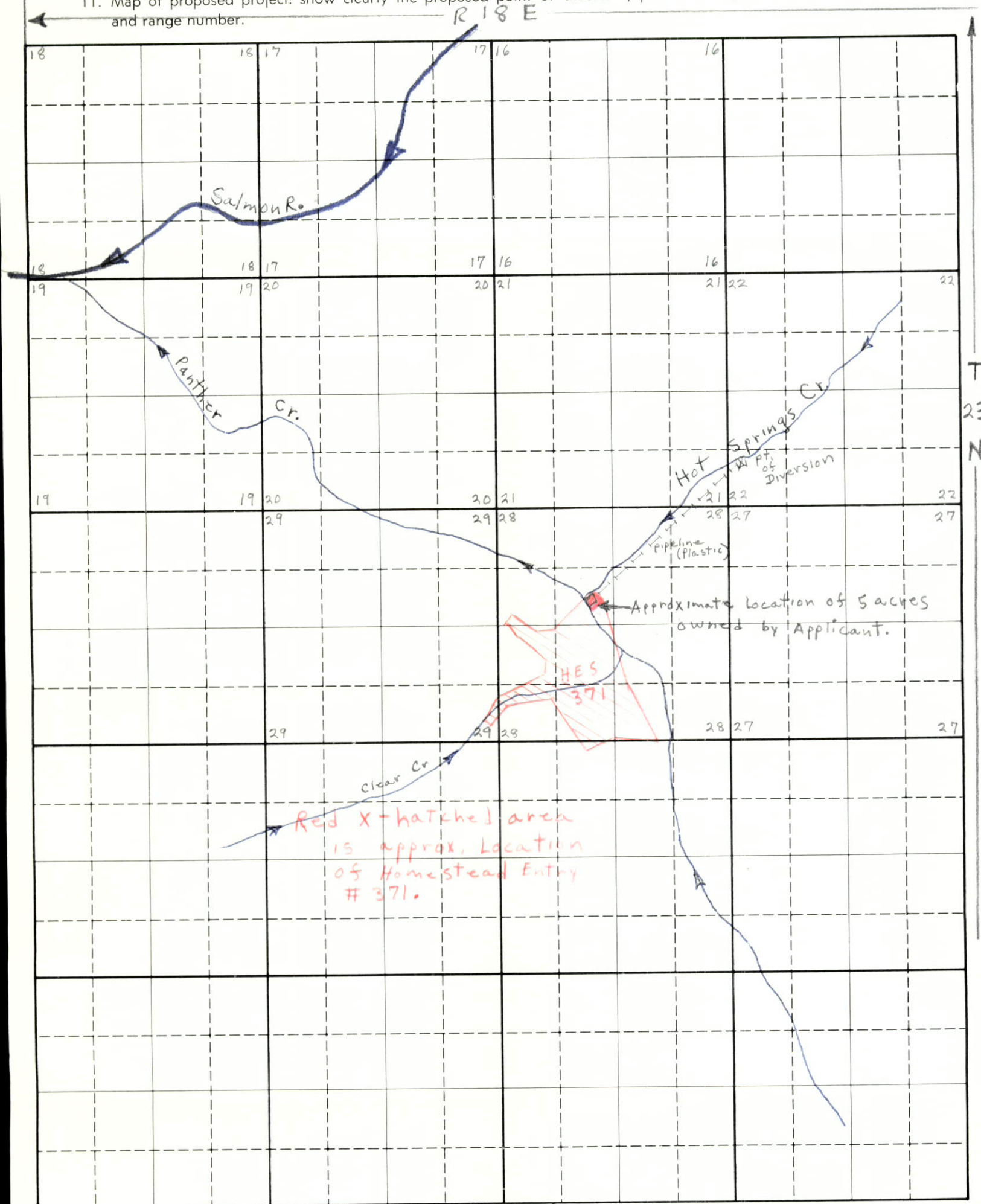

Scale: 2 inches equal 1 mile

BE IT KNOWN that the undersigned hereby makes application for permit to appropriate the public waters of the State of Idaho as herein set forth.

X Kathleen Wade  
(Applicant)

X Richard L. Wade  
(Applicant)

75-7012

RECEIVED

# Affidavit of Publication

Department of Water Administration  
1971

STATE OF IDAHO }  
County of Lemhi } ss.

JERRY G. ROSIN

being first duly sworn, deposes and says that he is one of the printers (publisher) of the RECORDER HERALD, a newspaper published weekly at Salmon, Lemhi County, Idaho, and of general circulation therein,

That the Notice of Application for Water Permit

No. 75-7012 a true printed copy of which is attached to the margin hereof, has been and was correctly printed and published in the regular and entire issue of every number of said newspaper and not in any supplement thereof or thereto for 2 consecutive issues, commencing with the issue dated May 6, 1971 and ending with the issue dated May 13, 1971

*Jerry G. Rosin*  
thirteenth

Subscribed and sworn to before me, this \_\_\_\_\_ day of May, 1971

*Verle Armstrong*  
Notary Public for the State of Idaho,  
Residing at Salmon, Idaho

Publication Fee \$ 7.92

75-7012

## NOTICE OF APPLICATION FOR WATER PERMIT

Notice is hereby given that Richard L. and Kathleen Hade, Shoup, Idaho, have on April 21, 1971, submitted Application No. 75-7012 for a permit to appropriate 0.08 cubic feet per second of water from Hot Springs Creek, tributary to Panther Creek, by means of pipe within the SW $\frac{1}{4}$ SW $\frac{1}{4}$  Sec. 22, T. 23N, R. 18E, B. M., Lemhi County, (unsurveyed) to be used from April 1 to Nov. 1 for the irrigation of 3 acres and from Jan. 1 to Dec. 31 for domestic purposes within Homestead Entry No. 371.

If issued this permit will be subject to all prior water rights. Protests against the granting of the permit must be filed with the Idaho Department of Water Administration, Statehouse, Boise, Idaho, 83707, on or before May 24, 1971.

R. KEITH HIGGINSON  
Director

Published in the Recorder Herald, Salmon, Idaho, on May 6 and May 13, 1971.

5-6-2tc



Rge 18E

Twp 23N



Diagram of System

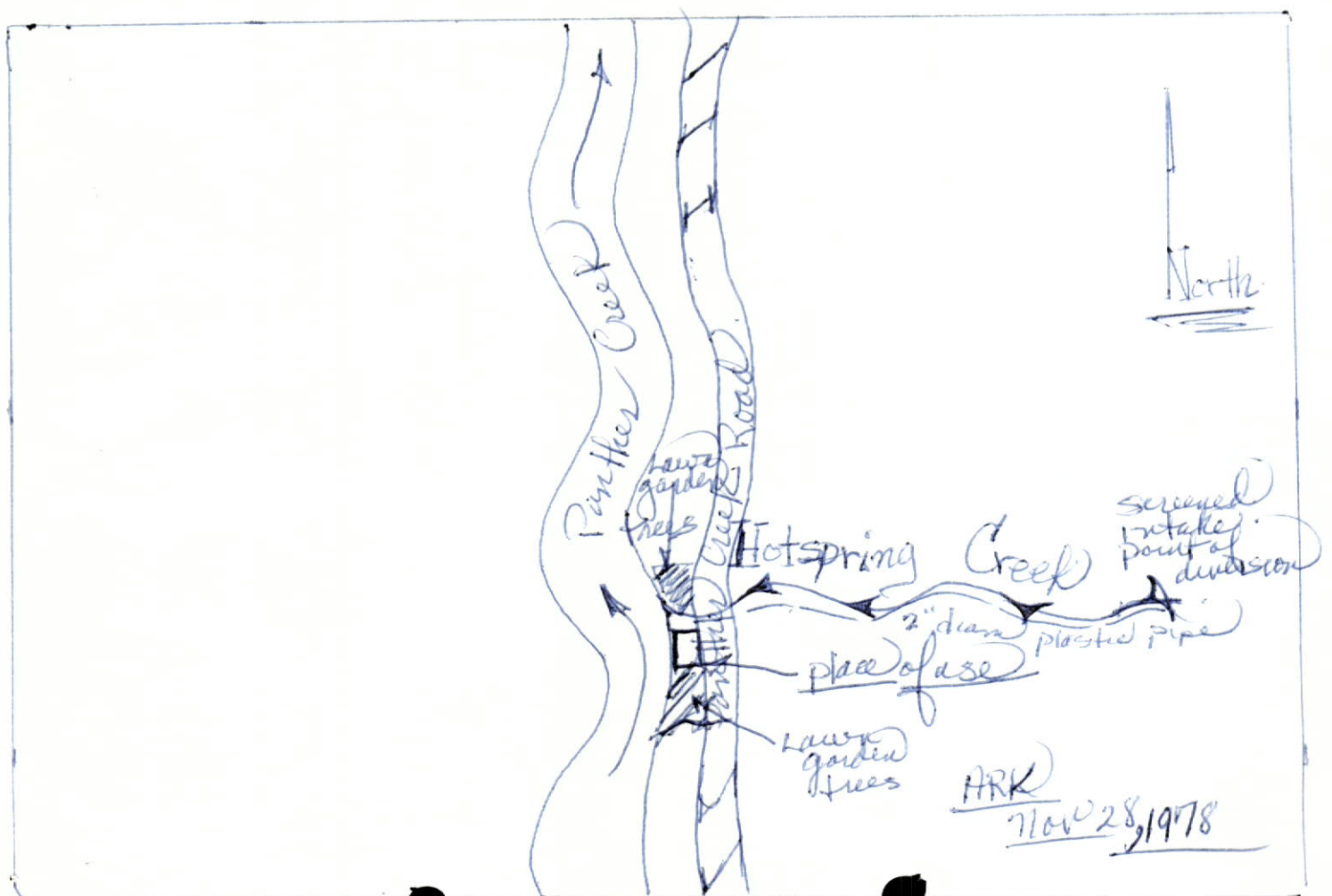

State of Idaho  
Department of Water Resources

WATER RIGHT LICENSE

License of Water Right No. 75-7012 Priority April 21, 1971 Amount 0.02 cfs

THIS IS TO CERTIFY, that RICHARD L & KATHLEEN HADE  
of Shoup, Idaho, has complied with the terms and conditions of Permit  
No. 75-7012 issued pursuant to Application for Permit dated April 21, 1971,  
and has submitted proof to the Department of Water Resources on May 30, 1978,  
that he has applied water to a beneficial use; an examination by the Department indicates that the works have a  
capacity for the diversion of 0.02 cfs of water from Hot Springs Creek,  
tributary to Panther Creek, and that the permit holder has applied to a beneficial use and  
established a right to use water as follows:

Beneficial Use	Period of Use	Rate of Diversion	Annual Volume
Domestic	from <u>January 1</u> to <u>December 31</u>	at <u>0.02</u> cfs and	<u>1.2</u> acre feet
	from _____ to _____	at _____ cfs and	_____
	from _____ to _____	at _____ cfs and	_____

(both dates inclusive)

Subject, however, to the condition that no more than 0.02 cfs of water be diverted at any one time, and  
that the amount of water so diverted and to which such right is entitled and confirmed is for the purpose  
aforementioned and is limited to the amount which can actually be beneficially used and shall not exceed  
1.2 acre feet per-year, said waters to be diverted within the SE 1/4 NW 1/4 Sec. 28, Twp. 23N,  
Rge. 18E, B.M. in the County of Lemhi

Description and location of place of use:

Twp.	Range	Sec.	NE 1/4				NW 1/4				SW 1/4				SE 1/4				Totals
			NE 1/4	NW 1/4	SW 1/4	SE 1/4	NE 1/4	NW 1/4	SW 1/4	SE 1/4	NE 1/4	NW 1/4	SW 1/4	SE 1/4	NE 1/4	NW 1/4	SW 1/4	SE 1/4	
23N	18E	28								X									

Total number of acres irrigated \_\_\_\_\_

NOTE: Modifications to or variance from this license must be made within the limits of Section 42-222, Idaho Code, or the applicable Idaho Law. This right may be forfeited by five years of non-use.

The right to the use of the water hereby confirmed is restricted and appurtenant to the lands or place of use herein described, as provided by the laws of Idaho.

Witness the seal and signature of the Director, affixed at Boise, Idaho, this 14 day of  
July, 19 80.

Director

DET

OF THE  
STATE OF IDAHO

ORDER

WHEREAS, on June 17, 1971, the Department approved said application and issued Permit No. 75-7012 with the condition that proof of construction of works and application of water to beneficial use be submitted to the Department on or before June 1, 1976; and,

WHEREAS, it appears that under the circumstances, the permit holders have been proceeding with reasonable diligence and have given good cause for delay;

Dated this 4 day of May, 1976.

Administrator, Operations Division

Identification No. 75-7012

Application No. \_\_\_\_\_

**STATE OF IDAHO**  
**DEPARTMENT OF WATER ADMINISTRATION**  
**APPLICATION FOR PERMIT**

**APPROVED**

**To Appropriate the Public Waters of the State of Idaho**  
(TYPE OR PRINT IN INK)

1. Name of applicant Richard L. and Kathleen Hade  
post office address Shoup, Idaho 83469
2. Source of water supply Hot Springs Creek which is a tributary of Panther Creek
3. a. Location of point of diversion is Unsurveyed SW  $\frac{1}{4}$  of SW  $\frac{1}{4}$  of Section 22 Township 23N  
Range 18E B.M. Lemhi County; additional points of diversion if any: None
- b. If water is not consumed, it will ~~be discharged into~~ Not be Diverted at a point in SW  $\frac{1}{4}$  of SW  $\frac{1}{4}$  of Section \_\_\_\_\_ Township \_\_\_\_\_ Range \_\_\_\_\_ B.M. \_\_\_\_\_
4. Water will be used for the following purposes:  
Amount 0.02 for Domestic purpose from 1 Jan. to 31 Dec. (both dates inclusive)  
(cfs or acre-feet per annum)  
Amount 0.06 for Irrigation purpose from 1 April to 1 Nov. (both dates inclusive)  
(cfs or acre-feet per annum)  
Amount \_\_\_\_\_ for \_\_\_\_\_ purpose from \_\_\_\_\_ to \_\_\_\_\_ (both dates inclusive)  
(cfs or acre-feet per annum)
5. Total quantity to be appropriated:  
a. 0.08 cubic feet per second and/or  
b. \_\_\_\_\_ acre feet per annum.
6. Proposed diverting works:  
a. Description of ditches, flumes, pumps, headgates, etc. Applicant proposes to use  
600' - 650' of 2" plastic pipe which will terminate at the house.
- b. Height of storage dam \_\_\_\_\_ feet, active reservoir capacity \_\_\_\_\_ acre feet; total reservoir capacity \_\_\_\_\_ acre feet, materials used in storage dam: \_\_\_\_\_  
Period of year during which storage will occur \_\_\_\_\_ (Mo. Day) to \_\_\_\_\_ (Mo. Day) inclusive.
- c. Proposed well diameter is \_\_\_\_\_ inches; proposed depth of well is \_\_\_\_\_ feet.
7. a. Time required for the completion of the works and application of the water to the proposed beneficial use is 5 years.  
b. Estimated construction cost is \$ 250.00.
8. Description of proposed uses:  
a. If water is **not** for irrigation:  
(1) Give the place of use of water: \_\_\_\_\_  $\frac{1}{4}$  of \_\_\_\_\_  $\frac{1}{4}$  of Section \_\_\_\_\_ Township \_\_\_\_\_ Range \_\_\_\_\_ B.M. \_\_\_\_\_  
(2) Amount of power to be generated: \_\_\_\_\_ hp under \_\_\_\_\_ feet of head.  
(3) List number of each kind of livestock to be watered Two or Three head of cattle will be watered.  
(4) Name of municipality to be served \_\_\_\_\_, or number of families to be supplied with domestic water \_\_\_\_\_.  
(5) If water is to be used for other purposes describe: \_\_\_\_\_

75-7012

b. If water is for irrigation, indicate acreage in each subdivision in the tabulation below:

TWP.	RANGE	SEC.	NE¼				NW¼				SW¼				SE¼				TOTALS
			NE¼	NW¼	SW¼	SE¼	NE¼	NW¼	SW¼	SE¼	NE¼	NW¼	SW¼	SE¼	NE¼	NW¼	SW¼	SE¼	
23N	18E	27, 28					(This area has not been surveyed by Government)												3
							The irrigated three acres is within												
							homestead entry #371.												

Total number of acres to be irrigated 3

c. Describe any other water rights used for the same purposes as described above. None

9. a. Who owns the property at the point of diversion U. S. Forest Service

b. Who owns the land to be irrigated or place of use Applicant

c. If the property is owned by a person other than the applicant, describe the arrangement enabling the applicant to make this filing. The point of diversion is presently on U. S. Forest Service property.

10. Remarks Water for irrigation and domestic purposes has been used for a number of years on this property. The permit process was started by Rollie and Rose Shoup but the process was not completed. The original permit of the Shoup's is being held for cancellation.

Applicant desires to initiate a new statutory right and let the Shoup permit be cancelled.

Applicant's property (5 acres) is part of Homestead Entry #371

11. Map of proposed project: show clearly the proposed point of diversion, place of use; section number, township and range number.

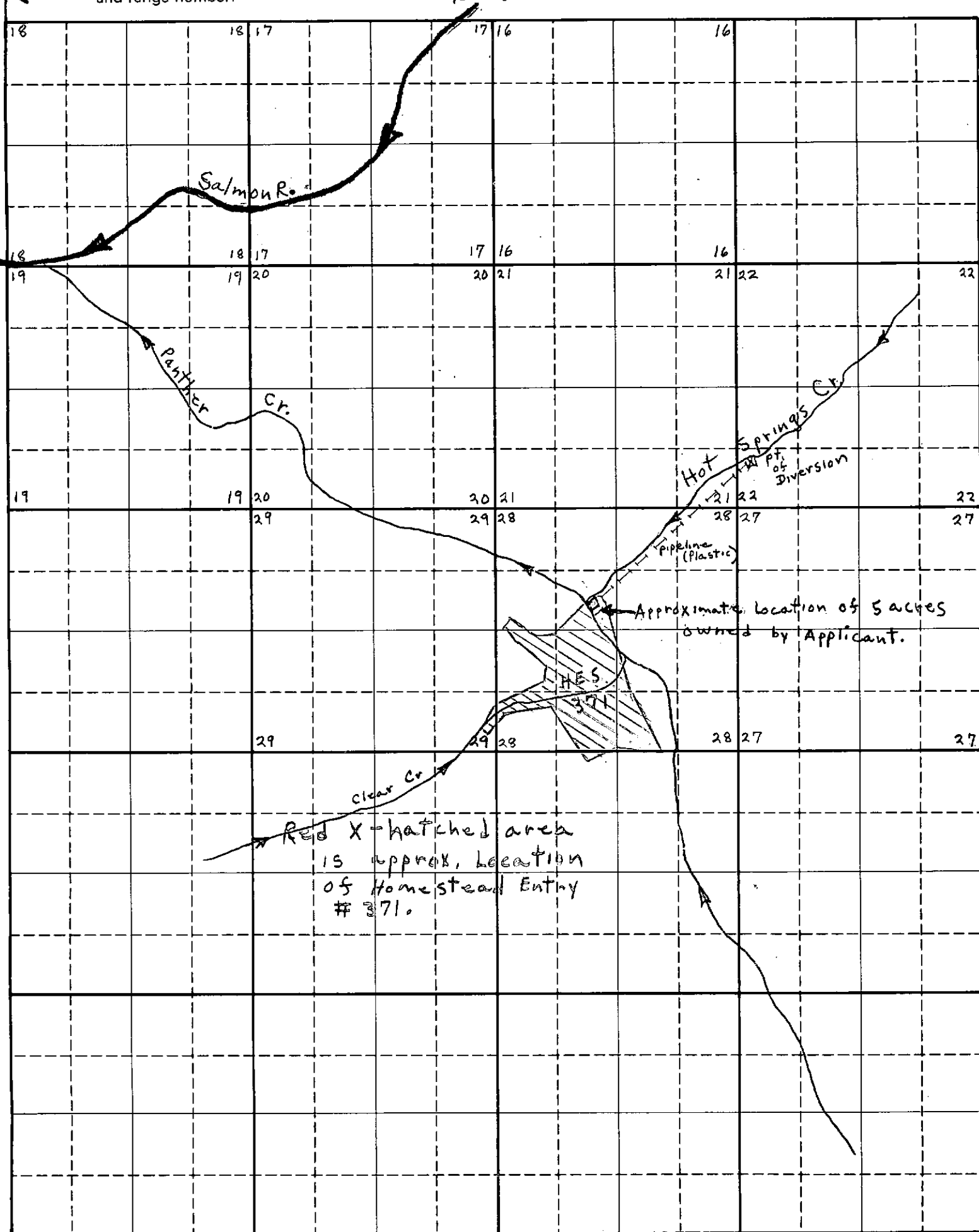

Scale: 2 inches equal 1 mile

BE IT KNOWN that the undersigned hereby makes application for permit to appropriate the public waters of the State of Idaho as herein set forth.

X Kathleen Wade  
(Applicant)

X Richard L. Wade  
(Applicant)

75-7012



75-7012

Received by 4 Date 4-21-71 Time 8:00a  
Preliminary check by D Fee \$ 10<sup>00</sup>  
Receipted by 4 Date 4-21-71  
Publication prepared by dr Date 4-28-71  
Published in Recorder=Herald  
Publication dates 5-6 & 5-13, 1971  
Publication approved sk Date 5-27-71  
Priority reduced to \_\_\_\_\_ Reason \_\_\_\_\_  
\_\_\_\_\_  
\_\_\_\_\_  
\_\_\_\_\_  
Protests filed by: \_\_\_\_\_  
\_\_\_\_\_  
\_\_\_\_\_  
Copies of protests forwarded by \_\_\_\_\_  
Hearing held by \_\_\_\_\_ Date \_\_\_\_\_  
Recommended for approval denial by A BDFC

ACTION OF THE DIRECTOR, DEPARTMENT OF WATER ADMINISTRATION

This is to certify that I have examined Application for Permit to appropriate the public waters of the State of Idaho No. 75-7012, and said application is hereby APPROVED.

- 1. Approval of said application is subject to the following limitations and conditions:
  - a. SUBJECT TO ALL PRIOR WATER RIGHTS.
  - b. Proof of construction of works and application of water to beneficial use shall be submitted on or before June 1, 1976.
  - c. Other: \_\_\_\_\_  
\_\_\_\_\_  
\_\_\_\_\_  
\_\_\_\_\_
- 2. Denial of said application is for the following reasons: \_\_\_\_\_  
\_\_\_\_\_  
\_\_\_\_\_  
\_\_\_\_\_  
\_\_\_\_\_

Witness my hand this 17<sup>th</sup> day of June, 1971.

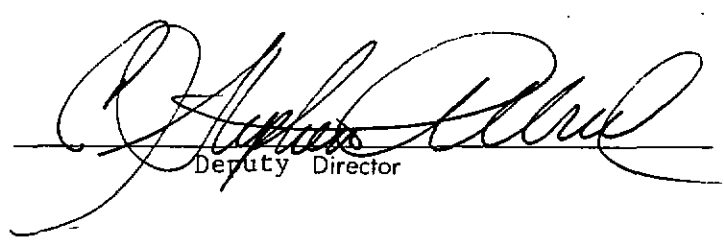
  
Deputy Director

DEPARTMENT OF WATER ADMINISTRATION

STAFF ANALYSIS

Application No. 75-7012 Name Richard L. and Kathleen Hade

Source Hot Springs Creek

Point of Diversion SW $\frac{1}{4}$ SW $\frac{1}{4}$ , Sec. 22, T. 23N, R. 18E, B.M., Leahy Co. (unsurveyed).

Quantity .02 Use Domestic Period Jan. 1 - Dec. 31

Quantity .06 Use Irrigation Period April 1 - Nov. 1

Quantity        Use        Period       

Well Size        Diameter        Proposed Depth        Feet

Use 3 acres - 2 or 3 head of cattle will be watered

Date Forwarded 4-27-71 Date Returned 4-29-71 Received by LL

COMMENTS: Flow measurements are not available for Hot Springs Creek.

RECOMMENDED:

Applied: Qty. .02 Use Dom. Period 1-1 to 12-31 AF/A - AF 1.0

Qty. .06 Use Irrig Period 4-1 to 11-1 AF/A 3.0 AF 9.0

Qty.        Use        Period        AF/A        AF       

Maximum: Qty. .02 Use Dom. Period 1-1 to 12-31 AF/A - AF 1.0

Qty. .06 Use Irrig Period 4-1 to 11-1 AF/A 3.0 AF 9.0

Qty.        Use        Period        AF/A        AF       

ACTION: Approved X Denied       

Conditions of approval or reason for denial:       

INVESTIGATION By Norman C. Young Title (D.R. Eng.)

Date 4-28-71

75-7012

RECEIVED

# Affidavit of Publication

May 1971  
Department of Water Administration

STATE OF IDAHO }  
County of Lemhi } ss.

JERRY G. ROSIN

being first duly sworn, deposes and says that he is one of the printers (publisher) of the RECORDER HERALD, a newspaper published weekly at Salmon, Lemhi County, Idaho, and of general circulation therein,

That the Notice of Application for Water Permit

No. 75-7012 a true printed copy of which is attached to the margin hereof, has been and was correctly printed and published in the regular and entire issue of every number of said newspaper and not in any supplement thereof or thereto for 2 consecutive issues, commencing with the issue dated May 6, 1971 and ending with the issue dated May 13, 1971

*Jerry G. Rosin*  
thirteenth

Subscribed and sworn to before me, this day of May, 1971

*Verle Armstrong*  
Notary Public for the State of Idaho,  
Residing at Salmon, Idaho

Publication Fee \$ 7.92

75-7012

## NOTICE OF APPLICATION FOR WATER PERMIT

Notice is hereby given, that Richard L. and Kathleen Hade, Shoup, Idaho, have on April 21, 1971, submitted Application No. 75-7012 for a permit to appropriate 0.08 cubic feet per second of water from Hot Springs Creek, tributary to Panther Creek, by means of pipe within the SW $\frac{1}{4}$ SW $\frac{1}{4}$  Sec. 22, T. 23N, R. 18E, B. M., Lemhi County, (unsurveyed) to be used from April 1 to Nov. 1 for the irrigation of 3 acres and from Jan. 1 to Dec. 31 for domestic purposes within Homestead Entry No. 371.

If issued this permit will be subject to all prior water rights. Protests against the granting of the permit must be filed with the Idaho Department of Water Administration, State House, Boise, Idaho, 83707, on or before May 24, 1971.

R. KEITH HIGGINSON  
Director

Published in the Recorder Herald, Salmon, Idaho, on May 6 and May 13, 1971.

5-6-2tc

WATER RIGHT NUMBER 75-7012

OWNER LAST NAME - HADE  
OWNER LAST NAME - HADEFIRST NAME - RICHARD L.  
FIRST NAME - KATHLEENORIG OWNER -  
ORIG OWNER -ADDRESS LINE 1 -  
ADDRESS LINE 3 -ADDRESS LINE 2 -  
CITY - SHOUP

STATE - ID ZIP CODE - 83469

SOURCE - HOT SPRINGS CREEK

TRIBUTARY OF - PANTHER CREEK

STAGE - LICENSE

STATUS -

PRIORITY - 04-21-1971 COUNTY - LEMHI

TOTAL DIV. RATE - .0200 -CFS

TOTAL DIV. VOLUME -

1.20 AFA TRFR/AMEND -

WATER DIST. -

DLE/CAREY ACT -

RIGHT BASIS -

DIVERSION POINT - SENW 28 23N 18E LOT REDIV -

0.0 0.0 0.0 0.0 0.0 0.0 0.0 0.0 0.0 0.0

FROM - TO - USE -

USE DIV. RATE - .0000 CFS USE DIV. VOLUME - .00 AFA

FROM - 01-01 TO - 12-31 USE - DOMESTIC

USE DIV. RATE - .0200 CFS USE DIV. VOLUME - 1.20 AFA

USE - DOMESTIC

PLACE OF USE - TWN 23N RNG 18E SEC 28 TRACT SENW LOT AC

DECREE NAME -

DATE -

TOTAL ACRES 0

REMARKS -

NON IRRIG USE -

OTHER RIGHTS FOR SAME USE -

PROOF DUE - 06-01-1978 PERMIT/DENIED - 06-17-1971 PROTESTED -

HEARING -

OLD NO. -

PROOF MADE - P FLD EXAM - F COND. OF APPROVAL -

DIVERSION MEANS - PIPELINE.

IDENT. NO. 75-7612

WATER RIGHT  
DATA ENTRY LOG

[illegible]



## WATER RIGHT ANALYSIS FORM

- DATA ENTRY -

Identification No.

Old No.

New No.

/ 75-7012

## Record

1. Original Owner: Richard L. + Kathleen Hade

Present Owner: \_\_\_\_\_

2. Address:

3. City: Shoup State: Id Zip: 8341694. A. Source of Water: Hot Springs CreekB. Tributary of: Panther Creek5. A. Stage (A,P,L,D,S,J): F

B. Status (D,L,R,C,A,I,F - leave blank if valid):

C. Priority Date: 4-21-1971D. County: SAE. Total Diversion Rate: .08

F. Total Diversion Volume:

G. Transfer/Amendment (P,T of A or blank):

H. Water District: —

I. DLE/Carey Act (D,C or blank):

J. Right Basis (for adjudication claims A,B,C only):

	Tract	Sec.	Twp.	Rge.	Gov't Lot	Rediv.
6. A. Point of Diversion	<u>SW SW</u>	<u>22</u>	<u>23<sup>N</sup></u>	<u>18<sup>E</sup></u>		
	_____	_____	_____	_____	_____	_____
	_____	_____	_____	_____	_____	_____
	_____	_____	_____	_____	_____	_____
	_____	_____	_____	_____	_____	_____

7. Period of Use, Use, Diversion Rate/Volume:

from \_\_\_\_\_ to \_\_\_\_\_ for A purposes. Amount .010  
(cfs or AC-Ft/yr)from \_\_\_\_\_ to \_\_\_\_\_ for D purposes. Amount .02

from \_\_\_\_\_ to \_\_\_\_\_ for \_\_\_\_\_ purposes. Amount \_\_\_\_\_

from \_\_\_\_\_ to \_\_\_\_\_ for \_\_\_\_\_ purposes. Amount \_\_\_\_\_

from \_\_\_\_\_ to \_\_\_\_\_ for \_\_\_\_\_ purposes. Amount \_\_\_\_\_

from \_\_\_\_\_ to \_\_\_\_\_ for \_\_\_\_\_ purposes. Amount \_\_\_\_\_

from \_\_\_\_\_ to \_\_\_\_\_ for \_\_\_\_\_ purposes. Amount \_\_\_\_\_

8. Use Code:

[illegible]

9. A. Decree Name:

**B. Decree Date:**

10. Remarks: A. P/U T23N, R18E, S27+28. R2. Lm = 3.  
B. H.E.S. - 371.  
C.  
D.  
E.

11. Other Uses (Non-irrigation explanatory information):

12. Other Rights for Same Use:

13. A. Proof Due Date: ~~6-1-1978~~ 6-1-1978  
B. Date Permit Approved or Denied: 6-17-1978  
C. Protested Date:  
D. Hearing Date:  
E. Old Number:  
F. Proof Made (P or blank): P  
G. Field Exam Made (P,R,F or blank): F  
H. Conditions of Approval:

14. Diversion Means (brief narrative): pipeline



State of Idaho

## DEPARTMENT OF WATER RESOURCES

STATE OFFICE, 450 W. State Street, Boise, Idaho

JOHN V. EVANS

Governor

C. STEPHEN ALLRED

Director

Mailing address:

Storehouse

Boise, Idaho 83720

(208) 334-4440

July 15, 1980

Richard & Kathleen Hade  
Shoup,  
Idaho 83469

Dear Mr. & Mrs. Hade,

RE: License No. 75-7012

Enclosed is a copy of the Water Right License issued on the above referenced permit.

Sincerely,

JAN GROVER  
Water Rights Supervisor

JG:mr  
Enclosure

MICROFILMED



State of Idaho

## DEPARTMENT OF WATER RESOURCES

STATE OFFICE, 450 W. State Street, Boise, Idaho

JOHN V. EVANS  
Governor

C. STEPHEN ALLRED  
Director

Mailing address:  
Starehouse  
Boise, Idaho 83720  
(208) 334-4440

June 10, 1980

Richard & Kathleen Hade  
Shoup,  
Idaho 83469

Dear Mr. & Mrs. Hade,

A representative of this Department has made an examination of the works covered by your Permit No. 75-7012, and has found the following:

Amount of water that can be recognized as beneficially used under  
Idaho law: 0.02 cfs Source: Hot Springs Creek

The maximum quantity diverted shall not exceed 1.2 acre feet  
per year.

Point(s) of diversion: SE $\frac{1}{4}$ NW $\frac{1}{4}$ , Sec. 28, Twp. 23N, Rge. 18E, B.M.

Beneficial use: Domestic use within the SE $\frac{1}{4}$ NW $\frac{1}{4}$ , Sec. 28, Twp. 23N, Rge. 18E.

Priority date established: April 21, 1971.

Conditions (if any):

If you do not concur with these findings please contact us within 10 days,  
otherwise a water license will be issued as set forth above.

Sincerely,

JIM JOHNSON  
Water Rights Supervisor

MICROFILMED





Rge 18E

Twp 23N

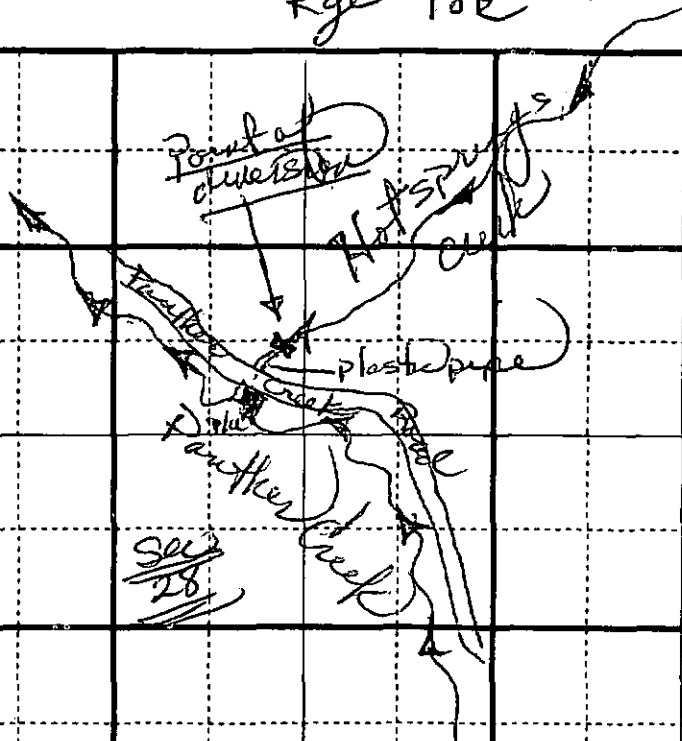
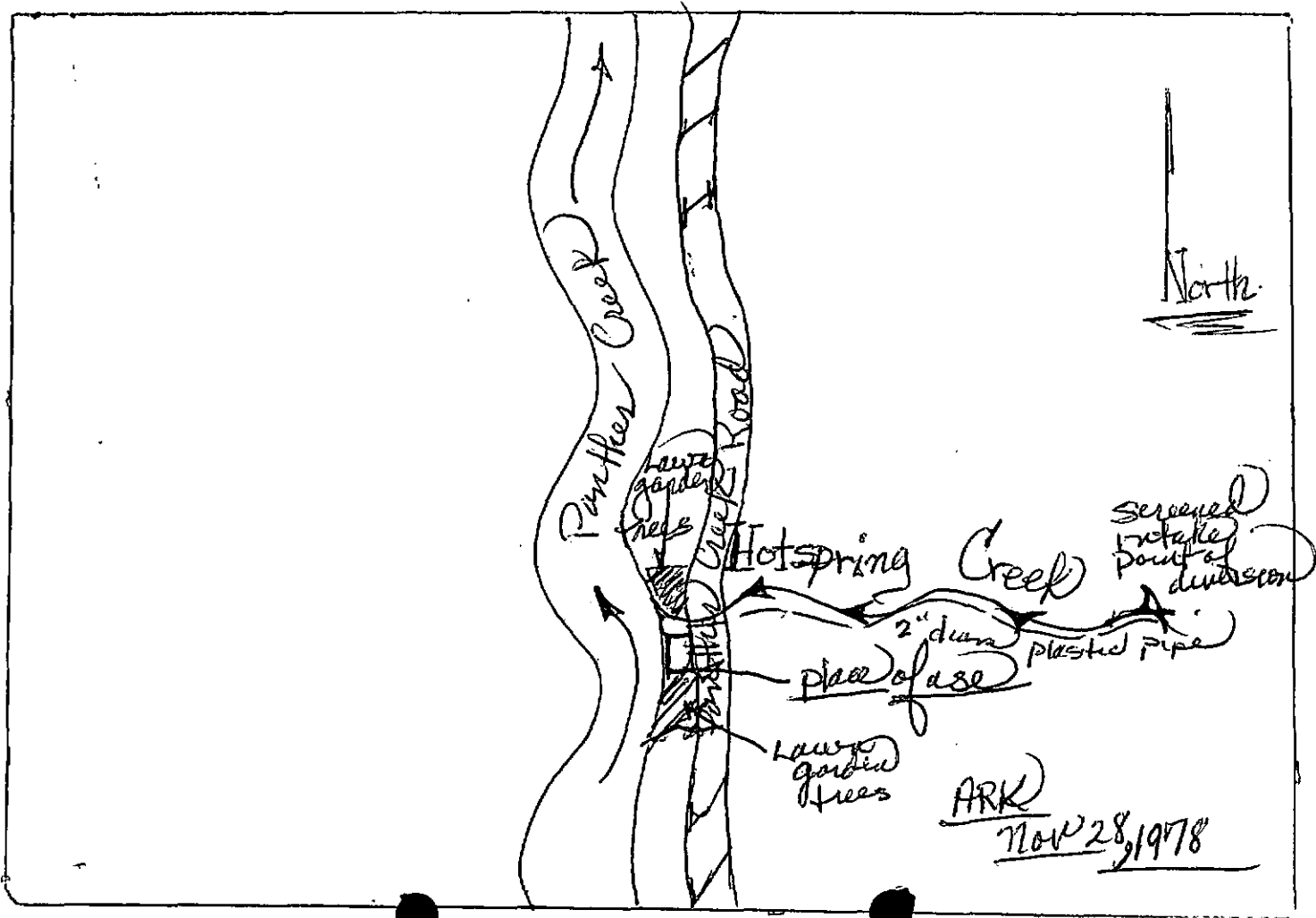

Diagram of System



DATE OF EXAM 8/9/78

ACREAGE

Found n/a

Recommended n/a

Irrigation Requirement n/a Ac Ft/Ac

USE

Irrigation Q = 0.02 c.f.s. V = 1.20 AF/Ann. from Jan to Dec 31  
Domestic Q = 0.02 c.f.s. V = 1.20 AF/Ann. from Jan to Dec 31  
Livestock Q = 0.02 c.f.s. V = 1.20 AF/Ann. from Jan to Dec 31

Is water co-mingled? yes no X

Name source: n/a  
twp. N/S, Rge E/W, B.M., Sec. 1/4, Sub. 1/4 County

Exchange? yes no X

Name source exchanged with: n/a  
twp. N/S, Rge E/W, B.M., Sec. 1/4, Sub. 1/4 County

Point of injection: n/a  
twp. N/S, Rge E/W, B.M., Sec. 1/4, Sub. 1/4 County

Point of exchange: n/a  
twp. N/S, Rge E/W, B.M., Sec. 1/4, Sub. 1/4 County

Total Q measured n/a Method of measurement n/a

Total Q recommended 0.02 cfs Meter No. n/a Type n/a Condition n/a

Total V recommended 1.20 AF/yr

Recommended Amendments:

P.D. None  
Place of Use None  
Other None

MEASUREMENT CALCULATION:

by assignment - based on single family domestic use

SYSTEM DESCRIPTION:

Surface water is diverted thru a screened intake and is conveyed by force of gravity through a 2" flexible plastic pipe to the point of diversion. The point of diversion is located 1500 to 2000 up the Hot Springs Creek Canyon. The plastic pipeline runs down the canyon under Panther Creek Road and to a small single family dwelling. Water is diverted for culinary use only - 2 hydrants on the yard near the home are conveniently located for the irrigation of approx 2 ac of lawns, garden, & trees. (Included under domestic right)

REMARKS: No Preexisting Rights

Examiner's Signature Anthony R Kozlowski Date Nov 28, 1978

Checked by Rodney A Parker Date Dec 3, 1978

Approved by \_\_\_\_\_ Date \_\_\_\_\_

Jim- (Johnson)  
could  
you please  
answer this.

RECEIVED

JUN 10 1980

Department of Water Resources

*Handwritten:* Linda, Jim, Bill, Kay

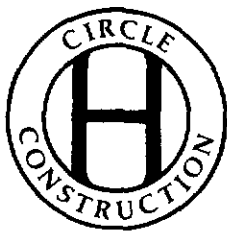
75-7012  
**RECEIVED**Kathleen  
Richard L. Hade

JUN 10 1980

Shoup, Idaho 83469

Department of Water Resources

June 6 - 1980

Department of Water Resources  
1515 Lincoln Rd.  
Idaho Falls, Ida.

**RECEIVED**

JUN 9 1980

Department of Water Resources  
Eastern District Office

Dear Sirs:

Re - water Right For  
Kathleen Hade

I have pruned up on my water source  
as state requires, you have inspected it  
at least two years ago or more - So far I  
have received no document stating I have  
my permanent water rights on Hestspring  
Creek - at Panther Creek, Shoup, Ida.

I have called you on this matter  
a couple of times - you have assured  
me, everything is in order - But so  
far nothing legally in writing from  
the State of Idaho - So may I hear from  
you on this matter - as soon as possible

Sincerely  
Kathleen Hade  
Panther Creek  
Shoup, Ida - 83469

**MICROFILMED**

June 20, 1978

Re: Permit No. 75-7012

Richard L. & Kathleen Hade  
Shoup,  
Idaho 83469

Dear Mr. & Mrs. Hade:

We acknowledge receipt of the affidavit submitted as proof of beneficial use for the above referenced permit.

Before a license can be issued, a field examination must be made by a representative of this Department. We cannot tell just when this examination will be made, but our examiner will try to contact you at the time he makes the examination so that you may show him the system.

If you have any questions regarding the field examination, please contact our Regional Office in Idaho Falls.

Sincerely,

JANICE RENK  
Water Rights

MICROFILMED



RECEIVED

MAY 30 1978

Department of Water Resources  
Eastern District Office

STATE OF IDAHO

DEPARTMENT OF WATER RESOURCES

Identification No. \_\_\_\_\_

Permit No. 75-7012

PROOF OF APPLICATION OF WATER TO BENEFICIAL USE

1. a) Name of Permit Holder Richard L. & Kathleen Hade  
b) Post Office Address Shoup, Idaho 83469
2. Permit Number 75-7012
3. Date of Priority that you are prepared to establish 4-21-71
4. a) Source from which water was appropriated Hot Spring Creek  
b) Location of the point of diversion: SE  $\frac{1}{4}$  NW  $\frac{1}{4}$ , Section 28  
Township 23N, Range 18E Boise Meridian, Other points of diversion: \_\_\_\_\_
5. a) The amount of water and use to which the water has been applied:  
Amount 0.02 for Domestic purposes from Jan. 1 to Dec. 31 incl.  
(cfs and/or acre-feet per annum) (Month-Day) (Month-Day)  
Amount 0.06 for Irrigation purposes from Apr. 1 to Nov. 1 incl.  
(cfs and/or acre-feet per annum) (Month-Day) (Month-Day)  
Amount \_\_\_\_\_ for \_\_\_\_\_ purposes from \_\_\_\_\_ to \_\_\_\_\_ incl.  
(cfs and/or acre-feet per annum) (Month-Day) (Month-Day)  
b) Total amount appropriated 0.08 cfs and/or acre-feet per annum  
c) Describe how and by whom measurement of rate of flow or amount of storage was made and the qualifications of the person making the measurement: \_\_\_\_\_
6. If the means of diversion and conveyance are owned by someone other than the Permit Holder:  
a) Give the name or description of the canal, ditch or other works by which the water is conducted to the place of use: \_\_\_\_\_  
b) Describe the agreement or understanding by which you take water from the works: \_\_\_\_\_
7. a) Briefly describe the works for diverting and conveying the water to the place of use, (if from a subterranean source, give the pump size, motor size, size of well casing, depth of well; if from surface water, give brief description of diversion structure and/or canal or ditch) A 2-in. plastic pipe diverts water from stream 550 to 600 ft. upstream from place of use. Pipe provides water for one home and the irrigation of three acres  
b) Describe the type and size of measuring device which you have installed at your point of diversion: N.A.  
c) Give well driller's name and address and the date the well was completed: N.A.
8. If for other than irrigation, describe the beneficial use to which you have applied the water and the place of use: Culinary water for one house hold and stockwater for 2 horses and a few head of beef cattle

Exam typed 6/29/78 by df

RECEIVED

9. Irrigation uses: describe the lands irrigated by giving the acreages irrigated within each 40 acre subdivision: \_\_\_\_\_  
 Irrigation is primarily confined to an orchard of over 20 trees \_\_\_\_\_  
 \_\_\_\_\_  
 \_\_\_\_\_

T	R	SEC.	NE¼				NW¼				SW¼				SE¼				TOTAL
			NE¼	NW¼	SW¼	SE¼	NE¼	NW¼	SW¼	SE¼	NE¼	NW¼	SW¼	SE¼	NE¼	NW¼	SW¼	SE¼	
23N	18E	28								3									3

Total number of acres irrigated 3

10. Remarks: \_\_\_\_\_  
 \_\_\_\_\_  
 \_\_\_\_\_  
 \_\_\_\_\_

The above information is a true statement of the extent to which the above numbered permit has been developed.

5-30-78 (Date) Richard L Hade (Signature)  
Kathleen Hade

State of Idaho )  
 ) ss.  
 County of Bonneville )

On this 30<sup>th</sup> day of May, 19 78, personally appeared before me the signer(s) of the above instrument, who duly acknowledged to me that he (she) (they) executed the same.

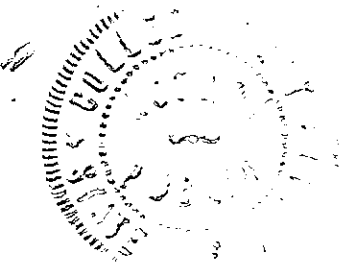

Colleen Wray  
 Notary Public residing at Idaho Falls, Idaho

My commission expires 6/15/81

May 2, 1978

Richard L. & Kathleen Hade  
Panther Creek  
Shoup, ID 83469

Dear Mr. & Mrs. Hade:

The Department is only allowed to grant one extension of time per permit (Idaho Code, Section 42-204).

However, in order to prevent this permit from lapsing, you need to complete the proof of beneficial use form enclosed showing the work you have completed. A field exam will be made later on in the irrigation season, and a license will be issued for what the field examiner finds at that time. If any work at all has been done, please complete the enclosed proof of beneficial use form and return it to this office as soon as possible.

If you have any questions, please contact us.

Sincerely,

JAN GROVER  
Water Rights Supervisor

JG:lt

Enclosure

**MICROFILMED**

4-19-78  
Shary, Idaho

Dear Sir:

Due to the fact that my husband is and has  
been in very poor health - I requested and received  
a two year extension.

Now even due to finances and labor problems,  
I still need a 6 more months of a time extension  
(if possible) to completely prove up on my water  
rights for a water permit -

Please advise me as soon as possible

Thank you

Kathleen Hale  
Panther Creek  
Shary, Ida.

MICROFILMED



# STATE OF IDAHO

## DEPARTMENT OF WATER RESOURCES

Cecil D. Andrus  
Governor

R. Keith Higginson  
Director

Statehouse  
Boise, Idaho 83720  
(208) 384-2215

March 31, 1978

CERTIFIED MAIL

RECEIVED

APR 18 1978

Department of Water Resources

Re: Permit No. 75-7012

Richard L. and Kathleen Hade  
Panther Creek  
Shoup, Idaho 83469

Dear Mr. & Mrs. Hade:

One of the conditions of approval of your water Permit No. 75-7012 (see last page of your approved permit) was that evidence of the extent of development be submitted as proof of application of water to beneficial use to this office on or before June 1, 1978. Enclosed is an affidavit form which must be used to submit the required proof of beneficial use.

If you have not fully completed your project, and you have not previously received an extension of time, you may request an extension of time provided the delay is for reasonable cause as indicated in Section 42-204, Idaho Code, amended. If you have been prevented from proceeding by a governmental agency or by litigation, more than one extension of time can be granted.

Either the beneficial use affidavit or a request for an extension of time must be received by this Department on or before the above mentioned date, otherwise the permit will lapse and be of no further force or effect.

Norman C. Young  
NORMAN C. YOUNG  
Administrator,  
Resources Administration Division

NCY:jfr

Encl: Proof affidavit





# STATE OF IDAHO

## DEPARTMENT OF WATER RESOURCES

Cecil D. Andrus  
Governor

R. Keith Higginson  
Director

Statehouse  
Boise, Idaho 83720  
(208) 384-2215

March 31, 1978

CERTIFIED MAIL

128551

Re: Permit No. 75-7012

Richard L. and Kathleen Hade  
Panther Creek  
Shoup, Idaho 83469

Dear Mr. & Mrs. Hade:

One of the conditions of approval of your water Permit No. 75-7012 (see last page of your approved permit) was that evidence of the extent of development be submitted as proof of application of water to beneficial use to this office on or before June 1, 1978. Enclosed is an affidavit form which must be used to submit the required proof of beneficial use.

If you have not fully completed your project, and you have not previously received an extension of time, you may request an extension of time provided the delay is for reasonable cause as indicated in Section 42-204, Idaho Code, amended. If you have been prevented from proceeding by a governmental agency or by litigation, more than one extension of time can be granted.

Either the beneficial use affidavit or a request for an extension of time must be received by this Department on or before the above mentioned date, otherwise the permit will lapse and be of no further force or effect.

*Norman C. Young*  
NORMAN C. YOUNG

Administrator,  
Resources Administration Division

NCY:jfr

Encl: Proof affidavit

MICROFILMED

May 17, 1976

Re: Permit No. 75-7012

Richard & Kathleen Hade  
Panther Creek  
Shoup, ID 83469

Dear Mr. & Mrs. Hade:

Enclosed is a copy of the approved application for extension of time in connection with the above referenced permit.

The time within which to submit proof of beneficial use of water has been extended to June 1, 1978.

Sincerely,

D. Darlene Reich  
Water Rights Supervisor



# STATE OF IDAHO

## DEPARTMENT OF WATER RESOURCES

Cecil D. Andrus  
Governor

R. Keith Higginson  
Director

Statehouse  
Boise, Idaho 83720  
(208) 384-2215

April 1, 1976

CERTIFIED MAIL

Re: Permit No. 75-7012

Richard L. & Kathleen Hade  
Shoup,  
Idaho 83469

Dear Mr. & Mrs. Hade:

One of the conditions of approval of your water Permit No. 75-7012 (see last page of your approved permit) was that evidence of the extent of development be submitted as proof of application of water to beneficial use to this office on or before JUNE 1, 1976. Enclosed is an affidavit form which must be used to submit the required proof of beneficial use.

If you have not fully completed your project, and you have not previously received an extension of time, you may request an extension of time provided the delay is for reasonable cause as indicated in Section 42-204, Idaho Code, amended. If you have been prevented from proceeding by a governmental agency or by litigation, more than one extension of time can be granted.

Either the beneficial use affidavit or a request for an extension of time must be received by this Department on or before the above mentioned date, otherwise the permit will lapse and be of no further force or effect.

  
R. KEITH HIGGINSON  
Director

RKH:jg  
Enc: Proof affidavit

**WATER RESOURCE BOARD:**

John F. Streiff  
Chairman  
  
Franklin Jones  
Member

George L. Yost  
Vice-Chairman  
  
M. Reed Hansen  
Member

Donald R. Kramer  
Secretary  
  
Scott W. Reed  
Member

Edwin C. Schlender  
Member  
  
Joseph H. Nettleton  
Member

May 3, 1976  
Shoup, Idaho

83469

State of Idaho  
Department of Water Resources  
Boise, Idaho - 83720

RECEIVED

MAY 7 1976

Department of Water Resources

To Whom it May Concern -

We would like to request a extension of time to  
Phase up on our water rights development  
Permit No - 75-7012 - Due to Mr Hades -  
Poor health and numerous stays in the hospital -  
We would like to request a extension of two years -

Sincerely  
Mrs Richard L. Hade

ok  
BDI-

RECEIVED

MAY 7 1976

Department of Water Resources

TO BE COMPLETED BY NOV 11  
AS SHOWN BY 20106 20106 20106  
VOLUME 10 to 10106 10106  
Identification No.

Permit No. 75-7012

STATE OF IDAHO

DEPARTMENT OF WATER RESOURCES

PROOF OF APPLICATION OF WATER TO BENEFICIAL USE

1. a) Name of Permit Holder Richard L. Hade Kathleen Hade  
b) Post Office Address Shoup, Idaho 83469
2. Permit Number 75-7012
3. Date of Priority that you are prepared to establish June 1978
4. a) Source from which water was appropriated Hot Springs Creek  
b) Location of the point of diversion: SW 1/4 SW 22  
Township 23N, Range 18E Boise Meridian, Other points of diversion: NONE
5. a) The amount of water and use to which the water has been applied:  
Amount 0.02 for DOMESTIC purposes from 1 Jan to 31-Dec incl.  
(cfs and/or acre-feet per annum) (Month-Day) (Month-Day)  
Amount 0.06 for IRRIGATION purposes from 1 April to 1 Nov incl.  
(cfs and/or acre-feet per annum) (Month-Day) (Month-Day)  
Amount \_\_\_\_\_ for \_\_\_\_\_ purposes from \_\_\_\_\_ to \_\_\_\_\_ incl.  
(cfs and/or acre-feet per annum) (Month-Day) (Month-Day)  
b) Total amount appropriated 0.08 cfs and/or acre-feet per annum  
c) Describe how and by whom measurement of rate of flow or amount of storage was made and the qualifications of the person making the measurement:  
  
6. If the means of diversion and conveyance are owned by someone other than the Permit Holder:  
a) Give the name or description of the canal, ditch or other works by which the water is conducted to the place of use:  
  
b) Describe the agreement or understanding by which you take water from the works:  
  
7. a) Briefly describe the works for diverting and conveying the water to the place of use, (if from a subterranean source, give the pump size, motor size, size of well casing, depth of well; if from surface water, give brief description of diversion structure and/or canal or ditch)  
  
b) Describe the type and size of measuring device which you have installed at your point of diversion: 2" plastic pipe laid in stream - no pump or dam or diversion made as of this date  
  
c) Give well driller's name and address and the date the well was completed:  
  
8. If for other than irrigation, describe the beneficial use to which you have applied the water and the place of use:  
domestic use - for our home - toilet - dishes washing - etc -

more acres, please submit an  
aerial photo of the property  
with this affidavit.

9. Irrigation uses: describe the lands irrigated by giving the acreages irrigated within each 40 acre subdivision: \_\_\_\_\_

T	R	SEC.	NE $\frac{1}{4}$				NW $\frac{1}{4}$				SW $\frac{1}{4}$				SE $\frac{1}{4}$				TOTAL
			NE $\frac{1}{4}$	NW $\frac{1}{4}$	SW $\frac{1}{4}$	SE $\frac{1}{4}$	NE $\frac{1}{4}$	NW $\frac{1}{4}$	SW $\frac{1}{4}$	SE $\frac{1}{4}$	NE $\frac{1}{4}$	NW $\frac{1}{4}$	SW $\frac{1}{4}$	SE $\frac{1}{4}$	NE $\frac{1}{4}$	NW $\frac{1}{4}$	SW $\frac{1}{4}$	SE $\frac{1}{4}$	
23	18E	28																	

Total number of acres irrigated 3

10. Remarks:

Poor health - arthritis + intermittent hospitalization  
of module over the past 5 years - has slowed down  
our progress considerably - Therefore we request a two  
year extension -  
on Richard L. Nade

The above information is a true statement of the extent to which the above numbered permit has been developed.

(Date)

(Signature)

State of Idaho )  
County of Lemhi ) ss.

On this 6th day of May, 1976, personally appeared before me  
the signer(s) of the above instrument, who duly acknowledged to me that he (she) (they) executed the same.

Notary Public residing at Salmon

My commission expires

5-6-76

**UNITED STATES POSTAL SERVICE**

**OFFICIAL BUSINESS**

**SENDER INSTRUCTIONS**

Print your name, address, and ZIP Code in the space below.

- Complete items 1, 2, and 3 on reverse side.
- Moisten gummed ends and attach to back of article.

**RETURN  
TO**



**PENALTY FOR PRIVATE  
USE TO AVOID PAYMENT  
OF POSTAGE, \$300**



17-170213

- **SENDER:** Complete items 1, 2, and 3.  
Add your address in the "RETURN TO" space on reverse.

1. The following service is requested (check one).

- ☐ Show to whom and date delivered..... 15¢  
☐ Show to whom, date, & address of delivery.. 35¢  
☐ RESTRICTED DELIVERY.  
 Show to whom and date delivered..... 65¢  
☐ RESTRICTED DELIVERY.  
 Show to whom, date, and address of delivery 85¢

2. ARTICLE ADDRESSED TO:

*Beef from Heidi*

3. ARTICLE DESCRIPTION:

REGISTERED NO.	CERTIFIED NO.	INSURED NO.
	138493	

(Always obtain signature of addressee or agent)

I have received the article described above.

SIGNATURE ☐ Addressee ☐ Authorized agent

4. *Richard E. Heid*  
DATE OF DELIVERY

5. ADDRESS (Complete only if requested)

6. UNABLE TO DELIVER BECAUSE:

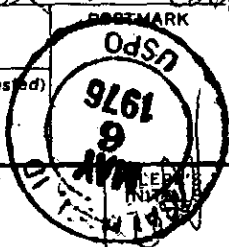



April 1, 1976

CERTIFIED MAIL #138493

Re: Permit No. 75-7012

Richard L. & Kathleen Hade  
Shoup,  
Idaho 83469

Dear Mr. & Mrs. Hade:

One of the conditions of approval of your water Permit No. 75-7012 (see last page of your approved permit) was that evidence of the extent of development be submitted as proof of application of water to beneficial use to this office on or before JUNE 1, 1976. Enclosed is an affidavit form which must be used to submit the required proof of beneficial use.

If you have not fully completed your project, and you have not previously received an extension of time, you may request an extension of time provided the delay is for reasonable cause as indicated in Section 42-204, Idaho Code, amended. If you have been prevented from proceeding by a governmental agency or by litigation, more than one extension of time can be granted.

Either the beneficial use affidavit or a request for an extension of time must be received by this Department on or before the above mentioned date, otherwise the permit will lapse and be of no further force or effect.

  
R. KEITH HIGGINSON  
Director

RKH:jg  
Enc: Proof affidavit

June 18, 1971

Re: Permit No. 75-7012 - Richard L. and Kathleen Hade

Richard L. and Kathleen Hade  
Shoup,  
Idaho 83469

Dear Mr. and Mrs. Hade:

Enclosed is a copy of your approved Application for Permit No. 75-7012. We direct your attention to the conditions of approval as listed on the fourth page.

Very truly yours,

BOBBY D. FLEENOR  
Assistant Director

BDF:kh

Enclosures

P.S. We wish to advise you that in order to gain right of way for pipe over U.S. lands, you should contact the U.S. Forest Service and obtain a special use permit.

75-7012

April 28, 1971

Re: Application No. 75-7012 - Richard L. & Kathleen Hade  
Claim No. 75-4003 - Eugene G. Hussey

Recorder Herald  
P.O. Box 310  
Salmon, Idaho 83467

Gentlemen:

Enclosed you will find a legal notice which we wish to have published once a week for two consecutive weekly issues of your newspaper. We have inserted the publication dates allowing ample time for you to submit us a galley proof for our review before publication.

After sending us a galley proof, proceed with the publication on the dates we have inserted assuming the notice is correct. If we have any corrections, we will notify you before the first publication date. If you cannot publish the notice on the proposed dates, please contact us immediately.

An affidavit of publication must be submitted to the Department along with the publication bill. In order to receive payment, the following certification must appear on the bill:

"I hereby certify that the foregoing account is just and correct, that the amount claimed is legally due, after allowing all just credits, and that no part of the same has been paid."

-----  
(signature of claimant)

Very truly yours,

Donald W. McEldowney  
Appropriation Supervisor

Bill submitted 5-27-71 by sk

DWM:DR  
Enc: Legal notices (2)

75-7012

**NOTICE OF APPLICATION FOR  
WATER PERMIT**

Notice is hereby given that Richard L. and Kathleen Hade, Shoup, Idaho, have on April 21, 1971, submitted Application No. 75-7012 for a permit to appropriate .008 cubic feet per second of water from Hot Springs Creek, tributary to Panther Creek, by means of pipe within the SW $\frac{1}{4}$ SW $\frac{1}{4}$  Sec. 22, T. 23N, R. 18E, B. M., Lemhi County, (unsurveyed) to be used from April 1 to Nov. 1 for the irrigation of 3 acres and from Jan. 1 to Dec. 31 for domestic purposes within Homestead Entry No. 371.

If issued this permit will be subject to all prior water rights. Protests against the granting of the permit must be filed with the Idaho Department of Water Administration, Statehouse, Boise, Idaho, 83707, on or before May 24, 1971.

**R. KEITH HIGGINSON**  
Director

Published in the Recorder Herald, Salmon, Idaho, on May 6 and May 13, 1971.

5-6-2tc

O.K.  
5-6-71  
J.D.

75-7012

NOTICE OF APPLICATION FOR WATER PERMIT

Notice is hereby given that Richard L. and Kathleen Hade, Shoup, Idaho,

~~has on~~ have on April 21, 1971, submitted Application No. 75-7012  
for a permit to appropriate 0.08 cubic feet per second ~~more or less~~  
of water from Hot Springs Creek, tributary to Panther Creek,  
by means of pipe  
within the SW $\frac{1}{4}$ SW $\frac{1}{4}$  Sec. 22, T. 23N, R. 18E, B.M., Lemhi County, (unsurveyed)

to be used from April 1 to Nov. 1 for the irrigation of 3 acres and from Jan. 1  
~~now~~ to Dec. 31 for ~~domestic~~ domestic purposes

within ~~the~~ Homestead Entry No. 371

issued

If ~~used~~, this permit will be subject to all prior water rights. Protests against the granting of the permit must be filed with the Idaho Department of Water Administration, Statehouse, Boise, Idaho, 83707, on or before May 24, 1971.

R. KEITH HIGGINSON  
Director

Published in the Recorder Herald, Salmon, Idaho,  
on May 6 and May 13, 1971.

75-7012

April 21, 1971

Richard L. Hade  
Shoup,  
Idaho 83469

Dear Mr. Hade:

Returned herewith is your receipt No. 5922 in the amount of \$10.00  
for application for permit,  
which was received in this office under the above date.

Very truly yours,

M. RUSSELL BOSCH  
Administrative Assistant

MRB:ejw

Enclosure

75-7012