

(8) Remarks \_\_\_\_\_

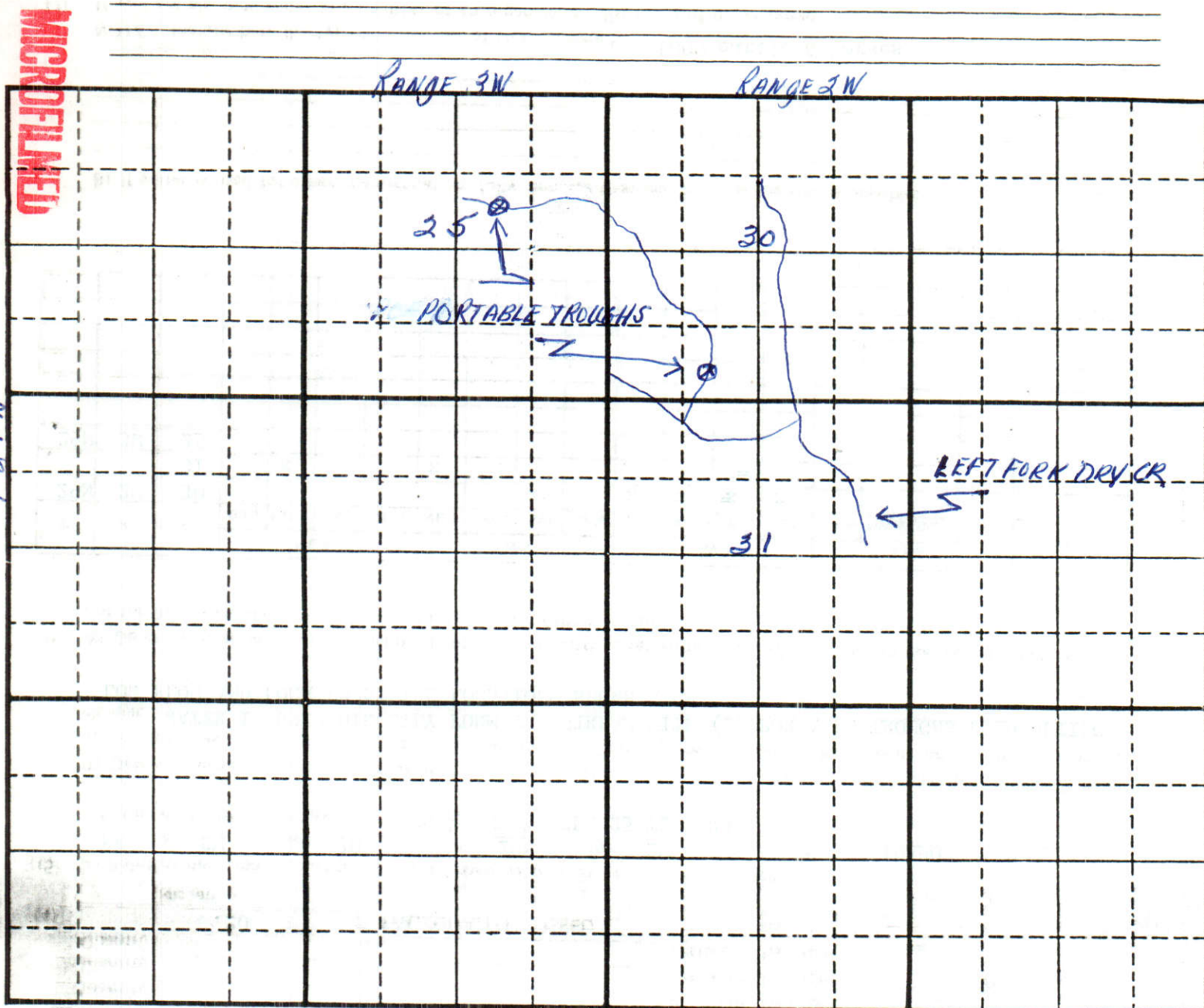

Scale: 2 inches equal 1 mile.

Map should show the location of the point of diversion and the place of use of the water by 40-acre subdivisions, section, township and range of the public land survey system.

State of Idaho )  
County of Adams ) ss.

Be it known that the undersigned, being duly sworn, deposes and says that he, she, they subscribed the foregoing claim to a water right, together with all attached information, and that the matters and facts therein are true to the best of the affiant's knowledge.

Sworn to before me this 6 day of June, 19 83.

W. G. Kitchcock

(Claimant)

Synda L. Swift  
Notary Public  
Residing at New Meadows, Idaho

My commission expires 3-9-85

6-9-83 FOR DEPARTMENT USE ONLY			
Received by <u>SRL</u>	Date <u>6/9/83</u>	Exception filed by:	Forwarded to
Prelim. check by <u>bhs</u>	Date <u>6/17/83</u>		claimant by:
\$30.00 fee received by <u>jp</u>	Date <u>6/10/83</u>	#28974	
Published in <u>Idaho County Free Press</u>			
Dates <u>9/28 &amp; 10/5/83</u>			

STATE OF IDAHO  
DEPARTMENT OF WATER RESOURCES

## CLAIM TO A WATER RIGHT

Under the provisions of Section 42-243, Idaho Code, any person using or claiming rights to the public waters of Idaho established by diversion and application to a beneficial use must file a claim with the Department of Water Resources on or before June 30, 1983. Exempted from this filing are single family domestic uses as defined in Section 42-230(d), Idaho Code. Also exempted are rights represented by a permit, license, decree, adjudicated right, or a previously filed claim.

The filing of this claim does not confirm the water right claimed but failure to file may result in forfeiture of a water right.

Notice is hereby given that M.G. HIT COCK

(Name of Claimant)

P.O. BOX 431

WHITE SWAN, WA

98952

Telephone No. (509)874-2144

(Mailing Address)

(Zip Code)

claims a right to the diversion and beneficial use of the surface or ground water. The extent and nature of said claim is as follows:

- (1) Date of priority: (When was the water first applied to a beneficial use) MAY 21, 1919

A claim is not acceptable on a ground water source with a priority later than March 25, 1963 or on a surface water source with a priority later than May 20, 1971. An exception is that a claim may be filed on single family domestic use from a ground water source.

- (2) Describe the source of water: (Name of stream, lake, spring, etc., or ground water)

NO NAME CREEK Unnamed Stream tributary to LEFT FORK DRY CR

- (3) Describe the purpose for which the water has been used and the time during the year when you have used the right claimed:

	(cfs, af)	(Domestic, Irrigation, Stock, Etc.)	(Both dates inclusive)	
			(Mo., Day)	(Mo., Day)
Quantity	<u>.20</u>	Use <u>STOCK WATERING</u>	Period of Use From <u>1/1</u>	To <u>12/31</u>
Quantity		Use	Period of Use From	To
Quantity		Use	Period of Use From	To
Quantity		Use	Period of Use From	To
Quantity		Use	Period of Use From	To
(4)	<u>.20</u>	<u>TOTAL QUANTITY USED.</u>		

(cfs, af)

- (5) A) Point of diversion: (Location of point where water is diverted from its source)

SE ¼ SW ¼, Sec. 30 Twp. 29N Rge. 2W B.M., County of IDAHO

Additional points of diversion: SW ¼ NE ¼ SEC 25 T29N R3W Include Allot Items

B) Describe means of diversion of water: (Pump and pipeline, well, diversion dam, reservoir, length of ditch and field, etc.). Give sizes and capacities: be as specific as possible. Describe any changes in the system and give the date of the change. WATER IS USED DIRECTLY FROM THE STREAM WITH (2) PORTABLE TROUGHS USED DURING LOW FLOW AND LOCATED AT THE LOCATIONS SHOWN ABOVE

- (6) A) Describe location of use by listing number of irrigated acres within each 40-acre tract in appropriate box. If use is not for irrigation, place an "X" in appropriate box to show location.

T	R	SEC.	NE¼				NW¼				SW¼				SE¼				TOTAL
			NE¼	NW¼	SW¼	SE¼	NE¼	NW¼	SW¼	SE¼	NE¼	NW¼	SW¼	SE¼	NE¼	NW¼	SW¼	SE¼	
29N	2W	30							X		X	X	S	X					
		31		X			X	X											
29N	3W	25				X													

No. of acres \_\_\_\_\_

B) If water is used for other than irrigation, fully describe that use, being as specific as possible: \_\_\_\_\_

NOTE: Include here the type and number of stock watered: 1000 cattle & horses

- (7) If you are claiming water as a member of an organization, list name of organization: \_\_\_\_\_

(8) Remarks \_\_\_\_\_  
\_\_\_\_\_  
\_\_\_\_\_

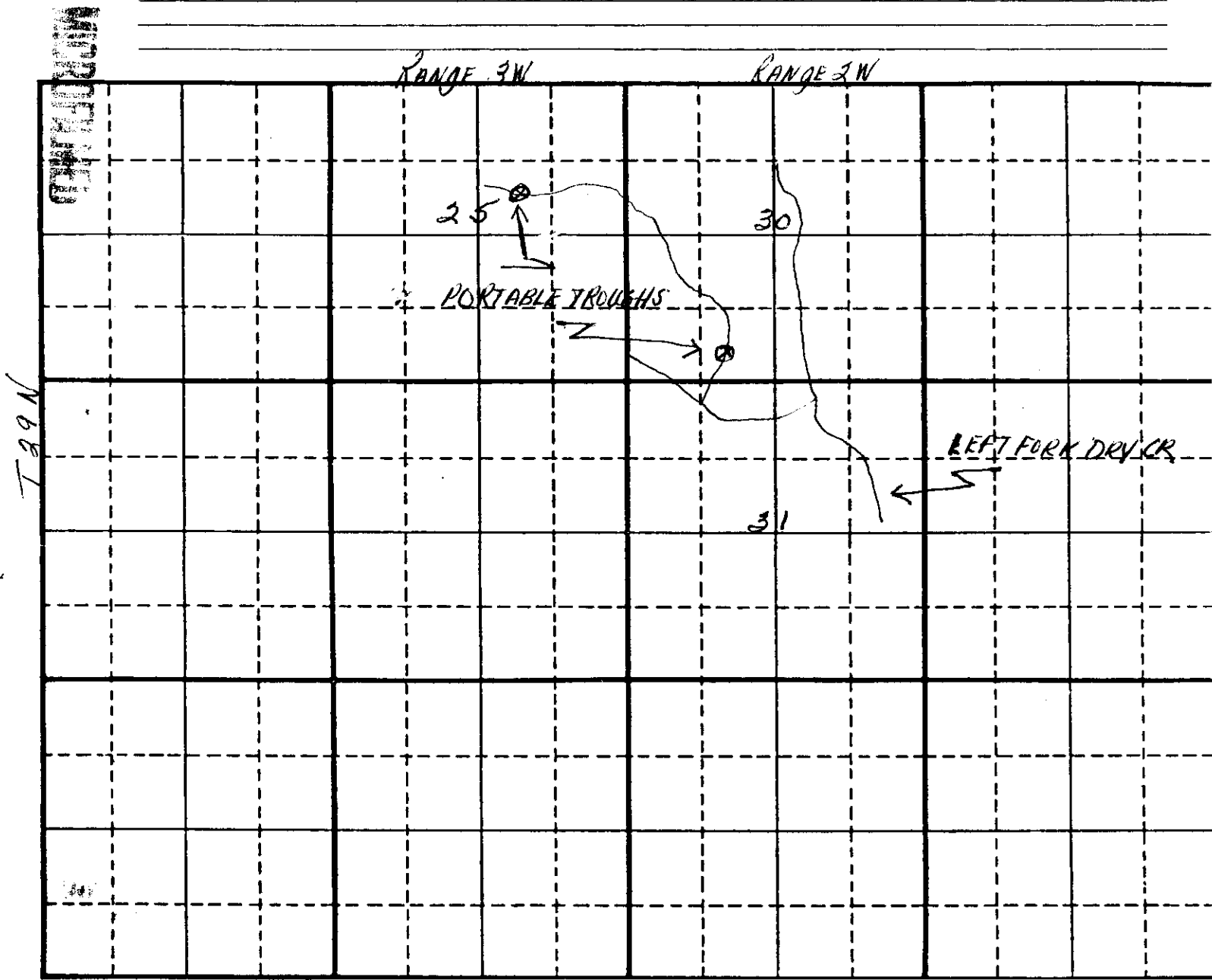

Scale: 2 inches equal 1 mile.

Map should show the location of the point of diversion and the place of use of the water by 40-acre subdivisions, section, township and range of the public land survey system.

State of Idaho )  
County of Adams ) ss.

Be it known that the undersigned, being duly sworn, deposes and says that he, she, they subscribed the foregoing claim to a water right, together with all attached information, and that the matters and facts therein are true to the best of the affiant's knowledge.

Sworn to before me this 6 day of June, 1983.  
My Kitchcock  
(Claimant)

Synda L. Swift  
Notary Public  
Residing at New Meadows, Idaho

My commission expires 3-9-85

6-9-83 FOR DEPARTMENT USE ONLY			
Received by <u>SKC</u>	Date <u>6/9/83</u>	Exception filed by:	Forwarded to
Prelim. check by <u>bhs</u>	Date <u>6/17/83</u>		claimant by:
\$30.00 fee received by <u>jp</u>	Date <u>6/10/83</u>	#28974	
Published in <u>Idaho County Free Press</u>			
Dates <u>9/23 &amp; 10/5/83</u>			

## PUBLIC NOTICES

### NOTICE OF CLAIMS TO WATER RIGHTS

The following claim(s)  
have been filed on water  
right(s) created by diversion  
and beneficial use:

77-4189

JOMAS, HAROLDE.

5727 HILL RD., BOISE, ID  
83703

Source: SPRING trib to BIG  
MALLARD CREEK;

HARBISON CREEK trib to

BIG MALLARD CREEK;

BIG MALLARD CREEK

trib. to SALMON RIVER.

Priority Date: 01/01/1900

Diversion Pt: NENW Sec 36

T 27N R 09E

Use: STOCKWATER (0.06

CFS) DOMESTIC (0.08 CFS)

In: SWNW Sec 36 T 27N R

09E.

78-4278

U.S. DEPT. OF INTERIOR

BUREAU OF LAND

MGNT., COEUR D'ALENE

DIST., 1808 N. THIRD,

COEUR D'ALENE, ID 83814

Source: SPRING trib. to

LITTLE ELK CREEK

Priority Date: 01/07/1969

Diversion Pt: NWNE Sec 24

T 22N R 01E

Use: STOCKWATER (0.01

CFS) WILDLIFE (0.01 CFS)

In: NWNE Sec 24 T 22N R

01E.

## PUBLIC NOTICES

FOR 154 ACRES.

79-4385

BICANDI, TOM &/or

LORRAINE

P.O. BOX 198, RIGGINS, ID

83549

Source: BEAN CREEK trib.

to RACE CREEK, WEST

FORK

Priority Date: 01/01/1880

Diversion Pt: SENE Sec 32

T 25N R 01E

Use: IRRIGATION (0.40

CFS) STOCKWATER (0.07

CFS)

In: SENE Sec 32 T 25N R 01E

SWNW NWSE Sec 33 T 25N

R 01E FOR 20 ACRES.

79-4386

LAURINO, M.D., JAMESA.

P.O. BOX 85, KEUTER-

VILLE, ID 83538

Source: SPRING trib. to

ROCK CREEK

Priority Date: 01/01/1936

Diversion Pt: SWNE Sec 24

T 30N R 01W

Use: IRRIGATION (0.04

CFS) STOCKWATER (0.04

CFS) DOMESTIC (0.04 CFS)

In: SENE Sec 24 T 30N R

01E.

## PUBLIC NOTICES

01W FOR 1 ACRES.

79-4387

HITCHCOCK, M.G.

P.O. BOX 431, WHITE

SWAN, WA 98952

Source: SPRING trib. to

CAMP CREEK

Priority Date: 06/29/1950

Diversion Pt: SWSE Sec 31 T

30N R 02W

Use: STOCKWATER (0.10

CFS)

In: SWSE Sec 31 T 30N R

02W.

79-4388

HITCHCOCK, M.G.

P.O. BOX 431, WHITE

SWAN, WA 98952

Source: SPRING trib. to

SINKS

Priority Date: 06/17/1950

Diversion Pt: NESE Sec 05 T

29N R 02W

Use: STOCKWATER (0.10

CFS)

In: NESE Sec 05 T 29N R

02W.

79-4389

HITCHCOCK, M.G.

P.O. BOX 431, WHITE

SWAN, WA 98952

Source: SPRING trib. to

SINKS

Priority Date: 06/17/1950

Diversion Pt: NESE Sec 05 T

29N R 02W

Use: STOCKWATER (0.10

CFS)

In: NESE Sec 05 T 29N R

02W.

## PUBLIC NOTICES

Source: LITTLE SUPHER  
CREEK trib. to SNAKE  
RIVER

Priority Date: 06/28/1919

Diversion Pt: NENE NWNE

SWNE SENE NESW Sec 02 T

28N R 03W NESE NWSE

SWSE Sec 35 T 29N R 03W

SWSW Sec 36 T 29N R 03W

Use: STOCKWATER (0.20

CFS)

In: NENE NWNE SWNE

SENE NESW Sec 02 T 28N R

03W NESE NWSE SWSE Sec

35 T 29N R 03W SWSW Sec 36

T 29N R 03W.

79-4390

HITCHCOCK, M.G.

P.O. BOX 431, WHITE

SWAN, WA 98952

Source: SPRING trib. to

STREAM trib. to SNAKE

Priority Date: 06/29/1919

Diversion Pt: NESE NWSE

SWSE Sec 02 T 28N R

03W NWNE Sec 11 T 28N R

03W

Use: STOCKWATER (0.20

CFS)

In: NESE NWSE SWSE

## PUBLIC NOTICES

SESE Sec 02 T 28N R 03W  
NWNE Sec 11 T 28N R 03W.

79-4391

HITCHCOCK, M.G.

P.O. BOX 431, WHITE

SWAN, WA 98952

Source: SPRING trib. to

DIVIDE CREEK

Priority Date: 06/17/1950

Diversion Pt: SWNW Sec 36

T 30N R 03W

Use: STOCKWATER (0.04

CFS)

In: SWNW Sec 36 T 30N R

03W.

79-4392

HITCHCOCK, M.G.

P.O. BOX 431, WHITE

SWAN, WA 98952

Source: UNNAMED

STREAM trib. to DRY

Priority Date: 06/21/1919

Diversion Pt: SWNW NESW

NWSW SWSW SESW Sec 30 T

29N R 02W NWNE Sec 29 T

29N R 02W NENW NWNW

Sec 31 T 29N R 02W SENE

SWNE Sec 25 T 29N R 03W

Use: STOCKWATER (0.20

CFS)

## PUBLIC NOTICES

In: SWNW NESW NWSW  
SWSW SESW Sec 30 T 29N R  
02W NWNE NENW NWNW  
Sec 31 T 29N R 02W SENE  
Sec 25 T 29N R 03W.

79-4393

HITCHCOCK, M.G.

P.O. BOX 431, WHITE

SWAN, WA 98952

Source: SPRING trib. to

DOUG CREEK

Priority Date: 06/18/1919

Diversion Pt: SWSW Sec 24 T

29N R 03W

Use: STOCKWATER (0.02

CFS)

In: SWSW Sec 24 T 29N R

03W.

79-4394

HITCHCOCK, M.G.

P.O. BOX 431, WHITE

SWAN, WA 98952

Source: DIVIDE CREEK,

WEST FORK trib. to

DIVIDE CREEK

Priority Date: 07/17/1950

Diversion Pt: SWNE SENW

NESW NWSW Sec 03 T 29N R

02W SWNE NESE NWSE

Sec 04 T 29N R 02W

Use: STOCKWATER (0.20

CFS)

In: NWNE NENW SENW

NESE NWSE Sec 01 T

28N R 03W NENE SENE Sec

12 T 28N R 03W NESW SWSW

Sec 36 T 29N R 03W.

## PUBLIC NOTICES

NWSE Sec 09 T 29N R 02W  
Use: STOCKWATER (0.20  
CFS)

In: SWNE SENW NESW

NWSW Sec 03 T 29N R 02W

SWNE NESE NWSE SWSW

Sec 04 T 29N R 02W NWNE

SWNE NESW SESW NWSE

Sec 09 T 29N R 02W.

79-4395

HITCHCOCK, M.G.

P.O. BOX 431, WHITE

SWAN WA 98952

Source: BIG SULPHUR trib.

to SNAKE RIVER, BIG

SULPHUR CREEK trib. to

SNAKE RIVER

Priority Date: 06/15/1919

Diversion Pt: NWNE NENW

SENE NESE NWSE SESE

Sec 01 T 28N R 03W NENE

SENE Sec 12 T 28N R 03W

NESW SWSW Sec 36 T 29N R

03W

Use: STOCKWATER (0.20

CFS)

In: NWNE NENW SENW

NESE NWSE Sec 01 T

28N R 03W NENE SENE Sec

12 T 28N R 03W NESW SWSW

Sec 36 T 29N R 03W.

Exceptions to a claim may

be filed with the Director,

Dept. of Water Resources,

Western Region, Statthouse,

Boise, Idaho 83720.

Ken Dunn, Dir.

Published 09/28 & 10/06/83.

528-05

## AFFIDAVIT OF PUBLICATION

Nona Donaldson being first duly sworn, says he is the office manager of the IDAHO COUNTY FREE PRESS, a weekly newspaper which is published and issued weekly at Grangeville, Idaho County, State of Idaho, and which is of general circulation in said county and state; that the said notice, of which the one hereto attached is a true copy, was published in said paper for 2 weeks, being published 2 times, the first publication being on the 28 day of September, 19 83, and the last publication on the 5 day of October, 1983; and that the said notice was published in the newspaper proper and not a supplement; that said newspaper has been continuously and uninterruptedly published in said county during a period of more than seventy-eight consecutive weeks prior to the first publication of said notice or advertisement.)

Nona C. Donaldson

Subscribed and sworn to before me this 6 day of October, 19 83

Notary Public  
for State of Idaho, residing at Grangeville, Idaho.

RECORDED

RECORDED  
1983 OCT 12

State of Idaho  
Department of Water Resources

CLAIM ANALYSIS SHEET

INITIAL REVIEW BY: 665

Right Number 79-4392 Applicant Hite/Conrad

NOTE: IF ANY OF THE ITEMS BELOW ARE MISSING, THE CLAIM IS INCOMPLETE AND MUST BE RETURNED IMMEDIATELY TO THE CLAIMANT ALONG WITH THE APPROPRIATE COVER LETTER.

CHECK:

- ☒ Name and address.
- ☒ Date of priority. (Check for a date past the mandatory filing dates.) (One date only.)
- ☒ Source.
- ☒ Quantity, use, period.
- ☒ Point(s) of diversion.
- ☒ Location of use.
- ☒ Signature/notarization/fee.

FINAL REGIONAL PROCESSING REVIEW:

- ☒ Affidavit of publication received. 10/14/83
- ☒ Claim published correctly. Idaho County Press  
4/28 & 10/5/83 30/28974
- ☒ Exceptions processed.

By 665 Date 2/9/84

STATE OFFICE PROCESSING:

- ☒ Claim review complete.

By DR Date 2/22/84

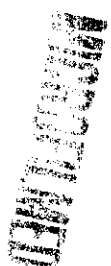

79-4392

HITCHCOCK, M. G.

P.O. BOX 431, WHITE SWAN, WA 98952

Source: UNNAMED STREAM trib. to DRY CREEK, LEFT FORK

Priority Date: 05/21/1919

Diversion Pt: SWNW NESW NWSW SWSW SESW Sec 30 T 29N R 02W NWNE  
Sec 29 T 29N R 02W NENW NWNW Sec 31 T 29N R 02W SENE SWNE  
Sec 25 T 29N R 03W

Use: STOCKWATER (0.20 CFS)

In: SWNW NESW NWSW SWSW SESW Sec 30 T 29N R 02W NWNE NENW NWNW  
Sec 31 T 29N R 02W SENE Sec 25 T 29N R 03W

RECEIVED



STATE OF IDAHO  
DEPARTMENT OF WATER RESOURCES  
Western Region

---

Statehouse  
Boise, Idaho 83720  
(208) 334-2190

OCTOBER 12, 1983

M. G. HITCHCOCK  
P.O. BOX 431  
WHITE SWAN WA 98952

RE: Claim No. 79-4392

Dear Claimant:

The Department of Water Resources has completed the advertising of your claim to a water right, and no further action is authorized under Section 42-243 and 42-244, IDAHO CODE. Your claim will be retained in our files and will be available at any time for use by you or the court.

The filing and advertising of the claim does not confirm the water right claimed, but will serve to record and preserve the information and the evidence which you included in your claim.

If, at a later date, you find that you have additional information or supporting evidence that you would like to have included with the claim, you may have that information or evidence added at any time. Please refer to the claim identification number when corresponding with this office.

We are enclosing a copy of your claim for your records. If you have questions, or if this office may be of further assistance, please feel free to contact us.

Yours truly,

DAVID B. SHAW  
Western Region Supervisor

Enclosure