

United States Department of the Interior  
Bureau of Reclamation

**Water Rental and Forbearance Agreement**  
with  
**South Elmore Irrigation Company, Inc.**

**COPY RECEIVED**  
JUN 25 2004

DEPARTMENT OF WATER RESOURCES

Reclamation Agreement No. **1425-04-WL-10-0005**

This Agreement is entered into pursuant to the Reclamation Act of 1902, as amended and supplemented, for the purpose of meeting commitments of the Bureau of Reclamation (Reclamation) under the Biological Opinions on the Operation of the Federal Columbia River Power System and the operation and maintenance of Reclamation Projects in the Snake River Basin above Brownlee Dam. This Agreement is by and between the United States of America, acting by and through the Department of the Interior, Bureau of Reclamation, represented by the officer executing this instrument on its behalf and South Elmore Irrigation Company, Inc., hereafter known as the Lessor.

**RECITALS**

- A. WHEREAS, Reclamation has commitments under Biological Opinions on the operation of the Federal Columbia River Power System and the operation and maintenance of Reclamation Projects in the Snake River Basin above Brownlee Dam to provide flow augmentation for delivery at Lower Granite Dam.
- B. WHEREAS, The Idaho Legislature authorized Reclamation to annually rent up to 427,000 acre-feet of storage water per year during the years 2002-2004 under the provisions of Idaho Code § 42-1763B.
- C. WHEREAS, In 2003, there was insufficient storage water available for rental by Reclamation to meet the 427,000 acre-feet rental target. Therefore, Reclamation conducted a pilot leasing program under which water right holders submitted proposals to idle land and place their water rights in the State Water Supply Bank, thereby increasing water flow downstream to Lower Granite Dam. Rules governing the Idaho State Water Supply Bank, IDAPA 37.02.03, provide that rentals shall be approved only for use in Idaho unless there is compliance with the provisions of Idaho Code § 42-401(3). In order to avoid the complexities of Reclamation seeking approval for out-of-state use, the water was rented by the Idaho Power Company and used for hydropower generation in Idaho with the result that additional water flowed to Lower Granite Dam for flow augmentation.
- D. WHEREAS, Similar to 2003, it is expected that insufficient storage water will be available this year for rental by Reclamation. Therefore, Reclamation is conducting another similar pilot program (Program). Under this Program, water right holders will forego irrigation of land and place their water right into the Idaho State Water Supply Bank. As a practical way of ensuring that Reclamation receives additional water, over and above the water flows that would otherwise be available, a qualification was added requiring that the land to which the water right is appurtenant was either irrigated last year or was in Reclamation's 2003

program explained in Recital C above. Again, it is intended for Idaho Power to rent the water from the State Water Supply Bank.

- E. Reclamation advertised a request for proposals to the public. In response, the Lessor submitted a proposal for participation in the Program. The proposal shows that the Lessor has a right to use water for irrigation purposes and absent this Program was intending to irrigate with the water proposed for the Program. Therefore, placing the Lessor's water in the Water Bank during 2004 will result in additional water in the Snake River at Lower Granite Dam, Oregon. This additional water will be counted towards Reclamation's obligation to provide 427,000 acre-feet of water at Lower Granite Dam.

## AGREEMENT

NOW THEREFORE, in consideration of the mutual and dependent covenants herein contained, the parties agree as follows:

- I. **Land Accepted into the Program**
- A. The total number of acres accepted into the Program is 4883.9 acres. The land, hereinafter referred to as the Land, accepted into the Program is identified as "LL" on the map(s) included in Attachment A. This is the maximum number of acres eligible for payment under this Agreement. Reclamation recognizes the following conditions may exist: 1) additional acres may have been proposed in the Lessor's application, 2) the Lessor may have a right to irrigate additional acres, 3) the Lessor may intend to irrigate additional acres in 2004 and is willing to idle those acres, and 4) the Lessor may submit an application to the State Water Supply Bank to lease water rights appurtenant to acres other than the acres identified in this Agreement. Notwithstanding any of the conditions stated above or any other conditions, under this "willing seller, willing buyer" Agreement, the number of acres covered by the Agreement is limited to the number and location stated in this section I.A. of the Agreement.
- B. If it is determined after the execution of this Agreement that certain acres are not eligible for the Program because of a mistake, error, or misrepresentation in the Lessor's application, the land covered under this Program will be reduced accordingly.
- C. The Land may not be irrigated from any source, regardless of whether there is another valid water right appurtenant to the Land. Water authorized to be diverted under water rights, or portions of water rights, leased to the Water Supply Bank may not be applied to lands that are not identified in this Agreement. The Lessor may not water the Land for any reason; for example, testing equipment, irrigating a cover crop, or dust abatement.
- D. IDWR intends to monitor the Lessor's idled lands. The monitoring will include field visits, and the collection and analysis of satellite data and related pump and flow measurements collected at IDWR's discretion. The Lessor agrees to allow the collection of data and access for field visits.

II. **Water Rights Appurtenant to the Leased Land**

- A. The Lessor agrees that this Agreement shall be submitted to the Idaho State Water Supply Bank as an application to lease water to the bank, and that the Lessor is offering the water rights described in Attachment A to the bank by signing this Agreement. The Lessor agrees that any additional information or requirement IDWR may require to process or accept the application shall be furnished promptly to IDWR, including but not limited to, the submission of a separate application form if required. Failure to comply with IDWR requests for information or other requirements is cause for termination of this agreement.
- B. All rentals of the Lessor's water rights out of the water bank shall be subject to Reclamation's approval.
- C. With respect to the water rights covered by this Agreement, the Lessor warrants that the Lessor has the right, title, and interest necessary to enter into this Agreement; and that there are no agreements, leases, licenses, liens or encumbrances which would prohibit the Lessor from placing the Lessor's water rights into the Idaho State Water Bank; and that to the extent necessary, the Lessor has obtained any consent or approval necessary to authorize the execution of this contract.
- D. The Lessor shall immediately notify Reclamation if there are any changes in ownership, or any encumbrances or liens placed upon, any of the real property or water rights covered by this contract during the term of the Agreement.

III. **Payment**

- A. By signing this Agreement the Lessor offers to the Idaho State Water Supply Bank the water rights described above for a total lease price of \$ 683,746.00 . This amount is based on \$ 140.00 per acre of land idled. The Lessor understands that the amount the Lessor will receive from the Idaho State Water Supply Bank is 90% of the total lease price. Ten percent will be retained by IDWR for administrative costs of operating the Water Supply Bank, pursuant to the Water Supply Bank Rules.
- B. Payment as shown in section III.A above is based upon a dollar amount per acre of land idled, regardless of the diversion rate or maximum diversion volume allowed under the water right, the historical diversion rate or consumptive use under the water right, or the diversion rate or diversion volume approved for lease by IDWR.
- C. Pursuant to the Water Supply Bank Rules, IDAPA 37.02.03, after the water rights are leased, payment is to be made by the Water Supply Bank to the Lessor. Lessor agrees to accept the following intended plan for payment by IDWR: One half of the estimated payment will be made on or about July 30, 2004, and the remainder will be paid after the irrigation season ends and final verification of program compliance is complete. Reclamation will enter into a separate contract with IDWR to make payment to the Water Supply Bank for this purpose.

IV. **Term, Termination of Agreement and Remedies**

- A. The Agreement shall become effective on the date of the last signature hereto and shall extend through December 31, 2004.
- B. At Reclamation's discretion, this Agreement may be terminated upon:
- (1) Failure of the Lessor to abide by the terms and conditions of this Agreement;
  - (2) Refusal of the Lessor to allow Reclamation or IDWR access to the Land to monitor compliance with the Agreement;
  - (3) Application of water by the Lessor to the Land during the period of this Agreement, except in emergency situations where the application of water is required for public safety reasons;
  - (4) Discovery of fraudulent information submitted in the Lessor's Application.
- C. If this Agreement is terminated for any other reason prior to its ending date, the Lessor shall reimburse Reclamation for a prorated portion of the amount stated in Section III.A of this Agreement, as determined by Reclamation.

V. **Miscellaneous**

- A. The Landowner or Lessor is responsible for all taxes, assessments, soil conservation measures such as weed and erosion control and other obligations related to any of the Land covered by this Agreement.
- B. The Landowner will indemnify and hold harmless Reclamation from any loss or damage and from any liability on account of personal injury, property damage, or claims for personal injury or death, or property damage of any nature caused by the Landowner or any person, firm or corporation acting on the Landowner's behalf related to or arising out this Agreement.
- C. **Water Right Ownership**
- This Agreement shall not be used as evidence of ownership of water rights in the Snake River Basin Adjudication.
- D. **Officials Not to Benefit**
- No member of or delegate to Congress or the Resident Commissioner shall be admitted to any share or part of this Agreement or to any benefit to arise therefrom, but this restriction shall not be construed to extend to this Agreement if made with a corporation or company for its general benefit.
- E. **Covenant Against Contingent Fees**

The Lessor warrants that no person or agency has been employed or retained to solicit or secure this Agreement upon an agreement or understanding for a commission, percentage, brokerage, or contingent fee except bona fide employees and bona fide commercial agencies maintained by the Lessor for the purpose of securing business. For breach or violation of this warranty, Reclamation shall have the right to revoke this Agreement without liability or in its discretion to require the Lessor to pay the full amount of such commission, percentage, brokerage, or contingency fee to the United States.

Signatures South Elmore Irrigation Co., Inc.

Print name(s): By Jack Post - President & Terry L. Ketterling - Secretary

Mailing address: P.O. Box 396, Mtn. Home, Id 83647

Phone: 587.2789 - Chris - Bkpr.

Signed [Signature] - President

Signed [Signature] - Secretary

Title: \_\_\_\_\_

Date: 4.19.04

On this 19<sup>th</sup> day of April, 2004, before me the undersigned Notary Public in and for said county and state, personally appeared Jack Post & Terry Ketterling, known to me to be the person whose name is subscribed to within instrument and acknowledged to me that he/she executed the same.

In WITNESS WHEREOF, I have hereunto set my hand and affixed my official seal, the day and year in this certificate first written.

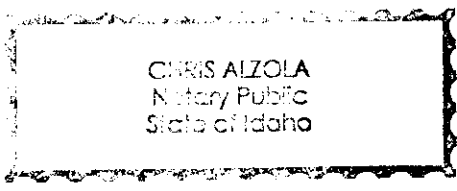

Chris Alzola  
Notary Public in and for Idaho  
Residing at: Mountain Home  
Commission Expires: 5.31.05

Signature: Kenneth R. Redde  
Acting for Regional Director, Pacific Northwest Region  
Bureau of Reclamation

Date: 5/3/04

State of Idaho )  
County of Ada ) S.S.

On this 3rd day of May 2004, before me the undersigned Notary Public in and for said county and state, personally appeared Kenneth R. Redde, known to me to be the person whose name is subscribed to within instrument and acknowledged to me that he/she executed the same.

In WITNESS WHEREOF, I have hereunto set my hand and affixed my official seal, the day and year in this certificate first written.

Lou Ann Wirick  
Notary Public in and for Idaho  
Commission Expires: Oct 22, 2008

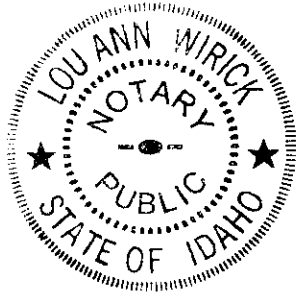

Water Right Numbers for lands in 2004 Snake River Pilot Leasing Program.  
02-2345, 02-2367, 02-2269

Legal Description of Lands Approved for 2004 Snake River Pilot Leasing Program.

TLK

TWN	RGE	SEC	NE				NW				SW				SE			
			NE	NW	SW	SE	NE	NW	SW	SE	NE	NW	SW	SE	NE	NW	SW	SE
5S	7E	18																
		19	33												22			39.8
		20		38			38	38					18.3	37	38.7	39.9	39	
		17									39.4	36	39.9	39.9		23.9	37.0	
		21										2						
		16									39.4	39.5	40	40	39	39.7	40.3	39.

TLK 4-26-04

Total 917.1

Applicant initials TLK Applicant initials \_\_\_\_\_ Applicant initials \_\_\_\_\_ Applicant initials \_\_\_\_\_

Total Acres for  
all 4 pages 4883.9

Water Right Numbers for lands in 2004 Snake River Pilot Leasing Program.  
02-2345, 02-2367, 02-2269

Legal Description of Lands Approved for 2004 Snake River Pilot Leasing Program.

405

TWN	RGE	SEC	NE				NW				SW				SE			
			NE	NW	SW	SE	NE	N W	SW	SE	NE	NW	SW	SE	NE	N W	SW	SE
5S	6E	15			36	37	34.6	39.2	17	6.2					30	31	30	30
		16	32	32	32	32	28	26.5	25.6	28								
		22	30	29	29	30								29.2	29	29	30	

Total 762.3

Applicant initials MB <sup>MWFC, FLCA</sup> Applicant initials \_\_\_\_\_ Applicant initials \_\_\_\_\_ Applicant initials \_\_\_\_\_  
 AUTHORIZED AGENT.

Water Right Numbers for lands in 2004 Snake River Pilot Leasing Program.  
  
02-2345, 02-2367, 02-2269

Legal Description of Lands Approved for 2004 Snake River Pilot Leasing Program.

*Hillhead*

TWN	RGE	SEC	NE				NW				SW				SE			
			NE	NW	SW	SE	NE	NW	SW	SE	NE	NW	SW	SE	NE	NW	SW	SE
5S	6E	14					30.9	26	40	40	40	40	40	40				
		23					40.4	40.5	40	40	38	38						

Total 523.8

Applicant initials JGH/SW Applicant initials \_\_\_\_\_ Applicant initials \_\_\_\_\_ Applicant initials \_\_\_\_\_

Water Right Numbers for lands in 2004 Snake River Pilot Leasing Program.

02-2345, 02-2367, 02-2269

Legal Description of Lands Approved for 2004 Snake River Pilot Leasing Program.

*Post*

TWN	RGE	SEC	NE				NW				SW				SE			
			NE	NW	SW	SE	NE	NW	SW	SE	NE	NW	SW	SE	NE	NW	SW	SE
5S	6E	11	38.7		39.7	39.7									39.5	40	35.6	35.7
		14	39	39	40	39.8									39.7	40	40	39.7
		23	39.5	40	26.4	39.4									33.1	11.6		
		1		38	39.5	41.2								39.7	39.8	40	39.9	39
		12	39	39.9	39.9	39	39.9	39.9	39.9	40	40	40	35.9	34.5	39	40	35.8	35.1
		13	38	39	40	39	33.2	39	40	40	40	40	40	40	35.8	40	37	36.1
		24	37.5			18.2	40	40	40	23.3		35						

*Total 2680.7*

Applicant initials *[Signature]* Applicant initials \_\_\_\_\_ Applicant initials \_\_\_\_\_ Applicant initials \_\_\_\_\_

April 7, 2004

Bureau of Reclamation  
Attn: Ruth Page  
Fax: 378-5305

Re: Questionable lands irrigated

This is to notify you that the 208.8 acres that are questionable land of the 2004 Snake River Pilot Leasing Program were irrigated in 2003.

If you have any questions, please call me at 587-4844.

Sincerely,



Bob Gibson  
South Elmore Irrigation Co., Inc.  
Ditch rider

\* Refer to attached map for notary.

Notary page for Bob Gibson - South Elmore Irrigation Co., Inc. Ditchrider

State of Idaho )  
County of Elmore ) S.S.

On this 7<sup>th</sup> day of April, in the year 2004, before me  
Chris Alzola, a notary public, personally  
appeared Bob Gibson,  
personally known to me to be the person(s) whose name(s) is(~~are~~) subscribed to  
the within instrument, and acknowledged to me that he (~~she~~) (~~they~~) executed the same.

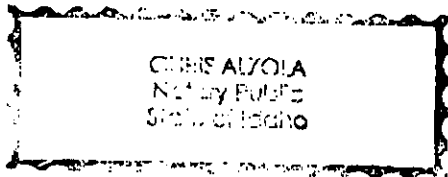

Chris Alzola  
Notary Public  
My Commission Expires on: 5-31-05



APPLICATION FOR PROPOSAL FOR SNAKE RIVER PILOT LEASING PROGRAM 2004

A. GENERAL

A1. Applicant name(s): South Elmore Irrigation Co., Inc.  
A2. Proposed price per acre: \$ 140.<sup>00</sup> per acre. Note that you will only receive 90% of that rate.  
A3. Number of acres you propose to idle: 5133 acres

B. INFORMATION ABOUT THE APPLICANT

B1. Type of applicant:  
 Single individual       Partnership       Limited liability co.  
 Joint owners       Corporation       Irrigation district       Other \_\_\_\_\_

B2. Taxpayer identification number, if applicable: 82-0312348

B3. Mailing Address: P.O. Box 396, Mountain Home, Id. 83647

B4. Daytime Phone Number: 587-2789 Additional cell phone number: 863-5818 Chris Fax: 587-3675

B5. E-mail Address: CALZOLA@earthlink.net 599-0400 Jack Post

B6. Do you  own the land that is to be idled?  
 lease the land that is to be idled?  
 neither, you only hold the water rights, e.g. irrigation district, canal company.

B7. If you lease the land that is to be idled, complete the following:  
a. Provide a copy of your entire lease.  
b. Does your lease provide for authorization to put water into the water bank?  
 Yes, on page \_\_\_ of my lease.  
 No, but I have separate authorization, which is enclosed.  
c. Name and address of the lessor landowner: \_\_\_\_\_

C. INFORMATION ABOUT THE LAND THAT WILL BE IDLED

C1. Does each tract of land you are proposing meet the eligibility criteria?  Yes  No  
C2. Were any of the proposed lands leased to the Idaho State Water Supply Bank under a 2003 contract with Reclamation?  Yes  No  
C3. Is a cover crop planned for the idled land?  No  Yes, my cover crop will be: Pea and Alfalfa  
C4. Have you completed and enclosed the attached grid? (See application instructions.)  Yes  
C5. Have you attached an **acceptable** map with the proposed acres identified? (See application instructions.)  Yes

C6. Have you enclosed acceptable evidence of irrigation of the proposed lands during the 2003 irrigation season? (See instructions)  Yes  
Refer to attached Imagery Map dated Sept. 23, 2003 for 2003 Snake River Pilot Leasing Program

**D. INFORMATION FOR EACH WATER RIGHT INCLUDED IN YOUR PROPOSAL**

If you are proposing to lease more than one water right, copy this section and fill out a separate page for each water right.

- D1. Water Right Number: 02-2269/02-2367
- D2. What is the basis of the water right?  permit  license  decree
- D3. Have you attached a copy of the permit, license, or decree?  Yes
- D4. Has a claim been made for the water right in the Snake River Basin Adjudication (SRBA)?  Yes Attach a copy of this SRBA claim.
- D5. Priority date of the water right: 02-2269 Priority Feb. 19, 64., 02-2367 Priority Mar. 22, 65.
- D6. (a) What is the total number of acres described in the place of use for irrigation under this water right? 5954 acres  
(b) Does this right have a permissible place of use?  Yes  No
- D7. Is the number of acres authorized for irrigation under this right limited within the place of use in a single irrigation season?  
 Yes, it is limited to 5954 acres.  
 No
- D8. Are any other water rights appurtenant to the proposed lands that are not included in this proposal?  
 Yes, the other water rights are: \_\_\_\_\_  
 No
- D9. How many acres authorized **under this water right** were irrigated during the 2003 season? 4,015 acres
- D10. Were any acres under this water right leased to the Idaho Water Supply Bank under a 2003 Contract with Reclamation?  
 Yes, 1791.7 acres.  
 No
- D11. Do you propose to enter only a portion of the water right into the Program?  Yes  No
- D12. If so, how many acres authorized under this water right will still be irrigated during the 2004 irrigation season if your proposal is accepted into the Program? \_\_\_\_\_ acres

*Attached for D3 - D4 • Notice of Claim  
To A Water Right Acquired Under  
State Law.*

**D. INFORMATION FOR EACH WATER RIGHT INCLUDED IN YOUR PROPOSAL**

If you are proposing to lease more than one water right, copy this section and fill out a separate page for each water right.

D1. Water Right Number: 02-2210

*Attached for D3 + D4 - Notice of Claim  
To A Water Right Acquired Under  
State Law.*

D2. What is the basis of the water right?  permit  license  decree

D3. Have you attached a copy of the permit, license, or decree?  Yes

D4. Has a claim been made for the water right in the Snake River Basin Adjudication (SRBA)?  Yes Attach a copy of this SRBA claim.

D5. Priority date of the water right: Apr. 12, 63

D6. (a) What is the total number of acres described in the place of use for irrigation under this water right? 847 acres

(b) Does this right have a permissible place of use?  Yes  No

D7. Is the number of acres authorized for irrigation under this right limited within the place of use in a single irrigation season?

Yes, it is limited to 847 acres.  
 No

D8. Are any other water rights appurtenant to the proposed lands that are not included in this proposal?

Yes, the other water rights are: \_\_\_\_\_  
 No

D9. How many acres authorized **under this water right** were irrigated during the 2003 season? 847 acres

D10. Were any acres under this water right leased to the Idaho Water Supply Bank under a 2003 Contract with Reclamation?

Yes, \_\_\_\_\_ acres.  
 No

D11. Do you propose to enter only a portion of the water right into the Program?  Yes  No

D12. If so, how many acres authorized under this water right will still be irrigated during the 2004 irrigation season if your proposal is accepted into the Program? 206 acres

**E. INFORMATION ABOUT OVERALL IRRIGATION PRACTICES**

**Answer E1 & E2 if you are a landholder, i.e. you own or lease land that was or will be irrigated, or you are a part owner of an entity that owns or leases land that was or will be irrigated.**

- E1. (a) If you are a landholder, how many acres did you irrigate in 2003, at any location from any water rights from, or tributary to, the Snake River? \_\_\_\_ acres
- (b) If you were a part owner of one or more entities that leased or owned land, how many acres did each entity irrigate in 2003, at any location from any water rights from, or tributary to, the Snake River? \_\_\_\_\_ acres
- E2. (a) How many acres do you intend to irrigate in 2004, at any location from any and all water sources from, or tributary to, the Snake River if your proposed acres are accepted? \_\_\_\_ acres
- (b) If you are a part owner of one or more entities that holds land and intends to irrigate in 2004, at any location from any and all water sources from, or tributary to, the Snake River if your proposed acres are accepted? \_\_\_\_ acres

**Answer E3 if you are completing this application on behalf of an irrigation district or canal company or similar entity.**

- E3. Submit the following information for each landholder who is proposing to idle land under this application:

**Landholder #1**

- (a) Name: Hillard Farms
- (b) Number of acres the landholder proposes to idle: 531 acres
- (c) Number of acres the landholder (either by him/herself, or as part of another entity, such as a partnership or limited liability company) irrigated in 2003 from any and all water sources from, or tributary to, the Snake River in any location: 393 acres
- (d) Number of acres the landholder (either by him/herself, or as part of another entity) plans to irrigate in 2004: 340 acres

E3 (cont.) Make copies of this page if you need additional space.

**Landholder #2**

- (a) Name: Jack Post
- (b) Number of acres the landholder proposes to idle: 2887 acres
- (c) Number of acres the landholder (either by him/herself, or as part of another entity, such as a partnership or limited liability company) irrigated in 2003 from any and all water sources from, or tributary to, the Snake River in any location: 2805 acres
- (d) Number of acres the landholder (either by him/herself, or as part of another entity) plans to irrigate in 2004: 1280 acres

**Landholder #3**

- a) Name: TLK Farms, Inc
- (b) Number of acres the landholder proposes to idle: 914 acres
- (c) Number of acres the landholder (either by him/herself, or as part of another entity, such as a partnership or limited liability company) irrigated in 2003 from any and all water sources from, or tributary to, the Snake River in any location: 5958 acres
- (d) Number of acres the landholder (either by him/herself, or as part of another entity) plans to irrigate in 2004: 4527 acres

**Landholder #4**

- a) Name: Northwest Farm Credit Service, FLCA
- (b) Number of acres the landholder proposes to idle: 801 acres
- (c) Number of acres the landholder (either by him/herself, or as part of another entity, such as a partnership or limited liability company) irrigated in 2003 from any and all water sources from, or tributary to, the Snake River in any location: 227 acres
- (d) Number of acres the landholder (either by him/herself, or as part of another entity) plans to irrigate in 2004: 0 acres

**Landholder #5**

- a) Name: \_\_\_\_\_
- (b) Number of acres the landholder proposes to idle: \_\_\_\_\_ acres
- (c) Number of acres the landholder (either by him/herself, or as part of another entity, such as a partnership or limited liability company) irrigated in 2003 from any and all water sources from, or tributary to, the Snake River in any location: \_\_\_\_\_ acres
- (d) Number of acres the landholder (either by him/herself, or as part of another entity) plans to irrigate in 2004: \_\_\_\_\_ acres

**SIGNATURES**

By signing below, you certify that the information included in this proposal is accurate and true to the best of your knowledge.

**NOTE:** To support your proposal, you may be asked to provide additional information. We will notify the applicant shown above if additional information is necessary.

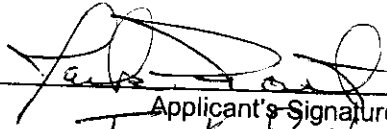

Applicant's Signature

Jack Jost

Printed Name

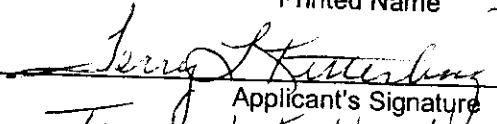

Applicant's Signature

Terry L Ketterling

Printed Name

Applicant's Signature

Printed Name

Applicant's Signature

Printed Name

Applicant's Signature

Printed Name

1-16-04

Date

President South Elmore Irrig Co.

Office held (if entity)

1-16-04

Date

Sec. Tres. South Elmore Irrig Co.

Office held (if entity)

Date

Office held (if entity)

Date

Office held (if entity)

Date

Office held (if entity)



For general Customer Service Account questions, please call 1-800-488-6151, or within the Treasure Valley area, 388-2323.

For more in-depth Irrigation related questions, please contact the IPCo Agricultural Rep for your area:

**Blackfoot, American Falls & Rupert**  
*Dennis Elison* 236-7744

**Burley, Twin Falls & Jerome**  
*Richard Hawkes* 736-3215

**Fairfield, Gooding & Hagerman**  
*Quentin Nesbitt* 388-2519

**Glenns Ferry, Grand View, & Boise**  
*Rex Winn* 388-6366

**Nampa, Weiser & Vale**  
*Mike Liechty* 465-8626

Account Information as of: 5/29/2003

**SO ELMORE CANAL CO**  
**PO BOX 396**  
**MOUNTAIN HOME ID 83647-0396**

**IRRIGATION ACCOUNTS**

Name	Account #	Old Location #	New Location #	Service City	Meter #	HP
SO ELMORE CANAL CO	5706189916	0490 POST	05S06E0101	MTN HOME	4483196	40
SO ELMORE CANAL CO	9827941458	0540 360	05S06E1102	MTN HOME	3473494	360
SO ELMORE CANAL CO	8005278767	0545 HP 150	05S06E1104	MTN HOME	1495942	150
SO ELMORE CANAL CO	9935731949	0570 POST	05S06E1201	MTN HOME	83080746	150
SO ELMORE CANAL CO	3322546438	0580 POST	05S06E1202	MTN HOME	58189843	325
SO ELMORE CANAL CO	7752995172	0550 POST	05S06E1401	MTN HOME	3473467	250
SO ELMORE CANAL CO	3615369333	0552 HP 275	05S06E1402	MTN HOME	2142552	150
SO ELMORE CANAL CO	2343002609	0527 300 HP	05S06E1502	MTN HOME	1495960	300
SO ELMORE CANAL CO	2062180799	0520 HERGERT IDR	05S06E1503	MTN HOME	50757009	200
SO ELMORE CANAL CO	4647520399	0535 SQUAW CRK	05S06E1504	MTN HOME	92536530	400
SO ELMORE CANAL CO	1670099078	0530 TLK	05S06E1505	MTN HOME	3473465	450
SO ELMORE CANAL CO	6883809921	0620 SMALL RELIFT	05S07E1703	MTN HOME	3473498	250
SO ELMORE CANAL CO	6883809921	0625 T L K	05S07E1704	MTN HOME	3473511	325
SO ELMORE CANAL CO	2900268224	0605 T L K	05S07E1705	MTN HOME	50595070	150
SO ELMORE CANAL CO	7974117760	0610 LARGE RE-IDR	05S07E1706	MTN HOME	4433220	600
SO ELMORE CANAL CO	6698104358	0615 T L K	05S07E1707	MTN HOME	4433221	1,350
SO ELMORE CANAL CO	4746561557	0645 T L K	05S07E2101	MTN HOME	2209651	125
SO ELMORE CANAL CO	2465865652	0640 T L K	05S07E2102	MTN HOME	70139610	250
SO ELMORE CANAL CO	9301012071	0635 T L K	05S07E2103	MTN HOME	4029549	100
SO ELMORE CANAL CO	9704288936	0628 FLYHSUB	05S07E2801	MTN HOME	4433222	4,300

*If you need power bills, please let me know*

*Thanks,  
Chris*



IN THE DISTRICT COURT OF THE FIFTH JUDICIAL DISTRICT OF THE STATE OF IDAHO,  
IN AND FOR THE COUNTY OF TWIN FALLS

IN RE THE GENERAL ADJUDICATION  
OF RIGHTS TO THE USE OF WATER FROM  
THE SNAKE RIVER BASIN WATER SYSTEM.

CIVIL CASE NUMBER: 39576

Ident. Number: A02-02269  
Date Received: 12/05/1989  
Receipt No: \_\_\_\_\_  
Received By: \_\_\_\_\_

NOTICE OF CLAIM TO A WATER RIGHT  
ACQUIRED UNDER STATE LAW

1. Name: SOUTH ELMORE IRRIGATION CO. 208-587-9881  
Address: P.O. BOX 396  
MOUNTAIN HOME, ID 83647

2. Date of Priority: FEB 19, 1964

3. Source: SNAKE RIVER Trib. to: COLUMBIA RIVER

4. Point of Diversion:

Township	Range	Section	1/4 of	1/4 of	1/4	Lot	County
05S	07E	28	NE	SW		2	ELMORE

5. Description of diverting works:  
PUMP, PIPELINE AND SPRINKLER SYSTEM

6. Water is used for the following purposes:

Purpose	From	To	C.F.S.	(or)	A.F.A.
IRRIGATION	03/15	11/15	87.110		

7. Total Quantity Appropriated is:  
87.110 C.F.S. (and/or) A.F.A.

8. Total consumptive use is 19698.0 Acre Feet Per Annum.

9. Non-irrigation uses:  
NA

10. Place of Use:

Township	Range	Section	1/4 of	1/4	Lot	Use	Acres
05S	06E	1	NW	NE	2	IRR	39.0
			SW	NE		IRR	40.0
			SE	NE		IRR	39.0

10. Place of Use: Continued

Township	Range	Section	1/4 of	1/4	Lot	Use	Acres			
05S	06E	1	NE	SW		IRR	40.0			
			NW	SW		IRR	40.0			
			SW	SW		IRR	40.0			
			SE	SW		IRR	40.0			
			NE	SE		IRR	39.0			
			NW	SE		IRR	40.0			
			SW	SE		IRR	40.0			
			SE	SE		IRR	39.0			
			Section Acres							436.0
3			NE	NE	1	IRR	40.0			
			NW	NE	2	IRR	40.0			
			SW	NE		IRR	40.0			
			SE	NE		IRR	40.0			
			NE	SW		IRR	40.0			
			NW	SW		IRR	40.0			
			SW	SW		IRR	40.0			
			SE	SW		IRR	40.0			
			NE	SE		IRR	40.0			
			NW	SE		IRR	40.0			
			SW	SE		IRR	40.0			
			SE	SE		IRR	40.0			
			Section Acres							480.0
			10			NE	NE		IRR	36.0
NW	NE					IRR	39.0			
SW	NE					IRR	40.0			
SE	NE					IRR	38.0			
NE	NW					IRR	40.0			
NW	NW					IRR	40.0			
SW	NW					IRR	40.0			
SE	NW					IRR	40.0			
NE	SW					IRR	40.0			
NW	SW					IRR	40.0			
SW	SW					IRR	39.0			
SE	SW					IRR	39.0			
NE	SE					IRR	38.0			
NW	SE					IRR	40.0			
SW	SE					IRR	39.0			
SE	SE					IRR	38.0			
Section Acres							626.0			
11			NE	NE		IRR	39.0			
			Section Acres							39.0

10. Place of Use: Continued

Township	Range	Section	1/4	of	1/4	Lot	Use	Acres
05S	06E	11	SW		NE		IRR	39.0
			SE		NE		IRR	40.0
			SW		SW		IRR	40.0
			NE		SE		IRR	39.0
			NW		SE		IRR	40.0
			SW		SE		IRR	39.0
			SE		SE		IRR	39.0
		12	NE		NE		IRR	39.0
			NW		NE		IRR	40.0
			SW		NE		IRR	40.0
			SE		NE		IRR	39.0
			NE		NW		IRR	40.0
			NW		NW		IRR	40.0
			SW		NW		IRR	40.0
			SE		NW		IRR	40.0
			NE		SW		IRR	40.0
			NW		SW		IRR	40.0
			SW		SW		IRR	39.0
			SE		SW		IRR	39.0
			NE		SE		IRR	39.0
			NW		SE		IRR	40.0
		SW		SE		IRR	39.0	
		SE		SE		IRR	39.0	
							Section Acres	633.0
		13	NE		NE		IRR	40.0
			NW		NE		IRR	40.0
			SW		NE		IRR	40.0
			SE		NE		IRR	39.0
			NE		NW		IRR	39.0
			NW		NW		IRR	39.0
			SW		NW		IRR	40.0
			SE		NW		IRR	40.0
			NE		SW		IRR	40.0
			NW		SW		IRR	40.0
			SW		SW		IRR	40.0
			SE		SW		IRR	40.0
			NE		SE		IRR	38.0
			NW		SE		IRR	40.0
			SW		SE		IRR	36.0
			SE		SE		IRR	40.0
							Section Acres	631.0

10. Place of Use: Continued

Township	Range	Section	1/4	of	1/4	Lot	Use	Acres			
05S	06E	14	NE		NE		IRR	40.0			
			NW		NE		IRR	40.0			
			SW		NE		IRR	40.0			
			SE		<u>NE</u>		IRR	40.0			
			NE		NW		IRR	31.0-			
			NW		NW		IRR	40.0-			
			SW		NW		IRR	40.0-			
			SE		NW		IRR	40.0			
			NE		SW		IRR	40.0			
			NW		SW		IRR	40.0			
			SW		SW		IRR	40.0			
			SE		SW		IRR	40.0			
			NE		<u>SE</u>		IRR	40.0			
			NW		SE		IRR	40.0			
			SW		SE		IRR	40.0			
			SE		SE		IRR	40.0			
										Section Acres	631.0
					15	SW		NE		IRR	40.0
						SE		NE		IRR	39.0
						NE		SE		IRR	40.0
			NW		SE		IRR	40.0			
			SW		SE		IRR	40.0			
			SE		SE		IRR	40.0			
							Section Acres	239.0			
		16	NE		NE		IRR	40.0			
			NW		NE		IRR	40.0			
			SW		NE		IRR	40.0			
			SE		NE		IRR	40.0			
			NE		SW		IRR	20.0			
			NW		SW		IRR	17.0			
			NE		SE		IRR	10.0			
			NW		SE		IRR	14.0			
							Section Acres	221.0			
		22	NE		NE		IRR	40.0			
			SE		NE		IRR	40.0			
			NE		SE		IRR	40.0			
			SE		SE		IRR	40.0			
							Section Acres	160.0			

10. Place of Use: Continued

Township	Range	Section	1/4	of	1/4	Lot	Use	Acres			
05S	06E	23	NE		NE		IRR	40.0			
			NW		NE		IRR	40.0			
			SW		NE		IRR	27.0			
			SE		NE		IRR	40.0			
			NE		NW		IRR	40.0			
			NW		NW		IRR	40.0			
			SW		NW		IRR	40.0			
			SE		NW		IRR	40.0			
			NE		SE		IRR	31.0			
			NW		SE		IRR	13.0			
										Section Acres	351.0
					24	NE		NE		IRR	37.0
		SE		NE			IRR	16.0			
		NE		NW			IRR	40.0			
		NW		NW			IRR	39.0			
		SW		NW			IRR	40.0			
		SE		NW			IRR	20.0			
		NW		SW			IRR	35.0			
							Section Acres	227.0			
	07E	17	NE		SW		IRR	40.0			
			NW		SW		IRR	36.0			
			NW		SE		IRR	39.0			
							Section Acres	115.0			
		18	NE		SE		IRR	3.0			
							Section Acres	3.0			
		20	SW		SW		IRR	21.0			
			SE		SW		IRR	40.0			
			NE		SE		IRR	38.0			
			NW		SE		IRR	39.0			
			SW		SE		IRR	40.0			
							Section Acres	178.0			
		21	NE		NE		IRR	38.0			
			NW		NE		IRR	39.0			
			SW		NE		IRR	40.0			

10. Place of Use: Continued

Township	Range	Section	1/4	of	1/4	Lot	Use	Acres
05S	07E	21	SE		NE		IRR	34.0
			NE		SW		IRR	40.0
			NW		SW		IRR	35.0
			Section Acres					
		22	NE		NW		IRR	38.0
			NW		NW		IRR	39.0
			SW		NW		IRR	40.0
			SE		NW		IRR	39.0
Section Acres							156.0	
Total Acres							5628.0	

11. Place of use in counties: ELMORE

12. Do you own the property listed above as place of use? YES

13. Other Water Rights Used:  
NONE

14. Remarks:

15. Basis of Claim: LICENSE

16. Signature(s)

(a.) By signing below, I/We acknowledge that I/We have received, read and understand the form entitled "How you will receive notice in the Snake River Basin Adjudication." (b.) I/We do \_\_\_\_\_ do not \_\_\_\_\_ wish to receive and pay a small annual fee for monthly copies of the docket sheet.

Number of attachments: \_\_\_\_\_

For Organizations:

I do solemnly swear or affirm that I am \_\_\_\_\_ Title \_\_\_\_\_ of \_\_\_\_\_

Organization \_\_\_\_\_, that I have signed the foregoing document in the space below as \_\_\_\_\_ Title \_\_\_\_\_ of \_\_\_\_\_

Organization \_\_\_\_\_ and that the statements contained in the foregoing document are true and correct.

\_\_\_\_\_  
Signature of Authorized Agent

\_\_\_\_\_  
Title and Organization

\_\_\_\_\_  
Date

State of Idaho )  
County of \_\_\_\_\_ ) SS.

Subscribed and sworn (or affirmed) before me this \_\_\_\_\_ day

of \_\_\_\_\_ 19 \_\_\_\_\_

\_\_\_\_\_  
Notary Public

Seal

Residing at \_\_\_\_\_

My Commission Expires \_\_\_\_\_

IN THE DISTRICT COURT OF THE FIFTH JUDICIAL DISTRICT OF THE STATE OF IDAHO,  
IN AND FOR THE COUNTY OF TWIN FALLS

IN RE THE GENERAL ADJUDICATION  
OF RIGHTS TO THE USE OF WATER FROM  
THE SNAKE RIVER BASIN WATER SYSTEM.

CIVIL CASE NUMBER: 39576

Ident. Number: A02-02367  
Date Received: 12/05/1989  
Receipt No: \_\_\_\_\_  
Received By: \_\_\_\_\_

NOTICE OF CLAIM TO A WATER RIGHT  
ACQUIRED UNDER STATE LAW

1. Name: SOUTH ELMORE IRRIGATION CO. 208-587-9881  
Address: P.O. BOX 396  
MOUNTAIN HOME, ID 83647
2. Date of Priority: MAR 22, 1965
3. Source: SNAKE RIVER Trib. to: COLUMBIA RIVER
4. Point of Diversion:
- | Township | Range | Section | 1/4 of | 1/4 of | 1/4 | Lot | County |
|----------|-------|---------|--------|--------|-----|-----|--------|
| 05S      | 07E   | 28      | NE     | SW     |     | 2   | ELMORE |
5. Description of diverting works:  
PUMP, PIPELINE, AND SPRINKLER SYSTEM
6. Water is used for the following purposes:
- | Purpose    | From  | To    | C.F.S | (or) | A.F.A. |
|------------|-------|-------|-------|------|--------|
| IRRIGATION | 03/15 | 11/15 | 6.520 |      |        |
7. Total Quantity Appropriated is:  
6.520 C.F.S. (and/or) A.F.A.
8. Total consumptive use is 1141.0 Acre Feet Per Annum.
9. Non-irrigation uses:  
NA
10. Place of Use:

Township	Range	Section	1/4 of	1/4	Lot	Use	Acres
05S	06E	11	SE	SW		IRR	6.0
Section Acres							6.0

10. Place of Use: Continued

Township	Range	Section	1/4	of	1/4	Lot	Use	Acres.
05S	06E	16	NE		NW		IRR	40.0
			NW		NW		IRR	40.0
			SW		NW		IRR	40.0
			SE		NW		IRR	40.0
						Section Acres		160.0
		23	NE		SW		IRR	40.0
			NW		SW		IRR	40.0
			SW		SW		IRR	40.0
			SE		SW		IRR	40.0
						Section Acres		160.0
						Total Acres		326.0

11. Place of use in counties: ELMORE

12. Do you own the property listed above as place of use? YES

13. Other Water Rights Used:  
NONE

14. Remarks:  
THIS RT WHEN COMBINED WITH RT 02-2269 SHALL NOT EXCEED 87.11 CFS.

15. Basis of Claim: LICENSE

16. Signature(s)

(a.) By signing below, I/We acknowledge that I/We have received, read and understand the form entitled "How you will receive notice in the Snake River Basin Adjudication." (b.) I/We do \_\_\_\_\_ do not \_\_\_\_\_ wish to receive and pay a small annual fee for monthly copies of the docket sheet.

Number of attachments: \_\_\_\_\_

For Organizations:

I do solemnly swear or affirm that I am \_\_\_\_\_ of \_\_\_\_\_ Title

\_\_\_\_\_, that I have signed the foregoing

Organization document in the space below as \_\_\_\_\_ of \_\_\_\_\_ Title

\_\_\_\_\_ and "that" the statements contained in the Organization foregoing document are true and correct.

\_\_\_\_\_  
Signature of Authorized Agent

\_\_\_\_\_  
Title and Organization

\_\_\_\_\_  
Date

State of Idaho )  
County of \_\_\_\_\_ ) SS.

Subscribed and sworn (or affirmed) before me this \_\_\_\_\_ day

of \_\_\_\_\_ 19 \_\_\_\_\_

\_\_\_\_\_  
Notary Public

Seal

Residing at \_\_\_\_\_

My Commission Expires \_\_\_\_\_

IN THE DISTRICT COURT OF THE FIFTH JUDICIAL DISTRICT OF THE STATE OF IDAHO,  
IN AND FOR THE COUNTY OF TWIN FALLS

IN RE THE GENERAL ADJUDICATION  
OF RIGHTS TO THE USE OF WATER FROM  
THE SNAKE RIVER BASIN WATER SYSTEM.

CIVIL CASE NUMBER: 39576

Ident. Number: A02-02210  
Date Received: 12/05/1989  
Receipt No: \_\_\_\_\_  
Received By: \_\_\_\_\_

NOTICE OF CLAIM TO A WATER RIGHT  
ACQUIRED UNDER STATE LAW

1. Name: SOUTH ELMORE IRRIGATION CO. 208-587-9881  
Address: P.O. BOX 396  
MOUNTAIN HOME, ID 83647

2. Date of Priority: APR 12, 1963

3. Source: SNAKE RIVER Trib. to: COLUMBIA RIVER

4. Point of Diversion:

Township	Range	Section	1/4 of	1/4 of	1/4	Lot	County
05S	07E	28	NE	SW		2	ELMORE

5. Description of diverting works:  
PUMP & PIPELINE.

6. Water is used for the following purposes:

Purpose	From	To	C.F.S.	(or)	A.F.A.
IRRIGATION	03/15	11/15	17.900		

7. Total Quantity Appropriated is:  
17.900 C.F.S. (and/or) A.F.A.

8. Total consumptive use is 2964.5 Acre Feet Per Annum.

9. Non-irrigation uses:  
NA

10. Place of Use:

Township	Range	Section	1/4 of	1/4	Lot	Use	Acres
05S	07E	16	NE	NE		IRR	7.0
			NW	NE		IRR	5.0
			SW	NE		IRR	36.0

10. Place of Use: Continued

Township	Range	Section	1/4	of	1/4	Lot	Use	Acres
05S	07E	16	SE		NE		IRR	37.0
			NE		NW		IRR	26.0
			NW		NW		IRR	36.0
			SW		NW		IRR	39.0
			SE		NW		IRR	40.0
			NE		SW		IRR	40.0
			NW		SW		IRR	40.0
			SW		SW		IRR	40.0
			SE		SW		IRR	40.0
			NE		SE		IRR	39.0
			NW		SE		IRR	40.0
			SW		SE		IRR	40.0
			SE		SE		IRR	39.0
		17	SW		SW		IRR	40.0
			SE		SW		IRR	40.0
			SW		SE		IRR	37.0
							Section Acres	117.0
		18	SE		SE		IRR	40.0
							Section Acres	40.0
		19	NE		NE		IRR	32.0
							Section Acres	32.0
		20	NW		NE		IRR	38.0
			NE		NW		IRR	38.0
			NW		NW		IRR	38.0
							Section Acres	114.0
							Total Acres	847.0

11. Place of use in counties: ELMORE

12. Do you own the property listed above as place of use? YES

13. Other Water Rights Used:  
NONE

14. Remarks:

15. Basis of Claim: LICENSE

16. Signature(s)

(a.) By signing below, I/We acknowledge that I/We have received, read and understand the form entitled "How you will receive notice in the Snake River Basin Adjudication." (b.) I/We do \_\_\_\_\_ do not \_\_\_\_\_ wish to receive and pay a small annual fee for monthly copies of the docket sheet.

Number of attachments: \_\_\_\_\_

**For Individuals:**

I/We do solemnly swear or affirm that the statements contained in the foregoing document are true and correct.

Signature of Claimant(s): \_\_\_\_\_ Date: \_\_\_\_\_  
\_\_\_\_\_ Date: \_\_\_\_\_

State of Idaho )  
) SS.  
County of \_\_\_\_\_ )

Subscribed and sworn (or affirmed) before me this \_\_\_\_\_ day  
of \_\_\_\_\_ 19 \_\_\_\_\_

\_\_\_\_\_  
Notary Public

Seal

Residing at \_\_\_\_\_  
My Commission Expires \_\_\_\_\_

R07 E R08 E

R06 E R07 E

2 Miles

1

0

1

# South Elmore Irrigation Company







Satellite Imagery collected: July 26, 2002



T04 S  
T05 S

T05 S  
T06 S

**Water Right Numbers**

-  02-2269 / 02-2367 (including 1996 Transfer)
-  02-2210
-  02-2345 - PERMIT
-  02-7263
-  02-7255
-  02-7317
-  Lands to be added/removed with expansion claim

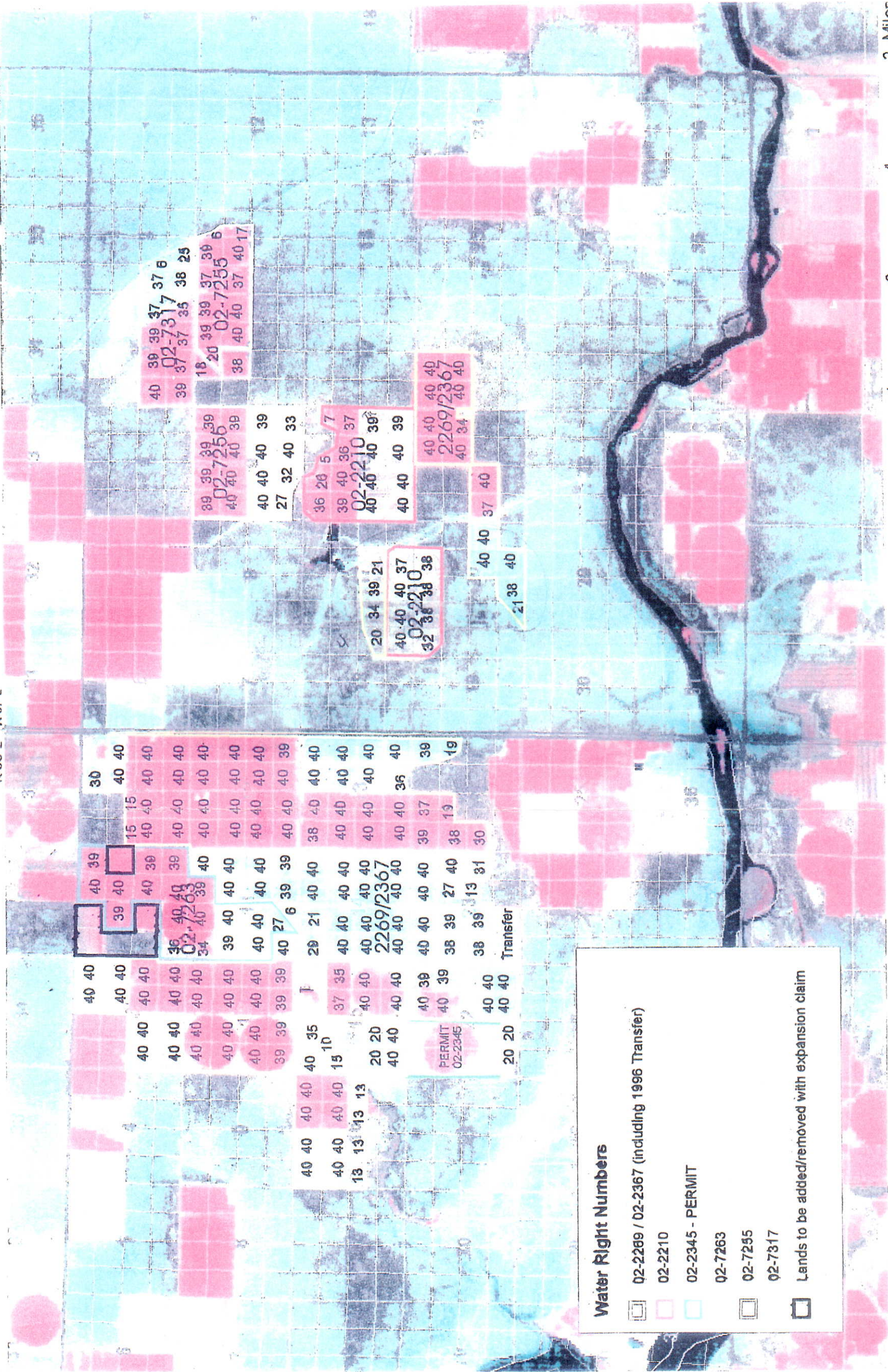

3-2-04 Cynthia,

Here is the information for the questionnaire here,  
 on South Eamon Aborigines.

If this isn't right or you need something  
 else, please let me know.

Thanks,  
 Chris

PROGRAM YEAR 2003  
 DATE: 03-02-2004

REPORT OF ACREAGE  
 FARM AND TRACT DETAIL LISTING

Original: \_\_\_\_\_  
 Revision: \_\_\_\_\_  
 Cropland: 634.0  
 Farmland: 648.0

Land Use	Reported Acreage	Determined Acreage	D/F	Prop Stat	Prod Share	Prod LU	RMA Unit	Ent Unit
F FAY	240.00			I	.1250 .2500 .3750	4415 8734 2319		
F FAY	78.50			I	.1250 .2500 .3750	4915 9731 2319		
F FAY	41.50			I	.1250 .2500 .3750	4915 9731 2319		
	171.00			I	1.0000	2319		
	103.00			I	1.0000	2319		
Prop Type	Mon-Irrig	Irrigated	SPR	Type	Spec	LU	Mon-Irrig	Irrigated
SPR	I	FA						.0
1: S23H1, S24	T55 R6E SEC 14.23						Reported D.S.R.	.0
orted:	634.0	Difference:						.0

R16E

S 23, 24

Verification of  
Questionable Acre  
for South Elmore  
Irrigation Co.  
2004 Snake River  
Pilot Leasing Program

2003<sup>370</sup><sub>441</sub>

10 11  
15 14

23H1

T367  
814

25% Hilliard  
CLARK  
50% DERRON  
33 1/3 JASOW  
16 2/3 WYATT

360 AC  
POTATOES

1  
162.4

R 6 E

1. 240.0

15 14 2. 78.5  
22 23

3  
170.3

old Past  
Oats farm

171 AC  
OATS

71 ballast

5  
181.3 HA

FARM # 814

OPERATOR'S CERTIFICATION: I certify to the best of my  
knowledge and belief that the acreage of crops and land uses listed are  
true and correct, and that all required crops and land uses have been  
reported for the farm as applicable. The signing of this certification gives  
SA representatives authorization to enter and inspect crops and land uses  
on the above-identified land.

Signature *John W. Clark*

Date 6-23-03

OPERATOR'S CERTIFICATION: I certify to the best of my knowledge and belief that the acreage of crops and land uses listed are true and correct, and that all required crops and land uses have been reported for the farm as applicable. The signing of this certification gives FSA representatives authorization to enter and inspect crops and land uses on the above-identified land.

6-23-03  
Date

FARM # 814

OPERATOR'S CERTIFICATION: I certify to the best of my knowledge and belief that the acreage of crops and land uses listed are true and correct, and that all required crops and land uses have been reported for the farm as applicable. The signing of this certification gives FSA representatives authorization to enter and inspect crops and land uses on the above-identified land.

[Signature]  
Signature

6-26-03  
Date

22 | 23  
27 | 26  
3 HEL  
315.5

FARM # 814

OPERATOR'S CERTIFICATION: I certify to the best of my knowledge and belief that the acreage of crops and land uses listed are true and correct, and that all required crops and land uses have been reported for the farm as applicable. The signing of this certification gives FSA representatives authorization to enter and inspect crops and land uses on the above-identified land.

[Signature]  
Signature

5-29-03  
Date

5  
113.2  
HEL

5  
181.3 HA

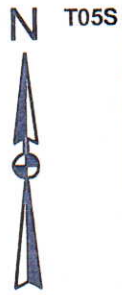

Prepared by: M. Wilkins  
 Idaho Department of Water Resources  
 1300 North Central Street  
 Boise, ID 83706  
 (208) 373-7900

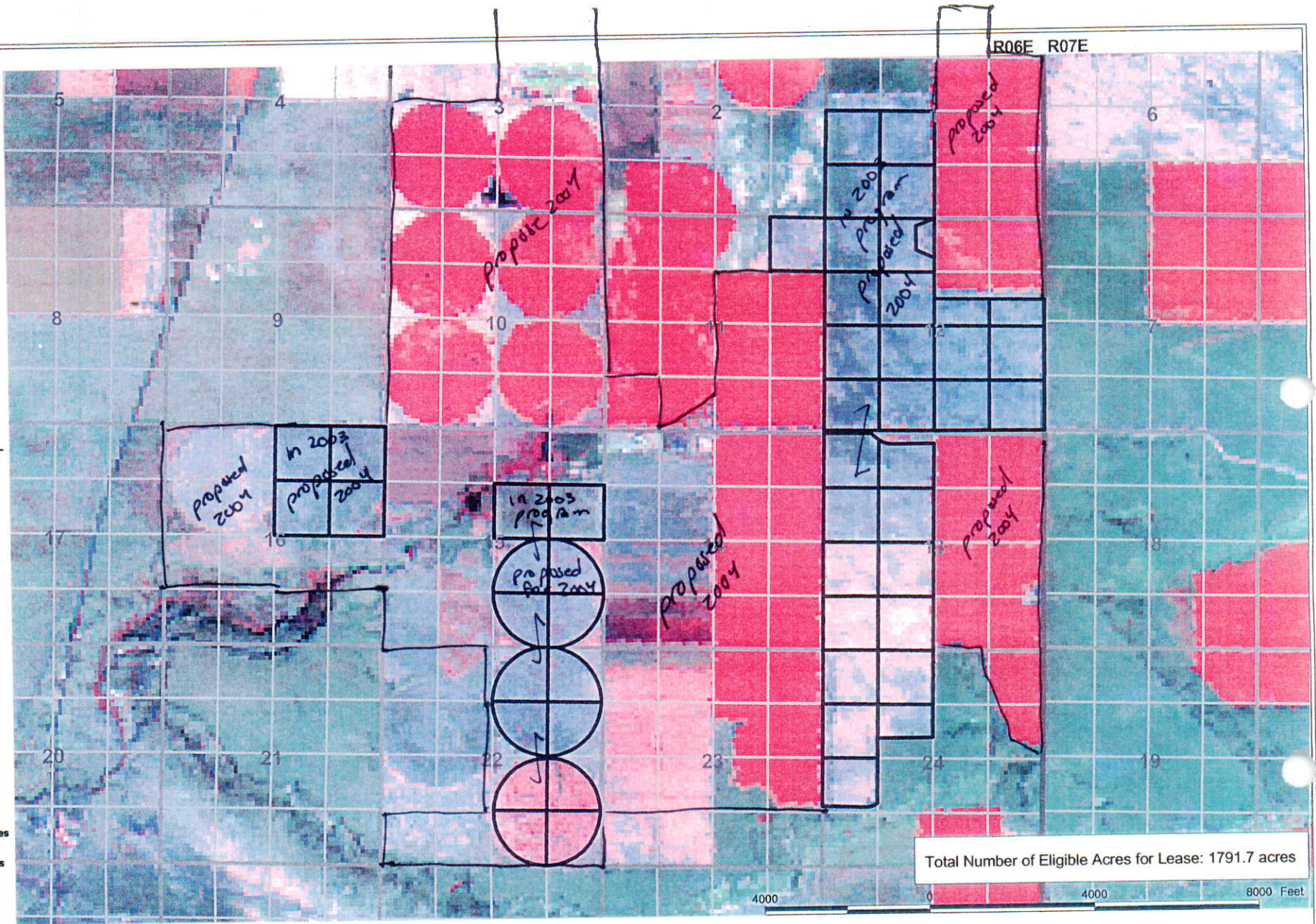

- ELIGIBLE
- INELIGIBLE
- QUESTIONABLE
- Township/Range Lines
- Section Lines
- Quarter/Quarter Lines

Total Number of Eligible Acres for Lease: 1791.7 acres



Imagery: September 23, 2003

## South Elmore Irrigation, Inc.

### 2003 Snake River Pilot Leasing Program Rental of Water from the Water Supply Bank

Prepared: December 2, 2003

