

# BLUE LAKES TROUT FARM

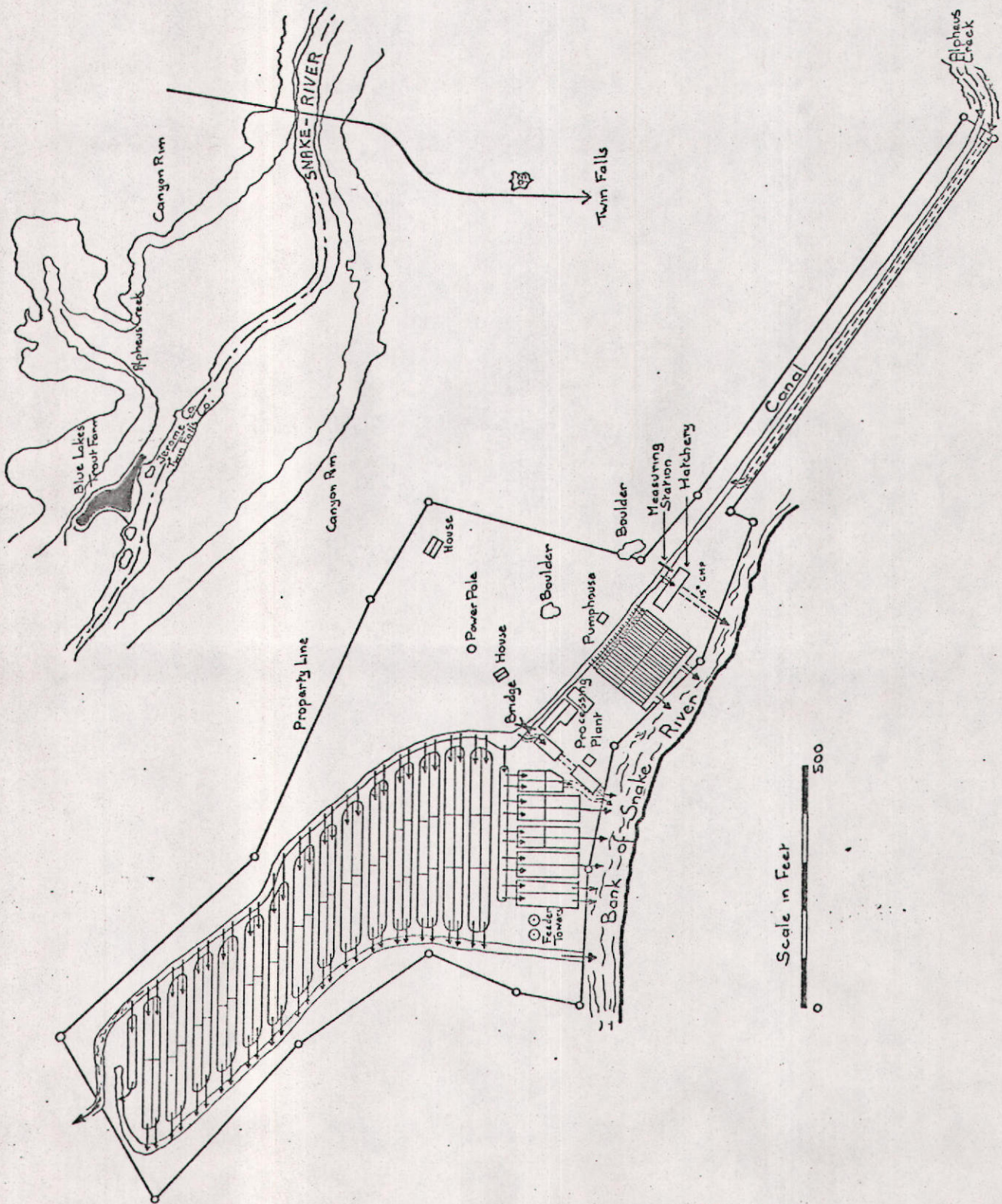
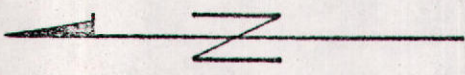
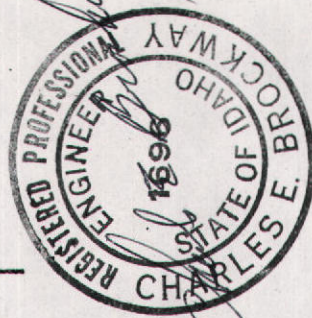

# AFFIDAVIT OF PUBLICATION

# RECEIVED

State of Idaho, }  
County of Jerome } SS.

JAN 20 1974

Department of Water Administration  
Southern District Office

Ernest Hansen, being first duly sworn, deposes and says that he is the printer (publisher) of the Jerome North Side News, a newspaper published every week in Jerome, County of Jerome, State of Idaho; that said newspaper has been continuously and uninterruptedly published for a period of seventy-eight consecutive weeks prior to the first publication of the annexed notice, and is a newspaper qualified to publish legal notices as provided by act of the 1919 session of the legislature of the State of Idaho, known as House Bill 145; that the annexed advertisement was published once

each week for two consecutive issues in said newspaper proper and not in a supplement; that the date of the first publication of said advertisement was on the 10<sup>th</sup> day of January, 1974, and the date of the last publication was on the 17<sup>th</sup> day of January, 1974.

Subscribed and sworn to before me this 18<sup>th</sup> day of January, 1974.  
(SEAL)

Darla Bratt  
NOTARY PUBLIC

NORTH SIDE NEWS  
Jerome, Idaho

## COST OF PUBLICATION

Number of Lines in Notice .....	_____	_____	_____
Number of Insertions .....	_____	_____	_____
Lines tabular at .....	315c	_____	_____
<u>36</u> Lines straight at .....	21c	<u>7.56</u>	_____
<u>36</u> Subsequent lines at .....	15c	<u>5.40</u>	_____
TOTAL COST ....	_____	<u>12.96</u>	_____

## COPY OF NOTICE

(Paste Here)

Water Permit  
TITLE OF NOTICE  
36-7427

PLAINTIFF ATTORNEY

DEFENDANT

PLAINTIFF

Dept Water  
BILL TO

### NOTICE OF APPLICATION FOR WATER PERMIT

Notice is hereby given that Blue Lakes Trout Farm, Box 1237, Twin Falls, ID has on December 20, 1973 submitted Application No. 36-7427 for a permit to appropriate 52.23 cubic feet per second of water from Alpheus Creek, tributary of Snake River by means of existing ditch and headgate within the Gvt. Lot 14, Sec. 28, T. 9S, R. 17E, B.M., Jerome County to be used from Jan. 1 to Dec. 31 for fish propagation within the Lot 13, Sec. 28; Lots 14 and 19, Sec. 29, T. 9S, R. 17E, B.M.

If issued, this permit will be subject to all prior water rights. Protest against the granting of the permit must be filed with the Idaho Department of Water Administration, 1041 Blue Lakes Blvd. North, Twin Falls, Idaho, 83301 on or before January 28, 1974.

R. KEITH HIGGINSON  
Director

1-10-21c-11

No. 2305

36 7427

# Calibration of Staff Gage

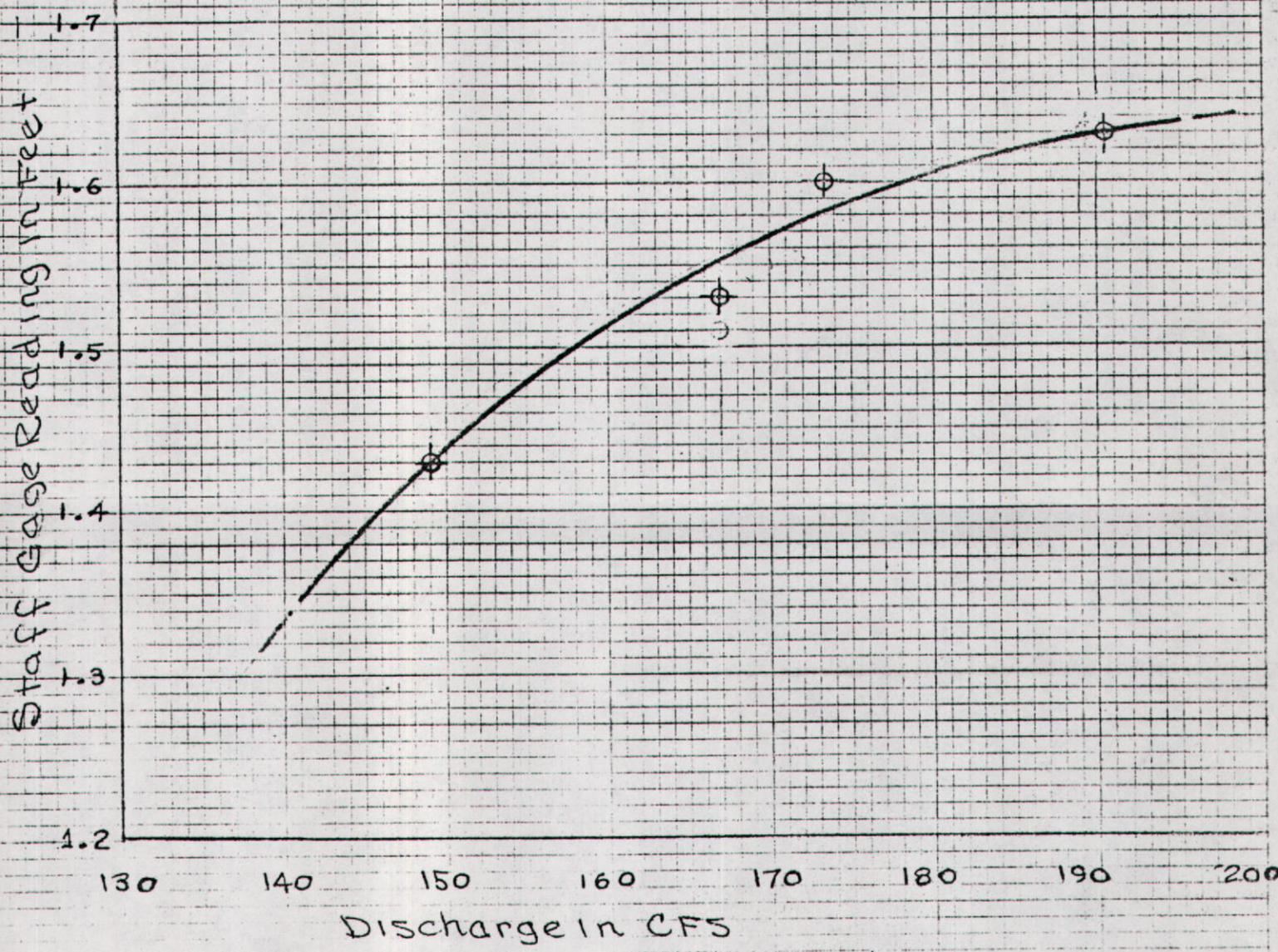

⊕ Measured Value

Gage	CFS	Date
1.63	190.4	2/15/77
1.43	149.1	2/15/77
1.60	173.5	2/22/77
1.53	166.9	2/23/77

MICROFILMED



BLUE LAKES TROUT FARM

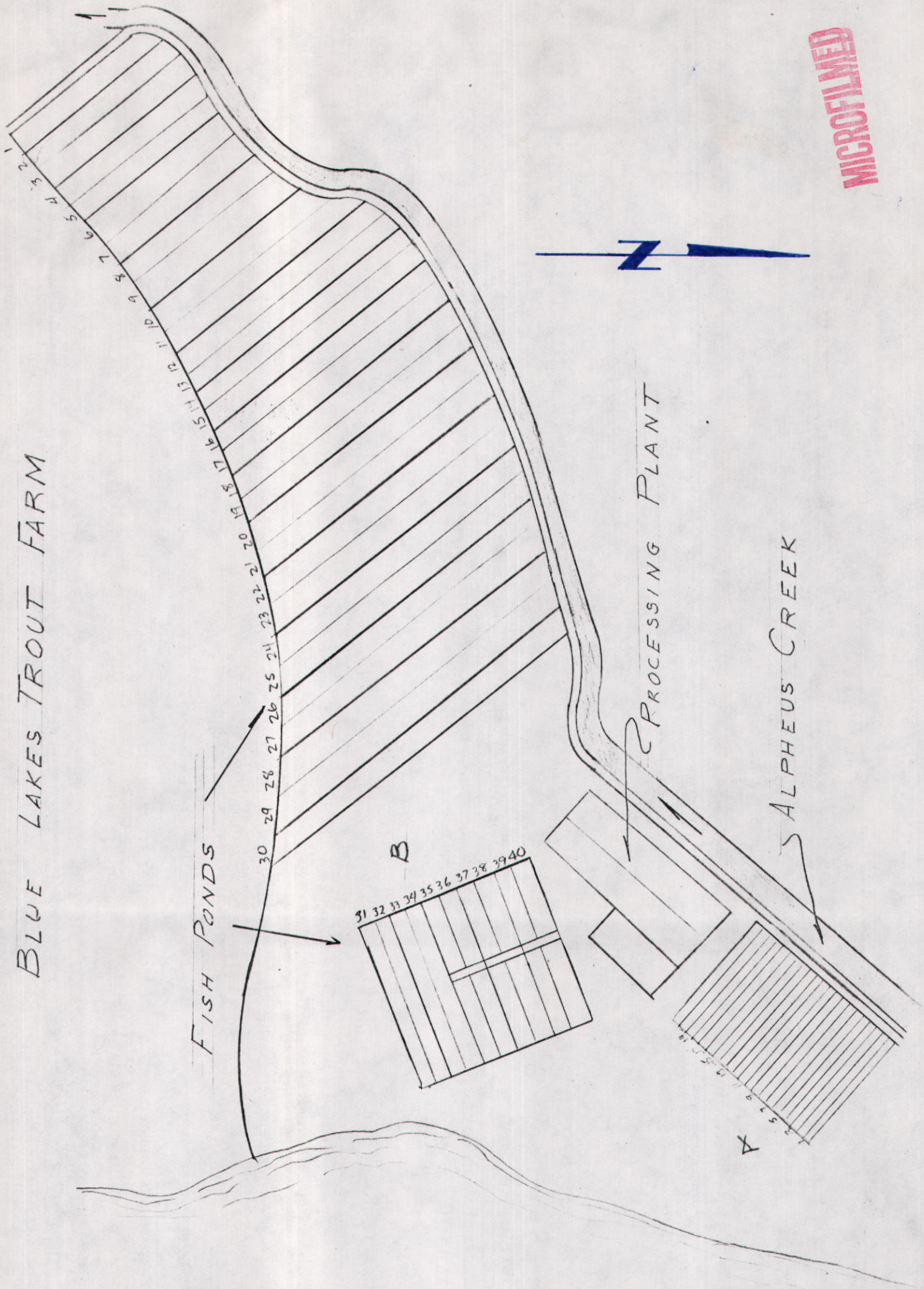

FISH PONDS

PROCESSING PLANT

SALPHEUS CREEK

MICROFILMED

State of Idaho  
Department of Water Resources

**WATER RIGHT LICENSE**

License of Water Right No. 36-7427 Priority December 28, 1973 Amount 52.23 cfs

THIS IS TO CERTIFY, that BLUE LAKES TROUT FARM  
of Twin Falls, Idaho, has complied with the terms and conditions of Permit  
No. 36-7427 issued pursuant to Application for Permit dated December 28, 1973,  
and has submitted proof to the Department of Water Resources on January 30, 1976,  
that he has applied water to a beneficial use; an examination by the Department indicates that the works have a  
capacity for the diversion of 190.4 cfs of water from Alpheus Creek,  
tributary to Snake River, and that the permit holder has applied to a beneficial use and  
established a right to use water as follows:

Beneficial Use	Period of Use	Rate of Diversion	Annual Volume
Fish Propagation	from <u>Jan. 1</u> to <u>Dec. 31</u>	at <u>52.23</u> cfs and	<u>N/A</u>
	from _____ to _____	at _____ cfs and	_____
	from _____ to _____	at _____ cfs and	_____

(both dates inclusive)

Subject, however, to the condition that no more than 52.23 cfs of water be diverted at any one time, and  
that the amount of water so diverted and to which such right is entitled and confirmed is for the purpose  
aforementioned and is limited to the amount which can actually be beneficially used and shall not exceed  
N/A acre feet per year, said waters to be diverted within the Gov't Lot 14, Sec. 28,  
Twp. 9S, Rge. 17E, B.M. in the County of Jerome

Description and location of place of use:

Twp.	Range	Sec.	NE¼				NW¼				SW¼				SE¼				Totals	
			NE¼	NW¼	SW¼	SE¼	NE¼	NW¼	SW¼	SE¼	NE¼	NW¼	SW¼	SE¼	NE¼	NW¼	SW¼	SE¼		
9S	17E	28									Lot 13									
		29			Lot 14								Lot 19							

Total number of acres irrigated \_\_\_\_\_

Measuring devices of a type approved by this Department shall be maintained at the point of diversion and the point of effluent discharge.

**NOTE:** Modifications to or variance from this license must be made within the limits of Section 42-222, Idaho Code, or the applicable Idaho Law. This right may be forfeited by five years of non-use.

The right to the use of the water hereby confirmed is restricted and appurtenant to the lands or place of use herein described, as provided by the laws of Idaho.

Witness the seal and signature of the Director, affixed at Boise, Idaho, this 9 day of

March, 19 78.

  
Director

STATE OF IDAHO  
DEPARTMENT OF WATER ADMINISTRATION

APPLICATION FOR EXTENSION OF TIME

State of Idaho )  
County of Twin Falls )

Permit No. 36-7427

PERCY M. GREENE, President  
Blue Lakes Trout Farm, Inc.

of P. O. Box 1237, Twin Falls, ID 83301

(name)

(address)

State of Idaho, being first duly sworn, upon his oath deposes and says:

That he is the holder, or the duly authorized agent of the holder \*, of Permit to appropriate the Public Waters of the State of Idaho No. 36-7427.

That under the terms and conditions of said permit, work thereunder was required to be completed on or before February 1, 19 75.

That he has heretofore performed the following work described under said permit:  
Fixing canal bank with riprap and additional material

Costing \$ \_\_\_\_\_

That he is unable to complete the remainder of the work within the required time for the following reasons, to-wit: The weir has not been completed because: (1) Extra work on the canal bank required more time and effort than we had anticipated; (2) After delayed completion of the canal bank, the onset of winter weather has prevented completion of the weir.

Wherefore, he asks that the Department of Water Administration extend the time for the completion of obligations under said permit to July 1, 19 75.

BLUE LAKES TROUT FARM, INC.,

By Percy M. Greene  
(signature) \* President

Subscribed and sworn before me this 8 day of January, 19 75.

seal

Janice L. Moore  
(notary public)

My commission expires 5-25-76

ACTION OF THE DEPARTMENT OF WATER ADMINISTRATION

I, R. KEITH HIGGINSON, Director of the Idaho Department of Water Administration, State of Idaho, hereby approve the above application for extension of time for Permit No. 36-7427 to February 1, 1976.

Witness my hand this 27 day of January, 19 75.

R. Keith Higginson  
Director

\* IF OTHER THAN HOLDER, Power of Attorney must be supplied. Forms are available through the Department of Water Administration, Statehouse - Annex 2, Boise, Idaho, 83707.

MICROFILMED

Identification No. \_\_\_\_\_

Application No. 36-7427

STATE OF IDAHO  
DEPARTMENT OF WATER ADMINISTRATION

APPLICATION FOR PERMIT

APPROVED

To Appropriate the Public Waters of the State of Idaho  
(TYPE OR PRINT IN INK)

1. Name of applicant BLUE LAKES TROUT FARM  
post office address Box 1237, Twin Falls, Idaho 83301

2. Source of water supply Alpheus Creek which is a tributary of Snake River

3. a. Location of point of diversion is <sup>Gvt</sup> Lot 14 ~~xxx~~ ~~xxxx~~ Section 28 Township 9S  
Range 17E. B.M. Jerome County; additional points of diversion if any: \_\_\_\_\_

b. If water is not consumed, it will be discharged into Snake River at a point in Lot 19 ~~xx~~  
~~xxx~~ ~~xxx~~ of Section 29 Township 9S Range 17E. B.M. Jerome County

4. Water will be used for the following purposes:  
Amount 52.23 cfs for Fish Hatchery purpose from Jan. 1 to Dec. 31 (both dates inclusive)  
(cfs or acre-feet per annum)  
Amount \_\_\_\_\_ for \_\_\_\_\_ purpose from \_\_\_\_\_ to \_\_\_\_\_ (both dates inclusive)  
(cfs or acre-feet per annum)  
Amount \_\_\_\_\_ for \_\_\_\_\_ purpose from \_\_\_\_\_ to \_\_\_\_\_ (both dates inclusive)  
(cfs or acre-feet per annum)

5. Total quantity to be appropriated:  
a. 52.23 cubic feet per second and/or  
b. \_\_\_\_\_ acre feet per annum.

6. Proposed diverting works:  
a. Description of ditches, flumes, pumps, headgates, etc. Existing ditch and headgate  
used in connection with and described fully in application  
for State of Idaho water license No. 27502 (see Remarks)

b. Height of storage dam \_\_\_\_\_ feet, active reservoir capacity \_\_\_\_\_ acre feet; total reservoir capacity \_\_\_\_\_ acre feet, materials used in storage dam: \_\_\_\_\_  
Period of year during which storage will occur \_\_\_\_\_ to \_\_\_\_\_ inclusive.  
(Mo. Day) (Mo. Day)

c. Proposed well diameter is \_\_\_\_\_ inches; proposed depth of well is \_\_\_\_\_ feet.

7. a. Time required for the completion of the works and application of the water to the proposed beneficial use is 1 years. (Will utilize existing works and continue current use)  
b. Estimated construction cost is \$ 0.

8. Description of proposed uses:  
a. If water is **not** for irrigation: Lot 13, Section 28 and Lots 14 and 19  
(1) Give the place of use of water: ~~xxx~~ ~~xxxx~~ Section 29 Township 9S  
Range 17E. B.M.  
(2) Amount of power to be generated: \_\_\_\_\_ hp under \_\_\_\_\_ feet of head.  
(3) List number of each kind of livestock to be watered \_\_\_\_\_  
(4) Name of municipality to be served \_\_\_\_\_, or number of families to be supplied with domestic water \_\_\_\_\_.  
(5) If water is to be used for other purposes describe: Fish Hatchery

b. If water is for irrigation, indicate acreage in each subdivision in the tabulation below:

TWP.	RANGE	SEC.	NE <sup>1</sup> / <sub>4</sub>				NW <sup>1</sup> / <sub>4</sub>				SW <sup>1</sup> / <sub>4</sub>				SE <sup>1</sup> / <sub>4</sub>				TOTALS
			NE <sup>1</sup> / <sub>4</sub>	NW <sup>1</sup> / <sub>4</sub>	SW <sup>1</sup> / <sub>4</sub>	SE <sup>1</sup> / <sub>4</sub>	NE <sup>1</sup> / <sub>4</sub>	NW <sup>1</sup> / <sub>4</sub>	SW <sup>1</sup> / <sub>4</sub>	SE <sup>1</sup> / <sub>4</sub>	NE <sup>1</sup> / <sub>4</sub>	NW <sup>1</sup> / <sub>4</sub>	SW <sup>1</sup> / <sub>4</sub>	SE <sup>1</sup> / <sub>4</sub>	NE <sup>1</sup> / <sub>4</sub>	NW <sup>1</sup> / <sub>4</sub>	SW <sup>1</sup> / <sub>4</sub>	SE <sup>1</sup> / <sub>4</sub>	
			Not used for irrigation																

Total number of acres to be irrigated \_\_\_\_\_

c. Describe any other water rights used for the same purposes as described above. (see Remarks)  
 State of Idaho water license No. 27502 (100 cfs.)

Application for permit No. 36-7210, approved Jan. 31, 1972 (45 cfs.)

9. a. Who owns the property at the point of diversion applicant  
 b. Who owns the land to be irrigated or place of use applicant  
 c. If the property is owned by a person other than the applicant, describe the arrangement enabling the applicant to make this filing \_\_\_\_\_

10. Remarks (A) Re. 6a. Existing ditch and headgate were fully described in prior application No. 35339 for permit No. 27502 and water license No. 27502. In addition, the same was incorporated by reference in application for permit No. 36-7210 approved Jan. 31, 1972. While there have been improvements from time to time, the basic scheme remains the same. As stated in prior permit application, because the existing works accommodate the water being appropriated, no particular time is required for completion of the works and application of the water to beneficial use.

(B) Re. 8c. This application is being filed in accordance with the statutory procedure enacted by the State Legislature in 1971. IRC Sec. 42-220 to establish a water right. By conforming with this process, the applicant does not intend to waive its constitutional right of appropriation. Rather, it is the applicant's belief that it has heretofore established a valid water right to the water made the subject matter herein upon putting said water to beneficial use. Accordingly, the applicant believes that by constitutional appropriation it has established a valid water right in all water increasing the water flow in Alpheus Creek since the trout farm's inception in 1960.

# BLUE LAKES TROUT FARM

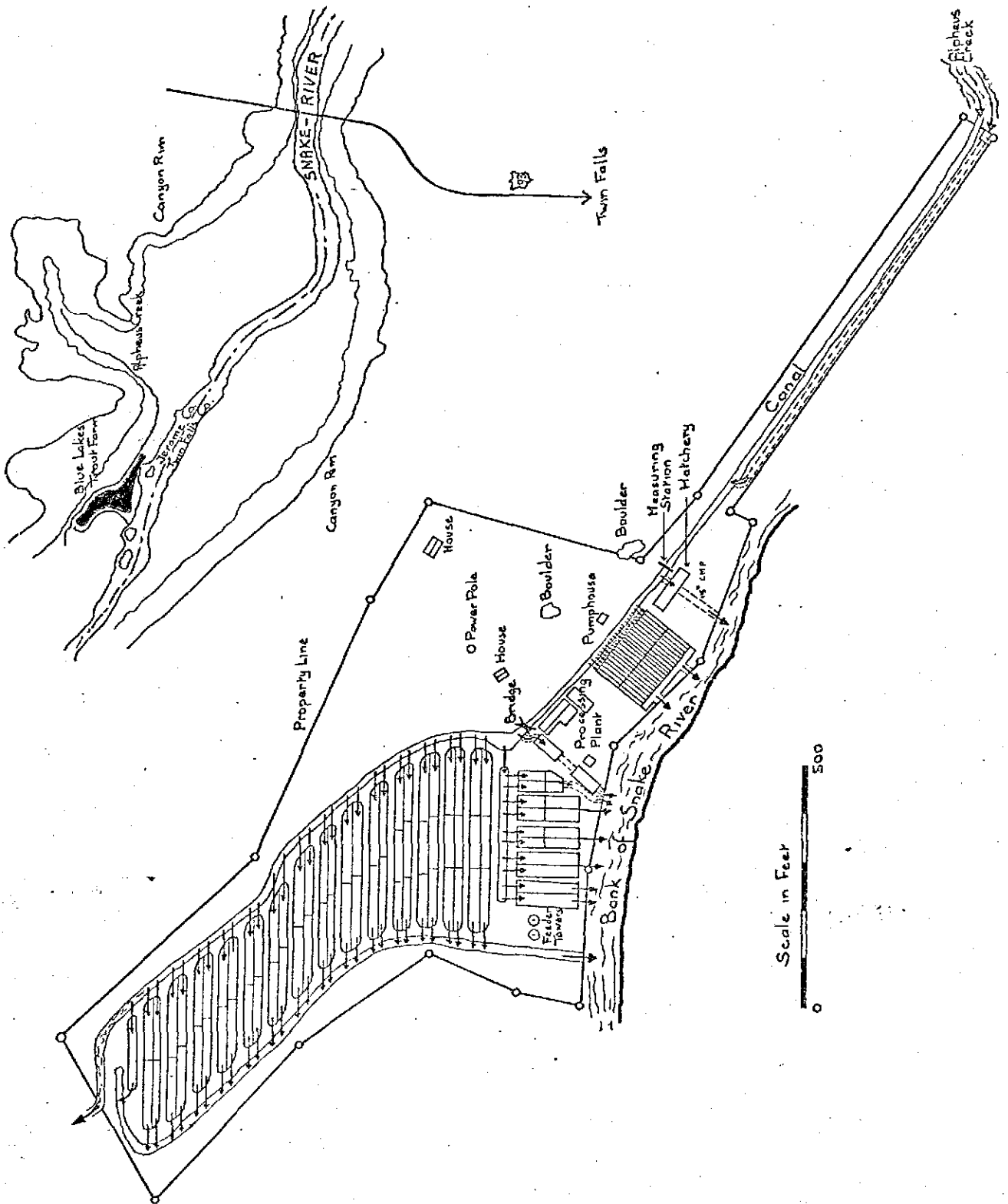
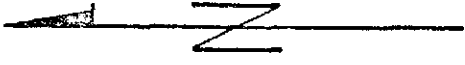

Scale in Feet  
0 500



Proposed Priority 12-28-1973

Received by ML Date 12-20-73 Time 8:00 A  
 Preliminary check by ML Fee \$ 380.00  
 Received by jmm Date 12-28-73 # 11751  
 Publication prepared by jmm Date 12-31-73  
 Published in North Side News  
 Publication dates 1-10 & 1-17-74  
 Publication approved [Signature] Date 1-22-74  
 Priority reduced to \_\_\_\_\_ Reason \_\_\_\_\_  
 \_\_\_\_\_  
 \_\_\_\_\_  
 \_\_\_\_\_  
 Protests filed by: \_\_\_\_\_  
 \_\_\_\_\_  
 \_\_\_\_\_  
 Copies of protests forwarded by \_\_\_\_\_  
 Hearing held by \_\_\_\_\_ Date \_\_\_\_\_  
 Recommended for approval denial by [Signature] BDF

ACTION OF THE DIRECTOR, DEPARTMENT OF WATER ADMINISTRATION

This is to certify that I have examined Application for Permit to appropriate the public waters of the State of Idaho No. 36-7427, and said application is hereby APPROVED.

1. Approval of said application is subject to the following limitations and conditions:
  - a. SUBJECT TO ALL PRIOR WATER RIGHTS.
  - b. Proof of construction of works and application of water to beneficial use shall be submitted on or before February 1, 19 75.
  - c. Other: Measuring devices of a type approved by this Department shall be permanently installed and maintained at the point of diversion and the point of effluent discharge. The permit shall not be assigned or sold without securing the written approval of the Department of Water Administration.

2. Denial of said application is for the following reasons: \_\_\_\_\_  
 \_\_\_\_\_  
 \_\_\_\_\_  
 \_\_\_\_\_  
 \_\_\_\_\_

Witness my hand this 31 day of January 19 74.

[Signature]  
Director

DEPARTMENT OF WATER ADMINISTRATION  
- STAFF ANALYSIS -

Blue Lakes Trout Farm

Item	Initial	Date	
(1)	<u>mls</u>	<u>12-28-73</u>	Application No. <u>36-7427</u>
(2)			<input checked="" type="checkbox"/> Source <input checked="" type="checkbox"/> Point of Diversion <input checked="" type="checkbox"/> County <input checked="" type="checkbox"/> Quantity of Water and Period of Use <input checked="" type="checkbox"/> Description of Diverting Works <input checked="" type="checkbox"/> Time required for B/U of water <input checked="" type="checkbox"/> Place of Use or Acres Irrigated <input checked="" type="checkbox"/> Map <input checked="" type="checkbox"/> Signature <input checked="" type="checkbox"/> Fee
(3)	<u>mls</u>	<u>12-28-73</u>	In form to receipt
	<u>KOF</u>	<u>12-31-73</u>	Send Copies to: <input type="checkbox"/> Idaho State Health Department <input checked="" type="checkbox"/> Idaho Fish and Game Department <input type="checkbox"/> Bureau of Land Management
(4)	<u>KOF</u>	<u>12-31-73</u>	<input type="checkbox"/> Request Special Use Permit from U. S. F. S. <input type="checkbox"/> Request Easement from B. L. M. <input checked="" type="checkbox"/> Request Information from Applicant
(5)	<u>mls</u>	<u>12-28-73</u>	In form for advertising
(6)	<u>KET</u>	<u>1-28-74</u>	Located within Water District No. <u>36</u>
(7)	<u>KOF</u>	<u>1-28-74</u>	Critical groundwater area: yes <input type="checkbox"/> no <input checked="" type="checkbox"/>
(8)	<u>KOF</u>	<u>1-28-74</u>	Groundwater levels: <input type="checkbox"/> Decline (comment) _____ <input checked="" type="checkbox"/> Stable (comment) _____ <input type="checkbox"/> Increasing (comment) _____
(9)			Comments: _____
(10)	<u>LS</u>		Affidavit of Publication received (date) <u>1-22-74</u>
(11)	<u>LS</u>	<u>1-28-74</u>	Final date for protests <u>1-28-74</u> Protests received: yes <input type="checkbox"/> no <input checked="" type="checkbox"/>
(12)			Date and Place of hearing _____ Decision reached at hearing _____
(13)	<u>KOF</u>	<u>1-28-74</u>	All requested information received from agencies or applicant yes <input checked="" type="checkbox"/> no <input type="checkbox"/>
(14)	<u>KOF</u>	<u>1-28-74</u>	Action recommended: <input checked="" type="checkbox"/> Approve Priority <u>12-28-73</u> <input type="checkbox"/> Deny Reason for Reduction _____ <input type="checkbox"/> Measuring device required
			<input checked="" type="checkbox"/> See attached sheet for additional conditions of approval
			<input type="checkbox"/> No additional conditions for approval
(15)	District <u>Southern</u>	By <u>KO Flanagan</u>	Date <u>1-28-74</u>

RECOMMENDED

CONDITIONS OF APPROVAL

A measuring device of a type approved by this Department shall be permanently installed and maintained as part of the diverting works.

Measuring devices of a type approved by this Department shall be permanently installed and maintained at the point of diversion and the point of effluent discharge.

Use of water under this permit is supplemental to all existing water rights with the same purpose and place of use.

Maximum rate of diversion shall not exceed \_\_\_\_\_ c.f.s.

Settling ponds shall be installed which are capable of reducing the silt load in the return water to such a level that the quality of the waters of \_\_\_\_\_ Creek will not be impaired for other beneficial uses.

Return water shall be treated to insure that the effluent meets (interstate) (intrastate) stream water quality standards.

Use of water under this permit is subject to control by the watermaster of State Water District No. \_\_\_\_\_, \_\_\_\_\_ River.

The proposed well shall not be drilled within \_\_\_\_\_ feet of another well.

The issuance of this permit in no way grants any right-of-way or easement across the land of another person.

*But -  
?*

The permit shall not be assigned or sold without first securing the written approval of the Department of Water Administration.

This permit cannot be assigned, mortgaged, or conveyed without complying with Section 42-208, Idaho Code.

Other: \_\_\_\_\_

\_\_\_\_\_  
\_\_\_\_\_

# AFFIDAVIT OF PUBLICATION

# RECEIVED

State of Idaho, }  
County of Jerome } SS.

JAN 20 1974

Department of Water Administration

Southern District Office

being first duly sworn,

*Ernest Hansen*  
deposes and says that he is the printer (publisher) of the Jerome North Side News, a newspaper published every week in Jerome, County of Jerome, State of Idaho; that said newspaper has been continuously and uninterruptedly published for a period of seventy-eight consecutive weeks prior to the first publication of the annexed notice, and is a newspaper qualified to publish legal notices as provided by act of the 1919 session of the legislature of the State of Idaho, known as House Bill 145; that the annexed advertisement was published once

each week for two consecutive issues in said newspaper proper and not in a supplement; that the date of the first publication of said advertisement was on the 10<sup>th</sup> day of January, 19 74, and the date of the last publication was on the 17<sup>th</sup> day of January, 19 74.

Subscribed and sworn to before me this 18<sup>th</sup> day of January, 19 74.  
(SEAL)

*Darla Bratt*

NOTARY PUBLIC

## NORTH SIDE NEWS

Jerome, Idaho

## COST OF PUBLICATION

Number of Lines in Notice \_\_\_\_\_

Number of Insertions \_\_\_\_\_

\_\_\_\_\_ Lines tabular at \_\_\_\_\_ 315c

36 Lines straight at \_\_\_\_\_ 21c 7.56

36 Subsequent lines at \_\_\_\_\_ 15c 5.40

TOTAL COST 12.96

## COPY OF NOTICE

(Paste Here)

*Water Permit*

TITLE OF NOTICE

36-7427

PLAINTIFF ATTORNEY

DEFENDANT

PLAINTIFF

*Dept Water*

BILL TO

## NOTICE OF APPLICATION FOR WATER PERMIT

Notice is hereby given that Blue Lakes Trout Farm, Box 1237, Twin Falls, ID has on December 20, 1973 submitted Application No. 36-7427 for a permit to appropriate 52.23 cubic feet per second of water from Alpheus Creek, tributary of Snake River by means of existing ditch and headgate within the Gvt. Lot 14, Sec. 28, T. 9S, R. 17E, B.M., Jerome County to be used from Jan. 1 to Dec. 31 for fish propagation within the Lot 13, Sec. 28; Lots 14 and 19, Sec. 29, T. 9S, R. 17E, B.M.

If issued, this permit will be subject to all prior water rights. Protest against the granting of the permit must be filed with the Idaho Department of Water Administration, 1041 Blue Lakes Blvd. North, Twin Falls, Idaho, 83301 on or before January 28, 1974.

R. KEITH HIGGINSON  
Director

1-10-21c-n

No. 2305

36 7427

March 13, 1978

Re: Permit No. 36-7427

Blue Lakes Trout Farm, Inc.  
Box 1237  
Twin Falls, ID 83301

Gentlemen:

Enclosed herewith is a copy of the Water Right License issued on the above referenced permit.

Sincerely,

JAN GROVER  
Water Rights Supervisor

JG/kw  
Enclosure

February 23, 1978

Re: Permit No. 36-7427

Blue Lake Trout Farms, Inc.  
Box 1237  
Twin Falls, ID 83301

Gentlemen:

A representative of this Department made an examination of the works covered by your Permit No. 36-7427 on March 1, 1977, and has found the following:

Amount of water that can be recognized as beneficially used under  
Idaho law: 52.23 cfs Source: Alpheus Creek

The maximum quantity diverted shall not exceed n/a acre feet per  
year.

Point of diversion: Govt. Lot 14, Sec. 28, Twp. 9S, Rge. 17E, B. M.

Beneficial use: Fish propagation within Lots 13, Sec. 28; Lots 14  
and 19, Sec. 29, Twp. 9S, Rge. 17E, B. M.

Priority date established: December 23, 1973

If you do not concur with these findings please contact us within 10 days, otherwise a water license will be issued as set forth above.

Sincerely,

BOBBY D. FLEENOR  
Chief, Operations Bureau

BDF/cah



# J-U-B ENGINEERS, INC.

North Plaza Offices, Suite 1  
800 Falls Avenue

Twin Falls, Idaho 83301

Telephone: (208) 733-2414

February 24, 1977

RECEIVED

FEB 25 1977

Department of Water Resources  
Southern District Office

Mr. Percy Green  
Blue Lakes Trout Farm  
266 Buchanan  
Twin Falls, Idaho 83301

Dear Mr. Green:

C  
Transmitted with this letter is a graph showing the results of four (4) measurements made at the prepared section of the inlet canal at Blue Lakes Trout Farm. The graph shows a "calibration curve" for discharges through this section at different staff gage readings.

Please note that discharge values are slightly different from those reported earlier. An error in computer programing was found and corrected.

O  
The graph may be used with confidence for staff gage readings between 1.35 feet and 1.65 feet. Extrapolations beyond these readings may be used but should be applied cautiously.

P  
Measurements reported by the U.S. Geological Survey between April 1969 and March 1976, ranged from 146 cfs to 201 cfs, which lie within the suggested range of accuracy of the curve.

Y  
If you have any questions, please call us at your convenience. Also please advise us if you wish to continue measurements on a regular basis.

Yours truly,

J-U-B ENGINEERS, Inc.

*R.R. Underwood*

R.R. Underwood, R.P.G.

RRU/et

cc: Mr. Funderburg, Dept. of Water Resources, Twin Falls

Calibration of Staff Gage

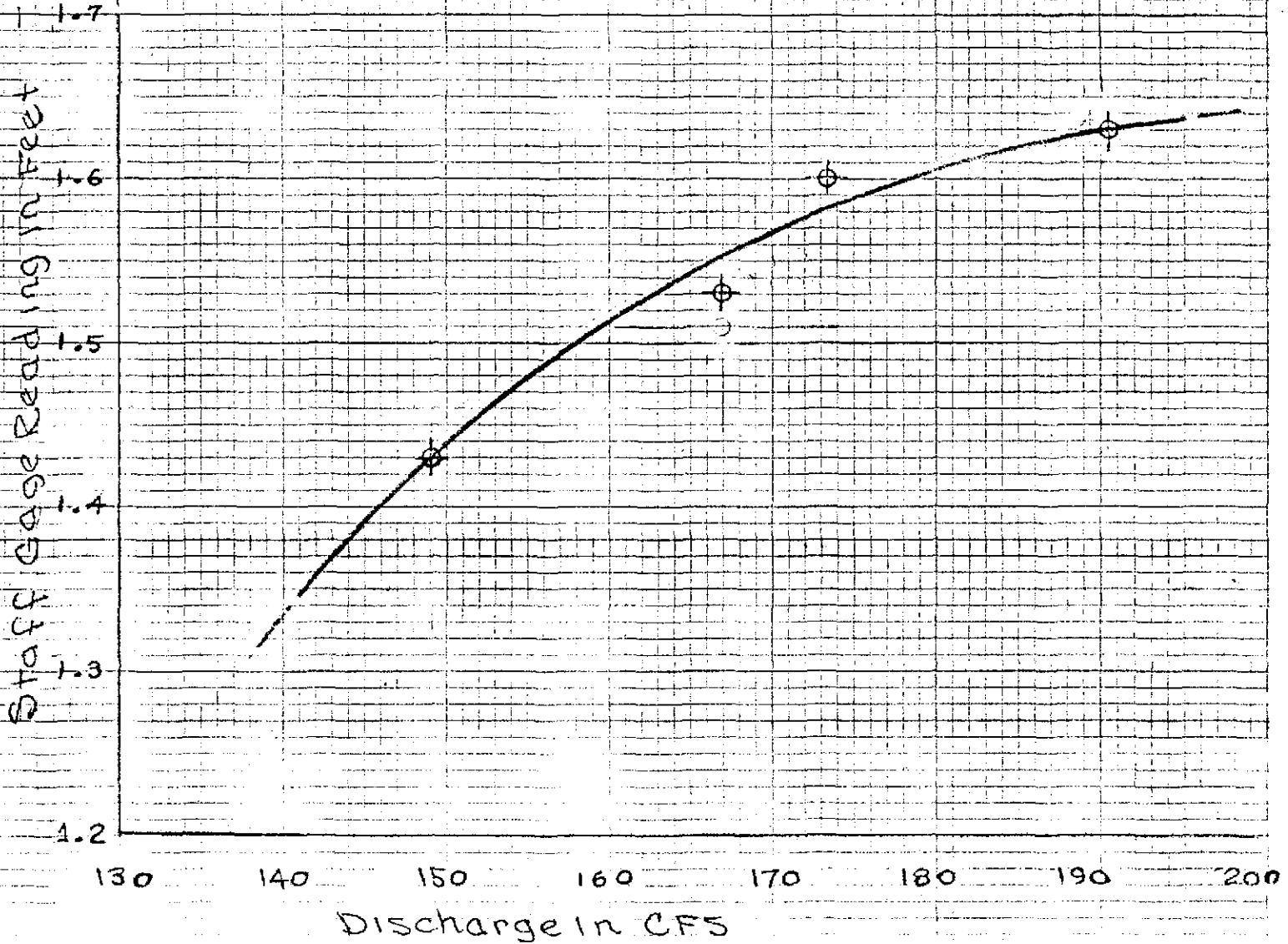

Gage	CFS	Date
1.63	190.4	2/15/77
1.43	149.1	2/15/77
1.60	173.5	2/22/77
1.53	166.9	2/23/77

⊕ Measured Value



FROM Kay Weaver

DATE

TO Jan

7-6-1977

SUBJECT Files # 36-7427 and 36-7210

Mr. Greene called and asked if he might get these two licensed so he can have copies for his roecrds. I have not done anything about them them myself.

---

SIGNATURE

# BLUE LAKES TROUT FARM

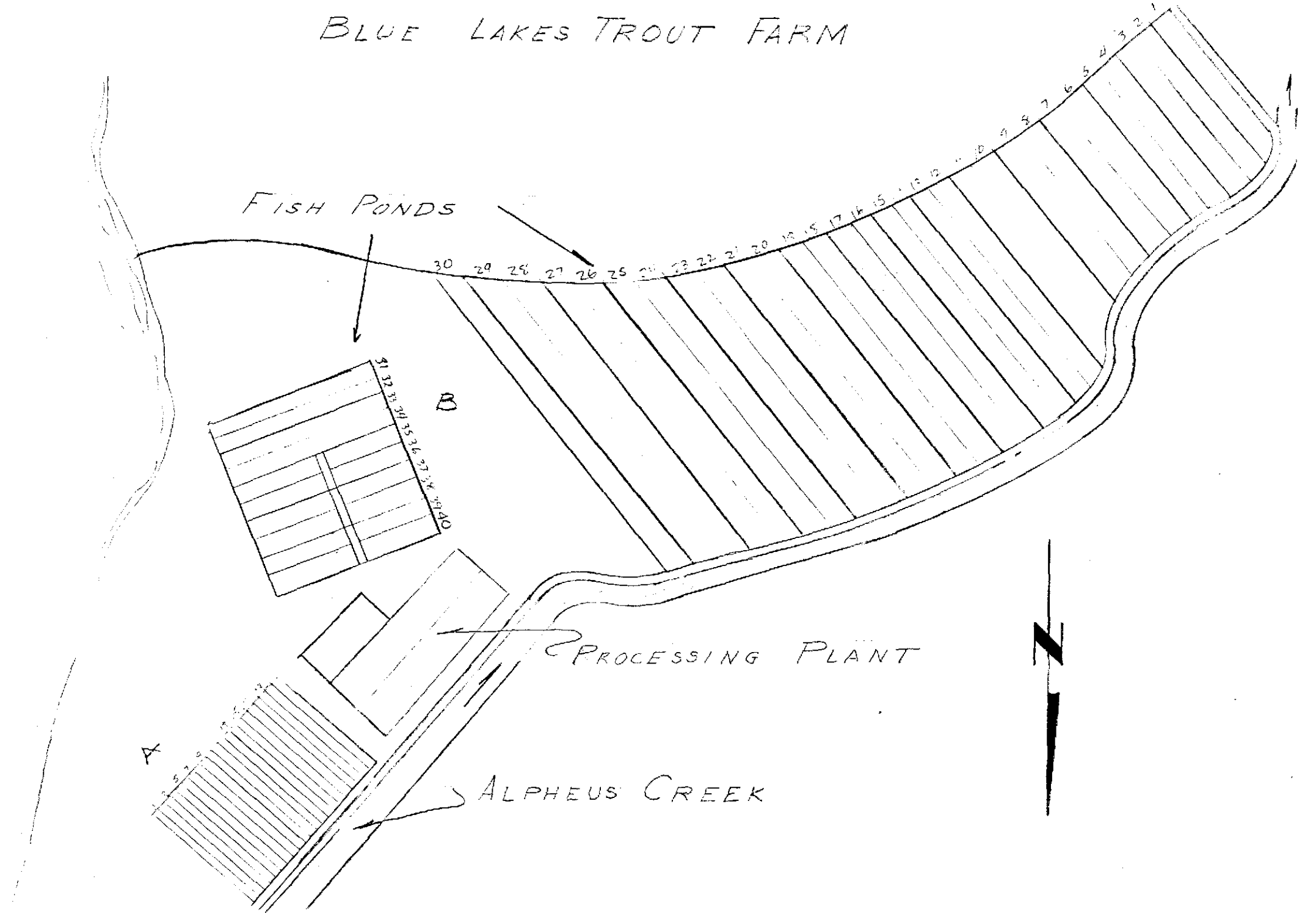

SIZE OF RACEWAYS FOR BLUE LAKES TROUT FARM

A-RACEWAYS

1. 120 X 10 X 4
2. " "
3. " "
4. " "
5. " "
6. " "
7. " "
8. " "
9. " "
10. " "
11. " "
12. " "
13. " "
14. " "
15. " "
16. " "
17. " "
18. " "
19. " "
20. " "

B-RACEWAYS

1. 166 X 14 X 4
2. 224 X 14 X 4
3. 261 X 14 X 4
4. 280 X 14 X 4
5. 273 X 14 X 4
6. 251 X 14 X 4
7. 251 X 14 X 4
8. 244 X 14 X 4
9. 258 X 14 X 4
10. 258 X 14 X 4
11. 238 X 14 X 4
12. 236 X 14 X 4
13. 242 X 14 X 4
14. 258 X 14 X 4
15. 271 X 14 X 4
16. 275 X 14 X 4
17. 287 X 14 X 4
18. 293 X 14 X 4
19. 297 X 14 X 4
20. 301 X 14 X 4
21. 291 X 14 X 4
22. 293 X 14 X 4
23. 298 X 14 X 4
24. 308 X 14 X 4
25. 319 X 14 X 4
26. 324 X 14 X 4
27. 336 X 14 X 4
28. 350 X 14 X 4
29. 367 X 14 X 4
30. 356 X 14 X 4
31. 158 X 20 X 4
32. 158 X 20 X 4
33. 170 X 20 X 4
34. 170 X 20 X 4
35. 170 X 20 X 4
36. 170 X 20 X 4
37. 159 X 20 X 4
38. 159 X 20 X 4
39. 159 X 20 X 4
40. 159 X 20 X 4

**DEPARTMENT OF WATER ADMINISTRATION**  
FIELD REPORT

**RECEIVED**

FEB 5 1977

1. Name of permit holder Blue Lakes Trout Farm, Inc.  
 Post office address Box 1237, Twin Falls, ID 83301  
 Person to contact Percy M. Greene, President

Department of Water Administration  
 Phone \_\_\_\_\_

2. Source of water supply: Groundwater  Surface water  Alpheus Creek  
 Tributary to Snake (name spring, stream, etc.)

3. Water will be used for the following purposes:

Amount 52.23 c.f.s. for Fish Hatchery  
 \_\_\_\_\_ AF/Annum (nature of use)

Period of Use: from Jan. 1 to Dec. 31  
 (mo.-day) inclusive (mo.-day)

Amount \_\_\_\_\_ c.f.s. for \_\_\_\_\_  
 \_\_\_\_\_ AF/Annum (nature of use)

Period of Use: from \_\_\_\_\_ to \_\_\_\_\_  
 (mo.-day) inclusive (mo.-day)

Amount \_\_\_\_\_ c.f.s. for \_\_\_\_\_  
 \_\_\_\_\_ AF/Annum (nature of use)

Period of Use: from \_\_\_\_\_ to \_\_\_\_\_  
 (mo.-day) inclusive (mo.-day)

Other uses: \_\_\_\_\_

Permit No. 36-7427  
 Examination for b/u

4. Total amount to be appropriated:

Max Rate of Diversion 52.23 cubic feet per second and annual volume \_\_\_\_\_ AF/Annum.

5. Location of Point(s) of Diversion:

Township 9S N/S, Range 17E E/W, B.M., Section 28, Subdivision Lt 14 1/4 1/4, Jerome County  
 Township \_\_\_\_\_ N/S, Range \_\_\_\_\_ E/W, B.M., Section \_\_\_\_\_, Subdivision \_\_\_\_\_ 1/4 1/4, \_\_\_\_\_ County  
 Township \_\_\_\_\_ N/S, Range \_\_\_\_\_ E/W, B.M., Section \_\_\_\_\_, Subdivision \_\_\_\_\_ 1/4 1/4, \_\_\_\_\_ County

Other Points of Diversions: \_\_\_\_\_

Description of diverting works: existing ditch and headgate used in connection with and fully described in application and license no. 27502.

Measuring device required: yes  no

6. Lands to be irrigated or place of use.

TWP.	RANGE	SEC.	NE1/4				NW1/4				SW1/4				SE1/4				TOTALS
			NE1/4	NW1/4	SW1/4	SE1/4	NE1/4	NW1/4	SW1/4	SE1/4	NE1/4	NW1/4	SW1/4	SE1/4	NE1/4	NW1/4	SW1/4	SE1/4	
9S	17E	29	Lots 14 and 19																
		28	Lot 13																

**TOTAL ACREAGE** \_\_\_\_\_

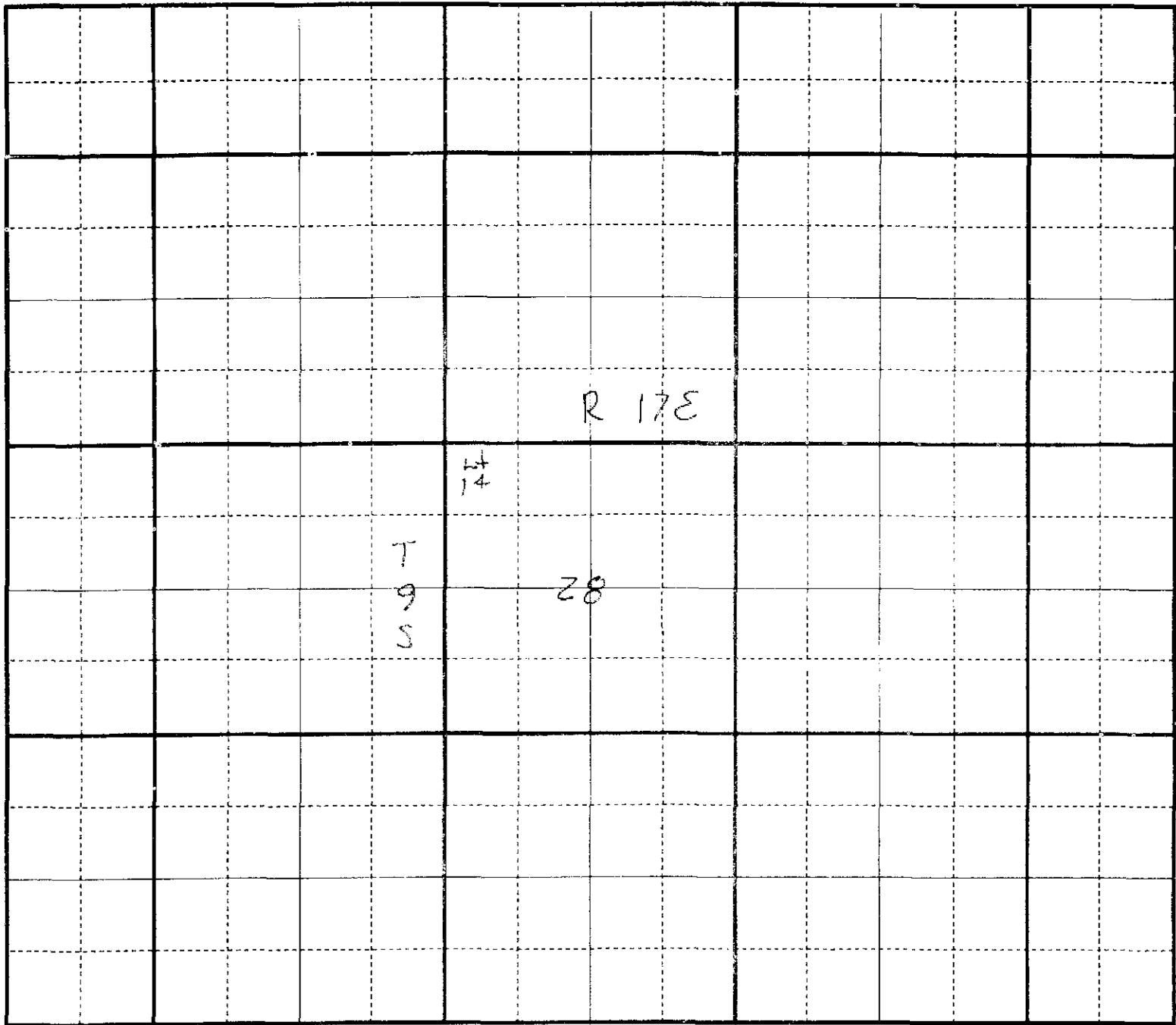

Diagram of System

DATE OF EXAM 3-1-77

ACREAGE  
Found X  
Recommended X

Irrigation Requirement X Ac Ft/Ac

USE  
Irrigation Q= \_\_\_\_\_ c.f.s. V= \_\_\_\_\_ AF/Ann. from \_\_\_\_\_ to \_\_\_\_\_  
Domestic Q= \_\_\_\_\_ c.f.s. V= \_\_\_\_\_ AF/Ann. from \_\_\_\_\_ to \_\_\_\_\_  
Livestock Q= \_\_\_\_\_ c.f.s. V= \_\_\_\_\_ AF/Ann. from \_\_\_\_\_ to \_\_\_\_\_  
Fish propagation Q= 52.23 c.f.s. from Jan. 1 to Dec. 31

Is water co-mingled? yes \_\_\_\_\_ no ✓

Name source: \_\_\_\_\_  
twp. \_\_\_\_\_ N/S, Rge \_\_\_\_\_ E/W, B.M., Sec. \_\_\_\_\_, Sub. \_\_\_\_\_ 1/4 \_\_\_\_\_ 1/4 \_\_\_\_\_  
County \_\_\_\_\_

Exchange? yes \_\_\_\_\_ no ✓

Name source exchanged with: \_\_\_\_\_  
twp. \_\_\_\_\_ N/S, Rge \_\_\_\_\_ E/W, B.M., Sec. \_\_\_\_\_, Sub. \_\_\_\_\_ 1/4 \_\_\_\_\_ 1/4 \_\_\_\_\_  
County \_\_\_\_\_

Point of injection:  
twp. \_\_\_\_\_ N/S, Rge \_\_\_\_\_ E/W, B.M., Sec. \_\_\_\_\_, Sub. \_\_\_\_\_ 1/4 \_\_\_\_\_ 1/4 \_\_\_\_\_  
County \_\_\_\_\_

Point of exchange:  
twp. \_\_\_\_\_ N/S, Rge \_\_\_\_\_ E/W, B.M., Sec. \_\_\_\_\_, Sub. \_\_\_\_\_ 1/4 \_\_\_\_\_ 1/4 \_\_\_\_\_  
County \_\_\_\_\_

Total Q measured 1.63 ft = 190.4 c.f.s. Method of measurement Staff gage Reading at a cross section  
See discharge Notes

Total Q recommended 52.23 c.f.s. Meter No. \_\_\_\_\_ Type \_\_\_\_\_ Condition good

Total V recommended N/A

Recommended Amendments:  
P.D. \_\_\_\_\_  
Place of Use \_\_\_\_\_  
Other \_\_\_\_\_  
None ✓

MEASUREMENT CALCULATION:  
Meas: Staff gage Reading 1.63 ft = 190.4 c.f.s.  
Allowed = 52.23 c.f.s. Amount applied for \_\_\_\_\_

SYSTEM DESCRIPTION:  
Water is diverted from alpheus Cr by means of headgate to fish ponds or Race ways.  
There are 60 ponds. See Attached sheet for size of fish ponds.  
Attached is a curve which was calibrated by J.U.B. Engineering Co.

REMARKS:  
Percy Green was present during Field Exam.  
Allen Merritt helped in Field Exam.

Examiner's Signature Gary Funderburg Date 3-1-77  
Checked by Allen Merritt Date 5-5-77  
Approved by Michael L. Steele Date 5-12-77

ADM

State of Idaho  
Department of Water Resources

**ROUGH DRAFT**

**WATER RIGHT LICENSE**

License of Water Right No. 36-7427 Priority \_\_\_\_\_ Amount 52.23 cfs

THIS IS TO CERTIFY, that Blue Lakes Trout Farm, Inc.  
of Twin Falls, Idaho, has complied with the terms and conditions of Permit  
No. 36-7427 issued pursuant to Application for Permit dated \_\_\_\_\_,  
and has submitted proof to the Department of Water Resources on \_\_\_\_\_,  
that he has applied water to a beneficial use; an examination by the Department indicates that the works have a  
capacity for the diversion of 190.4 cfs of water from Alpheus Creek,  
tributary to Snake River, and that the permit holder has applied to a beneficial use and  
established a right to use water as follows:

Beneficial Use	Period of Use	Rate of Diversion	Annual Volume
<u>Fish Prop.</u>	from <u>Jan. 1</u> to <u>Dec. 31</u>	at <u>52.23</u> cfs and	<u>N/A</u>
	from _____ to _____	at _____ cfs and	_____
	from _____ to _____	at _____ cfs and	_____

(both dates inclusive)

Subject, however, to the condition that no more than 52.23 cfs of water be diverted at any one time, and  
that the amount of water so diverted and to which such right is entitled and confirmed is for the purpose  
aforementioned and is limited to the amount which can actually be beneficially used and shall not exceed  
N/A acre feet per year, said waters to be diverted within the Lot 14, Sec. 28  
T.9S., R.17E., B.M. in the County of Jerome

Description and location of place of use:

Twp.	Range	Sec.	NE¼				NW¼				SW¼				SE¼				Totals
			NE¼	NW¼	SW¼	SE¼	NE¼	NW¼	SW¼	SE¼	NE¼	NW¼	SW¼	SE¼	NE¼	NW¼	SW¼	SE¼	
<u>9S.</u>	<u>17E.</u>	<u>29</u>					<u>Lots 14 &amp; 19</u>												
		<u>28</u>					<u>Lot 13</u>												

Meas. Device Reg'd.

Total number of acres irrigated \_\_\_\_\_

**ROUGH DRAFT**

NOTE: Modifications to or variance from this license must be made within the limits of Section 42-222, Idaho Code, or the applicable Idaho Law. This right may be forfeited by five years of non-use.

The right to the use of the water hereby confirmed is restricted and appurtenant to the lands or place of use herein described, as provided by the laws of Idaho.

Witness the seal and signature of the Director, affixed at Boise, Idaho, this \_\_\_\_\_ day of \_\_\_\_\_, 19 \_\_\_\_\_.

Director

February 3, 1976

Re: Permit No. 36-7427

Blue Lakes Trout Farms, Inc.  
Box 1237  
Twin Falls, Idaho 83301

Gentlemen:

We acknowledge receipt of the affidavit submitted as proof of beneficial use for the above referenced permit.

Before a license can be issued, a field examination must be made by a representative of this Department. We cannot tell just when this examination will be made, but our examiner will try to contact you at the time he makes the examination so that you may show him the system.

If you have any questions regarding the field examination, please contact our District Office in **Twin Falls.**

Sincerely,

D. Darlene Reich  
Water Rights Supervisor

DDR:JG

Identification No. \_\_\_\_\_

Permit No. \_\_\_\_\_

STATE OF IDAHO

DEPARTMENT OF WATER RESOURCES

PROOF OF APPLICATION OF WATER TO BENEFICIAL USE

1. a) Name of Permit Holder Blue Lakes Trout Farm, Inc.

b) Post Office Address Post Office Box 1237, Twin Falls, Idaho 83301

2. Permit Number 36-7427

3. Date of Priority that you are prepared to establish December 28, 1973 (see remarks)

4. a) Source from which water was appropriated Alpheus Creek, Tributary of Snake River

b) Location of the point of diversion: Lot 14 ¼, Section 28

Township 95, Range 17E Boise Meridian, Other points of diversion: None

5. a) The amount of water and use to which the water has been applied:  
Amount 52.23 cfs. for fish hatchery purposes from Jan. 1 to Dec. 31 incl.  
(cfs and/or acre-feet per annum) (Month-Day) (Month-Day)

Amount \_\_\_\_\_ for \_\_\_\_\_ purposes from \_\_\_\_\_ to \_\_\_\_\_ incl.  
(cfs and/or acre-feet per annum) (Month-Day) (Month-Day)

Amount \_\_\_\_\_ for \_\_\_\_\_ purposes from \_\_\_\_\_ to \_\_\_\_\_ incl.  
(cfs and/or acre-feet per annum) (Month-Day) (Month-Day)

b) Total amount appropriated 52.23 cfs. cfs and/or acre-feet per annum

c) Describe how and by whom measurement of rate of flow or amount of storage was made and the qualifications of the person making the measurement: Charles E. Brockway, Professional Engineer; through a stabilized rating section in main canal with staff gauge. Section to be rated with current meter.

6. If the means of diversion and conveyance are owned by someone other than the Permit Holder:

a) Give the name or description of the canal, ditch or other works by which the water is conducted to the place of use: Existing ditch and headgate used in connection with and fully described in application for State of Idaho water license no. 27502.

b) Describe the agreement or understanding by which you take water from the works: Easement granted in land sale contract by owner.

7. a) Briefly describe the works for diverting and conveying the water to the place of use, (if from a subterranean source, give the pump size, motor size, size of well casing, depth of well; if from surface water, give brief description of diversion structure and/or canal or ditch) Existing ditch and headgate used in connection with and fully described in application for State of Idaho water license no. 27502. Improvements have been made to the ditch bank and the weir has been completed.

b) Describe the type and size of measuring device which you have installed at your point of diversion: Stabilized rating section in main canal with staff gauge. Section to be rated with current meter.

c) Give well driller's name and address and the date the well was completed: None

8. If for other than irrigation, describe the beneficial use to which you have applied the water and the place of use: Fish hatchery, ponds located in Lot 13, Section 28 and Lots 14 and 19, Section 29, Township 9 South, Range 17 East, Boise Meridian

*[Handwritten signature]*

9. Irrigation uses: describe the lands irrigated by giving the acreages irrigated within each 40 acre subdivision: \_\_\_\_\_  
Not used for irrigation  
 \_\_\_\_\_  
 \_\_\_\_\_

T	R	SEC.	NE $\frac{1}{4}$				NW $\frac{1}{4}$				SW $\frac{1}{4}$				SE $\frac{1}{4}$				TOTAL	
			NE $\frac{1}{4}$	NW $\frac{1}{4}$	SW $\frac{1}{4}$	SE $\frac{1}{4}$	NE $\frac{1}{4}$	NW $\frac{1}{4}$	SW $\frac{1}{4}$	SE $\frac{1}{4}$	NE $\frac{1}{4}$	NW $\frac{1}{4}$	SW $\frac{1}{4}$	SE $\frac{1}{4}$	NE $\frac{1}{4}$	NW $\frac{1}{4}$	SW $\frac{1}{4}$	SE $\frac{1}{4}$		
			Not used for irrigation																	

Total number of acres irrigated \_\_\_\_\_

10. Remarks: Re 4. The remarks in the application, p. 2, item 10(B),  
 pertaining to item 8c, are incorporated herein by reference  
 for all purposes.  
 \_\_\_\_\_  
 \_\_\_\_\_

The above information is a true statement of the extent to which the above numbered permit has been developed.  
 BLUE LAKES TROUT FARM, INC.

1-29-76  
 (Date)

Percy M. Greene  
 (Signature)  
 Percy M. Greene President

State of Idaho )  
 ) ss.  
 County of Twin Falls )

On this 29th day of January, 19 76, personally appeared before me  
 the signer(s) of the above instrument, who duly acknowledged to me that he (she) (they) executed the same.

James L. Kennedy J.  
 Notary Public residing at Twin Falls, Idaho

My commission expires November 8, 1978

**WALKER & KENNEDY**  
ATTORNEYS AND COUNSELORS AT LAW  
BANK OF IDAHO BUILDING  
POST OFFICE BOX 23  
**TWIN FALLS, IDAHO 83301**  
TELEPHONE (208) 733-3083

LLOYD J. WALKER  
JAMES L. KENNEDY, JR.  
CLINTON E. JACOB  
KEVIN F. TRAINOR  
R. MICHAEL REDMAN

**Twin Falls Office**  
**January 29, 1976**

KETCHUM-SUN VALLEY OFFICE  
GIACOBBI SQUARE  
POST OFFICE BOX 437-A  
KETCHUM, IDAHO 83340  
TELEPHONE (208) 726-5881

Mr. R. Keith Higginson  
Department of Water Resources  
Statehouse  
Boise, Idaho 83720

Re: Proof of Application  
Permit No. 36-7427

Dear Keith:

On behalf of Blue Lakes Trout Farm, Inc., I am submitting a Proof of Application of Water to Beneficial Use.

With every good wish, I am

Cordially yours,

WALKER & KENNEDY

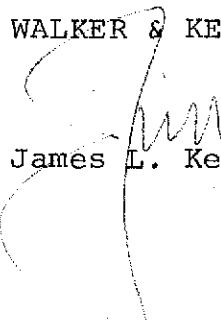
  
James L. Kennedy Jr.

JLK/ss

Enclosure

cc: Mr. Larry H. Armga (with copy)

- **SENDER:** Complete items 1, 2, and 3.  
Add your address in the "RETURN TO" space on reverse.

1. The following service is requested (check one).

- Show to whom and date delivered..... 15¢
- Show to whom, date, & address of delivery.. 35¢
- RESTRICTED DELIVERY.  
Show to whom and date delivered..... 65¢
- RESTRICTED DELIVERY.  
Show to whom, date, and address of delivery 85¢

2. ARTICLE ADDRESSED TO:

**CERTIFIED MAIL**

3. ARTICLE DESCRIPTION:

REGISTERED NO.      CERTIFIED NO.      INSURED NO.

138105

(Always obtain signature of addressee or agent)

I have received the article described above.

SIGNATURE       Addressee       Authorized agent

*Blue Lake Trust*

4. DATE OF DELIVERY

5. ADDRESS (Complete only if requested)

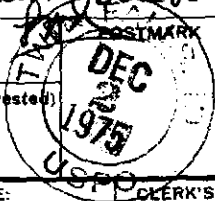

6. UNABLE TO DELIVER BECAUSE:

CLERK'S INITIALS

UNITED STATES POSTAL SERVICE

OFFICIAL BUSINESS

SENDER INSTRUCTIONS

Print your name, address, and ZIP Code in the space below.

- Complete items 1, 2, and 3 on reverse side.
- Moisten gummed ends and attach to back of article.

RETURN  
TO



DEPARTMENT OF WATER RESOURCES  
STATE HOUSE  
BOISE, IDAHO 83720

PENALTY FOR PRIVATE  
USE TO AVOID PAYMENT  
OF POSTAGE, \$300



December 1, 1975

CERTIFIED MAIL

138105

Re: Permit No. 36-7427

Blue Lakes Trout Farm, Inc.  
Attn: Percy M. Greene, President  
Box 1237  
Twin Falls, Idaho 83301

Dear Mr. Greene:

One of the conditions of approval of your water Permit No. 36-7427 (see last page of your approved permit) was that evidence of the extent of development be submitted as proof of application of water to beneficial use to this office on or before February 1, 1976. Enclosed is an affidavit form which must be used to submit the required proof of beneficial use.

If you have not fully completed your project, and you have not previously received an extension of time, you may request an extension of time provided the delay is for reasonable cause as indicated in Section 42-204, Idaho Code, amended. If you have been prevented from proceeding by a governmental agency or by litigation, more than one extension of time can be granted.

Either the beneficial use affidavit or a request for an extension of time must be received by this Department on or before the above mentioned date, otherwise the permit will lapse and be of no further force or effect.



R. KEITH HIGGINSON  
Director

RKH:jg  
Enc: Proof affidavit

February 1, 1974

Re: Permit No. 36-7427

Blue Lakes Trout Farm  
Box 1237  
Twin Falls, Idaho 83301

Gentlemen:

Enclosed is a copy of your approved Application for Permit No. 36-7427. We direct your attention to the conditions of approval as listed on the fourth page.

Be sure to note that a special condition requiring you to install and maintain a measuring device at your point of diversion has been placed upon your permit. We are enclosing a letter describing different types of measuring devices accepted by this office.

Sincerely,

BOBBY D. FLEENOR  
Assistant Director

36 7427

BDF/bjg

Enclosures

# BLUE LAKES TROUT FARM, Inc.

PERCY M. GREENE, MANAGER

BOX 1237                      DIAL (208) 733-4631  
TWIN FALLS, IDAHO 83301

January 3, 1974

RECEIVED

JAN 4 1974

STATE OF IDAHO  
DEPARTMENT OF WATER ADMINISTRATION  
TWIN FALLS, IDAHO



Department of Water Administration  
STATE OF IDAHO  
Mr. Bob Haynes  
District Engineer  
1041 Blue Lakes Blvd. North  
Twin Falls, Idaho 83301

Re: Application No. 36-7427

Dear Mr. Haynes:

Replying to your letter of the 31st of December.

1. Justification for the water requested, is based upon the expected increase in the production in facilities that have already been constructed. This will amount to ten thousand (10,000) pounds of Rainbow Trout per second foot of water.
2. Adequate measuring devices are now in place at the point of diversion and at the point of return.

Very truly yours,

BLUE LAKES TROUT FARM, INC.

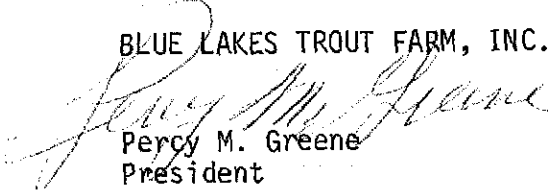
  
Percy M. Greene  
President

PRODUCERS AND PACKERS OF

*Blue*<sup>®</sup>  
*Lakes*

BRAND ROCKY MOUNTAIN RAINBOW TROUT

36 7427

December 31, 1973

RE: Application No. 36-7427

Blue Lakes Trout Farm  
P.O. Box 1237  
Twin Falls, Idaho 83301

Gentlemen:

In order to further consider your application for permit, we will require additional information not included with the above referenced application as follows:

1. A justification, based upon the preliminary design and the estimated production of the hatchery, for the amount of water requested.

You should be aware that all applications, if approved, will require the installation and maintenance of adequate measuring devices both at the point of diversion and the point of return of the water. These devices must be of a type approved by the Department; they can be of any generally recognized standard measuring device type. Your should include the installation of these devices in your preliminary plans for construction.

We would appreciate receiving this information on or before January 14, 1974. Thank you for your cooperation in this matter.

Very truly yours,

Bob Haynes  
District Engineer  
Southern District

BH:jmm

December 31, 1973

RE: Application No. 36-7427 - Blue Lakes Trout Farms

Mr. Robert Bell  
Idaho Fish & Game Department  
P.O. Box 138  
Jerome, Idaho 83338

Dear Mr. Bell:

We are enclosing a copy of the above referenced application for permit, which may be of interest to your agency.

Please review the application and if you have any comments, please submit them to our Department as soon as possible.

We normally complete the processing of an application within a six (6) week period and we are required to take final action shortly thereafter.

If we may be of any assistance to you in the meantime, please don't hesitate to contact the Department.

Very truly yours,

Bob Haynes  
District Engineer  
Southern District

BH:jmm

Enc.

36 7427

December 31, 1973

RE: Application Nos. 36-7425 - William F. and/or Judy L. Gulley  
36-7427 - Blue Lakes Trout Farms

North Side News  
P.O. Box 400  
Jerome, ID 83330

Gentlemen:

Enclosed you will find a legal notice which we wish to have published once a week for two consecutive weekly issues of your newspaper. We have inserted the publication dates allowing ample time for you to submit us a galley proof for review before publication.

After sending us a galley proof, proceed with the publication on the dates we have inserted, assuming the notice is correct. If we have any corrections, we will notify you before the first publication. If you cannot publish the notice on the proposed dates, please contact us immediately.

An affidavit of publication must be submitted to the Department along with the publication bill. In order to receive payment, the following certification must appear on the bill:

"I hereby certify that the foregoing account is just and correct, that the amount claimed is legally due, after allowing all just credits, and that no part of the same has been paid."

\_\_\_\_\_  
(signature of claimant)

Very truly yours,

Bob Haynes  
District Engineer  
Southern District

Bill submitted \_\_\_\_\_ by \_\_\_\_\_

BH:jmm

Enc.: Legal Notices (2)

36 7425

*Paid By*  
*12-14-74*  
*Ja*

**NOTICE OF APPLICATION  
FOR WATER PERMIT**

Notice is hereby given that Blue Lakes Trout Farm, Box 1237, Twin Falls, ID has on December 20, 1973 submitted Application No. 36-7427 for a permit to appropriate 52.23 cubic feet per second of water from Alpheus Creek, tributary of Snake River by means of existing ditch and headgate within the Gvt. Lot 14, Sec. 28, T. 9S, R. 17E, B.M., Jerome County to be used from Jan. 1 to Dec. 31 for fish propagation within the Lot 13, Sec. 28; Lots 14 and 19, Sec. 29, T. 9S, R. 17E, B.M.

If issued, this permit will be subject to all prior water rights. Protest against the granting of the permit must be filed with the Idaho Department of Water Administration, 1041 Blue Lakes Blvd. North, Twin Falls, Idaho, 83301 on or before January 28, 1974.

R. KEITH HIGGINSON  
Director

1-10-2tc-n

NOTICE OF APPLICATION FOR WATER PERMIT

Notice is hereby given that Blue Lakes Trout Farms  
Box 1237, Twin Falls, ID  
has on December 20, 1973 submitted Application No. 36-7427  
for a permit to appropriate 52.23 cubic feet per second ~~XXXXXXXXXXXXXXXXXXXX~~  
of water from Alpheus Creek, tributary of Snake River  
by means of existing ditch and headgate  
within the Gvt. Lot 14, Sec. 28, T. 9S, R. 17E, B.M., Jerome County  
to be used from Jan. 1 to Dec. 31  
for fish propagation  
within the Lot 13, Sec. 28; Lots 14 and 19, Sec. 29, T. 9S, R. 17E, B.M.

If issued, this permit will be subject to all prior water rights. Protests against the granting of the permit must be filed with the Idaho Department of Water Administration, 1041 Blue Lakes Blvd. North, Twin Falls, Idaho, 83301 on or before January 23, 1974.

R. KEITH HIGGINSON

Director

Published in the North Side News  
on January 10 and January 17, 1974

36 7427

- **SENDER:** Complete items 1 and 2.  
Add your address in the "RETURN TO" space on reverse.

1. The following service is requested (check one).

- Show to whom and date delivered..... 15¢
- Show to whom, date, & address of delivery.. 35¢
- DELIVER ONLY TO ADDRESSEE and show to whom and date delivered..... 65¢
- DELIVER ONLY TO ADDRESSEE and show to whom, date, and address of delivery ..... 85¢

2. ARTICLE ADDRESSED TO:

3. ARTICLE DESCRIPTION:

REGISTERED NO.	CERTIFIED NO.	INSURED NO.
	26266	

(Always obtain signature of addressee or agent)

I have received the article described above

SIGNATURE

*Blue folder*

4. DATE OF DELIVERY

DEC 3 1974

5. ADDRESS (Complete if requested)

6. UNABLE TO DELIVER BECAUSE:

CLERK'S  
INITIALS

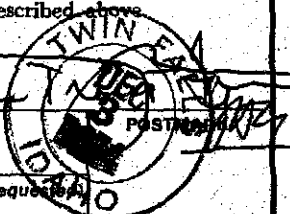

UNITED STATES POSTAL SERVICE

OFFICIAL BUSINESS

**SENDER INSTRUCTIONS**

Print your name, address, and ZIP Code in the space below.

- Complete items 1 and 2 on reverse side.
- Moisten gummed ends and attach to back of article.

**RETURN  
TO**



DEPARTMENT OF WATER RESOURCES  
STATEHOUSE  
BOISE, IDAHO 83720

PENALTY FOR PRIVATE  
USE TO AVOID PAYMENT  
OF POSTAGE, \$300



RECEIVED

December 2, 1974

CERTIFIED MAIL

#26266

Re: Permit No. 36-7427

Blue Lakes Trout Farm  
Box 1237  
Twin Falls, ID 83301

Gentlemen:

One of the conditions of approval of your water Permit No. 36-7427 (see last page of your approved permit) was that evidence of the extent of development be submitted as proof of application of water to beneficial use to this office on or before February 1, 1975. Enclosed is an affidavit form which must be used to submit the required proof of beneficial use.

If you have not fully completed your project, and you have not previously received an extension of time, you may request an extension of time provided the delay is for reasonable cause as indicated in Section 42-204, Idaho Code, amended. If you have been prevented from proceeding by a governmental agency or by litigation, more than one extension of time can be granted.

Either the beneficial use affidavit or a request for an extension of time must be received by this Department on or before the above mentioned date, otherwise the permit will lapse and be of no further force or effect.



R. KEITH HIGGINSON  
Director

RKH:jg  
Enc: Proof affidavit

MICROFILMED

January 28, 1975

Re: Permit No. 36-6427

Blue Lakes Trout Farm, Inc.  
Attn: Percy M. Greene, Pres.  
P. O. Box 1237  
Twin Falls, ID 83301

Dear Mr. Greene:

Enclosed is a copy of the approved application for extension of time submitted in connection with the above referenced permit.

The time within which to submit proof of beneficial use of water has been extended to February 1, 1976.

Sincerely,

D. Darlene Reich  
Water Rights Supervisor

DDR:JG  
Enclosure

cc: James L. Kennedy, Jr.

**MICROFILMED**

LAW OFFICES OF  
**LLOYD J. WALKER**  
BANK OF IDAHO BUILDING  
P. O. Box 23  
TWIN FALLS, IDAHO 83301  
TELEPHONE (208) 733-3083

LLOYD J. WALKER  
CLINTON E. JACOB

January 9, 1975

GIACOBBI SQUARE  
SUN VALLEY, IDAHO 83353  
(208) 726-5861

Department of Water Administration  
State of Idaho  
Statehouse - Annex 2  
Boise, Idaho 83707

Re: Permit No. 36-7427

Gentlemen:

In response to your letter of December 2, 1974, informing Blue Lakes Trout Farm of the necessity for submitting proof of application to beneficial use by February 1, 1975, I am transmitting on behalf of Blue Lakes Trout Farm an application for extension of time executed by Percy M. Greene, President of Blue Lakes Trout Farm.

Sincerely yours,

WALKER & KENNEDY

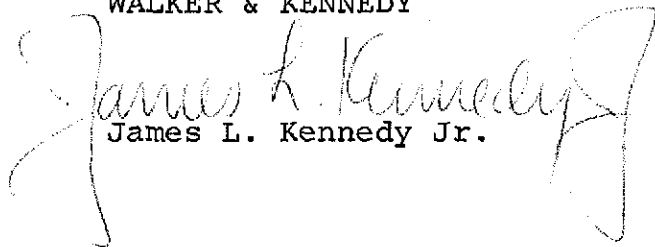
  
James L. Kennedy Jr.

JLK:jm  
Enc.

cc: Mr. Percy M. Greene

**MICROFILMED**