

State of Idaho
License and Certificate of Water Right

Water License No. 27700

Amount 8.0 c.f.s.

Water District No.

Priority January 7, 1959

THIS IS TO CERTIFY that W. P. STRICKLAND
of Bruneau, Idaho, made application for a permit to appropriate the
public waters of the State of Idaho, dated January 7, 1959; that Permit No. 27700
was issued under said application; that Certificate of Completion of works, with a carrying capacity of
8.0 second feet, was issued thereunder on December 10, 1964, showing that said works
were completed on the 6th day of January, 1964; and that on the 21st
day of February, 1964,

W. P. STRICKLAND

of Bruneau, State of Idaho, made proof to the satisfaction of the
State Reclamation Engineer of Idaho, of the right to use the waters of Snow Creek
, a tributary of Bruneau River, for the purpose of Irrigation
, under Use Permit No. 27700 of the Department of Reclamation
and that said right to the use of said waters has been perfected in accordance with the laws of Idaho,
and is hereby confirmed by the State Reclamation Engineer of Idaho and entered of record in Volume
13 of Licenses at page 8062, on the 10 day of December, 1964;
The right hereby confirmed dates from January 7, 1959;
The Point of Diversion is located

in the NE 1/4 NE 1/4, Sec. 15, Tp. 15 S., R. 4 E., B. M. Owyhee County

That the amount of water to which such right is entitled and hereby confirmed, for the purposes
aforesaid, is limited to an amount actually needed and beneficially used for said purposes, and shall
not exceed 8.0 cubic feet per second.

Description and location of use:

The right
of use herein d

WITNESS

10th da

11

(SEAL)

SE	NW	24	24
NE	SW	33	33
NW	SW	19	19
SW	SW	35	34
SE	SW	35	35
NE	SE	29	29
NW	SE	40	40
SW	SE	17	17
SE	SE	26	26
NE	NW	11	11
NW	NW	26	26
SW	NW	38	38
SE	NW	12	12
NE	SW	6	6
NW	SW	31	31
SW	SW	7	7

Total number of acres to be irrigated: 705

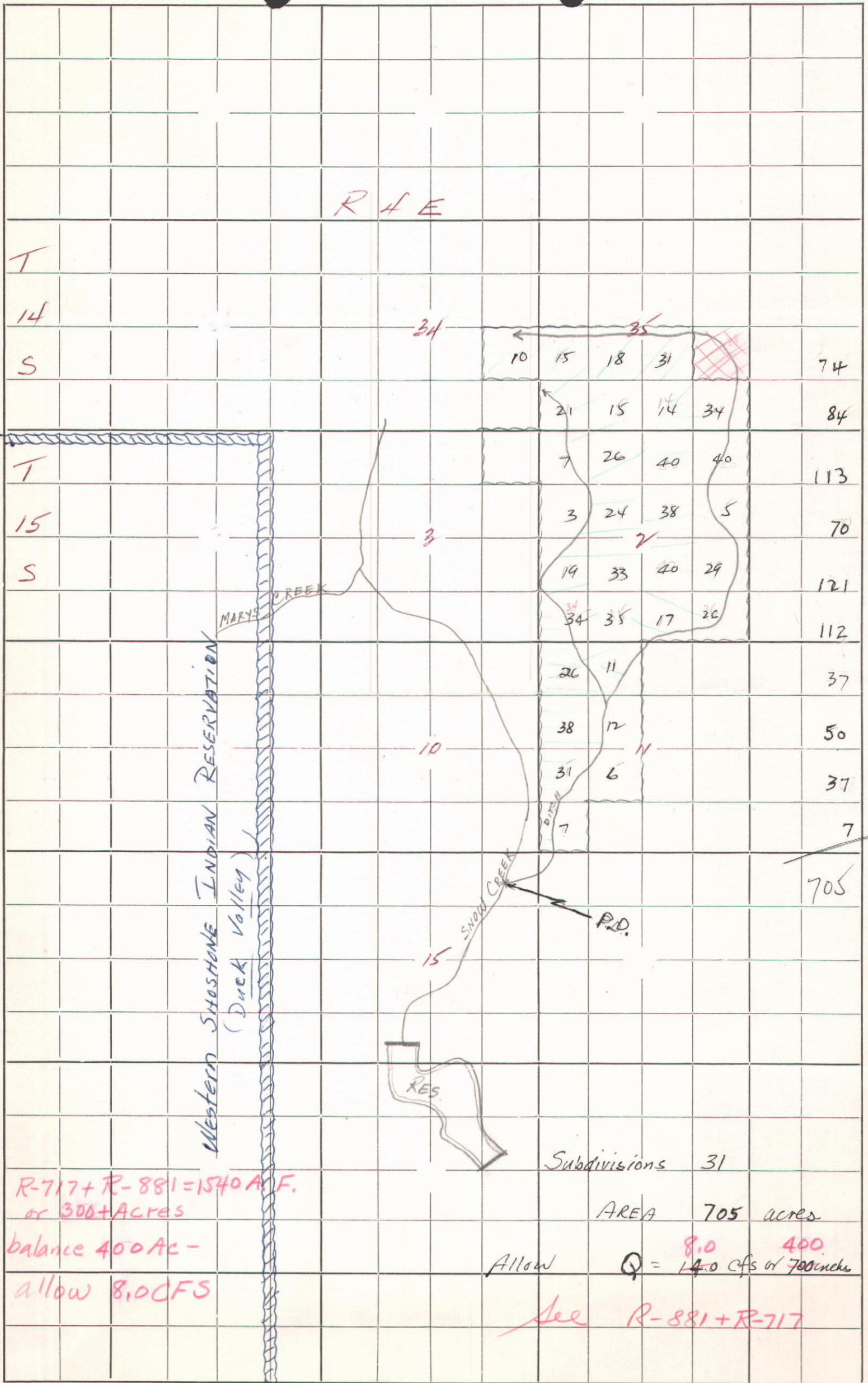

Re: Permit No. 27700
W. P. Strickland

January 10, 1964

Mr. Harley M. McDowell,
Idaho Land and Appraisal Service,
Box 2161,
Boise, Idaho.

Dear Mr. McDowell:

This acknowledges the Notice of Proof of ~~Completion of Work~~ Application of Water to Beneficial Use under Permit No. 27700, in the name of W. P. Strickland. Final Proof is to be made before ~~you~~, Joan Bain as Notary on the 21st day of February, 1964, at 10:00 o'clock A.M., at Idaho Building, Boise, Idaho.

As of this date, we have mailed the Notice to the Owyhee Nugget Marsing, Idaho, with instructions to publish it once a week for four consecutive weeks prior to the date set for final proof and then mail the Affidavit of Publication and statement of costs to you.

It is important that the enclosed depositions be executed by the permit holder and two disinterested witnesses who are familiar with the terms of the permit and the work done thereunder, at the time, on the date and before you, as Notary, as stated in the publication notice. It is very important and necessary that each question be answered in detail.

In returning the depositions to this office, be sure that all copies have been signed, that your Notary's seal has been placed on each and that all depositions, (holder and two witnesses) are being returned. Also be sure to enclose the AFFIDAVIT OF PUBLICATION.

Very truly yours,

CARL E. TAPPAN
State Reclamation Engineer
By

(MRS.) EDNA P. RULE
Chief Clerk

Encl.
EPR:pmk
cc: Applicant

27700

T 14 S - R 4 E
T 15 S - R 4 E

Marys Creek

34 34
3 2

3 2
10 11

Snow Creek

Reservoir

Permit Map No. 27700
As Approved
JAN 9 1959
GEO. N. CARTER
State Reclamation Engineer

State of Idaho
License and Certificate of Water Right

Water License No. 27700

Amount 8.0 c.f.s.

Water District No.

Priority January 7, 1959

THIS IS TO CERTIFY that **W. P. STRICKLAND**
of **Bruneau, Idaho**, made application for a permit to appropriate the
public waters of the State of Idaho, dated **January 7**, 19 **59**; that Permit No. 27700
was issued under said application; that Certificate of Completion of works, with a carrying capacity of
8.0 second feet, was issued thereunder on **December 10**, 19 **64**, showing that said works
were completed on the **6th** day of **January**, 19 **64**; and that on the **21st**
day of **February**, 19 **64**,

W. P. STRICKLAND

of **Bruneau**, State of **Idaho**, made proof to the satisfaction of the
State Reclamation Engineer of Idaho, of the right to use the waters of **Snow Creek**
a tributary of **Bruneau River**, for the purpose of **Irrigation**
under Use Permit No. 27700 of the **Department of Reclamation**
and that said right to the use of said waters has been perfected in accordance with the laws of Idaho,
and is hereby confirmed by the State Reclamation Engineer of Idaho and entered of record in Volume
13 of Licenses at page **8062**, on the **10** day of **December**, 19 **64**;
The right hereby confirmed dates from **January 7**, 19 **59**;

The Point of Diversion is located

in the **NE 1/4 NE 1/4**, Sec. **15**, Tp. **15 S.**, R. **4 E.**, B. M. **Owyhee** County

That the amount of water to which such right is entitled and hereby confirmed, for the purposes
aforesaid, is limited to an amount actually needed and beneficially used for said purposes, and shall
not exceed **8.0** cubic feet per second.

Description and location of use:

Twp.	Range	Sec.	Forty-acre Tract	No. Acres Described in Permit	No. Acres Actually Irrigated
14 S.	4 E.	34	NE SE	10	10
			NE SW	18	18
			NW SW	15	15
			SW SW	21	21
			SE SW	15	15
			NW SE	31	31
			SW SE	14	14
			SE SE	34	34
15 S.	4 E.	2	NE NE	20	40
			NW NE	40	40
			SW NE	38	38
			SE NE	5	5
			NE NW	26	26
			NW NW	7	7
			SW NW	17	3
			SE NW		

The right to the use of the water aforesaid hereby confirmed is restricted to the lands or place
of use herein described, as provided by the laws of Idaho.

WITNESS the seal and signature of the State Reclamation Engineer, affixed at Boise, Idaho, this

10th day of **December**, 19 **64**

/s/ **RALPH W. THOMAS**
Deputy State Reclamation Engineer.

(SEAL)

State of Idaho

License and Certificate of Water Right

Water License No. 27700

Amount 8.0 c.f.s.

Water District No.

Priority January 7, 1959

THIS IS TO CERTIFY that **W. P. STRICKLAND** of **Bruneau, Idaho**, made application for a permit to appropriate the public waters of the State of Idaho, dated **January 7**, 19 **59**; that Permit No. 27700 was issued under said application; that Certificate of Completion of works, with a carrying capacity of **8.0** second feet, was issued thereunder on **December 10**, 19 **64**, showing that said works were completed on the **6th** day of **January**, 19 **64**; and that on the **21st** day of **February**, 19 **64**,

W. P. STRICKLAND

of **Bruneau**, State of **Idaho**, made proof to the satisfaction of the **State Reclamation Engineer** of Idaho, of the right to use the waters of **Snow Creek**, a tributary of **Bruneau River**, for the purpose of **Irrigation**, under Use Permit No. 27700 of the **Department of Reclamation** and that said right to the use of said waters has been perfected in accordance with the laws of Idaho, and is hereby confirmed by the State Reclamation Engineer of Idaho and entered of record in Volume

13 of Licenses at page **8062**, on the **10** day of **December**, 19 **64**;

The right hereby confirmed dates from **January 7**, 19 **59**;

The Point of Diversion is located

in the **NE 1/4 NE 1/4**, Sec. **15**, Tp. **15 S.**, R. **4 E.**, **B. M. Owyhee** County

That the amount of water to which such right is entitled and hereby confirmed, for the purposes aforesaid, is limited to an amount actually needed and beneficially used for said purposes, and shall not exceed **8.0** cubic feet per second.

Description and location of water

The right
of use herein d

WITNESS

10th da

(SEAL)

11

SW	SW	24	24
SW	SW	33	33
SW	SW	19	19
SW	SW	35	34
SE	SW	35	35
NE	SE	29	29
NW	SE	40	40
SW	SE	17	17
SE	SE	26	26
NE	NW	11	11
NW	NW	26	26
SW	NW	38	38
SE	NW	12	12
NE	SW	6	6
NW	SW	31	31
SW	SW	7	7

Total number of acres to be irrigated

705

Application For Permit To Appropriate the Public Waters of the State of Idaho

51-2147

APPLICATION No. 35636
PERMIT No. 27700
DISTRICT No.

Idaho Land & Map Service
P. O. Box 2161
Boise, Idaho

1. Name of Applicant: W. P. STRICKLAND

Postoffice address: Bruneau

County: Owyhee

State: Idaho

I. If applicant is a corporation, give:

- (a) Date and place of incorporation:
- (b) Amount of capital stock:
- (c) Amount paid in:
- (d) Names and addresses of directors:

II. The financial resources of the applicant are:

- (a) Cash on hand:
- (b) Treasury stock:
- (c) Bond to be issued:
- (d) Other resources:

2. Quantity of water claimed: 700 miner's inches or 14 cubic feet per second.

3. Source of water supply: Snow Creek which is a tributary of Marys Creek which in turn is a tributary of the Bruneau River

4. Location of point of diversion: 400' South, 1180' West feet distant from the Northeast corner of Section 15, T. 15 S., R. 4 E., B.M., and is in the NE $\frac{1}{4}$ NE $\frac{1}{4}$ of section 15, T. 15 S., R. 4 E., B. M., County of Owyhee

5. Water is to be used for Irrigation

6. If for mining, milling, power or manufacturing purposes, give:

- (a) Point of use of water: feet distant from corner of Section T. , R. , B.M., in the of Section of , T. , R. , B.M.
- (b) Amount of power generated: H.P., under feet head.
- (c) Water is to be returned to at a point feet distant from the corner of Section , T. , R. , B.M., in the of Section , T. , R. , B.M.

7. Estimated cost of works: \$ 2,500.00

8. Kind of works: Only small rock and earth diversion out of the actual creek into a ditch which will be probably 2 $\frac{1}{2}$ miles long and is capable of carrying 800"

9. Height of dam 4' feet; length of dam at top 160' feet; length of dam at bottom 80' feet; material used in dam: Rock and earth

10. Size of headgate: Width 10' feet; height 6' feet.

11. Ditch: Width at bottom 6' feet; width at water line 8' feet; depth of water 4' feet; dimensions of flume: None

Diameter of pipe inches; length of conduit miles.
Average grade per mile feet.

12. The time required for the completion of such work is 5 years.

13. The time required for the complete application of the water to the proposed use is 5 additional years.

14. The land to be irrigated is described in the following tabulation: See remarks.

15. Existing water rights and/or valid permits appurtenant to the lands to be irrigated are: Only reservoir permit is already applied for under R-11 and R-717

16. (a) Is reservoir to be used? Yes, but this permit is particularly for early runoff
If so, fill in (b) and (c) below:
(b) Name of Reservoir and number of Storage Permit: R-881 and R-717
(c) Date of filing of Application for Storage Permit and Name of Applicant: W. P. Strickland
R-881 filed Oct. 10, 1951, R-717 filed August 28, 1941

BE IT KNOWN THAT The undersigned hereby makes application for permit to appropriate the public water of the State of Idaho as herein set forth.

/s/ W. P. Strickland
Applicant.

Approval of State Reclamation Engineer

/s/ GEO. N. CARTER
State Reclamation Engineer.

(SEAL) By /s/ ARNOLD WILLIAMS Secretary of State.

By /s/ ROBERT E. SMYLIW Governor.

14.

[illegible]

Permit No. 27700
 CERTIFICATE OF COMPLETION OF WORKS

✓
 TO ALL WHOM IT MAY CONCERN:

This is to certify that W. P. STRICKLAND of Bruneau, County of Owyhee, and State of Idaho, the holder of Permit No. 27700, issued upon Application No. 35636 bearing date of priority of January 7, 1959, authorizing the diversion of 14.0 second feet of waters of Snow Creek County of Owyhee, State of Idaho, for irrigation purposes, has fully complied with the provisions of the laws of the State of Idaho relating to the proof of completion of the works of diversion set out and described in said Permit; that said works are adequate for diverting and conveying to the place of intended use 8.0 second feet of the waters of Snow Creek tributary of Bruneau River; that the point of diversion of said waters NE¹/₄NE¹/₄, Sec. 15, T. 15 S., R. 4 E., B.M. and that the lands proposed to be irrigated by the use of said water are described as follows, to-wit:

NE¹/₄SE¹/₄, Sec. 34; NW¹/₄SE¹/₄, S¹/₂SE¹/₄, SW¹/₄,
 15 S., R. 4 E., B.M.; Sec. 35, T. 14 S., R. 4 E., B.M.; Sec. 2; NW¹/₄, N¹/₂SW¹/₄, SW¹/₄SW¹/₄, Sec. 11, T. 15 S., R. 4 E., B.M.

Witness my hand this 10th day of December, A. D. 1964.

/s/ RALPH W. THOMAS
 Deputy State Reclamation Engineer

Proof of Completion of Works Made: February 21, 1964

LICENSE ISSUED FOR 8.0 SEC. FT.
 LICENSE PAGE NO. 8062.

December 10, 1964

RE: Permit No. R-881, R-894,
27700

W. P. Strickland
Brassai, Idaho

Dear Mr. Strickland:

Enclosed are the Certificates of Completion of Work on Permit
No. 27700, and the Licenses on Permits No. R-881 and R-894, 27700.

Also enclosed is departmental receipt No. 32552 in the amount
\$81.00 covering the fees for the certificates.

Very truly yours,

CARL E. TAPPAN
State Reclamation Engineer
By

(Mrs.) Edna P. Hale
Chief Clerk

EPB:mf

Enc. Licenses 3
certificates
receipt

27700

October 20, 1964

RE: Permit No. 27700

W. P. Strickland
Bruneau, Idaho

Dear Mr. Strickland:

Our field engineer's report on his inspection of Proof of Completion of Works and Application of Water to Beneficial Use under the terms of Permit No. 27700 shows the dam and ditches are capable of conveying 400 miner's inches, or 8.0 c.f.s. of water for irrigation of 705 acres.

Upon receipt of the statutory fee of \$5.00 we will issue the Certificate of Completion of Works and License and Certificate of Water Right, confirming the right, with priority of January 7, 1959 to the use of 8.0 c.f.s. of surface water with the point of diversion in the NE $\frac{1}{4}$ NE $\frac{1}{4}$, Sec. 15, T. 15 S., R. 4 E., B.M. from Snow Creek for irrigation of 705 acres in the NE $\frac{1}{4}$ SE $\frac{1}{4}$, Sec. 34; SW $\frac{1}{4}$, NW $\frac{1}{4}$ SE $\frac{1}{4}$, S $\frac{1}{2}$ SE $\frac{1}{4}$, Sec. 35; T. 14 S., R. 4 E., B.M. Sec. 2; NW $\frac{1}{4}$, N $\frac{1}{2}$ SW $\frac{1}{4}$, SW $\frac{1}{4}$ SW $\frac{1}{4}$, Sec. 11, T. 15 S., R. 4 E., B.M.

Very truly yours,

CARL E. TAPPAN
State Reclamation Engineer
By

(Mrs.) Edna P. Rule
Chief Clerk

EPR:mr

27700

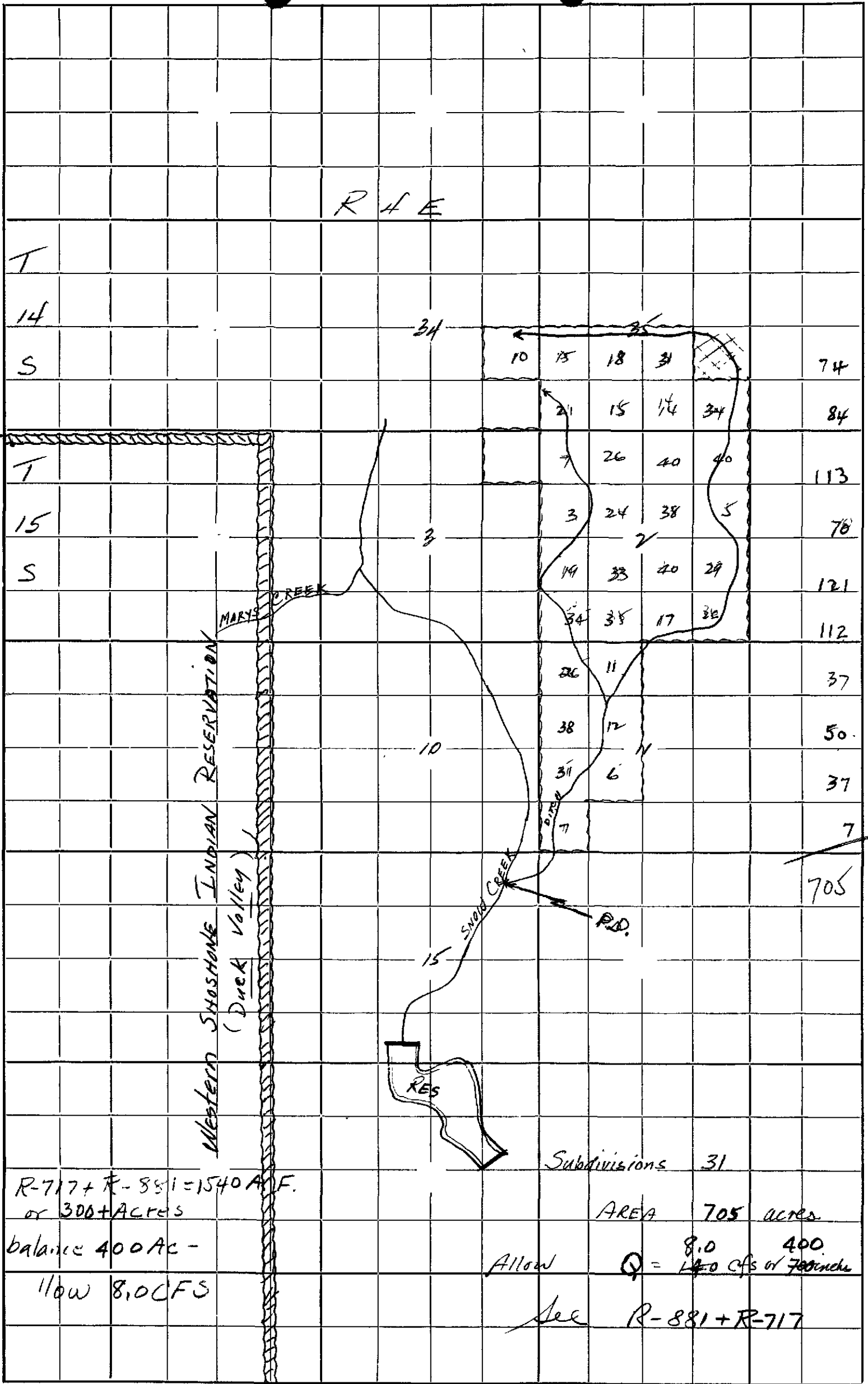

STATE OF IDAHO
DEPARTMENT OF RECLAMATION
BOISE

REPORT OF ENGINEER

PERMIT NO. 27700

REPORT ON PROOF OF Completion of Works & Beneficial Use

W. P. Strickland, Bruneau, Idaho

STATE OF IDAHO
DEPARTMENT OF RECLAMATION
BOISE, IDAHO
REPORT OF ENGINEER

Permit No. 27700

This proof is for Completion of Works & Beneficial Use In Water District No. _____

1. Name of applicant W. P. Strickland

2. Source of water supply: Snow Creek

3. Location of point of diversion: Is in the NE $\frac{1}{4}$ NE $\frac{1}{4}$ of Section 15

T. 15S R. 4 E.B.M. County of Owyhee

4. Describe works as they exist, giving dimensions and capacities of same: Earth and Rock dam on creek channel diverts the whole amount except during high water into wide flat ditches capable of carrying 800 to 900 inches.

5. Water is used for: Irrigation

6. State whether or not water has been turned into works of diversion: yes

7. List legal subdivisions of lands to be irrigated. If proof is for beneficial use, give exact number of acres under cultivation in each forty-acre tract. (Describe manner and place of use if other than irrigation):

131 acres in NW $\frac{1}{4}$, N $\frac{1}{2}$ SW $\frac{1}{4}$ & SW $\frac{1}{4}$ SW $\frac{1}{4}$ Sec. 11., 411 acres in Sec. 2., all in Twp. 15 S., Rge. 4 E.B.M. 10 acres in NE $\frac{1}{4}$ SE $\frac{1}{4}$ Sec. 34., 148 acres in SW $\frac{1}{4}$, NW $\frac{1}{4}$ SE $\frac{1}{4}$, S $\frac{1}{2}$ SE $\frac{1}{4}$ Sec. 35., all in Twp. 14 S., Rge. 4 E.B.M. Total No. of acres 700

(Submit map on attached plat, showing location and details of above description.)

8. What large stream would the water here appropriated finally reach? _____

Remarks: Mr. Grant Strickland along

Abutment made as only approximately 200' being diverted from Reservoir.

This examination was made on the 23rd day of September, 1964

(Signed) Laurel Johnson Examiner.

INSTRUCTIONS TO EXAMINERS

1. Always carefully note the location of the point of diversion and accurately plat same.
2. When proof is for beneficial use, carefully check up the number of acres actually irrigated in each forty and accurately plat same.
3. Make a map showing the correct location of streams and ditches, and the irrigated lands, and any adjacent permanent landmarks, such as towns, lakes, large streams and public roads.
4. If any unusual conditions are discovered, make plain statement of them under remarks.
5. Always see the holder, if possible, and go over the whole ground with him and make your report only upon actual existing facts and conditions.
6. Give general characteristics of soils, topography, and crops raised.

RECEIVED
OCT 19 1964

Department of Reclamation

W. P. Strickland
Bruneau, Idaho

Permit No. 27700

Examination for Completion of Works & Beneficial Use

County Owyhee

Sec. 15 T15S R. 4 EBM

Quantity: 14 C.F.S.

Source: Snow Creek

P. D.: NENE, 15-15S-4E

Use: Irrigation

Filed: 1-7-59

Due: 1-9-64 C/w
1-9-69 B/u

Extension:

Protest:

Completion of Works:

Other Rights:

R-881, R-717

The following information was telephoned
in by Jean Bain Jan. 10, 1964;
from Harley McDowell's office

Permit No. 27700

For publication

Point of diversion:

NE¹/₄NE¹/₄ Sec. 15., Twp. 15S; Rge. 4 E.B.M.

27700

1M April 1962

February 25, 1961

Re: Permit No. **27700**

Mr. W. P. Strickland
Brunnau, Idaho

Dear Mr. Strickland:

We acknowledge receipt of the depositions of holder and two witnesses, also affidavit of publication in the Oxyhee Nugget, all submitted in proof of completion of works and beneficial use on Permit No. **27700**.

Before final action is taken in the matter, the law requires that a field examination be made by an engineer from this department.

We cannot tell just when this examination will be made, but our field engineer will try and contact you at the time he makes the examination so that arrangements may be made to show him over the grounds.

Very truly yours ,

GEO. N. CARTER
State Reclamation Engineer

By:

(Mrs.) Edna P. Rule
Chief Clerk

EPR:
cc: **Harley M. McDowell**
P. O. Box 2161
Boise, Idaho

27700

RECEIVED
FEB 25 1964

STATE OF IDAHO
DEPARTMENT OF RECLAMATION
BOISE, IDAHO

Department of Reclamation

Permit No. 27700

Proof of Application of Water to Beneficial Use

Deposition of Holder

Ques. 1. State your name, residence, occupation and postoffice address.

Ans. W. P. Strickland; residence, Bruneau, Ida; occupation, farmer; postoffice address, Bruneau, Ida.

Ques. 2. If acting in behalf of corporation, state its name, principal place of business (if a foreign corporation, give name of postoffice of statutory agent), your position with reference to same, and your authority for appearing in its behalf.

Ans. Individual.

Ques. 3. State number and date of permit, and date of priority you propose to establish under the permit.

Ans. Permit 27700; date of permit 1/9/59; date of priority 1/7/59.

Ques. 4. State source of water supply and give exact location of point of diversion.

Ans. Snow Ck., NE 1/4 Sec. 15, T15S-R4E, B.M., Ida.

Ques. 5. Describe your works of diversion, and state amount of water they are capable of conveying from point of diversion to place of use, and give name of canal or ditch or other works by which water is conducted to such place of use. If a well, state depth of well, depth and size of casing and depth to water. If pump is used, state discharge of pump and tell how it was measured or determined. If sprinkler irrigation, give number and size of nozzles and operating pressure.

Ans. Works of diversion consist of earth and rock diversion out of creek into ditch; ditch is 5' deep, 12' top, 2' mi. long and is capable of conveying 800" of water to place of use. This is a private ditch.

Ques. 6. State for what purpose water is used and describe place of use. (If for irrigation, name each subdivision in which used, and number of acres in each subdivision that have actually been irrigated with said water.) State whether cultivated or natural meadow land and the nature of all improvements which have been made as a direct result of said use.

Ans. Water is used for irrigation as per attached list. No natural meadow land. All improvements were made as a direct result of said use.

Ques. 6-a If this is a ground water permit, give name and address of person that drilled the well.

Ans.

27700

Ques. 7. If for other than irrigation purposes; state how applied, amount of horse power generated, etc.

Ans. Livestock watering purposes.

Ques. 8. What is the minimum amount of water required for the purpose specified above?

Ans. Water being used is minimum necessary.

Ques. 9. If you are not the person or representative of the corporation to whom above mentioned permit was originally issued, please state how ownership was acquired by present holder.

Ans. Original applicant.

Ques. 10. State when, how, in what amount and to what extent the water diverted under above mentioned permit has been used.

Ans. Water from this permit has been used since 1959, every irrigation
season.

Ques. 11. State when, how, in what amount and to what extent waters other than those diverted under the above mentioned permit have been diverted and applied to beneficial use upon the lands herein described. Give full particulars regarding such other appropriations and rights claimed thereunder.

Ans. None.

(Sign)

W. P. Stuckelund

I hereby certify that the foregoing testimony was read to the above subscribed before its signing, that I believe him to be the person he represents himself to be, and that said testimony was subscribed and sworn to before me, at my office in Boise, County of Ada, State of Idaho, on this 21st day of February, A. D. 1964.

Joan A. Bain
Notary Public for the State of Idaho

My commission expires 6/20/65

STATE OF IDAHO
DEPARTMENT OF RECLAMATION
BOISE, IDAHO

RECEIVED
FEB 25 1964

Department of Reclamation

PERMIT NO. 27700

Proof of Application of Water to Beneficial Use

Deposition of Witness

The deposition of two witnesses, on this form, taken separately, required in each case.

Ques. 1. State your name, age, residence, occupation and postoffice address.

Ans. Bud Jewett; age, 55; residence, Bruneau, Ida. occupation; farming;
postoffice address, Bruneau, Ida.

Ques. 2. Are you acquainted with W. P. Strickland, the holder of Permit No 27700? How long have you known him and where does he reside?

Ans. I have known him 40 years. He resides at Bruneau, Ida.

Ques. 3. Have you read or heard read said Permit No 27700, and are you familiar with its provisions and conditions?

Ans. Yes.

Ques. 4. State source of water supply, place of diversion, and describe works for conveying water from point of diversion to place of use.

Ans. Snow Ck. is source of water; place of diversion, NE $\frac{1}{4}$ NE $\frac{1}{4}$, Sec. 15, T15S-R4E. Works consist of earth and rock diversion dam and ditch to convey water to place of use.

Ques. 5. How many second feet of water do you estimate said works will safely conduct to place of use, and how much water have you seen being so conveyed?

Ans. 16 cfs.

Ques. 6. State for what purpose water is used and at what place (If for irrigation, give each subdivision in which water has been used and number of acres irrigated in each subdivision.) State whether cultivated or natural meadow land and the nature of all improvements which have been made as a direct result of said use.

Ans. Water is used for irrigation in NW $\frac{1}{4}$, N $\frac{1}{4}$ SW $\frac{1}{4}$, SW $\frac{1}{4}$ SW $\frac{1}{4}$, Sec. 11; All, Sec. 2; T15S-R4E. NE $\frac{1}{4}$ SE $\frac{1}{4}$, Sec. 34; SW $\frac{1}{4}$, W $\frac{1}{4}$ SE $\frac{1}{4}$, SE $\frac{1}{4}$ SE $\frac{1}{4}$, Sec. 35, T14S-R4E. All cultivated land. All improvements have been made as a direct result of said use.

Ques. 7. If for power or other purposes than irrigation, state how water has been applied and to what extent.

Ans. None

Ques. 8. (If for irrigation) state character of land that has been reclaimed, and give your estimate of the amount of water required for its profitable cultivation.

Ans. This is clay loam soil. He needs all of the water being used for profitable cultivation.

Ques. 9. Have you any interest in the works, water or lands above mentioned? If so, in what way and to what extent?

Ans. No.

Ques. 10. State when, how, in what amount and to what extent you have witnessed the application to beneficial use of water diverted under said permit.

Ans. I have seen this development since 1959 frequently.

(Signed)

And Junior

I hereby certify that the foregoing testimony was read to the above subscriber before its signing, that I believe him to be the person he represents himself to be, and that said testimony was subscribed and sworn to before me in Boise,
County of Ada, State of Idaho, on this 21 day of February,
A. D. 19 64.

Joan H. Bain

Notary Public.

My commission expires 6/20/65

Description of lands irrigation under permit 27700, W. F. Strickland:

	Acres
T 15 S - R 4 E.,	
Section 11, NW $\frac{1}{4}$ NW $\frac{1}{4}$	26
SW $\frac{1}{4}$ NW $\frac{1}{4}$	38
SE $\frac{1}{4}$ NW $\frac{1}{4}$	12
NE $\frac{1}{4}$ NW $\frac{1}{4}$	11
NE $\frac{1}{4}$ SW $\frac{1}{4}$	5
NW $\frac{1}{4}$ SW $\frac{1}{4}$	31
SW $\frac{1}{4}$ SW $\frac{1}{4}$	7
Section 2 NE $\frac{1}{4}$ NE $\frac{1}{4}$	40
SE $\frac{1}{4}$ NE $\frac{1}{4}$	5
SW $\frac{1}{4}$ NE $\frac{1}{4}$	38
NW $\frac{1}{4}$ NE $\frac{1}{4}$	40
NW $\frac{1}{4}$ NW $\frac{1}{4}$	7
NE $\frac{1}{4}$ NW $\frac{1}{4}$	26
SE $\frac{1}{4}$ NW $\frac{1}{4}$	24
SW $\frac{1}{4}$ NW $\frac{1}{4}$	3
NW $\frac{1}{4}$ SW $\frac{1}{4}$	19
NE $\frac{1}{4}$ SW $\frac{1}{4}$	33
SE $\frac{1}{4}$ SW $\frac{1}{4}$	35
SW $\frac{1}{4}$ SW $\frac{1}{4}$	35
NW $\frac{1}{4}$ SE $\frac{1}{4}$	40
NE $\frac{1}{4}$ SE $\frac{1}{4}$	29
SE $\frac{1}{4}$ SE $\frac{1}{4}$	26
SW $\frac{1}{4}$ SE $\frac{1}{4}$	17
T 14 S - R 4 E., S	
Section 34, NE $\frac{1}{4}$ SE $\frac{1}{4}$	10
Section 35, NW $\frac{1}{4}$ SW $\frac{1}{4}$	15
SW $\frac{1}{4}$ SW $\frac{1}{4}$	21
SE $\frac{1}{4}$ SW $\frac{1}{4}$	15
NE $\frac{1}{4}$ SW $\frac{1}{4}$	18
NW $\frac{1}{4}$ SE $\frac{1}{4}$	31
SW $\frac{1}{4}$ SE $\frac{1}{4}$	14
SE $\frac{1}{4}$ SE $\frac{1}{4}$	34

FEB 25 1964

STATE OF IDAHO
DEPARTMENT OF RECLAMATION
BOISE, IDAHO

RECEIVED
FEB 25 1964

Department of Reclamation

PERMIT NO. 27700

Proof of Application of Water to Beneficial Use

Deposition of Witness

The deposition of two witnesses, on this form, taken separately, required in each case.

Ques. 1. State your name, age, residence, occupation and postoffice address.

Ans. Eugene C. Davis; age, 40; residence, Bruneau, Ida.; occupation, farmer;
postoffice address, Bruneau, Ida.

Ques. 2. Are you acquainted with W. P. Strickland, the holder of Permit No. 27700? How long have you known him and where does he reside?

Ans. I have known him 14 years and know he resides in Bruneau, Ida.

Ques. 3. Have you read or heard read said Permit No. 27700, and are you familiar with its provisions and conditions?

Ans. Yes.

Ques. 4. State source of water supply, place of diversion, and describe works for conveying water from point of diversion to place of use.

Ans. Source is Snow Ck. Point of diversion NE 1/4, Sec. 15, T15S-R4E. Works consist of
earth and rock diversion and ditch for conveying water.

Ques. 5. How many second feet of water do you estimate said works will safely conduct to place of use, and how much water have you seen being so conveyed?

Ans. 800"

Ques. 6. State for what purpose water is used and at what place. (If for irrigation, give each subdivision in which water has been used and number of acres irrigated in each subdivision) State whether cultivated or natural meadow land and the nature of all improvements which have been made as a direct result of said use.

Ans. Water is used for irrigation. Water is used to irrigate about 700 acres in
Sec. 2, 11, T15S-R4E., Sec. 34, 35, T14S-R4E.

Ques. 7. If for power or other purposes than irrigation, state how water has been applied and to what extent.

Ans. None.

Ques. 8. (If for irrigation) state character of land that has been reclaimed, and give your estimate of the amount of water required for its profitable cultivation.

Ans. ~~Character of soil is silt/loam. He needs all of this water for profitable irrigation.~~ ^{clay}

Ques. 9. Have you any interest in the works, water or lands above mentioned? If so, in what way and to what extent?

Ans. No.

Ques. 10. State when, how, in what amount and to what extent you have witnessed the application to beneficial use of water diverted under said permit.

Ans. I have seen this water used since 1959.

(Signed)

Eugene C. Davis

I hereby certify that the foregoing testimony was read to the above subscriber before its signing, that I believe him to be the person he represents himself to be, and that said testimony was subscribed and sworn to before me in Boise, County of Ada, State of Idaho, on this 21 day of February, A. D. 19 64.

Joan W. Bain

Notary Public.

My commission expires 6/20/65.

PROOF OF PUBLICATION

STATE OF IDAHO }
County of Owyhee } ss.

I, RODNEY A. HAWES, being first duly sworn, on oath says that he is the Publisher of the OWYHEE NUGGET, a newspaper of general circulation, published weekly by Rodney A. Hawes, publisher and printer thereof, at Marsing, County of Owyhee, State of Idaho;

That the annexed notice was published in said newspaper once each week and every week for consecutive weeks, the first publication being on the day of, 19, and the last publication being on the day of, 19;

That the said newspaper has been published continuously and uninterruptedly in said county during a period of more than seventy-eight consecutive weeks prior to the first publication of the attached notice.

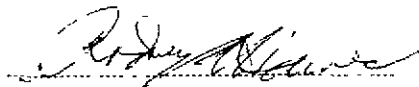

PUBLISHER.

Subscribed and sworn to before me this day of

., 19

NOTARY PUBLIC

My commission expires

(SEAL)

NOTICE FOR PUBLICATION NOTICE OF PROOF APPLICATION OF WATER TO BENEFICIAL USE

Notice is hereby given that at 10 A. M. on the 21 day of February, 1964, at Boise, County of Ada, State of Idaho, before Joan H. Bain, proof will be submitted of the application to beneficial use of 14 cubic feet per second of the waters of Snow Ck. in accordance with the terms and conditions of Permit No. 27700 heretofore issued by the Idaho Department of Reclamation of the State of Idaho.

The name and postoffice address of the person or corporation holding said permit are W. P. Strickland, Bruneau, Ida.

The use to which said water has been applied is irrigation.

The amount applied to beneficial use is 14 cfs.

The place where said water is used (if for irrigation, give full and accurate description of the lands irrigated) NW $\frac{1}{4}$, N $\frac{1}{2}$ -SW $\frac{1}{4}$, SW $\frac{1}{4}$ SW $\frac{1}{4}$, Sec. 11; All Sec. 2, T15S, R4E, NE $\frac{1}{4}$ SE $\frac{1}{4}$, Sec. 34; SW $\frac{1}{4}$, W $\frac{1}{2}$ SE $\frac{1}{4}$, SE $\frac{1}{4}$ SE $\frac{1}{4}$, Sec. 35, T14 S., R4E.

POINT OF DIVERSION:
NE $\frac{1}{4}$ NE $\frac{1}{4}$ Sec. 15, Twp. 15 S., Rge. 4 E. B. M.

The name of the canal or ditch or other works by which said water is conducted to such place of use is private ditch.

The right to take water from such works is based upon Permit No. 27700.

The source of supply from which such water is diverted is Snow Ck.

The date of priority which said user is prepared to establish is 1/7/59.

CARL E. TAPPAN,
State Reclamation Engineer.
(Jan. 23 — Feb. 13)

27700

January 20, 1964

Re: Permit No. 27700
W. P. Strickland

Owyhee Nugget
Marsing, Idaho

Gentlemen:

On checking the copy of the Notice of Publication on the above numbered permit, we find the following correction:

In Paragraph 5, Line 5, the SW¹/₄SW¹/₄, Sec. 11, was left out entirely. The land in Section 11 should read - NW¹/₄, N¹/₂SW¹/₄, SW¹/₄SW¹/₄, Sec. 11.

We must ask that this be readvertised so that it is right for the four consecutive issues, according to the recent ruling of the Attorney General's office.

Very truly yours,

CARL E. TAPPAN
State Reclamation Engineer

By:

H. PETRI
State Water Rights Clerk

HP:ew

Enc. copy of Notice
Mailed to You

cc: Harley M. McDowell
Box 2161
Boise, Idaho

27700

Hold until B/U Proofs come in on February 21st
then make engineer's report on both the comple-
tion of Works and Beneficial Use proofs.

RE: Permit No. 27700

Edna
1/10/64

27 700

Re: Permit No. 27700
W. P. Strickland

January 10, 1964

Mr. Harley M. McDowell,
Idaho Land and Appraisal Service,
Box 2161,
Boise, Idaho.

Dear Mr. McDowell:

This acknowledges the Notice of Proof of ~~Completion of Work~~ Application of Water to Beneficial Use under Permit No. 27700, in the name of W. P. Strickland. Final Proof is to be made before ~~you~~, Joan Bain as Notary on the 21st day of February, 1964, at 10:00 o'clock A.M., at Idaho Building, Boise, Idaho.

As of this date, we have mailed the Notice to the Orysee Nugget Marsing, Idaho, with instructions to publish it once a week for 4 consecutive weeks prior to the date set for final proof and then mail the Affidavit of Publication and statement of costs to you.

It is important that the enclosed depositions be executed by the permit holder and two disinterested witnesses who are familiar with the terms of the permit and the work done thereunder, at the time, on the date and before you, as Notary, as stated in the publication notice. It is very important and necessary that each question be answered in detail.

In returning the depositions to this office, be sure that all copies have been read, that your Notary's seal has been placed on each and that all depositions, (holder and two witnesses) are being returned. Also be sure to enclose the AFFIDAVIT OF PUBLICATION.

Very truly yours,

CARL E. TAPPAN
State Reclamation Engineer
By

(MRS.) EDNA P. RULE
Chief Clerk

Encl.
E R:prk
cc: Applicant

27700

Re: Permit No. 27700
W. P. Strickland

Date: January 10, 1964

Owyhee Nugget,
Marsing, Idaho.

Gentlemen:

Enclosed you will find Notice for Publication, once a week for four consecutive weeks prior to February 21, 1964 the date set for proof; the expense of the publication is to be paid by the ~~applicant~~ Idaho Land and Appraisal Service of Box 2161, Boise, Idaho to whom you should furnish proof of publication on or prior to the date set for proof.

Please acknowledge receipt of this notice and furnish this office with a copy or tear sheet of the first publication.**

Very truly yours,



CARL E. TAPPAN
State Reclamation Engineer

** If the first copy is not received in this office for checking purposes and errors appear in subsequent issues, it is possible that re-publication of corrected copy will be at your own expense.

CET:pmk

NOTICE FOR PUBLICATION
NOTICE OF PROOF APPLICATION OF WATER
TO BENEFICIAL USE

Notice is hereby given that at 10-A A. M. on the 21 day of February, 1964,
at Boise, County of Ada, State of Idaho, before
Joan M. Bain, proof will be submitted of the
application to beneficial use of 14 cubic feet per second of the waters of Snow Cr.
in accordance with the terms and conditions of Permit No. 27700
heretofore issued by the Idaho Department of Reclamation of the State of Idaho.

The name and postoffice address of the person or corporation holding said permit are

W. P. Strickland, Bruneau, Ida.

The use to which said water has been applied is irrigation.

The amount applied to beneficial use is 14 cfs.

The place where said water is used (if for irrigation, give full and accurate description of the lands irrigated)

NW¹/₄, N¹/₂SW¹/₄, SW¹/₄SW¹/₄, Sec. 11; All, Sec. 2, T15S-R4E, NE¹/₄SE¹/₄, Sec. 34;
SW¹/₄, W¹/₂SE¹/₄, SE¹/₄SE¹/₄, Sec. 35, T14S-R4E.

POINT OF DIVERSION: NE¹/₄NE¹/₄ Sec. 15., Twp. 15S., Rge. 4 E.B.M.

The name of the canal or ditch or other works by which said water is conducted to such place of use is

private ditch.

The right to take water from such works is based upon Permit No. 27700

The source of supply from which such water is diverted is Snow Cr.

The date of priority which said user is prepared to establish is 1/7/59

CARL E. TAPPAN

State Reclamation Engineer.

27700

NOTICE TO ACCOMPANY THIS LETTER MUST BE MADE IN DUPLICATE

(Date) January 9, 1964

(P. O.) Bruneau, Ida.

TO THE STATE RECLAMATION ENGINEER:

Boise, Idaho

Dear Sir:

You are hereby authorized to have the attached notice published at my expense in the

Owyhee Nugget of Marsing, Ida. published in

the county in which the works are situated

PLEASE SEND STATEMENT OF CHARGES AND AFFIDAVIT OF PUBLICATION TO IDAHO LAND & APPRAISAL
SERVICE, PO BOX 2161, BOISE, IDA.

W.P. Strickland

(In case of canals or other works designed to divert and carry more than 50 cubic feet of water per second, the following certificate must be signed by a well known and competent engineer.)

I hereby certify that the facts set forth in the attached notice are true.

Engineer

PERMIT NO. 27700

Proof of Completion of Works

DEPOSITION OF HOLDER

Ques. 1. State your name, residence, occupation and postoffice address.

Ans. W. P. Strickland; Bruneau, Ida.; occupation, farmer; postoffice
address, Bruneau, Ida.

Ques. 2. If acting in behalf of a corporation, state its name, principal place of business, your position with reference to same, and your authority for appearing in its behalf.

Ans. Individual.

Ques. 3. State number and date of permit, amount of water you are authorized to divert, source, and point of diversion.

Ans. Permit 27700; date of permit 1/9/59; date of priority 1/7/59; 14 cfs.;
point of diversion, NE¹/₄NE¹/₄, Sec. 15, T15S-R4E, B.M., Ida.

Ques. 4. State purpose for which water is to be used, and, if for irrigation, state the number of acres and give description of the land you intend to reclaim.

Ans. Irrigation. 705 acres in Sec. 11 and 2, T15S-R4E and Sec. 34 and 35.
T14S-R4E, See attached for exact acreages.

Ques. 5. State whether or not the water has been turned into your works of diversion, and, if so, when and to what extent.

Ans. Yes. Has been used in 1959 and every irrigation season since.

Ques. 6. State whether or not the works of diversion are fully completed, and whether or not they comply in all respects with the terms of the permit.

Ans. Yes.

Ques. 7. If the works of diversion do not comply with all the terms of your permit, state fully those particulars in which there is any variance.

Ans. -

Ques. 8. Give description of works, state dimensions and capacity of each part, and give cost of same.

Ans. Earth and rock diversion out of creek into ditch ~~XXXXXX~~, Ditch 5' deep,
12' top, 2 1/2 mi. long, will carry 800" of water - cost \$3,100. There is a rock
overflow 12' wide, 4' deep, 3-1 slope.

(Sign here.)

W. P. Strickland

I hereby certify that the foregoing testimony was read to the above subscriber before its signing, that I believe him to be the person he represents himself to be, and that said testimony was subscribed and sworn to before me, in Boise,

County of Ada, State of Idaho, on this 6th
day of January, A. D. 1964.

Jean H. Bani

Notary Public.

My Commission expires 6/20/65

Description of lands irrigation under permit 27700, W. P. Strickland:

	Acres
T 15 S - R 4 E.,	
Section 11, NW $\frac{1}{4}$ NW $\frac{1}{4}$ ✓	26
SW $\frac{1}{4}$ NW $\frac{1}{4}$ ✓	38
SE $\frac{1}{4}$ NW $\frac{1}{4}$ ✓	12
NE $\frac{1}{4}$ NW $\frac{1}{4}$ ✓	11
NE $\frac{1}{4}$ SW $\frac{1}{4}$ ✓	5
NW $\frac{1}{4}$ SW $\frac{1}{4}$ ✓	31
SW $\frac{1}{4}$ SW $\frac{1}{4}$ ✓	7
Section 2 NE $\frac{1}{4}$ NE $\frac{1}{4}$ ✓	40
SE $\frac{1}{4}$ NE $\frac{1}{4}$ ✓	5
SW $\frac{1}{4}$ NE $\frac{1}{4}$ ✓	38
NW $\frac{1}{4}$ NE $\frac{1}{4}$ ✓	40
NW $\frac{1}{4}$ NW $\frac{1}{4}$ ✓	7
NE $\frac{1}{4}$ NW $\frac{1}{4}$ ✓	26
SE $\frac{1}{4}$ NW $\frac{1}{4}$ ✓	24
SW $\frac{1}{4}$ NW $\frac{1}{4}$ ✓	3
NW $\frac{1}{4}$ SW $\frac{1}{4}$ ✓	19
NE $\frac{1}{4}$ SW $\frac{1}{4}$ ✓	33
SE $\frac{1}{4}$ SW $\frac{1}{4}$ ✓	35
SW $\frac{1}{4}$ SW $\frac{1}{4}$ ✓	35
NW $\frac{1}{4}$ SE $\frac{1}{4}$ ✓	40
NE $\frac{1}{4}$ SE $\frac{1}{4}$ ✓	29
SE $\frac{1}{4}$ SE $\frac{1}{4}$ ✓	26
SW $\frac{1}{4}$ SE $\frac{1}{4}$ ✓	17
T 14 S - R 4 E., S	
Section 34, NE $\frac{1}{4}$ SE $\frac{1}{4}$ ✓	10
Section 35, NW $\frac{1}{4}$ SW $\frac{1}{4}$ ✓	15
SW $\frac{1}{4}$ SW $\frac{1}{4}$ ✓	21
SE $\frac{1}{4}$ SW $\frac{1}{4}$ ✓	15
NE $\frac{1}{4}$ SW $\frac{1}{4}$ ✓	18
NW $\frac{1}{4}$ SE $\frac{1}{4}$ ✓	31
SW $\frac{1}{4}$ SE $\frac{1}{4}$ ✓	14
SE $\frac{1}{4}$ SE $\frac{1}{4}$ ✓	34

705

The Depositions of two Witnesses, in this form, taken separately, required in each case.

Permit No. 27700

Proof of Completion of Works**DEPOSITION OF WITNESS**

Ques. 1. State your name, residence, occupation and postoffice address.

Ans. Bud Jewett; residence, Bruneau, Ida.; occupation, farming; postoffice address, Bruneau, Ida.

Ques. 2. Are you acquainted with W. P. Strickland, the holder of Permit No. 27700, authorizing the diversion of 14 second-feet of the waters of Snow Cr., N E 1/4, Sec. 15, at T15S-R4E, for irrigation purposes? How long have you known him, and where does he reside?

Ans. I have known him 40 years and know that he resides at Bruneau, Ida.

Ques. 3. Have you read or heard read said Permit No. 27700, and are you familiar with its terms and conditions?

Ans. Yes.

Ques. 4. (If for irrigation purposes). Are you acquainted with the land proposed to be irrigated under said permit? If so, describe same, state its character, and give your estimate of the amount of water required for its profitable cultivation.

Ans. Yes. T15S-R4E, Sec. 11, NW 1/4, N 1/2 SW 1/4, SW 1/4 SW 1/4, Sec. 2, All; T14S-R4E, Sec. 34, NE 1/4 SE 1/4; Sec. 35, SW 1/4, W 1/2 SE 1/4, SE 1/4 SE 1/4. Soils are clay loam. All the water being used is necessary for profitable cultivation.

Ques. 5. Are the works of diversion fully completed and of sufficient capacity to convey the entire amount of water set out in the permit from point of diversion to place of use?

Ans. Yes.

Ques. 6. Describe the works of diversion as they now exist, and give your estimate of their capacity.

Ans. Works of diversion consist of an earth and rock diversion dam and ditch to convey the water to place of use.

(Sign here.)

Bud Jewett

I hereby certify that the foregoing testimony was read to the above subscriber before its signing, that I believe him to be the person he represents himself to be, and that said testimony was subscribed and sworn to before me, at my office in Boise County of Ada, State of Idaho, on this 6 day of January, A. D. 1964.

Jean H. Bani

The Depositions of two Witnesses, in this form, taken separately, required in each case.

Permit No. 27700

Proof of Completion of Works**DEPOSITION OF WITNESS**

Ques. 1. State your name, residence, occupation and postoffice address.

Ans. Eugene C. Davis; residence, Bruneau, Ida.; occupation, farming; postoffice address, Bruneau, Ida.

Ques. 2. Are you acquainted with W. P. Strickland, the holder of Permit No. 27700, authorizing the diversion of 14 second-feet of the waters of Snow Cr., at NE 1/4, Sec. 15, T15S-R4E. for irrigation purposes? How long have you known him, and where does he reside?

Ans. I have known him 14 years. He resides at Bruneau, Ida.

Ques. 3. Have you read or heard read said Permit No. 27700, and are you familiar with its terms and conditions?

Ans. Yes.

Ques. 4. (If for irrigation purposes). Are you acquainted with the land proposed to be irrigated under said permit? If so, describe same, state its character, and give your estimate of the amount of water required for its profitable cultivation.

Ans. Lands to be irrigated are in Sec. 2, 11, T15S-R4E. and Sec. 34, 35, T14S-R4E. Clay loam soil. Water being used is necessary for profitable cultivation.

Ques. 5. Are the works of diversion fully completed and of sufficient capacity to convey the entire amount of water set out in the permit from point of diversion to place of use?

Ans. Yes.

Ques. 6. Describe the works of diversion as they now exist, and give your estimate of their capacity.

Ans. Works consist of earth and rock diversion, ditches and capacity would be at least 800"

(Sign here.)

Eugene C. Davis

I hereby certify that the foregoing testimony was read to the above subscriber before its signing, that I believe him to be the person he represents himself to be, and that said testimony was subscribed and sworn to before me, at my office in Boise County of Ada, State of Idaho, on this 6 day of January, A. D. 19 64.

Joan H. Bain

January 10, 1964

RE: Permit No. 27700
W. P. Strickland

Harley M. McDowell
Idaho Land & Appraisal Service
Box 2161
Boise, Idaho

Attn: Joan Bain

Dear Joan:

Returned herewith is your check in the amount of \$5.00
covering the fee for the Certificate of Completion of Works
on the above numbered permit.

You will be notified of the amount of fees on both proofs
after our engineer has made his inspection.

Very truly yours,

CARL E. TAPPAN
State Reclamation Engineer
By

(Mrs.) Edna P. Rule
Chief Clerk

T.R:mr

Enc. check

27700

PROOF OF PUBLICATION

STATE OF IDAHO }
County of Owyhee } ss.

I, RODNEY A. HAWES, being first duly sworn, on oath says that
he is the Publisher of the OWYHEE NUGGET, a newspaper of gen-
eral circulation, published weekly by Rodney A. Hawes, publisher
and printer thereof, at Marsing, County of Owyhee, State of Idaho;

That the annexed notice was published in said newspaper once
each week and every week for 4 consecutive weeks, the first pub-
lication being on the 21 day of Nov., 19 63, and
the last publication being on the 12 day of Dec.,
19 63;

That the said newspaper has been published continuously and un-
interruptedly in said county during a period of more than seventy-
eight consecutive weeks prior to the first publication of the attached
notice.

Rodney A. Hawes
PUBLISHER.

Subscribed and sworn to before me this 12 day of

Dec., 19 63

Rodney A. Hawes
NOTARY PUBLIC

My commission expires 9-10-64

(SEAL)

NOTICE FOR PUBLICATION COMPLETION OF WORKS

Notice is hereby given that at
10 A. M., on the 6th day of Jan-
uary, 1964, at Boise, County of
Ada, State of Idaho, before Jean
H. Bain, 329 Idaho Bldg., Boise,
Idaho, proof will be submitted
of the completion of works for
the diversion of 14.0 cubic feet
per second of the waters of
Snow Ck. in accordance with
the terms and conditions of a
certain permit heretofore issued
by the Department of Reclama-
tion of the State of Idaho.

1. The name of the person or
corporation holding said permit
is W. P. Strickland.

2. The postoffice address of
such person or principal place
of business of such corporation
is Bruneau, Idaho, County of
Owyhee, State of Idaho.

3. The number of such permit
is 27700, and the date set for
the completion of such work is
1/9/64.

4. Said water is to be used
for irrigation.

5. Said works of diversion
will be fully completed on the
date set for such completion,
and the amount of water which
said works are capable of con-
ducting to the place of intended
use, in accordance with the
plans accompanying the appli-
cation for such permit, is 14
cubic feet per second.

6. The amount of lands for
which said water is available is
1240 acres, particularly describ-
ed as follows: NW $\frac{1}{4}$, NE $\frac{1}{4}$,
SW $\frac{1}{4}$, W $\frac{1}{2}$ SW $\frac{1}{4}$, Sec. 11, all
Sec. 2, T15S - R4E, NE $\frac{1}{4}$, SE $\frac{1}{4}$,
Sec. 34, SW $\frac{1}{4}$, NW $\frac{1}{4}$, SE $\frac{1}{4}$, S $\frac{1}{2}$,
SE $\frac{1}{4}$, Sec. 35, T14S - R4E, B.
M., Idaho.

CARL E. TAPPAN,
State Reclamation Engineer
(Nov. 21 - Dec. 12)

November 21, 1963

Re: Permit No. 27700
W. P. Strickland

Mr. Harley M. McDowell,
Idaho Land & Appraisal Service,
Box 2161,
Boise, Idaho.

Dear Mr. McDowell:

This acknowledges the Notice of Proof of Completion of Works ~~and Application~~
of Water to Beneficial Use under Permit No. 27700, in the name of W. P. Strickland,
Final Proof is to be made before Joan Bain
as Notary on the 6th day of January, 19 64, at 10:00 o'clock A.M.,
at 329 Idaho Bldg., Boise, Idaho.

As of this date we have mailed the Notice to the Owyhee Nugget
Marsing, Idaho, with instructions to publish it once a week for four consecutive
weeks prior to the date set for final proof and then mail the Affidavit of Publi-
cation and statement of costs to you.

It is important that the enclosed depositions be executed by the permit
holder and two disinterested witnesses who are familiar with the terms of the
permit and the work done thereunder, at the time, on the date and before you, as
Notary, as stated in the publication notice. It is very important and necessary
that each question be answered in detail.

In returning the depositions to this office, be sure that all copies have
been signed, that your Notary's seal has been placed on each and that all depositions,
(holder and two witnesses) are being returned. Also be sure to enclose the
Affidavit of Publication.

Very truly yours,

~~W. P. CARTER~~
State Reclamation Engineer

By:

(Mrs.) Edna P. Rule
Chief Clerk

EPR:pmk
Enc.
cc: Applicant

27760

1. 2. 3. 4. 5. 6. 7. 8. 9. 10. 11. 12. 13. 14. 15. 16. 17. 18. 19. 20. 21. 22. 23. 24. 25. 26. 27. 28. 29. 30. 31. 32. 33. 34. 35. 36. 37. 38. 39. 40. 41. 42. 43. 44. 45. 46. 47. 48. 49. 50. 51. 52. 53. 54. 55. 56. 57. 58. 59. 60. 61. 62. 63. 64. 65. 66. 67. 68. 69. 70. 71. 72. 73. 74. 75. 76. 77. 78. 79. 80. 81. 82. 83. 84. 85. 86. 87. 88. 89. 90. 91. 92. 93. 94. 95. 96. 97. 98. 99. 100. 101. 102. 103. 104. 105. 106. 107. 108. 109. 110. 111. 112. 113. 114. 115. 116. 117. 118. 119. 120. 121. 122. 123. 124. 125. 126. 127. 128. 129. 130. 131. 132. 133. 134. 135. 136. 137. 138. 139. 140. 141. 142. 143. 144. 145. 146. 147. 148. 149. 150. 151. 152. 153. 154. 155. 156. 157. 158. 159. 160. 161. 162. 163. 164. 165. 166. 167. 168. 169. 170. 171. 172. 173. 174. 175. 176. 177. 178. 179. 180. 181. 182. 183. 184. 185. 186. 187. 188. 189. 190. 191. 192. 193. 194. 195. 196. 197. 198. 199. 200. 201. 202. 203. 204. 205. 206. 207. 208. 209. 210. 211. 212. 213. 214. 215. 216. 217. 218. 219. 220. 221. 222. 223. 224. 225. 226. 227. 228. 229. 230. 231. 232. 233. 234. 235. 236. 237. 238. 239. 240. 241. 242. 243. 244. 245. 246. 247. 248. 249. 250. 251. 252. 253. 254. 255. 256. 257. 258. 259. 260. 261. 262. 263. 264. 265. 266. 267. 268. 269. 270. 271. 272. 273. 274. 275. 276. 277. 278. 279. 280. 281. 282. 283. 284. 285. 286. 287. 288. 289. 290. 291. 292. 293. 294. 295. 296. 297. 298. 299. 300. 301. 302. 303. 304. 305. 306. 307. 308. 309. 310. 311. 312. 313. 314. 315. 316. 317. 318. 319. 320. 321. 322. 323. 324. 325. 326. 327. 328. 329. 330. 331. 332. 333. 334. 335. 336. 337. 338. 339. 340. 341. 342. 343. 344. 345. 346. 347. 348. 349. 350. 351. 352. 353. 354. 355. 356. 357. 358. 359. 360. 361. 362. 363. 364. 365. 366. 367. 368. 369. 370. 371. 372. 373. 374. 375. 376. 377. 378. 379. 380. 381. 382. 383. 384. 385. 386. 387. 388. 389. 390. 391. 392. 393. 394. 395. 396. 397. 398. 399. 400. 401. 402. 403. 404. 405. 406. 407. 408. 409. 410. 411. 412. 413. 414. 415. 416. 417. 418. 419. 420. 421. 422. 423. 424. 425. 426. 427. 428. 429. 430. 431. 432. 433. 434. 435. 436. 437. 438. 439. 440. 441. 442. 443. 444. 445. 446. 447. 448. 449. 450. 451. 452. 453. 454. 455. 456. 457. 458. 459. 460. 461. 462. 463. 464. 465. 466. 467. 468. 469. 470. 471. 472. 473. 474. 475. 476. 477. 478. 479. 480. 481. 482. 483. 484. 485. 486. 487. 488. 489. 490. 491. 492. 493. 494. 495. 496. 497. 498. 499. 500. 501. 502. 503. 504. 505. 506. 507. 508. 509. 510. 511. 512. 513. 514. 515. 516. 517. 518. 519. 520. 521. 522. 523. 524. 525. 526. 527. 528. 529. 530. 531. 532. 533. 534. 535. 536. 537. 538. 539. 540. 541. 542. 543. 544. 545. 546. 547. 548. 549. 550. 551. 552. 553. 554. 555. 556. 557. 558. 559. 560. 561. 562. 563. 564. 565. 566. 567. 568. 569. 570. 571. 572. 573. 574. 575. 576. 577. 578. 579. 580. 581. 582. 583. 584. 585. 586. 587. 588. 589. 590. 591. 592. 593. 594. 595. 596. 597. 598. 599. 600. 601. 602. 603. 604. 605. 606. 607. 608. 609. 610. 611. 612. 613. 614. 615. 616. 617. 618. 619. 620. 621. 622. 623. 624. 625. 626. 627. 628. 629. 630. 631. 632. 633. 634. 635. 636. 637. 638. 639. 640. 641. 642. 643. 644. 645. 646. 647. 648. 649. 650. 651. 652. 653. 654. 655. 656. 657. 658. 659. 660. 661. 662. 663. 664. 665. 666. 667. 668. 669. 670. 671. 672. 673. 674. 675. 676. 677. 678. 679. 680. 681. 682. 683. 684. 685. 686. 687. 688. 689. 690. 691. 692. 693. 694. 695. 696. 697. 698. 699. 700. 701. 702. 703. 704. 705. 706. 707. 708. 709. 710. 711. 712. 713. 714. 715. 716. 717. 718. 719. 720. 721. 722. 723. 724. 725. 726. 727. 728. 729. 730. 731. 732. 733. 734. 735. 736. 737. 738. 739. 740. 741. 742. 743. 744. 745. 746. 747. 748. 749. 750. 751. 752. 753. 754. 755. 756. 757. 758. 759. 760. 761. 762. 763. 764. 765. 766. 767. 768. 769. 770. 771. 772. 773. 774. 775. 776. 777. 778. 779. 780. 781. 782. 783. 784. 785. 786. 787. 788. 789. 790. 791. 792. 793. 794. 795. 796. 797. 798. 799. 800. 801. 802. 803. 804. 805. 806. 807. 808. 809. 810. 811. 812. 813. 814. 815. 816. 817. 818. 819. 820. 821. 822. 823. 824. 825. 826. 827. 828. 829. 830. 831. 832. 833. 834. 835. 836. 837. 838. 839. 840. 84

Notice for Publication

COMPLETION OF WORKS

Notice is hereby given that at **10 A.** M, on the **6th** day of **January**,
1964, at **Boise**, County of **Ada**, State of Idaho,
 before **Joan H. Bain, 329 Ida. Bldg. Boise, Ida.** proof will be submitted of the completion of works
 for the diversion of **14.0** cubic feet per second of the waters of **Snow Cr.**
 in accordance with the terms and conditions of a
 certain permit heretofore issued by the **Department of Reclamation** of the State of Idaho.

1. The name of the person or corporation holding said permit is **W. P. Strickland**

2. The postoffice address of such person or principal place of business of such corporation is **Bruneau, Ida.**
 County of **Owyhee**, State of Idaho.

3. The number of such permit is **27700**, and the date set for the completion of such work is
1/9/64

4. Said water is to be used for **irrigation** purposes.

5. Said works of diversion will be fully completed on the date set for such completion, and the amount of water
 which said works are capable of conducting to the place of intended use, in accordance with the plans accompanying
 the application for such permit, is **14** cubic feet per second.

6. The amount of lands for which said water is available is **124.0** acres, particularly described as follows:
NW 1/4, NE 1/4, W 1/4, Sec. 11, all, Sec. 2, T15S-R4E, NE 1/4, Sec. 34; SW 1/4, NW 1/4, SE 1/4, Sec. 35, T14S-R4E, B.M., Ida.

CARL E. TAPPAN

Commissioner of Reclamation

27700

Re: Permit No. 27700
W. P. Strickland

Date: November 21, 1963

Owyhee Nugget,
Marsing, Idaho.

Gentlemen:

Enclosed you will find Notice for Publication, once a week for four consecutive weeks prior to January 6, 1964 the date set for proof; the expense of the publication is to be paid by the ~~Spokane~~ Idaho Land and Appraisal Service of Box 2161, Boise, Idaho to whom you should furnish proof of publication on or prior to the date set for proof.

Please acknowledge receipt of this notice and furnish this office with a copy or tear sheet of the first publication.**

Very truly yours,

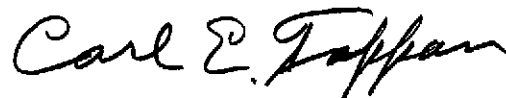

CARL E. TAPPAN
State Reclamation Engineer

** If the first copy is not received in this office for checking purposes and errors appear in subsequent issues, it is possible that re-publication of corrected copy will be at your own expense.

CET:pmk

27700

State of Idaho
DEPARTMENT OF RECLAMATION
BOISE

INSTRUCTIONS

Re: Permit No. 27700 .

PROOF OF COMPLETION OF WORKS

W. P. Strickland
Bruneau, Idaho

Boise, Idaho,

Oct. 1, 1963

Dear Sir:—

I enclose herewith blank form upon which to give notice that you are prepared and desire to submit proof of completion of works under your permit No. 27700

This form should be filled out and mailed to the Department of Reclamation, at least 60 days before the date upon which proof is to be submitted, which proof MUST be on or before Jan. 9, 1964. Upon receipt of the blank properly filled out, notice of publication will be sent to the paper direct from this office, which notice must be published a period of four weeks prior to the date of proof.

The proof may be submitted at any place convenient to you and two witnesses, where there is a notary public or other officer authorized to administer oaths.

The certificate that shall be issued under this proof does not give you a perpetual right to the use of the water for which application is made, as it only confirms the completion of the works of a capacity to divert and convey to the place of intended use a certain amount of water. The law requires that another proof be submitted when the water has been fully applied to a beneficial use, at which time license is issued for the amount of water actually in use. Information in regard to this last proof will be furnished on request.

Very truly yours,

CARL E. TAPPAN

State Reclamation Engineer

Enc. Form 8 - 11

27700

January 14, 1959

Re: Permit No. 27700
W. P. Strickland

Idaho Land & Map Service
P. O. Box 2161
Boise, Idaho

Attention: Harley M. McDowell

Dear Mr. McDowell:

We enclose Permit No. 27700, in the name of W. P. Strickland, in which we direct your attention to the limitations and conditions as given on the fourth page under approval of the State Reclamation Engineer.

We also enclose departmental receipt No. 29433, which was issued covering payment in the amount of \$3.25, for the filing fee of the above listed permit.

Very truly yours,

GEO. N. CARTER
State Reclamation Engineer
By

(Mrs.) Edna P. Rutledge
Chief Clerk

EPR/lw
Encls. (2)

27700

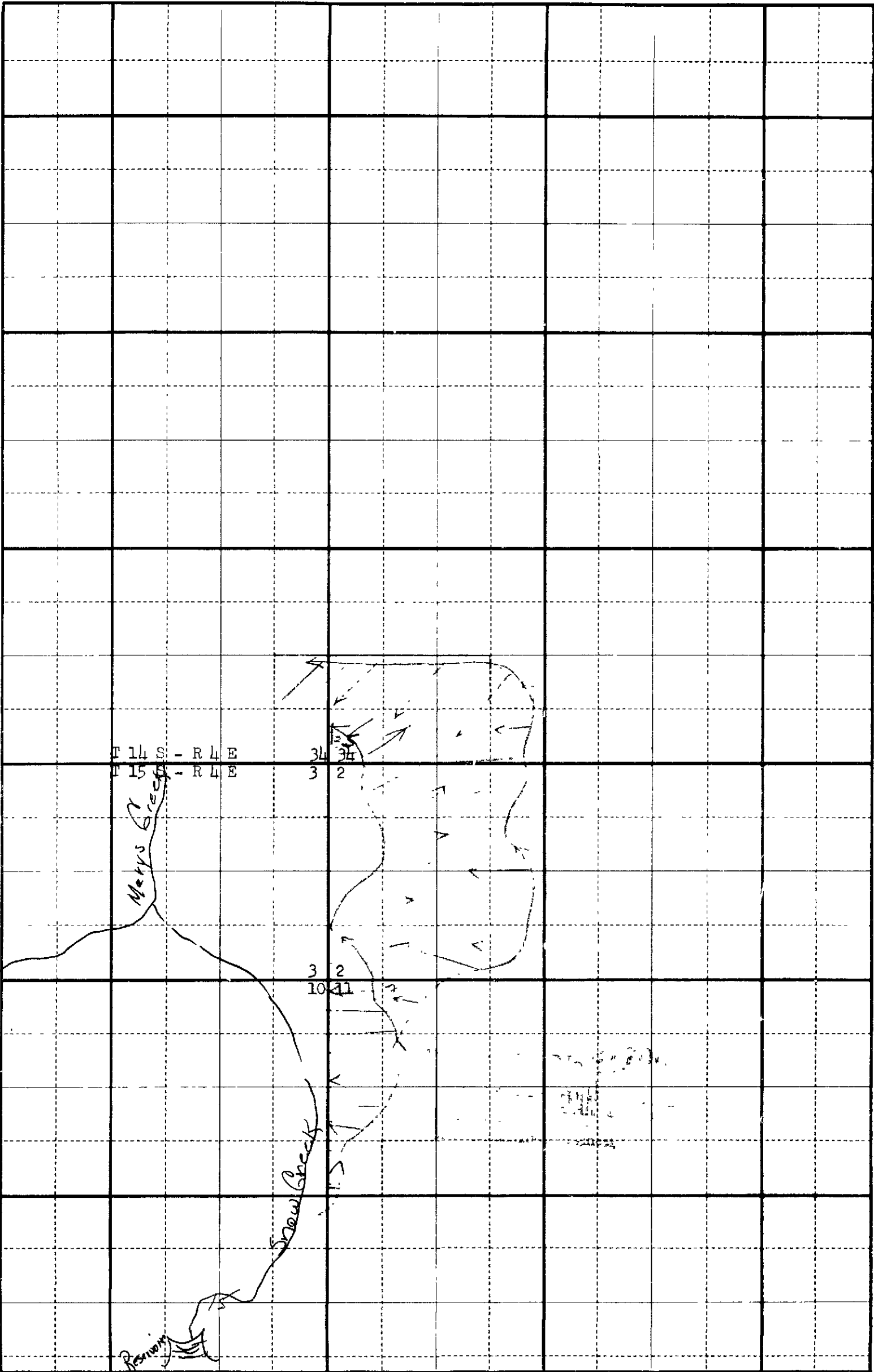

ber 21, 1963

NOTICE FOR PUBLICATION COMPLETION OF WORKS

Notice is hereby given that at 10 A. M., on the 6th day of January, 1964, at Boise, County of Ada, State of Idaho, before Joan H. Bain, 329 Idaho Bldg., Boise, Idaho, proof will be submitted of the completion of works for the diversion of 14.0 cubic feet per second of the waters of Snow Ck. in accordance with the terms and conditions of a certain permit heretofore issued by the Department of Reclamation of the State of Idaho.

1. The name of the person or corporation holding said permit is W. P. Strickland.

2. The postoffice address of such person or principal place of business of such corporation is Bruneau, Idaho, County of Owyhee, State of Idaho.

3. The number of such permit is 27700, and the date set for the completion of such work is 1/9/64.

4. Said water is to be used for irrigation.

5. Said works of diversion will be fully completed on the date set for such completion, and the amount of water which said works are capable of conducting to the place of intended use, in accordance with the plans accompanying the application for such permit, is 14 cubic feet per second.

6. The amount of lands for which said water is available is 1240 acres, particularly described as follows: NW $\frac{1}{4}$, NE $\frac{1}{4}$ -SW $\frac{1}{4}$, W $\frac{1}{2}$ SW $\frac{1}{4}$, Sec. 11; all Sec. 2, T15S - R4E. NE $\frac{1}{4}$ SE $\frac{1}{4}$, Sec. 34; SW $\frac{1}{4}$, NW $\frac{1}{4}$ SE $\frac{1}{4}$, S $\frac{1}{2}$ -SE $\frac{1}{4}$, Sec. 35, T14S - R4E., B. M., Idaho.

CARL E. TAPPAN,
State Reclamation Engineer
(Nov. 21 — Dec. 12)

777500

**NOTICE FOR PUBLICATION
NOTICE OF PROOF
APPLICATION OF WATER
TO BENEFICIAL USE**

Notice is hereby given that at 10 A. M. on the 21 day of February, 1964, at Boise, County of Ada, State of Idaho, before Joan H. Bain, proof will be submitted of the application to beneficial use of 14 cubic feet per second of the waters of Snow Ck. in accordance with the terms and conditions of Permit No. 27700 heretofore issued by the Idaho Department of Reclamation of the State of Idaho.

✓ The name and postoffice address of the person or corporation holding said permit are W. P. Strickland, Bruneau, Ida.

3 The use to which said water has been applied is irrigation.

4 The amount applied to beneficial use is 14 cfs.

5 The place where said water is used (if for irrigation, give full and accurate description of the lands irrigated) NW $\frac{1}{4}$, N $\frac{1}{2}$ -SW $\frac{1}{4}$, Sec. 11; All Sec. 2, T15S-R4E, NE $\frac{1}{4}$ SE $\frac{1}{4}$, Sec. 34; SW $\frac{1}{4}$, W $\frac{1}{2}$ SE $\frac{1}{4}$, SE $\frac{1}{4}$ SE $\frac{1}{4}$, Sec. 35, T14S - R4E.

POINT OF DIVERSION:
NE $\frac{1}{4}$ NE $\frac{1}{4}$ Sec. 15, Twp. 15 S., Rge. 4 E. B. M.

The name of the canal or ditch or other works by which said water is conducted to such place of use is private ditch.

The right to take water from such works is based upon Permit No. 27700.

The source of supply from which such water is diverted is Snow Ck.

The date of priority which said user is prepared to establish is 1/7/59.

CARL E. TAPPAN,
State Reclamation Engineer.

(Jan. 15, — Feb. 2)

27700

**NOTICE FOR PUBLICATION
NOTICE OF PROOF
APPLICATION OF WATER
TO BENEFICIAL USE**

Notice is hereby given that at 10 A. M. on the 21 day of February, 1964, at Boise, County of Ada, State of Idaho, before Joan H. Bain, proof will be submitted of the application to beneficial use of 14 cubic feet per second of the waters of Snow Ck. in accordance with the terms and conditions of Permit No. 27700 heretofore issued by the Idaho Department of Reclamation of the State of Idaho.

The name and postoffice address of the person or corporation holding said permit are W. P. Strickland, Bruneau, Ida.

The use to which said water has been applied is irrigation.

The amount applied to beneficial use is 14 cfs.

The place where said water is used (if for irrigation, give full and accurate description of the lands irrigated) NW $\frac{1}{4}$, N $\frac{1}{2}$ -SW $\frac{1}{4}$, SW $\frac{1}{4}$ SW $\frac{1}{4}$, Sec. 11; All Sec. 2, T15S, R4E. NE $\frac{1}{4}$ SE $\frac{1}{4}$, Sec. 34; SW $\frac{1}{4}$, W $\frac{1}{2}$ SE $\frac{1}{4}$, SE $\frac{1}{4}$ -SE $\frac{1}{4}$, Sec. 35, T14 S., R4E.

POINT OF DIVERSION:
NE $\frac{1}{4}$ NE $\frac{1}{4}$ Sec. 15, Twp. 15 S., Rge. 4 E. B. M.

The name of the canal or ditch or other works by which said water is conducted to such place of use is private ditch.

The right to take water from such works is based upon Permit No. 27700.

The source of supply from which such water is diverted is Snow Ck.

The date of priority which said user is prepared to establish is 1/7/59.

CARL E. TAPPAN,
State Reclamation Engineer.
(Jan. 23 — Feb. 13)

27700