

NAME OF APPLICANT

C. O. McGill # 8751

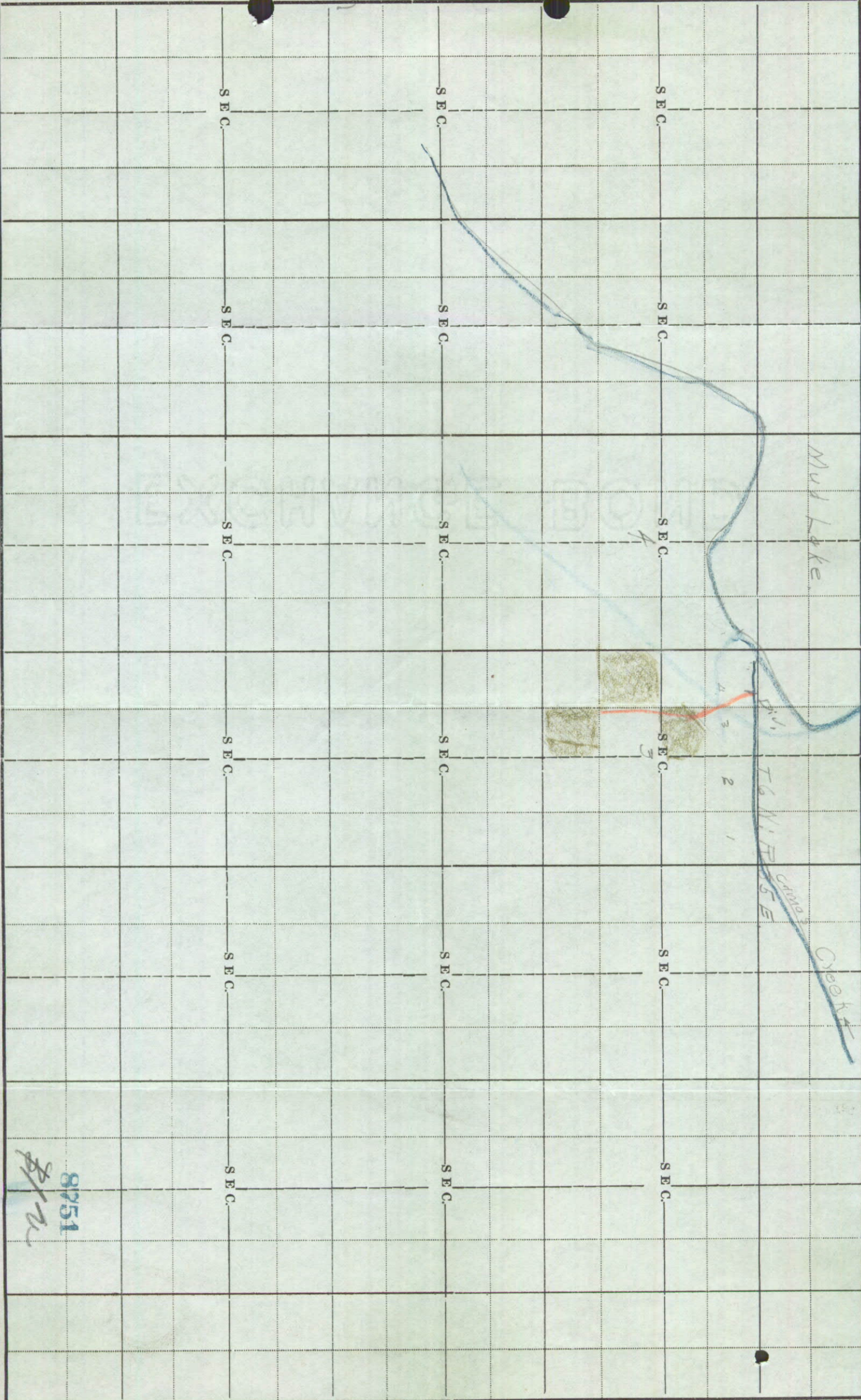



State of Idaho  
License and Certificate of Water Right

Water License No. 8751  
Water District No. 65

Amount 1.5  
Priority 9-21-1912.

THIS IS TO CERTIFY that CLARENCE O. MAGILL  
of Hamer, Idaho, made application for a permit to appropriate the  
public waters of the State of Idaho, dated September 21st, 1912; that Permit No. 8751  
was issued under said application; that Certificate of Completion of works, with a carrying capacity of 4  
second feet, was issued thereunder on September 26th, 1916, showing that said works  
were completed on the 15th day of September, 1916; and that on the 22d  
day of June, 1918, Clarence O. Magill

of Hamer, State of Idaho, made proof to the satisfaction of the  
State Engineer of Idaho, of a right to the use of the waters of Camas Creek,  
a tributary of Mud Lake, for the purpose of irrigation and domestic use,  
under Use Permit No. 8751 of the State Engineer, and that said right to the use of said  
waters has been perfected in accordance with the laws of Idaho, and is hereby confirmed by the State  
Engineer of Idaho and entered of record in Volume 5 of Licenses, at page 2336, on the 15th  
day of October, 1918;

The right hereby confirmed dates from September 21st, 1912;

The Point of Diversion is located as follows: Lot 4

~~XXXXX~~ ~~XX~~ ~~XX~~, Sec. 3, Tp. 6 N, R. 35 E., B. M.

That the amount of water to which such right is entitled and hereby confirmed, for the purposes  
aforesaid, is limited to an amount actually needed and beneficially used for said purposes, and shall not  
exceed 1.5 cubic feet per second.

Description and location of use:

Twp.	Range	Sec.	Forty-acre Tract	No. Acres Described in Permit	No. Acres Actually Irrigated
6 N	35 E	3	SW $\frac{1}{4}$ SW $\frac{1}{4}$	40	25
			NE $\frac{1}{4}$ SW $\frac{1}{4}$	40	25
			NW $\frac{1}{4}$ SW $\frac{1}{4}$	40	25

The right to the use of the water aforesaid hereby confirmed is restricted to the lands or place of  
use herein described, as provided by the laws of Idaho.

WITNESS the seal and signature of the State Engineer, affixed at Boise, Idaho, this 15th  
day of October, 1918.

FRED A. WILKIE

State Engineer.

(SEAL)

31 2101

No. 13177.

**APPLICATION FOR PERMIT**

To Appropriate the Public Waters of the State of Idaho

1. Name of applicant: Clarence O. Magill.

Postoffice address: Hamer

County: Fremont

State: Idaho.

I. If applicant is a corporation, give

(a) Date and place of incorporation:

(b) The amount of capital stock:

(c) The amount paid in:

(d) Names and addresses of directors:

II. The financial resources of the applicant are: (a) Cash on hand:

(b) Treasury stock:

(c) Bonds to be issued:

(d) Other resources:

2. The quantity of water claimed is four (4) cubic feet per second.

3. Source of water supply: Camas Creek.

4. Location of point of diversion: Lot 4, Sec. 3, Twp. 6 North, Range 35 E. B. M.

County of Fremont.

5. To be used for: Irrigation and domestic use.

I. Irrigation and domestic use: (a) Amount of land to be irrigated: Two hundred acres.

(b) In the following legal subdivisions: SE $\frac{1}{4}$  NW $\frac{1}{4}$ , and the southwest quarter all in section Three (3) Twp. 6 North, Range 35 E. B. M.

II. Mining, milling, power, manufacturing, transportation or other purposes:

[a] At what point:

[b] Amount of power to be generated:

H. P. under ft. head

[c] Is water to be returned to any stream?  
return:

(d) If so, name stream and locate point of

6. Estimated cost of works: \$1,000.00

7. Description of works for diversion:

I. Kind of works: pumping system without dam.

II. Dimensions of works:

[a] Height of dam feet, length of dam at top feet,

length of dam at bottom feet. Material used in construction:

[b] Capacity of reservoir acre feet. [c] Size of headgate, width eight feet,

Height three feet. (d) Conduit ditch width at bottom six feet,

width at water line seven feet, depth of water two feet, diameter of pipe

inches; average grade per mile is one foot. Length of conduit is  $\frac{1}{4}$  miles,  
and it crosses the following quarter sections: Northwest quarter section three Twp. 6 North,  
Range 35 E. B. M.

8. The time required for the completion of the construction of such work is three years.

9. Time required for the complete application of the water to the proposed use is one  
additional years.BE IT KNOWN That the undersigned hereby makes application for a permit to appropriate the public  
waters of the State of Idaho as herein set forth.

Clarence O. Magill,

Applicant.

By ...Bash L. Bennett..... Agent.

Date of first receipt at office of State Engineer 9.00 a.m. September 21, 1912.

Returned to applicant for correction

Corrected application received

### APPROVAL OF STATE ENGINEER.

The number of this permit is 8751.

Recorded in Book 28 Page 8751 Approved October 12, 1913.

This is to certify that I have examined the within application for a permit to appropriate the public waters of the State of Idaho, and hereby approve the same, subject to the following limitations and conditions.

Bond in the sum of to be filed on or before

Work to begin on or before December 11, 1912 and to continue diligently and uninterruptedly to completion, unless temporarily interrupted by circumstances over which permit holder has no control.

One-fifth of the work above specified to be completed on or before April 12, 1914.

The whole of said work to be completed on or before October 12, 1915.

Beneficial use of water appropriated in accordance herewith, to be made on or before October 12, 1916.

Witness my hand this 12th day of October, 1912.

A. E. Robinson,  
State Engineer.

#### Remarks:

The location of point of diversion is on homestead entry of applicant.

Upon proper request of the holders of the above numbered permit, I have this 15th day of September, 1915, extended the time for the completion of construction work thereunder, to October 12th, 1916.

J. H. Smith,

State Engineer.

Proof of Completion of Works made Sept. 15, 1916.

Certificate of Completion of Works issued Sept. 26, 1916.

Permit No. 8751.

#### CERTIFICATE OF COMPLETION OF WORKS.

To All Whom It May Concern:

This is to certify that Clarence O. Magill, of Hamer, County of Jefferson, and State of Idaho, the holder of Permit No. 8751, issued upon Application No. 13177, bearing date of priority of September 21, 1912, authorizing the diversion of four (4) second feet of the waters of Camas Creek, County of Jefferson, State of Idaho, for irrigation and domestic purposes, has fully complied with the provisions of the laws of the State of Idaho relating to the proof of completion of the works of diversion set out and described in said Permit; that said works are adequate for diverting and conveying to the place of intended use four (4) second feet of the waters of Camas Creek; that the point of diversion of said waters is in Lot 4, Sec. 3, T. 6 N., R. 35 E., B. M., and that the lands proposed to be irrigated by the use of said water are described as follows, to-wit: 200 acres in the SE $\frac{1}{4}$  of NW $\frac{1}{4}$  and the SW $\frac{1}{4}$  of Sec. 3, T. 6 N., R. 35 E., B. M.

Witness my hand this 25th day of September, A. D. 1916.

License issued for 1.5 second feet  
Page 2336

J. H. SMITH,  
State Engineer of the State of Idaho.

#### EXTENSION OF TIME

Upon proper request of Clarence O. Magill, holder of Permit No. 8751, I have, this 27th day of August, 1917 extended the time for beneficial use of water thereunder to the 13th day of October, 1919.

Recorded by

Checked by

J. H. SMITH,  
State Engineer.

# REPORT OF ENGINEER

This proof is for beneficial useIn Water District No. 65

1. State name of applicant and number of permit: C. O. Magill, Permit: 8751
2. State source of water supply: Camas Creek.
3. Location of point of diversion: Lot 4, Sec. 3, Twp. 6 N., R. 35 E. B. M.
4. Describe works as they exist, giving dimensions and capacities of same:
 

10" Cent. pump. 25 H.P. Elec. Motor. 6' Lift.

Ditch, 8' B. 1.5 D. Cap. 10 sec. ft.
5. State whether or not water has been turned into works of diversion: Yes.
6. Give exact location of lands to be irrigated. If proof is for beneficial use, give exact number of acres under cultivation in each forty-acre tract. (Describe manner and place of use if for other than irrigation): SE $\frac{1}{4}$ NW $\frac{1}{4}$ , SE $\frac{1}{4}$ SW $\frac{1}{4}$ , NW $\frac{1}{4}$ SW $\frac{1}{4}$ , Sec. 3, Twp. 6 N., R. 35 E. B. M.
7. Submit map on enclosed plat, showing location and details of above description.
8. How many parties conduct water in this system? One.
9. Give names and amount of each right: C.O. Magill. with two permits, -  
# 8751 and 7244
10. What large stream would the water here appropriated finally reach? Mud Lake.
11. Describe the various tributaries en route, from point of diversion to the principal drainage stream:

Remarks: 100 A. cult. 20 A. pasture.This examination was made on the 28 day of Apr. 19 20.

(Signed)

*L. R. Annett.*  
 L. R. Annett.

8751

Examiner.

Dist: 65

C. O. McGill  
Hemer  
Permit: 8751

3-67-35E

Instructions to Examiners

1. Examiners will not be permitted to examine any of the receipts in the office pertaining to this permit. They are to furnish a report of the facts and conditions as they exist, from their own observations and inquiries.
2. Always carefully note the location of the point of diversion, and accurately plat same.
3. Find out how many parties own right in the ditch or canal and give their names and amount of right.
4. When proof is for beneficial use, carefully check up the number of acres actually irrigated in each forty and accurately plat same.
5. Make a map showing the correct location of streams and ditches, and the irrigated lands, and any adjacent permanent landmarks, such as towns, lakes, large streams and public roads.
6. If any unusual conditions are discovered, make a plain statement of them under re-marks.
7. Always see the holder, if possible, and go over the whole ground with him, and make your report only upon actual existing facts and conditions.

(This report must be sworn to when not made by an attache of the office.)

STATE OF IDAHO,

ss. }  
County of.....

....., being first duly sworn, deposes and says that the statements contained in the within report are correct to the best of his knowledge and belief.  
Subscribed and sworn to before me this..... day of..... 19.....

My commission expires.....  
Notary Public.....

NAME OF APPLICANT C. C. Magill # 8751

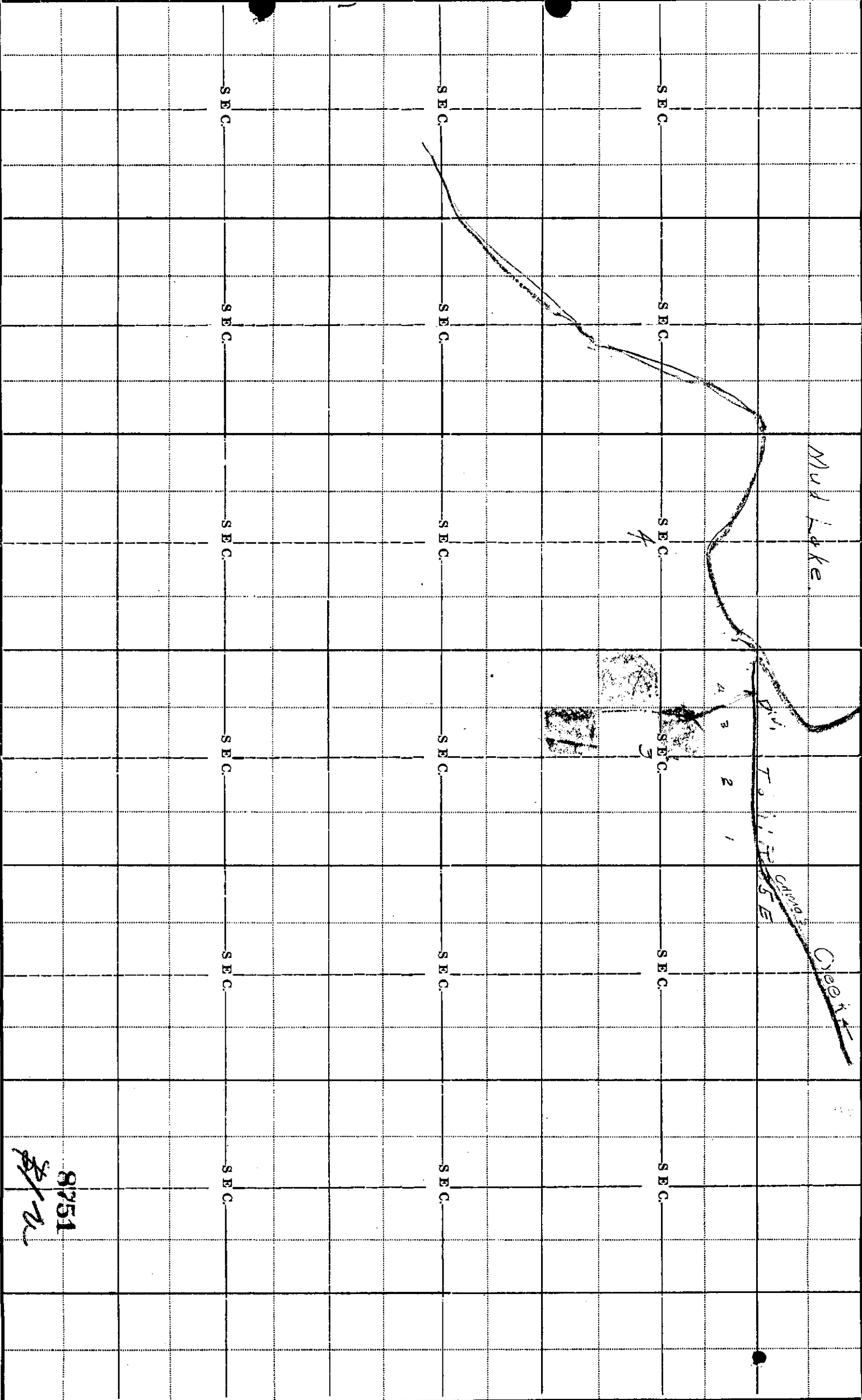

SCALE: 2 INCHES=1 MILE. DRAW PLAN IN INK.