

10662

State of Idaho

License and Certificate of Water Right

Water License No. 10662

Amount 0.7 sec. ft.

Water District No. 65

Priority 11-13-14

THIS IS TO CERTIFY that G. Ouldhouse of Rocker, Montana and Virgil Green of Whitefish, Montana, made application for a permit to appropriate the public waters of the State of Idaho, dated September 18, 1914; that Permit No. 10662 was issued under said application; that Certificate of Completion of works, with a carrying capacity of 6.4 second feet, was issued thereunder on December 14, 1918, showing that said works were completed on the 18th day of November, 1918; and that on the 15th day of December, 1921,

Gerrett Ouldhouse

of Rigby, State of Idaho, made proof to the satisfaction of the Commissioner of Reclamation of Idaho, of the right to use the waters of Mud Lake, a tributary of -----, for the purpose of irrigation & domestic, under Use Permit No. 10662 of the State Engineer and that said right to the use of said waters has been perfected in accordance with the laws of Idaho, and is hereby confirmed by the Commissioner of Reclamation of Idaho and entered of record in Volume 6 of Licenses, at page 2911, on the 23d day of January, 1922;

The right hereby confirmed dates from November 13, 1914;

The Point of Diversion is located in the SE $\frac{1}{4}$ NW $\frac{1}{4}$, Sec. 9, Tp. 7 N., R. 34 E., B. M. County of Jefferson

That the amount of water to which such right is entitled and hereby confirmed, for the purposes aforesaid, is limited to an amount actually needed and beneficially used for said purposes, and shall not exceed 0.7 cubic feet per second.

Description and location of use:

Twp.	Range	Sec.	Forty-acre Tract	No. Acres Described in Permit	No. Acres Actually Irrigated
7 N.	33 E.	12	NE $\frac{1}{4}$ SE $\frac{1}{4}$	40	35
			NW $\frac{1}{4}$ SE $\frac{1}{4}$	40	--
			SW $\frac{1}{4}$ SE $\frac{1}{4}$	40	--
			SE $\frac{1}{4}$ SE $\frac{1}{4}$	40	--
		13	NE $\frac{1}{4}$ NE $\frac{1}{4}$	40	--
			NW $\frac{1}{4}$ NE $\frac{1}{4}$	40	--
			SW $\frac{1}{4}$ NE $\frac{1}{4}$	40	--
			SE $\frac{1}{4}$ NE $\frac{1}{4}$	40	--

The right to the use of the water aforesaid hereby confirmed is restricted to the lands or place of use herein described, as provided by the laws of Idaho.

WITNESS the seal and signature of the Commissioner of Reclamation, affixed at Boise, Idaho, this 23d day of January, 1922.

W. G. SWENDSEN.

Commissioner of Reclamation.

(SEAL)

State of Idaho

License and Certificate of Water Right

Water License No. 10260
 Water District No. 12-H

Amount 0.3 sec. ft.
 Priority 6-28-15

THIS IS TO CERTIFY that **WILLIAM HOWELL**
 of **Boise, Idaho**, made application for a permit to appropriate the
 public waters of the State of Idaho, dated **April 5**, 19 **14**; that Permit No. 10260
 was issued under said application; that Certificate of Completion of works, with a carrying capacity of
3 second feet, was issued thereunder on **June 14**, 19**16**, showing that said works
 were completed on the 6th day of **June**, 19**16**; and that on the 1st
 day of **September**, 19**19**,

William Howell

of **Boise**, State of **Idaho**, made proof to the satisfaction of the
 Commissioner of Reclamation of Idaho, of the right to use the waters of **Timber Gulch**
Creek, a tributary of **So. Fk. Boise River**, for the purpose of irrigation &
 domestic use, under Use Permit No. 10260 of the **State Engineer**
 and that said right to the use of said waters has been perfected in accordance with the laws of
 Idaho, and is hereby confirmed by the Commissioner of Reclamation of Idaho and entered of record in
 Volume **6** of Licenses, at page 2912, on the 30th day of **January**, 19**22**;

The right hereby confirmed dates from **June 28**, 19**15**;

The Point of Diversion is located
 in the **SW ¼ SW ¼**, Sec. **5**, Tp. **1 N.**, R. **7 E.**, B. M. **County of Elmore.**

That the amount of water to which such right is entitled and hereby confirmed, for the purposes
 aforesaid, is limited to an amount actually needed and beneficially used for said purposes, and shall not
 exceed **0.3** cubic feet per second.

Description and location of use:

Twp.	Range	Sec.	Forty-acre Tract	No. Acres Described in Permit	No. Acres Actually Irrigated
1 N.	7 E.	5	$E\frac{1}{2} E\frac{1}{2} NW\frac{1}{4}$ $NW\frac{1}{4} NE\frac{1}{4} NW\frac{1}{4}$ $W\frac{1}{2} W\frac{1}{2} NE\frac{1}{4}$ $NE\frac{1}{4} NW\frac{1}{4} EE\frac{1}{4}$ $W\frac{1}{2} NW\frac{1}{4} SE\frac{1}{4}$ $NW\frac{1}{4} SW\frac{1}{4} SE\frac{1}{4}$ $E\frac{1}{2} SW\frac{1}{4} SW\frac{1}{4}$ $W\frac{1}{2} SE\frac{1}{4} SW\frac{1}{4}$ $NE\frac{1}{4} SE\frac{1}{4} SW\frac{1}{4}$	160	13 2

The right to the use of the water aforesaid hereby confirmed is restricted to the lands or place of
 use herein described, as provided by the laws of Idaho.

WITNESS the seal and signature of the Commissioner of Reclamation, affixed at Boise, Idaho,
 this 30th day of **January**, 19 **22**.

W. G. SWENDSEN
 Commissioner of Reclamation.

(SEAL)

No. 15688

APPLICATION FOR PERMIT

To Appropriate the Public Waters of the State of Idaho

1. Name of applicant: G. Oldhouse, Rucker, Montana, Virgil Green, Whitefish, Montana

Postoffice address:

County:

State:

- I. If applicant is a corporation, give
 (a) Date and place of incorporation;
 (b) The amount of capital stock;
 (c) The amount paid in;
 (d) Names and addresses of directors.

- II. The financial resources of the applicant are: (a) Cash on hand;
 (b) Treasury stock; (c) Bonds to be issued;
 (d) Other resources.

2. The quantity of water claimed is Six and four tenths cubic feet per second.

3. Source of water supply: Mud Lake

4. Location of point of diversion: NW $\frac{1}{4}$: Sec. 16, T.7 N.R.34 E.B.M.

County of Jefferson

5. To be used for: Irrigation and domestic use.

- I. Irrigation and domestic use: (a) Amount of land to be irrigated: 320 acres.
 (b) In the following legal subdivisions: NE $\frac{1}{4}$: SE $\frac{1}{4}$: section 12 in township 7 North
 Range 33 E.B.M.

II. Mining, milling, power, manufacturing, transportation or other purposes:

[a] At what point:

[b] Amount of power to be generated:

H. P. under

ft. head

[c] Is water to be returned to any stream?
return:

[d] If so, name stream and locate point of

6. Estimated cost of works: \$1500.00

7. Description of works for diversion:

I. Kind of works: dam and ditch

II. Dimensions of works:

[a] Height of dam 4 feet, length of dam at top 680 feet,

length of dam at bottom 650 feet. Material used in construction: earth

[b] Capacity of reservoir acre feet. (c) Size of headgate, width 5 feet;

Height 4 feet. (d) Conduit ditch width at bottom 5 feet,

width at water line 6 feet, depth of water one feet; diameter of pipe

inches; average grade per mile is 1 feet. Length of conduit is 2 $\frac{1}{4}$ miles,and it crosses the following quarter sections: NE $\frac{1}{4}$:NW $\frac{1}{4}$:sec.17-NE $\frac{1}{4}$:NW $\frac{1}{4}$: sec.18 in township
7 North Range 34.

8. The time required for the completion of the construction of such work is four years.

9. Time required for the complete application of the water to the proposed use is one
additional years.BE IT KNOWN That the undersigned hereby makes application for a permit to appropriate the public
waters of the State of Idaho as herein set forth.

Virgil Green, G. Oldhouse

Applicant.

By Bash L. Bennett

Agent.

Date of first receipt at office of State Engineer 9.00 A. M. September 18, 1914.

Returned to applicant for correction

Corrected application received

APPROVAL OF STATE ENGINEER

The number of this permit is 10662

Recorded in Book 36 Page 10662 Approved October 20, 1914.

This is to certify that I have examined the within application for a permit to appropriate the public waters of the State of Idaho, and hereby approve the same, subject to the following limitations and conditions.

Bond in the sum of to be filed on or before

Work to begin on or before December 19, 1914 and to continue diligently and uninterruptedly to completion, unless temporarily interrupted by circumstances over which permit holder has no control.

One-fifth of the work above specified to be completed on or before October 20, 1916.

The whole of said work to be completed on or before October 20, 1918.

Beneficial use of water appropriated in accordance herewith, to be made on or before October 20, 1919

Witness my hand this 20th day of October, 1914.

Herbert Wing,

Acting State Engineer.

Remarks: Mud Lake is over 5 acres in extent and the point of diversion is upon non patented land no filings made upon it.

STATE OF IDHO :
:ss.
COUNTY OF JEFFERSON.:

G. Oldhouse and Virgil Green being first duly sworn, upon his oath, deposes and says:

That he is the owner of a decreed water right appurtenant to the following described land, to-wit: The SE4 section 12, and the NE4, Section 13, all in township Seven North, Range 33 East, Boise Meridian, as evidenced by the permit dated October 20th, 1914; that he is the owner and holder of Permit to appropriate the Public Waters of the State of Idaho, No. 10662.

That he intends to change the point of diversion as described in said permit, to the following described point:

The point of diversion mentioned in said permit is NW4 NW4, Sec. 16, Twp. 7 N. R. 34, and he desires that the point of diversion be changed to the SE4NW4, Sec. 9 Twp. 7 N., R. 34 E. BM.

That such change will be made for the following reasons, to-wit:

That the point of diversion gives a better fall to the ditch, and the point of diversion is in a better place for a head gate and is more desirable for the above reason, applicant being enabled to go in with other parties and use the same point to better advantage.

That no one will be injured by such change and that deponent will make such change at his own risk.

And farther deponent saith not.

G. Oldhouse.
Virgil Green.

Subscribed and sworn to before me this ^{thirtieth} ~~fourth~~ day of December, 1915.

Bash L. Bennett.

My commission expires Nov. 9, 1918.

Received and file for record in the office the State Engineer, at Boise, Idaho,

Recorded by 9:00 A.M. Dec. 31, 1915. - - - J.H. Smith, State Engineer.

Checked by

APPLICATION FOR AMENDMENT
TO PERMIT TO APPROPRIATE THE PUBLIC WATERS
OF THE STATE OF IDAHO, NO. 10662.

Comes now G. Ouldhouse and Virgil Green and represents to the State Engineer of the State of Idaho,

That he is the owner and holder of Permit to appropriate the Public Waters of the State of Idaho, No. 10662, and requests that the list of lands to be irrigated as described in said permit, be changed to read as follows:

The southeast quarter (SE4) of section twelve, and the Northeast quarter (NE4) of section thirteen (13) all in Twp. 7, North, Range 33, East Boise Meridian in Jefferson County, Idaho, making a total of 320 acres.

That an additional amount of water is not asked for, and that the rights of others will not be adversely affected by such change.

Signed at Roberts, Idaho, this 30th day of December, 1915.

G. Ouldhouse,

Virgle Green.

APPROVAL OF STATE ENGINEER.

I, J. H. Smith, State Engineer of the State of Idaho, hereby approve the above and foregoing application for amendment to Permit to appropriate the Public Waters of the State of Idaho, No. 10662. This approval constitutes a new permit and is issued as an amendment to the original permit, to which it refers and of which it becomes a part, and said application is approved only insofar as the rights of others will not be adversely affected thereby.

Witness my hand this 3rd day of January, 1916.

J. H. Smith,

State Engineer.

Proof of Completion of Works made November 18, 1918.
Certificate of Completion of Works issued December 14, 1918.

To All Whom It May Concern: Permit No. 10662.

This is to certify that G. Oldhouse and Virgil Green, of Anaconda, County of and State of Montana, the holders of Permit No. 10662, issued upon Application No. 15688, bearing date of priority of September 18, 1914, authorizing the diversion of 6.4 second feet of the waters of Mud Lake, County of Jefferson, State of Idaho, for irrigation and domestic purposes, have fully complied with the provisions of the laws of the State of Idaho relating to the proof of completion of the works of diversion set out and described in said Permit; that said works are adequate for diverting and conveying to the place of intended use 6.4 second feet of the waters of Mud Lake; that the point of diversion of said waters is in the SE $\frac{1}{4}$ NW $\frac{1}{4}$ Sec. 16, T. 7 N., R. 34 E., B.M., and that the lands proposed to be irrigated by the use of said water are described as follows, to-wit: SE $\frac{1}{4}$ Sec. 12, and NE $\frac{1}{4}$ Sec. 13, in T. 7 N., R. 33 E., B.M.

Witness my hand this 14th day of December, A. D. 1918.

FRED A. WILKIE,
State Engineer of the State of Idaho.

Upon proper request of the holder of the above numbered permit, I have this 12th day of December, 1919, extended the time for beneficial use of water thereunder to the 20th day of October, 1920.

W. G. SWENDSEN,
Commissioner of Reclamation,
By S. T. Baer, Deputy.

EXTENSION OF TIME

Upon proper request of the holder of the above numbered permit, I have this 11th day of October, 1920, extended the time for proof of Beneficial Use to the 20th day of October, 1921.

W. G. Swendsen,
Commissioner of Reclamation.
By: S. T. Baer.
Deputy.

License issued for 0.7 second feet

Page 2911

Jan. 30, 1922.

Re License 10662

Mr. G. Ouldhouse,
Rigby, Idaho.

Dear Sir:-

We wish to acknowledge our mistake in recording the above numbered license. We have remised the same and trust you will find us correct.

Thanking you for calling our attention to this oversight, we wish to remain,

Very truly yours,

W. G. SWENDSEN,

Commissioner of Reclamation

By

10662

Permit 10662. Pelly Ida.
Jan 27-1922

State Engineer

Dear Sirs.

Place of use. The License should
read The N.E. $\frac{1}{4}$ of S.E. $\frac{1}{4}$ of section 12, instead
of S.E. $\frac{1}{4}$ N.E. $\frac{1}{4}$ sec 13 Twp 7 N. R 33, E. B. M.
I am enclosing this License for correction
and obliged

G Bellhouse
P F I No 3.

Pelly
Ida.

10662

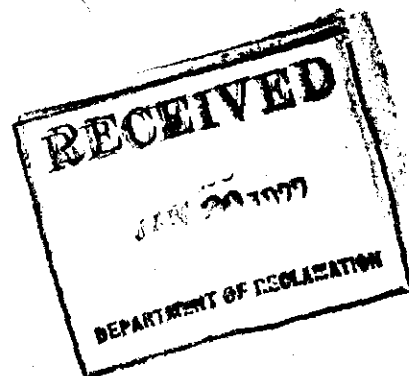



D. W. DAVIS, GOVERNOR

STATE OF IDAHO
DEPARTMENT OF RECLAMATION
W. G. SWENDSEN, COMMISSIONER
BOISE

BUREAU OF WATER RESOURCES
WATER APPROPRIATIONS
CAREY ACT DEVELOPMENT

January 24, 1922.

RE: Permit 10662.

Mr. G. Ouldhouse,
Rigby, Idaho.

Dear Sir:

We inclose herewith Water License, issued
under the above numbered Permit, together with re-
ceipt for fees.

Very truly yours,

W. G. SWENDSEN,
Commissioner of Reclamation

By *C. Brown*,
Chief Clerk.

Encls.

January 24, 1922.

Re: Permit 10662.

Mr. G. Ouldhouse,
Rigby, Idaho.

Dear Sir:

We inclose herewith Water License, issued
under the above numbered Permit, together with re-
ceipt for fees.

Very truly yours,

W. G. SWENDSEN,
Commissioner of Reclamation

Encls.

By

Chief Clerk.

10662

P.O. Box 10662

W. G. Swendsen
Dear Sir.

Enclosed here
with kind two dollars
for license to navigate 35
acres and obliged.

Yours Truly
G. H. Guldhouse.
Regly.

Ida.
R.F.L. no 3.



D. W. DAVIS, GOVERNOR

STATE OF IDAHO
DEPARTMENT OF RECLAMATION

W. G. SWENDSEN, COMMISSIONER

BOISE

BUREAU OF WATER RESOURCES
WATER APPROPRIATIONS
CAREY ACT DEVELOPMENT

December 28, 1921.

Re: Permit No. 10662.

Mr. Gerrett Ouldhouse,
Rigby, Idaho.

Dear Sir:-

In checking the report of the examining engineer on proof of use of water under the above permit I find that you have 35 acres cultivated and irrigated in the NE $\frac{1}{4}$ of SE $\frac{1}{4}$ of Sec. 12-7N-33E., but that the rest of your land under this permit has not been cultivated and irrigated. The fees will, therefore, amount to only \$2.00 and, upon receipt of same, license will issue for this 35 acres, allowing an inch to the acre.

Very truly yours,

W. G. SWENDSEN,

Commissioner of Reclamation.

By J. Brown
Chief Clerk.

This is all right. goahead and secure your license for the 35 acres, then goahead and make necessary improvements and you can prove up any time on balance and secure balance of water for the 160 acres, keeping you date of priority same as present.

Very truly

Barth R. Bennett

10662

December 28, 1921.

Re: Permit No. 10662

Mr. Gerrett Ouldhouse,
Rigby, Idaho.

Dear Sir:-

In checking the report of the examining engineer on proof of use of water under the above permit I find that you have 35 acres cultivated and irrigated in the NE $\frac{1}{4}$ of SE $\frac{1}{4}$ of Sec. 12-7T-33E., but that the rest of your land under this permit has not been cultivated and irrigated. The fees will, therefore, amount to only \$2.00 and, upon receipt of same, license will issue for this 35 acres, allowing an inch to the acre.

Very truly yours,

W. G. SWENDSEN,

Commissioner of Reclamation.

By _____
Chief Clerk.

10662

Hamer, Idaho, Dec. 19, 1921.

Mr. W. G. Swendsen,
Commissioner of Reclamation,
Boise, Idaho.

Dear Sir:-

In the matter of Permit 10662-G Ouldhouse,
I have to say the acreage shown in my report as irrigated
is the total amount water^{ed}, namely 30 acres, and this is
liberal on my part.

If any further acreage was ever wetted it was due
to excessive floods and the acreage shown being drowned in
the process, as there is no natural meadow, the portion
unirrigated consisting of small sand dunes with no ditches
serving it. I gave the extra five acres in the one forty to
take care of any slopping over, so to speak, that occurs
when the cultivated area is irrigated, and I believe this to
be too liberal. The evidence is that water is pretty scant
for the 30@.

I could not change my showing of 35@ of irrigated
land.

Very truly,

Elmer W. Henninger

10662

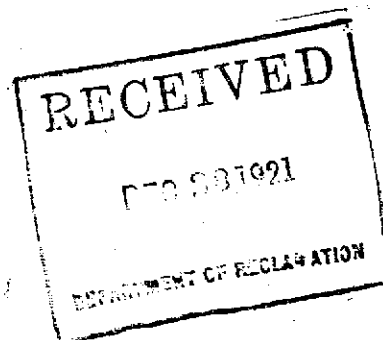

December 17, 1921.

Re: Permit 10662-G. Ouldhouse.

Mr. Elvin W. Henninger.
Hamer, Idaho.

Dear Sir:

The depositions filed in the matter of proof of beneficial use of water by Mr. Ouldhouse and two witnesses, show thirty acres under cultivation and the balance of the land irrigated as natural meadow for pasture.

Your report gives thirty-five acres only in one forty with no mention of irrigation for the balance of the land. Can you from your notes make a supplemental report showing the balance of the land irrigated as natural meadow for pasture purposes, if you found such to be the case?

No action will be taken in regard to this proof until we hear from you further in this matter.

Very truly yours,

W. G. SWENDSEN,
Commissioner of Reclamation

CB/E

By _____
Chief Clerk.

10662

December 17, 1921.

Re: Permit 10662-G.Oulthouse.

Mr. Bash L. Bennett,
Rigby, Idaho.

Dear Sir:

We are to-day in receipt of your letter of the 15th inst., inclosing depositions and affidavit of publication for proof of beneficial use of water under the above numbered Permit.

Very truly yours,

W. G. SWENDSEN,
Commissioner of Reclamation

CB/E

By
Chief Clerk.

10662

OFFICE OF
BASH L. BENNETT
UNITED STATES COMMISSIONER
RIGBY, IDAHO

December 15th.
1921.

Hon. W.G. Swendsen,

Boise, Idaho.

Dear sir;

I enclose you depositions in the matter of final proof water permit #10662 Gerret Ouldhouse, and trust same will be found in order.

Will you kindly acknowledge receipt of same and oblige,

Yours very truly,

Bash L. Bennett

10662

Affidavit of Publication

STATE OF IDAHO,

County of Jefferson,

} ss.

I, R. I. Jones, do solemnly swear that I am the manager of THE RIGBY STAR, a weekly newspaper of general circulation, published once each week at Rigby, Jefferson County, Idaho; that the notice attached hereto and which is a part of this affidavit, and a part of the proof of publication was published in said newspaper four consecutive weeks; first publication having been made on the 10th day of November, 1921; that said notice was published in the regular and entire issue of every number of the paper during the period and times of publication, and that the notice was published in the newspaper and not in a supplement; that said Rigby Star was published continuously and without interruption for more than 78 weeks prior to the first publication of this notice.

Subscribed and sworn to before me this 15th day of December, A. D., 1921.

NOTICE FOR PUBLICATION. NOTICE OF PROOF OF APPLICATION OF WATER TO BENEFICIAL USE.

Notice is Hereby Given that 10 a. m. on the 15th day of December, 1921, at Rigby, county of Jefferson, state of Idaho, before Bash L. Bennett, a Notary Public, proof will be submitted of the application to beneficial use of 3.2 cubic feet per second of the waters of Mud Lake in accordance with the terms and conditions of Permit No. 10662 heretofore issued by the State Engineer of the State of Idaho.

The name and postoffice address of the persons or corporation holding said permit are Gerrett Ouldhouse, and Virgil Green, Rigby, Idaho.

The use to which said water has been applied is irrigation and domestic purposes.

The amount applied to beneficial use is 3.2 cubic feet per second.

The place where said water is used (if for irrigation, give full and accurate description of the lands irrigated) Southeast quarter (SE $\frac{1}{4}$) of Section 12, in Township 7 North, Range 33, East Boise Meridian.

The date of the priority which said user is prepared to establish is October 20th, 1914.

W. G. SWENDSEN,
Commissioner of Reclamation.

(48-51)

Notary Public for Idaho.
Residing at Rigby, Idaho.

My commission expires Nov. 9th, 1922.

10662

PERMIT NO. 10662

Proof of Application of Water to Beneficial Use

Deposition of Holder

Ques. 1. State your name, age, residence, occupation and postoffice address.

Ans. Gerrett Ouldhouse, aged 32, Rigby, 3, Idaho, farmer, Rigby-3, Idaho.

Ques. 2. If acting in behalf of corporation, state its name, principal place of business (if a foreign corporation, give name of postoffice of statutory agent), your position with reference to same, and your authority for appearing in its behalf.

Ans. No.

Ques. 3. State number and date of permit, and date of priority you propose to establish under the permit.

Ans. 10662, October 20th, 1914. October 20th, 1914.

Ques. 4. State source of water supply and give exact location of point of diversion.

Ans. Mud Lake NW 1/4 NW 1/4, section 16, Twp. 7 North R. 34 E.B.M.

Ques. 5. Describe your works of diversion, and state amount of water they are capable of conveying from point of diversion to place of use, and give name of canal or ditch or other works by which water is conducted to such place of use.

Ans. Ditch is 14 ft at bottom and 3 ft deep. will carry 10 cubic feet per second.

Ques. 6. State for what purpost water is used and describe place of use. (If for irrigation, name each subdivision in which used, and number of acres in each subdivision that have actually been irrigated with said water.) State whether cultivate or natural meadow land and the nature of all improvement which have been made as a direct result of said use.

Ans. Irrigation purposes. Have irrigated about 30 acres of cultivated land, and balance has been irrigated as natural meadow, at high water time from Mud Lake. All on the Southeast quarter of section 12, Township 7 North Range 33 East Boise Meridian.

Ques. 7. If for other than for irrigation purposes, state how applied, amount of horse power generated, etc.

Ans. No

Ques. 8. What is the minimum amount of water required for the specified above?

Ans. Will require at least one miners inch per acre.

Ques. 9. If you are not the person or representative of the corporation to whom above mentioned permit was originally issued, please state how ownership was acquired by present holder.

Ans. I am the original applicant.

10662

Ques. 10. State when, how, in what amount and to what extent the water diverted under above mentioned permit has been used.

Ans. In 1915 in April, used 300 miners inches, used every year since.

Ques. 11. State when, how, in what amount and to what extent waters other than those diverted under the above mentioned permit have been diverted and applied to beneficial use upon the lands herein described. Give full particulars regarding such other appropriations and right claimed thereunder.

Ans. None used except under terms of permit.

(Sign)

Gerritt C. Culhouse

I hereby certify that the foregoing testimony was read to the above subscribed before its signing, that I believe him to be the person he represents himself to be, and that said testimony was subscribed and sworn to before me, at my office in Rigby County of Jefferson State of Idaho, on this 15th day of December A. D. 1921

Walter R. Bennett

Notary Public for Idaho.
Residing at Rigby, Idaho.

My commission expires Nov. 9th, 1922.

10662

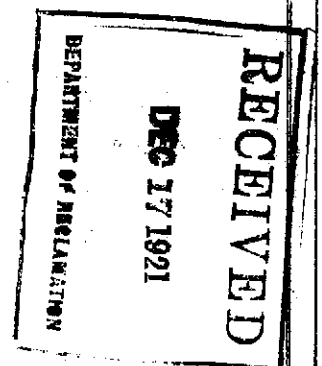

Permit No. 10662

Proof of Application of Water to Beneficial Use

DEPOSITION OF WITNESS

Ques. 1. State your name, age, residence, occupation and postoffice address,

Ans. Walter L. Hicks, aged 32, Rigby, farmer, Rigby Idaho Falls—5th, Idaho.

Ques. 2. Are you acquainted with Gerrett Ouldhouse, the holder of Permit No. 10662? How long have you known him and where does he reside?

Ans. Yes, known him since in 1915, he now resides at Rigby—5th, Idaho.
Formerly lived at Mud Lake.

Ques. 3. Have you read or heard read said Permit No. 10662, and are you familiar with its provisions and conditions?

Ans. Yes sir.

Ques. 4. State source of water supply, place of diversion, and describe works for conveying water from point of diversion to place of use.

Ans. Mud Lake, ditch 14 ft. at bottom and 3 ft. deep.
Place of diversion is in the NW¹/₄ NW¹/₄ section 16th, Twp. 7 North Range 34, E.B.M.

Ques. 5. How many second feet of water do you estimate said works will safely conduct to place of use, and how much water have you seen being so conveyed?

Ans. Will carry possibly 10 cubic feet per second or 500 miners inches.

Ques. 6. State for what purpose water is used and at what place. (If for irrigation, give each subdivision in which water has been used and number of acres irrigated in each subdivision.) State whether cultivated or natural meadow land and the nature of all improvements which have been made as a direct result of said use.

Ans. Irrigation purposes, there is 30 acres irrigated as cultivated lands balance natural meadow, land is in good shape for agricultural pursuits.

Ques. 7. If for power or other purposes than irrigation, state how water has been applied and to what extent.

Ans. No sir.

Ques. 8. (If for irrigation) state character of land that has been reclaimed, and give your estimate of the amount of water required for its profitable cultivation.

Ans. Sandy loam soil, some sand ridges, will require anyhow 1 miners inch per acre.

10662

Ques. 9. Have you any interest in the works, water or lands above mentioned? If so, in what way and to what extent?

Ans. ~~No sir, none.~~

Ques. 10. State when, how, in what amount and to what extent you have witnessed the application to beneficial use of water diverted under said permit.

Ans. In the spring of 1915, applicant used about 300 miners inches, I was living near near this property then.

(Sign) Walter L. Hicks

I hereby certify that the foregoing testimony was read to the above subscriber before its signing, that I believe him to be the person he represents himself to be, and that said testimony was subscribed and sworn to before me in Rigby, County of Jefferson, State of Idaho, on this 15th day of December A. D. 1921.

Bash L. Garner
Notary Public.
Residing at Rigby, Idaho For Idaho.

My commission expires Nov. 9th, 1922.

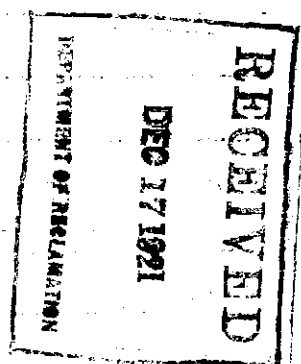

Permit No. 10662

Proof of Application of Water to Beneficial Use**DEPOSITION OF WITNESS**

Ques. 1. State your name, age, residence, occupation and postoffice address,

Ans. ~~Jesse Gardiner~~ Gardiner, aged 57, farmer, Rigby-3, Idaho.

Ques. 2. Are you acquainted with Gerritt Ouldhouse, the holder of Permit No. 10662? How long have you known him and where does he reside?

Ans. Yes, known him over 7 years, resides now at Rigby 3 Idaho, used to live at Mud Lake,

Ques. 3. Have you read or heard read said Permit No. 10662, and are you familiar with its provisions and conditions?

Ans. Yes sir.

Ques. 4. State source of water supply, place of diversion, and describe works for conveying water from point of diversion to place of use.

Ans. Mud Lake, has a ditch 14 ft. at bottom and about 3 ft. deep.

NW¹ NW¹: section 16, Twp. 7 North Range 34 E.B.M is point of diversion.

Ques. 5. How many second feet of water do you estimate said works will safely conduct to place of use, and how much water have you seen being so conveyed?

Ans. About 10 cubic feet per second. About that amount.

Ques. 6. State for what purpose water is used and at what place. (If for irrigation, give each subdivision in which water has been used and number of acres irrigated in each subdivision.) State whether cultivated or natural meadow land and the nature of all improvements which have been made as a direct result of said use.

Ans. Irrigation purposes, on the SE¹: section 12, Twp. 7 North Range 33 E.B.M. 30 acres was irrigated as cultivated lands and balance of entry, except sand ridges was irrigated as natural meadow, at high water. Used about 500 miners inches at each irrigation.

Ques. 7. If for power or other purposes than irrigation, state how water has been applied and to what extent.

Ans. No.

Ques. 8. (If for irrigation) state character of land that has been reclaimed, and give your estimate of the amount of water required for its profitable cultivation.

Ans. Land is sandy loam soil, will require at least one miners inch per acre.

Ques. 9. Have you any interest in the works, water or lands above mentioned? If so, in what way and to what extent?

Ans. No sir, none.

Ques. 10. State when, how, in what amount and to what extent you have witnessed the application to beneficial use of water diverted under said permit.

Ans. In April 1915 land was first irrigated, and has been irrigated each year since. applied most times about 300 to 500 miners inches in each irrigation.

(Sign)

Jesse Gardiner

I hereby certify that the foregoing testimony was read to the above subscriber before its signing, that I believe him to be the person he represents himself to be, and that said testimony was subscribed and sworn to before me in Rigby, County of Jefferson, State of Idaho, on this 15th day of December A. D. 1921.

Bash L. Bennett

Notary Public.

Residing at Rigby, Idaho For Idaho

My commission expires Nov. 9th, 1922.

10662

RECEIVED
DEC 17 1921
DEPARTMENT OF REGISTRATION

Garrett Ouldhouse

Level

Permit 10662

Instructions to Examiners

1. Examiners will not be permitted to examine any of the receipts in the office pertaining to this permit. They are to furnish a report of the facts and conditions as they exist, from their own observations and inquiries.
2. Always carefully note the location of the point of diversion, and accurately plat same.
3. Find out how many parties own right in the ditch or canal and give their names and amount of right.
4. When proof is for beneficial use, carefully check up the number of acres actually irrigated in each forty and accurately plat same.
5. Make a map showing the correct location of streams and ditches, and the irrigated lands, and any adjacent permanent landmarks, such as towns, lakes, large streams and public roads.
6. If any unusual conditions are discovered, make a plain statement of them under remarks.
7. Always see the holder, if possible, and go over the whole ground with him, and make your report only upon actual existing facts and conditions.

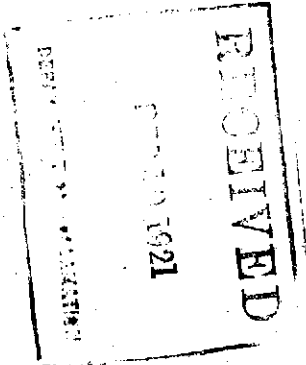

(This report must be sworn to when not made by an attache of the office.)

STATE OF IDAHO,

County of _____ ss. }

_____, being first duly sworn, deposes and says that the statements contained in the within report are correct to the best of his knowledge and belief.

Subscribed and sworn to before me this _____ day of _____ 19____

My commission expires _____ Notary Public.

NAME OF APPLICANT *Garrett Coldhouse No. 10662*

Beneficial Use

E.W.H.

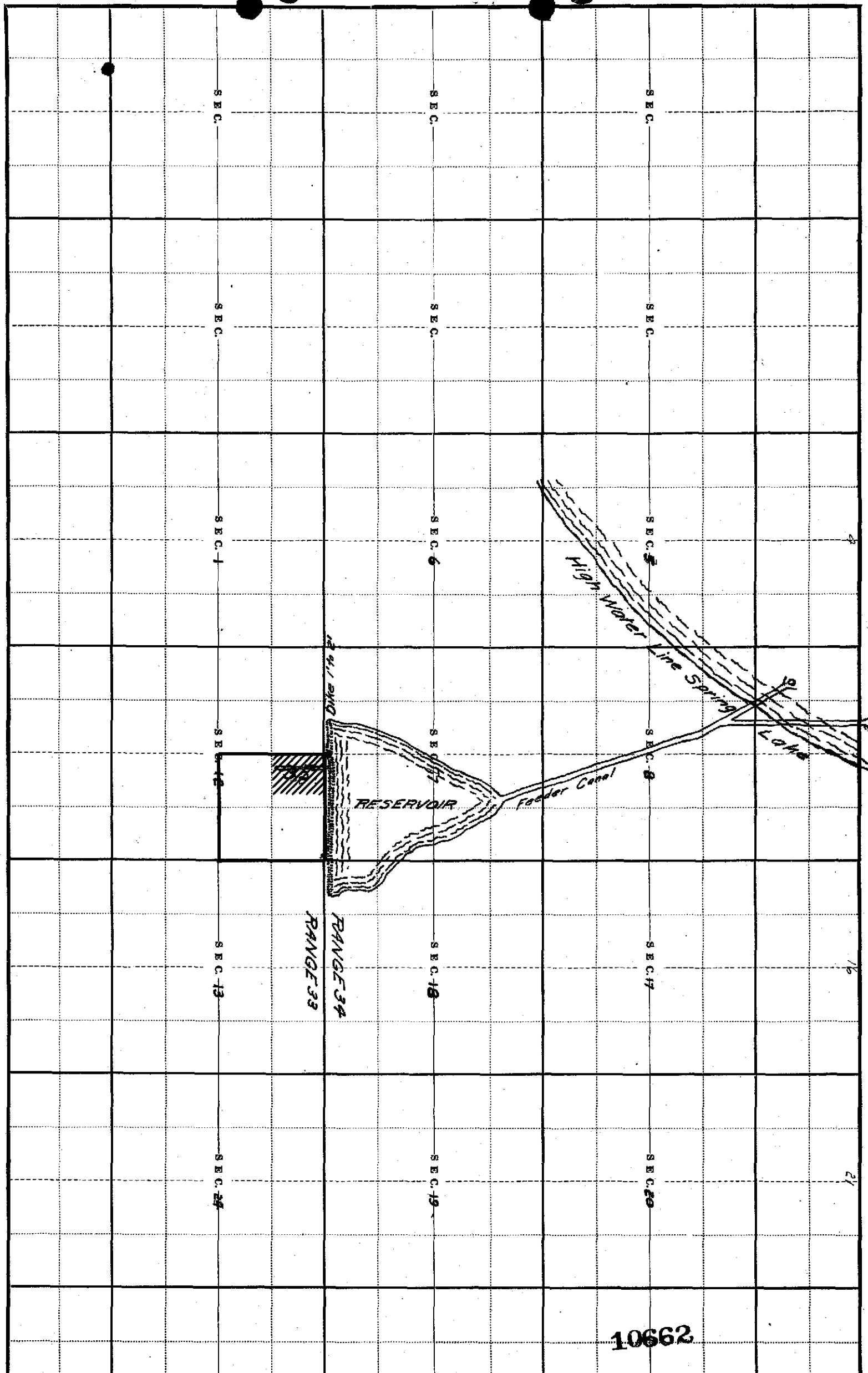

SCALE: 2 INCHES = 1 MILE. DRAW PLAN IN INK.

December 2, 1921.

Re: Permits 6701 & 10662.

Mr. Elvin W. Henninger,

Hamer, Idaho.

Dear Sir:

I am inclosing herewith the examinations papers for the beneficial use proof under the above numbered Permits.

Very truly yours,

W. G. SWENDESEN,
Commissioner of Reclamation

By _____
Chief Clerk.

CB/E
Encls.

10662

State of Idaho

DEPARTMENT OF RECLAMATION

BOISE

INSTRUCTIONS

PROOF OF BENEFICIAL USE

BOISE, IDAHO,

December 1, 1921.

Garrett Ouldhouse & Virgil Green,
c/o Bash L. Bennett,
Rigby, Idaho.

DEAR SIR:

I enclose herewith the following forms to be used in connection with proof of application of water to beneficial use under Permit No. **10662**.

DEPOSITION OF PERMIT HOLDER.

DEPOSITIONS OF TWO WITNESSES.

In submitting this proof the following instructions should be CAREFULLY followed out, since failure to do so may result in the loss of the permit holder's rights:

1. On **December 15, 1921**, the date set for the proof of application of water to beneficial use, the enclosed deposition forms (one for permit holder and one each for two witnesses) should be filled out and sworn to at **Rigby before Bash L. Bennett, a Notary Public.**

2. When the depositions have been taken they should be mailed to this office, together with affidavit of publication of notice. When these have been received, together with report of examining engineer, you will be further advised as to fees due before issuing license.

Yours truly,

W. G. SWENDSEN,

Commissioner of Reclamation.

10662

(P. O.)

(Date)

Regby Ida

Nov. 9, 1921

Commissioner of Reclamation, Boise.

Dear Sir:

I have your letter of *Nov 8th* *1921* enclosing notice of proof under
Permit No. *10662* which will be published as you request, beginning with our issue of *10th*

Nov

Regby Ida
RID

10662

STATE OF IDAHO
DEPARTMENT OF RECLAMATION

BOISE

The Star,

Rigby, Idaho.

Boise, Idaho, November 8, 1921.

Dear Sirs:

Enclosed find Notice for Publication under Permit no. **10662** which please publish once a week for four consecutive weeks in your paper. The expense of this publication will be paid by **Gerret Ouldhouse, of Rigby,** to whom you will please furnish proof of publication of this notice on or before date of proof.

Please promptly acknowledge receipt of this notice, and kindly mail me your first issue containing its publication that I may compare it with my records.

Yours truly,

W. G. SWENDSEN,

10662 Commissioner of Reclamation

Dec 5 1921

November 8, 1921.

Re: Permit No. 10662-Gerrett Ouldhouse.

Mr. Bash L. Bennett,
Rigby, Idaho.

Dear Sir:

Yours of the 4th inst., received together with notice of proof of beneficial use of water under the above numbered Permit. One copy of the notice will to-day be mailed to the Rigby Star for the required publication prior to December 15th, the date set for proof. Depositions blanks will be mailed to you as Notary Public, later.

Very truly yours,

W. G. SWENDSEN,
Commissioner of Reclamation

CB/E

By _____
Chief Clerk.

10662

BASH L. BENNETT
ATTORNEY AT LAW
RIGBY, IDAHO

Rigby, Idaho.

November 4th
1921.

To the Commissioner of Reclamation.

Boise, Idaho.

Dear sir;

You are hereby authorized and directed to have the
attached notice published at my expense in the "Rigby Star", of Rigby,
published in the county in which said ~~land~~ works are situated,

Gerret C. Culhouse.

Please mail notice to me at Rigby #3, Idaho, and you may attach date of
priority as I am not sure that you can allow the date mentioned in the notice.

10662

NOTICE FOR PUBLICATION

NOTICE OF PROOF OF APPLICATION OF WATER
TO BENEFICIAL USE

Notice is hereby given that at 10 a. m. on the 16th day of December, 1921,
 at Rigby, County of Jefferson, State of Idaho,
 before Bash L. Bennett, a Notary Public, proof will be submitted
 of the application to beneficial use of 3.2 cubic feet per second of the
 waters of Mud Lake in accordance with the terms and conditions of
 Permit No. 10662 heretofore issued by the State Engineer of the State of Idaho.

The name and postoffice address of the person or corporation holding said permit are.....
Garrett Ouldhouse, and Virgil Green, Rigby, Idaho.

The use to which said water has been applied is irrigation and domestic purposes.

The amount applied to beneficial use is 3.2 cubic feet per second.

The place where said water is used (if for irrigation, give full and accurate description of the lands irrigated) Southeast quarter (SE₄) of section 12, in Township # 7 North, Range 33, East Boise Meridian.

The name of the canal or ditch or other works by which said water is conducted to such place of use is Ouldhouse Canal.

The right to take water from such works is based upon Permit No. 10662

The source of supply from which such water is diverted is Mud Lake

The date of the priority which said user is prepared to establish is Oct. 20th, 1914.

W. G. Svendsen.

Commissioner of Reclamation. State Engineer.

10662

RENW-16-74-34E
68

State of Idaho
DEPARTMENT OF RECLAMATION

BOISE

Mr. G. Oldhouse,
Anaconda, Mont.
Dear Sir:

July 5, 1921

I enclose herewith blank notice of proof of Application of Water to Beneficial Use under your Permit No. 10662-----, which kindly fill out and return to me at least 60 days before the date upon which you wish to submit proof. The date of the proof is set out in your permit, and if proof is submitted subsequent to that your priority will be advanced a time equal to the difference of the time between the date proof should have been submitted and date it is submitted.

Yours truly,
W. G. SWENDSEN

Commissioner of Reclamation.

10662

State of Idaho
DEPARTMENT OF RECLAMATION
BOISE

Mr. Virgil Green,
Anaconda, Mont.

July 5, 1921.

Dear Sir:

I enclose herewith blank notice of proof of Application of Water to Beneficial Use under your Permit No. **10662**-----, which kindly fill out and return to me at least 60 days before the date upon which you wish to submit proof. The date of the proof is set out in your permit, and if proof is submitted subsequent to that your priority will be advanced a time equal to the difference of the time between the date proof should have been submitted and date it is submitted.

Yours truly,

W. G. SWENDSEN

Commissioner of Reclamation.

10662

STATE OF IDAHO
Department of Reclamation

Permit No.

Application for Extension of Time for Beneficial Use Proof

STATE OF IDAHO

County of

} ss.

....., of

State of being first duly sworn upon his oath deposes and says:

That he is the owner and holder of Permit to appropriate the Public Waters of the State of Idaho, No.

THAT, under the terms and conditions of said permit, proof of beneficial use thereunder was required to be made by, 19.....

THAT he has heretofore put to beneficial use second feet of water and has irrigated acres.

THAT, for the following reasons, he is unable to put to beneficial use within the required time, the remainder of the water appropriated under his permit, to-wit:

WHEREFORE, He asks that the Commissioner of Reclamation extend the time for the making of proof of beneficial use under said permit to, 191.....

Subscribed and sworn to before me this day of, 191.....

Notary Public.

My commission expires

Date of receipt at office of Department of Reclamation

APPROVAL OF COMMISSIONER OF RECLAMATION

I, W. G. Swendsen, Commissioner of Reclamation of the State of Idaho, hereby extend the time for the making of proof of beneficial use under Permit to appropriate the Public Waters of the State of Idaho, No. **10662**, to **October 20**, 19**21**.

Witness my hand this **11th** day of **October**, 19**20**.

10662

By *W. G. Swendsen*
L. B. Bar Commissioner of Reclamation.
 Deputy

STATE OF MONTANA,)
County of Deer Lodge.) SS.

G.Ouldhouse, being first duly sworn, on oath deposes and says: That he is one of the owners and holders of permit to appropriate the public waters of the State of Idaho, No. 10662.

That at the present time and for the eleven months last past, he has been employed by the Butte, Anaconda & Pacific Railway Company, and at present is located at Anaconda, Deer Lodge County, Montana.

That for the past twelve months, the wife of affiant has been critically ill, and under the care of a physician. That on account of the expenses of doctors' fees, and other expenses incident to illness, affiant is unable to procure the necessary funds to prepare and till and put the land, to be irrigated by the waters held under said above permit, in such shape that he can successfully make final proof on said waters, and on said account, affiant requests a continuance of time from the 20th of October, 1920, up to and including the 20th day of October, 1921.

G. Ouldhouse

Subscribed and sworn to before me this 9th day of October, 1920.

A. H. Morgan
Notary Public for the State of Montana
residing at Anaconda, Montana.
My Commission expires Feb'y 19, 1923.

Anaconda, Montana,
October 9th, 1920.

State Engineer of Idaho,
Boise, Idaho.

Dear Sir:

I am enclosing my affidavit in connection with final proof on permit to appropriate the waters of the State of Idaho, No. 10662, with the view of requesting a continuance of time to make final proof on water until October 20th, 1921.

My partner Mr. Virgle Green, is now on the claims, and has been for about the last four months, since his return from service with the American Expeditionary Forces. He is also short of cash as he has been under necessity of supporting a sick sister since his return from France.

Kindly notify me at once if this continuance may be granted.

Respectfully yours,

Gerret C. Guldhouse

10662

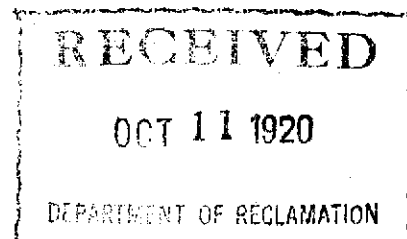

Address
G. Guldhouse
31945, Cornish St
Anaconda
Mont.

10662

L/B
Enc.

STATE OF IDAHO
Department of Reclamation

Permit No. 10662

Application for Extension of Time for Beneficial Use Proof

Montana
STATE OF ~~IDAHO~~ } ss.
County of *Deer Lodge* }
G. Ouldhouse of *Jefferson County*
State of *Idaho* being first duly sworn upon his oath deposes and says:

That he is the owner and holder of Permit to Appropriate the Public Waters of the State of Idaho, No. 10662

THAT, under the terms and conditions of said permit, proof of beneficial use thereunder was required to be made by October 20th, 1919.

THAT he has heretofore put to beneficial use about 20 inches second feet of water and has irrigated about 20 acres.

THAT, for the following reasons, he is unable to put to beneficial use within the required time, the remainder of the water appropriated under his permit, to-wit: that for the past two years Virgil Greene - co-owner of said permit to appropriate public waters of the State of Idaho, has been in Military Service of the United States with the American Expeditionary Forces, and deponent has not been financially able to carry on the necessary work, within the time allowed by said permit. The said Virgil Greene has now been discharged.

WHEREFORE, He asks that the Commissioner of Reclamation extend the time for the making of proof of beneficial use under said permit to October 20th, 1920.

Subscribed and sworn to before me this 9th day of December, 1919.

My commission expires _____

Notary Public for the State of Montana G. Ouldhouse Notary Public,
residing at Anaconda, Montana.

My Commission expires Feb'y 19, 1920

Date of receipt at office of Department of Reclamation Dec. 12, 1919.

APPROVAL OF COMMISSIONER OF RECLAMATION

I, W. G. Swendsen, Commissioner of Reclamation of the State of Idaho, hereby extend the time for the making of proof of beneficial use under Permit to Appropriate the Public Waters of the

State of Idaho, No. 10662, to October 20th, 1920
Witness my hand this 12th day of December, 1919

10662

W. G. SWENDSEN
Commissioner of Reclamation.
By [Signature] Deputy.

October 6, 1919.

In re: Permit 10662.

G. Ouldhouse,
Lewell, Idaho.

Dear Sir:

An application for extension of time
to show beneficial use of water should be made
on the enclosed blank.

Yours very truly,

W. O. SWENDSEN,
Commissioner of Reclamation.

By

Chief Clerk.

L/B
Enc.

10662

Level, Ida. 36
Oct 3-1919.

State Engineer,

Dear Sir,

Myself + Virgil Green
are holders of permit No 10662. and would
like to have the time extended to make
final proof on the water.

Virgil Green was in A & F and I was unable
to use the water on account of sickness.

Yours Truly
G. C. Caldwell
Level
Ida.

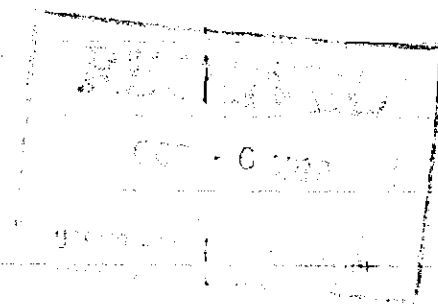

10662

State of Idaho
ENGINEERING DEPARTMENT
BOISE

G. Oldhouse.

July 7, 1919

Anaconda, Montana

I enclose herewith blank notice of proof of Application of Water to Beneficial Use under your Permit No. **10662**-----, which kindly fill out and return to me at least 60 days before the date upon which you wish to submit proof. The date of the proof is set out in your permit, and if proof is submitted subsequent to that your priority will be advanced a time equal to the difference of the time between the date proof should have been submitted and date it is submitted.

Yours truly,

Virgil Green

W. G. Swendsen.

~~State Engineer.~~
Commissioner of Reclamation

10662

January 30, 1919.

Re Permit No. 10662.

Mr. Garrett Ouldhouse,
414 West 4th St.,
Anaconda, Montana.

Dear Sir:

In reply to yours of the 28th inst., would say that the first step towards making final proof, under the above permit, is to fill out the enclosed blanks and return same to this office, allowing time for the notice to be published four weeks prior to the date of making proof. This proof can be made at any place in the State of Idaho most convenient to holders and witnesses. Depositions of two witnesses will be required at the time of making proof, blanks for which will be furnished.

Very truly yours,

FRED A. WILKIE,

State Engineer.

By _____

CB-NC

10662

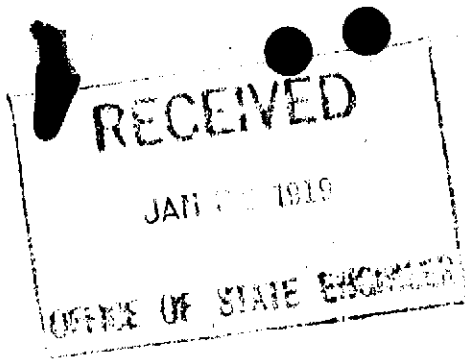

Anaconda Mont
1-28-19.

Fred A Wilkie
State Engineer
Boise Ida.

Dear Sir.

I received Certificate of

Completion of Works + Receipt OK.

Myself and Virgil Green are holders of
Permit no 10662.

I would like to ask what steps we must take
to complete proving up on the water.

Hoping to get information on this, our land filings
were homesteads.

Respectfully Yours,
Gerret Buldhouse,
414 West 4th St.
Anaconda.
Mont.

10662

December 21, 1918

Re Permit No. 10662.

Mr. G. Oldhouse,
Anaconda, Montana.

Dear Sir:

Enclosing herewith Certificate of Completion of Works issued under the above numbered permit with receipt for fee.

Very truly yours,

FRED A. WILKIE,

State Engineer.

By _____

10662

Hotel Weber

2 FIRST-CLASS ROOMS A SPECIALTY 2

MRS. N. J. WEBER, Proprietress.

BELLEVUE, IDAHO Dec 5th 1918

State Engineer

Sir

I have sold my ranch and
I am leaving the Country so I wish
you to forward all Communications
to Leander Wiles the Interested party
Mulaorn
Idaho

Thanking you for your
past favours
Walter B Ramsey
Mulaorn
Idaho

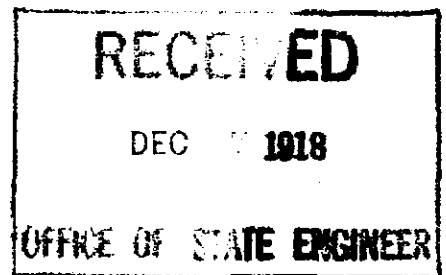

10662

Permit No. 10872

OFFICE OF STATE ENGINEER

PROOF OF COMPLETION OF WORKS

AFFIDAVIT OF HOLDER

no-57437
5-02

STATE OF IDAHO,

County of Blaine } ss.

Walter B. Ramsay, being first duly sworn, upon his oath deposes and says:
 First: That he is the holder and owner of Permit to appropriate the Public Waters of the State of Idaho, No. 15729, and that his postoffice address is Waldron Idaho
 State of Idaho

Second: That the name of the stream from which said water is to be diverted is Waldron Creek

Third: That the point of diversion of said water is 500 feet East 200 feet North of the South West Corner of Section 1 T.P. 3 N. R. 21 E

Fourth: That under the terms and conditions of said permit, construction thereunder was required to be completed by December 4th, 1918

Fifth: That the use for which said water is intended is Irrigation

Sixth: That on the date above mentioned, the works constructed under said permit were (or were not) fully completed and consisted of the following:

I. Kind of works: Dam and ditch
 (Reservoir, dam, ditch, flume, pipe or otherwise)

II. Dimensions of work:

(a) Height of dam 3 feet, length of dam at top 21 feet, length of dam at bottom 20 feet. Material used in construction Timber & Rock

(State whether wood, earth, stone or concrete)

(b) Capacity of reservoir _____ acre feet.

(c) Size of headgate: Width 1 feet, height 1 feet.

(d) Conduit ditch width at bottom 2 feet, width at water line 3 feet, depth of water 7 inches; diameter of pipe _____ inches;

(State whether ditch, flume or pipe)

average grade per mile is 5 feet. Length of conduit is 1/4 miles.

Seventh: That said works are capable of conducting to the place of intended use 1.6 cubic feet second feet of water.

Eighth: That water appropriated under said permit is available for 80 acres of land described as follows: Sec 17 T. 2 N. R. 21 E.

Ninth: Remarks: That Location of point of diversion the Springs are located on the South & S.W. 1/4 S. 1 T. 2 N. R. 21 E.

Walter B. Ramsay
 (Sign here)

Subscribed and sworn to before me this 3rd day of Nov., 1918

My commission expires _____

C. P. Larsen
 Notary Public.

My Comm. expires _____

OFFICE OF STATE ENGINEER

PROOF OF COMPLETION OF WORKS

AFFIDAVIT OF HOLDER

STATE OF MontanaCounty of Deer Lodge

ss.

G. Oldhouse, being first duly sworn, upon his oath deposes and says:
 First: That he is the holder and owner of Permit to appropriate the Public Waters of the State of Idaho, No. 15688/10662, and that his postoffice address is 414 W 4th - Anaconda State of Montana

Second: That the name of the stream from which said water is to be diverted is Mud Lake, Jefferson County, Idaho

Third: That the point of diversion of said water is SE 1/4 NE 1/4 Section 9 Township 7 North, Range 34 E. B. M.

Fourth: That under the terms and conditions of said permit, construction thereunder was required to be completed by October 20th, 1918

Fifth: That the use for which said water is intended is Irrigation

Sixth: That on the date above mentioned, the works constructed under said permit were (~~or were not~~) fully completed and consisted of the following:

I. Kind of works: Ditch and Flume

(Reservoir, dam, ditch, flume, pipe or otherwise)

II. Dimensions of work:

(a) Height of dam None feet, length of dam at top ✓ feet, length of dam at bottom ✓ feet. Material used in construction ✓

(State whether wood, earth, stone or concrete)

(b) Capacity of reservoir ✓ acre feet.

(c) Size of headgate: Width ✓ feet, height ✓ feet.

(d) Conduit Ditch and Flume width at bottom 12 feet, width at water line 14 feet, depth of water 1 feet; diameter of pipe ✓ inches; average grade per mile is .60 feet. Length of conduit is 2 1/2 miles.

Seventh: That said works are capable of conducting to the place of intended use 6.4 Cubic feet per second feet of water.

Eighth: That water appropriated under said permit is available for 320 acres of land described as follows: SE 1/4 Section 12 T4 N6 E Section 13 all in Township 7, North, Range 33 E. B. M.

Ninth: Remarks: That this affidavit has not been returned sooner as affiant was away from Rocker, Montana and did not return until Nov. 15th 1918 and on that date received notice to make proof of completion of work - Co-owner Virgil Green is now in US Army - address unknown.

Subscribed and sworn to before me this 18th day of November, 1918

My commission expires ✓

G. Oldhouse (Sign here)
D. H. Morgan
 Notary Public for the State of Montana
 residing at Anaconda, Montana.
 My Commission expires Feb'y 19, 1920.

September 6, 1918.

Re: Permit 10662.

Mr. Gerrett Guldhouse,
Lewistown, Idaho.

Dear Sir:

I have your letter of the 4th and take it that your difficulty is in a settlement for a right-of-way for a head gate through an obstruction to your right-of-way.

From your letter I discover no obstacle to your securing permission to put a head gate in the dyke you refer to, but the question of a right-of-way is one over which this office has no control. You must procure the same, either by agreement or under the law of Eminent Domain.

Very truly yours,

State Engineer.

FAW/MB

File: Per. 10662. ✓

10662

Re. Water Permit
No. 10662

A. B. KENNEDY, JR.

UNITED STATES COMMISSIONER

LAND FILINGS, FINAL PROOFS, AND ALL LAND MATTERS ATTENDED

ROBERTS, IDAHO

September 4, 1918

Hon. Fred H. Wilkie,
State Engineer,
Boise, Idaho.

Dear Sir:

On January 12, 1916 your office allowed my application for amendment of Permit No. 10662, for 6.4 second feet of the waters of Mud Lake, point of diversion being SE¹/₄ NW¹/₄, Sec. 9, Twp. 7 north, Range 34 E. B. M., and waters were for domestic and irrigation use.

Some parties have now built a dyke finishing same this summer, which will preclude me from drawing water through my ditch unless permission is given me to cut through the dyke.

The dyke was built ~~after~~ for purpose of making proof on a reservoir site, and it was not necessary to build the dyke to keep waters back at the point where my ditch crosses the dyke.

I have 3 miles of ditch completed, and it will be of no avail unless I am allowed to go through the dyke, and I also could not make completion of water works or irrigate my land unless I can be allowed to go through the dyke.

Myself and Virgil Green are interested in the ditch and water filing, and Mr. Green is now in the U. S. Army and cannot be here to protect himself.

We are willing to install headgates at point where our ditch would cross reservoir, so as to keep the dyke for its original purpose, and it would in no way hurt the reservoir or the dyke.

The interested people in the dyke and reservoir are known Palmgren and Harwood reservoir.

Awaiting an early reply with information, I am,

Very truly yours,

Address me at

Gerritt Ouldhouse, Level, Idaho.

Gerritt Ouldhouse

RECEIVED

SEP 5 1918

OFFICE OF STATE ENGINEER

10662

Address me at

Gerritt Ouldhouse, Level, Idaho.

Gerritt Ouldhouse

10662

State of Idaho
ENGINEERING DEPARTMENT
BOISE

INSTRUCTIONS
PROOF OF COMPLETION OF WORKS

G. Oldhouse & Virgil Greene

G. Oldhouse,
Rocker, Mont.

Dear Sir:—

Boise, Idaho, JUL 13 1918

Under the terms of your Permit No. ~~10662~~, you are required to complete your diversion works on or before ~~Oct. 20, 1918~~. I enclose herewith blank affidavit to be filled out, sworn to by you before a Notary Public or a Justice of the Peace, and returned to this office on or before the above date, or within ten days thereafter, for the purpose of making proof of completion under the permit. Upon receipt of this affidavit in this office, provided the same satisfactorily shows the completion of the works substantially in accordance with the terms of the permit, together with a fee of \$5.00, a Certificate of Completion will be issued to you.

The certificate to be issued under this proof will not give a perpetual right to the use of water for which application was made, as it only confirms the completion of works of a capacity to divert and convey to the place of intended use a certain amount of water. The law requires that another proof be submitted when the water has been fully applied to a beneficial use, at which time license is issued for the amount of water actually in use. Information in regard to this last proof will be furnished on request.

Yours truly,

FRED A. WILKIE

I. H. SMITH,

State Engineer.

10662

January 12, 1916.

Re Permit No. 10662.

Mr. G. Oldhouse,
Roberts, Idaho.

Sir:--

The application for amendment of above permit
has been approved and same is herewith returned to
you, with duplicate map.

Very truly yours,

J. H. SMITH,

State Engineer.

AA-M -APD

By _____

10662

Name of Applicant - *L. Adolant & Virgil Green*

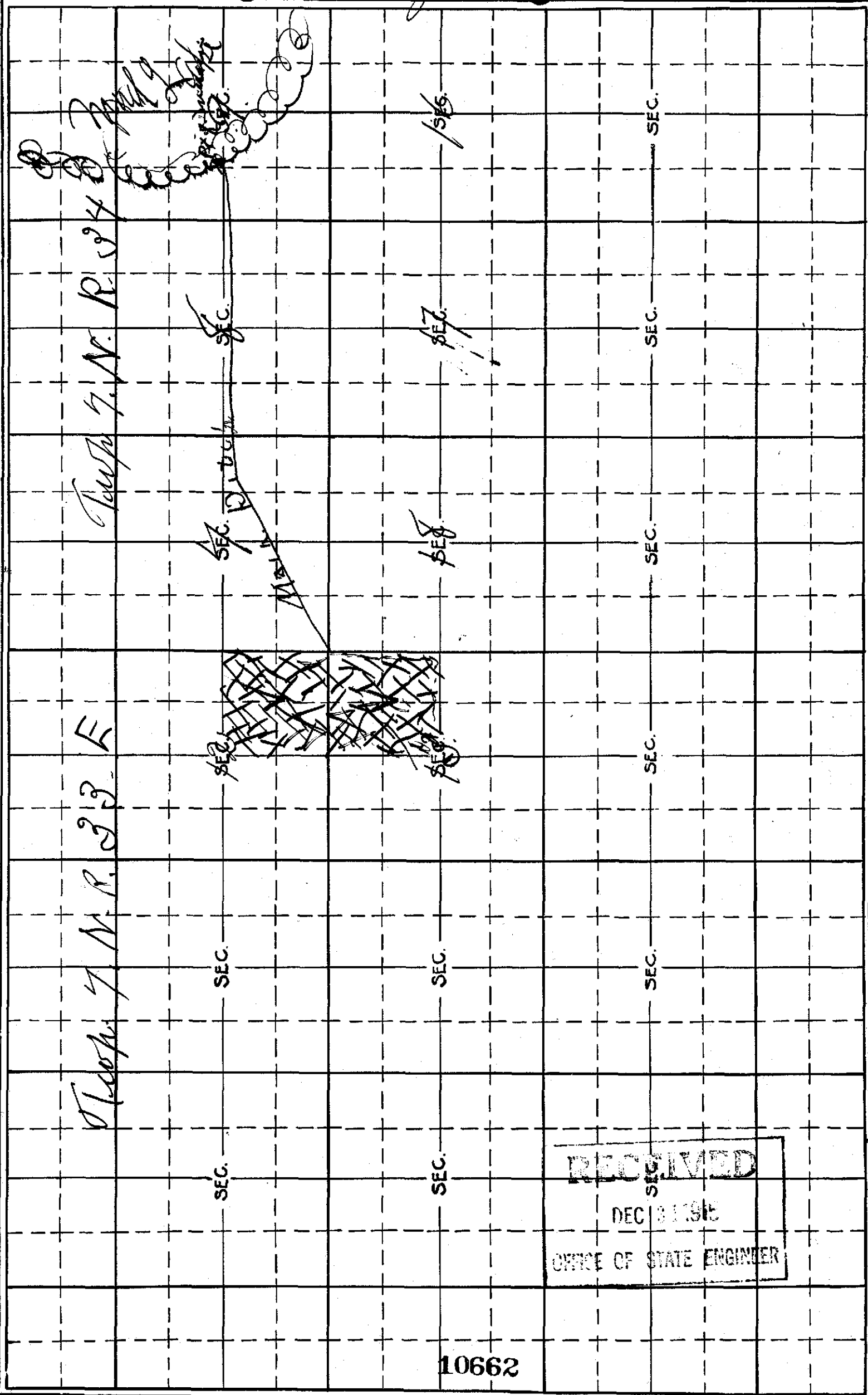

RECEIVED
DEC 31 1915
OFFICE OF STATE ENGINEER

10662

December 27, 1915.

Re Permit No. 10662.

Bash L. Bennett, Attorney,
Rigby, Idaho.

Sir:--

Am enclosing herewith affidavit for change of
point of diversion and application for amendment of
lands under above permit. Duplicate maps should accompany
these.

Very truly yours,

J. H. SMITH,

State Engineer.

F13-AA-2MF

By _____

10662

BASH L. BENNETT
UNITED STATES COMMISSIONER
LAND ENTRIES, PROOFS & CONTESTS

ROBERTS, IDAHO.

December 23d, 1915.

State Engineer,
Boise, Idaho,

10662

Sir;

Will you please send to me at Rigby, Idaho a
blank for a change of diversion and, and there is also
an error in the place that water is to be applied, this
applicant amended his desert entry and wants his water permit
amended to cover another piece of land in lieu of the one
now designated. This is in reference to permit, #10662

Thanking you for these blanks, I am,

Sincerely yours,

Bash L. Bennett
Rigby - Idaho

RECEIVED

DEC 27 1915

OFFICE OF STATE ENGINEER

Boise, Idaho, December 18, 1914.

10662
Permit No. 15608.

Mr. Bash L. Bennett,
Roberts, Idaho.

Sir:--

Replying to yours of the 4th inst.
in the above would say that applicant should
file application for amendment to Permit
together with two maps, as is required by
the rules and regulations on back of form.

I enclose amendment blank herewith
together with two plate.

Very truly yours,

Acting State Engineer.

Enc. Amend. Form and
2MF.
W/L

10662

BASSEL BENNETT
UNITED STATES COMMISSIONER
LAND ENTERIES, PROOFS & CONTESTS

ROBERTS, IDAHO.
December 14th, 1914.

State Engineer
Boise Idaho.

Dear sir;

In the matter of Permit #15688, the land is
discribed incorrectly. It should read the NE¹: section 13, 1
instead of the northeast quarter of section 12 as in the permit
Will you please send to me the proper blanks upon which the
correction may be made,

Sincerely yours,

Bassel L Bennett

RECEIVED

DEC 16 1914

OFFICE OF STATE ENGINEER

P15688

10662

State of Idaho

ENGINEERING DEPARTMENT BOISE

STATE ENGINEER

Permit No. 10662-Oldhouse et al.

Boise, Idaho, Oct. 20, 1914.

Mr. Bash L. Bennett,
Roberts, Ida.

I enclose herewith above numbered permit. BE SURE TO NOTE
LIMITATIONS AND CONDITIONS OF SAME as given under approval of
State Engineer on the third page.

Herbert Wing,

Acting State Engineer.

10662

Name of Applicant *Virgil Green, G. Old Town*

