

(8) Remarks

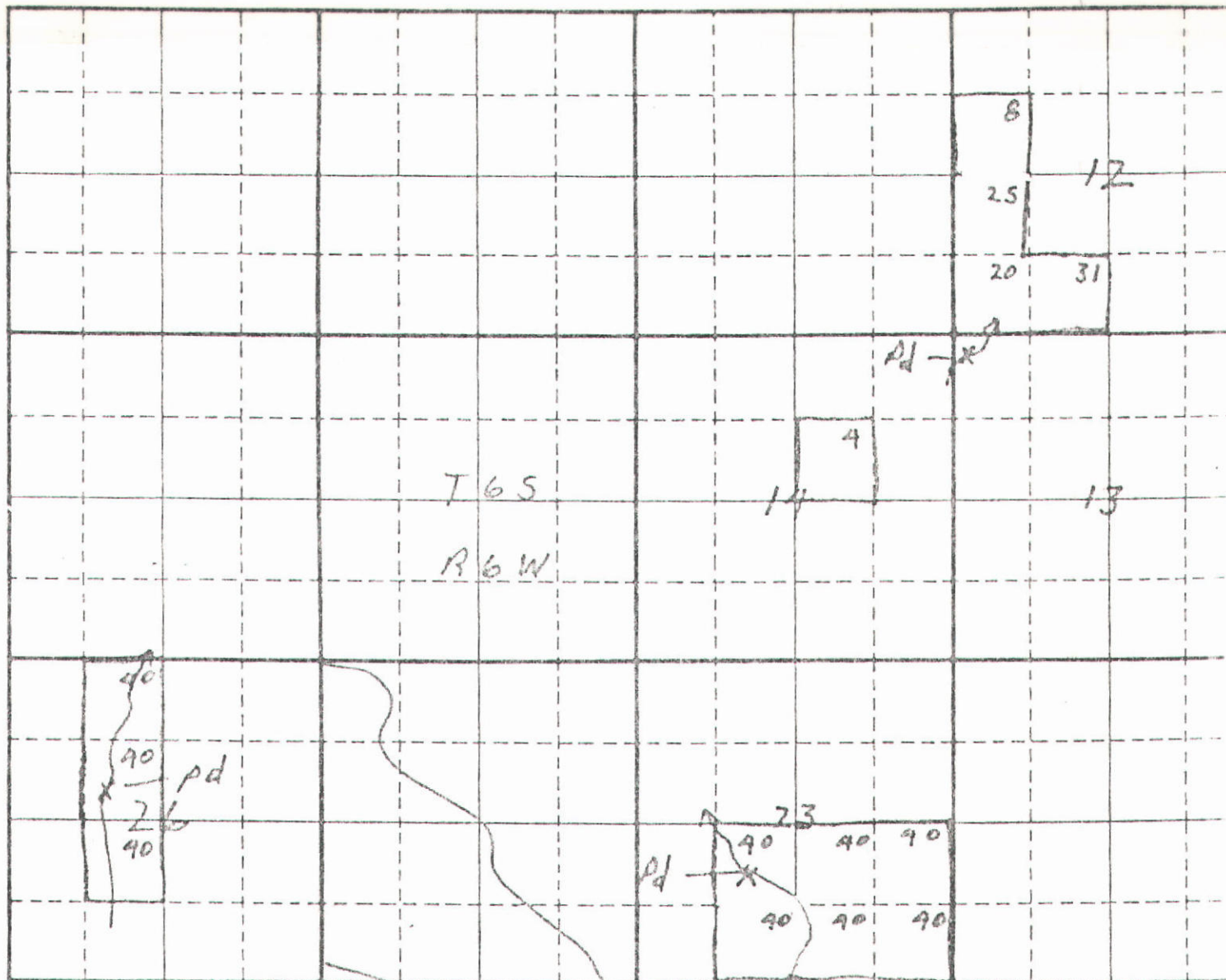

Scale: 2 inches equal 1 mile.

Map should show the location of the point of diversion and the place of use of the water by 40-acre subdivisions, section, township and range of the public land survey system.

State of Idaho)
County of Ada) ss.

Be it known that the undersigned, being duly sworn, deposes and says that he, she, they subscribed the foregoing claim to a water right, together with all attached information, and that the matters and facts therein are true to the best of the affiant's knowledge.

Thomas R. Gluck
(Claimant)

Sworn to before me this 19th day of October, 1981.

Nancy M. Northway
Notary Public
Residing at Boise

My commission expires Life

FOR DEPARTMENT USE ONLY

Received by KG Date 10/20/81 Exception filed by: _____ Date _____
Prelim. check by KG Date 10/20/81 Forwarded to claimant by: _____
\$20.00 fee received by Do fee Date _____
Published in Owyhee Nugget _____
Dates 11/05 & 11/12/81 _____

PROOF OF PUBLICATION

STATE OF IDAHO, County of Owyhee, s.s.

I, RODNEY A. HAWES, being first duly sworn, on oath says that he is the Publisher of the OWYHEE NUGGET, a newspaper of general circulation, published weekly by Rodney A. Hawes, publisher and printer thereof, at Marsing, County of Owyhee, State of Idaho;

That the annexed notice was published in said newspaper once a week and every week for 2 consecutive weeks, the first publication being on the 5 day of Nov., 1981, and the last publication being on the 12 day of Nov., 1981;

That the said newspaper has been published continuously and uninterruptedly in said county during a period of more than seventy - eight consecutive weeks prior to the first publication of the attached notice.

Rodney A. Hawes
PUBLISHER

Subscribed and sworn to before me this 12 day of

November, 1981.

Leona S. Hawes
NOTARY PUBLIC

My commission expires 9-10-84

(SEAL)

RECEIVED
JAN 25 1982

Department of Water Resources
Western Regional Office

NOTICE OF CLAIMS TO WATER RIGHTS

Notice is hereby given that the following claim(s) to water right(s) have been established by diversion and application to beneficial use:

AMENDED / 13

55 - 4060

GLUCH, THOMAS R. & / or ANITA L.

P. O. BOX 257, JORDAN VALLEY, OR 97910

Source: LONE TREE CREEK tributary to JORDAN CREEK

Priority Date: 01/01/1887

Amount: 9.77 CFS

Diversion Point: NESW Sec 23 T 06S R 06W SWNW Sec 26 T 06S R 06W NWNW Sec 13 T 06S R 06W OWYHEE Co.

Use: IRRIGATION (9.68 CFS) from 04/01 to 11/01

STOCKWATER (0.09 CFS) from 01/01 to 12/31

Place of Use: SWNE Sec 14 T 06S R 06W NESW SESW NESE NWSE SWSE SESE Sec 23 T 06S R 06W NENW SENW NESW Sec 26 T 06S R 06W SWNW NWSW SWSW SESW Sec 12 T 06S R 06W FOR 448 ACRES

Diversion Means: CHECK DAM & GRAVITY DITCH

AMENDED

55 - 4061

GLUCH, THOMAS R. & / or ANITA L.

P. O. BOX 257, JORDAN VALLEY, OR 97910

Source: JORDAN CREEK tributary to OWYHEE RIVER

Priority Date: 01/01/1884

Amount: 0.95 CFS

Diversion Point: NWSE Sec 12 T 06S R 06W OWYHEE Co.

Use: IRRIGATION (0.88 CFS) from 04/01 to 11/01

STOCKWATER (0.09 CFS) from 01/01 to 12/31

Place of Use: NENW NWNW SWNW SENW NWSE Sec 12 T 06S R 06W FOR 43 ACRES

Diversion Means: PUMP, PIPELINE & GRAVITY DITCH

Any exception to any claim of water right may be filed with the Director of the Idaho Department of Water Resources, 92 S. Cole Road, Boise, Idaho 83709.

A. KENNETH DUNN,
Director

Published November 5 and 12, 1981 in the Owyhee Nugget, Marsing, Owyhee County, ID.

(8) Remarks _____

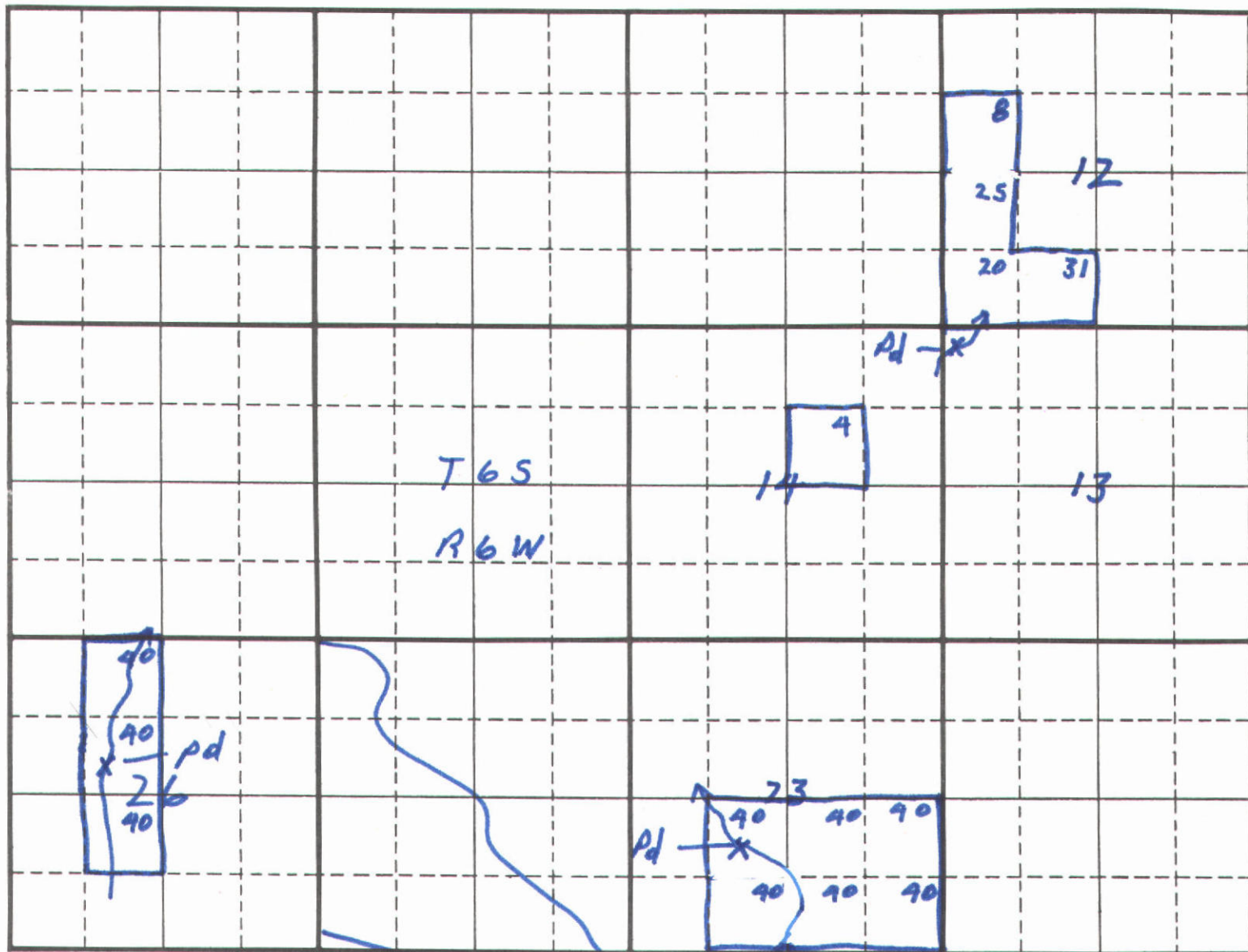

Scale: 2 inches equal 1 mile.

Map should show the location of the point of diversion and the place of use of the water by 40-acre subdivisions, section, township and range of the public land survey system.

State of Idaho)
County of ADA) ss.

Be it known that the undersigned, being duly sworn, deposes and says that he, she, they subscribed the foregoing claim to a water right, together with all attached information, and that the matters and facts therein are true to the best of the affiant's knowledge.

Thomas R. Gluck
(Claimant)

Sworn to before me this 16 day of DECEMBER, 1980.

[Signature]
Notary Public
Residing at BOISE, ID

My commission expires LIFE

FOR DEPARTMENT USE ONLY

Received by chs Date 12/16/80 Exception filed by: _____ Forwarded to _____ Date _____
Prelim. check by JG Date _____ claimant by: _____
\$30.00 fee received by WIK Date 12/24/80 # 17220
Published in Owyhee Nugget _____
Dates 1/1 - 10/8/80 _____

RECEIVED

PROOF OF PUBLICATION

STATE OF IDAHO, County of Owyhee, s.s.

I, RODNEY A. HAWES, being first duly sworn, on oath says that he is the Publisher of the OWYHEE NUGGET, a newspaper of general circulation, published weekly by Rodney A. Hawes, publisher and printer thereof, at Marsing, County of Owyhee, State of Idaho;

That the annexed notice was published in said newspaper once a week and every week for 2 consecutive weeks, the first publication being on the 26 day of Feb, 1981, and the last publication being on the 5 day of March, 1981;

That the said newspaper has been published continuously and uninterruptedly in said county during a period of more than seventy - eight consecutive weeks prior to the first publication of the attached notice.

PUBLISHER

Subscribed and sworn to before me this 5 day of

March, 1981.

NOTARY PUBLIC

My commission expires 9-10-84

(SEAL)

316
RECEIVED

MAR 12 1981

Department of Water Resources
Western Regional Office

NOTICE OF CORRECTION

Notice is hereby given that notice of Claim to a Water Right, No. 55 - 4060 in the name of Thomas R. & / or Anita I. Gluch was published in error on 1/1 and 1/8/81.

The points of diversion were advertised as being within the NESW, Sec. 23, SWNW, Sec. 26 and NWNW, Sec. 13, all in Twp 6S, Rge 6W, B. M. WHEREAS, the actual points of diversion are within the NESW, Sec. 23, SENW, Sec. 26, and NWNW, Sec. 13, all within Twp 6S, Rge 6W, B. M.

Any exception to this claim of water right may be filed with the Director of the Department of Water Resources, 92 South Cole Road, Boise, Idaho 83709.

C. STEPHEN ALLRED,
Director

Published in the Owyhee Nugget, Marsing, Owyhee County, Idaho on February 26 and March 5, 1981.

o.k.
neu

PROOF OF PUBLICATION

STATE OF IDAHO, County of Owyhee, s.s.

I, RODNEY A. HAWES, being first duly sworn, on oath says that he is the Publisher of the OWYHEE NUGGET, a newspaper of general circulation, published weekly by Rodney A. Hawes, publisher and printer thereof, at Marsing, County of Owyhee, State of Idaho;

That the annexed notice was published in said newspaper once a week and every week for 2 consecutive weeks, the first publication being on the 1 day of January, 1981, and the last publication being on the 8 day of January, 1981;

That the said newspaper has been published continuously and uninterruptedly in said county during a period of more than seventy - eight consecutive weeks prior to the first publication of the attached notice.

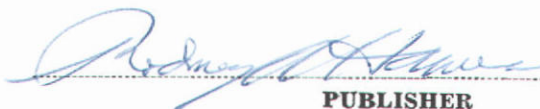
PUBLISHER

Subscribed and sworn to before me this 8 day of

January, 1981

NOTARY PUBLIC

My commission expires 9-10-84

(SEAL)

NOTICE OF CLAIMS TO WATER RIGHTS

Notice is hereby given that the following claim(s) to water right(s) have been established by diversion and application to beneficial use:

55 - 4060

GLUCH, THOMAS R. &/OR ANITA L.

BOX 257, JORDAN VALLEY, OR 97910

Source: LONE TREE CREEK tributary to JORDAN CREEK

Priority Date: 01/01/1887

Amount: 9.68 CFS

Diversion Point: NESW Sec 23 T 06S R 06W SWNW Sec 26 T 06S R 06W NWNW Sec 13 T 06S R 06W, OWYHEE Co.

Use: IRRIGATION (9.68 CFS) from 04/01 to 11/01

Place of Use: SWNE Sec 14 T 06S R 06W NESW SESW NESE NWSE SWSE SESE Sec 23 T 06S R 06W NENW SENW NESW Sec 26 T 06S R 06W SWNW NWSW SWSW SESW Sec 12 T 06S R 06W FOR 448 ACRES

Diversion Means: CHECK DAM & GRAVITY DITCH.

55 - 4061

GLUCH, THOMAS R. &/or ANITA L.

BOX 257, JORDAN VALLEY, OR 97910

Source: JORDAN CREEK tributary to OWYHEE RIVER

Priority Date: 01/01/1884

Amount: 0.86 CFS

Diversion Point: NWSE Sec 12 T 06S R 06W, OWYHEE Co.

Use: IRRIGATION (0.86 CFS) from 04/01 to 11/01

Place of Use: NENW NWNW SWNW SENW NWSE Sec 12 T 06S R 06W FOR 43 ACRES

Diversion Means: PUMP, PIPELINE & DITCH.

Any exception to any claim of water right may be filed with the Director of the Idaho Department of Water Resources, 92 S. Cole Road, Boise, Idaho 83709.

C. STEPHEN ALLRED,
Director

Published January 1 and 8, 1981. Owyhee Nuggets, Marsing, Owyhee County, Idaho.

RECEIVED

FEB 2 1981

Department of Water Resources
Western Regional Office

STATE OF IDAHO
DEPARTMENT OF WATER RESOURCES



AMENDED

CLAIM TO A WATER RIGHT

AMENDED

Under the provisions of Section 42-243, Idaho Code, any person using or claiming rights to the public waters of Idaho established by diversion and application to a beneficial use must file a claim with the Department of Water Resources on or before June 30, 1983. Exempted from this filing are single family domestic uses as defined in Section 42-230(d), Idaho Code. Also exempted are rights represented by a permit, license, decree, adjudicated right, or a previously filed claim.

The filing of this claim does not confirm the water right claimed but failure to file may result in forfeiture of a water right.

Notice is hereby given that Thomas R. &/or Anita L. Gluch
(Name of Claimant)

Box 257, Jordan Valley, Oregon 97910 Telephone No. 208-583-2287
(Mailing Address) (Zip Code)

claims a right to the diversion and beneficial use of the surface or ground water. The extent and nature of said claim is as follows

(1) Date of priority. (When was the water first applied to a beneficial use) 1/1/1887

A claim is not acceptable on a ground water source with a priority later than March 25, 1963 or on a surface water source with a priority later than May 20, 1971. An exception is that a claim may be filed on single family domestic use from a ground water source.

(2) Describe the source of water: (Name of stream, lake, spring, etc., or ground water)

Lone Tree Creek tributary to Jordan Creek

(3) Describe the purpose for which the water has been used and the time during the year when you have used the right claimed

	(cfs, gpd, AFA)	(Domestic, Irrigation, Stock, Etc.)	(Both dates inclusive)	
			(Mo., Day)	(Mo., Day)
Quantity	<u>9.68</u>	Use <u>Irrigation</u>	Period of Use From <u>4/1</u>	To <u>11/1</u>
Quantity	<u>0.09</u>	Use <u>Stockwater</u>	Period of Use From <u>1/1</u>	To <u>12/31</u>
Quantity		Use	Period of Use From	To
Quantity		Use	Period of Use From	To
Quantity		Use	Period of Use From	To

(4) 9.77 TOTAL QUANTITY USED.
(cfs, gpd, AFA)

(5) A) Point of diversion: (Location of point where water is diverted from its source)

NE 1/4 SW 1/4, Sec. 23 Twp. 6S Rge. 6W B.M., County of Owyhee
Additional points of diversion SW 1/4 NW 1/4, Sec. 26. NW 1/4, Sec. 13, all in Twp. 6S, Rge. 6W.

B) Describe means of diversion of water: (Pump and pipeline, well, diversion dam, reservoir, length of ditch and field, etc.). Give sizes and capacities be as specific as possible. Describe any changes in the system and give the date of the change. Check dam in creek into gravity ditch.

(6) A) Describe location of use by listing number of irrigated acres within each 40-acre tract in appropriate box. If use is not for irrigation, place an "X" in appropriate box to show location.

T	R	SEC.	NE 1/4				NW 1/4				SW 1/4				SE 1/4				TOTAL
			NE 1/4	NW 1/4	SW 1/4	SE 1/4	NE 1/4	NW 1/4	SW 1/4	SE 1/4	NE 1/4	NW 1/4	SW 1/4	SE 1/4	NE 1/4	NW 1/4	SW 1/4	SE 1/4	
6S	6W	14			4														4
		23								40			40	40	40	40	40	40	240
		26					40			40	40								120
		12							8			25	20	31					84

No. of acres 448

B) If water is used for other than irrigation, fully describe that use, being as specific as possible

Stockwater same place of use as irrigation.

NOTE. Include here the type and number of stock watered: 400 hd.

(7) If you are claiming water as a member of an organization, list name of organization:

Remarks

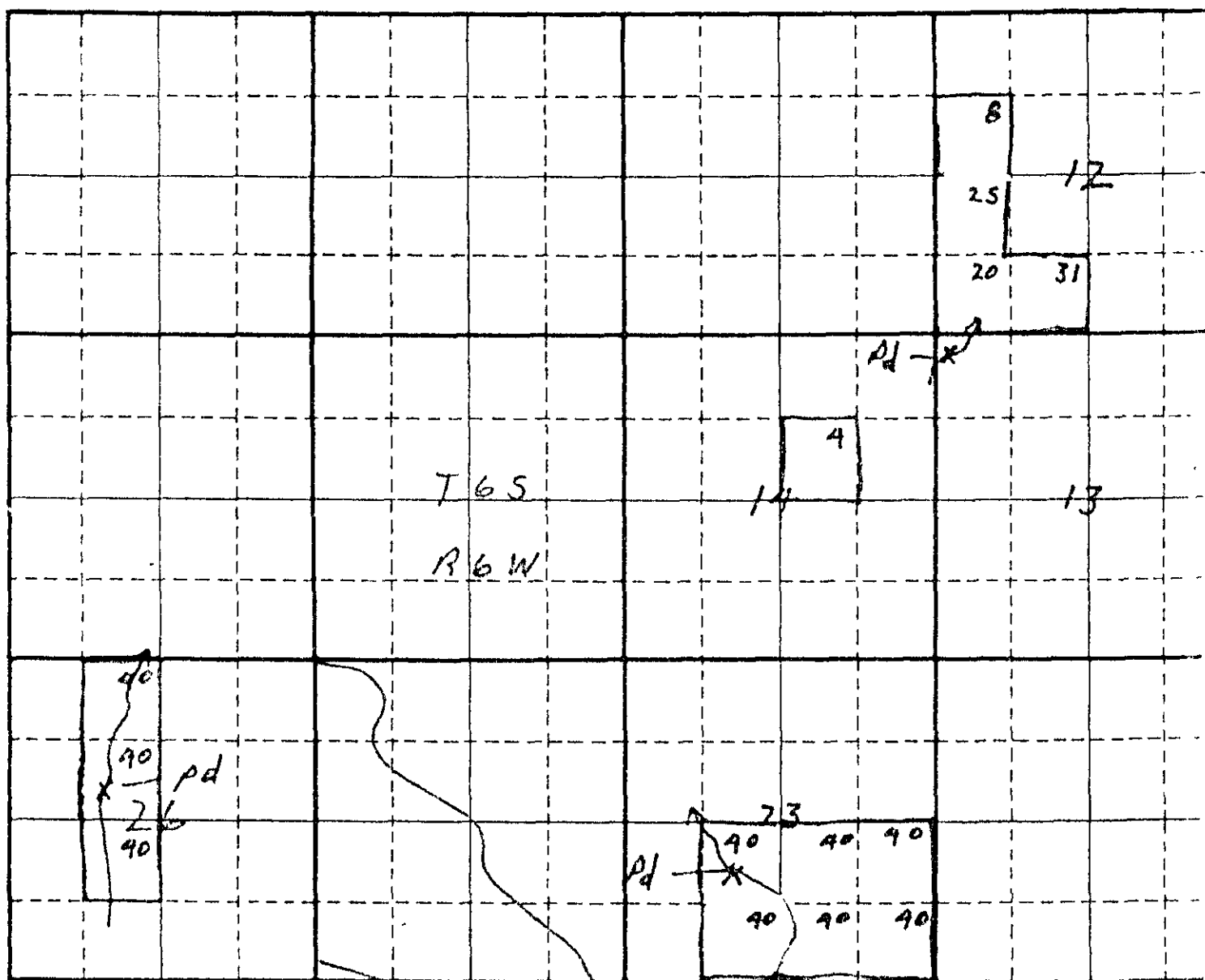

Scale 2 inches equal 1 mile.

Map should show the location of the point of diversion and the place of use of the water by 40-acre subdivisions section, township and range of the public land survey system.

State of Idaho)
County of Ada) ss.

Be it known that the undersigned, being duly sworn, deposes and says that he, she, they subscribed the foregoing claim to a water right, together with all attached information, and that the matters and facts therein are true to the best of the affiant's knowledge.

Thomas R. Gluck
(Claimant)

Sworn to before me this 19th day of October, 1981.

Nancy M. Northway
Notary Public
Residing at Boise

My commission expires Life

FOR DEPARTMENT USE ONLY

Received by KG Date 10/20/81 Exception filed by _____ Fowarded to _____ Date _____
Prelim. check by KG Date 10/20/81 claimant by _____
\$20.00 fee received by no fee Date _____
Published in Owensboro Journal _____
Dates 11/05 & 11/12/81 _____

PROOF OF PUBLICATION

STATE OF IDAHO, County of Owyhee, s.s.

I, RODNEY A. HAWES, being first duly sworn, on oath says that he is the Publisher of the OWYHEE NUGGET, a newspaper of general circulation, published weekly by Rodney A. Hawes, publisher and printer thereof, at Marsing, County of Owyhee, State of Idaho;

That the annexed notice was published in said newspaper once a week and every week for 2 consecutive weeks, the first publication being on the 5 day of Nov., 1981, and the last publication being on the 12 day of Nov., 1981;

That the said newspaper has been published continuously and uninterruptedly in said county during a period of more than seventy - eight consecutive weeks prior to the first publication of the attached notice.

Rodney A. Hawes
PUBLISHER

Subscribed and sworn to before me this 12 day of

November, 1981.

Leona S. Hawes
NOTARY PUBLIC

My commission expires 9-10-84

(SEAL)

JAN 5 1981

Department of Water Resources
Western Regional Office

STATE OF IDAHO
DEPARTMENT OF WATER RESOURCES



CLAIM TO A WATER RIGHT

Under the provisions of Section 42-243, Idaho Code, any person using or claiming rights to the public waters of Idaho established by diversion and application to a beneficial use must file a claim with the Department of Water Resources on or before June 30, 1983. Exempted from this filing are single family domestic uses as defined in Section 42-230(d), Idaho Code. Also exempted are rights represented by a permit, license, decree, adjudicated right, or a previously filed claim.

The filing of this claim does not confirm the water right claimed but failure to file may result in forfeiture of a water right.

Notice is hereby given that Thomas R. &/or Anita L. Gluch
(Name of Claimant)

Box 257, Jordan Valley, OR 97910 Telephone No. 208-583-2287
(Mailing Address) (Zip Code)

claims a right to the diversion and beneficial use of the surface or ground water. The extent and nature of said claim is as follows

(1) Date of priority: (When was the water first applied to a beneficial use) 1/1/1887

A claim is not acceptable on a ground water source with a priority later than March 25, 1963 or on a surface water source with a priority later than May 20, 1971. An exception is that a claim may be filed on single family domestic use from a ground water source.

(2) Describe the source of water: (Name of stream, lake, spring, etc., or ground water)
Lone Tree Creek tributary to Jordan Creek

(3) Describe the purpose for which the water has been used and the time during the year when you have used the right claimed.

(cfs, gpd, AFA)		(Domestic, Irrigation, Stock, Etc.)		(Both dates inclusive)	
				(Mo., Day)	(Mo., Day)
Quantity	<u>9.68</u>	Use	<u>Irrigation</u>	Period of Use From <u>4/1</u>	To <u>11/1</u>
Quantity		Use		Period of Use From	To
Quantity		Use		Period of Use From	To
Quantity		Use		Period of Use From	To
Quantity		Use		Period of Use From	To

(4) 9.68 cfs TOTAL QUANTITY USED.
(cfs, gpd, AFA)

(5) A) Point of diversion (Location of point where water is diverted from its source)
NE 1/4 SW 1/4, Sec. 23 Twp 6S Rge. 6W B.M., County of Owyhee
Additional points of diversion: SE NW, Sec. 26, NWNW, Sec. 13, all in T6S, R6W

B) Describe means of diversion of water (Pump and pipeline, well, diversion dam, reservoir, length of ditch and field, etc.) Give sizes and capacities be as specific as possible. Describe any changes in the system and give the date of the change.
Check dam in creek in to gravity ditch

(6) A) Describe location of use by listing number of irrigated acres within each 40-acre tract in appropriate box. If use is not for irrigation, place an "X" in appropriate box to show location.

T	R	SEC.	NE%				NW%				SW%				SE%				TOTAL
			NE%	NW%	SW%	SE%	NE%	NW%	SW%	SE%	NE%	NW%	SW%	SE%	NE%	NW%	SW%	SE%	
6S	6W	14			4														4
		23									40			40	40	40	40	40	240
		26					40			40	40								120
		12							8			25	20	31					84

No. of acres 448

B) If water is used for other than irrigation, fully describe that use, being as specific as possible

NOTE Include here the type and number of stock watered.

(7) If you are claiming water as a member of an organization, list name of organization

(8) Remarks _____

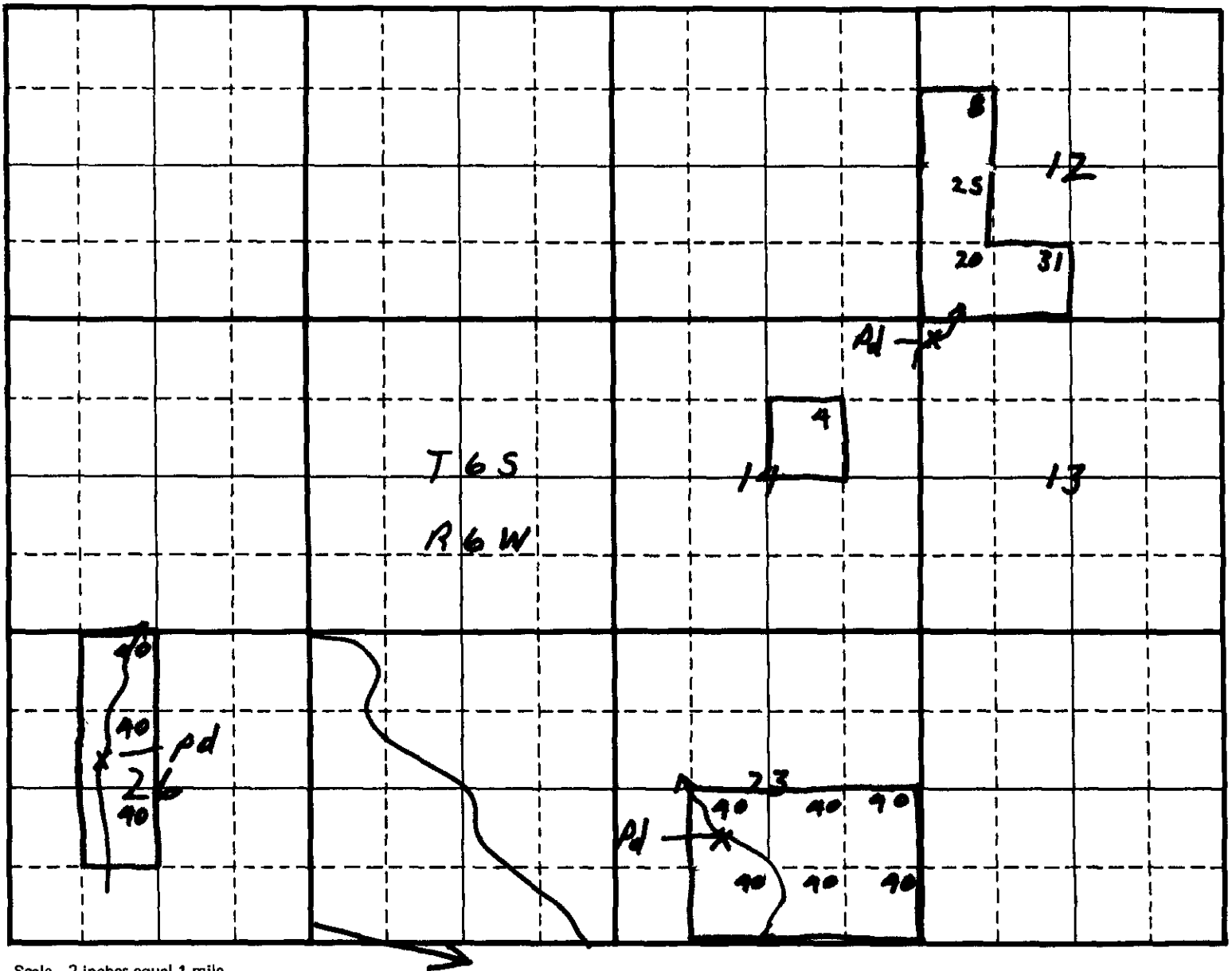

Map should show the location of the point of diversion and the place of use of the water by 40-acre subdivisions, section, township and range of the public land survey system.

State of Idaho)
County of ADA) ss.

Be it known that the undersigned, being duly sworn, deposes and says that he, she, they subscribed the foregoing claim to a water right, together with all attached information, and that the matters and facts therein are true to the best of the affiant's knowledge.

Thomas R. Gluck
(Claimant)

Sworn to before me this 16 day of DECEMBER, 1980.

[Signature]
Notary Public
Residing at BOISE, ID

My commission expires LIFE

FOR DEPARTMENT USE ONLY

Received by <u>CHS</u>	Date <u>12/16/80</u>	Exception filed by.	Forwarded to	Date
Prelim check by <u>JG</u>	Date		claimant by	
\$20.00 fee received by <u>WIK</u>	Date <u>12/24/80</u>	<u>#17220</u>	<u>LER</u>	<u>2/18/81</u>
Published in <u>Owyhee Nugget</u>				
Dates <u>1/1 - 1/8/80</u>				

PROOF OF PUBLICATION

STATE OF IDAHO, County of Owyhee, s.s.

I, RODNEY A. HAWES, being first duly sworn, on oath says that he is the Publisher of the OWYHEE NUGGET, a newspaper of general circulation, published weekly by Rodney A. Hawes, publisher and printer thereof, at Marsing, County of Owyhee, State of Idaho;

That the annexed notice was published in said newspaper once a week and every week for 2 consecutive weeks, the first publication being on the 26 day of Feb, 1981, and the last publication being on the 5 day of March, 1981;

That the said newspaper has been published continuously and uninterruptedly in said county during a period of more than seventy - eight consecutive weeks prior to the first publication of the attached notice.

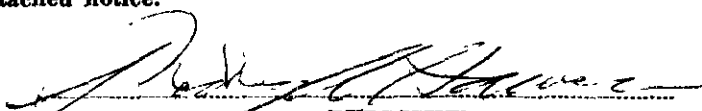
PUBLISHER

Subscribed and sworn to before me this 5 day of

March, 1981.

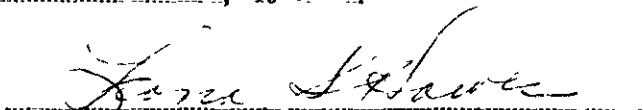
NOTARY PUBLIC

My commission expires 9-10-84

(SEAL)

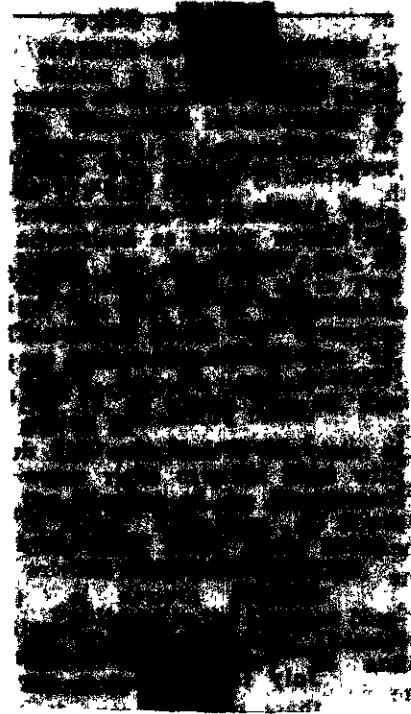

O.K.
new

PROOF OF PUBLICATION

STATE OF IDAHO, County of Owyhee, s.s.

I, RODNEY A. HAWES, being first duly sworn, on oath says that he is the Publisher of the OWYHEE NUGGET, a newspaper of general circulation, published weekly by Rodney A. Hawes, publisher and printer thereof, at Marsing, County of Owyhee, State of Idaho;

That the annexed notice was published in said newspaper once a week and every week for 2 consecutive weeks, the first publication being on the 1 day of January, 1981, and the last publication being on the 8 day of January, 1981;

That the said newspaper has been published continuously and uninterruptedly in said county during a period of more than seventy - eight consecutive weeks prior to the first publication of the attached notice.

Rodney A. Hawes
PUBLISHER

Subscribed and sworn to before me this 8 day of

January, 1981.

James L. Shores

NOTARY PUBLIC

My commission expires 9-10-84

(SEAL)

MICROFILMED

RECEIVED

FEB 2 1981

Department of Water Resources
Western Regional Office

noted
corrected

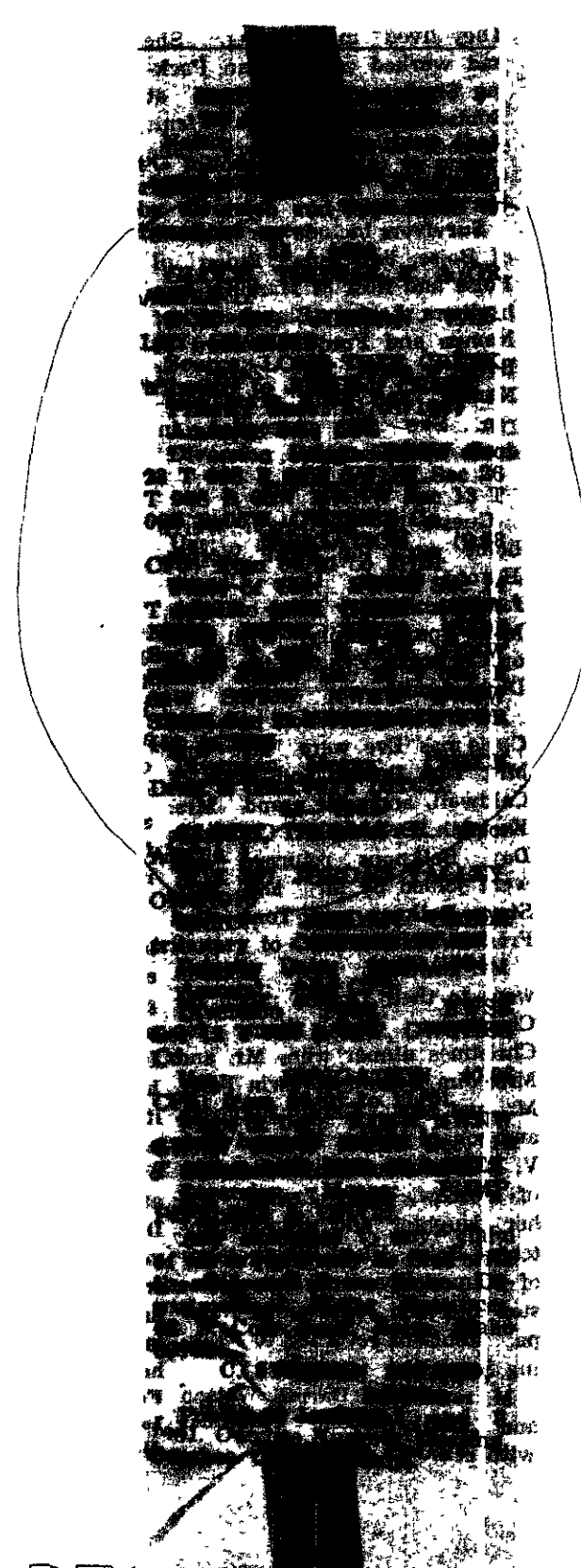

State of Idaho
Department of Water Resources

AMENDED CLAIM ANALYSIS SHEET

INITIAL REVIEW BY: *Jan Gracie*

Right Number *ES-4000* Applicant *Gluck*

NOTE: IF ANY OF THE ITEMS BELOW ARE MISSING, THE CLAIM IS INCOMPLETE AND MUST BE RETURNED IMMEDIATELY TO THE CLAIMANT ALONG WITH THE APPROPRIATE COVER LETTER.

CHECK:

- ☒ Name and address.
- ☒ Date of priority. (Check for a date past the mandatory filing dates.) (One date only.)
- ☒ Source.
- ☒ Quantity, use, period.
- ☒ Point(s) of diversion.
- ☒ Location of use.
- ☒ Signature/notarization/fee.

FINAL REGIONAL PROCESSING REVIEW:

- ☐ Affidavit of publication received. *original request*
- ☐ Claim published correctly. *4/05 & 4/12/81*
- ☒ Exceptions processed.

By _____ Date _____

STATE OFFICE PROCESSING:

- ☒ Claim review complete.

By *CHS* Date *2/5/82*

RECEIVED
FEB 05 1982

Department of Water Resources

STATE OF IDAHO
DEPARTMENT OF WATER RESOURCES
Western Region

92 South Cole Road
Boise, Idaho 83709
(208) 334-2190

NOVEMBER 25, 1981

THOMAS R. GLUCH
ANITA L. GLUCH
P.O. BOX 257
JORDAN VALLEY OR 97910

RE: Claim No. 55-4060

Dear Claimant:

The Department of Water Resources has completed the advertising of your claim to a water right, and no further action is authorized under Section 42-243 and 42-244, IDAHO CODE. Your claim will be retained in our files and will be available at any time for use by you or the court.

The filing and advertising of the claim does not confirm the water right claimed, but will serve to record and preserve the information and the evidence which you included in your claim.

If, at a later date, you find that you have additional information or supporting evidence that you would like to have included with the claim, you may have that information or evidence added at any time. Please refer to the claim identification number when corresponding with this office.

We are enclosing a copy of your claim for your records. If you have questions, or if this office may be of further assistance, please feel free to contact us.

Yours truly,

DAVID B. SHAW
Western Region Supervisor

Enclosure

AMENDED

NOTICE OF CLAIMS TO WATER RIGHTS

Notice is hereby given that the following claim(s) to water right(s) have been established by diversion and application to beneficial use:

Any exception to any claim of water right may be filed with the Director of the Idaho Department of Water Resources, 92 S. Cole Road, Boise, Idaho 83709.

A. KENNETH DUNN

Director

Published 11/05 & 11/12/81.

STATE OF IDAHO
DEPARTMENT OF WATER RESOURCES
Western Region

92 South Cole Road
Boise, Idaho 83709
(208) 334-2190

OCTOBER 29, 1981

Dwyrhee Nusset
Marsing, ID 83639

Gentlemen:

Enclosed you will find a legal notice which we wish to have published on the dates indicated (once a week for two consecutive weekly issues) in your newspaper. We have allowed ample time for you to submit a galley proof to this office for review before the first publication date. If you cannot publish the notice on the proposed dates, please contact us immediately.

An affidavit of publication must be submitted to the Department along with the publication bill. Your cooperation is appreciated.

Please send the affidavit of publication and publication billing to this office before NOVEMBER 23, 1981.

Yours truly,

HELEN L. HARRINGTON
Secretary

Encl.

AMENDED
55-4060

GLUCH, THOMAS R. &/or ANITA L.

P.O. BOX 257, JORDAN VALLEY, OR 97910

Source: LONE TREE CREEK tributary to JORDAN CREEK

Priority Date: 01/01/1887

Amount: 9.77 CFS

Diversion Point: NESW Sec 23 T 06S R 06W SWNW Sec 26 T 06S R 06W NWNW
Sec 13 T 06S R 06W, Owyhee Co.

Use: IRRIGATION (9.68 CFS) from 04/01 to 11/01
STOCKWATER (0.09 CFS) from 01/01 to 12/31

Place of Use: SWNE Sec 14 T 06S R 06W NESW SESW NESE NWSE SWSE SESE
Sec 23 T 06S R 06W NENW SENW NESW Sec 26 T 06S R 06W SWNW NSW
SWSW SESW Sec 12 T 06S R 06W FOR 448 ACRES

Diversion Means: CHECK DAM & GRAVITY DITCH

State of Idaho
Department of Water Resources

CLAIM ANALYSIS SHEET

INITIAL REVIEW BY: JG

Right Number 55-4060 Applicant Gluck

NOTE: IF ANY OF THE ITEMS BELOW ARE MISSING, THE CLAIM IS INCOMPLETE AND MUST BE RETURNED IMMEDIATELY TO THE CLAIMANT ALONG WITH THE APPROPRIATE COVER LETTER.

CHECK:

- ☒ Name and address.
- ☒ Date of priority. (Check for a date past the mandatory filing dates.) (One date only.)
- ☒ Source.
- ☒ Quantity, use, period.
- ☒ Point(s) of diversion.
- ☒ Location of use.
- ☒ Signature/notarization/fee.

FINAL REGIONAL PROCESSING REVIEW: web

- ☒ Affidavit of publication received.
- ☒ Claim published correctly.
- ☐ Exceptions processed. none

By DBS Date 3/16/81

STATE OFFICE PROCESSING:

- ☒ Claim review complete.

By Maureen Date 3/18/81

NOTICE OF CORRECTION

Notice is hereby given that notice of Claim to a Water Right No. 55-4060 in the name of Thomas R. &/or Anita L. Gluch was published in error on 1/1 and 1/8/81.

The points of diversion were advertised as being within the NESW, Sec. 23, SWNW, Sec. 26 and NWNW, Sec. 13, all in Twp 6S, Rge 6W, B.M. WHEREAS, the actual points of diversion are within the NESW, Sec. 23, SENW, Sec. 26, and NWNW, Sec. 13, all within Twp 6S, Rge 6W, B.M.

Any exception to this claim of water right may be filed with the Director of the Department of Water Resources, 92 South Cole Road, Boise, Idaho 83709.

C. STEPHEN ALLRED

Director

Published in the Owyhee Nugget on 2/26 and 3/5/1981.

RECEIVED
FEB 28 1981

NOTICE OF CLAIMS TO WATER RIGHTS

Notice is hereby given that the following claim(s) to water right(s) have been established by diversion and application to beneficial use:

Any exception to any claim of water right may be filed with the Director of the Idaho Department of Water Resources, 92 S. Cole Road, Boise, Idaho 83709.

C. STEPHEN ALLRED

Director

Published 1/1 & 1/8/81.

MICROFILMED

55-4060-

GLUCH, THOMAS R. &/or ANITA L.

BOX 257, JORDAN VALLEY, OR 97910

Source: LONE TREE CREEK tributary to JORDAN CREEK

Priority Date: 01/01/1887

Amount. 9.68 CFS

Diversion Point: NESW Sec 23 T 06S R 06W SWNW Sec 26 T 06S R 06W NWNW
Sec 13 T 06S R 06W. Owyhee Co.

Use IRRIGATION (9.68 CFS) from 04/01 to 11/01

Place of Use: SWNE Sec 14 T 06S R 06W NESW SESW NESE NWSE SWSE SESE
Sec 23 T 06S R 06W NENW SENW NESW Sec 26 T 06S R 06W SWNW NWSW
SWSW SESW Sec 12 T 06S R 06W FOR 448 ACRES

Diversion Means: CHECK DAM & GRAVITY DITCH.

MICROFILMED

STATE OF IDAHO
DEPARTMENT OF WATER RESOURCES
Western Region

92 South Cole Road
Boise, Idaho 83709
(208) 334-2190

JANUARY 21, 1981

THOMAS R. GLUCH
ANITA L. GLUCH
BOX 257
JORDAN Valley OR 97910

RE: Claim No. 55-4060

Dear Claimant:

The Department of Water Resources has completed the advertising of your claim to a water right, and no further action is authorized under Section 42-243 and 42-244, IDAHO CODE. Your claim will be retained in our files and will be available at any time for use by you or the court.

The filing and advertising of the claim does not confirm the water right claimed, but will serve to record and preserve the information and the evidence which you included in your claim.

If, at a later date, you find that you have additional information or supporting evidence that you would like to have included with the claim, you may have that information or evidence added at any time. Please refer to the claim identification number when corresponding with this office.

We are enclosing a copy of your claim for your records. If you have questions, or if this office may be of further assistance, please feel free to contact us.

Yours truly,

DAVID B. SHAW
Western Region Supervisor

Enclosure

MICROFILMED