

**MICROFILMED**

**JUN 21 1990**



POOR QUALITY

JUN 21 1990

POOR QUALITY

JUN 21 1990

The above value of Silver  
Sheet of the above described  
composition to the price  
on this system, without in-  
crease of material & price  
of the Gold. Should the  
above composition be  
adoptioned with this



(1315.30')  
1315.40'

BRUNEAU

1311.00'

HIGHWAY

BASIS OF BEARING:  
1977 Davenport Eng. Survey  
for Bud Shields

THIS SKETCH IS MADE SOLELY TO ASSIST  
IN LOCATING THE PROPERTY. THE COMPANY  
ASSUMES NO LIABILITY FOR VARIATION,  
IF ANY WITH AN ACTUAL SURVEY.

Find 1/2" rebar 0.06' East  
& 4.43' North of 1/16 cor.

4.40'  
8.10'  
12.3' 12.3'  
Permanent 25.00' ingress—

(S. 89°32'40" W. - Inst. #151317)

N. 89°54'00" E. 1998.22'

N. 0°39'34" W. 466.85'

existing wood fence

2.879 ACRES

cattle guard

S. 89°54'00" W. 318.25'

S. 89°54'00" W. 2322.43'

N. 84°37'16" E. 206.76'

approximate mean high water line  
S. 13°37'54" E. 499.73'

RIVER

S. 13°37'54" E.  
25.71'

SNAKE

Microfilm

JUN 21 1980

Compliments of:  
OWYHEE COUNTY TITLE CO.  
P.O. Box 8 495-2589  
Murphy, ID 83650









T3N NENW  
R4W 60r Lt8  
sec 34

MICHIGAN  
AUG 06 1998





Spring +  
Pump



p/u

MICROFILMED  
AUG 06 1998

57-07520

**STATE OF IDAHO**  
**IDAHO DEPARTMENT OF WATER RESOURCES**  
**NOTICE OF CHANGE OF WATER RIGHT OWNERSHIP**

**RECEIVED**  
**OCT 26 1999**  
 DEPARTMENT OF WATER RESOURCES

Please print or type. Attach pages with additional information. Instructions are on the back of this page.  
 Incomplete forms will be returned.

1. Water Right No(s): 57-07520  
 Adjudication Claim No(s): \_\_\_\_\_

2. The following **REQUIRED** information must be submitted with this form:

A. A copy of the most recent **DEED, TITLE POLICY, CONTRACT OF SALE** or other legal document indicating your ownership of the property and water rights or claims in question, **WITH ATTACHED LEGAL DESCRIPTION.**

**AND**

B. **PLAT OF PROPERTY** or **SURVEY MAP** showing the location of the place of use of the water right(s) or claim(s). (These are usually attached to your deed or on file with the county.)

**OR**

C. If your water right or adjudication claim is for ten or more acres of irrigation, you must submit a USDA Farm Service Agency **AERIAL PHOTO** with the irrigated acres outlined and point(s) of diversion clearly marked. The **AERIAL PHOTO** should be submitted in place of the **PLAT OF PROPERTY** or **SURVEY MAP**.

3. Name and Address of Former  
 Owner/Claimant

VANCE VAN HALL

4. New Owner/Claimant(s)

ROGER AND /OR SHARON MCILWEEEN

Name Connector (Check one): ☐ and, ☐ or, ☐ and/or

New Mailing Address

RT. 1 BOX 16

City, State and ZIP Code

MARSING ID 83639

New Telephone Number

(208) 896-5474

5. Date you acquired the property

8.13.99

6. Did you acquire all of the former owner's property? If you did, skip this item and go to item 7. If you acquired only a portion of the former owner's property, IDWR may need to split the water right(s) or adjudication claim(s). Describe in detail your portion of each water right or adjudication claim in the spaces in the box below **only if the water right(s) or claim(s) need to be split between owners**. If necessary, attach additional pages. If a water right or adjudication claim is being split and you are not sure how to identify your portion of the original right or claim, please contact the nearest IDWR office for assistance.

Number of acres you irrigate with this water right 1 Number and type of stock 0

Diversion rate in CFS 0.03 Number of homes you acquired 1 Other uses \_\_\_\_\_

7. Signature of New Owner(s)  
 or Claimant(s)

Sharon J. McIlwheen

Corporations or other organizations must submit a list of directors and/or officers demonstrating authority to sign form.

8. For Snake River Basin Adjudication Claims: Please attach a Notice of Appearance completed by your attorney, if you wish IDWR to correspond with him or her for all matters related to your claims.



## INSTRUCTIONS

This form has been prepared to assist new owners of property to comply with the requirements of Sections 42-248 and 42-1409(6), Idaho Code. Section 42-248 requires certain property holders to notify the Department of Water Resources (IDWR) of any change in mailing address or ownership of all or part of a water right record on file with IDWR. Section 42-1409(6) provides that new property owners must notify IDWR of any change in ownership of a water right during an adjudication of water rights. Required claims may be filed by a new owner.

Separate brochures are available from IDWR describing the adjudication of water rights and the requirement to notify IDWR of changes in ownership. Please contact your nearest IDWR office, or call 1-800-451-4129, if you would like more information or need help completing this form. Please attach additional sheets to the form if you require additional space to describe or explain any of the items on the form.

1. If there are water rights associated with the property, the seller should be able to provide you with the water right or adjudication claim number(s). Please enter these number(s) at Item 1. If you or the seller believes there are water rights for the property but the numbers are unknown, you may wish to contact IDWR for assistance in identifying the water rights for the property in question. If claims for the rights are required, and have not been filed, IDWR will so advise you.
2. The information described at Item 2 is required, since IDWR cannot process the requested change without documentation of ownership. The preferred types of documentation are shown; contact IDWR if you have difficulty obtaining this information. Do not obtain a new survey for purposes of this form before contacting IDWR.
3. Please provide the name and address of the former owner of the water right and/or adjudication claim at Item 3.
4. The name, mailing address, and telephone number of the new owner(s) is entered at Item 4. Please indicate the relationship between multiple owners by using the connector 'and', 'or', or 'and/or'. If an 'and' is used, all parties must sign this form. If an 'and/or' or 'or' is used, all parties may sign. However, only one of the named parties is required to sign.
5. At Item 5, please provide the date the property in question was acquired. This may be the date of "closing" in the case of a real estate transaction or the date of court order for other types of ownership changes.
6. You may be purchasing only a portion of the total water right held by the seller. This means the water right held by the seller may be "split" to provide your share of the right in question. Be sure to include a description of the portion of the water right you have purchased at Item 6.

Please provide as much detail as possible concerning your portion of the water right: include the number of homes you acquired, number of acres irrigated with your portion of the right, if it is more than 1/2 acre, type and number of stock if your portion of the right includes stockwater, etc. In the absence of information to the contrary, IDWR will assume the intent is to split the rights proportionately.

7. The new owner(s) must sign the form in the space(s) provided at Item 7. Corporations and other organizations must submit a list of directors or officers demonstrating the authority of the director or officer to sign the form.
8. There is no filing fee. When complete, you should retain a copy and return the original of the form to the IDWR office nearest you:

IDWR Western Region  
2735 Airport Way  
Boise, ID 83705-5082  
(208) 334-2190

IDWR Southern Region  
1341 Fillmore St., Suite 200  
Twin Falls, ID 83301-3380  
(208) 736-3033

IDWR Northern Region  
1910 Northwest Blvd., Suite 210  
Coeur d'Alene, ID 83814-2615  
(208) 769-1450

IDWR Eastern Region  
900 N. Skyline Dr., Suite A  
Idaho Falls, ID 83402-1718  
(208) 525-7161



THIS FORM FURNISHED COURTESY OF:

229432

FILED - RECORD 11  
99 AUG 13 PM 2:57

ALLIANCE TITLE &  
ESCROW CORP.

REQUIS FOR  
FEE

*[Signature]*

READ & APPROVED BY GRANTEE(S):

SPACE ABOVE THIS LINE FOR RECORDING DATA  
Order No.: 99021255 EBN

### WARRANTY DEED

FOR VALUE RECEIVED JOE F. RINKE and WILMA E. RINKE, husband and wife

GRANTOR(S), does(do) hereby GRANT, BARGAIN, SELL and CONVEY unto ROGER MCILVEEN  
and SHARON MCILVEEN, husband and wife

GRANTEE(S), whose current address is: 1010 WINSOR STREET, SAN JOSE, CA 95129  
the following described real property in OWYHEE County, State of Idaho, more particularly  
described as follows, to wit

As set forth on the attached EXHIBIT "A", which by this  
reference becomes a part hereof.

FILED - RECORD 10

229517

99 AUG 19 PM 2:06

WARRANT OF  
*[Signature]*

C. 11  
DE *[Signature]*

\* RE Recorded to attach legal description

TO HAVE AND TO HOLD the said premises, with their appurtenances unto the said Grantee(s), and  
Grantee(s) heirs and assigns forever. And the said Grantor(s) does(do) hereby covenant to and with the said  
Grantee(s), that Grantor(s) is/are the owner(s) in fee simple of said premises; that said premises are free from  
all encumbrances, EXCEPT those to which this conveyance is expressly made subject and those made, suffered  
or done by the Grantee(s); and subject to reservations, restrictions, dedications, easements, rights of way and  
agreements, (if any) of record, and general taxes and assessments, (including irrigation and utility assessments,  
if any) for the current year, which are not yet due and payable, and that Grantor(s) will warrant and defend  
the same from all lawful claims whatsoever.

Dated: August 13, 1999

\* *[Signature]*  
JOE F. RINKE

\* *[Signature]*  
WILMA E. RINKE

STATE OF Idaho  
COUNTY OF Canyon }

On this 13th day of August, in the year of 1999, before me, the undersigned, a Notary  
Public in and for said State, personally appeared JOE F. RINKE and WILMA E. RINKE

known or identified to me to be the person(s) whose name(s) is/are subscribed to the within instrument, and  
acknowledged to me that he/she/they executed the same.

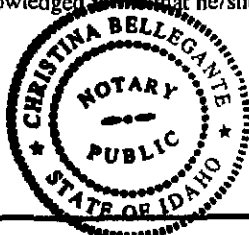

Signature: *[Signature]*

Name: *[Signature]*

Residing at: *[Signature]*

My Commission Expires: 10/22/2001



EXHIBIT "A"

PARCEL I

This is a portion of Government Lot 8 of Section 34, Township 3 North, Range 4 West, of the Boise Meridian, Owyhee County, Idaho, and is more particularly described as follows:

COMMENCING at the Northwest corner of said Section 34;  
thence  
South 00 degrees 13'20" East a distance of 1,311.00 feet;  
thence  
North 89 degrees 54'00" East a distance of 1,998.22 feet  
to the TRUE POINT OF BEGINNING; thence  
North 00 degrees 39'34" West a distance of 414.02 feet;  
thence  
North 84 degrees 37'16" East a distance of 218.74 feet to  
a point on the mean high water line of the Westerly  
bank of the Snake River; thence  
South 13 degrees 37'54" East along the meander of said  
high water line a distance of 446.52 feet;  
thence  
South 89 degrees 54'00" West a distance of 318.25 feet to  
the TRUE POINT OF BEGINNING.

PARCEL II

A portion of Government Lot 8 of Section 34, Township 3 North, Range 4 West, Boise Meridian, Owyhee County, Idaho, more particularly described as follows:

COMMENCING at the Northwest corner of said Section 34;  
thence  
South 89 degrees 37'06" East along the North boundary of  
said Section 34 a distance of 1,322.61 feet; thence  
South 00 degrees 13'20" East a distance of 331.13 feet;  
thence  
South 06 degrees 59'25" East a distance of 774.50 feet  
to the TRUE POINT OF BEGINNING; thence  
North 60 degrees 26'36" East a distance of 651.65 feet;  
thence  
North 84 degrees 37'16" East a distance of 206.76 feet  
to a point on the mean high water line of the  
Westerly bank of the Snake River; thence  
South 13 degrees 37'54" East along the meander of said  
high water line a distance of 108.20 feet; thence  
South 84 degrees 37'16" West a distance of 218.74 feet  
to a point on the Westerly boundary of the Parcel  
shown on the Record of Survey recorded as  
Instrument No. 202090, records of Owyhee County;  
thence  
South 00 degrees 39'34" East along said boundary a distance



Continuation of Exhibit A

Order No.:99021255 EBN

of 414.02 feet to the Southwest corner of said Parcel;  
thence  
South 89 degrees 54'00" West a distance of 560.68 feet; thence  
North 06 degrees 59'25" West a distance of 201.30 feet to  
the TRUE PINT OF BEGINNING.

PARCEL III

A non-exclusive easement for ingress and egress as  
Created by WARRANTY DEED  
Grantor VANCE VAN HALL, A MARRIED MAN AS HIS SOLE  
AND SEPARATE PROPERTY  
Grantee JOE F. RINKE AND WILMA E. RINKE, HUSBAND AND  
WIFE  
Recorded JUNE 7, 1994  
Instrument No. 212968

This parcel includes use of and is subject to an  
ingress-egress and drainage easement described as follows:

COMMENCING at the Northwest corner of Section 34, Township  
3 North, Range 4 West, Boise Meridian; thence  
South 89 degrees 37'06" East along the North boundary  
of said Section 34 a distance of 1,322.61 feet;  
thence  
South 00 degrees 13'20" East a distance of 331.13 feet;  
thence  
South 89 degrees 37'06" East parallel with said North  
boundary a distance of 103.02 feet to the TRUE  
POINT OF BEGINNING of said easement; thence  
South 00 degrees 55'54" East a distance of 967.99 feet  
to a point on the North boundary of the easement  
shown in the document filed as Instrument No.  
151317, records of Owyhee County; thence  
North 89 degrees 54'00" East (Record North 89 degrees  
52'40" East) along said boundary a distance of  
35.00 feet; thence  
North 00 degrees 55'54" West a distance of 967.99 feet;  
thence  
North 89 degrees 37'06" West a distance of 35.00 feet  
to the TRUE POINT OF BEGINNING for said easement.



State of Idaho  
Department of Water Resources  
**Water Right License**

**WATER RIGHT NO. 57-07520**

**Priority:** February 15, 1990

Maximum Diversion Rate:

0.03 CFS

Maximum Diversion Volume:

4.5 AF

This is to certify, that VANCE VAN HALL

RT 1 BOX 16

MARSING ID 83639

has complied with the terms and conditions of the permit, issued pursuant to Application for Permit dated February 15, 1990; and has submitted Proof of Beneficial Use on February 23, 1994. An examination indicates that the works have a diversion capacity of 0.170 cfs of water from:

**SPRING**

tributary to **SNAKE RIVER**

source, and a water right has been established as follows:

<u>BENEFICIAL USE</u>	<u>PERIOD OF USE</u>	<u>RATE OF DIVERSION</u>	<u>ANNUAL VOLUME</u>
IRRIGATION	03/15 to 11/15	0.03 CFS	4.5 AF

LOCATION OF POINT(S) OF DIVERSION: Lot 8 (SENENW), Sec. 34, Township 03N, Range 04W  
OWYHEE County

PLACE OF USE: IRRIGATION

<u>TWN</u>	<u>RGE</u>	<u>SEC</u>	<u>ACRES</u>	<u>ACRES</u>	<u>ACRES</u>	<u>TOTAL</u>
03N	04W	34	Lot 8 (NENW)	1		1

Total number of acres irrigated: 1

CONDITIONS OF APPROVAL AND REMARKS

1. The maximum diversion volume is defined as the maximum allowable volume of water that may be diverted annually from the source under this right. The use of water confirmed by this right is limited to the amount which can actually be beneficially used. The maximum diversion volume may be adjusted to more accurately describe the beneficial use or to implement accepted standards of diversion and use efficiency.
2. This water right is appurtenant to the described place of use.
3. This right is subject to all prior water rights and may be forfeited by five years of non-use.
4. Modifications to or variance from this license shall be made within the limits of Section 42-222, Idaho Code, or the applicable Idaho law.
5. This right when combined with all other rights shall provide no more than 0.03 cfs per acre nor more than 4.5 afa per acre at the field headgate for irrigation of the lands above.

MICROFILMED

AUG 06 1998



State of Idaho  
Department of Water Resources

# Water Right License

WATER RIGHT NO. 57-07520

This license is issued pursuant to the provisions of Section 42-219, Idaho Code.  
Witness the seal and signature of the Director, affixed at Boise, this 3<sup>RD</sup>  
day of June, 1998.

  
Acting for KARL J. DREHER, Director

11-11-1998  
J. J. R. 1998



1841

OFFICE USE ONLY  
Amt. of Fee \$ 50.00  
Date 2-23-94  
Receipt No C029669  
Receipt by [Signature]

STATE OF IDAHO  
DEPARTMENT OF WATER RESOURCES

RECEIVED

FEB 23 1994

PROOF OF BENEFICIAL USE

Department of Water Resources

The Idaho Department of Water Resources considers this form a statement that the permit holder(s) has/have completed all development that will occur under this permit and that water has been applied according to the provisions of the permit for the beneficial use(s) described below. This form must be accompanied by a license examination fee, when necessary, or a completed field examination report prepared by a certified water right examiner who has been appointed by the department.

1. Permit No. 57-07520 Telephone No. 896-4848
2. Name(s) of Permit Holder(s): Vance Van Hall
3. Mailing Address: Rt. 1, Box 16 Marsing, ID 83639
4. Source of Water: Spring

If **GROUNDWATER**, Well Driller's Name: \_\_\_\_\_ Date Drilled: \_\_\_\_\_

OPTIONAL:

Pump horsepower: \_\_\_\_\_ Pressure (psi): \_\_\_\_\_ Dynamic pumping level (ft.): \_\_\_\_\_

5. Extent of Use (as authorized by the permit):

Domestic \_\_\_\_\_ (No. of households) Stockwater \_\_\_\_\_ (No. and type of stock)

Irrigation 3 (No. of acres) Other heating & cooling

6. Total rate and/or volume for which proof is submitted .13 cfs OR \_\_\_\_\_ acre/feet

7. Refer to the approval conditions on your permit and respond accordingly:

Measuring device: Required? ☐ Yes ☒ No Installed? ☐ Yes ☐ No

OR

Flow Measurement Port: Required? ☐ Yes ☒ No Installed? ☐ Yes ☐ No

8. Fee Enclosed: \$ 50.00 (See License Fee Schedule on back of Instruction Sheet)

9. Person to contact to accompany the Department representative during field examination of the water system

permit holder  
Name \_\_\_\_\_ Telephone No. \_\_\_\_\_

Address \_\_\_\_\_

10 The above information is my true statement of the extent to which the above numbered permit has been developed and I relinquish any undeveloped portion of the permit to the state of Idaho.

4-12-92  
Date

Vance Van Hall  
Signature (and title, if on behalf of a company or organization)

APR 13 1994



RECEIVED  
MAY 12 1992

For Office Use Only  
\$15 Fee Received by LLB  
Date 5-12-92  
Receipt No. 0024127

Department of Water Resources  
STATE OF IDAHO  
DEPARTMENT OF WATER RESOURCES

**REQUEST FOR EXTENSION OF TIME**  
TO PROVIDE ADDITIONAL TIME IN WHICH TO SUBMIT PROOF OF  
BENEFICIAL USE FOR A WATER RIGHT PERMIT

The Idaho Department of Water Resources will consider this form as a request that the permit holder(s) be granted an additional period of time in which to complete development of water right under the provisions of Section 42-204, Idaho Code.

Permit No. 57-07520  
Name(s) of Permit Holder: Vance Van Hall  
Mailing Address: Pt. 1 Box 16 Marsing, ID 83639  
Date Proof is Due 7/1/92 Telephone No. 896-4848

Describe what work has been completed toward the development of this water right:  
(This must be filled out! If no work has been completed, show "none".)

Am currently using the spring to irrigate  
the 3 acres.

Costing \$ \_\_\_\_\_

The permit holder(s) has been unable to complete the remainder of the work for the following reasons:

Would like additional time to purchase & install  
necessary equipment for heating & cooling

Permit holder(s) request an extension to July 1, 19 97.

FEE: \$15.00

Vance Van Hall  
(Signature)\*

\*If other than permit holder, Power of Attorney must be supplied.

ACTION OF THE DEPARTMENT OF WATER RESOURCES

**MICROFILMED**

IT IS HEREBY ORDERED that the above request for extension of time be APPROVED  
and the time within which to submit proof of beneficial use is extended to  
July 1, 1994.

MAY 19 1992

Signed this 14<sup>th</sup> day May, 19 92

A. Glen Saylor  
Chief, Water Allocation Bureau

State of Idaho  
Department of Water Resources  
**Permit To Appropriate Water**

NO. 57-07520

Proposed Priority: February 15, 1990      Maximum Diversion Rate: 0.13 CFS  
This is to certify, that **VANCE VAN HALL**

RT. 1 BOX 16  
MARSING, ID 83639

has applied for a permit to appropriate water from:

**SPRING**      tributary of **SNAKE RIVER**

and a permit is **APPROVED** for development of water as follows:

<u>BENEFICIAL USE</u>	<u>PERIOD OF USE</u>	<u>RATE OF DIVERSION</u>
IRRIGATION	03/15 to 11/15	0.09 CFS
HEATING	01/01 to 12/31	0.04 CFS
COOLING	01/01 to 12/31	0.04 CFS
Totals		0.13 CFS

LOCATION OF POINT(S) OF DIVERSION: LOT 8( NENW), Sec. 34, Township 03N, Range 04W  
OWYHEE County

PLACE OF USE: IRRIGATION

<u>TWN</u>	<u>RGE</u>	<u>SEC</u>	<u>ACRES</u>	<u>ACRES</u>	<u>ACRES</u>	<u>TOTAL</u>
03N	04W	34	LOT 8(NENW)	3		3

Total number of acres irrigated: 3

PLACE OF USE: HEATING, same as IRRIGATION use

PLACE OF USE: COOLING, same as IRRIGATION use

CONDITIONS/REMARKS:

1. Proof of construction of works and application of water to beneficial use shall be submitted on or before July 1, 1992.
2. Subject to all prior water rights.

This permit is issued pursuant to the provisions of Section 42-204, Idaho Code.  
Witness the seal and signature of the Director, affixed at Boise, this

11 day of June, 1990

for *[Signature]*  
R. Keith Higginson, Director  
**RECORDED**

JUN 21 1990



Ident. No. 57-07520

STATE OF IDAHO  
DEPARTMENT OF WATER RESOURCES

APPLICATION FOR PERMIT

To appropriate the public waters of the State of Idaho

1. Name: VANCE VAN HALL 208-896-4848  
Address: BOX 16, RT.1  
MARSING, ID 83639
2. Source: SPRING Trib. to: SNAKE RIVER
3. Location of Point of Diversion: LOT 8( NENW), Sec. 34, Township 03N, Range 04W  
OWYHEE County
4. Water will be used for the following purposes:
- | Purpose    | From  | To    | CFS   | (or) | AF |
|------------|-------|-------|-------|------|----|
| IRRIGATION | 03/15 | 11/15 | 0.090 |      |    |
| HEATING    | 01/01 | 12/31 | 0.040 |      |    |
| COOLING    | 01/01 | 12/31 | 0.040 |      |    |
5. Total quantity to be appropriated is:  
0.130 CFS (and/or) AF
6. Proposed diverting works:
- Description of ditches, flumes, pumps, headgates, etc.  
PUMP IN A SUMP, PIPED TO THE PLACE OF USE. WTR TO AIR HEAT PUMP.
  - Height of storage dam feet; active reservoir capacity  
acre-feet; total reservoir capacity acre-feet; period of  
year when water will be diverted to storage: to inclusive.
  - Proposed well diameter is inches; proposed depth of well is  
feet.
  - Is groundwater with a temperature greater than 90F being sought? NO
7. Time required for the completion of the works and application of  
the water to the proposed beneficial use is 2 years.
8. Description of proposed uses:  
HEATING AND COOLING OF 1 HOME.
9. Place of Use: IRRIGATION

TWN	RGE	SEC	ACRES	ACRES	ACRES	TOTAL
03N	04W	34	LOT 8(NENW)	3		3

Total number of acres irrigated: 3

JUN 21 1990

Place of Use: HEATING, same as IRRIGATION use  
Place of Use: COOLING, same as IRRIGATION use

10. Describe any other water rights used for the same purposes.  
PART OF RIGHT 02-2113 FOR IRRIGATION PURPOSES.

11. a. Who owns the property at the point of diversion?  
APPLICANT  
b. Who owns the land to be irrigated or place of use?  
APPLICANT  
c. If the property is owned by a person other than the applicant,  
describe the arrangement enabling the applicant to make this filing.

\* 12. Remarks:  
SEE MEMOS AND BOUNDS DESCRIPTION FOR EXACT LOCATION OF PROPERTY.  
MEMOS

13. Map of proposed point of diversion and place of use attached? [X]

BE IT KNOWN that the undersigned hereby makes application for permit to appropriate the public waters of the State of Idaho as herein set forth.

W. E. McCall  
Applicant

Received by Der Date 2/15/90 Time 11:45 Preliminary check by SP  
Fee \$ 30.00 Receipted by Der # W008950 Date 2/15/90  
Publication prepared by GG Date 2-28-90 Published in Owyhee Avalanche  
3/7 & 3/14/90  
Publication approved ST Date 4-19-90

MICROFILMED

JUN 21 1990

\* Corrected in data base 2-22-90 RS



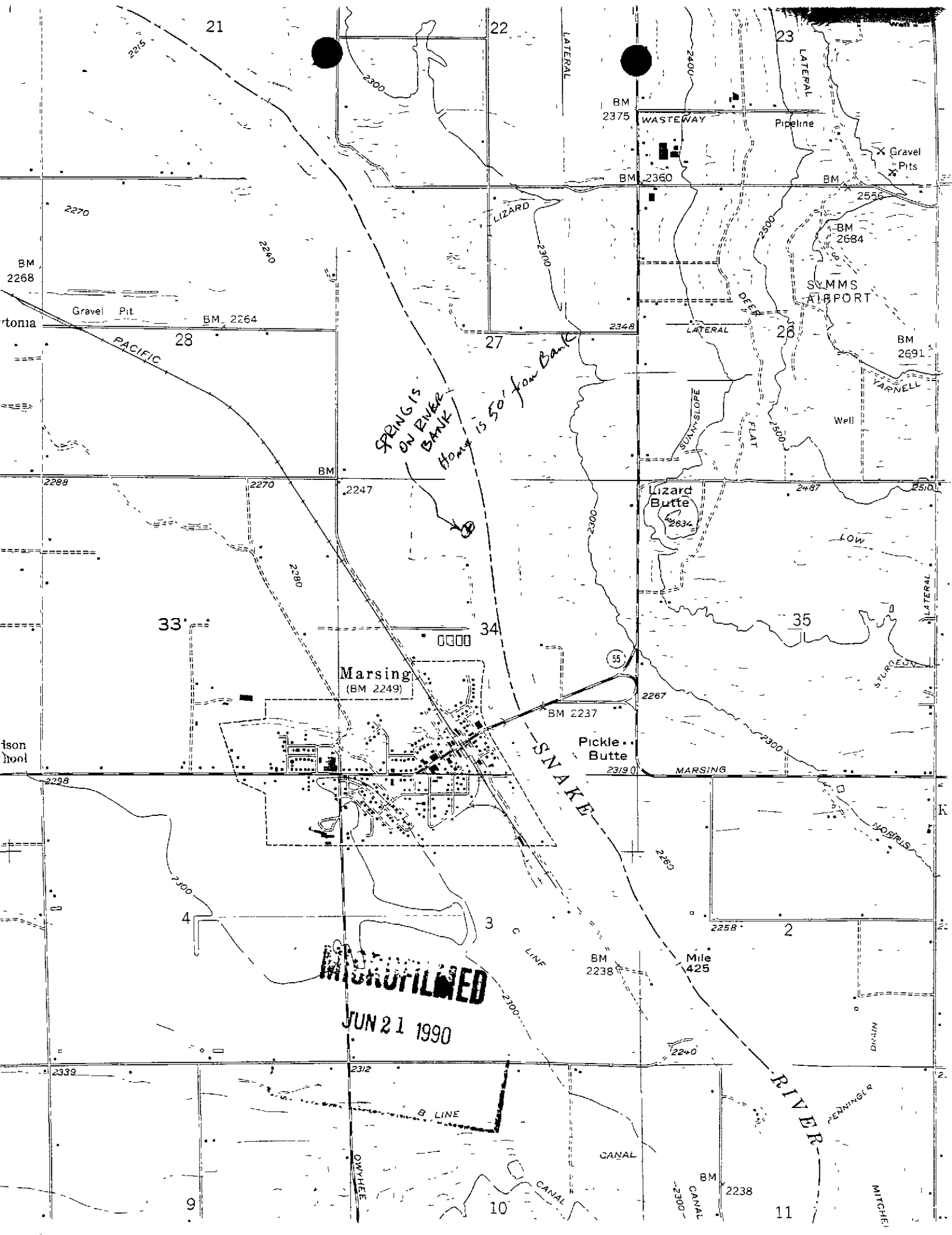





FOR TITLE INSURANCE

**SCHEDULE C**

File Number: 6496 Amended

The land referred to in this Commitment is described as follows:

PARCEL I:

IN TOWNSHIP 3 NORTH, RANGE 4 WEST, B. M., OWYHEE COUNTY, IDAHO  
Section 34: Lot 8 EXCEPTING THEREFROM a parcel of land  
described as follows:

COMMENCING at the Northwest corner of  
said Section 34; thence South 0°13'20" East along the westerly  
boundary of said Section 34 a distance of 1311.00 feet to a  
point which bears North 0°13'20" West a distance of 4.40  
feet from the southwest corner of the NW¼NW¼ of said Section  
34; Thence North 89°54'00" East a distance of 1998.22 feet  
to the TRUE POINT OF BEGINNING; thence North 0°39'34" West a  
distance of 466.85 feet; Thence North 84°37'16" East a  
distance of 206.76 feet to a point on the mean high water  
line of the Snake River; Thence South 13°37'54" East along  
said mean high water line a distance of 499.73 feet; Thence  
South 89°54'00" West a distance of 318.25 feet to the TRUE  
POINT OF BEGINNING.

PARCEL II:

A parcel of land in Government Lot 8 of Section 34, Township 3  
North, Range 4 West, B. M. Owyhee County, Idaho, more  
particularly described as follows:

COMMENCING at the Northwest corner of said Section 34;  
thence South 0°13'20" East along the westerly boundary of  
said Section 34 a distance of 1311.00 feet to a point which  
bears North 0°13'20" West a distance of 4.40 feet from the  
southwest corner of the NW¼NW¼ of said Section 34; Thence  
North 89°54'00" East a distance of 1998.22 feet to the TRUE  
POINT OF BEGINNING; thence North 0°39'34" West a distance of  
466.85 feet; Thence North 84°37'16" East a distance of  
206.76 feet to a point on the mean high water line of the  
Snake River; Thence South 13°37'54" East along said mean  
high water line a distance of 499.73 feet; Thence South  
89°54'00" West a distance of 318.25 feet to the TRUE POINT  
OF BEGINNING.

TOGETHER WITH a perpetual ingress-egress easement  
described as follows: Commencing at the northwest corner of  
said Section 34; Thence South 0°13'20" East along the  
westerly boundary of said Section 34 a distance of 1311.00  
feet to a point which bears North 0°13'20" West a distance  
of 4.40 feet from the southwest corner of the NW¼NW¼ of said  
Section 34, which point is the TRUE POINT OF BEGINNING of  
said easement; Thence North 89°54'00" East a distance of  
2316.47 feet; Thence South 13°37'54" East a distance of  
25.71 feet; Thence South 89°54'00" West a distance of 2322.43  
feet to a point on the westerly boundary of said Section 34;  
Thence North 0°13'20" West along said westerly boundary a  
distance of 25.00 feet to the TRUE POINT OF BEGINNING.

**SCHEDULE C**

Commitment

Reorder Form No 11124

RECORDED

JUN 21 1990

Compliments of:  
OWYHEE COUNTY TITLE CO.  
P.O. Box 8 495-2589  
Murphy, ID 83650

JUN 21 1990

BRUNEAU RIVER

approximate mean high water line  
S. 13°37'54" E. 499.73'

2.879 ACRES

N. 84°37'16" E. 206.76'

N. 0°39'34" W. 466.85'

S. 89°54'00" W. 318.25'

S. 89°54'00" W. 2322.43'

S. 13°37'54" E. 25.71'

cattle guard

existing wood fence

BASIS OF BEARING:

1977 Davenport Eng. Survey  
for Bud Shields

THIS SKETCH IS MADE SOLELY TO ASSIST  
IN LOCATING THE PROPERTY. THE COMPANY  
ASSUMES NO LIABILITY FOR VARIATION,  
IF ANY WITH AN ACTUAL SURVEY.

HIGHWAY

1311.00'

BRUNEAU

Find 1/2" rebar 0.06' East  
& 4.43' North of 1/18 cor.

(S. 89°52'40" W. - Inst. #151317)

N. 89°54'00" E. 1998.22'

2316.47'

12.6126'

4.40'

8.10'

Permanent 25.00' ingress-

1315.40'  
(1315.90')



Dept of Water  
Western

# THE OWYHEE AVALANCHE

P.O. BOX 97 • HOMEDALE, ID 83628 • 208/337-4681

## AFFIDAVIT OF PUBLICATION

STATE OF IDAHO )  
 )ss  
COUNTY OF OWYHEE )

I, Joe E. Aman, being first duly sworn, depose and say:

1. That I am a citizen of the United States of America, and at all times mentioned was and now over the age of twenty-one years, not a party to or in the proceedings hereinafter mentioned.

2. That during the time of the publication of the notice hereinafter mentioned I am the publisher of **The Owyhee Avalanche**, a newspaper of general interest printed and published weekly, on Wednesday of each and every week, in Homedale, County of Owyhee and State of Idaho.

3. That the said **The Owyhee Avalanche** has been printed and published and uninterruptedly in said County during a period of more than seven years prior to the first publication of the attached notice.

4. That said notice of which a printed copy, taken from said newspaper, is attached hereto, was published in the regular issue thereof, and not a supplement thereto.

Said newspaper, in 2 (two) consecutive calendar weekly issue(s) of said newspaper, in the following

March 7 & 14 1990

Signed Joe E. Aman

Subscribed and sworn to before me this 14th day of March A.D., 1990

Lisa Aman Notary Public

**RECORDED**

Notary Public in and for the State of Idaho  
Residing at Nampa, Idaho  
Commission expires October 1991

JUL 21 1990

## NOTICE OF APPLICATION FOR WATER RIGHT

The Following application(s) have been filed to appropriate the public waters of the State of Idaho:

**51-07336**

U.S. DEPT. OF INTERIOR  
BUREAU OF LAND MGMT.  
IDAHO STATE OFFICE  
3380 AMERICANA TERRACE  
BOISE, ID 83706

Source: UNNAMED STREAM Tributary: THREE CREEK  
Diversion Pt: SWNESE Sec 13 T 16S R 11E

Use: STOCKWATER	(.140 CFS)	
STOCKWATER STORAGE		(5.00 AF)
WILDLIFE	(.140 CFS)	
WILDLIFE STORAGE		(5.00 AF)
Total Diversion	(.140 CFS)	(5.00 AF)

Date Filed: 2/23/1990  
In: T16S R11E S13 NESE

**57-07520**

VAN HALL, VANCE  
RT. 1, BOX 16  
MARSING, ID 83639

Source: SPRING Tributary: SNAKE RIVER  
Diversion Pt: LOT 8 (NENW) Sec 34 T 03N R 04W

Use: IRRIGATION	(.090 CFS)
HEATING	(.040 CFS)
COOLING	(.040 CFS)
Total Diversion:	(.130 CFS)

Date Filed: 2/15/1990  
In: T03N R04W S34 Lot 8 (NENW)  
3.0 ACRES TOTAL

The permit(s) will be subject to all prior water rights. Protests must be filed with the Director, Dept. of Water Resources, Western Region, 2735 Airport Way, Boise, Idaho 83705 on or before MARCH 26, 1990.

s/R. KEITH HIGGINSON  
Director

14  
Publish March 7 & 14, 1990

**RECEIVED**

APP 03 1990

Department of Water Resources  
Western Regional Office



State of Idaho

DEPARTMENT OF WATER RESOURCES

1301 North Orchard Street, P.O. Box 83720, Boise, Idaho 83720-0098

Phone: (208) 327-7900 FAX: (208) 327-7866

October 27, 1999

DIRK KEMPTHORNE  
GOVERNOR

KARL J. DREHER  
DIRECTOR

ROGER MC ILVEEN  
SHARON MC ILVEEN  
RT 1 BOX 16  
MARSING ID 83639

RE: Water Right 57-07520

Dear Mr. & Mrs. McIlveen:

The department acknowledges receipt of correspondence changing ownership of the above referenced water right to you. The department has modified its records to reflect the change in ownership and has enclosed a computer-generated report for your records.

Please note that as of July 1, 1996, water right owners are required to report any change of water right ownership and any change of mailing address of the owner of a water right to the department. Notice of the change must be provided to the department within 120 days of the change. Change reporting forms are available from any office of the department.

Please feel free to contact the department if you have questions.

Sincerely,

A handwritten signature in cursive script, appearing to read 'Jeff Peppersack'.

Jeff Peppersack, Manager  
Water Right Permits Section

JP:klt

Enclosure





State of Idaho

DEPARTMENT OF WATER RESOURCES

1301 North Orchard Street, P.O. Box 83720, Boise, Idaho 83720-0098

Phone: (208) 327-7900 FAX: (208) 327-7866

July 6, 1998

PHILIP E. BATT  
GOVERNOR

KARL J. DREHER  
DIRECTOR

VANCE VAN HALL  
RT 1 BOX 16  
MARSING ID 83639

RE: WATER RIGHT NO. 57-07520

Dear Water Right Holder(s):

The Department of Water Resources (the Department) has issued the enclosed license confirming that a water right has been established in accordance with the permit referenced above. The license is a preliminary order issued by the Department pursuant to section 67-5243, Idaho Code. It can and will become a final order without further action of the Department unless a party petitions for reconsideration or files an exception and/or brief as further described below:

PETITION FOR RECONSIDERATION

Any party may file a petition for reconsideration of a preliminary order with the Department within fourteen (14) days of the service date of this order. The Department will act on a petition for reconsideration within twenty-one (21) days of its receipt, or the petition will be considered denied by operation of law. See section 67-5243(3), Idaho Code.

EXCEPTIONS AND BRIEFS

Within twenty-one (21) days after (a) the service date of a preliminary order, (b) the service date of a denial of a petition for reconsideration from this preliminary order, or (c) the failure within twenty-one (21) days to grant or deny a petition for reconsideration from this preliminary order, any party may in writing support or take exceptions to any part of a preliminary order and may file briefs in support of the party's position on any issue in the proceeding. Otherwise, this preliminary order will become a final order of the Department.

If any party appeals or takes exceptions to this preliminary order, opposing parties shall have twenty-one (21) days to respond to any party's appeal. Written briefs in support of or taking exceptions to the preliminary order shall be filed with the Department. The Department retains the right to review the preliminary order on its own motion.

RECORDED  
JUL 10 1998

### ORAL ARGUMENT

If the Department grants a petition to review the preliminary order, the Department shall allow all parties an opportunity to file briefs in support of or taking exceptions to the preliminary order and may schedule oral argument in the matter before issuing a final order. If oral arguments are to be heard, the Department will within a reasonable time period notify each party of the place, date and hour for the argument of the case. Unless the Department orders otherwise, all oral arguments will be heard in Boise, Idaho.

### CERTIFICATE OF SERVICE

All exceptions, briefs, requests for oral argument and any other matters filed with the Department in connection with the preliminary order shall be served on all other parties to the proceedings in accordance with Rules of Procedure 302 and 303.

### FINAL ORDER

The Department will issue a final order within fifty-six (56) days of receipt of the written briefs, oral argument or response to briefs, whichever is later, unless waived by the parties or for good cause shown. The Department may remand the matter for further evidentiary hearings if further factual development of the record is necessary before issuing a final order. The Department will serve a copy of the final order on all parties of record.

Section 67-5246(5), Idaho Code, provides as follows:

Unless a different date is stated in a final order, the order is effective fourteen (14) days after its issuance if a party has not filed a petition for reconsideration. If a party has filed a petition for reconsideration with the agency head, the final order becomes effective when:

- (a) the petition for reconsideration is disposed of; or
- (b) the petition is deemed denied because the agency head did not dispose of the petition within twenty-one (21) days.

### APPEAL OF FINAL ORDER TO DISTRICT COURT

Pursuant to sections 67-5270 and 67-5272, Idaho Code, if this preliminary order becomes final, any party aggrieved by the final order or orders previously issued in this case may appeal the final order and all previously issued orders in this case to district court by filing a petition in the district court of the county in which:

- i. A hearing was held,
- ii. The final agency action was taken,
- iii. The party seeking review of the order resides, or
- iv. The real property or personal property that was the subject of the agency action is located.

The appeal must be filed within twenty-eight (28) days of this preliminary order becoming final. See section 67-5273, Idaho Code. The filing of an appeal to district court does not itself stay the effectiveness or enforcement of the order under appeal.

If you have any questions, please call me at 208-327-7946.

Sincerely,



Shelley W. Keen  
Water Rights Supervisor

SK:klt

Enclosure

RECEIVED  
JUN 3 6 1998



CERTIFICATE OF MAILING

I hereby certify that on the 6th day of July, 1998, I mailed a true and correct copy, postage prepaid, of the foregoing PRELIMINARY ORDER (Approved License) to the person(s) listed below:

Water Right No. 57-07520

VANCE VAN HALL  
RT 1 BOX 16  
MARSING ID 83639

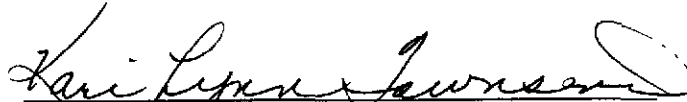
  
Kari Lynn Townsend  
Secretary

RECEIVED  
JUL 16 1998

# LICENSE REVIEW CHECKLIST

PERMIT NO. 57-07520 DATE 6/30/98 REVIEWER: SHARLA

NAME Change/OK  
 Address OK  
 SOURCE OK Does change clarify orig. intended source? If no, Void permit  
 POINT OF DIV OK Change (P39 /P47) Add (P45/P42) Feds - P40

W32 (multiple in 1/4)  
 W36 (overlap)  
 W59 (subd desc)

Overlaps: Right(s): \_\_\_\_\_  
 File reviewed \_\_\_\_\_ Profile reports printed \_\_\_\_\_

PLACE OF USE OK Change (P41/P47) Add (P41/P42) Feds - P43

W60 (subd. desc)  
 W27 (ppu acre limit)

Overlaps. Right(s): \_\_\_\_\_  
 File reviewed \_\_\_\_\_ Profile reports printed \_\_\_\_\_

PD & PU amend (P37) Feds - P48

## RATE OF DIV

Permitted Rate .13 cfs  
 Fee limit .20 cfs \$5000  
 Measured — cfs  
 Theoretical .17 cfs

Recommended Total Div Rate .03 cfs

WATER USES	<u>OK</u>	Change (P46)		
<u>Irrig</u>	<u>.03</u> cfs	<u>4.5</u> af	Irrig -	overlap (R58-R61, R62-R65, R66-R69)
_____	_____ cfs	_____ af		supp gw (WB7/065/079)
_____	_____ cfs	_____ af		overlap spec combined rts (W35)
_____	_____ cfs	_____ af		<1acre (W31)
_____	_____ cfs	_____ af	Domestic	(W01/WB5/070/071/075)
TOTALS	<u>.03</u> cfs	<u>4.5</u> af	Power	(W42 or W43/025/027/R22 or R23)
			Fish (042)	Fire (077) Wtr Quality (081/R07)

Flow rate .03 cfs X 246 days X 1.98 = 14.6 af

REMARKS \_\_\_\_\_

ADD'L CONDITIONS \_\_\_\_\_ Watermaster Control WD# \_\_\_\_\_  
 \_\_\_\_\_ GW Measurement/Measuring Device  
 \_\_\_\_\_ Others Trust (052/R55 - remove 051) Non-trust (048/049)

Advance Priority yes no

SRBA Claim N/A

Adjust Memo \_\_\_\_\_  
 Amend letters \_\_\_\_\_

STATE OF IDAHO  
DEPARTMENT OF WATER RESOURCES  
**BENEFICIAL USE FIELD REPORT**

RECEIVED

MAR 29 1996

Department of Water Resources

**A. GENERAL INFORMATION**Permit No. 57-075201. Owner: Vance Van Hall Phone No. 896-4848Current Address: Rt 1 Box 16 Marrying 836392. Accompanied by: Joe Reinke EXAM DATE: 9/5/95Address: Rt 1 Phone No. 896-4999Relationship to Permit Holder: new owner3. Source: Spring tributary to Snake R

A02-00064

57-10059

A02-00065

A02-02113B-6

A63-02388

**B. OVERLAP REVIEW**1. Other water rights with the same place of use: 02-02276, 02-02113, 02-07468, 63-023882. Other water rights with the same point of diversion: 02-07468, 57-10059**C. DIVERSION AND DELIVERY SYSTEM****1. Point(s) of Diversion:**

Ident No.	Gov't Lot	¼	¼	¼	Sec.	Twp.	Rge.	County	Method of Determination/Remarks
	8	SE	NE	NW	34	3N	4W	Owyhee	USGS Quad

**2. Place(s) of Use:**

Indicate Method of Determination

TWP	RGE	SEC	NE				NW				SW				SE				Totals
			NE	NW	SW	SE	NE	NW	SW	SE	NE	NW	SW	SE	NE	NW	SW	SE	
3N	4W	34					1												1
							48												

MICROFILMED

JUN 11 1998



3. **Delivery System Diagram:** Indicate all major components and distances between components. Indicate weir size/ditch size/pipe I.D. as applicable.

Scale: 1" = \_\_\_\_\_

\_\_\_\_\_ Copy of USGS Quadrangle Attached Showing location(s) of point(s) of diversion and place(s) of use (required).

\_\_\_\_\_ Aerial Photo Attached (required for irrigation of 10+ acres)

\_\_\_\_\_ Photo of Diversion and System Attached

4.

Well or Diversion Identification No.*	Motor Make	Hp	Motor Serial No.	Pump Make	Pump Serial No. or Discharge Size
		3	MODEL #	Baldor	
			JML1406T		

\*Code to correspond with No. on map and aerial photo

#### D. FLOW MEASUREMENTS

1.

Measurement Equipment	Type	Make	Model No.	Serial No.	Size	Calib. Date

2. Measurements:

Theoretical

ENCLOSURE

APR 11 1966

E. NARRATIVE/REMARKS/COMMENTS

A 3HP pump is used to supply spring water to 1 acre of lawn area automatic sprinklers. The P/D consists of a concrete collection box and is located ~ 15' below the P/U. The system has a 1" intake and a 1 1/2" discharge. The water to air heat pump system was not developed. The only beneficial use found was irrigation for the lawn. A ground water well is used for internal domestic use - 57-10059. No other water uses are used on the lawn. Owner uses Snake River water on separate acres.

Have conditions of permit approval been met? ☒ yes ☐ no

JUN 16 1958

## F. FLOW CALCULATIONS

☒ Additional Computation Sheets Attached

Measured Method:

$$\frac{3 \times 8.8 \times .7}{15 + 40 \times 2.31} = .17 \text{ cfs}$$

## G. VOLUME CALCULATIONS

### 1. Volume Calculations for Irrigation:

$$V_{IR} = (\text{Acres Irrigated}) \times (\text{Irrigation Requirement}) = 1 \times 4.5 = 4.5$$

$$V_{DR} = [\text{Diversion Rate (cfs)}] \times (\text{Days in Irrigation Season}) \times 1.9835 = .03 \times 246 \times 1.9835 = 14.6$$

$$V = \text{Smaller of } V_{IR} \text{ and } V_{DR} = 4.5$$

### 2. Volume Calculations for Other Uses:

## H. RECOMMENDATIONS

### 1. Recommended Amounts

Beneficial Use	Period of Use		Rate of Diversion Q (cfs)	Annual Volume V (afa)
	From	To		
Irrigation	3/15	11/15	.03	4.5
Totals:			.03	4.5

### 2. Recommended Amendments

☐ Change P.D. as reflected above    ☐ Add P.D. as reflected above    ☒ None  
☐ Change P.U. as reflected above    ☐ Add P.U. as reflected above    ☐ Other

## I. AUTHENTICATION

Field Examiner's Name Loi Craven Date 3/8/96

Reviewer \_\_\_\_\_ Date \_\_\_\_\_

SEAL



THEORETICAL HORSEPOWER EQUATION WORKSHEET (cjh 1/92)

Water Right No.: 57-07520  
Examiner: LORI GRAVES  
Date of Field Exam: 09-05-1995

	OPTION 1	OPTION 2	OPTION 3
P/D No.:	1		
PUMP HORSEPOWER	3		
BOOSTER HORSEPOWER			
PUMPING LEVEL	15		
DISCHARGE PRESSURE	40		
RATE OF FLOW (cfs)	0.17	ERR	ERR

W.C. L.

09-05-1995

57-07520





T3N NENW  
R4W 60r Lt 8  
SEC 34





Spring +  
Pump



P/u

March 1, 1994

VANCE VAN HALL  
RT. 1 BOX 16  
MARSING ID 83639

PROOF ACKNOWLEDGMENT LETTER

RE: PERMIT NO. 57-07520

Dear Permit Holder:

The department acknowledges receipt of the proof of beneficial use form submitted for the above referenced permit. The next step in the process of developing a water right is for the department to conduct a field examination to determine and confirm the use being made of the water.

If you have questions concerning this matter, please feel free to contact the WESTERN Regional Office in Boise at (208)334-2190.

Sincerely,

JULIE L. YARBROUGH  
Senior Secretary

c: IDWR - Region

85-11379

APR 13 1994

57-7520

September 10, 1992

MEMO TO FILE:

From: Carolyn Andregg

During the spring and summer of 1992, drought conditions caused record low flows in the Snake River. Twice, the flow of the Snake River fell below 4,750 cfs, the minimum stream flow at the Weiser gauge. Notices were mailed to the water user listed under this right because the priority is later than July 1, 1976, in order to protect the Snake River minimum stream flow. The following is a chronological history of the mailings.

May 19, 1992: Letter sent to water right holder informing holder of possible temporary cessation of diversion rights and notice of public meetings.

June 8, 1992: Letter sent informing water right holder directing immediate cessation of diversion of water until further notice.

June 12, 1992: Letter sent to water right holder authorizing resumption of diversion of water.

June 26, 1992: Letter sent to water right holder directing immediate cessation of diversion of water until further notice.

June 29, 1992: Letter sent to water right holder authorizing resumption of diversion of water.

APR 13 1994

June 8, 1992

VANCE VAN HALL  
RT. 1 BOX 16  
MARSING ID 83639

RE: Water Right No. 57-07520

Dear Water Right Holder(s):

On May 19, 1992, the department sent you a letter advising that you might be required to temporarily cease diverting water from the Snake River or its tributaries if the established minimum stream flow of the Snake River in the amount of 4,750 cubic feet per second measured near Weiser is not satisfied or likely will not be satisfied.

The flow of the Snake River at Weiser is now less than 4,750 cfs. You are, therefore, directed to immediately cease diverting water under the above referenced water right and to not resume use until authorized by the department.

Past flow records show that the duration of seasonal low flow periods typically last several days to a week. Since your use of water is extremely important to you and since mail notification includes a delay associated with mail delivery time, feel free to call the toll-free telephone number 1-800-451-4129 to determine when you are again authorized to divert and use water under your water right. Please use this phone number only in connection with resumption of use.

You need to be aware that Section 42-351, Idaho Code, provides for penalties of up to \$100 per day for unauthorized diversion.

Thank you for your cooperation in this matter. Please feel free to contact L. Glen Saxton (phone: 208-327-7955) or Gary Spackman (phone: 208-327-7946) of my staff if you have questions.

Sincerely,

R. KEITH HIGGINSON  
Director

RECEIVED  
JUN 13 1992



May 19, 1992

VANCE VAN HALL  
RT. 1 BOX 16  
MARSING ID 83639

RE: Water Right No. 57-07520

Dear Water Right Holder(s):

Department water right records show that you divert water from the Snake River or its tributaries under a water right that has a priority date later than December 29, 1976. This is the priority of the established minimum stream flow of the Snake River at the Weiser Gage (Weiser) in the amount of 4,750 cubic feet per second.

Because of the continuing drought conditions in the Snake River Basin, department hydrologists project that during 1992, there could be periods when the required minimum flow will not be satisfied due to low flows of the Snake River. The department urges you to not divert at a higher rate than authorized by your water right and to not use your right in any manner different than authorized. In addition, when the minimum flow will not be satisfied or is not being satisfied, you are required to cease diverting water under your water right, because your right is of later priority than the minimum stream flow at Weiser.

If the department determines the minimum flow will not be satisfied, the department will advise you and will provide as much lead time as possible in requiring that you temporarily cease your diversion of water. The greatest likelihood for this to occur is during a period from mid-June to late June.

While the department expects good cooperation from junior water right holders, water users should be aware that Section 42-352, Idaho Code, provides for penalties of up to \$100 per day for unauthorized diversions of water.

The department has contacted both the Idaho Power Company and the U.S. Bureau of Reclamation with respect to the timing of storage releases from upstream reservoirs for flow enhancement purposes. This type of coordination could minimize the impact on

APR 13 1994

existing water users and reduce the need to curtail diversions.

The department has scheduled public information meetings relative to this potential regulation as follows:

Mountain Home - June 4, 1992 - 10:00 a.m. - gymnasium at  
North Elementary School, 290 E. 12th N.

Caldwell - June 4, 1992 - 7:00 p.m. - Ballroom in the  
Student Union Building, Albertson College of Idaho,  
2112 Cleveland

If you have questions concerning this letter or wish to  
provide the name of a different contact person or address to  
receive department correspondence, please contact the department.

Sincerely,

L. GLEN SAXTON  
Chief, Water Allocation Bureau

LGS:klg

RECEIVED  
JUN 13 1992



State of Idaho  
DEPARTMENT OF WATER RESOURCES

1301 North Orchard Street, Statehouse Mail, Boise, Idaho 83720-9000  
Phone: (208) 327-7900 FAX: (208) 327-7866

CECIL D. ANDRUS  
GOVERNOR

R. KEITH HIGGINSON  
DIRECTOR

May 14, 1992

Vance Van Hall  
Route 1 box 16  
Marsing, ID 83639

Re: Permit No. 57-07520

Dear Permit Holder:

Enclosed is a copy of the approved request for extension of time. The time within which to submit proof of beneficial use is extended to July 1, 1994. Please note that the department has granted this extension based on due diligence. It is important that you work diligently toward the completion of this project during the construction period allowed. The department may not be able to grant additional requests.

If you have any questions or if I can be of any further assistance, please feel free to contact this office.

Sincerely,

*Karen L. Gustafson*  
Karen L. Gustafson  
Secretary/Records Manager

Enclosure

C: IDWR-Regional Office

MISSOURI MED

MAY 19 1992

April 30, 1992

VANCE VAN HALL  
RT. 1 BOX 16  
MARSING ID 83639

PROOF DUE NOTICE

RE: PERMIT NO. 57-07520

Dear Permit Holder:

One of the conditions of approval of the above referenced water permit was that proof of the extent of your beneficial use must be submitted to this office on or before July 1, 1992. (See last page of your approved permit or your last approved extension request.) Enclosed is a form which when accompanied by the license examination fee or a complete field examination report prepared by a certified water right examiner may be used to submit the required proof.

If you have not fully completed your project, and you or a previous owner of this permit have not received a prior extension of time, you may request an extension of time if the delay is for reasonable cause as provided in Section 42-204, Idaho Code. If you have been prevented from proceeding by a governmental agency or by litigation which might bring title to the water in question, more than one extension of time can be granted. An extension of time request form is enclosed for your convenience.

Either an acceptable proof of beneficial use submittal or an acceptable request for an extension of time must be received by this department on or before the above described proof due date. If neither is received, the department will send you a lapse notice. Within sixty (60) days of the mailing of the lapse notice, the permit will no longer be of any force nor effect.

SINCERELY,

Karen L. Gustafson  
Secretary/Records Manager

Enclosures

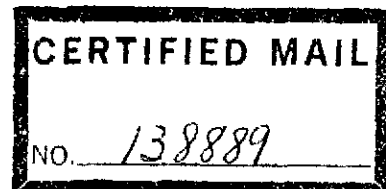

MAY 19 1992



S T A T E   O F   I D A H O

DEPARTMENT OF WATER RESOURCES

-----

Statehouse  
Boise, Idaho 83720  
(208) 327-7900  
June 11, 1990

VANCE VAN HALL  
RT. 1 BOX 16  
MARSING, ID 83639

PERMIT APPROVAL NOTICE

RE: PERMIT NO.      P57-07520

Dear Permit Holder:

Enclosed is a copy of your approved application for permit. We direct your attention to the conditions of approval on the final page.

Please note the requirement that as a permit holder you must commence the excavation or construction of diverting works within one year of the date the permit was issued, and you must proceed diligently until the project is completed. The enclosed blue card must be completed and returned to this office as soon as you commence construction, no later than one year from the date the permit was approved.

We have enclosed a form entitled "Instructions for Proof of Beneficial Use". Please read the instructions carefully since you must take further action to develop this permit into a license.

Sincerely,

GARY SPACKMAN, Supervisor  
Water Right Permits Section

GS: SC  
Enclosures

**RECEIVED**

JUN 21 1990

57-07520

VAN HALL, VANCE  
RT. 1 BOX 16  
MARSING, ID 83639

Source: SPRING

Tributary: SNAKE RIVER

Diversion Pt: LOT 8 (NENW) Sec 34 T 03N R 04W

Use: IRRIGATION	( .090 CFS)
HEATING	( .040 CFS)
COOLING	( .040 CFS)
Total Diversion:	( .130 CFS)

Date Filed: 2/15/1990

In: T03N R04W S34 Lot 8 (NENW)

3.0 ACRES TOTAL

**MICROFILMED**

JUN 21 1990