

Affidavit of Publication

RECEIVED

FEB 23 1977

Department of Water Resources
Eastern District Office

I, Le Ella Cammack, of the
Arco Advertiser, a weekly newspaper of general
circulation, published weekly at Arco, Idaho, since
March, 1909, do solemnly swear that a copy of
this notice, per clipping attached, was published
weekly in the regular and entire issue of said
newspaper, and not in any supplement thereof,

for 2 consecutive weeks, commencing with

the issue dated Jan. 20, 1977

and ending with the issue dated 1-27-77

Le Ella Cammack

Subscribed and sworn to before me this

21 day of Feb, 1977

Charles H. McDonald
Notary Public

Residence: Arco, Idaho.

My commission expires 5/14, 1978

NOTICE OF APPLICATION FOR WATER PERMIT

Notice is hereby given that
Charles H. McDonald, Howe, Idaho,
has on 1-11-77 submitted Ap-
plication No. 33-7047 for a permit to
appropriate 1.86 cubic feet per
second of water from a ground-
water source by means of well and
pump within the NW $\frac{1}{4}$ NE $\frac{1}{4}$, Sec.
26, T. 6N, R. 29E, B.M., Butte
County; to be used from Apr. 1 to
Nov. 1 for the irrigation of 240 acres
within the NW $\frac{1}{4}$, Sec. 25, W $\frac{1}{2}$ NE $\frac{1}{4}$,
Sec. 26, T. 6N, R. 29E, B.M.

If issued, this permit will be
subject to all prior water rights.
Protests against the granting of the
permit must be filed with the Idaho
Department of Water Resources,
1515 Lincoln Road, Idaho Falls,
Idaho, 83401 on or before February
7, 1977.

R. KEITH HIGGINSON
Director

Published in the Arco Advertiser,
Arco, Idaho on January 20 and
January 27, 1977.

MICROFILMED
MICROFILMED

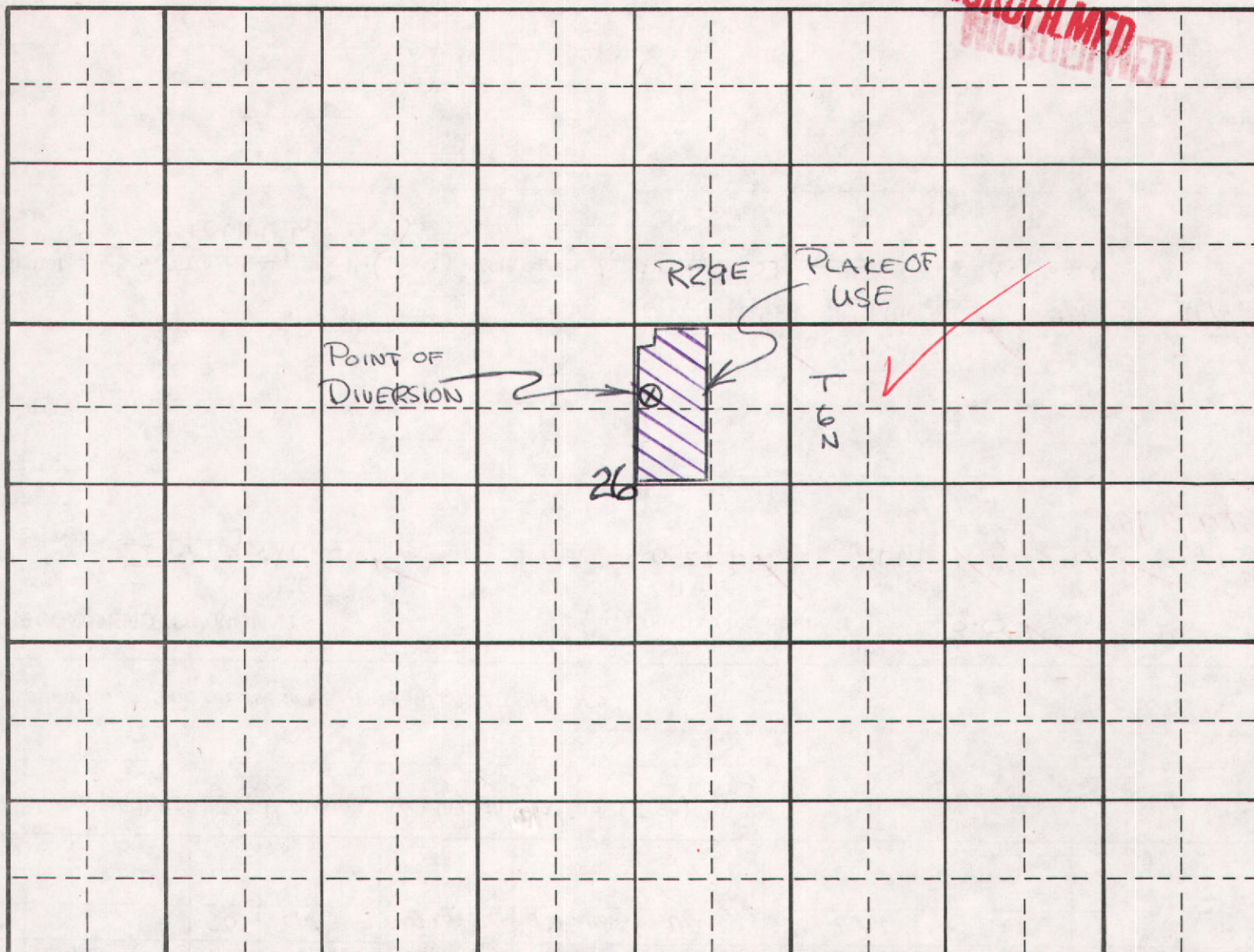

SCHEMATIC DIAGRAM OF SYSTEM

(Include distance from pump to measuring device, if applicable.)

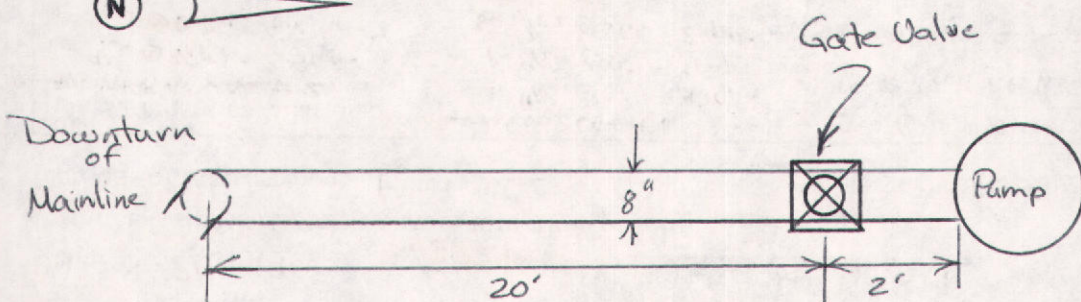
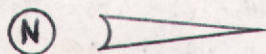

Point(s) of diversion: ☒ NW $\frac{1}{4}$ NE $\frac{1}{4}$ SEC 26 T6N R29E

Place(s) of Use ☒

TWP.	RGE.	SEC.	NE $\frac{1}{4}$				NW $\frac{1}{4}$				SW $\frac{1}{4}$				SE $\frac{1}{4}$				TOTALS
			NE $\frac{1}{4}$	NW $\frac{1}{4}$	SW $\frac{1}{4}$	SE $\frac{1}{4}$	NE $\frac{1}{4}$	NW $\frac{1}{4}$	SW $\frac{1}{4}$	SE $\frac{1}{4}$	NE $\frac{1}{4}$	NW $\frac{1}{4}$	SW $\frac{1}{4}$	SE $\frac{1}{4}$	NE $\frac{1}{4}$	NW $\frac{1}{4}$	SW $\frac{1}{4}$	SE $\frac{1}{4}$	
6N	29E	26		36	40														76

Recommended Amendments:

- ☐ Change P.D. as reflected above ☐ Add P.D. as reflected above ☒ None
☐ Change P.U. as reflected above ☐ Add P.U. as reflected above ☐ Other

Examiner's Signature Keith C Wilson

Checked by 245

Approved by KW

Date 7 Dec 1983

Date 12-09-1983

Date 9-18-84

R-29E

23

BERENICE

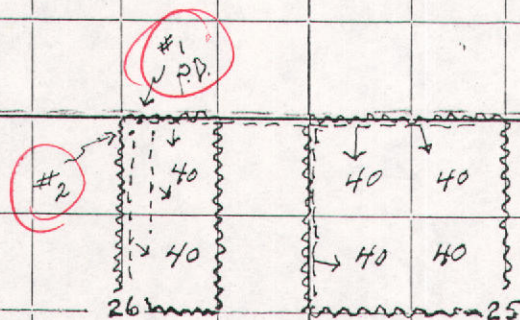

T.
6
N.

FS 128' S
67' E
SD 50' S
#1 107' E

from 1/4 cor.
Sec. 26
and S. 23.

Subdivisions = 6

Area = 240 acres.

Q = 147 inches

T = 48 1/2° F on #2

wants 80" on West 80 acres.

MICROFILMED

State of Idaho
Department of Water Resources

WATER RIGHT LICENSE

(Late Proof)
License of Water Right No. 33-7047 Priority February 4, 1977 Amount 0.27 cfs

THIS IS TO CERTIFY, that Charles H. McDonald
of Howe, Idaho, has complied with the terms and conditions of Permit
No. 33-7047 issued pursuant to Application for Permit dated January 11, 1977,
and has submitted proof to the Department of Water Resources on March 25, 1982,
that he has applied water to a beneficial use; an examination by the Department indicates that the works have a
capacity for the diversion of 0.27 cfs of water from a groundwater source,
tributary to _____, and that the permit holder has applied to a beneficial use and
established a right to use water as follows:

Beneficial Use	Period of Use	Rate of Diversion	Annual Volume
Irrigation	from <u>April 1</u> to <u>November 1</u>	at <u>0.27</u> cfs and	<u>114.6</u> acre feet
	from _____ to _____	at _____ cfs and	_____
	from _____ to _____	at _____ cfs and	_____
(both dates inclusive)			

Subject, however, to the condition that no more than 0.27 cfs of water be diverted at any one time, and
that the amount of water so diverted and to which such right is entitled and confirmed is for the purpose
aforementioned and is limited to the amount which can actually be beneficially used and shall not exceed
114.6 acre feet per year, said waters to be diverted within the NW $\frac{1}{4}$ NE $\frac{1}{4}$ Section 26,
Twp 6N, Rge 29E in the County of Butte

Description and location of place of use:

Twp.	Range	Sec.	NE $\frac{1}{4}$				NW $\frac{1}{4}$				SW $\frac{1}{4}$				SE $\frac{1}{4}$				Totals
			NE $\frac{1}{4}$	NW $\frac{1}{4}$	SW $\frac{1}{4}$	SE $\frac{1}{4}$	NE $\frac{1}{4}$	NW $\frac{1}{4}$	SW $\frac{1}{4}$	SE $\frac{1}{4}$	NE $\frac{1}{4}$	NW $\frac{1}{4}$	SW $\frac{1}{4}$	SE $\frac{1}{4}$	NE $\frac{1}{4}$	NW $\frac{1}{4}$	SW $\frac{1}{4}$	SE $\frac{1}{4}$	
6N	29E	26		36	40														76

Total number of acres irrigated 76

This right when combined with all other rights shall provide no more than .02 cfs
per acre nor more than 3.0 afa per acre for the lands above.

NOTE: Modifications to or variance from this license must be made within the limits of Section 42-222, Idaho
Code, or the applicable Idaho Law. This right may be forfeited by five years of non-use.

The right to the use of the water hereby confirmed is restricted and appurtenant to the lands or place of use
herein described, and is subject to all prior water rights, as provided by the laws of Idaho.

Witness the seal and signature of the Director, affixed at Boise, Idaho, this 18TH day of
SEPTEMBER, 19 85.

Acting for the Director

MICROFILMED

Norman C. Young

BEFORE THE DEPARTMENT OF WATER RESOURCES
OF THE
STATE OF IDAHO

IN THE MATTER OF PERMIT NO. 33-7047

IN THE NAME OF CHARLES H. McDONALD

ORDER OF REINSTATEMENT

WHEREAS, on January 11, 1977, Charles H. McDonald applied to the Department of Water Resources for a permit to appropriate 1.86 cubic feet per second of water from a groundwater source to be diverted within the NW $\frac{1}{4}$ NE $\frac{1}{4}$, Sec. 26, Twp. 6N, Rge. 29E B.M., Butte County, to be used for irrigation purposes; and,

WHEREAS, on March 4, 1977, the Department approved said application and issued Permit No. 33-7047 with the condition that proof of construction of works and application of water to beneficial use be submitted on or before March 1, 1982; and,

WHEREAS, on December 31, 1982, the Department notified the permit holder by certified mail that proof was due and instructed the permit holder as to the steps to be taken to make said proof; and,

WHEREAS, Section 42-218a of the Idaho Code provides that a permit may be reinstated upon a showing of reasonable cause within sixty days from the date of the notice of lapsing; and,

WHEREAS, the permit holder has provided a reasonable showing as to why said permit should be reinstated by submitting proof of beneficial use;

IT IS, THEREFORE, HEREBY ORDERED that Permit No. 33-7047 be REINSTATED and the priority advanced to February 4, 1977.

Dated this 19th day of April, 1982.

L. Glen Saxton

L. GLEN SAXTON

Chief, Operations Bureau

MICROFILMED

BEFORE THE DEPARTMENT OF WATER RESOURCES
OF THE
STATE OF IDAHO

IN THE MATTER OF CHANGING THE MEASURING
DEVICE REQUIREMENT FOR PERMIT NO. 33-7047

ORDER

WHEREAS, the above numbered permit was approved with the condition that a measuring device of a type approved by the Department be permanently installed and maintained as part of the diverting works; and,

WHEREAS, on July 1, 1978, the Department adopted a new water measurement condition which states: "An access port or other device as specified by the Department shall be installed by the permit holder to provide for the installation of measuring equipment and the determination of the rate of diversion by the Department"; and,

WHEREAS, the former condition required the permit holder to purchase and install a measuring device or hire a professional engineer to certify the rate of diversion; and,

WHEREAS, the measuring device condition effective July 1, 1978, requires less capital expenditure by the permit holder; and,

WHEREAS, to be equitable to holders of permits issued prior to July 1, 1978, the new condition should be retroactive;

NOW THEREFORE, it is hereby ordered that the condition of approval of this permit related to water measurement is hereby changed as follows: "The permit holder shall either install a measuring device or provide a certified measurement by a professional engineer or install an access port or other device as specified by the Department".

Dated this 18th day of August, 1978.

C. STEPHEN ALLRED
Director

MICROFILMED

Identification No. 33 7047
Application No. _____

STATE OF IDAHO
DEPARTMENT OF WATER RESOURCES
APPLICATION FOR PERMIT

APPROVED

To Appropriate the Public Waters of the State of Idaho
(TYPE OR PRINT IN INK)

1. Name of applicant Charles H. McDonald Phone: ³³⁷⁹767-2801
post office address Howe, ID 83244
2. Source of water supply ground water which is a tributary of _____
3. a. Location of point of diversion is NW $\frac{1}{4}$ of NE $\frac{1}{4}$ of Section 26 Township 6N
Range 29E B.M. Butte County; additional points of diversion if any: _____
- b. If water is not consumed, it will be discharged into _____ at a point in _____ $\frac{1}{4}$
of _____ $\frac{1}{4}$ of Section _____ Township _____ Range _____ B.M. _____
4. Water will be used for the following purposes:
Amount 1.86 for irrigation purpose from Apr. 1 to Nov. 1 (both dates inclusive)
(cfs or acre-feet per annum)
Amount _____ for _____ purpose from _____ to _____ (both dates inclusive)
(cfs or acre-feet per annum)
Amount _____ for _____ purpose from _____ to _____ (both dates inclusive)
(cfs or acre-feet per annum)
5. Total quantity to be appropriated:
a. 1.86 cubic feet per second and/or
b. _____ acre feet per annum.
6. Proposed diverting works:
a. Description of ditches, flumes, pumps, headgates, etc. well, pump and sprinkler system

b. Height of storage dam _____ feet, active reservoir capacity _____ acre feet; total reservoir
capacity _____ acre feet, materials used in storage dam: _____
Period of year during which storage will occur _____ to _____ inclusive.
(Mo. Day) (Mo. Day)
c. Proposed well diameter is 16 inches; proposed depth of well is 150 feet.
7. a. Time required for the completion of the works and application of the water to the proposed beneficial use
is 5 years.
b. Estimated construction cost is \$25,000.00.
8. Description of proposed uses:
a. If water is **not** for irrigation:
(1) Give the place of use of water: _____ $\frac{1}{4}$ of _____ $\frac{1}{4}$ of Section _____ Township _____
Range _____ B.M. _____
(2) Amount of power to be generated: _____ hp under _____ feet of head.
(3) List number of each kind of livestock to be watered _____

(4) Name of municipality to be served _____, or number of families to be
supplied with domestic water _____
(5) If water is to be used for other purposes describe: _____

MICROFILMED

11. Map of proposed project: show clearly the proposed point of diversion, place of use, section number, township and range number.

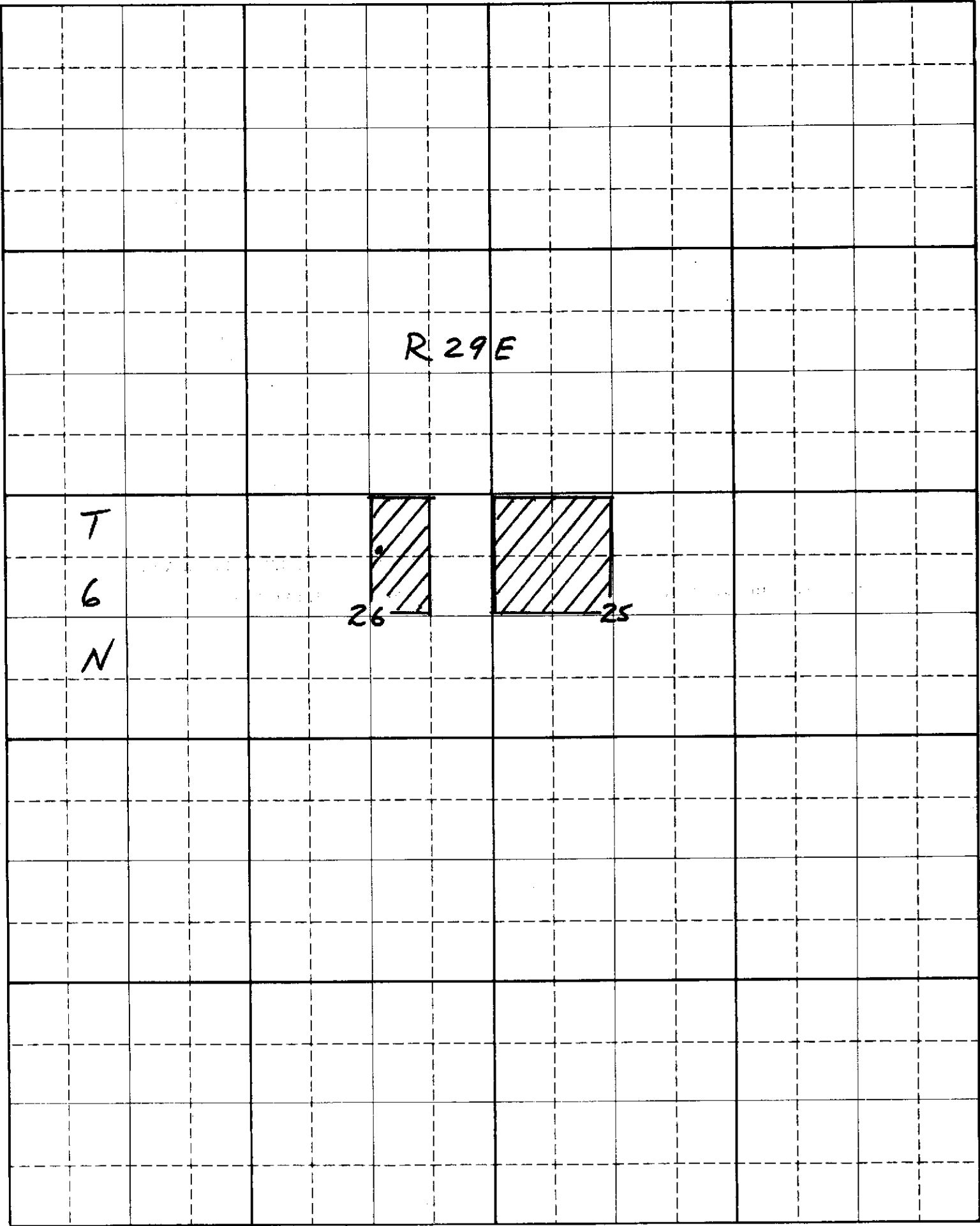

Scale: 2 inches equal 1 mile

BE IT KNOWN that the undersigned hereby makes application for permit to appropriate the public waters of the State of Idaho as herein set forth.

Charles H. McDonald
(Applicant)

46-11-1400000 2-11-1977
Proposed Priority 1/11/77

Received by CW Date 1-11-77 Time 2:55p.

Preliminary check by JG Fee \$ 35.00

Received by CW Date 1-11-77 # 4491

Publication prepared by CW Date 1-12-77

Published in Idaho Advertiser

Publication dates January 20 & 27, 1977

Publication approved me Date 2-23-77

Priority reduced to _____ Reason _____

Protests filed by: _____

Copies of protests forwarded by _____

Hearing held by _____ Date _____

Recommended for approval denial by RDC - JJ

ACTION OF THE DIRECTOR, DEPARTMENT OF WATER RESOURCES

This is to certify that I have examined Application for Permit to appropriate the public waters of the State of Idaho No. 33-7047, and said application is hereby APPROVED.

1. Approval of said application is subject to the following limitations and conditions:

a. SUBJECT TO ALL PRIOR WATER RIGHTS.

b. Proof of construction of works and application of water to beneficial use shall be submitted on or before March 1, 19 82.

c. Other: A measuring device of a type approved by the Director shall be permanently installed and maintained as part of the diverting works.

2. Denial of said application is for the following reasons: _____

Witness my hand this 4 day of March, 19 77.

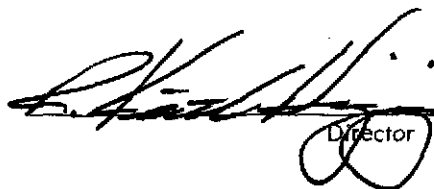
Director

Affidavit of Publication

RECEIVED
FEB 23 1977

FEB 23 1977

Department of Water Resources
Eastern District Office

I, L. Ella Connack, of the
Arco Advertiser, a weekly newspaper of general
circulation, published weekly at Arco, Idaho, since
March, 1909, do solemnly swear that a copy of
this notice, per clipping attached, was published
weekly in the regular and entire issue of said
newspaper, and not in any supplement thereof,

for 2 consecutive weeks, commencing with

the issue dated Jan. 20, 1977

and ending with the issue dated 1-27-77

L. Ella Connack

Subscribed and sworn to before me this

21 day of Feb, 1977

Charles H. Higginson
Notary Public

Residence: Arco, Idaho.

My commission expires 5/14, 1978

NOTICE OF APPLICATION FOR WATER PERMIT

Notice is hereby given that
Charles H. McDonald, Howe, Idaho,
has on 1-11-77 submitted Ap-
plication No. 33-7047 for a permit to
appropriate 1.86 cubic feet per
second of water from a ground-
water source by means of well and
pump within the NW $\frac{1}{4}$ NE $\frac{1}{4}$, Sec.
26, T. 6N, R. 29E, B.M., Butte
County, to be used from Apr. 1 to
Nov. 1 for the irrigation of 240 acres
within the NW $\frac{1}{4}$, Sec. 25, W $\frac{1}{2}$ NE $\frac{1}{4}$,
Sec. 26, T. 6N, R. 29E, B.M.
If issued, this permit will be
subject to all prior water rights.
Protests against the granting of the
permit must be filed with the Idaho
Department of Water Resources,
1515 Linotte Road, Idaho Falls,
Idaho, 83401 on or before February
7, 1977.

R. KEITH HIGGINSON
Director

Published in the Arco Advertiser,
Arco, Idaho on January 20 and
January 27, 1977.



State of Idaho

DEPARTMENT OF WATER RESOURCES

STATE OFFICE, 450 W. State Street, Boise, Idaho

JOHN V. EVANS

Governor

A. KENNETH DUNN

Director

Mailing address:
Statehouse
Boise, Idaho 83720
(208) 334-4440

September 20, 1985

RE: Permit No. 33-7047

Charles H. McDonald
Howe,
Idaho 83244

Dear Mr. McDonald:

Enclosed herewith is a copy of the Water Right License issued on the above referenced Permit.

Sincerely,

JIM JOHNSON
Water Distribution Supervisor

JJ:sc

Enclosure

MICROFILMED

WATER RIGHT NUMBER 33-7047

OWNER LAST NAME - MC DONALD

ADDRESS LINE 1 -

ADDRESS LINE 3 -

SOURCE - GROUNDWATER

STAGE - PERMIT

TOTAL DIV. VOLUME -

DIVERSION POINT - NWNE 26 06N 29E LOT

FROM - 04-01 TO - 11-01 USE - IRRIGATION

USE - IRRIGATION

USE - IRRIGATION

DECREE NAME -

REMARKS - REINSTATED 4-19-1982.

NON IRRIG USE -

OTHER RIGHTS FOR SAME USE - LIC. 33-2046.

PROOF DUE - 03-01-1982 PERMIT/DENIED - 03-04-1977 PROTESTED -

PROOF MADE - P FLD EXAM - COND. OF APPROVAL - 01B

DIVERSION MEANS - WELL, PUMP & SPRINKLERS.

FIRST NAME - CHARLES H.

ADDRESS LINE 2 -

CITY - HOWE

TRIBUTARY OF -

STATUS -

.00 AFA TRFR/AMEND -

REDIV -

USE - IRRIGATION

PLACE OF USE -

PLACE OF USE -

ORIG OWNER -

STATE - ID ZIP CODE - 83244

PRIORITY - 02-04-1977 COUNTY - BUTTE

WATER DIST. -

USE DIV. RATE -

USE DIV. RATE -

PLACE OF USE -

PLACE OF USE -

TOTAL DIV. RATE -

RIGHT BASIS -

USE DIV. VOLUME -

USE DIV. VOLUME -

TRACT NWNE LOT

TRACT NENW LOT

TRACT SWNW LOT

TRACT SENW LOT

TRACT SWNE LOT

TRACT NWNW LOT

TRACT AC 40

TRACT AC 40

TRACT AC 40

TRACT AC 40

TRACT AC 40

TRACT AC 40

TRACT AC 40

TRACT AC 40

TRACT AC 40

TRACT AC 40

TRACT AC 40

TRACT AC 40

TRACT AC 40

TRACT AC 40

TRACT AC 40

TRACT AC 40

TRACT AC 40

TRACT AC 40

TRACT AC 40

TRACT AC 40

TRACT AC 40

TRACT AC 40

TRACT AC 40

TRACT AC 40

TRACT AC 40

TRACT AC 40

TRACT AC 40

TRACT AC 40

TRACT AC 40

TRACT AC 40

TRACT AC 40

TRACT AC 40

TRACT AC 40

TRACT AC 40

TRACT AC 40

TRACT AC 40

TRACT AC 40

TRACT AC 40

TRACT AC 40

TRACT AC 40

TRACT AC 40

TRACT AC 40

TRACT AC 40

TRACT AC 40

TRACT AC 40



State of Idaho

DEPARTMENT OF WATER RESOURCES

STATE OFFICE, 450 W. State Street, Boise, Idaho

JOHN V. EVANS
Governor

A. KENNETH DUNN
Director

September 28, 1984

Mailing address:
Statehouse
Boise, Idaho 83720
(208) 334-4440

RE: Permit No. 33-7047

Charles H. McDonald
Howe,
Idaho 83244

Dear Mr. McDonald:

A representative of this Department has made an examination of the works covered by your Permit No. 33-7047, and has found the following:

Amount of water that can be recognized as beneficially used under
Idaho law: 0.27 cfs Source: groundwater

The maximum quantity diverted shall not exceed 114.6 acre feet
per year.

Point(s) of diversion: NW $\frac{1}{4}$ NE $\frac{1}{4}$, Sec. 26, Twp 6N, Rge 29E

Beneficial Use: Irrigation of 76 acres within W $\frac{1}{2}$ NE $\frac{1}{4}$, Sec. 26, Twp 6N,
Rge 29E

Priority date established: February 4, 1977 (Late Proof)

Conditions (if any): This right when combined with all other rights shall provide
no more than .02 cfs per acre nor more than 3.0 afa per acre for the lands above.

If you do not concur with these findings, please contact us within 10 days, otherwise a water license will be issued as set forth above.

Sincerely,

JIM JOHNSON
Water Distribution Supervisor

JJ:sc

MICROFILM

CONVERSATION MEMORANDUM

DATE 9-28-84

FILE 33-7047

Mrs.
NAME OF PARTY John McDonald

EMPLOYEE Jim Johnson

RE: Per conversation w/ Mrs. McDonald I
WAS ABLE TO DETERMINE THAT THE SYSTEM USED
TO IRRIGATE 76 ACRES IN THE W 1/2 NE 1/4 SEC. 26 WAS
DIFFERENT THAN THE SYSTEM IDENTIFIED UNDER
RIGHT 33-2046.

According to Mrs McDonald the well with
the 50HP motor was used to SPRINKLE ONLY THE
LAND IN THE W 1/2 NE 1/4 SEC. 26. The land in the
NW 1/4 SEC 25 RECEIVED MOSTLY SURFACE WATER AND
IN TIMES OF SHORTAGE WATER FROM 2 WELLS WITH
A 30HP AND 15HP MOTORS ON THEM WAS USED. THESE
WELLS ARE IDENTIFIED IN RIGHT 33-2046. SHE STATED
THAT WATER FROM THESE WELLS ^{WAS} ~~WAS~~ NO LONGER USED
ON LANDS IN THE W 1/2 NE 1/4 SEC 26

MICROFILMED

MICROFILMED

MICROFILMED

MAP (Attach Aerial Photo)

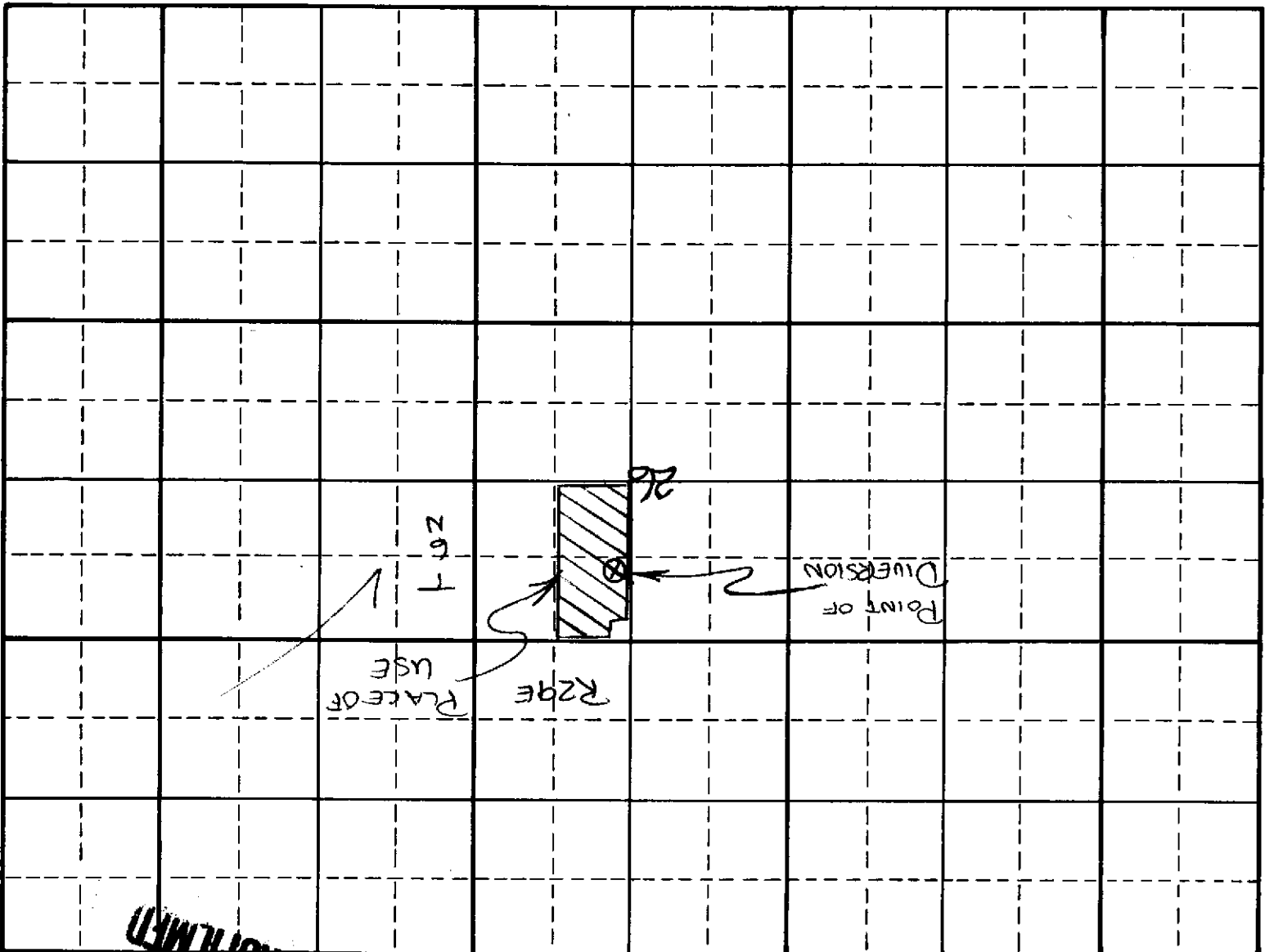

SCHEMATIC DIAGRAM OF SYSTEM

(Include distance from pump to measuring device, if applicable.)

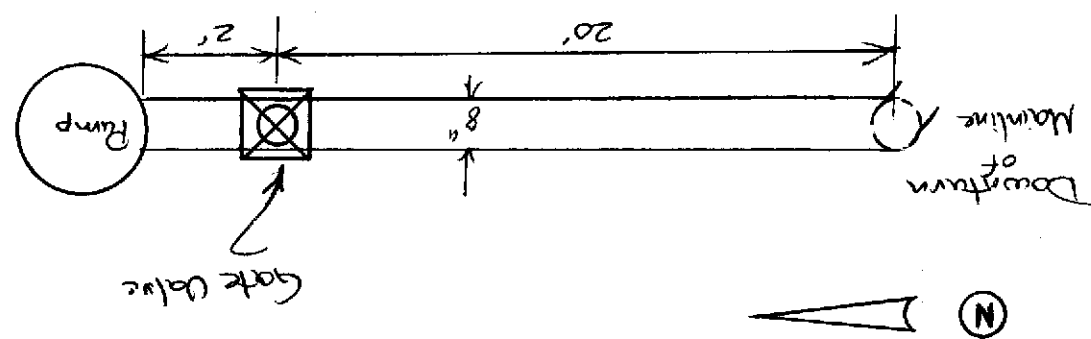

Point(s) of diversion: NW 1/4 NE 1/4 Sec 26 T6 N R29E

TWP.	RGE.	SEC.	NE 1/4	NW 1/4	SE 1/4	SW 1/4	NE 1/4	NW 1/4	SE 1/4	SW 1/4	NE 1/4	NW 1/4	SE 1/4	SW 1/4	TOTALS
T6 N	R29 E	26	36	40											76

Recommended Amendments:

- ☐ Change P.D. as reflected above
- ☐ Add P.D. as reflected above
- ☒ None
- ☐ Other
- ☐ Change P.U. as reflected above
- ☐ Add P.U. as reflected above

Examiner's Signature
Checked by
Approved by

Scott C. Wilson

Date 7 Dec 1983
Date 12-09-1983
Date 9-18-84

PERMIT NO. 33-7047

Charles McDonald
(Name)

EXAMINATION: DATE: 8-24-1982 ACCOMPANIED BY: John McDonald

Motor Make	HP	Motor Serial No.	Pump Make	Pump Serial No.
GE	50	DNJ209332	Johnson	N/A

Measuring Device Type: _____

Meter # _____

Annubar # _____

Size # _____

Remarks: _____

Measurement calculations:

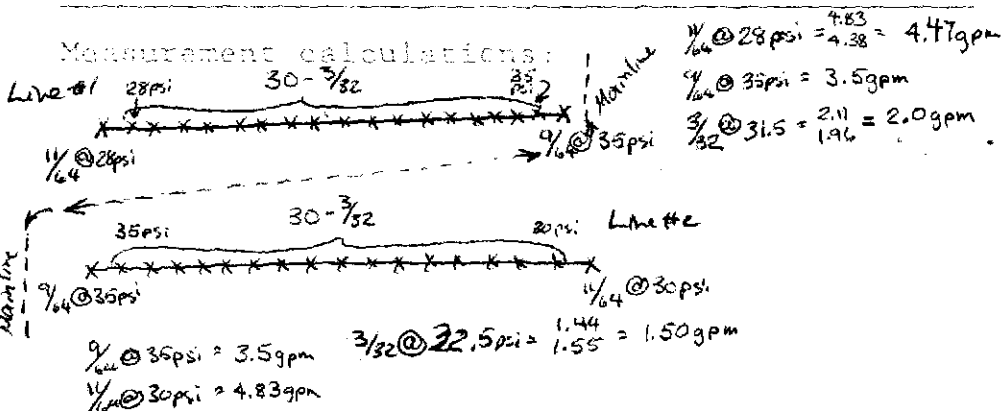

SCHEMATIC DIAGRAM OF SYSTEM

Mainline Dia. 8" od Length _____

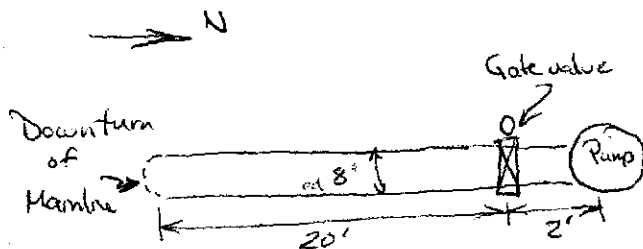

MICROFILMED

MAP

RQ

E.B.M.

TWP.					

RECOMMENDED AMENTMENTS:

☐ Change P/D☐ Change P/U☐ ADD P/D☐ ADD P/U☐ NONE☐ Other _____

Overlap Review for Permit 33-7047

per examiner: 33-2046 ✓
and permit: 33-2134

per micro-fische 9/18/84:

pld - 33-2046 ✓

plu - 33-2046 gw ✓

33-2134 Little Lost River ✓

33-2046 - Lic., gw, does not appear
to be same system - per
maps on exams - but is
within same 40 ac. tract -
see copy of exam attached -
plu overlap -

240 ac. @ 2.94 cfs = 0.01225 cfs
per acre

33-2134 - Lic./Decree - Little Lost
River - different source - plu
recommend R16(3.0) ✓ overlap

allow capacity of system — 0.27 ✓
will not exceed 0.02 cfs
per acre.

$$240 \times 0.02 = 4.80$$

$$0.27 + 2.94 = 3.21$$

kw

License and Certificate of Water Right

Water License No. 20427

Amount 2.94 c.f.s.

Water District No. _____

Priority April 20, 1953

THIS IS TO CERTIFY that

M. L. JONES

of Howe, Idaho, made application for a permit to appropriate the public waters of the State of Idaho, dated April 20, 1953; that Permit No. 2027 was issued under said application; that Certificate of Completion of works, with a carrying capacity of 2.94 second feet, was issued thereunder on June 25, 1959, showing that said works were completed on the 26 day of March, 1953; and that on the 26 day of March, 1953,

M. L. JONES

of Howe, State of Idaho, made proof to the satisfaction of the State Reclamation Engineer of Idaho, of the right to use the waters of a well, a tributary of subterranean flow, for the purpose of irrigation, under Use Permit No. 2427 of the Department of Reclamation and that said right to the use of said waters has been perfected in accordance with the laws of Idaho, and is hereby confirmed by the State Reclamation Engineer of Idaho and entered of record in Volume 11 of Licenses at page 6671, on the 25 day of June, 1959;

The right hereby confirmed dates from April 20, 1953;

The Point of Diversion is located

in the NW $\frac{1}{4}$ NE $\frac{1}{4}$, Sec. 26, Tp. 5 N., R. 29 E., B. M. Butte County

That the amount of water to which such right is entitled and hereby confirmed, for the purposes aforesaid, is limited to an amount actually needed and beneficially used for said purposes, and shall not exceed 2.94 cubic feet per second.

Description and location of use:

Twp.	Range	Sec.	Forty-acre Tract	No. Acres Described in Permit	No. Acres Actually Irrigated
6 N.	29 E.	25	NE $\frac{1}{4}$ NW $\frac{1}{4}$	40	40
			NW $\frac{1}{4}$ NW $\frac{1}{4}$	40	40
			SW $\frac{1}{4}$ NW $\frac{1}{4}$	40	40
			SE $\frac{1}{4}$ NW $\frac{1}{4}$	40	40
			NW $\frac{1}{4}$ NE $\frac{1}{4}$	40	40
			SW $\frac{1}{4}$ NE $\frac{1}{4}$	40	40
		26			
Total number of acres to be irrigated:					210

36 overlap

The right to the use of the water aforesaid hereby confirmed is restricted to the lands or place of use herein described, as provided by the laws of Idaho.

WITNESS the seal and signature of the State Reclamation Engineer, affixed at Boise, Idaho, this 25 day of June, 1959.

S/ G. M. CARTER

State Reclamation Engineer.

(SEAL)

MICROFILMED

33 20

33-20460

STATE OF IDAHO
DEPARTMENT OF RECLAMATION
BOISE, IDAHO
REPORT OF ENGINEER

Permit No. 20427

This proof is for Completion of works and Beneficial use Water District No. _____

1. Name of applicant M. L. Jones, Howe, Idaho
2. Source of water supply: Subterranean from wells
3. Location of point of diversion: Is in the NW $\frac{1}{4}$ NE $\frac{1}{4}$ of Section 26
T. 6 N. R. 29 E. County of Butte
4. Describe works as they exist, giving dimensions and capacities of same: P.D. #1. 16" x 76' well. concrete to 42', cased remainder. Static Height 41.5', draw down unknown. 10" column, 14" 1 stage, pump to bottom. 30 H.P. G.E. Motor # 22 6710025. 220 V. 74 amp. 1760 R.P.M. F.M. Panama turbine # PJ 3254. delivery from 10" opening into Wood's Mole trough, then to ditch. A.B. Panel, Bulldog switch on Pole to West. G.E. Meter # 28 859 185. demand. 52 x 40 (Con't. under Q. 7.)
5. Water is used for: Irrigation
6. State whether or not water has been turned into works of diversion: Yes
7. List legal subdivisions of lands to be irrigated. If proof is for beneficial use, give exact number of acres under cultivation in each forty-acre tract. (Describe manner and place of use if other than irrigation):
NW $\frac{1}{4}$ Section 25; W $\frac{1}{2}$ NE $\frac{1}{4}$ Section 26;
Twp. 6 North, Range 29 East, B. M.
(#4 cont.) Well No. 2. Well is 22" diameter by 66 $\frac{1}{2}$ ' deep. H=35', draw down is unknown. Pump is in the bottom. 6" column. Parma Water Lifter. G. E. Motor 15 HP, No. PL 15625. Horizontal motor used in a vertical position, used as a 4 B. Belt drive. Delivery to West through 6" pipe into a concrete heading into ditch. All irrigation by gravity.

(Submit map on attached plat, showing location and details of above description.)

8. What large stream would the water here appropriated finally reach? _____

Remarks: _____

This examination was made on the 4th & 5th day of August, 19 53

(Signed) _____

Judd Rose
E. H. H.

Examiner.

MICROFILMED

20427

R-29E

23

BERENICE

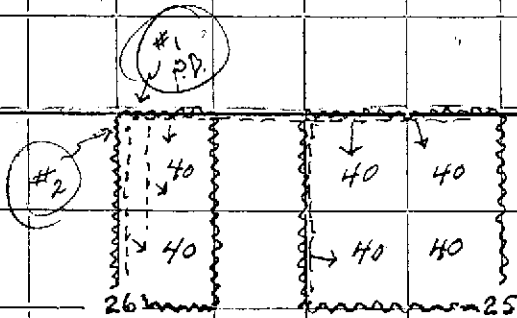

T.
6
N.

128' S
67' E
53' S
107 7/8' E

from 1/2 mi.
Sec. 26
and S. 23.

Subdivisions = 6

Area = 240 acres.

Q = 147 inches

T = 48 1/2° F on #2

wants 80" on west 80 acres.

MICROFILMED



STATE OF IDAHO
DEPARTMENT OF WATER RESOURCES
EASTERN REGION

John V. Evans
Governor

C. Stephen Allred
Director

1515 Lincoln Road
Idaho Falls, Idaho 83401
(208) 523-7186

May 21, 1982

RE: Permit No. 33-7047

Charles H. McDonald
Howe,
Idaho 83244

Dear Mr. McDonald:

Enclosed please find an Order reinstating your permit and advancing the priority date to February 4, 1977.

We acknowledge receipt of the proof of beneficial use card submitted for the above referenced permit.

Before a license can be issued, a field examination must be made by a representative of this department. We cannot tell just when this examination will be made, but our examiner will try to contact you at the time he makes the examination so that you may show him the system.

If you have any questions regarding the field examination, please contact our eastern regional office.

Very truly yours,

COLLEEN WRAY
Adm. Secretary

IDWR - State Office

MICROFILMED

C. N. S. DONALD

Howe

IDAHO 83244

RECEIVED

MAR 25 1982

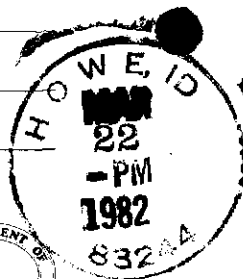

MICROFILMED

Department of Water Resources

IDAHO DEPARTMENT OF WATER RESOURCES
STATEHOUSE
BOISE, IDAHO 83720

DEPARTMENT OF WATER RESOURCES

The Idaho Department of Water Resources will consider this card as a statement that the permit holder(s) has completed development to the extent shown below of Permit No. 23-7047.

Name(s) of Permit Holder: CHARLES H. McDONALD

Post Office Address: HOWE, IDAHO 83244

Tel. No. 767-3379

Source of Water: GROUND WATER

Use of Use:

<input type="checkbox"/> Domestic	_____	(number of households)
<input type="checkbox"/> Stockwater	_____	(number and type of stock)
<input checked="" type="checkbox"/> Irrigation	<u>80</u>	(acres)
<input type="checkbox"/> Other	_____	

Measuring Device: Required? ☐ Yes ☐ No Installed? ☐ Yes ☐ No
Access Port: Required? ☒ Yes ☐ No Installed? ☒ Yes ☐ No

The above information is a true statement of the extent to which the above numbered permit has been developed.

MARCH 19, 1982
Date

Charles H. McDonald
Signature of Permit Holder

WARNING

CANCELLED OR LAPSED

This permit has been officially CANCELLED or LAPSED.

Ninety days following the date of official action this file will be DESTROYED.

STATE OF IDAHO
DEPARTMENT OF WATER RESOURCES

STATEHOUSE
BOISE, IDAHO 83720
(208) 334-4440

MC DONALD, CHARLES H.
HOWE, ID 83244

MARCH 02, 1982

DEAR PERMIT HOLDER:

YOU ARE HEREBY NOTIFIED THAT UNDER THE PROVISIONS OF SECTION 42-218A OF THE IDAHO CODE, PERMIT NO. 33-7047 HAS LAPSED. THIS OFFICE DID NOT RECEIVE EITHER A NOTICE THAT YOU HAVE COMPLETED THE PROJECT BY THE DATE REQUIRED ON YOUR PERMIT, OR A REQUEST FOR AN EXTENSION OF TIME. YOU WERE PROVIDED THE PROPER FORMS IN OUR NOTICE TO YOU DATED DECEMBER 31, 1981.

YOUR PERMIT CANNOT BE REINSTATED UNLESS YOU SUBMIT THE STATEMENT OF BENEFICIAL USE POSTCARD OR SUBMIT AN EXTENSION OF TIME REQUEST SHOWING REASONABLE CAUSE FOR DELAY. EITHER THE COMPLETED POSTCARD OR THE EXTENSION REQUEST MUST BE RECEIVED BY THIS OFFICE WITHIN SIXTY DAYS OF THE DATE OF THIS LAPSE NOTICE OR THE PERMIT WILL NO LONGER BE OF ANY FORCE OR EFFECT.

A STATEMENT OF BENEFICIAL USE POSTCARD AND A REQUEST FOR EXTENSION OF TIME FORM ARE ENCLOSED FOR YOUR USE. PLEASE NOTE THAT A FEE OF \$15.00 MUST ACCOMPANY AN EXTENSION OF TIME REQUEST.

L. GLEN SAXTON
CHIEF, OPERATIONS BUREAU

ENCLOSURES

CERTIFICATION OF MAILING

I hereby certify that on 3-15-1982
~~a copy~~ an original of this document was
deposited in the United States mail,
postage prepaid addressed to the
individual(s) named above.

John Lusk

MICROFILMED

STATE OF IDAHO
DEPARTMENT OF WATER RESOURCES

STATEHOUSE
BOISE, IDAHO 83720
(208) 334-4440
CERTIFIED MAIL

138971

MC DONALD, CHARLES H.
HUWE, ID 83244

DECEMBER 31, 1981

DEAR PERMIT HOLDER:

ONE OF THE CONDITIONS OF APPROVAL OF YOUR WATER PERMIT NO. 33-7047 WAS THAT EVIDENCE OF THE EXTENT OF DEVELOPMENT MUST BE SUBMITTED TO THIS OFFICE ON OR BEFORE MARCH 01, 1982. (SEE LAST PAGE OF YOUR APPROVED PERMIT). ENCLOSED IS A POST CARD WHICH MAY BE USED TO SUBMIT THE REQUIRED PROOF OF BENEFICIAL USE.

IF YOU HAVE NOT FULLY COMPLETED YOUR PROJECT, AND YOU HAVE NOT PREVIOUSLY RECEIVED AN EXTENSION OF TIME, YOU MAY REQUEST AN EXTENSION OF TIME PROVIDED THE DELAY IS FOR REASONABLE CAUSE AS INDICATED IN SECTION 42-204, IDAHO CODE, AMENDED. IF YOU HAVE BEEN PREVENTED FROM PROCEEDING BY A GOVERNMENTAL AGENCY OR BY LITIGATION, MORE THAN ONE EXTENSION OF TIME CAN BE GRANTED.

EITHER THE BENEFICIAL USE POST CARD OR A REQUEST FOR AN EXTENSION OF TIME MUST BE RECEIVED BY THIS DEPARTMENT ON OR BEFORE THE ABOVE MENTIONED DATE, OTHERWISE, THE PERMIT WILL LAPSE AND BE OF NO FURTHER FORCE OR EFFECT WITHIN 60 DAYS.

SINCERELY,

RITA FLECK
SR. SECRETARY

ENC: 1

MICROFILMED



State of Idaho

DEPARTMENT OF WATER RESOURCES

STATE OFFICE, 450 W. State Street, Boise, Idaho

JOHN V. EVANS

Governor

C. STEPHEN ALLRED

Director

Mailing address:
Statehouse
Boise, Idaho 83720
(208) 334-4440

19 May, 1981

Dear Wateruser:

The enclosed Order changes the measuring device condition of approval on your water right permit.

The changed condition is less restrictive and provides you the option to install an access port or have your system measured and certified by a professional engineer. Instructions for access port installation are also enclosed.

If you have questions regarding this matter, please contact the Regional Office nearest to you.

Sincerely,

David R. Tuthill Jr.

DAVID R. TUTHILL JR., P.E.
Supervisor, Water Allocations Section

DRT:jg

Enclosures

Northern Region Office
Rt. #5 Box 203, Government Way
Coeur d'Alene, Idaho 83814

Eastern Region Office
1515 Lincoln Road
Idaho Falls, Idaho 83401

Southern Region Office
1041 Blue Lake Boulevard North
Idaho Falls, Idaho 83301

Western Region Office
92 South Cole Road
Boise, Idaho 83705

MICROFILMED

JUN 1977
WELL DRILLER'S REPORT

State law requires that this report be filed with the Director, Department of Water Resources within 30 days after the completion or abandonment of the well.

Department of Water Resources
Eastern District Office

1. WELL OWNER

Name CHARLES H. McDONALD
Address HOWE, IDAHO 83213
Owner's Permit No. 33-7047

7. WATER LEVEL

Static water level 42 feet below land surface
Flowing? ☐ Yes ☒ No G.P.M. flow _____
Temperature _____ ° F. Quality 9006
Artesian closed-in pressure _____ p.s.i.
Controlled by ☐ Valve ☐ Cap ☐ Plug

2. NATURE OF WORK

☒ New well ☐ Deepened ☐ Replacement
☐ Abandoned (describe method of abandoning)

8. WELL TEST DATA

☒ Pump ☐ Bailor ☐ Other

Discharge G.P.M.	Draw Down	Hours Pumped
<u>400</u>	<u>30'</u>	<u>8 HRS.</u>

3. PROPOSED USE

☐ Domestic ☒ Irrigation ☐ Test ☐ Other (specify type)
☐ Municipal ☐ Industrial ☐ Stock ☐ Waste Disposal or Injection

9. LITHOLOGIC LOG

Hole Diam.	Depth		Material	Water	
	From	To		Yes	No
16"	0	6	SOIL		
	6	17	GRAVEL		
	17	24	HARD PAN		
	24	50	SAND + GRAVEL		
	50	65	SAND + GRAVEL		
	65	71	SANDY CLAY		
	71	85	SAND + GRAVEL		
	85	92	SANDY CLAY		
	92	95	SAND + GRAVEL		
	95	100	CLAY		

4. METHOD DRILLED

☒ Cable ☐ Rotary ☐ Dug ☐ Other

5. WELL CONSTRUCTION

Diameter of hole 16 inches Total depth 100 feet
Casing schedule: ☒ Steel ☐ Concrete

Thickness	Diameter	From	To
<u>1.250</u> inches	<u>16</u> inches	<u>1</u> feet	<u>100</u> feet
_____ inches	_____ inches	_____ feet	_____ feet
_____ inches	_____ inches	_____ feet	_____ feet
_____ inches	_____ inches	_____ feet	_____ feet
_____ inches	_____ inches	_____ feet	_____ feet

Was casing drive shoe used? ☒ Yes ☐ No
Was a packer or seal used? ☐ Yes ☐ No
Perforated? ☒ Yes ☐ No
How perforated? ☒ Factory ☐ Knife ☐ Torch
Size of perforation 1/8 inches by 2 inches

Number	From	To
<u>1080</u> perforations	<u>30</u> feet	<u>90</u> feet
_____ perforations	_____ feet	_____ feet
_____ perforations	_____ feet	_____ feet

Well screen installed? ☐ Yes ☒ NoManufacturer's name _____
Type _____ Model No. _____
Diameter _____ Slot size _____ Set from _____ feet to _____ feet
Diameter _____ Slot size _____ Set from _____ feet to _____ feetGravel packed? ☐ Yes ☒ No Size of gravel _____
Placed from _____ feet to _____ feetSurface seal depth 20 Material used in seal ☐ Cement grout
☐ Pudding clay ☒ Well cuttingsSealing procedure used ☐ Slurry pit ☐ Temporary surface casing
☐ Overbore to seal depth

6. LOCATION OF WELL

Sketch map location must agree with written location.

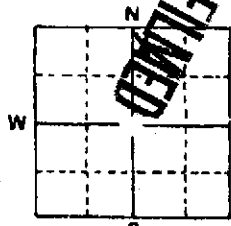

Subdivision Name _____

Lot No. _____ Block No. _____

County BUTTENW 1/4 NE 1/4 Sec. 26, T. 6 N1/2, R. 29 E1/4

10.

Work started APRIL 4/77 finished april 13/77

11. DRILLERS CERTIFICATION

Firm Name GUTHRIE WELL DRILLING Firm No. 226
Address P.O. BOX 319 ARCO, IDAHO 83213 Date 6/9/77
Signed by (Firm Official) G.T. Guthrie
and
(Operator) G.T. Guthrie

March 4, 1977

Re: Permit No. 33-7047

Charles H. McDonald
Howe, ID 83244

Dear Mr. McDonald:

Enclosed is a copy of your approved Application for Permit No. 33-7047. We direct your attention to the conditions of approval as listed on the fourth page.

Be sure to note that a special condition requiring you to install and maintain a measuring device at your point of diversion has been placed upon your permit. We are enclosing a letter describing different types of measuring devices accepted by this office.

Sincerely,

BOBBY D. FLEENOR
Chief, Water Rights

Enclosure: Copy of permit

MICROFILMED

February 7, 1977

RE: Application for Permit No. 33-7047 McDONALD

Arco Advertiser
Box "C"
Arco, Idaho 83213

Gentlemen:

Would you please submit an affidavit of publication and certified bill in connection with the above referenced application. The legal notice was to have been published in your paper on January 20 and January 27, 1977.

Your cooperation in this matter is greatly appreciated.

Very truly yours,

RONALD D. CARLSON
Supervisor,
Eastern Region

RDC:CW

cc: IDWR - State Office

MICROFILMED

*Called 2-14-77
CW*

January 13, 1977

RE: Application for Permit No. 34-7047 McDONALD

Arco Advertiser
Box "C"
Arco, Idaho 83213

Gentlemen:

Enclosed you will find a legal notice which we wish to have published once a week for two consecutive weekly issues of your newspaper. We have inserted the publication dates allowing time for you to submit us a galley proof for review before publication.

After sending us a galley proof, proceed with the publication on the dates we have inserted, assuming the notice is correct. If we have any corrections, we will notify you before the first publication. If you cannot publish the notice on the proposed dates, please contact us immediately.

An affidavit of publication must be submitted to the Department along with the publication bill.

Very truly yours,

RONALD D. CARLSON
Supervisor,
Eastern Region

Bill submitted 2-23-77 by CW

RDC:CW

Enc: Legal Notice (1)

PUBLIC NOTICE

NOTICE OF APPLICATION FOR WATER PERMIT

Notice is hereby given that Charles H. McDonald, Howe, Idaho, has on 1-11-77 submitted Application No. 33-7047 for a permit to appropriate 1.86 cubic feet per second of water from a ground-water source by means of well and pump within the NW $\frac{1}{4}$ NE $\frac{1}{4}$, Sec. 26, T. 6N, R. 29E, B.M., Butte County, to be used from Apr. 1 to Nov. 1 for the irrigation of 240 acres within the NW $\frac{1}{4}$, Sec. 25, W $\frac{1}{2}$ NE $\frac{1}{4}$, Sec. 26, T. 6N, R. 29E, B.M. If issued, this permit will be subject to all prior water rights. It must be filed with the Idaho Department of Water Resources, 1015 Lincoln Road, Idaho Falls, Idaho, 83401 on or before February 27, 1977.

R. KEITH HIGGINSON
Director

Published in the Ardo Advertiser,
Idaho on January 20 and
January 27, 1977.

NOTICE OF APPLICATION FOR WATER PERMIT

Notice is hereby given that Charles H. McDonald,
Howe, Idaho

has on 1-11-77 submitted Application No. 33-7047
for a permit to appropriate 1.86 cubic feet per second ~~XXXXXXXXXXXXXXXXXXXX~~
of water from a ground-water source
by means of well and pump
within the NW $\frac{1}{4}$, Sec. 26, T. 6N, R. 29E, B.M., Butte County;

to be used from Apr. 1 to Nov. 1
for the irrigation of 240 acres

within the NW $\frac{1}{4}$, Sec. 25, W $\frac{1}{2}$ NE $\frac{1}{4}$, Sec. 26, T. 6N, R. 29E, B.M.

If issued, this permit will be subject to all prior water rights. Protests
against the granting of the permit must be filed with the Idaho Department of
Water Resources, 1515 Lincoln Road, Idaho Falls, Idaho, 83401 on or before _____
February 7, 1977

R. KEITH HIGGINSON

Director

Published in the Arco Advertiser, Arco, Idaho

on January 20 and January 27, 1977

McG. Me-G.

DEPARTMENT OF WATER RESOURCES
- STAFF ANALYSIS -

Item Initial Date

Application No. McDonald

- ☒ Source
☒ Point of Diversion
☒ County
☒ Quantity of Water and Period of Use
☒ Description of Diverting Works
☒ Time required for B/U of water
☒ Place of Use or Acres Irrigated
☒ Map
☒ Signature
☒ Fee

(1) EMC 1/11/77

In form to receipt YES

(2) EMC 1/11/77

Send Copies to:

- ☒ Idaho State Health Department
☒ Idaho Fish and Game Department
☒ Bureau of Land Management

(3) EMC 1/11/77

- ☒ Request Special Use Permit from U.S.F.S.
☒ Request Easement from B.L.M.
☒ Request Information from Applicant

(4) EMC 1/11/77

In form for advertising YES

(5) EMC 1/11/77

Platted on Map No. IN 33E BASIN 33

(6) EMC 1/11/77

Located within Water District No. _____

(7) EMC 1/11/77

Critical groundwater area: yes _____ no X

(8) EMC 1/11/77

Groundwater levels:

_____ Declining, X Stable, _____ Increasing

(comment) OB. WELL ON 30E 30ABA1

(9) EMC 1/11/77

Other rights on the same place of use L. # 33-2046
for 2094 a/s

(10) EMC 1/11/77

Comments: PURPOSE IS TO BRING LICENSED H₂O
UP TO ONE INCH PER FOOT

(11) EW 2-23-77

Affidavit of Publication received (date) Feb. 23, 1977

(12) EW 2-23-77

Final date for protests February 7, 1977

Protests received: yes _____ no X

(13) RDC 2/23/77

All requested information received from agencies or applicant: yes _____ no _____

(14) 11 11

Action recommended:

✓ Approve _____ Deny

1/11/77 Proposed Priority

Reason for Reduction _____

✓ Measuring device required

See attached sheet for other conditions of approval

No special conditions for approval

(15) District E

By RDC

Date 2/23/77

MICROFILMED