

13. Map of proposed project: show clearly the proposed point of diversion, place of use, section number, township and range number.

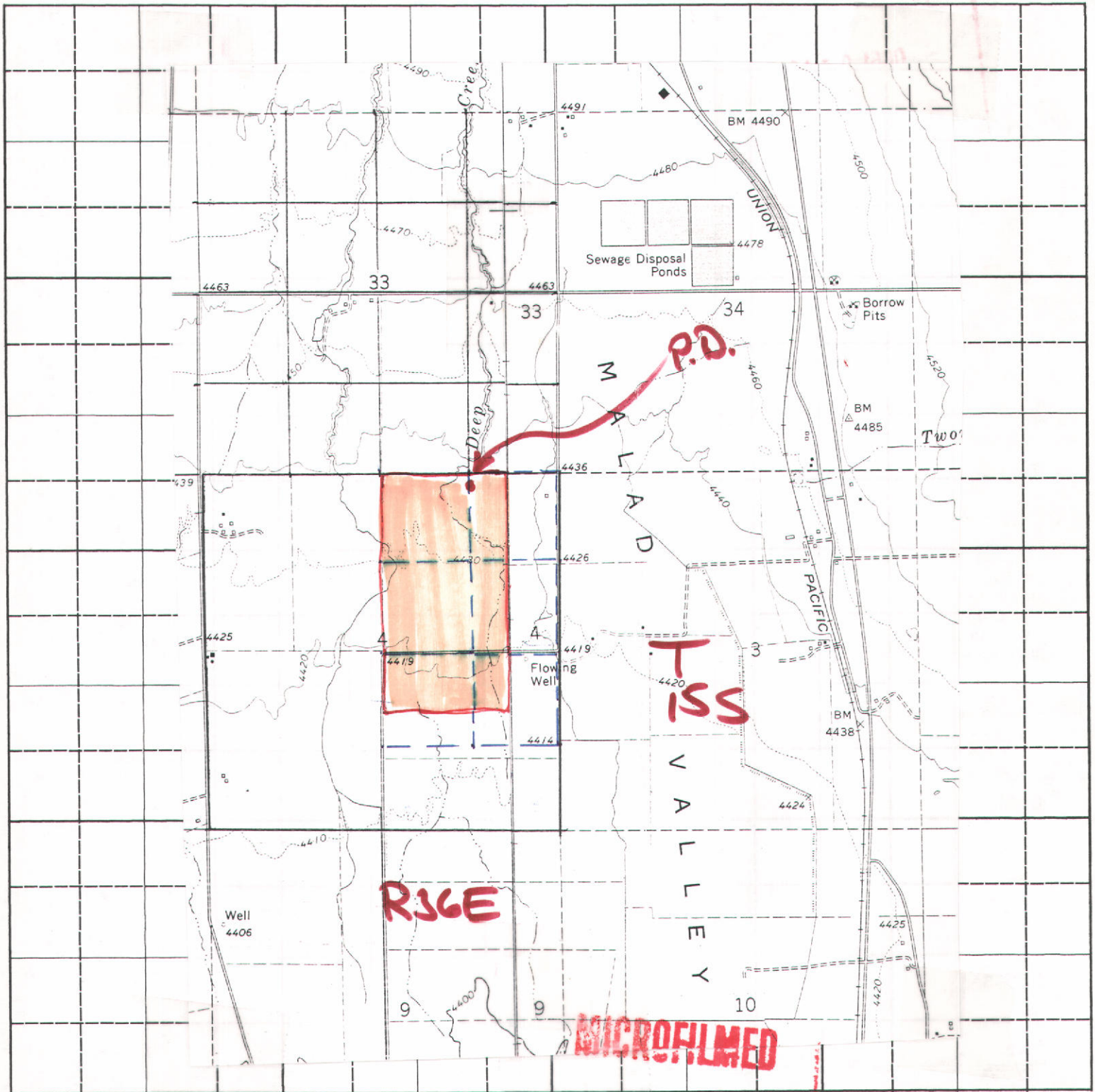

Scale: 2 inches equal 1 mile.

BE IT KNOWN that the undersigned hereby makes application for permit to appropriate the public waters of the State of Idaho as herein set forth.

Jennie Alder
(Applicant) *Jeff Alder*

Nº 1260

AFFIDAVIT OF PUBLICATION

RECEIVED

OCT 4 1990

STATE OF IDAHO, }
 } ss.
County of Oneida }

Department of Water Resources
Eastern District Office

Sandra Struks

being duly sworn,
deposes and says: That she is the secretary of THE IDAHO ENTERPRISE, a weekly newspaper published at Malad, in the County of Oneida and State of Idaho; that said paper has been and is in general circulation in the county aforesaid, and in the vicinity of Malad; that the advertisement, a copy of which is attached hereto, was published in said newspaper once a week for 2 consecutive weeks in the regular and entire issue of said paper during the period of time of publication, and was published in the newspaper proper and not a supplement; that said paper has been established and regularly published for more than seventy-eight consecutive weeks prior to the date of first publication of said advertisement.

Such notice was published in the issue beginning with

September 6, 1990, and ending

with the issue of September 13, 1990

Sandra Struks

Fee \$ 65.84

Subscribed and sworn to before me this 3rd day

of October, 1990.

Susan J. Wittman

Notary Public, Residing at Malad, Idaho

My Commission Expires 2-9, 1994

NOTICE OF APPLICATION FOR WATER RIGHT

The Following application(s) have been filed to appropriate the public waters of the State of Idaho:
15-07117

ALDER, JENNIE
ALDER, JEFF
440 S. MAIN
MALAD, ID 83252
Source: GROUNDWATER
Diversions Pt:

NENE Sec 4 T 15S R 36E
Use: IRRIGATION (3.000 CFS)
Total Diversion: (3.000 CFS)

Date Filed: 1/19/1990
In: T15S R36E S04
NENE NWNE SWNE SENE
NESE NWSE
150.0 ACRES TOTAL
15-07122

JONES, CAROL D.
JONES, DEON D.
RT. 1 BOX 133
MALAD CITY, ID 83252
Source: SPRING Tributary: SINKS
Diversions Pt:

SESENW Sec 8 T 14S R 36E
Use: IRRIGATION (.100 CFS)
STOCKWATER (.030 CFS)
Total Diversion: (.100 CFS)

Date Filed: 4/17/1990
In: T14S R36E S08 NESW
5.0 ACRES TOTAL
15-07123

EVANS, DAVID E
519 FRUITVALE ROAD
VACAVILLE, CALIFORNIA 95688
Source: GROUNDWATER
Diversions Pt:

NWNE Sec 15 T 14 S R 36E
Use: STOCKWATER (.030 CFS)
Total Diversion: (.030 CFS)

Date Filed: 6/25/1990
In: T14S R36E S15 NWNE

The permit(s) will be subject to all prior water rights. Protests must be filed with the Director, Dept. of Water Resources, Eastern Region, 150 Shoup Avenue, Suite 15, Idaho Falls, Idaho 83402 on or before SEPTEMBER 24, 1990.

R. KEITH HIGGINSON,
Director

No. 1260
9-6-13 T2

MICROFILM

NOV 26 1990

No. 1245

AFFIDAVIT OF PUBLICATION

RECEIVED

AUG - 6 1990

STATE OF IDAHO, }
 } ss.

County of Oneida

Department of Water Resources
Eastern District Office

Sandra Strub

being duly sworn,
deposes and says: That she is the secretary of THE IDAHO ENTERPRISE, a weekly newspaper published at Malad, in the County of Oneida and State of Idaho; that said paper has been and is in general circulation in the county aforesaid, and in the vicinity of Malad; that the advertisement, a copy of which is attached hereto, was published in said newspaper once a week for 2 consecutive weeks in the regular and entire issue of said paper during the period of time of publication, and was published in the newspaper proper and not a supplement; that said paper has been established and regularly published for more than seventy-eight consecutive weeks prior to the date of first publication of said advertisement.

Such notice was published in the issue beginning with

July 19, 1990, and ending

with the issue of July 26, 1990

Sandra Strub

Fee \$ 54.46

Subscribed and sworn to before me this 27th day

of July, 1990.

Susan J. Wittman
Notary Public, Residing at Malad, Idaho

My Commission Expires Feb. 9, 1994

Application Notice

NOTICE OF APPLICATION FOR WATER RIGHT

The Following application(s) have been filed to appropriate the public waters of the State of Idaho:
15-07117

ALDER, JEFF
ALDER, JENNIE
440 S. MAIN
MALAD, ID 83252
Source: GROUNDWATER
Diversion Pt: NENE

Sec 4 T 15S R 36E

Use: IRRIGATION (3.000 CFS)

Total Diversion: (3.000 CFS)

Date Filed: 1/19/1990

In: T15S R36E S04

NENE NWNE SWNE SENE

NESW NWSW

150.0 ACRES TOTAL

15-07122

JONES, CAROL D.

JONES, DEON D.

RT. 1, BOX 133

MALAD CITY, IDAHO 83252

Source: SPRING Tributary: SINKS

Diversion Pt: SESENW

Sec 8 T 14S R 36E S08 NESW

5.0 ACRES TOTAL

The permit(s) will be subject to all prior water rights. Protests must be filed with the Director, Dept. of Water Resources, Eastern Region, 150 Shoup Avenue, Suite 15, Idaho Falls, Idaho 83402 on or before AUGUST 26, 1990.

R. KEITH HIGGINSON,
Director

No. 1245
7-19-26 T2

MICROFILMED

NOV 26 1990

ACTION OF THE DEPARTMENT OF WATER RESOURCES

This Permit is Approved Date 10-6-92

If approved, this permit authorizes the construction or modification of a well subject to the following conditions: **READ CAREFULLY!**

GENERAL CONDITIONS:

1. The well must be constructed in compliance with the applicable statutes, specific conditions of approval shown on the water right permit, injection well permit, transfer or amendment and the rules and regulations of the Department for water appropriation, injection wells and well construction standards.
2. This drilling permit is valid for two (2) months from the above approval date for the start of construction and is valid for one (1) year from the approval date for completion of the well unless an extension has been granted.
3. This permit does not constitute an approval of the District Health Department or the Idaho Department of Health and Welfare which may be required before construction of this well. All wells must be drilled a minimum distance of 100 feet from a drain field. Domestic and Public Water Supply wells must be drilled a minimum distance of 50 feet and 100 feet respectively from a septic tank.
4. The well shall be constructed by a driller currently licensed in the State of Idaho who must maintain a copy of the drilling permit at the drilling site.
5. Approval of this drilling permit does not authorize trespass on the land of another party.
6. This permit does not constitute other local, county, state or federal approvals which may be required for construction of a well.
7. This drilling permit does not represent a right to divert and use the water of the State of Idaho.
8. If a bottom hole temperature of 85° or greater is encountered, well construction shall cease and the well driller and the well owner shall contact the Department immediately.
9. If this permit is for a replacement well, the well being replaced must be abandoned in accordance with Department Rules and Regulations.

SPECIFIC CONDITIONS:

[Signature]
Signature of Authorized Department Representative

[Signature]
Title

Receipt No. ED17953 Received by [Signature] Fee 200 Date 10-6-92

EXTENSION OF DRILLING PERMIT

Extension approved by _____ Approval Date _____

This extension is good for 60 days beyond the above extension approval date.

REPRODUCTION
JAN 10 1994

ANALYSIS SHEET
FOR
EXTENSION OF TIME

Permit No. 15-07117 Reviewed by Klg Date 11/2/92

BASIC INFORMATION

10/26/92 Date stamp received
yes Extension received timely
yes Fee received and receipted
yes Name and signature same as permit
yes Address Change

BASIS FOR EXTENSION REQUEST

yes Has adequate work been completed to demonstrate due diligence?
Has the permit been involved in litigation?
Is supporting documentation needed to complete the file? Requested?
Is delay by a government agency?
Is supporting documentation needed to complete the file? Requested?
Is the project more than 25,000 acre feet for irrigation or 10,000 acre feet for a reservoir?

ACTION TAKEN

Recommend approval Based on due diligence
Extend to 6/1/93

PRIORITY CALCULATION

Date extension received	<u>NA</u>	=	_____
Proof due date	/	=	_____
Number of days late	/	=	_____
Priority date	/	=	_____
New Priority Date	/	=	_____

DATA ENTRY

New Address 215 Cherry Creek Rd Klg
Change Proof Due Date 11/3/92 Klg
Change Priority Date _____

RECEIVED

OCT 29 1993

Department of Water Resources

OFFICE USE ONLY
Amt. of Fee \$ 150.00
Date 10-29-93
Receipt No. 028889
Receipt by _____

STATE OF IDAHO
DEPARTMENT OF WATER RESOURCES

PROOF OF BENEFICIAL USE

The Idaho Department of Water Resources considers this form a statement that the permit holder(s) has/have completed all development that will occur under this permit and that water has been applied according to the provisions of the permit for the beneficial use(s) described below. This form must be accompanied by a license examination fee, when necessary, or a completed field examination report prepared by a certified water right examiner who has been appointed by the department.

- 1. Permit No. 15-07117 Telephone No. 208-766-4946
- 2. Name(s) of Permit Holder(s): Jeff Alder and Jennie Alder
- 3. Mailing Address: 215 Cherry Creek Rd. Malad, Idaho 83252
- 4. Source of Water: Groundwater - Well

If **GROUNDWATER**, Well Driller's Name: Arnold Lundstrom Date Drilled: 1991

OPTIONAL:

Pump horsepower: 50 HP Pressure (psi): _____ Dynamic pumping level (ft.): _____

5. Extent of Use (as authorized by the permit):

Domestic _____ (No. of households) Stockwater _____ (No. and type of stock)

Irrigation 150 (No. of acres) Other _____

6. Total rate and/or volume for which proof is submitted 3.00 cfs OR _____ acre/feet

7. Refer to the approval conditions on your permit and respond accordingly:

Measuring device: Required? ___ Yes ___ No Installed? ___ Yes ___ No

OR

Flow Measurement Port: Required? ___ Yes ___ No Installed? ___ Yes ___ No

8. Fee Enclosed: \$ 150.00 (See License Fee Schedule on back of Instruction Sheet)

9. Person to contact to accompany the Department representative during field examination of the water system.

Jeff Alder 208-766-4946
Name Telephone No.

215 Cherry Creek Rd. Malad, Id. 83252
Address

10. The above information is my true statement of the extent to which the above numbered permit has been developed and I relinquish any undeveloped portion of the permit to the state of Idaho.

10/24/93
Date

Jeff Alder
Signature (and title, if on behalf of a company or organization)

JAN 10 1994

BEFORE THE DEPARTMENT OF WATER RESOURCES
OF THE
STATE OF IDAHO

IN THE MATTER OF PERMIT NO. 15-07117) ORDER EXTENDING
IN THE NAME OF JENNIE AND JEFF ALDER) PROOF OF
BENEFICIAL USE)

WHEREAS, the Department has issued the above-captioned permit with the condition that proof of construction of works and application of water to beneficial use be submitted on or before June 1, 1993; and,

WHEREAS, notice was not given to the permit holder sixty days prior to the date that proof of beneficial use of water was due as required by Section 42-204, Idaho Code;

IT IS THEREFORE HEREBY ORDERED that the time within which to submit the proof of beneficial use of water under Permit No. 15-07117 be extended to November 1, 1993.

Dated this 13th day of August, 1993.

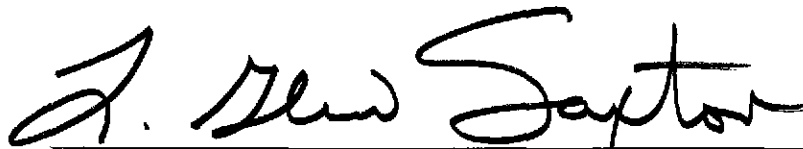

L. GLEN SAXTON
Chief, Water Allocations Bureau

RECEIVED

JAN 10 1994

RECEIVED

OCT 26 1992

For Office Use Only
\$15 Fee Received by AWJ
Date 10-26-92
Receipt No. E018031

STATE OF IDAHO Department of Water Resources
Eastern District Office
DEPARTMENT OF WATER RESOURCES

REQUEST FOR EXTENSION OF TIME
TO PROVIDE ADDITIONAL TIME IN WHICH TO SUBMIT PROOF OF
BENEFICIAL USE FOR A WATER RIGHT PERMIT

The Idaho Department of Water Resources will consider this form as a request that the permit holder(s) be granted an additional period of time in which to complete development of water right under the provisions of Section 42-204, Idaho Code.

Permit No. 15 - 07117

Name(s) of Permit Holder: Jennie Alder + Jeff Alder

Mailing Address: 215 Cherry Creek Road Malad, Idaho 83252

Date Proof is Due Nov. 1, 1992 Telephone No. 208 - 766 - 4946

Describe what work has been completed toward the development of this water right:
(This must be filled out! If no work has been completed, show "none".)

The well has been drilled to 233 feet with 16 inch well casing but needs to be perforated again.

Costing \$ 15,000⁰⁰

The permit holder(s) has been unable to complete the remainder of the work for the following reasons:

We are now waiting for the well driller to come back and perforate the casing again; because it was not done right the first time. Then we will install a pump to complete the project.

Permit holder(s) request an extension to June, 19 92

FEE: \$15.00

(Signature)* Jeff Alder

*If other than permit holder, Power of Attorney must be supplied.

MICROFILMED

ACTION OF THE DEPARTMENT OF WATER RESOURCES

IT IS HEREBY ORDERED that the above request for extension of time be APPROVED and the time within which to submit proof of beneficial use is extended to June 1, 1993.

NOV 12 1992

Signed this 3 day November, 19 92

[Signature]
Chief, Water Allocation Bureau

State of Idaho
Department of Water Resources

Permit To Appropriate Water

NO. 15-07117

Proposed Priority: January 19, 1990 Maximum Diversion Rate: 3.00 CFS
This is to certify, that JENNIE ALDER

JEFF ALDER
440 S. MAIN
MALAD, ID 83252

has applied for a permit to appropriate water from: GROUNDWATER
and a permit is APPROVED for development of water as follows:

<u>BENEFICIAL USE</u>	<u>PERIOD OF USE</u>	<u>RATE OF DIVERSION</u>
IRRIGATION	04/01 to 11/01	3.00 CFS
<u>LOCATION OF POINT(S) OF DIVERSION:</u>	NENE	Sec. 4, Township 15S, Range 36E ONEIDA County

PLACE OF USE: IRRIGATION

<u>TWN RGE SEC</u>	<u>ACRES</u>	<u>ACRES</u>	<u>ACRES</u>	<u>TOTAL</u>
15S 36E 4	NENE 20	NWNE 40	SWNE 40	
	SENE 20	NESE 10	NWSE 20	150
				Total number of acres irrigated: 150

CONDITIONS/REMARKS:

1. Proof of construction of works and application of water to beneficial use shall be submitted on or before November 1, 1992.
2. Subject to all prior water rights.
3. Project construction shall commence within one year from the date of permit issuance and shall proceed diligently to completion unless it can be shown to the satisfaction of the Director of the Department of Water Resources that delays were due to circumstances over which permit holder had no control.
4. Permit holder shall comply with the drilling permit requirements of Section 42-235, Idaho Code.

This permit is issued pursuant to the provisions of Section 42-204, Idaho Code.
Witness the seal and signature of the Director, affixed at Boise, this

6th day of November, 1990.

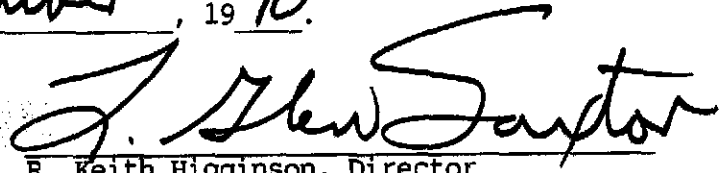
for

R. Keith Higginson, Director

MICROFILMED

NOV 26 1990

157117

Form 202
6/85

Ident. No. _____

STATE OF IDAHO
DEPARTMENT OF WATER RESOURCES
APPLICATION FOR PERMIT

To appropriate the public waters of the State of Idaho

1. Name of applicant Jennie or Jeff Alder Phone 776-4946
Post office address 440 S. Main, Malad, ID 83252

2. Source of water supply Groundwater which is a tributary of _____

3. Location of point of diversion is _____ 1/4 of NE _____ 1/4 of NE _____ 1/4, Govt. Lot _____
Sec. 4 Township 15S Range 36E B.M. Oneida County; additional
points of diversion if any: _____

4. Water will be used for the following purposes:

Amount 3.00 for Irrigation purposes from 4-1 to 11-1 (both dates inclusive)
(cfs or acre-feet per annum)

Amount _____ for _____ purposes from _____ to _____ (both dates inclusive)
(cfs or acre-feet per annum)

Amount _____ for _____ purposes from _____ to _____ (both dates inclusive)
(cfs or acre-feet per annum)

Amount _____ for _____ purposes from _____ to _____ (both dates inclusive)
(cfs or acre-feet per annum)

5. Total quantity to be appropriated is (a) 3.00 and/or (b) _____
cubic feet per second acre feet per annum

6. Proposed diverting works:

a. Description of ditches, flumes, pumps, headgates, etc. Well & pump to sprinklers

b. Height of storage dam _____ feet; active reservoir capacity _____ acre-feet; total
reservoir capacity _____ acre-feet; period of year when water will be diverted to storage:
_____ to _____ inclusive.

c. Proposed well diameter is NA inches; proposed depth of well is NA feet.

d. Is ground water with a temperature of greater than 90°F being sought? NO

7. Time required for the completion of the works and application of the water to the proposed beneficial use is
2 years (minimum 1 year).

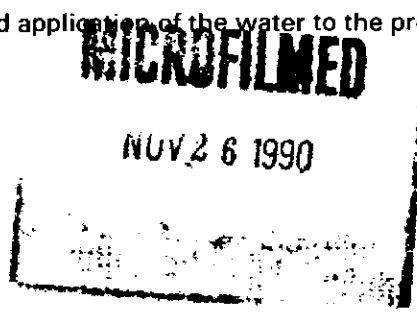

8. Description of proposed uses (if irrigation only, go to item 9):

- a. Hydropower; show total feet of head and proposed capacity in KW. _____
- b. Stockwatering; list number and kind of livestock. _____
- c. Municipal; show name of municipality. _____
- d. Domestic; show number of households. _____
- e. Other; describe fully. _____

9. Description of place of use:

- a. If water is for irrigation, indicate acreage in each subdivision in the tabulation below.
- b. If water is used for other purposes, place a symbol of the use (example: D for Domestic) in the corresponding place of use below. See instructions for standard symbols.

TWP	RANGE	SEC.	NE¼				NW¼				SW¼				SE¼				TOTALS
			NE¼	NW¼	SW¼	SE¼	NE¼	NW¼	SW¼	SE¼	NE¼	NW¼	SW¼	SE¼	NE¼	NW¼	SW¼	SE¼	
15S	36E	4	20	40	40	20					10	20			10	20			150

Total number of acres to be irrigated 150

10. Describe any other water rights used for the same purposes as described above. Claim 15-04147

11. a. Who owns the property at the point of diversion? Applicant

b. Who owns the land to be irrigated or place of use? Applicant

c. If the property is owned by a person other than the applicant, describe the arrangement enabling the applicant to make this filing. _____

12. Remarks: _____

MICROFILMED

NOV 26 1990

13. Map of proposed project: show clearly the proposed point of diversion, place of use, section number, township and range number.

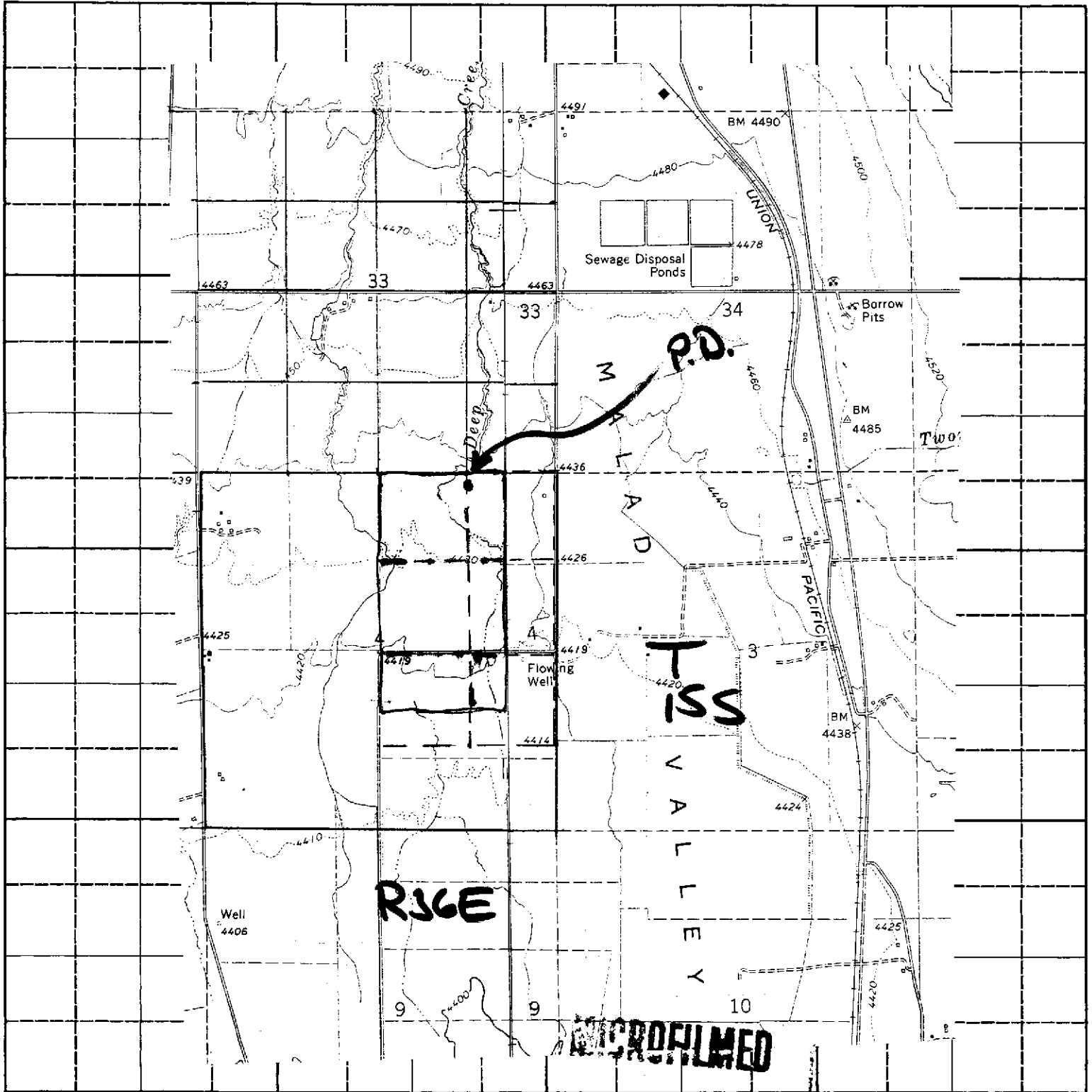

Scale: 2 inches equal 1 mile.

NOV 26 1990

BE IT KNOWN that the undersigned hereby makes application for permit to appropriate the public waters of the State of Idaho as herein set forth.

Jennifer Alder *Jeff Alder*
 (Applicant)

Received by C.W. Date 1-19-90 Time 12:15p Preliminary check by _____

Fee \$ 85.00 Received by HWS # E011796 Date 1-19-90

Publication prepared by RB Date 4-19-26-90 Published in ID Enterprise
7-19-26-90 9-8-13-90

Publication approved RB RB Date 6-5-90 10-12-90

ACTION OF THE DIRECTOR, DEPARTMENT OF WATER RESOURCES

This is to certify that I have examined Application for Permit to appropriate the public waters of the State of Idaho No. _____, and said application is hereby _____.

1. Approval of said application is subject to the following limitations and conditions:
 - a. SUBJECT TO ALL PRIOR WATER RIGHTS.
 - b. Proof of construction of works and application of water to beneficial use shall be submitted on or before _____, 19 ____.
 - c. The rate of diversion, if water is to be used for irrigation under this permit, when combined with all other water rights for the same land shall not exceed 0.02 cubic feet per second for each acre of land.
 - d. The water right acquired under this permit if for hydropower purposes shall be junior and subordinate to all rights to the use of water, other than hydropower, within the State of Idaho that are initiated later in time than the priority of this permit and shall not give rise to any right or claim against any future rights to the use of water, other than hydropower, within the State of Idaho initiated later in time than the priority of this permit.
 - e. Other:

MICROFILMED
NOV 26 1990

Nº 1260

AFFIDAVIT OF PUBLICATION

RECEIVED

STATE OF IDAHO, }
County of Oneida } ss.

OCT 4 1990

Department of Water Resources
Eastern District Office

Sandra Struhs

being duly sworn,
deposes and says: That she is the secretary of THE IDAHO ENTERPRISE, a weekly newspaper published at Malad, in the County of Oneida and State of Idaho; that said paper has been and is in general circulation in the county aforesaid, and in the vicinity of Malad; that the advertisement, a copy of which is attached hereto, was published in said newspaper once a week for 2 consecutive weeks in the regular and entire issue of said paper during the period of time of publication, and was published in the newspaper proper and not a supplement; that said paper has been established and regularly published for more than seventy-eight consecutive weeks prior to the date of first publication of said advertisement.

Such notice was published in the issue beginning with

September 6, 19 90, and ending

with the issue of September 13, 19 90

Sandra Struhs

Fee \$ 65.84

Subscribed and sworn to before me this 3rd day

of October, 19 90

Susan J. Wittman

Notary Public Residing at Malad, Idaho

My Commission Expires 29, 19 94

NOTICE OF APPLICATION FOR WATER RIGHT

The Following application(s) have been filed to appropriate the public waters of the State of Idaho:

15-07117

ALDER, JENNIE
ALDER, JEFF
440 S. MAIN
MALAD, ID 83252
Source: GROUNDWATER
Diversion Pt:

NENE Sec 4 T 15S R 36E
Use: IRRIGATION (3.000 CFS)
Total Diversion: (3.000 CFS)

Date Filed: 1/19/1990

In: T15S R36E S04

NENE NWNE SWNE SENE
NESE NWSE

150.0 ACRES TOTAL

15-07122

JONES, CAROL D.

JONES, DEON D.

FT. 1 BOX 133

MALAD CITY, ID 83252

Source: SPRING Tributary: SINKS
Diversion Pt:

SESENW Sec 8 T 14S R 36E
Use: IRRIGATION (.100 CFS)

STOCKWATER (.030 CFS)

Total Diversion: (.100 CFS)

Date Filed: 4/17/1990

In: T14S R36E S08

5.0 ACRES TOTAL

15-07123

EVANS, DAVID E

519 FRUITVALE ROAD

VACAVILLE, CALIFORNIA 95688

Source: GROUNDWATER

Diversion Pt:

NWNE Sec 15 T 14 S R 36E
Use: STOCKWATER (.030 CFS)

Total Diversion: (.030 CFS)

Date Filed: 6/25/1990

In: T14S R36E S15

NWNE

The permit(s) will be subject to all prior water rights. Protests must be filed with the Director, Dept. of Water Resources, Eastern Region, 150 Shoup Avenue, Suite 15, Idaho Falls, Idaho 83402 on or before SEPTEMBER 24, 1990.

R. KEITH HIGGINSON,
Director

Nº. 1260

9-6-13 T2

MICROFILM

NOV 26 1990

N^o 1245

Application Notice

AFFIDAVIT OF PUBLICATION

RECEIVED

STATE OF IDAHO, }
County of Oneida } ss.

AUG - 6 1990

Department of Water Resources
Eastern District Office

NOTICE OF APPLICATION FOR WATER RIGHT

The Following application(s) have been filed to appropriate the public waters of the State of Idaho:
15-07117

ALDER, JEFF
ALDER, JENNIE
440 S. MAIN
MALAD, ID 83262
Source: GROUNDWATER
Diversion Pt: NENE

Sec 4 T 15S R 36E

Use: IRRIGATION (3.000 CFS)
Total Diversion: (3.000 CFS)

Date Filed: 1/19/1990
In: T15S R36E S04
NENE NWNE SWNE SENE
NESW NWSW

150.0 ACRES TOTAL
15-07122

JONES, CAROL D.
JONES, DEON D.
RT. 1, BOX 133
MALAD CITY, IDAHO 83252
Source: SPRING Tributary: SINKS
Diversion Pt: SESENW
Sec 8 T 14S R 36E S08 NESW
5.0 ACRES TOTAL

The permit(s) will be subject to all prior water rights. Protests must be filed with the Director, Dept. of Water Resources, Eastern Region, 150 Shoup Avenue, Suite 15, Idaho Falls, Idaho 83402 on or before AUGUST 28, 1990.

R. KEITH HIGGINSON,
Director

No. 1245
7-19-26 T2

MICROFILMED

NOV 26 1990

Sandra Strub

being duly sworn, deposes and says: That she is the secretary of THE IDAHO ENTERPRISE, a weekly newspaper published at Malad, in the County of Oneida and State of Idaho; that said paper has been and is in general circulation in the county aforesaid, and in the vicinity of Malad; that the advertisement, a copy of which is attached hereto, was published in said newspaper once a week for 2 consecutive weeks in the regular and entire issue of said paper during the period of time of publication, and was published in the newspaper proper and not a supplement; that said paper has been established and regularly published for more than seventy-eight consecutive weeks prior to the date of first publication of said advertisement.

Such notice was published in the issue beginning with July 19, 1990, and ending with the issue of July 26, 1990
Sandra Strub

Fee \$ 54.46

Subscribed and sworn to before me this 27th day

of July, 1990

Susan J. Wittman
Notary Public, Residing at Malad, Idaho

My Commission Expires Feb. 9, 1994

Nº 1211

AFFIDAVIT OF PUBLICATION

RECEIVED

MAY 10 1990

STATE OF IDAHO, }
County of Oneida } ss.

Department of Water Resources
Eastern District Office

Sandra Struks

being duly sworn,
deposes and says: That she is the secretary of THE IDAHO ENTERPRISE, a weekly newspaper published at Malad, in the County of Oneida and State of Idaho; that said paper has been and is in general circulation in the county aforesaid, and in the vicinity of Malad; that the advertisement, a copy of which is attached hereto, was published in said newspaper once a week for 2 consecutive weeks in the regular and entire issue of said paper during the period of time of publication, and was published in the newspaper proper and not a supplement; that said paper has been established and regularly published for more than seventy-eight consecutive weeks prior to the date of first publication of said advertisement.

Such notice was published in the issue beginning with

April 19, 1990, and ending
with the issue of April 26, 1990

Sandra Struks

Fee \$ 144.23

Subscribed and sworn to before me this 17th day

of May, 1990

Susan J. Wittman

Notary Public, Residing at Malad, Idaho

My Commission Expires February 9, 1994

MICROFILMED

NOV 26 1990

Water Right Notice

NOTICE OF APPLICATION FOR WATER RIGHT

The Following applications(s) have been filed to appropriate the public waters of the State of Idaho:
15-07114

COUCH, GERALD
COUCH, CONSTANCE
405 CHERRY CREEK WOODRUFF RD.
MALAD, ID 83252
Source: GROUNDWATER
Diversion Pt: SENE
Sec 14 T 15S R 36 E
SWNW Sec 15 T 15S R 36E
Use: IRRIGATION(8.600 CFS)
Total Diversion: (8.600 CFS)

Date Filed: 12/21/1989
In: T 15S R36E S14
NENE NWNW SWNE SENE
NESE NWSE SESE
S15 SWNW NWSW SWSW
330.0 ACRES TOTAL
15-07115

MC BRIDE, REED
86 E. 155 S.
MALAD, ID 83252
Source: GROUNDWATER
Diversion Pt: SENE
Sec 3 T 15S R 36E
Use: IRRIGATION(.400 CFS)
STOCKWATER(.020 CFS)
DOMESTIC(.040 CFS)
Total Diversion:(.460 CFS)

Date Filed: 12/13/1989
In: T 15S R36E S03SENE
24.0 ACRES TOTAL
15-07117

ALDER, JEFF
ALDER, JENNIE
440 S. Main
MALAD, ID 83252
Source: GROUNDWATER
Diversion Pt:
NENE Sec 4 T 15S R 36E
Use: IRRIGATION(3.000 CFS)
Total Diversion: (3.000 CFS)

Date Filed: 1/19/1990
In: T 15S R36E S04
NENE NWNW SWNE SENE
NESW NWSW
150.0 ACRES TOTAL
15-07118

ALDER, JEFF
ALDER, JENNIE
440 S. Main
MALAD, ID 83252
Source: TWO MILE CREEK
Tributary: SINKS

Diversion Pt: SWSE
Sec 35 T 14S R 38E
Use: IRRIGATION(3.220 CFS)
Total Diversion: (3.220 CFS)

Date Filed: 1/19/1990
In: T 15S R36E S03
NWNW SENE NENW NWNW
SWNW SENW
161.0 ACRES TOTAL
15-07119

ALDER, JEFF
ALDER, JENNIE
440 S. MAIN

December 1, 1993

JENNIE ALDER
JEFF ALDER
215 CHERRY CREEK RD
MALAD ID 83252

PROOF ACKNOWLEDGMENT LETTER

RE: PERMIT NO. 15-07117

Dear Permit Holder:

The department acknowledges receipt of the proof of beneficial use form submitted for the above referenced permit. The next step in the process of developing a water right is for the department to conduct a field examination to determine and confirm the use being made of the water.

If you have questions concerning this matter, please feel free to contact the EASTERN Regional Office in Idaho Falls at (208)525-7161.

Sincerely,



JULIE L. YARBROUGH
Senior Secretary

c: IDWR - Region

MICROFILMED

JAN 10 1994

ANALYSIS SHEET
FOR
PROOF OF BENEFICIAL USE

Permit No. 15-07117 Reviewed by Klg Date 11/1/93

GENERAL CONSIDERATIONS

TYPES OF USE

yes Name same as permit? irrigate, -150
no Address same as permit?
yes Proof timely received? Correct Uses? yes
If not, complete calculation below.

SOURCE OF WATER

Surface water source
Ground water source
yes Drilling permit required?
yes Copy in the file? Drilling Permit No. 15-92-E-0030-000
200.00 Amount paid for permit yes Correct?
yes Well log in the file?

LICENSE EXAMINATION FEE

MEASURING DEVICE

yes Required?
150 Amount Submitted
yes Correct?
NA Required?
/ Installed?
/ Waiver requested?

PRIORITY CALCULATION

Date proof received NA
Date proof due _____ - _____
No. of days late _____ = _____
Priority Date _____ + _____
New Priority Date _____

DEFICIENCIES OR ACTION ITEMS

Proof is acceptable

DATA ENTRY

New Address 215 Cherry Creek Rd Proof Made 10-29-93



State of Idaho
DEPARTMENT OF WATER RESOURCES

1301 North Orchard Street, Statehouse Mail, Boise, Idaho 83720-9000
 Phone: (208) 327-7900 FAX: (208) 327-7866

Att: Julie

CECIL D. ANDRUS
 GOVERNOR

R. KEITH HIGGINSON
 DIRECTOR

November 1, 1993

Jeff and Jennie Alder
 215 Cherry Creek Rd
 Malad, ID 83252

Re: Permit No. 15-07117

Dear Permit Holder:

In the department's review of the proof of beneficial use submitted in connection with the above referenced permit, the department was not able to locate a drilling permit which should have been applied for before the opening of your well began. We have also been unable to locate a well log which should have been submitted by your well driller 30 days after completion of the construction of your wells. You have indicated on the proof of beneficial use that the well was drilled in 1991.

If you have a drilling permit or a copy of the well log, please provide this office with a copy of each. If you do not have a copy of the well log, please contact your driller and ask that he submit a copy. In your return letter, please be sure to show the above referenced permit number on any documents. Also, please address any correspondence directly to me. Your response, with both forms attached, should be received within 30 days of the date of this mailing.

This information is needed before the department can proceed further with the examination of your system and the eventual issuance of a license of water right.

If you have any questions or if I can be of any further assistance, please feel free to contact me.

Sincerely,

Karen L. Gustafson

Karen L. Gustafson
 Senior Secretary

RECORDED

JAN 10 1994

Form 235-1
7/90

Drilling Permit No. 15-92E-0030-
Water Right Permit No. 15-07117
Injection Permit No. _____

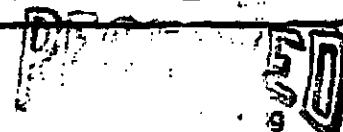

State of Idaho
Department of Water Resources

APPLICATION FOR DRILLING PERMIT

SEP 23 1992
Department of Water Resources
Eastern District Office 5
RE

1. Applicant (please print) Jeff Alder
2. Mailing Address 215 Cherry Creek Road
City & State Malad, Idaho Zip Code 83252 Telephone 208-766-4948
 Well Owner Well Operator Other, specify _____
3. Proposed well location SE 1/4 NE 20 1/4 NE 1/4 NE 1/4 or Gov't Lot No. NE 1/4 NE 1/4
Sec. 4 Twp. T5S Rge. 36E County Oneida
Street Address of Well Site Hayland Road
Lot, block and subdivision _____

4. Proposed use of well:
 Domestic: The use of water for homes, organization camps, public campgrounds, livestock and for any other purpose in connection therewith, including irrigation of up to 1/2 acre of land, if the total use is not in excess of 13,000 gpd; any other uses, if the total use does not exceed a diversion rate of 0.04 cfs and a diversion volume of 2500 gpd.
Domestic does not include water for multiple ownership subdivisions, mobile home parks, commercial, or business establishments, unless the use does not exceed a diversion rate of 0.04 cfs and a diversion volume of 2500 gpd.
 Non-Domestic: Any beneficial use not included within the definition of domestic.
 Injection
 Monitoring - A well bore schematic and map is required for each well.
No. of proposed wells: _____
 Other _____
(Describe) _____

5. Well construction information:
A. New well Deepen Enlarge Replace - See Condition 9
B. Proposed Surface Diameter 16" Proposed Maximum Depth 200' - 250'
C. Anticipated bottom hole temperature:
 85°F or less (Cold water well)
 85°F to 212°F (Low temp. geothermal well)
 212° or more (Geothermal well)

JAN 10 1994

Construction Start Date Oct. 92
Anticipated Well Driller Arnold Lundstrom
NOTE: The actual well driller must be identified prior to drilling.
Applicant's signature Jeff Alder Date Sept. 25, 1992

ACTION OF THE DEPARTMENT OF WATER RESOURCES

This Permit is Approved Date 10-6-92

If approved, this permit authorizes the construction or modification of a well subject to the following conditions. READ CAREFULLY

GENERAL CONDITIONS:

1. The well must be constructed in compliance with the applicable statutes, specific conditions of approval shown on the water right permit, injection well permit, transfer or amendment and the rules and regulations of the Department for water appropriation, injection wells and well construction standards.
2. This drilling permit is valid for two (2) months from the above approval date for the start of construction and is valid for one (1) year from the approval date for completion of the well unless an extension has been granted.
3. This permit does not constitute an approval of the District Health Department or the Idaho Department of Health and Welfare which may be required before construction of this well. All wells must be drilled a minimum distance of 100 feet from a drain field. Domestic and Public Water Supply wells must be drilled a minimum distance of 50 feet and 100 feet respectively from a septic tank.
4. The well shall be constructed by a driller currently licensed in the State of Idaho who must maintain a copy of the drilling permit at the drilling site.
5. Approval of this drilling permit does not authorize trespass on the land of another party.
6. This permit does not constitute other local, county, state or federal approvals which may be required for construction of a well.
7. This drilling permit does not represent a right to divert and use the water of the State of Idaho.
8. If a bottom hole temperature of 85° or greater is encountered, well construction shall cease and the well driller and the well owner shall contact the Department immediately.
9. If this permit is for a replacement well, the well being replaced must be abandoned in accordance with Department Rules and Regulations.

SPECIFIC CONDITIONS:

[Signature] Signature of Authorized Department Representative
[Signature] District Regional Manager
 Title

Receipt No. E01953 Received by [Signature] Fee 200 Date 10-6-92

EXTENSION OF DRILLING PERMIT

Extension approved by _____ Approval Date _____

This extension is good for 30 days beyond the above extension approval date. JAN 10 1994

Form 238-7
11/91

STATE OF IDAHO
DEPARTMENT OF WATER RESOURCES
WELL DRILLER'S REPORT

USE TYPEWRITER OR
BALLPOINT PEN

State law requires that this report be filed with the Director, Department of Water Resources
within 30 days after the completion or abandonment of the well.

1. WELL OWNER
Name Jeff Alder
Address 4405 N. Main, Pocatello, Idaho
Drilling Permit No. 15-92 E0030
Water Right Permit No. 15-07-1107

7. WATER LEVEL
Static water level _____ feet below land surface.
Flowing? Yes No G.P.M. flow _____
Artesian closed-in pressure _____ p.s.i.
Controlled by: Valve Cap Plug
Temperature _____ °F. Quality _____
Describe artesian or temperature zones below.

2. NATURE OF WORK
 New well Deepened Replacement
 Well diameter increase Modification
 Abandoned (describe abandonment or modification procedures such as liners, screen, materials, plug depths, etc. in lithologic log, section 9.)

8. WELL TEST DATA
 Pump Bailor Air Other _____
Discharge G.P.M. _____ Pumping Level _____ Hours Pumped _____
WIRE

3. PROPOSED USE
 Domestic Irrigation Monitor
 Industrial Stock Waste Disposal or Injection
 Other _____ (specify type)

9. LITHOLOGIC LOG

Bore Diam.	Depth		Material	Water	
	From	To		Yes	No
20	0	20	CLAY		
16	20	31	CLAY		
	31	60	Green clay		
	60	79	White clay		
	79	90	Blue clay + rocks		
	90	133	Brown clay with some rocks		
	133	160	Blue clay - some gravel		
	160	205	tan clay + pink rocks		
	205	217	tan gravel + brown clay		
	217	230	gray sandstone		
	230	240	tan fine rocks		

4. METHOD DRILLED
 Rotary Air Auger Reverse rotary
 Cable Mud Other _____ (backhoe, hydraulic, etc.)

5. WELL CONSTRUCTION
Casing schedule: Steel Concrete Other _____
Thickness _____ Diameter _____ From _____ To _____
20 inches 16 inches + 1 feet 233 feet
Was casing drive shoe used? Yes No
Was a packer or seal used? Yes No
Perforated? Yes No
How perforated? Factory Knife Torch Gun
Size of perforation? 1/2 inches by _____ inches
40 perforations 84 feet 90 feet
135 perforations 135 feet 160 feet
135 perforations 205 feet 230 feet
Well screen installed? Yes No
Manufacturer _____ Type _____
Top Packer or Headpipe _____
Bottom of Tailpipe _____
Diameter _____ Slot size _____ Set from _____ feet to _____ feet
Gravel packed? Yes No Size of gravel _____
Placed from _____ feet to _____ feet
Surface seal depth 20 Material used in seal: Cement grout
 Bentonite Pudding clay _____
Sealing procedure used: Slurry pit
 Temp. surface casing Overbore to seal depth
Method of joining casing: Threaded Welded
 Solvent Weld Cemented between strata
Describe access port _____

10.
Work started Oct 29 finished Dec 29

6. LOCATION OF WELL
Sketch map location must agree with written location.
Subdivision Name _____
Lot No. _____ Block No. _____
County _____
N E
S R W

11. DRILLER'S CERTIFICATION
I/We certify that all minimum well construction standards were complied with at the time the rig was removed.
Firm Name Landstream Firm No. 118
Address Pocatello Date 12-29-93
Signed by Drilling Supervisor David Landstream
and _____
(Operator) _____
(If different than the Drilling Supervisor)

JAN 10 1994



State of Idaho
DEPARTMENT OF WATER RESOURCES

1301 North Orchard Street, Statehouse Mail, Boise, Idaho 83720-9000
Phone: (208) 327-7900 FAX: (208) 327-7866

CECIL D. ANDRUS
GOVERNOR

R. KEITH HIGGINSON
DIRECTOR

November 1, 1993

Jeff and Jennie Alder
215 Cherry Creek Rd
Malad, ID 83252

Re: Permit No. 15-07117

Dear Permit Holder:

In the department's review of the proof of beneficial use submitted in connection with the above referenced permit, the department was not able to locate a drilling permit which should have been applied for before the opening of your well began. We have also been unable to locate a well log which should have been submitted by your well driller 30 days after completion of the construction of your wells. You have indicated on the proof of beneficial use that the well was drilled in 1991.

If you have a drilling permit or a copy of the well log, please provide this office with a copy of each. If you do not have a copy of the well log, please contact your driller and ask that he submit a copy. In your return letter, please be sure to show the above referenced permit number on any documents. Also, please address any correspondence directly to me. Your response, with both forms attached, should be received within 30 days of the date of this mailing.

This information is needed before the department can proceed further with the examination of your system and the eventual issuance of a license of water right.

If you have any questions or if I can be of any further assistance, please feel free to contact me.

Sincerely,

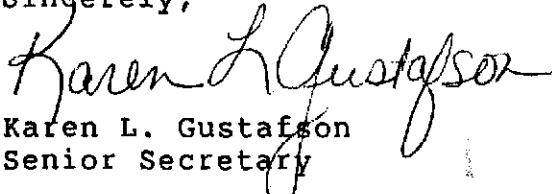
Karen L. Gustafson
Senior Secretary

JAN 10 1994



State of Idaho
DEPARTMENT OF WATER RESOURCES

1301 North Orchard Street, Statehouse Mail, Boise, Idaho 83720-9000
Phone: (208) 327-7900 FAX: (208) 327-7866

CECIL D. ANDRUS
GOVERNOR

R. KEITH HIGGINSON
DIRECTOR

August 31, 1993

Jeff and Jennie Alder
440 S Main
Malad, ID 83252

PROOF DUE NOTICE

RE: Permit No. 15-07117

Dear Permit Holder:

One of the conditions of approval of the above referenced water permit was that proof of the extent of your beneficial use must be submitted to this office on or before November 1, 1993. (See last page of your approved permit or your last approved extension request.) Enclosed is a form which when accompanied by the license examination fee or a complete field examination report prepared by a certified water right examiner may be used to submit the required proof.

If you have not fully completed your project, and you or a previous owner of this permit have not received a prior extension of time, you may request an extension of time if the delay is for reasonable cause as provided in Section 42-204, Idaho Code. If you have been prevented from proceeding by a governmental agency or by litigation which might bring title to the water in question, more than one extension of time can be granted. An extension of time request form is enclosed for your convenience.

Either an acceptable proof of beneficial use submittal or an acceptable request for an extension of time must be received by this department on or before the above described proof due date. If neither is received, the department will send you a lapse notice. Within sixty days of the mailing of the lapse notice, the permit will no longer be of any force nor effect.

Sincerely,

Karen L. Gustafson
Secretary/Records Manager

Enclosures

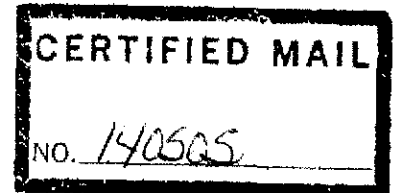

SEP 1 1993

SEP 10 1993



State of Idaho
DEPARTMENT OF WATER RESOURCES

1301 North Orchard Street, Statehouse Mail, Boise, Idaho 83720-9000
Phone: (208) 327-7900 FAX: (208) 327-7866

CECIL D. ANDRUS
GOVERNOR

R. KEITH HIGGINSON
DIRECTOR

November 3, 1992

Jennie and Jeff Alder
440 South Main
Malad, ID 83252

Re: Permit No. 15-07117

Dear Permit Holder:

Enclosed is a copy of the approved request for extension of time. The time within which to submit proof of beneficial use is extended to June 1, 1993. Please note that the department has granted this extension based on due diligence. It is important that you work diligently toward the completion of this project during the construction period allowed. The department may not be able to grant additional requests.

If you have any questions or if I can be of any further assistance, please feel free to contact this office.

Sincerely,

A handwritten signature in cursive script that reads "Karen L. Gustafson".

Karen L. Gustafson
Secretary/Records Manager

Enclosure

C: IDWR-Regional Office

MICROFILMED

NOV 12 1992

ANALYSIS SHEET
FOR
EXTENSION OF TIME

Permit No. 15-07117 Reviewed by Klg Date 11/2/92

BASIC INFORMATION

10/26/92 Date stamp received
yes Extension received timely
yes Fee received and receipted
yes Name and signature same as permit
yes Address Change

BASIS FOR EXTENSION REQUEST

yes Has adequate work been completed to demonstrate due diligence?
Has the permit been involved in litigation?
Is supporting documentation needed to complete the file? Requested?
Is delay by a government agency?
Is supporting documentation needed to complete the file? Requested?
Is the project more than 25,000 acre feet for irrigation or 10,000 acre feet for a reservoir?

ACTION TAKEN

*Recommend approval Based on due diligence
Extend to 6/1/93*

PRIORITY CALCULATION

Date extension received	<u>NA</u>	=	_____
Proof due date	/	=	_____
Number of days late	/	=	_____
Priority date	/	=	_____
New Priority Date	/	=	_____

DATA ENTRY

New Address 215 Cherry Creek Rd
Change Proof Due Date _____
Change Priority Date _____

August 31, 1992

JENNIE ALDER
JEFF ALDER
440 S. MAIN
MALAD ID 83252

PROOF DUE NOTICE

RE: PERMIT NO. 15-07117

Dear Permit Holder:

One of the conditions of approval of the above referenced water permit was that proof of the extent of your beneficial use must be submitted to this office on or before November 1, 1992. (See last page of your approved permit or your last approved extension request.) Enclosed is a form which when accompanied by the license examination fee or a complete field examination report prepared by a certified water right examiner may be used to submit the required proof.

If you have not fully completed your project, and you or a previous owner of this permit have not received a prior extension of time, you may request an extension of time if the delay is for reasonable cause as provided in Section 42-204, Idaho Code. If you have been prevented from proceeding by a governmental agency or by litigation which might bring title to the water in question, more than one extension of time can be granted. An extension of time request form is enclosed for your convenience.

Either an acceptable proof of beneficial use submittal or an acceptable request for an extension of time must be received by this department on or before the above described proof due date. If neither is received, the department will send you a lapse notice. Within sixty (60) days of the mailing of the lapse notice, the permit will no longer be of any force nor effect.

SINCERELY,

Karen L. Gustafson
Secretary/Records Manager

Enclosures



RECEIVED
NOV 12 1992



State of Idaho
DEPARTMENT OF WATER RESOURCES

1301 North Orchard Street, Statehouse Mail, Boise, Idaho 83720 - (208) 327-7900

CECIL D. ANDRUS

GOVERNOR

R. KEITH HIGGINSON

DIRECTOR

November 7⁷ 26, 1990

JENNIE ALDER
JEFF ALDER
440 S. MAIN
MALAD, ID 83252

PERMIT APPROVAL NOTICE

RE: PERMIT NO. 15-07117

Dear Permit Holder:

Enclosed is a copy of your approved application for permit. We direct your attention to the conditions of approval on the final page.

As a permit owner you must commence the excavation or construction of the diverting works within one year of the date the permit was issued, and you must proceed diligently until the project is completed. The date shown under condition no. 1 is the date when the project must be completed. You will receive a "Proof Due Notice" from this Department approximately 60 days prior to the completion date requiring you to file either a Proof of Beneficial Use form stating that the project has been completed or file a Request for an Extension of Time in which to file the proof statement.

Section 42-235, Idaho Code, requires that a "drilling permit" must be obtained from the department for all wells constructed after July 1, 1987. A drilling permit is a separate permit that must be issued in addition to your permit to appropriate water. Commencement of well construction or diversion of water under your permit to appropriate water is prohibited unless a drilling permit is obtained.

MICROFILMED

DEC 07 1990

Be sure to note the special condition requiring you to install a measuring device. Enclosed, for your reference, is a list of measuring device options.

Sincerely,

JIM JOHNSON
Water Rights Supervisor

JJ:blm

Enclosures

MICROFILMED

DEC 07 1990

APPLICATION FOR PERMIT REVIEW

J.J.
 P FILE
 MADE
 DATA ENTRY
 Completed
 Jim

Date: 10-21-90 Reviewer: Jim Johnson

Existing:

- No - 026A-P17
- Complete in 1 year - P16
- Yes - P16

Source:

- Groundwater - 01G-P03 (Greater than 0.7 cfs)

Drilling Permit:

- Approved - 046-P99
- Not included - 046-P23

Location:

- ~~Water Districts~~
- surface water - 005-P01, 01H-P01, P04
- ~~groundwater~~ - ~~005-P05~~, 01H-P01, 01J-P08
- Irrigation Districts - 023
- Canal Co. Areas - 023
- Drainage Districts - 024
- Boise Front (63) - 58 (Groundwater)
- Trust (see list) - 032, 041, 051, 052, 053
- Non Trust (see list) - 048, 049

River Basins:

- Boise (63) - 11D-P72
- Payette (65) - 047, 059-P71
- Snake (01) - 11A, 061-P22

Use:

- Fish Propagation - (P06) 002, 06A, 007, 09E-P10, 010, 042, 044
- Power - (less than 25cfs P18), 01F-P19, 008, 08A, 09E-P10, 017K, 017G, 017M, 025
- Mining - 06A, 006, 09E-P10, 010, 54
- Storage - 18A-P09, 18B-P09
- Domestic - (restricted areas) 021

Ownership:

- Non land owner - 004

Protested:

- Agreement - 020, 20A

Mimumum Stream Flow:

- Overlapping uses - 029-P20

Beneficial Use Due Date: - 11-1-1992

Swan Falls Flag: - Blank

MEMORANDUM

TO: EASTERN REGION

FROM: KAY WALKER *Kay*

RE: APPLICATION FOR PERMIT NO. 15-7117

DATE: 26-JUN-1990

=====
There is an error on the place of use description. The map shows the p/u in the NE1/4 and N1/2SE1/4. The legal description describes use in the SW1/4. Please correct and re-advertise this one. Thanks!! Kay

Rita, re-ad at our expense

Danc-HWT 10-12-90

RECEIVED

JUN 26 1990

Department of Water Resources
Eastern District Office

MICROFILMED

DEC 07 1990

STATE OF IDAHO
DEPARTMENT OF WATER RESOURCES

APPLICATION FOR PERMIT ANALYSIS SHEET

INITIAL REVIEW BY KC Wilson DATE 2-9-1990 APPLICATION NUMBER 15-7117

REQUIRED INFORMATION

- Name (If applicant is a corporation or partnership, names must be provided for the director, officers, & other partners.)
- Address
- Source (See USGS Quad for names of water sources)
- Point of Diversion (10 acres for spring, lot & block descriptions for subdivisions, local name, flow and/or volume)
- County
- Quantity (flow and/or volume)
- Period of Use
- Nature of proposed use (Include description of use.)
- Description of diverting works
- Time required for beneficial use of water
- Place of use or acres irrigated
- Map
- Signature (If applicant is corp. partnership, or municipality, title of signator is required)
- Fee
- Yes ___ No* In form to receipt

ADDITIONAL INFORMATION

- ___ Overlapping place of use (Describe source & relationship to present application on the back.)
- ___ Overlapping point of diversion
- ___ Yes ___ No Field check required
- ___ Yes ___ No Field check by _____
- ___ Yes ___ No Field report attached
- ___ Yes ___ No Critical groundwater area
- ___ Yes ___ No Groundwater management area
- ___ Yes ___ No Send dam safety information
- ___ Yes ___ No Send power requirement letter
- ___ Yes ___ No Send fish farm requirement letter
- ___ Yes ___ No Power residency affidavit
- ___ Yes ___ No Power efficiency form
- ___ Yes ___ No Within trustwater boundary (If yes, attach trust water supplementary analysis sheet.)
- ___ Yes ___ No Diversion greater than 5 cfs or 500 acre ft. (If yes, attach large diversion supplementary analysis sheet.)
- ___ See reverse side for additional information

RECEIVED
OCT 16 1990

Department of Water Resources

*REQUEST THE FOLLOWING ADDITIONAL INFORMATION FROM THE APPLICANT

_____ Date Requested _____

RECEIVED
JUN 25 1990

Department of Water Resources

PROCESSING Yes No In form for advertising
 Yes No Statewide advertising
 Yes No Fee amount, receipt date & No. recorded on application

SEND COPIES TO Idaho Dept. of Health & Welfare U.S. BLM
 Idaho Dept. of Fish & Game U.S. Forest Service
 Idaho Dept. of Lands Water District
 Adjudication Bureau Unit Other _____

FINAL REGIONAL PROCESSING REVIEW

Yes No Affidavit of publication received
 Yes No Application published correctly. If not, record action taken.

 Yes No Publication dates & paper, recorded on application
 Yes No Protests received
Final date for protest 5-7-90 8-8-90 9-24-90
 Yes No Protests, dates, resolution of protest, recorded on application
 Yes No Recommendations attached
 Yes No Measuring device required
 Yes No Access port required
 Yes No Will water be delivered by watermaster? If yes, what Dist. _____
 Yes No Special conditions of approval or cover letter below. _____

See below for additional information
Date of priority recommended T-19-90
By HWT Date 6-20-90

STATE OFFICE REVIEW P23 P17 46 26
See below for additional information
By _____ Date _____

ADDITIONAL INFORMATION

Condition; <0167
OK to allow 2 yrs. to develop

STATE OF IDAHO
DEPARTMENT OF WATER RESOURCES
Eastern Region
150 Shoup Ave., Suite 15

Idaho Falls, Idaho 83402
(208) 525-7161

AUGUST 21, 1990

THE IDAHO ENTERPRISE
P.O. BOX 205
MALAD CITY, ID 83252

Gentlemen:

Enclosed you will find a legal notice which we wish to have published on the dates indicated (once a week for two consecutive weekly issues) in your newspaper. If you cannot publish the notice on the proposed dates, please contact us immediately.

An affidavit of publication must be submitted to the Department along with the publication bill. Your cooperation is appreciated.

Please send the affidavit of publication and publication billing to this office before SEPTEMBER 24, 1990.

Yours truly,

Rita Bodell
Secretary

Encl.

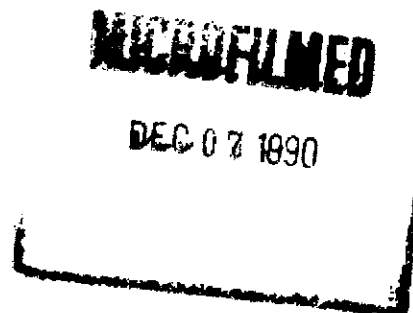

NOTICE OF APPLICATION FOR WATER RIGHT

The Following application(s) have been filed to appropriate the public waters of the State of Idaho:

MICROFILMED
DEC 07 1990

19-Apr-1990

Jennie or Jeff Alder
440 S. Main
Malad, ID 83252

RE: Application for Permit No. 15-7117, 15-7118, 15-7119,
15-7120, & 15-7121

Dear Water Right Applicant:

The Department of Water Resources acknowledges receipt of your water right permit. This office is currently in the process of advertising the application in the Idaho Enterprise on April 19 & 26, 1990. The advertisement will be published for two consecutive weeks, and a period of ten days following the second publication will be allowed for the submittal of protests.

If the application is protested, you will be sent a copy of the protest. The protest must be resolved before the application is approved or denied. If the protest is not resolved voluntarily, this Department will conduct a conference and/or hearing on the matter.

If the application is not protested, it will be forwarded to our state office in about five weeks. State office personnel will conduct a complete review prior to final processing of the application and will notify you of the outcome of this review. When a permit is issued, you will be sent a copy. A typical processing time for an unprotested application is about eight weeks.

Please feel free to contact this office if you have any questions regarding this procedure.

Sincerely,

MICROFILMED

HAROLD W. JONES
Water Rights Supervisor

DEC 07 1990

S T A T E O F I D A H O
DEPARTMENT OF WATER RESOURCES
Eastern Region
150 Shoup Ave., Suite 15

Idaho Falls, Idaho 83402
(208) 525-7161

JULY 11, 1990

THE IDAHO ENTERPRISE
P.O. BOX 205
MALAD CITY, ID 83252

Gentlemen:

Enclosed you will find a legal notice which we wish to have published on the dates indicated (once a week for two consecutive weekly issues) in your newspaper. If you cannot publish the notice on the proposed dates, please contact us immediately.

An affidavit of publication must be submitted to the Department along with the publication bill. Your cooperation is appreciated.

Please send the affidavit of publication and publication billing to this office before AUGUST 26, 1990.

Yours truly,

Rita Bodell
Secretary

Encl.

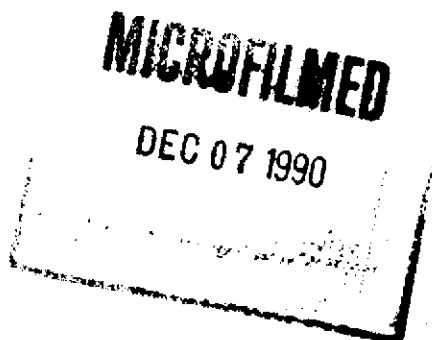

NOTICE OF APPLICATION FOR WATER RIGHT

The Following application(s) have been filed to appropriate the public waters of the State of Idaho:

MICROFILMED

DEC 07 1990

The permit(s) will be subject to all prior water rights. Protests must be filed with the Director, Dept. of Water Resources, Eastern Region, 150 Shoup Avenue, Suite 15, Idaho Falls, Idaho 83402 on or before AUGUST 26, 1990.

R. KEITH HIGGINSON, Director

Published 7/19/1990 & 7/26/1990

RECEIVED

DEC 9 7 1990

I have been unable to
locate a drilling permit
or well log for this
permit. P/D and/or
driller will have to
submit before we can
accept proof.