

STATE OF IDAHO
DEPARTMENT OF WATER RESOURCES

WATER SUPPLY BANK RENTAL AGREEMENT NO. 172

This is to certify that:

THE RALPH R & BETH POCOCK FAMILY LTD PARTNERSHIP
2964 N 5000 E
SUGAR CITY, ID 83448

RECEIVED
JUN 16 2017
DEPARTMENT OF
WATER RESOURCES

filed an application to rent water from the Water Supply Bank ("Bank"). The Idaho Water Resource Board ("Board"), being authorized to operate a Bank and to contract by and through the Director of the Idaho Department of Water Resources ("Director, Department") for rental of water from the Bank, agrees to rent water as follows:

Summary of Water Rights or Portions Rented from the Bank

Water Right No.	Priority Date	Source	Diversion Rate (CFS)	Diversion Volume (AF)	Acres (AC)	Rate Per Acre (CFS/AC)	Volume Per Acre (AF/AC)
22-13440	10/26/1965	GROUND WATER	0.45	107.5	30.7	0.015	3.50
35-7777	1/24/1978	GROUND WATER	0.14	32.8	8.2	0.017	4.00
35-13855	2/14/1961	GROUND WATER	0.06	20.0	5.0	0.012	4.00
35-2924	7/21/1965	GROUND WATER	0.02	4.5	NA	NA	NA
31-7128	7/30/1974	GROUND WATER	0.20	64.1	NA	NA	NA
Rental Totals			0.87	228.9	43.9	NA	NA

Term of Rental: This rental shall take effect when all parties have signed it and shall continue in effect until December 31, 2017

Annual Rental Fee:

2017: \$3,891.30

The full fee for the rental of the above-described right(s) is \$3,891.30 for 2017. The rental fee includes an administrative fee of \$389.13 for 2017.

Total Water Use Authorized Under Rental Agreement No.172

Beneficial Use	Diversion Rate (CFS)	Diversion Volume (AF)	Acres (AC)	Rate/Acre (CFS/AC)	Volume/Acre (AF/AC)
IRRIGATION	0.87	228.9	57.0	0.015	3.5
Total	0.87	228.9	57.0	0.015	3.5

** The authorized water usage reflects a reduction from the water right elements rented, to account for changes in nature of use.*

Detailed water right conditions are attached.

SUPPORT DATA

IN FILE # 22-13440

STATE OF IDAHO
DEPARTMENT OF WATER RESOURCES
WATER SUPPLY BANK RENTAL AGREEMENT NO. 172

The undersigned renter agrees to use the water rented under this agreement in accordance with the Water Supply Bank rules and in compliance with the limitations and conditions of use described in this agreement:



Signature of Renter

6-12-2017

Date

Ray R Poock

Printed Name

President

Title

*Title required if signing on behalf of a company or organization or with power of attorney

Having determined that this agreement satisfied the provisions of Idaho Code § 42-1763 and IDAPA 37.02.03.030 (Water Supply Bank Rule 30), for the rental and use of water under the terms and condition herein provided, and none other, I hereby execute this Rental Agreement on behalf of the Idaho Water Resource Board.

By 

BRIAN PATTON, Acting Administrator
Idaho Water Resource Board

Date 6/16/2017

Rental approved by IDWR As Water

Date 6-16-2017

WATER SUPPLY BANK RENTAL AGREEMENT No. 172

WATER USE DETAILS

LOCATION OF POINT(S) OF DIVERSION

GROUND WATER	NESW	Sec. 24, Twp 06N, Rge 41E,	MADISON County
GROUND WATER	SESW	Sec. 24, Twp 06N, Rge 41E,	MADISON County

Beneficial Use	Diversion Rate	Volume
IRRIGATION	0.87 CFS	228.9 AF

BENEFICIAL USE & SEASON OF USE

Water Right No.	From	To
35-7777	4/1	10/31
22-13440	4/1	10/31
35-2924	4/1	10/31
35-13855	4/1	10/31
31-7128	4/1	10/31

RENTERS PLACE OF USE: IRRIGATION

Twp	Rng	Sec	NE				NW				SW				SE				Totals
			NE	NW	SW	SE	NE	NW	SW	SE	NE	NW	SW	SE	NE	NW	SW	SE	
06N	41E	24	5.2	4.5	4.1	5.0	4.0	3.0	3.5	4.6	3.3	3.4	2.6	2.6	3.4	2.8	2.3	2.7	57.0

Total Acres: 57.0

RENTAL AGREEMENT CONDITIONS OF ACCEPTANCE

1. The use of water under this agreement shall be subject to the provisions of Idaho Code § 42-1766.
2. Rental of the specified right from the bank does not, in itself, confirm the validity of the right or any elements of the water right, or improve the status of the right including the notion of resumption of use. It does not preclude the opportunity for review of the validity of this water right in any other department application process.
3. Use of water under this agreement shall not prejudice any action of the Department in its consideration of an application for transfer or permit filed by the applicant for this same use.
4. Renter agrees to comply with all applicable state and federal laws while using water under this agreement.
5. Renter agrees to hold the Board, the Director and the state of Idaho harmless from all liability on account of negligent acts of the renter while using water.
6. Renter acknowledges and agrees that the Director may terminate authorization for the use of a water right based on a water right's priority date.
7. Failure of the renter to comply with the conditions of this agreement is cause for the Director to rescind approval of the rental agreement.
8. This rental agreement does not authorize the construction of a well.
9. Prior to diversion and use of water under this approval, the right holder shall install and maintain acceptable measuring device(s) at the authorized point(s) of diversion, in accordance with Department specifications.

10. Upon specific notification of the Department, the right holder shall install and maintain data loggers to record water usage information at the authorized point(s) of diversion in accordance with Department specifications.
11. A lockable device subject to the approval of the Department shall be maintained on the diverting works in a manner that will provide the watermaster suitable control of the diversion.
12. Use of water under this right will be regulated by a watermaster with responsibility for the distribution of water among appropriators within a water district. At the time of this approval, this water right is within State Water District No. 100.
13. A map depicting the place of use boundary for this water right at the time of this approval is attached to this document for illustrative purposes.
14. The following rights are diverted through the points of diversion described above: 22-7167A, 22-7052A, 22-2271D, 22-7439 22-14082, 22-14083 and 22-14084.
15. .This right when combined with all other rights shall provide no more than 0.02 cfs per acre nor more than 3.5 afa per acre at the field headgate for irrigation of the lands above.



Idaho Water Resource Board

Attachment to Water Supply Bank Rental Agreement No. 172

Effective until December 31, 2017

This map depicts the rental place of use pursuant to the rental agreement and is attached to the agreement solely for illustrative purposes.

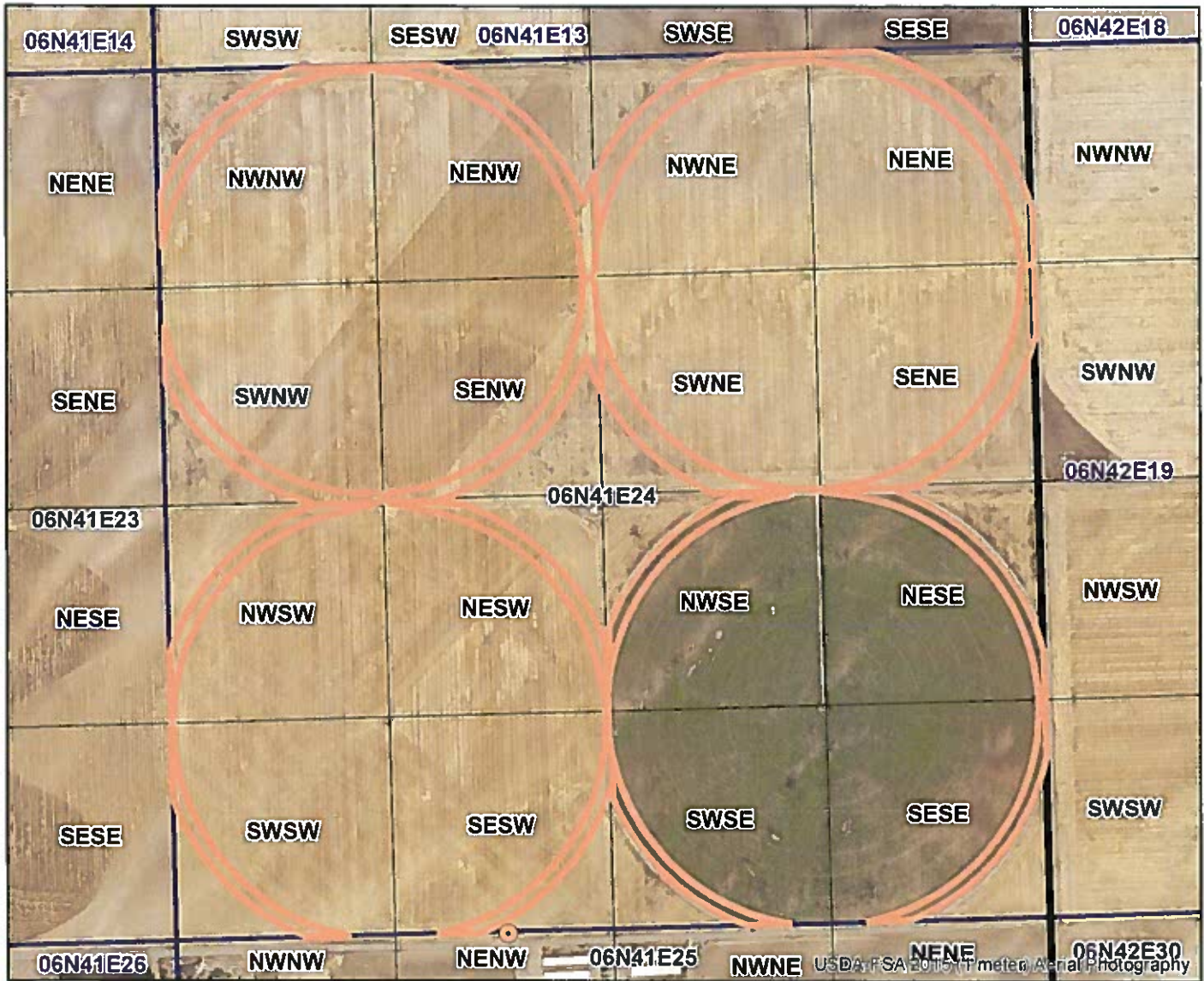

-  Authorized Rental Point of Diversion
-  Authorized Rental Place of Use
-  Townships
-  PLS Sections
-  Quarter Quarters



STATE OF IDAHO
WATER RESOURCE BOARD

RECEIVED

MAR 23 2017

DEPARTMENT OF
WATER RESOURCES

APPLICATION TO RENT WATER
FROM THE BOARD'S WATER SUPPLY BANK

Applicant Name: The Ralph R. and Beth Pocock Family Limited Partnership

Is this application being submitted with a lease application as a lease/rental package? Yes No
If yes, specify companion water rights in Section 4

This application must be completed according to the minimum requirement checklist below. This checklist is part of the rental application and must be included with the rental application. Applications that do not meet the minimum requirements will not be placed in the processing queue and may be returned until all minimum requirements have been met.

Rental applications should be submitted well in advance of the desired start date for the use of rental water. Rental applications may be processed as early as November 1 of the year prior to the intended use of rental water. Any rental application received on or before November 1 for use in the next year will be assigned a received date of November 1. Rental applications submitted more than one year in advance of the proposed start date for the use of rental water will not be accepted and will be returned to applicants. Rental applications may be returned to applicants if the desired start date for the use of rental water cannot be accommodated by the Water Supply Bank. Rental requests will not be accepted once the rental season of use period has concluded.

One rental application per beneficial use of water. For multiple beneficial uses of water, separate rental requests should be submitted for each unique beneficial use of water. One rental application can be submitted if you propose to rent water from multiple sources.

For additional instructions on completing a rental application, visit the Bank's website at http://idwr.idaho.gov/water_supply_bank.

MINIMUM REQUIREMENT CHECKLIST		
Check All Items as Either Attached (Yes) or Not Applicable (N/A)		
	Yes	
	<input checked="" type="checkbox"/>	Completed <i>Application to Rent Water from the Board's Water Supply Bank</i>
	<input checked="" type="checkbox"/>	Confirmation that this form has been printed single sided, per requirement of the Water Supply Bank
Attachment	N/A	Yes
2	<input checked="" type="checkbox"/>	A map showing the proposed point(s) of diversion, place(s) of use, and water diversion and distribution systems proposed to be used with your rental request
3A	<input type="checkbox"/>	<input type="checkbox"/> Detailed information on a proposed use of rental water
3F	<input type="checkbox"/>	<input type="checkbox"/> Authorization from the owner/operator of the rental point(s) of diversion
3H	<input type="checkbox"/>	<input checked="" type="checkbox"/> Water modeling to account for the impacts of the rental request
3J	<input type="checkbox"/>	<input type="checkbox"/> Documents justifying a rate of flow greater than 0.02 cfs/acre
3K	<input type="checkbox"/>	<input type="checkbox"/> Authorization from the owner/operator of the property at the proposed rental place(s) of use
4B	<input type="checkbox"/>	<input type="checkbox"/> Explanation of how the rental water will sufficiently accomplish your rental purposes
4C	<input type="checkbox"/>	<input type="checkbox"/> Explanation of consumptive use amounts for water rights experiencing a change in nature of use

Department Use Only – Proposed Water Right(s)
22-4046

815

STATE OF IDAHO
WATER RESOURCE BOARD

Application to Rent Water (Continued)

1. CONTACT INFORMATION

A. Applicant The Ralph R. and Beth Pocock Family Limited Partnership

Mailing Address 2964 N 5000 E Sugar City ID 83448
Street City State Zip Code

Email Address _____ Phone Number _____

B. Is this application being completed by an authorized representative on behalf of the applicant? Yes No
 If yes, representatives (includes company employees if the applicant is a corporation, as well as legal counsel or consultants) should provide their information below if they desire to be included on correspondence with the rental applicant.

Representative Kristin Moore Professional Title Sen. Water Right Analyst
 Organization Rocky Mtn Environmental Assoc. Relationship to Applicant Consultant

Mailing Address 482 Constitution Way Ste 303, Idaho Falls, ID 83402
 Email Address kristin.rmea@gmail.com Phone Number 208-524-2353

2. MAP

Create a map of the proposed point(s) of diversion, place(s) of use and water diversion, delivery and distribution systems. Make sure the rental place of use is outlined and annotated with legal land descriptions (Township, Range, Section and Quarter-Quarters) or with GPS coordinates. For irrigation purposes, mark the number of acres you desire to irrigate. Attach the map to this application and label it Attachment 2.

3. DESCRIPTION OF PROPOSED USE FOR RENTAL WATER

A. Describe why you desire to rent water and provide a detailed description of your proposed use. If the proposed use is not for irrigation, describe in detail how you determined the amount of rental water required. If the space below is insufficient, attach additional sheets as required and label them Attachment 3A:
This is for the irrigation of end guns on four center pivots in 06N 41E 24. The pivots are covered under existing water rights which do not cover the end guns. The water will be diverted from the same Points of Diversion as the existing water rights.

B. Enter the desired and/or minimum rates of flow, volume, or irrigable acres requested for your rental purposes:

Desired Rate (Cubic Feet/Second)	Desired Volume (Acre-Foot)	Minimum Rate* (Cubic Feet/Second)	Minimum Volume* (Acre-Foot)	Desired Acres (if applicable)
1.14 CFS	199.5 AF	1.14 CFS	199.5 AF	57 AC

* Sometimes water rights provide an exceptionally low rate per acre and/or low volume per acre. This section is meant to establish an acceptable range of water sufficient for your proposed water use. Please see question 4B and complete if necessary.

C. This section must be completed in full. Enter the proposed start date and latest possible start date for using rental water as well as the number of years you would like to rent water. The latest possible start is the latest possible date by which you would be willing to pay for a rental and be able to benefit from utilizing rental water.

Desired Start Date (month/day/year)	Latest Possible Start Date (month/day/year)	*Mark Desired Rental Duration (Calendar Years)					**Applicant's preference if rental application cannot be processed prior to the latest possible start?	
4/20/2017	6/1/2017	<input checked="" type="checkbox"/> 1	<input type="checkbox"/> 2	<input type="checkbox"/> 3	<input type="checkbox"/> 4	<input type="checkbox"/> 5	<input checked="" type="checkbox"/> Process application as soon as possible	<input type="checkbox"/> Return application to applicant

* The number of years permissible for a rental is subject to the lease contract duration for the water right(s) being rented.
 ** Per Idaho Code 42-201, it is unlawful to divert or use water without a valid water right. Water Supply Bank rental applicants are not authorized to utilize rental water prior to the execution of an approved rental agreement. Rental requests may be returned to applicants if no water is available from the Bank to fulfill a rental request.

STATE OF IDAHO
WATER RESOURCE BOARD

Application to Rent Water (Continued)

D. Describe your water distribution system and how rental water will be delivered from the point(s) of diversion (POD) to the proposed place of use (POU):
Wells with pumps deliver water to mainlines, which convey water to center pivots. If the rental is approved, end gun valves and booster pumps will be turned on to irrigate the proposed POU.

E. Describe the physical type (pump, headgate, etc.) and location of the POD from which rental water is proposed to be diverted:

POD Description	Water Source	Other Water Rights Diverted from this POD
Two Wells		Both Wells Share with the Following WR:
T6N R41E SEC 24 NESW	Ground Water	22-7167A, 22-7052A, 22-2271D, 22-7439
T6N R41E SEC 24 SESW	Ground Water	22-14082, 22-14083, 22-14084

If the POD(s) above are located where water is turned into a canal, lateral or ditch, or if they are located on your property but are serviced by water that is delivered via a canal, lateral or ditch, your rental request must include documented authorization from all relevant canal companies, irrigation districts and/or water delivery entities, confirming that they consent to your diversion of water from their system.

F. Has documented consent from all relevant water delivery entities been obtained? Yes N/A
 If yes, include documented consent as Attachment 3F.

G. Do any POD(s) identified in Question 3E divert from a water source that may require water modeling? Yes No
Refer to the Water Modeling Requirements Information Sheet to determine if a rental POD may require water modeling.

H. Has water modeling been provided with your rental request? Yes N/A
 If yes, label modeling Attachment 3H.
Rental applications that require modeling will be returned if modeling is not provided.

I. Specify the desired beneficial use of water and the requested season of use or number of acres required:

- Irrigation 57 (number of acres) Duration: Subject to IDWR standard seasons of use
- Commercial from: _____ (mm/dd) to: _____ (mm/dd)
- Stockwater from: _____ (mm/dd) to: _____ (mm/dd)
- Industrial from: _____ (mm/dd) to: _____ (mm/dd)
- Other: _____ from: _____ (mm/dd) to: _____ (mm/dd)

J. For irrigation uses, do you propose to divert water at a rate greater than 0.02 cfs/acre? N/A Yes No
 If yes, justify the rate of flow and attach any supporting documents as Attachment 3J. Justification may include information on soil composition, conveyance losses, crop type, irrigation systems, public access areas, etc. A rate of 0.03 cfs/acre is permissible for irrigation of 5 acres or less.

K. Do you own the land at the proposed rental place of use (POU)? Yes No
 If no, attach documentation from the POU owner/operator confirming your authorization to use the POU and label it Attachment 3K.

L. List all other water rights and sources of water at the rental place of use for the same purpose, including privately owned water rights and water received from a municipal supplier, an irrigation district, a canal company or any other water delivery entity. Explain why additional water is required:
Other Ground Water Rights that cover the center pivots, but not the end guns: 22-7167A, 22-7052A, 22-2271D, 22-7439, 22-14082, 22-14083, 22-14084

STATE OF IDAHO
WATER RESOURCE BOARD

Application to Rent Water (Continued)

4. RENTAL REQUESTS FOR SPECIFIC WATER RIGHTS

A. Are you requesting to rent specific water rights? Yes No
 If yes, specify below the elements of the water rights you are requesting to rent. If no, continue to Question 4B.

Important Information: Diversion rates and volumes sought for rent must be proportionate to the per acre diversion rates and per acre volume limits of the water right under lease contract to the Water Supply Bank. Prior to completing this section, applicants should review all water right lease contracts and any active rental agreements to determine which elements of a water right are available to satisfy a rental request. Lease and rental documents are searchable via [IDWR's website](#).

Water rights identified below must either already be leased to the Bank or a lease proposal should accompany this rental request. Rental requests for water rights not yet leased to the Bank will be returned if companion lease applications are not provided with the rental request. For leased rights featuring combined limits, rentals must be consistent with combined diversion rate, volume or acre limits. Combined limits should be listed on a row below water right numbers.

Water Right Elements Leased to Water Supply Bank					Leased totals, minus water right elements involved in active rental agreements, equals water right elements available for rent	Water Supply Bank Rental Request		
Water Right Number (leave blank if sub-total of combined limits)	Nature of Use	Diversion Rate (CFS)	Volume (AF)	Acres (AC)		Diversion Rate (CFS)	Volume (AF)	Acres (AC)
22-4046	Irrigation	2.32	406	116		1.14	199.5	57
Applicants must ensure the requested rate per acre and volume per acre do not exceed the rate per acre and volume per acre limits of water rights leased to the Water Supply Bank					TOTAL	1.14	199.5	57
						CFS	AF	AC

**Attach multiple copies of this page if space above is insufficient to list all water rights requested to be rented on this application.*

B. If water right conditions, combined limits, or the sum of all water right elements being requested provide an unconventional duty of water (e.g., an unusually low rate per acre or volume per acre for irrigation use), explain how your proposed rental will sufficiently accomplish your intended purposes. Attach a separate page if space is insufficient and label it **Attachment 4B**:
 N/A

C. Does your rental request propose to change the nature of use for any water right(s) being rented? Yes No
 If yes, explain how the water right(s) will be converted to new uses. Include the historic, consumptive use amounts for the water right being rented if you have it, as well as the new consumptive use amount for your proposed beneficial use. If space below is insufficient, attach a separate page and label it **Attachment 4C**:

STATE OF IDAHO
WATER RESOURCE BOARD

Application to Rent Water (Continued)

5. ADDITIONAL INFORMATION

A. Is this the first time that rental water is being requested for this purpose at the rental place of use? Yes No

If no, list previous rental requests/agreements and explain why you have not secured a permanent water right for your needs:

Applicant has secured water rights for a portion of the pivots, but have not yet secured enough to cover the end guns. Most recent rental agreement was from 2016 for water right nos. 22-4046.

B. Have you or do you intend to submit an application for permit or transfer proposing a similar use as this rental? Yes No

If yes, describe:

C. Was this rental application submitted in response to a Notice of Violation (NOV) or a pending NOV? Yes No

If yes, describe the date and location of the NOV.

D. Additional Information

DECLARATION

I hereby assert that the information contained in this application is true to the best of my knowledge. I understand that any willful misrepresentations made in this application may result in rejection of the application or cancellation of an approval. I understand that if this rental application is approved, it will be subject to the provisions of Section 42-1766, Idaho Code and all applicable state and federal laws. I understand that the submission of a rental application provides no guarantee for approval of a rental agreement. I also understand that, per Idaho Code 42-201, it is unlawful to divert or use water without a valid water right and that I am not authorized to utilize water as proposed in this application prior to the execution of an approved rental agreement.

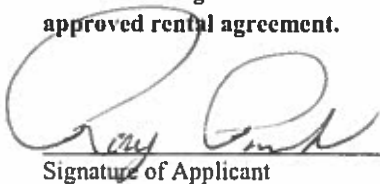
Signature of Applicant

Ray Pocock
Printed Name of Applicant

2-24-2017
Date

Signature of Representative

Printed Name of Representative

Date

Mail to:

Idaho Department of Water Resources
P.O. Box 83720
Boise, ID 83720-0098

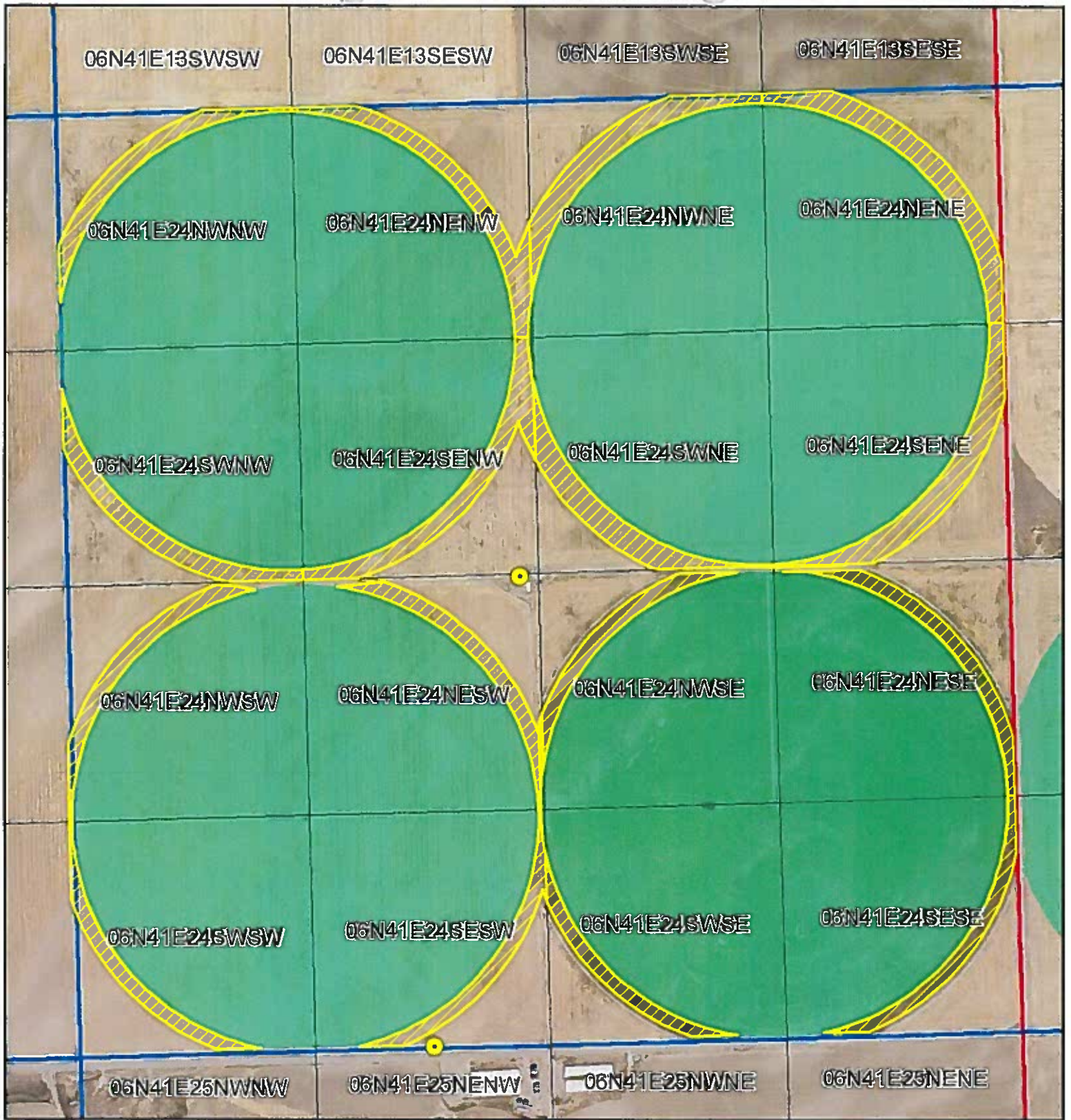

2015 Aerial Photography

Legend

-  Proposed POD
-  Proposed Acres
-  Existing WR POU
-  Twp & Rng
-  Section
-  QQ

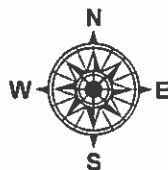

WSB Rental Application

The Ralph R and Beth Pocock Family Ltd Partnership

RMEA #13-0070

by: KM

February 14, 2017



Eastern Snake Plain Aquifer Modeling Analysis

The Applicant requires an additional 57 acres at the proposed place of use to irrigate acres under end guns. Water Right 22-4046 is proposed to be leased to the Water Supply Bank in this lease/rental package. Using ESPAM 2.1 to simulate the depletions of transferring 57 acres from the original point of diversion of 22-4046 to the proposed place of use, the affects do not exceed the threshold of 2.0 af/trimester. No mitigation is required.

Figures 1-3 include excerpts from the ESPAM 2.1 simulation.

Figure 1. Data Entry

ENHANCED GROUND-WATER RIGHTS TRANS

UNIVERSITY OF IDAHO - IDAHO WATER RESOURCES RESEARCH INSTITUTE IDAHO DEPA

Cells this color are set up for user entries

ENTER STARTING DATE F
SIMULATION. THEN PUSH
"UPDATE DATES" BUTTC

YEAR: 1982

SEASON:

TRANSFER NO.: WSB Rental

TRANSFER NAM: Daw 2 Pocock

UPDATE DATES

RUN MODEL

GET OUTPUT

CALCULATE EFFECTS

ENTER CELL LOCATIONS:

	'TO' CELL	'FROM1' CELL	'FROM2' CELL	'FROM3' CELL
ROW	65	57	0	0
COLUMN	192	192	0	0

TRIMESTER OF ACTIVITY	TO WELL	FROM1 WELL		FROM2 WELL		FROM3 WELL	
	Projected Use AF/TRIMESTER	With Transfer AF/TRIMESTER	Without Transfer AF/TRIMESTER	With Transfer AF/TRIMESTER	Without Transfer AF/TRIMESTER	With Transfer AF/TRIMESTER	Without Transfer AF/TRIMESTER
SPR 1982	0	67	67	0	0	0	0
SUM 1982	0	67	67	0	0	0	0
WIN 1982	0	67	67	0	0	0	0
SPR 1983	0	67	67	0	0	0	0
SUM 1983	0	67	67	0	0	0	0
WIN 1983	0	67	67	0	0	0	0
SPR 1984	0	67	67	0	0	0	0
SUM 1984	0	67	67	0	0	0	0
WIN 1984	0	67	67	0	0	0	0
SPR 2018	0	67	67	0	0	0	0
SUM 2018	0	67	67	0	0	0	0
WIN 2018	0	67	67	0	0	0	0
SPR 2017	67	0	67	0	0	0	0
SUM 2017	67	0	67	0	0	0	0
WIN 2017	67	0	67	0	0	0	0
SPR 2018	0	67	67	0	0	0	0
SUM 2018	0	67	67	0	0	0	0
WIN 2018	0	67	67	0	0	0	0
SPR 2109	0	67	67	0	0	0	0
SUM 2109	0	67	67	0	0	0	0
WIN 2109	0	67	67	0	0	0	0
SPR 2110	0	67	67	0	0	0	0
SUM 2110	0	67	67	0	0	0	0
WIN 2110	0	67	67	0	0	0	0
SPR 2111	0	67	67	0	0	0	0
SUM 2111	0	67	67	0	0	0	0
WIN 2111	0	67	67	0	0	0	0

Figure 2. Net Transfer Graphs

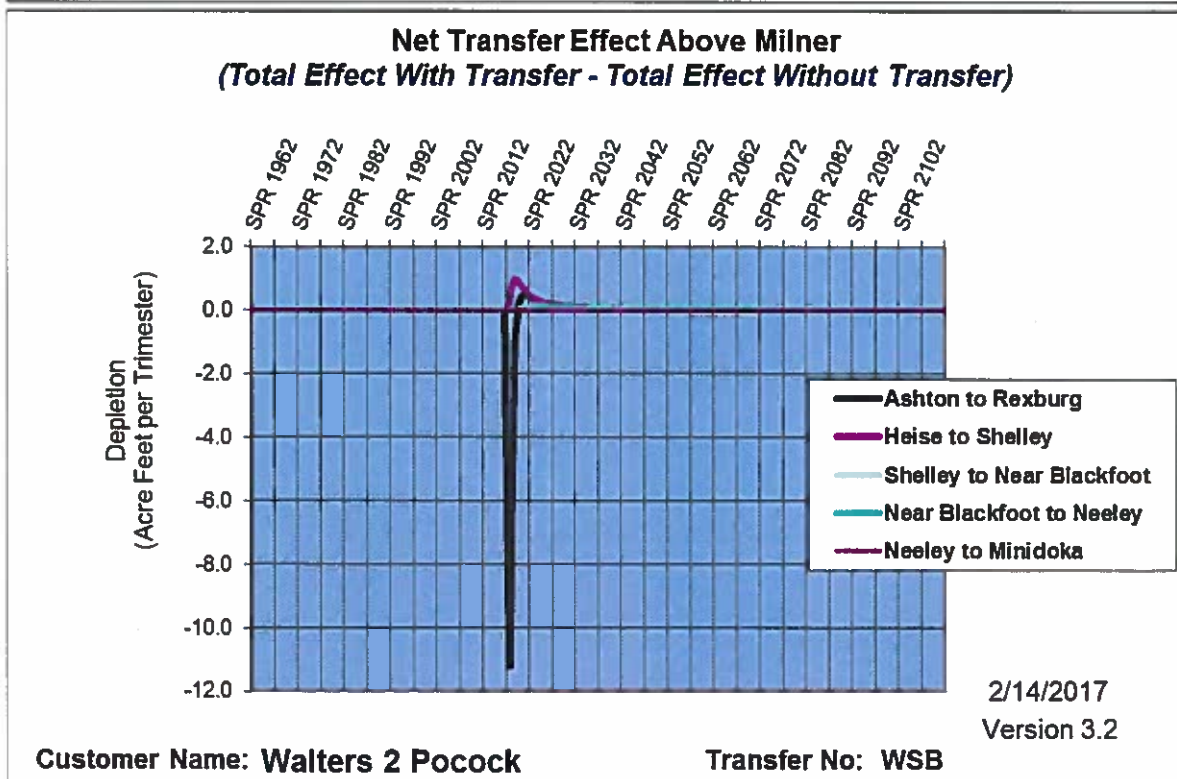
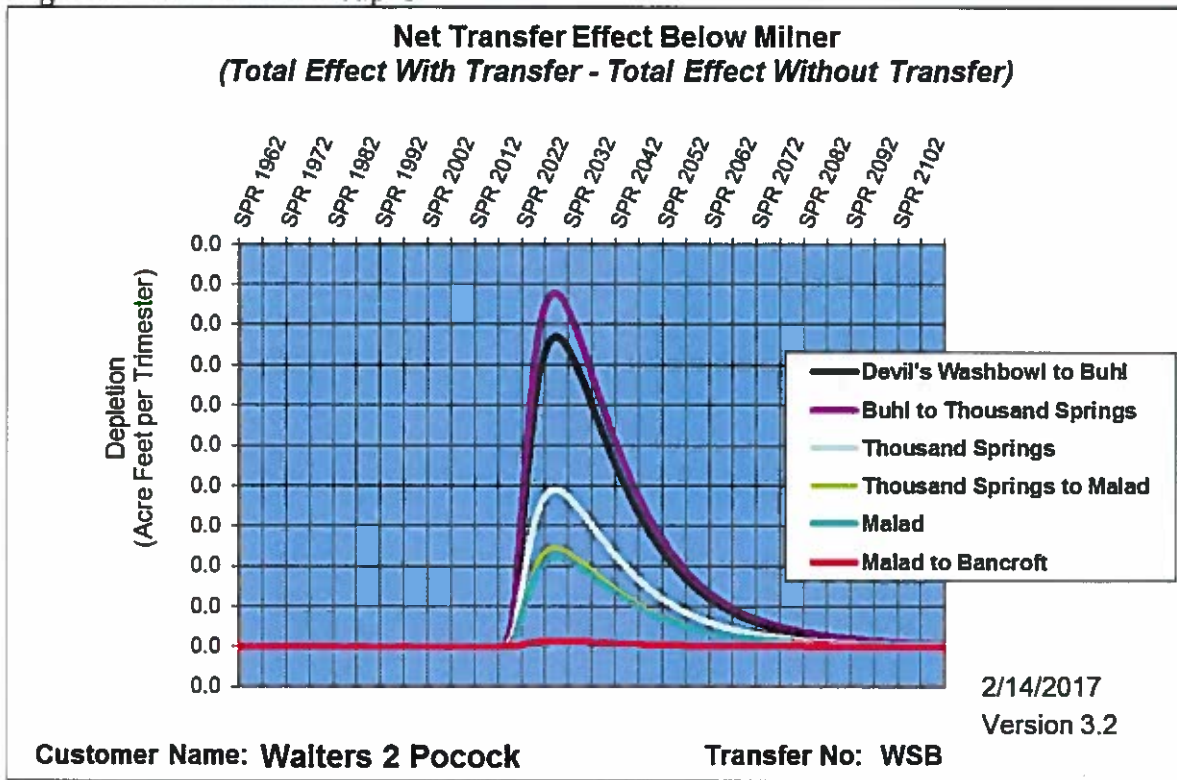



State of Idaho

DEPARTMENT OF WATER RESOURCES

322 East Front Street • P.O. Box 83720 • Boise, Idaho 83720 0098
Phone: (208) 287-4800 • Fax: (208) 287-6700 • Website: www.idwr.idaho.gov

C.L. "BUTCH" OTTER
Governor

GARY SPACKMAN
Director

June 19, 2017

THE RALPH R & BETH POCOCK FAMILY LTD PARTNERSHIP
2964 N 5000 E
SUGAR CITY ID 83448

**RE: RENTAL OF WATER FROM THE WATER SUPPLY BANK
WATER RIGHT NOS. 22-13440, 31-7128, 35-2924, 35-7777, and 35-13855**

Dear Renter:

Please find enclosed a receipt in the amount of **\$3,891.30** and a copy of a fully executed Water Supply Bank Rental Agreement in connection with the rental of 228.9 acre-feet of water for irrigation of 57.0 acres during 2017. Upon receipt of this fully executed agreement, you are authorized to divert water in compliance with the conditions of water use described in the agreement.

Pursuant to the Water Supply Bank Rules, 90% or \$3,502.17 of the rental fee will be paid to the lessor(s) and 10% or \$389.13 will be retained by the Department to offset administrative costs.

If you have any questions, please contact this office at (208) 287-4800.

Sincerely,

A handwritten signature in black ink, appearing to read "Debby Cudd". The signature is written in a cursive style.

The logo for the Water Supply Bank, featuring a stylized 'W' and 'S' intertwined, followed by the text "Water Supply Bank".
Water Supply Bank

Enclosures: Receipt No. C103732
Rental Agreement (copy)

c: Sascha Marston – Fiscal
James Cefalo – IDWR Eastern Regional Office/Water District # 100
Kristin Moore – Rocky Mountain Environmental
Madison GWD



State of Idaho

DEPARTMENT OF WATER RESOURCES

322 East Front Street • P.O. Box 83720 • Boise, Idaho 83720-0098
Phone: (208) 287-4800 • Fax: (208) 287-6700 • Website: www.idwr.idaho.gov

C.L. "BUTCH" OTTER
Governor

GARY SPACKMAN
Director

June 9, 2017

THE RALPH R & BETH POCOCK FAMILY LTD PARTNERSHIP
2964 N 5000 E
SUGAR CITY ID 83448

**RE: APPLICATION TO RENT WATER FROM THE WATER SUPPLY BANK
WATER RIGHT NOS. 22-13440, 31-7128, 35-2924, 35-7777, and 35-13855**

*****TIME SENSITIVE RESPONSE REQUIRED*****

Dear Applicant:

The Department of Water Resources acknowledges receipt of your application to rent water from the Water Supply Bank. I have enclosed a **Water Supply Bank Rental Agreement for your review and signature**. Upon signature and return of the original agreement, together with the rental fee described below, the Department will also sign the original agreement and return an executed copy to you. Execution of the agreement and compliance with the conditions of approval authorize diversion and use of water as provided in the agreement.

A rental fee of \$3,891.30 was calculated based on the current rental rate of \$17.00 per acre-foot times a diversion volume of 228.9 acre-feet.

Please send a check for \$3,891.30 made payable to the Idaho Department of Water Resources, **together with the signed rental agreement, within 14 days** so I can complete processing. Pursuant to the Water Supply Bank Rules, 90% or \$3,502.17 of the rental fee will be paid to the lessor(s) and 10% or \$389.13 will be retained by the Department to offset administrative costs.

If you have any questions, please contact this office at (208) 287-4800.

Sincerely,

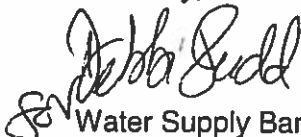
Water Supply Bank

Enclosure

c: IDWR Front Desk
Kristin Moore – Rocky Mountain Environmental

MEMORANDUM

To: Right(s) 22-13440, 31-7128, 35-2924, 35-7777, and 35-13855
From: Michele Edl
Date: June 8, 2017
Re: Review & Analysis of the Pocock Family Application to Rent Water from the State Water Supply Bank

PURPOSE/NARRATIVE: On March 23, 2017, Kristin Moore (Sr WR Analyst, Rocky Mountain Environmental Associates, Inc) submitted a WSB rental application on behalf of the Sanders Family. The original application proposed to rent a portion of water right 22-14206 for the 2017 season. However, it was not clear that the right had not been stacked with surface water.

After several attempts, an alternative rental package using portions of the above rights has been found sufficient to cover the irrigation of 57.0 acres requested by the Pocock Family. The 57 acres ring 4 existing pivots and are irrigated by the end-guns of those pivots.

AUTHORITY TO FILE: According to available Madison County taxlot information, the proposed place-of-use is owned by the Pocock, Ralph & Beth Fam Lmt & Prt. The Ralph R. and Beth Pocock Family Limited Partnership is listed with ISOS as #L3323. Ray R. Pocock is listed as a general partner and he signed the application.

The proposed PODs are two existing wells. They are the authorized PODs for water rights 22-7167A, 22-7052A, 22-2271D, 22-7439 22-14082, 22-14083 and 22-14084 which are held by The Ralph R & Beth Pocock Family Ltd Partnership.

WATER RIGHT VALIDITY:

Right 22-13440 is for irrigation use and has been leased to the bank since 2016. Forfeiture is not an issue at this time. The current lease is in effect until December 31, 2020. A sufficient quantity of the right is available to satisfy this request but the availability will be exhausted by this rental.

Right 31-7128 is for commercial and domestic uses and has been leased to the bank since 2016. The current lease mistakenly added the rates for the two uses instead of setting a combined limit on them. The database has been corrected but the 2017 lease agreement has not been amended. Forfeiture is not an issue at this time. The current lease is in effect until December 31, 2017. The commercial use involved land application of potato processing water so the rate and volume appear incompatible. A change in NOU analysis shows how many acres can be irrigated given that the rate is the limiting element. For this rental, it has been concentrated to 0.015 cfs which is typical of pivot operation.

Right 35-2924 is for industrial and stockwater use and has been leased to the bank since 2009. Forfeiture is not an issue at this time. The current lease is in effect until December 31, 2019 and defines the irrigation use elements as 1.11 cfs, 241 af and 60.3 acres. This rental request exhausts the rental availability of the right.

Right 35-7777 is for irrigation use and has been leased to the bank since 2006. Forfeiture is not an issue at this time. The current lease is in effect until December 31, 2018. This rental request exhausts the rental availability of the right.

Right 35-13855 is for industrial and irrigation use and has been leased to the bank since 2015. Forfeiture is not an issue at this time. The current lease is in effect until December 31, 2020 and defines the irrigation use elements as 0.06 cfs, 20 af and 5.0 acres. The irrigation component will be exhausted by this rental.

INJURY TO OTHER WATER RIGHTS: No injury is apparent. The consultant and I modeled this water rental using the current version of the ETRAN modeling utility. No mitigation is required for this rental.

ENLARGEMENT OF USE: No enlargement is anticipated. The rental rates and volumes rented from the rights will be made proportionate to the leased elements of the right. The authorized rental rate will be approximately 0.015 cfs/ac which is less than the standard 0.02 cfs/ac but sufficient for irrigation of these fields. The native rights appurtenant to the pivots are all less than 0.02 cfs/ac.

The consultant is aware of the rate limitations of these rights. The rental places-of-use have no water rights and according to the consultant, the renter has planted a grain crop for the 2017 season which does not need a high rate/acre. When pieced together the rights will provide enough water to save the crop.

LOCAL PUBLIC INTEREST: Review staff has no information to suggest this application is inconsistent with the local public interest.

BENEFICIAL USE/CONSERVATION OF WATER RESOURCES: The rental appears consistent with the conservation of water resources in Idaho.

DEPARTMENT STAFF OR WATERMASTER COMMENTS: Leased rights 35-7777 and 35-13855 are subject to Water District #120. Leased right 31-7128 is subject to Water District #110. The rental location is subject to Water District #100. Comment has been solicited from the one watermaster oversees the three water districts. He is not opposed to this rental. Nor is Eastern Region.

The rental wells are located within the Madison GW District.

Edl, Michele

From: Cefalo, James
Sent: Thursday, June 08, 2017 9:16 AM
To: Edl, Michele
Subject: RE: request for watermaster comment

Michele,

I don't have any comments or concerns with the proposed WSB Rentals. However, I think that some of the language of the review memo should be changed. The concern with water rights 22-14206 and 22-4046 was not related to their use as a primary or supplemental rights. The rights may very well be primary ground water rights. The issue was that the rights are currently stacked on acres with canal shares. Splitting the rights off of those canal shares may constitute an enlargement.

I also think the memo shouldn't reference the Eastern Region. As watermaster and program manager, I am asked to provide comments or concerns. I do not have veto power over WSB applications and I am not (and do not want to be) the final decision maker. In other words, the reason that a WSB rental is denied should never be that Eastern Region has concerns. If my concerns are valid, then the reason for denial should be the basis for concern (enlargement, injury, etc.). If, on the other hand, my concerns are invalid, or if you simply choose to ignore my concerns, then the WSB application should be approved. Decisions should be based on the facts of the case and the relevant legal statutes, not on the concerns of the regional office.

James

From: Edl, Michele
Sent: Wednesday, June 07, 2017 6:47 PM
To: Cefalo, James <James.Cefalo@idwr.idaho.gov>
Cc: Swank, Lyle <Lyle.Swank@idwr.idaho.gov>
Subject: request for watermaster comment

This should be my last request for comment this WSB season.

I have completed my review of the amended water supply bank rental originally submitted by Kristin Moore on behalf the Pocock Family Limited Partnership for 2017. Kristin and I have found enough water to satisfy the request for 57 acres worth of water for irrigation under the end guns. The rates for each rented right were either already compatibly thin or were concentrated to 0.015 cfs because they were even thinner than that to begin with.

I have attached: a map which shows the POUs and my review memo. Please let me know if you have any questions or concerns about this rental.

Thank you.
Michele Edl
208-287-4946

One-Way Analysis of Independent Transfers

1st batch Pecoek 2017

W/R No.	Dv. Rate (CFS)	Con. Vol. (AFA)	No. of Ir. Acres	Priority Date	POD Location	Dedicated Vol. AFA/AFT	Model Node
Transfer 1: Proposed Steady State Impacts following Transfer							
777	777	275.6	68.9	1/1/1960	8526E-3	275.6 91.9	SP082075
777	777	275.6	68.9	1/1/1960	8526E-3	275.6 91.9	SP082075
Transfer 1: Worst Case Transient State Impacts following Transfer							
777	777	275.6	68.9	1/1/1960	8526E-3	275.6 91.9	SP082075
777	777	275.6	68.9	1/1/1960	8526E-3	275.6 91.9	SP082075

Impact by Reach (AFT/Transfer)		Hesse to Sheley		Sheley to Neeley		Neeley to Minkoka		Dev. Wkld. To Burl		Burl to Kspr		Kspr to Maled		Maled to Bancroft	
Ashton to Rendburg	14.76	15.68	5.73	15.66	0.09	0.30	0.34	0.15	0.10	0.09	0.01	0.10	0.09	0.01	0.01
	14.75	15.68	5.73	15.95	0.09	0.30	0.34	0.15	0.10	0.09	0.01	0.10	0.09	0.01	0.01
	14.76	15.68	5.73	15.96	0.09	0.30	0.34	0.15	0.10	0.09	0.01	0.10	0.09	0.01	0.01
	14.75	15.68	5.73	15.95	0.09	0.30	0.34	0.15	0.10	0.09	0.01	0.10	0.09	0.01	0.01

Steady State Analysis

Mitigation Check 1 - >10% of Historical:	0.0%	0.0%	0.0%	0.0%	-0.1%	-0.1%	-0.1%	-0.1%	-0.1%	-0.1%	-0.1%	-0.1%	-0.1%	-0.1%	-0.1%
Mitigation Check 2 - > 2 AFT:	0.0	0.0	0.0	0.0	0.0	0.0	0.0	0.0	0.0	0.0	0.0	0.0	0.0	0.0	0.0
Mitigation Check 3 - >10% of Total:	27.7%	29.5%	10.8%	30.0%	0.2%	0.6%	0.3%	0.2%	0.2%	0.2%	0.0%	0.2%	0.2%	0.0%	0.0%
Mitigation Vol. Req'd (ac-ft):	0.0	0.0	0.0	0.0	0.0	0.0	0.0	0.0	0.0	0.0	0.0	0.0	0.0	0.0	0.0

Transient State Analysis

Mitigation Check 1 - >10% of Historical:	0.0%	0.0%	0.0%	0.0%	-0.1%	-0.1%	-0.1%	-0.1%	-0.1%	-0.1%	-0.1%	-0.1%	-0.1%	-0.1%	-0.1%
Mitigation Check 2 - > 2.01 AFT:	0.0	0.0	0.0	0.0	0.0	0.0	0.0	0.0	0.0	0.0	0.0	0.0	0.0	0.0	0.0
Mitigation Vol. Req'd (ac-ft):	0.0	0.0	0.0	0.0	0.0	0.0	0.0	0.0	0.0	0.0	0.0	0.0	0.0	0.0	0.0

2nd batch Pecoek 2017

W/R No.	Dv. Rate (CFS)	Con. Vol. (AFA)	No. of Ir. Acres	Priority Date	POD Location	Dedicated Vol. AFA/AFT	Model Node
Transfer: Proposed Steady State Impacts following Transfer							
0	0	0	0	1/0/1900	0	0 0	0
0	0	0	0	1/0/1900	0	0 0	0
Transfer 1: Worst Case Transient State Impacts following Transfer							
0	0	0	0	1/0/1900	0	0 0	0
0	0	0	0	1/0/1900	0	0 0	0

Steady State Analysis

Mitigation Check 1 - >10% of Historical:	0.0%	0.0%	0.0%	0.0%	-0.1%	-0.1%	-0.1%	-0.1%	-0.1%	-0.1%	-0.1%	-0.1%	-0.1%	-0.1%	-0.1%
Mitigation Check 2 - > 2 AFT:	0.0	0.0	0.0	0.0	0.0	0.0	0.0	0.0	0.0	0.0	0.0	0.0	0.0	0.0	0.0
Mitigation Check 3 - >10% of Total:	31.6%	37.4%	8.2%	21.3%	0.1%	0.4%	0.5%	0.2%	0.1%	0.1%	0.0%	0.1%	0.1%	0.0%	0.0%
Mitigation Vol. Req'd (ac-ft):	0.0	0.0	0.0	0.0	0.0	0.0	0.0	0.0	0.0	0.0	0.0	0.0	0.0	0.0	0.0

Transient State Analysis

Mitigation Check 1 - >10% of Historical:	0.0%	0.0%	0.0%	0.0%	-0.1%	-0.1%	-0.1%	-0.1%	-0.1%	-0.1%	-0.1%	-0.1%	-0.1%	-0.1%	-0.1%
Mitigation Check 2 - > 2.01 AFT:	0.0	0.0	0.0	0.0	0.0	0.0	0.0	0.0	0.0	0.0	0.0	0.0	0.0	0.0	0.0
Mitigation Vol. Req'd (ac-ft):	0.0	0.0	0.0	0.0	0.0	0.0	0.0	0.0	0.0	0.0	0.0	0.0	0.0	0.0	0.0

Impact by Reach (AFT/Transfer)

Ashton to Rendburg		Hesse to Sheley		Sheley to Neeley		Neeley to Minkoka		Dev. Wkld. To Burl		Burl to Kspr		Kspr to Maled		Maled to Bancroft	
5.2	6.1	1.3	1.3	3.5	0.0	0.1	0.1	0.1	0.1	0.0	0.0	0.0	0.0	0.0	0.0
5.2	6.1	1.3	1.3	3.5	0.0	0.1	0.1	0.1	0.1	0.0	0.0	0.0	0.0	0.0	0.0
5.2	6.1	1.3	1.3	3.5	0.0	0.1	0.1	0.1	0.1	0.0	0.0	0.0	0.0	0.0	0.0
5.2	6.1	1.3	1.3	3.5	0.0	0.1	0.1	0.1	0.1	0.0	0.0	0.0	0.0	0.0	0.0

ENHANCED GROUND-WATER RIGHTS TRANSFER

UNIVERSITY OF IDAHO - IDAHO WATER RESOURCES RESEARCH INSTITUTE

IDAHO DEPARTMENT OF WATER RESOURCES

Cells this color are set up for user entries

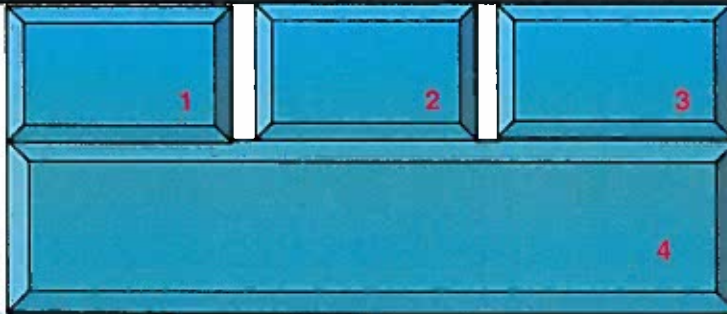

ENTER STARTING DATE FOR

SIMULATION. THEN PUSH "UPDATE DATES" BUTTON

TRANSFER NO: 123

YEAR: 1960

SEASON: SPRING

TRANSFER NAME: 1st Pocock 2017

ENTER CELL LOCATIONS:

ROW	'TO' CELL	'FROM1' CELL	'FROM2' CELL	'FROM3' CELL
COLUMN	64	70	62	58
	192	130	183	148

TRIMESTER OF ACTIVITY	TO WELL	FROM1 WELL		FROM2 WELL		FROM3 WELL	
	Projected Use AF/TRIMESTER	With Transfer AF/TRIMESTER	Without Transfer AF/TRIMESTER	With Transfer AF/TRIMESTER	Without Transfer AF/TRIMESTER	With Transfer AF/TRIMESTER	Without Transfer AF/TRIMESTER
SPR 1960	0	0	0	0	0	0	0
SUM 1960	0	0	0	0	0	0	0
WIN 1960	0	0	0	0	0	7	7
SPR 1961	0	0	0	0	0	7	7
SUM 1961	0	0	0	0	0	7	7
WIN 1961	0	0	0	0	0	7	7
SPR 1962	0	0	0	0	0	7	7
SUM 1962	0	0	0	0	0	7	7
WIN 1962	0	0	0	0	0	7	7
SPR 1963	0	0	0	0	0	7	7
SUM 1963	0	0	0	0	0	7	7
WIN 1963	0	0	0	0	0	7	7
SPR 1964	0	0	0	0	0	7	7
SUM 1964	0	0	0	0	0	7	7
WIN 1964	0	0	0	0	0	7	7
SPR 1965	0	0	0	0	0	7	7
SUM 1965	0	0	0	0	0	7	7
WIN 1965	0	0	0	36	36	7	7
SPR 1966	0	0	0	36	36	7	7
SUM 1966	0	0	0	36	36	7	7
WIN 1966	0	0	0	36	36	7	7
SPR 1967	0	0	0	36	36	7	7
SUM 1967	0	0	0	36	36	7	7
WIN 1967	0	0	0	36	36	7	7
SPR 1968	0	0	0	36	36	7	7
SUM 1968	0	0	0	36	36	7	7
WIN 1968	0	0	0	36	36	7	7
SPR 1969	0	0	0	36	36	7	7
SUM 1969	0	0	0	36	36	7	7
WIN 1969	0	0	0	36	36	7	7
SPR 1970	0	0	0	36	36	7	7
SUM 1970	0	0	0	36	36	7	7
WIN 1970	0	0	0	36	36	7	7
SPR 1971	0	0	0	36	36	7	7
SUM 1971	0	0	0	36	36	7	7
WIN 1971	0	0	0	36	36	7	7

SPR 1972	0	0	0	36	36	7	7
SUM 1972	0	0	0	36	36	7	7
WIN 1972	0	0	0	36	36	7	7
SPR 1973	0	0	0	36	36	7	7
SUM 1973	0	0	0	36	36	7	7
WIN 1973	0	0	0	36	36	7	7
SPR 1974	0	0	0	36	36	7	7
SUM 1974	0	0	0	36	36	7	7
WIN 1974	0	0	0	36	36	7	7
SPR 1975	0	0	0	36	36	7	7
SUM 1975	0	0	0	36	36	7	7
WIN 1975	0	0	0	36	36	7	7
SPR 1976	0	0	0	36	36	7	7
SUM 1976	0	0	0	36	36	7	7
WIN 1976	0	0	0	36	36	7	7
SPR 1977	0	0	0	36	36	7	7
SUM 1977	0	0	0	36	36	7	7
WIN 1977	0	11	11	36	36	7	7
SPR 1978	0	11	11	36	36	7	7
SUM 1978	0	11	11	36	36	7	7
WIN 1978	0	11	11	36	36	7	7
SPR 1979	0	11	11	36	36	7	7
SUM 1979	0	11	11	36	36	7	7
WIN 1979	0	11	11	36	36	7	7
SPR 1980	0	11	11	36	36	7	7
SUM 1980	0	11	11	36	36	7	7
WIN 1980	0	11	11	36	36	7	7
SPR 1981	0	11	11	36	36	7	7
SUM 1981	0	11	11	36	36	7	7
WIN 1981	0	11	11	36	36	7	7
SPR 1982	0	11	11	36	36	7	7
SUM 1982	0	11	11	36	36	7	7
WIN 1982	0	11	11	36	36	7	7
SPR 1983	0	11	11	36	36	7	7
SUM 1983	0	11	11	36	36	7	7
WIN 1983	0	11	11	36	36	7	7
SPR 1984	0	11	11	36	36	7	7
SUM 1984	0	11	11	36	36	7	7
WIN 1984	0	11	11	36	36	7	7
SPR 1985	0	11	11	36	36	7	7
SUM 1985	0	11	11	36	36	7	7
WIN 1985	0	11	11	36	36	7	7
SPR 1986	0	11	11	36	36	7	7
SUM 1986	0	11	11	36	36	7	7
WIN 1986	0	11	11	36	36	7	7
SPR 1987	0	11	11	36	36	7	7
SUM 1987	0	11	11	36	36	7	7
WIN 1987	0	11	11	36	36	7	7
SPR 1988	0	11	11	36	36	7	7
SUM 1988	0	11	11	36	36	7	7
WIN 1988	0	11	11	36	36	7	7
SPR 1989	0	11	11	36	36	7	7
SUM 1989	0	11	11	36	36	7	7
WIN 1989	0	11	11	36	36	7	7
SPR 1990	0	11	11	36	36	7	7
SUM 1990	0	11	11	36	36	7	7
WIN 1990	0	11	11	36	36	7	7
SPR 1991	0	11	11	36	36	7	7
SUM 1991	0	11	11	36	36	7	7
WIN 1991	0	11	11	36	36	7	7
SPR 1992	0	11	11	36	36	7	7
SUM 1992	0	11	11	36	36	7	7
WIN 1992	0	11	11	36	36	7	7
SPR 1993	0	11	11	36	36	7	7
SUM 1993	0	11	11	36	36	7	7
WIN 1993	0	11	11	36	36	7	7
SPR 1994	0	11	11	36	36	7	7
SUM 1994	0	11	11	36	36	7	7

WIN 1994	0	11	11	36	36	7	7
SPR 1995	0	11	11	36	36	7	7
SUM 1995	0	11	11	36	36	7	7
WIN 1995	0	11	11	36	36	7	7
SPR 1996	0	11	11	36	36	7	7
SUM 1996	0	11	11	36	36	7	7
WIN 1996	0	11	11	36	36	7	7
SPR 1997	0	11	11	36	36	7	7
SUM 1997	0	11	11	36	36	7	7
WIN 1997	0	11	11	36	36	7	7
SPR 1998	0	11	11	36	36	7	7
SUM 1998	0	11	11	36	36	7	7
WIN 1998	0	11	11	36	36	7	7
SPR 1999	0	11	11	36	36	7	7
SUM 1999	0	11	11	36	36	7	7
WIN 1999	0	11	11	36	36	7	7
SPR 2000	0	11	11	36	36	7	7
SUM 2000	0	11	11	36	36	7	7
WIN 2000	0	11	11	36	36	7	7
SPR 2001	0	11	11	36	36	7	7
SUM 2001	0	11	11	36	36	7	7
WIN 2001	0	11	11	36	36	7	7
SPR 2002	0	11	11	36	36	7	7
SUM 2002	0	11	11	36	36	7	7
WIN 2002	0	11	11	36	36	7	7
SPR 2003	0	11	11	36	36	7	7
SUM 2003	0	11	11	36	36	7	7
WIN 2003	0	11	11	36	36	7	7
SPR 2004	0	11	11	36	36	7	7
SUM 2004	0	11	11	36	36	7	7
WIN 2004	0	11	11	36	36	7	7
SPR 2005	0	11	11	36	36	7	7
SUM 2005	0	11	11	36	36	7	7
WIN 2005	0	11	11	36	36	7	7
SPR 2006	0	11	11	36	36	7	7
SUM 2006	0	11	11	36	36	7	7
WIN 2006	0	11	11	36	36	7	7
SPR 2007	0	11	11	36	36	7	7
SUM 2007	0	11	11	36	36	7	7
WIN 2007	0	11	11	36	36	7	7
SPR 2008	0	11	11	36	36	7	7
SUM 2008	0	11	11	36	36	7	7
WIN 2008	0	11	11	36	36	7	7
SPR 2009	0	11	11	36	36	7	7
SUM 2009	0	11	11	36	36	7	7
WIN 2009	0	11	11	36	36	7	7
SPR 2010	0	11	11	36	36	7	7
SUM 2010	0	11	11	36	36	7	7
WIN 2010	0	11	11	36	36	7	7
SPR 2011	0	11	11	36	36	7	7
SUM 2011	0	11	11	36	36	7	7
WIN 2011	0	11	11	36	36	7	7
SPR 2012	0	11	11	36	36	7	7
SUM 2012	0	11	11	36	36	7	7
WIN 2012	0	11	11	36	36	7	7
SPR 2013	0	11	11	36	36	7	7
SUM 2013	0	11	11	36	36	7	7
WIN 2013	0	11	11	36	36	7	7
SPR 2014	0	11	11	36	36	7	7
SUM 2014	0	11	11	36	36	7	7
WIN 2014	0	11	11	36	36	7	7
SPR 2015	0	11	11	36	36	0	7
SUM 2015	0	11	11	36	36	0	7
WIN 2015	0	11	11	36	36	0	7
SPR 2016	0	11	11	0	36	0	7
SUM 2016	0	11	11	0	36	0	7
WIN 2016	0	11	11	0	36	0	7
SPR 2017	54	0	11	0	36	0	7
SUM 2017	54	0	11	0	36	0	7
WIN 2017	54	0	11	0	36	0	7

SPR 2018	0	0	11	0	36	0	7
SUM 2018	0	0	11	0	36	0	7
WIN 2018	0	0	11	0	36	0	7
SPR 2019	0	0	11	0	36	0	7
SUM 2019	0	0	11	0	36	0	7
WIN 2019	0	0	11	0	36	0	7
SPR 2020	0	0	11	0	36	7	7
SUM 2020	0	0	11	0	36	7	7
WIN 2020	0	0	11	0	36	7	7
SPR 2021	0	11	11	36	36	7	7
SUM 2021	0	11	11	36	36	7	7
WIN 2021	0	11	11	36	36	7	7
SPR 2022	0	11	11	36	36	7	7
SUM 2022	0	11	11	36	36	7	7
WIN 2022	0	11	11	36	36	7	7
SPR 2023	0	11	11	36	36	7	7
SUM 2023	0	11	11	36	36	7	7
WIN 2023	0	11	11	36	36	7	7
SPR 2024	0	11	11	36	36	7	7
SUM 2024	0	11	11	36	36	7	7
WIN 2024	0	11	11	36	36	7	7
SPR 2025	0	11	11	36	36	7	7
SUM 2025	0	11	11	36	36	7	7
WIN 2025	0	11	11	36	36	7	7
SPR 2026	0	11	11	36	36	7	7
SUM 2026	0	11	11	36	36	7	7
WIN 2026	0	11	11	36	36	7	7
SPR 2027	0	11	11	36	36	7	7
SUM 2027	0	11	11	36	36	7	7
WIN 2027	0	11	11	36	36	7	7
SPR 2028	0	11	11	36	36	7	7
SUM 2028	0	11	11	36	36	7	7
WIN 2028	0	11	11	36	36	7	7
SPR 2029	0	11	11	36	36	7	7
SUM 2029	0	11	11	36	36	7	7
WIN 2029	0	11	11	36	36	7	7
SPR 2030	0	11	11	36	36	7	7
SUM 2030	0	11	11	36	36	7	7
WIN 2030	0	11	11	36	36	7	7
SPR 2031	0	11	11	36	36	7	7
SUM 2031	0	11	11	36	36	7	7
WIN 2031	0	11	11	36	36	7	7
SPR 2032	0	11	11	36	36	7	7
SUM 2032	0	11	11	36	36	7	7
WIN 2032	0	11	11	36	36	7	7
SPR 2033	0	11	11	36	36	7	7
SUM 2033	0	11	11	36	36	7	7
WIN 2033	0	11	11	36	36	7	7
SPR 2034	0	11	11	36	36	7	7
SUM 2034	0	11	11	36	36	7	7
WIN 2034	0	11	11	36	36	7	7
SPR 2035	0	11	11	36	36	7	7
SUM 2035	0	11	11	36	36	7	7
WIN 2035	0	11	11	36	36	7	7
SPR 2036	0	11	11	36	36	7	7
SUM 2036	0	11	11	36	36	7	7
WIN 2036	0	11	11	36	36	7	7
SPR 2037	0	11	11	36	36	7	7
SUM 2037	0	11	11	36	36	7	7
WIN 2037	0	11	11	36	36	7	7
SPR 2038	0	11	11	36	36	7	7
SUM 2038	0	11	11	36	36	7	7
WIN 2038	0	11	11	36	36	7	7
SPR 2039	0	11	11	36	36	7	7
SUM 2039	0	11	11	36	36	7	7
WIN 2039	0	11	11	36	36	7	7
SPR 2040	0	11	11	36	36	7	7
SUM 2040	0	11	11	36	36	7	7
WIN 2040	0	11	11	36	36	7	7
SPR 2041	0	11	11	36	36	7	7

SUM 2041	0	11	11	36	36	7	7
WIN 2041	0	11	11	36	36	7	7
SPR 2042	0	11	11	36	36	7	7
SUM 2042	0	11	11	36	36	7	7
WIN 2042	0	11	11	36	36	7	7
SPR 2043	0	11	11	36	36	7	7
SUM 2043	0	11	11	36	36	7	7
WIN 2043	0	11	11	36	36	7	7
SPR 2044	0	11	11	36	36	7	7
SUM 2044	0	11	11	36	36	7	7
WIN 2044	0	11	11	36	36	7	7
SPR 2045	0	11	11	36	36	7	7
SUM 2045	0	11	11	36	36	7	7
WIN 2045	0	11	11	36	36	7	7
SPR 2046	0	11	11	36	36	7	7
SUM 2046	0	11	11	36	36	7	7
WIN 2046	0	11	11	36	36	7	7
SPR 2047	0	11	11	36	36	7	7
SUM 2047	0	11	11	36	36	7	7
WIN 2047	0	11	11	36	36	7	7
SPR 2048	0	11	11	36	36	7	7
SUM 2048	0	11	11	36	36	7	7
WIN 2048	0	11	11	36	36	7	7
SPR 2049	0	11	11	36	36	7	7
SUM 2049	0	11	11	36	36	7	7
WIN 2049	0	11	11	36	36	7	7
SPR 2050	0	11	11	36	36	7	7
SUM 2050	0	11	11	36	36	7	7
WIN 2050	0	11	11	36	36	7	7
SPR 2051	0	11	11	36	36	7	7
SUM 2051	0	11	11	36	36	7	7
WIN 2051	0	11	11	36	36	7	7
SPR 2052	0	11	11	36	36	7	7
SUM 2052	0	11	11	36	36	7	7
WIN 2052	0	11	11	36	36	7	7
SPR 2053	0	11	11	36	36	7	7
SUM 2053	0	11	11	36	36	7	7
WIN 2053	0	11	11	36	36	7	7
SPR 2054	0	11	11	36	36	7	7
SUM 2054	0	11	11	36	36	7	7
WIN 2054	0	11	11	36	36	7	7
SPR 2055	0	11	11	36	36	7	7
SUM 2055	0	11	11	36	36	7	7
WIN 2055	0	11	11	36	36	7	7
SPR 2056	0	11	11	36	36	7	7
SUM 2056	0	11	11	36	36	7	7
WIN 2056	0	11	11	36	36	7	7
SPR 2057	0	11	11	36	36	7	7
SUM 2057	0	11	11	36	36	7	7
WIN 2057	0	11	11	36	36	7	7
SPR 2058	0	11	11	36	36	7	7
SUM 2058	0	11	11	36	36	7	7
WIN 2058	0	11	11	36	36	7	7
SPR 2059	0	11	11	36	36	7	7
SUM 2059	0	11	11	36	36	7	7
WIN 2059	0	11	11	36	36	7	7
SPR 2060	0	11	11	36	36	7	7
SUM 2060	0	11	11	36	36	7	7
WIN 2060	0	11	11	36	36	7	7
SPR 2061	0	11	11	36	36	7	7
SUM 2061	0	11	11	36	36	7	7
WIN 2061	0	11	11	36	36	7	7
SPR 2062	0	11	11	36	36	7	7
SUM 2062	0	11	11	36	36	7	7
WIN 2062	0	11	11	36	36	7	7
SPR 2063	0	11	11	36	36	7	7
SUM 2063	0	11	11	36	36	7	7
WIN 2063	0	11	11	36	36	7	7
SPR 2064	0	11	11	36	36	7	7
SUM 2064	0	11	11	36	36	7	7

WIN 2064	0	11	11	36	36	7	7
SPR 2065	0	11	11	36	36	7	7
SUM 2065	0	11	11	36	36	7	7
WIN 2065	0	11	11	36	36	7	7
SPR 2066	0	11	11	36	36	7	7
SUM 2066	0	11	11	36	36	7	7
WIN 2066	0	11	11	36	36	7	7
SPR 2067	0	11	11	36	36	7	7
SUM 2067	0	11	11	36	36	7	7
WIN 2067	0	11	11	36	36	7	7
SPR 2068	0	11	11	36	36	7	7
SUM 2068	0	11	11	36	36	7	7
WIN 2068	0	11	11	36	36	7	7
SPR 2069	0	11	11	36	36	7	7
SUM 2069	0	11	11	36	36	7	7
WIN 2069	0	11	11	36	36	7	7
SPR 2070	0	11	11	36	36	7	7
SUM 2070	0	11	11	36	36	7	7
WIN 2070	0	11	11	36	36	7	7
SPR 2071	0	11	11	36	36	7	7
SUM 2071	0	11	11	36	36	7	7
WIN 2071	0	11	11	36	36	7	7
SPR 2072	0	11	11	36	36	7	7
SUM 2072	0	11	11	36	36	7	7
WIN 2072	0	11	11	36	36	7	7
SPR 2073	0	11	11	36	36	7	7
SUM 2073	0	11	11	36	36	7	7
WIN 2073	0	11	11	36	36	7	7
SPR 2074	0	11	11	36	36	7	7
SUM 2074	0	11	11	36	36	7	7
WIN 2074	0	11	11	36	36	7	7
SPR 2075	0	11	11	36	36	7	7
SUM 2075	0	11	11	36	36	7	7
WIN 2075	0	11	11	36	36	7	7
SPR 2076	0	11	11	36	36	7	7
SUM 2076	0	11	11	36	36	7	7
WIN 2076	0	11	11	36	36	7	7
SPR 2077	0	11	11	36	36	7	7
SUM 2077	0	11	11	36	36	7	7
WIN 2077	0	11	11	36	36	7	7
SPR 2078	0	11	11	36	36	7	7
SUM 2078	0	11	11	36	36	7	7
WIN 2078	0	11	11	36	36	7	7
SPR 2079	0	11	11	36	36	7	7
SUM 2079	0	11	11	36	36	7	7
WIN 2079	0	11	11	36	36	7	7
SPR 2080	0	11	11	36	36	7	7
SUM 2080	0	11	11	36	36	7	7
WIN 2080	0	11	11	36	36	7	7
SPR 2081	0	11	11	36	36	7	7
SUM 2081	0	11	11	36	36	7	7
WIN 2081	0	11	11	36	36	7	7
SPR 2082	0	11	11	36	36	7	7
SUM 2082	0	11	11	36	36	7	7
WIN 2082	0	11	11	36	36	7	7
SPR 2083	0	11	11	36	36	7	7
SUM 2083	0	11	11	36	36	7	7
WIN 2083	0	11	11	36	36	7	7
SPR 2084	0	11	11	36	36	7	7
SUM 2084	0	11	11	36	36	7	7
WIN 2084	0	11	11	36	36	7	7
SPR 2085	0	11	11	36	36	7	7
SUM 2085	0	11	11	36	36	7	7
WIN 2085	0	11	11	36	36	7	7
SPR 2086	0	11	11	36	36	7	7
SUM 2086	0	11	11	36	36	7	7
WIN 2086	0	11	11	36	36	7	7
SPR 2087	0	11	11	36	36	7	7
SUM 2087	0	11	11	36	36	7	7
WIN 2087	0	11	11	36	36	7	7

SPR 2088	0	11	11	36	36	7	7
SUM 2088	0	11	11	36	36	7	7
WIN 2088	0	11	11	36	36	7	7
SPR 2089	0	11	11	36	36	7	7
SUM 2089	0	11	11	36	36	7	7
WIN 2089	0	11	11	36	36	7	7
SPR 2090	0	11	11	36	36	7	7
SUM 2090	0	11	11	36	36	7	7
WIN 2090	0	11	11	36	36	7	7
SPR 2091	0	11	11	36	36	7	7
SUM 2091	0	11	11	36	36	7	7
WIN 2091	0	11	11	36	36	7	7
SPR 2092	0	11	11	36	36	7	7
SUM 2092	0	11	11	36	36	7	7
WIN 2092	0	11	11	36	36	7	7
SPR 2093	0	11	11	36	36	7	7
SUM 2093	0	11	11	36	36	7	7
WIN 2093	0	11	11	36	36	7	7
SPR 2094	0	11	11	36	36	7	7
SUM 2094	0	11	11	36	36	7	7
WIN 2094	0	11	11	36	36	7	7
SPR 2095	0	11	11	36	36	7	7
SUM 2095	0	11	11	36	36	7	7
WIN 2095	0	11	11	36	36	7	7
SPR 2096	0	11	11	36	36	7	7
SUM 2096	0	11	11	36	36	7	7
WIN 2096	0	11	11	36	36	7	7
SPR 2097	0	11	11	36	36	7	7
SUM 2097	0	11	11	36	36	7	7
WIN 2097	0	11	11	36	36	7	7
SPR 2098	0	11	11	36	36	7	7
SUM 2098	0	11	11	36	36	7	7
WIN 2098	0	11	11	36	36	7	7
SPR 2099	0	11	11	36	36	7	7
SUM 2099	0	11	11	36	36	7	7
WIN 2099	0	11	11	36	36	7	7
SPR 2100	0	11	11	36	36	7	7
SUM 2100	0	11	11	36	36	7	7
WIN 2100	0	11	11	36	36	7	7
SPR 2101	0	11	11	36	36	7	7
SUM 2101	0	11	11	36	36	7	7
WIN 2101	0	11	11	36	36	7	7
SPR 2102	0	11	11	36	36	7	7
SUM 2102	0	11	11	36	36	7	7
WIN 2102	0	11	11	36	36	7	7
SPR 2103	0	11	11	36	36	7	7
SUM 2103	0	11	11	36	36	7	7
WIN 2103	0	11	11	36	36	7	7
SPR 2104	0	11	11	36	36	7	7
SUM 2104	0	11	11	36	36	7	7
WIN 2104	0	11	11	36	36	7	7
SPR 2105	0	11	11	36	36	7	7
SUM 2105	0	11	11	36	36	7	7
WIN 2105	0	11	11	36	36	7	7
SPR 2106	0	11	11	36	36	7	7
SUM 2106	0	11	11	36	36	7	7
WIN 2106	0	11	11	36	36	7	7
SPR 2107	0	11	11	36	36	7	7
SUM 2107	0	11	11	36	36	7	7
WIN 2107	0	11	11	36	36	7	7
SPR 2108	0	11	11	36	36	7	7
SUM 2108	0	11	11	36	36	7	7
WIN 2108	0	11	11	36	36	7	7
SPR 2109	0	11	11	36	36	7	7
SUM 2109	0	11	11	36	36	7	7
WIN 2109	0	11	11	36	36	7	7

ENHANCED GROUND-WATER RIGHTS TRANSFER

UNIVERSITY OF IDAHO - IDAHO WATER RESOURCES RESEARCH INSTITUTE

IDAHO DEPARTMENT OF WATER RESOURCES

Cells this color are set up for user entries

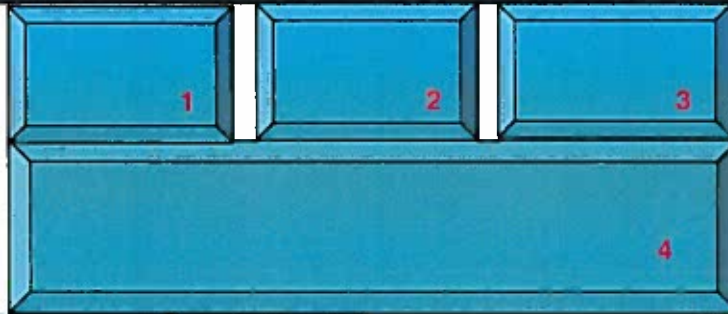

ENTER STARTING DATE FOR

SIMULATION. THEN PUSH "UPDATE DATES" BUTTON

TRANSFER NO: 123

YEAR: 1952

SEASON: SPRING

TRANSFER NAME: Pocock 2017 2nd

ENTER CELL LOCATIONS:

	'TO' CELL	'FROM1' CELL	'FROM2' CELL	'FROM3' CELL
ROW	64	33	61	0
COLUMN	192	173	164	0

TRIMESTER OF ACTIVITY	TO WELL	FROM1 WELL		FROM2 WELL		FROM3 WELL	
	Projected Use AF/TRIMESTER	With Transfer AF/TRIMESTER	Without Transfer AF/TRIMESTER	With Transfer AF/TRIMESTER	Without Transfer AF/TRIMESTER	With Transfer AF/TRIMESTER	Without Transfer AF/TRIMESTER
SPR 1952	0	0	0	0	0	0	0
SUM 1952	0	0	0	0	0	0	0
WIN 1952	0	0	0	0	0	0	0
SPR 1953	0	0	0	0	0	0	0
SUM 1953	0	0	0	0	0	0	0
WIN 1953	0	0	0	0	0	0	0
SPR 1954	0	0	0	0	0	0	0
SUM 1954	0	0	0	0	0	0	0
WIN 1954	0	0	0	0	0	0	0
SPR 1955	0	0	0	0	0	0	0
SUM 1955	0	0	0	0	0	0	0
WIN 1955	0	0	0	0	0	0	0
SPR 1956	0	0	0	0	0	0	0
SUM 1956	0	0	0	0	0	0	0
WIN 1956	0	0	0	0	0	0	0
SPR 1957	0	0	0	0	0	0	0
SUM 1957	0	0	0	0	0	0	0
WIN 1957	0	0	0	0	0	0	0
SPR 1958	0	0	0	0	0	0	0
SUM 1958	0	0	0	0	0	0	0
WIN 1958	0	0	0	0	0	0	0
SPR 1959	0	0	0	0	0	0	0
SUM 1959	0	0	0	0	0	0	0
WIN 1959	0	0	0	0	0	0	0
SPR 1960	0	0	0	0	0	0	0
SUM 1960	0	0	0	0	0	0	0
WIN 1960	0	0	0	0	0	0	0
SPR 1961	0	0	0	0	0	0	0
SUM 1961	0	0	0	0	0	0	0
WIN 1961	0	0	0	0	0	0	0
SPR 1962	0	0	0	0	0	0	0
SUM 1962	0	0	0	0	0	0	0
WIN 1962	0	0	0	0	0	0	0
SPR 1963	0	0	0	0	0	0	0
SUM 1963	0	0	0	0	0	0	0
WIN 1963	0	0	0	0	0	0	0

SPR 1964	0	0	0	0	0	0	0	0
SUM 1964	0	0	0	0	0	0	0	0
WIN 1964	0	0	0	0	0	0	0	0
SPR 1965	0	0	0	1	1	0	0	0
SUM 1965	0	0	0	1	1	0	0	0
WIN 1965	0	0	0	1	1	0	0	0
SPR 1966	0	0	0	1	1	0	0	0
SUM 1966	0	0	0	1	1	0	0	0
WIN 1966	0	0	0	1	1	0	0	0
SPR 1967	0	0	0	1	1	0	0	0
SUM 1967	0	0	0	1	1	0	0	0
WIN 1967	0	0	0	1	1	0	0	0
SPR 1968	0	0	0	1	1	0	0	0
SUM 1968	0	0	0	1	1	0	0	0
WIN 1968	0	0	0	1	1	0	0	0
SPR 1969	0	0	0	1	1	0	0	0
SUM 1969	0	0	0	1	1	0	0	0
WIN 1969	0	0	0	1	1	0	0	0
SPR 1970	0	0	0	1	1	0	0	0
SUM 1970	0	0	0	1	1	0	0	0
WIN 1970	0	0	0	1	1	0	0	0
SPR 1971	0	0	0	1	1	0	0	0
SUM 1971	0	0	0	1	1	0	0	0
WIN 1971	0	0	0	1	1	0	0	0
SPR 1972	0	0	0	1	1	0	0	0
SUM 1972	0	0	0	1	1	0	0	0
WIN 1972	0	0	0	1	1	0	0	0
SPR 1973	0	0	0	1	1	0	0	0
SUM 1973	0	0	0	1	1	0	0	0
WIN 1973	0	0	0	1	1	0	0	0
SPR 1974	0	15	15	1	1	0	0	0
SUM 1974	0	15	15	1	1	0	0	0
WIN 1974	0	15	15	1	1	0	0	0
SPR 1975	0	15	15	1	1	0	0	0
SUM 1975	0	15	15	1	1	0	0	0
WIN 1975	0	15	15	1	1	0	0	0
SPR 1976	0	15	15	1	1	0	0	0
SUM 1976	0	15	15	1	1	0	0	0
WIN 1976	0	15	15	1	1	0	0	0
SPR 1977	0	15	15	1	1	0	0	0
SUM 1977	0	15	15	1	1	0	0	0
WIN 1977	0	15	15	1	1	0	0	0
SPR 1978	0	15	15	1	1	0	0	0
SUM 1978	0	15	15	1	1	0	0	0
WIN 1978	0	15	15	1	1	0	0	0
SPR 1979	0	15	15	1	1	0	0	0
SUM 1979	0	15	15	1	1	0	0	0
WIN 1979	0	15	15	1	1	0	0	0
SPR 1980	0	15	15	1	1	0	0	0
SUM 1980	0	15	15	1	1	0	0	0
WIN 1980	0	15	15	1	1	0	0	0
SPR 1981	0	15	15	1	1	0	0	0
SUM 1981	0	15	15	1	1	0	0	0
WIN 1981	0	15	15	1	1	0	0	0
SPR 1982	0	15	15	1	1	0	0	0
SUM 1982	0	15	15	1	1	0	0	0
WIN 1982	0	15	15	1	1	0	0	0
SPR 1983	0	15	15	1	1	0	0	0
SUM 1983	0	15	15	1	1	0	0	0
WIN 1983	0	15	15	1	1	0	0	0
SPR 1984	0	15	15	1	1	0	0	0
SUM 1984	0	15	15	1	1	0	0	0
WIN 1984	0	15	15	1	1	0	0	0
SPR 1985	0	15	15	1	1	0	0	0
SUM 1985	0	15	15	1	1	0	0	0
WIN 1985	0	15	15	1	1	0	0	0
SPR 1986	0	15	15	1	1	0	0	0
SUM 1986	0	15	15	1	1	0	0	0

WIN 1986	0	15	15	1	1	0	0
SPR 1987	0	15	15	1	1	0	0
SUM 1987	0	15	15	1	1	0	0
WIN 1987	0	15	15	1	1	0	0
SPR 1988	0	15	15	1	1	0	0
SUM 1988	0	15	15	1	1	0	0
WIN 1988	0	15	15	1	1	0	0
SPR 1989	0	15	15	1	1	0	0
SUM 1989	0	15	15	1	1	0	0
WIN 1989	0	15	15	1	1	0	0
SPR 1990	0	15	15	1	1	0	0
SUM 1990	0	15	15	1	1	0	0
WIN 1990	0	15	15	1	1	0	0
SPR 1991	0	15	15	1	1	0	0
SUM 1991	0	15	15	1	1	0	0
WIN 1991	0	15	15	1	1	0	0
SPR 1992	0	15	15	1	1	0	0
SUM 1992	0	15	15	1	1	0	0
WIN 1992	0	15	15	1	1	0	0
SPR 1993	0	15	15	1	1	0	0
SUM 1993	0	15	15	1	1	0	0
WIN 1993	0	15	15	1	1	0	0
SPR 1994	0	15	15	1	1	0	0
SUM 1994	0	15	15	1	1	0	0
WIN 1994	0	15	15	1	1	0	0
SPR 1995	0	15	15	1	1	0	0
SUM 1995	0	15	15	1	1	0	0
WIN 1995	0	15	15	1	1	0	0
SPR 1996	0	15	15	1	1	0	0
SUM 1996	0	15	15	1	1	0	0
WIN 1996	0	15	15	1	1	0	0
SPR 1997	0	15	15	1	1	0	0
SUM 1997	0	15	15	1	1	0	0
WIN 1997	0	15	15	1	1	0	0
SPR 1998	0	15	15	1	1	0	0
SUM 1998	0	15	15	1	1	0	0
WIN 1998	0	15	15	1	1	0	0
SPR 1999	0	15	15	1	1	0	0
SUM 1999	0	15	15	1	1	0	0
WIN 1999	0	15	15	1	1	0	0
SPR 2000	0	15	15	1	1	0	0
SUM 2000	0	15	15	1	1	0	0
WIN 2000	0	15	15	1	1	0	0
SPR 2001	0	15	15	1	1	0	0
SUM 2001	0	15	15	1	1	0	0
WIN 2001	0	15	15	1	1	0	0
SPR 2002	0	15	15	1	1	0	0
SUM 2002	0	15	15	1	1	0	0
WIN 2002	0	15	15	1	1	0	0
SPR 2003	0	15	15	1	1	0	0
SUM 2003	0	15	15	1	1	0	0
WIN 2003	0	15	15	1	1	0	0
SPR 2004	0	15	15	1	1	0	0
SUM 2004	0	15	15	1	1	0	0
WIN 2004	0	15	15	1	1	0	0
SPR 2005	0	15	15	1	1	0	0
SUM 2005	0	15	15	1	1	0	0
WIN 2005	0	15	15	1	1	0	0
SPR 2006	0	15	15	1	1	0	0
SUM 2006	0	15	15	1	1	0	0
WIN 2006	0	15	15	1	1	0	0
SPR 2007	0	15	15	1	1	0	0
SUM 2007	0	15	15	1	1	0	0
WIN 2007	0	15	15	1	1	0	0
SPR 2008	0	15	15	1	1	0	0
SUM 2008	0	15	15	1	1	0	0
WIN 2008	0	15	15	1	1	0	0
SPR 2009	0	15	15	0	1	0	0
SUM 2009	0	15	15	0	1	0	0
WIN 2009	0	15	15	0	1	0	0

SPR 2010	0	15	15	0	1	0	0
SUM 2010	0	15	15	0	1	0	0
WIN 2010	0	15	15	0	1	0	0
SPR 2011	0	15	15	0	1	0	0
SUM 2011	0	15	15	0	1	0	0
WIN 2011	0	15	15	0	1	0	0
SPR 2012	0	15	15	0	1	0	0
SUM 2012	0	15	15	0	1	0	0
WIN 2012	0	15	15	0	1	0	0
SPR 2013	0	15	15	0	1	0	0
SUM 2013	0	15	15	0	1	0	0
WIN 2013	0	15	15	0	1	0	0
SPR 2014	0	15	15	0	1	0	0
SUM 2014	0	15	15	0	1	0	0
WIN 2014	0	15	15	0	1	0	0
SPR 2015	0	0	15	0	1	0	0
SUM 2015	0	0	15	0	1	0	0
WIN 2015	0	0	15	0	1	0	0
SPR 2016	0	0	15	0	1	0	0
SUM 2016	0	0	15	0	1	0	0
WIN 2016	0	0	15	0	1	0	0
SPR 2017	17	0	15	0	1	0	0
SUM 2017	17	0	15	0	1	0	0
WIN 2017	17	0	15	0	1	0	0
SPR 2018	0	15	15	0	1	0	0
SUM 2018	0	15	15	0	1	0	0
WIN 2018	0	15	15	0	1	0	0
SPR 2019	0	15	15	0	1	0	0
SUM 2019	0	15	15	0	1	0	0
WIN 2019	0	15	15	0	1	0	0
SPR 2020	0	15	15	1	1	0	0
SUM 2020	0	15	15	1	1	0	0
WIN 2020	0	15	15	1	1	0	0
SPR 2021	0	15	15	1	1	0	0
SUM 2021	0	15	15	1	1	0	0
WIN 2021	0	15	15	1	1	0	0
SPR 2022	0	15	15	1	1	0	0
SUM 2022	0	15	15	1	1	0	0
WIN 2022	0	15	15	1	1	0	0
SPR 2023	0	15	15	1	1	0	0
SUM 2023	0	15	15	1	1	0	0
WIN 2023	0	15	15	1	1	0	0
SPR 2024	0	15	15	1	1	0	0
SUM 2024	0	15	15	1	1	0	0
WIN 2024	0	15	15	1	1	0	0
SPR 2025	0	15	15	1	1	0	0
SUM 2025	0	15	15	1	1	0	0
WIN 2025	0	15	15	1	1	0	0
SPR 2026	0	15	15	1	1	0	0
SUM 2026	0	15	15	1	1	0	0
WIN 2026	0	15	15	1	1	0	0
SPR 2027	0	15	15	1	1	0	0
SUM 2027	0	15	15	1	1	0	0
WIN 2027	0	15	15	1	1	0	0
SPR 2028	0	15	15	1	1	0	0
SUM 2028	0	15	15	1	1	0	0
WIN 2028	0	15	15	1	1	0	0
SPR 2029	0	15	15	1	1	0	0
SUM 2029	0	15	15	1	1	0	0
WIN 2029	0	15	15	1	1	0	0
SPR 2030	0	15	15	1	1	0	0
SUM 2030	0	15	15	1	1	0	0
WIN 2030	0	15	15	1	1	0	0
SPR 2031	0	15	15	1	1	0	0
SUM 2031	0	15	15	1	1	0	0
WIN 2031	0	15	15	1	1	0	0
SPR 2032	0	15	15	1	1	0	0
SUM 2032	0	15	15	1	1	0	0
WIN 2032	0	15	15	1	1	0	0
SPR 2033	0	15	15	1	1	0	0

SUM 2033	0	15	15	1	1	0	0
WIN 2033	0	15	15	1	1	0	0
SPR 2034	0	15	15	1	1	0	0
SUM 2034	0	15	15	1	1	0	0
WIN 2034	0	15	15	1	1	0	0
SPR 2035	0	15	15	1	1	0	0
SUM 2035	0	15	15	1	1	0	0
WIN 2035	0	15	15	1	1	0	0
SPR 2036	0	15	15	1	1	0	0
SUM 2036	0	15	15	1	1	0	0
WIN 2036	0	15	15	1	1	0	0
SPR 2037	0	15	15	1	1	0	0
SUM 2037	0	15	15	1	1	0	0
WIN 2037	0	15	15	1	1	0	0
SPR 2038	0	15	15	1	1	0	0
SUM 2038	0	15	15	1	1	0	0
WIN 2038	0	15	15	1	1	0	0
SPR 2039	0	15	15	1	1	0	0
SUM 2039	0	15	15	1	1	0	0
WIN 2039	0	15	15	1	1	0	0
SPR 2040	0	15	15	1	1	0	0
SUM 2040	0	15	15	1	1	0	0
WIN 2040	0	15	15	1	1	0	0
SPR 2041	0	15	15	1	1	0	0
SUM 2041	0	15	15	1	1	0	0
WIN 2041	0	15	15	1	1	0	0
SPR 2042	0	15	15	1	1	0	0
SUM 2042	0	15	15	1	1	0	0
WIN 2042	0	15	15	1	1	0	0
SPR 2043	0	15	15	1	1	0	0
SUM 2043	0	15	15	1	1	0	0
WIN 2043	0	15	15	1	1	0	0
SPR 2044	0	15	15	1	1	0	0
SUM 2044	0	15	15	1	1	0	0
WIN 2044	0	15	15	1	1	0	0
SPR 2045	0	15	15	1	1	0	0
SUM 2045	0	15	15	1	1	0	0
WIN 2045	0	15	15	1	1	0	0
SPR 2046	0	15	15	1	1	0	0
SUM 2046	0	15	15	1	1	0	0
WIN 2046	0	15	15	1	1	0	0
SPR 2047	0	15	15	1	1	0	0
SUM 2047	0	15	15	1	1	0	0
WIN 2047	0	15	15	1	1	0	0
SPR 2048	0	15	15	1	1	0	0
SUM 2048	0	15	15	1	1	0	0
WIN 2048	0	15	15	1	1	0	0
SPR 2049	0	15	15	1	1	0	0
SUM 2049	0	15	15	1	1	0	0
WIN 2049	0	15	15	1	1	0	0
SPR 2050	0	15	15	1	1	0	0
SUM 2050	0	15	15	1	1	0	0
WIN 2050	0	15	15	1	1	0	0
SPR 2051	0	15	15	1	1	0	0
SUM 2051	0	15	15	1	1	0	0
WIN 2051	0	15	15	1	1	0	0
SPR 2052	0	15	15	1	1	0	0
SUM 2052	0	15	15	1	1	0	0
WIN 2052	0	15	15	1	1	0	0
SPR 2053	0	15	15	1	1	0	0
SUM 2053	0	15	15	1	1	0	0
WIN 2053	0	15	15	1	1	0	0
SPR 2054	0	15	15	1	1	0	0
SUM 2054	0	15	15	1	1	0	0
WIN 2054	0	15	15	1	1	0	0
SPR 2055	0	15	15	1	1	0	0
SUM 2055	0	15	15	1	1	0	0
WIN 2055	0	15	15	1	1	0	0
SPR 2056	0	15	15	1	1	0	0
SUM 2056	0	15	15	1	1	0	0

WIN 2056	0	15	15	1	1	0	0
SPR 2057	0	15	15	1	1	0	0
SUM 2057	0	15	15	1	1	0	0
WIN 2057	0	15	15	1	1	0	0
SPR 2058	0	15	15	1	1	0	0
SUM 2058	0	15	15	1	1	0	0
WIN 2058	0	15	15	1	1	0	0
SPR 2059	0	15	15	1	1	0	0
SUM 2059	0	15	15	1	1	0	0
WIN 2059	0	15	15	1	1	0	0
SPR 2060	0	15	15	1	1	0	0
SUM 2060	0	15	15	1	1	0	0
WIN 2060	0	15	15	1	1	0	0
SPR 2061	0	15	15	1	1	0	0
SUM 2061	0	15	15	1	1	0	0
WIN 2061	0	15	15	1	1	0	0
SPR 2062	0	15	15	1	1	0	0
SUM 2062	0	15	15	1	1	0	0
WIN 2062	0	15	15	1	1	0	0
SPR 2063	0	15	15	1	1	0	0
SUM 2063	0	15	15	1	1	0	0
WIN 2063	0	15	15	1	1	0	0
SPR 2064	0	15	15	1	1	0	0
SUM 2064	0	15	15	1	1	0	0
WIN 2064	0	15	15	1	1	0	0
SPR 2065	0	15	15	1	1	0	0
SUM 2065	0	15	15	1	1	0	0
WIN 2065	0	15	15	1	1	0	0
SPR 2066	0	15	15	1	1	0	0
SUM 2066	0	15	15	1	1	0	0
WIN 2066	0	15	15	1	1	0	0
SPR 2067	0	15	15	1	1	0	0
SUM 2067	0	15	15	1	1	0	0
WIN 2067	0	15	15	1	1	0	0
SPR 2068	0	15	15	1	1	0	0
SUM 2068	0	15	15	1	1	0	0
WIN 2068	0	15	15	1	1	0	0
SPR 2069	0	15	15	1	1	0	0
SUM 2069	0	15	15	1	1	0	0
WIN 2069	0	15	15	1	1	0	0
SPR 2070	0	15	15	1	1	0	0
SUM 2070	0	15	15	1	1	0	0
WIN 2070	0	15	15	1	1	0	0
SPR 2071	0	15	15	1	1	0	0
SUM 2071	0	15	15	1	1	0	0
WIN 2071	0	15	15	1	1	0	0
SPR 2072	0	15	15	1	1	0	0
SUM 2072	0	15	15	1	1	0	0
WIN 2072	0	15	15	1	1	0	0
SPR 2073	0	15	15	1	1	0	0
SUM 2073	0	15	15	1	1	0	0
WIN 2073	0	15	15	1	1	0	0
SPR 2074	0	15	15	1	1	0	0
SUM 2074	0	15	15	1	1	0	0
WIN 2074	0	15	15	1	1	0	0
SPR 2075	0	15	15	1	1	0	0
SUM 2075	0	15	15	1	1	0	0
WIN 2075	0	15	15	1	1	0	0
SPR 2076	0	15	15	1	1	0	0
SUM 2076	0	15	15	1	1	0	0
WIN 2076	0	15	15	1	1	0	0
SPR 2077	0	15	15	1	1	0	0
SUM 2077	0	15	15	1	1	0	0
WIN 2077	0	15	15	1	1	0	0
SPR 2078	0	15	15	1	1	0	0
SUM 2078	0	15	15	1	1	0	0
WIN 2078	0	15	15	1	1	0	0
SPR 2079	0	15	15	1	1	0	0
SUM 2079	0	15	15	1	1	0	0
WIN 2079	0	15	15	1	1	0	0

SPR 2080	0	15	15	1	1	0	0
SUM 2080	0	15	15	1	1	0	0
WIN 2080	0	15	15	1	1	0	0
SPR 2081	0	15	15	1	1	0	0
SUM 2081	0	15	15	1	1	0	0
WIN 2081	0	15	15	1	1	0	0
SPR 2082	0	15	15	1	1	0	0
SUM 2082	0	15	15	1	1	0	0
WIN 2082	0	15	15	1	1	0	0
SPR 2083	0	15	15	1	1	0	0
SUM 2083	0	15	15	1	1	0	0
WIN 2083	0	15	15	1	1	0	0
SPR 2084	0	15	15	1	1	0	0
SUM 2084	0	15	15	1	1	0	0
WIN 2084	0	15	15	1	1	0	0
SPR 2085	0	15	15	1	1	0	0
SUM 2085	0	15	15	1	1	0	0
WIN 2085	0	15	15	1	1	0	0
SPR 2086	0	15	15	1	1	0	0
SUM 2086	0	15	15	1	1	0	0
WIN 2086	0	15	15	1	1	0	0
SPR 2087	0	15	15	1	1	0	0
SUM 2087	0	15	15	1	1	0	0
WIN 2087	0	15	15	1	1	0	0
SPR 2088	0	15	15	1	1	0	0
SUM 2088	0	15	15	1	1	0	0
WIN 2088	0	15	15	1	1	0	0
SPR 2089	0	15	15	1	1	0	0
SUM 2089	0	15	15	1	1	0	0
WIN 2089	0	15	15	1	1	0	0
SPR 2090	0	15	15	1	1	0	0
SUM 2090	0	15	15	1	1	0	0
WIN 2090	0	15	15	1	1	0	0
SPR 2091	0	15	15	1	1	0	0
SUM 2091	0	15	15	1	1	0	0
WIN 2091	0	15	15	1	1	0	0
SPR 2092	0	15	15	1	1	0	0
SUM 2092	0	15	15	1	1	0	0
WIN 2092	0	15	15	1	1	0	0
SPR 2093	0	15	15	1	1	0	0
SUM 2093	0	15	15	1	1	0	0
WIN 2093	0	15	15	1	1	0	0
SPR 2094	0	15	15	1	1	0	0
SUM 2094	0	15	15	1	1	0	0
WIN 2094	0	15	15	1	1	0	0
SPR 2095	0	15	15	1	1	0	0
SUM 2095	0	15	15	1	1	0	0
WIN 2095	0	15	15	1	1	0	0
SPR 2096	0	15	15	1	1	0	0
SUM 2096	0	15	15	1	1	0	0
WIN 2096	0	15	15	1	1	0	0
SPR 2097	0	15	15	1	1	0	0
SUM 2097	0	15	15	1	1	0	0
WIN 2097	0	15	15	1	1	0	0
SPR 2098	0	15	15	1	1	0	0
SUM 2098	0	15	15	1	1	0	0
WIN 2098	0	15	15	1	1	0	0
SPR 2099	0	15	15	1	1	0	0
SUM 2099	0	15	15	1	1	0	0
WIN 2099	0	15	15	1	1	0	0
SPR 2100	0	15	15	1	1	0	0
SUM 2100	0	15	15	1	1	0	0
WIN 2100	0	15	15	1	1	0	0
SPR 2101	0	15	15	1	1	0	0
SUM 2101	0	15	15	1	1	0	0
WIN 2101	0	15	15	1	1	0	0

	Water Right No.	Rented Vol (AF)	Lessor Fee (90%)	Administrative Fee (10%)	Total Fee @ \$17 (2016)	Rental Amounts			
						Rate	Acres		
	Pocock Family 2017								
1st run	22-13440	107.5	\$1,644.75	\$182.75	\$1,827.50	0.45	30.70	2017-2020	HG = 3.5 SOU 4/1-10/31
1st run	35-7777	32.8	\$501.84	\$55.76	\$557.60	0.14	8.20	2006-2020	rent 1 yr
1st run	35-13855	20.0	\$306.00	\$34.00	\$340.00	0.06	4.00	2015-2019	
2nd run	35-2924	4.5	\$68.85	\$7.65	\$76.50	0.02	1.10	2009-2019	
2nd run	31-7128	64.1	\$980.73	\$108.97	\$1,089.70	0.20	13.00	2015-2017	
	Total	228.9	\$3,502.17	\$389.13	\$3,891.30	0.87	57.00		
	calculated by Michele Etl						142.50	CU volume needed	sufficient for the grain crop already planted
							40.71		
							0.00	acres still needed	64/192
									70/130
	35-7777	rate	volume	acre	af/ac	cfs/ac	timester vol	comment	
	decreed	1.77	416	104	4.00	0.0170			
	leased	1.77	416	104	4.00	0.0170			
	Sanders rental	0.16	38	9.5	4	0.0168			
	remaining	1.61	378	94.5	4	0.0170			
	L Funk rental1	0.81	190	47.5	4	0.0171			
	L Funk rental2	0.66	155.2	38.8	4.00	0.0170			
	Pocock rental	0.14	32.8	8.2	4.00	0.0171	10.9333		
	Pocock use	0.14	28.7	8.2	3.50	0.0171	9.5667		
	22-13440	rate	volume	acre	af/ac	cfs/ac	timester vol	comment	
	decreed	8.09	1939	554	3.50	0.01460			62/183
	leased	0.53	126	36	3.50	0.01472			
	Iona Cemetery	0.08	18.5	5.3	3.49	0.01509			
	remaining	0.45	107.5	30.7	3.50	0.01466	35.8333		
	Pocock rental	0.45	107.5	30.7	3.50	0.01466			
	35-13855 Ariva	rate	volume	acre	af/ac	cfs/ac	timester vol	comment	
	leased irrigation	0.06	20	5	4.00	0.012		HG = 4.0	58/148
	Pocock rental	0.06	20	5	4.00	0.012	6.5667		
	Pocock use	0.06	14	4	3.50	0.015	4.5667		
	35-2924	rate	volume	acre	af/ac	cfs/ac	timester vol	comment	
	leased	1.11	241	60.3	3.997	0.0184		HG = 4.0 2009-2019	61/164
	Gunderson request	1.11	206.5	59	3.5	0.0188		HG = 3.5 SOU 4/1-10/31	
	Gunderson actual use	1.09	206.5	59	3.5	0.0185			
	proportional to lease	1.09	235.8	59	3.997	0.0185			
	usable remaining	0.02	4.5	1.1	4.091	0.0182	1.5000		
	Pocock use	0.02	3.85	1.1	3.5	0.0182	1.2833		
	31-7128	rate	volume	acre	af/ac	cfs/ac	timester vol	comment	
	decreed total domg.com	0.2	64.1	18.1	3.541	0.0110		201516-2017	33/173
	leased (needs correction)	0.22	64.1	18.1	3.541	0.0122		HG=3.5	
	Pocock rental	0.2	64.1	13.3	4.820	0.0150		Q per ac concentrated for pivot	
	Pocock use	0.195	64.1	13	4.931	0.0150	21.3667		
	Pocock use	0.2	45.5	13	3.500	0.0154	15.1667		

Edl, Michele

From: Cefalo, James
Sent: Wednesday, May 24, 2017 9:37 AM
To: Edl, Michele; Holliday, Michael; Jordan, Blake
Subject: RE: Idahoan Foods 31-7128 and 31-7489
Attachments: WMIS300724.pdf

Michele,

It is my understanding that WSB rentals applications are evaluated under the same criteria as transfer applications. A WSB rental proposing to change the nature of use of a water right can only be approved if the change does not result in an enlargement of the water right. The Department may consider historical consumptive use, as defined in Section 42-202B, as a factor in determining whether a change would result in an enlargement.

Water rights 31-7128 and 31-7489 authorize a combined annual diversion volume of 739.5 af for commercial use at a potato processing plant. WMIS records from Water District 110, show the plant exceeded its water right volume in 5 of the last 20 years.

Documents in the backfile for water right 31-7128 suggest the waste water from the plant had always been land applied through irrigation systems. Pump cards provided to WD110 in 2000 confirm that commercial water was diverted and used at a constant rate throughout the entire year. A 2006 Wastewater Land Application Permit issued by IDEQ authorizes land application of wastewater during the non-irrigation season. The consumptive use during this time period would be greatly reduced. Assuming the full authorized diversion volume and 7 months of consumptive use (April-October), the volume available for a new nature of use would be 431.4 af ($739.5 \times 7/12 = 431.4$). At 3.5 af/acre, this volume of water could support about 123 acres.

Water rights 31-7128 and 31-7489 authorize a combined total diversion rate of 1.20 cfs for commercial use. Assuming a diversion rate of 0.015 cf/acre, these rights could support 80 acres of irrigation. I don't know the requested rate per acre, so this value may change.

It is clear that the WSB rental acres will be limited by the available diversion rate, not the volume. The historical consumptive use under the water rights exceeds the expected demand of the available rental acres. Even if the analysis were limited to the historical use over the last 10 years, the WSB rental would still be limited by rate, rather than volume. Taking the diversion volume from 2008 (514.3 af) and performing the same analysis described above results in 300 af available for rental. At 3.5 af/acre, this volume could support about 86 acres.

I hope this helps.

James

From: Edl, Michele
Sent: Tuesday, May 23, 2017 9:52 AM
To: Cefalo, James <James.Cefalo@idwr.idaho.gov>; Holliday, Michael <Michael.Holliday@idwr.idaho.gov>; Jordan, Blake <Blake.Jordan@idwr.idaho.gov>
Subject: Idahoan Foods 31-7128 and 31-7489

Gents,

I have been asked to evaluate the above rights for use as irrigation in rentals to Dave Sanders and Ray Pocock for 2017. The rights were commercial use in a potato processing facility, then cascaded into wastewater application. So the rights could be considered fully consumptive. But both rights have a WD8 condition which states "Water diverted

under this approval shall not be used for irrigation unless the water is first used at the commercial facility as authorized by this water right. "

Kristin Moore understood that the rights could be and have been used in irrigation rentals; that the idea of the condition was to restrict the rights from becoming irrigation rights at the identified location.

I haven't been able to locate a memo in the backfile which addresses that point. And I need to know the story before I work through the 2nd round of rental applications for these two families. You three are likely to know more so please share

Thank you

Michele Edl

208-287-4946