

STATE OF IDAHO
DEPARTMENT OF WATER RESOURCES

WATER SUPPLY BANK RENTAL AGREEMENT NO. 218

RECEIVED

MAR 09 2018

DEPARTMENT OF
WATER RESOURCES

This is to certify that:

THE RALPH R & BETH POCOCK FAMILY LTD PARTNERSHIP
2964 N 5000 E
SUGAR CITY, ID 83448

filed an application to rent water from the Water Supply Bank ("Bank"). The Idaho Water Resource Board ("Board"), being authorized to operate a Bank and to contract by and through the Director of the Idaho Department of Water Resources ("Director, Department") for rental of water from the Bank, agrees to rent water as follows:

Summary of Water Rights or Portions Rented from the Bank

Water Right No.	Priority Date	Source	Diversion Rate (CFS)	Diversion Volume (AF)	Acres (AC)	Rate Per Acre (CFS/AC)	Volume Per Acre (AF/AC)
22-13440	10/26/1965	GROUND WATER	0.42	100.80	28.80	0.015	3.50
Combined Rental Totals			0.42	100.80	28.80	0.015	3.50

Term of Rental: This rental shall take effect when all parties have signed it and shall continue in effect until December 31, 2020.

Annual Rental Fee:

2018 - 2020: \$2,016.00

The full fee for the rental of the above-described right(s) is \$2,016.00 per year for years 2018 - 2020. The rental fee includes an administrative fee of \$201.60 per year for years 2018 - 2020.

An annual payment shall be received by the Department on or before December 31 each year preceding the use of the rented water rights. The agreement will be void if payment is not received by the due date in a given year. Rental fees are non-refundable. To voluntarily terminate the agreement early, notify the Department in writing prior to the rental fee due date.

Detailed water right conditions are attached.

STATE OF IDAHO
DEPARTMENT OF WATER RESOURCES
WATER SUPPLY BANK RENTAL AGREEMENT NO. 218

RECEIVED
MAR 09 2018
DEPARTMENT OF
WATER RESOURCES

The undersigned renter agrees to use the water rented under this agreement in accordance with the Water Supply Bank rules and in compliance with the limitations and conditions of use described in this agreement:

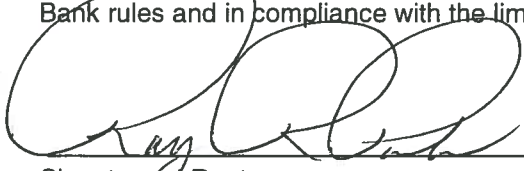
Signature of Renter

3-7-2018
Date

Ray R Pocock
Printed Name

~~Secretary~~ President
Title

*Title required if signing on behalf of a company or organization or with power of attorney

Having determined that this agreement satisfied the provisions of Idaho Code § 42-1763 and IDAPA 37.02.03.030 (Water Supply Bank Rule 30), for the rental and use of water under the terms and condition herein provided, and none other, I hereby execute this Rental Agreement on behalf of the Idaho Water Resource Board.

By 
BRIAN PATTON, Acting Administrator
Idaho Water Resource Board

Date 3/12/2018

Rental approved by IDWR 

Date 3-12-2018

WATER SUPPLY BANK RENTAL AGREEMENT NO. 218

WATER USE DETAILS

LOCATION OF POINT(S) OF DIVERSION

GROUND WATER	NESW	Sec. 24, Twp 06N, Rge 41E,	MADISON County
GROUND WATER	NENW	Sec. 25, Twp 06N, Rge 41E,	MADISON County

Beneficial Use	Diversion Rate	Volume
IRRIGATION	0.42 CFS	100.80 AF

BENEFICIAL USE & SEASON OF USE

Water Right No.	From	To
22-13440	4/1	10/31

RENTERS PLACE OF USE: IRRIGATION

Twp	Rng	Sec	NE				NW				SW				SE				Totals
			NE	NW	SW	SE	NE	NW	SW	SE	NE	NW	SW	SE	NE	NW	SW	SE	
06N	41E	24					3.0	3.7	0.4	3.0	2.9	2.6	2.8	2.9	2.6	2.2	2.7	28.8	

Total Acres: 28.8

RENTAL AGREEMENT CONDITIONS OF ACCEPTANCE

1. The use of water under this agreement shall be subject to the provisions of Idaho Code § 42-1766.
2. Rental of the specified right from the bank does not, in itself, confirm the validity of the right or any elements of the water right, or improve the status of the right including the notion of resumption of use. It does not preclude the opportunity for review of the validity of this water right in any other department application process.
3. Use of water under this agreement shall not prejudice any action of the Department in its consideration of an application for transfer or permit filed by the applicant for this same use.
4. Renter agrees to comply with all applicable state and federal laws while using water under this agreement.
5. Renter agrees to hold the Board, the Director and the state of Idaho harmless from all liability on account of negligent acts of the renter while using water.
6. Renter acknowledges and agrees that the Director may terminate authorization for the use of a water right based on a water right's priority date. This rental for mitigation by non use may be ineffective if the mitigating water right is not in priority.
7. Failure of the renter to comply with the conditions of this agreement is cause for the Director to rescind approval of the rental agreement.
8. This rental agreement does not authorize the construction of a well.
9. Prior to diversion and use of water under this approval, the right holder shall install and maintain acceptable measuring device(s) at the authorized point(s) of diversion, in accordance with Department specifications.
10. Upon specific notification of the Department, the right holder shall install and maintain data loggers to record water usage information at the authorized point(s) of diversion in accordance with Department specifications.

WATER SUPPLY BANK RENTAL AGREEMENT NO. 218

WATER USE DETAILS

11. A lockable device subject to the approval of the Department shall be maintained on the diverting works in a manner that will provide the watermaster suitable control of the diversion.
12. Use of water under this right will be regulated by a watermaster with responsibility for the distribution of water among appropriators within a water district. At the time of this approval, this water right is within State Water District No. 100.
13. A map depicting the place of use boundary for this water right at the time of this approval is attached to this document for illustrative purposes.



Idaho Water Resource Board

Attachment to Water Supply Bank Rental Agreement No. 218

Effective until December 31, 2020

This map depicts the **rental place of use** pursuant to the rental agreement and is attached to the agreement solely for illustrative purposes.

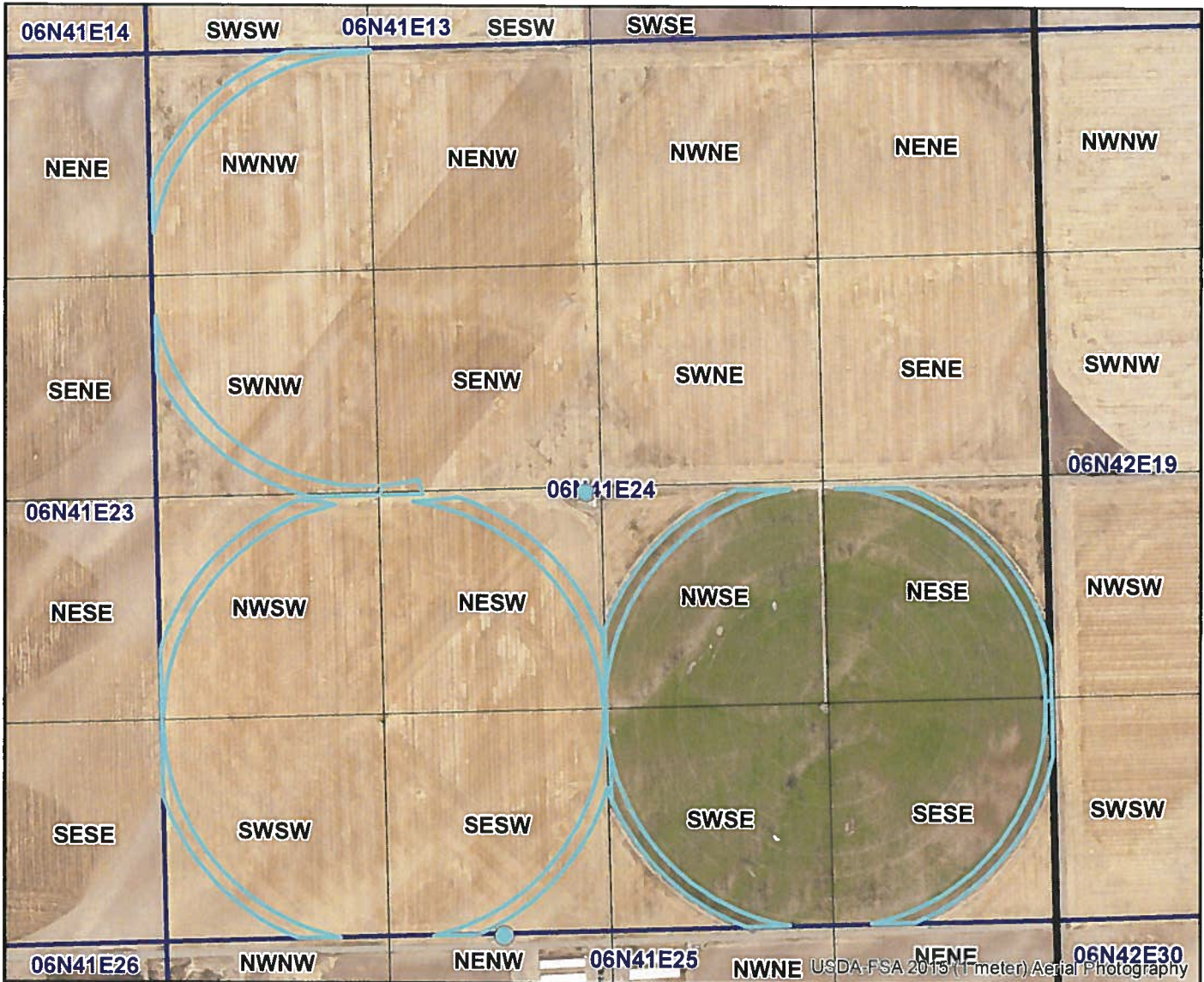

- Authorized Rental Point of Diversion
- Authorized Rental Place of Use
- Townships
- PLS Sections
- Quarter Quarters

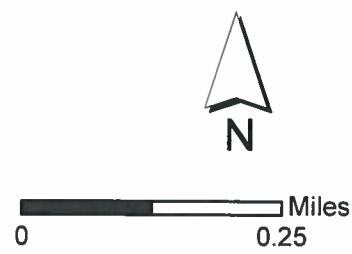

STATE OF IDAHO
WATER RESOURCE BOARD

RECEIVED

JAN 08 2018

DEPARTMENT OF
WATER RESOURCES

APPLICATION TO RENT WATER
FROM THE BOARD'S WATER SUPPLY BANK

Applicant Name: The Ralph R. and Beth Pocock Family Limited Partnership

Is this application being submitted with a lease application as a lease/rental package? Yes No

If yes, specify companion water rights in Section 4

This application must be completed according to the minimum requirement checklist below. This checklist is part of the rental application and must be included with the rental application. **Applications that do not meet the minimum requirements will not be placed in the processing queue and may be returned until all minimum requirements have been met.**

Rental applications should be submitted well in advance of the desired start date for the use of rental water. Rental applications may be processed as early as November 1 of the year prior to the intended use of rental water. Any rental application received on or before November 1 for use in the next year will be assigned a received date of November 1. Rental applications submitted more than one year in advance of the proposed start date for the use of rental water will not be accepted and will be returned to applicants. Rental applications may be returned to applicants if the desired start date for the use of rental water cannot be accommodated by the Water Supply Bank. Rental requests will not be accepted once the rental season of use period has concluded.

One rental application per beneficial use of water. For multiple beneficial uses of water, separate rental requests should be submitted for each unique beneficial use of water. One rental application can be submitted if you propose to rent water from multiple sources.

For additional instructions on completing a rental application, visit the Bank's website at http://idwr.idaho.gov/water_supply_bank.

MINIMUM REQUIREMENT CHECKLIST		
Check All Items as Either Attached (Yes) or Not Applicable (N/A)		
	Yes	
	<input checked="" type="checkbox"/>	Completed <i>Application to Rent Water from the Board's Water Supply Bank</i>
	<input checked="" type="checkbox"/>	Confirmation that this form has been printed single sided, per requirement of the Water Supply Bank
Attachment	N/A	Yes
2	<input checked="" type="checkbox"/>	A map showing the proposed point(s) of diversion, place(s) of use, and water diversion and distribution systems proposed to be used with your rental request
3A	<input type="checkbox"/>	<input type="checkbox"/> Detailed information on a proposed use of rental water
3F	<input type="checkbox"/>	<input type="checkbox"/> Authorization from the owner/operator of the rental point(s) of diversion
3H	<input type="checkbox"/>	<input checked="" type="checkbox"/> Water modeling to account for the impacts of the rental request
3J	<input type="checkbox"/>	<input type="checkbox"/> Documents justifying a rate of flow greater than 0.02 cfs/acre
3K	<input type="checkbox"/>	<input type="checkbox"/> Authorization from the owner/operator of the property at the proposed rental place(s) of use
4B	<input type="checkbox"/>	<input type="checkbox"/> Explanation of how the rental water will sufficiently accomplish your rental purposes
4C	<input type="checkbox"/>	<input type="checkbox"/> Explanation of consumptive use amounts for water rights experiencing a change in nature of use

Department Use Only – Proposed Water Right(s)
22-13440

981

STATE OF IDAHO
WATER RESOURCE BOARD

Application to Rent Water (Continued)

1. CONTACT INFORMATION

A. Applicant The Ralph R. and Beth Pocock Family Limited Partnership

Mailing Address	<u>2964 N 5000 E</u>	Sugar City	ID	<u>83448</u>
	Street	City	State	Zip Code

Email Address _____ Phone Number _____

B. Is this application being completed by an authorized representative on behalf of the applicant? Yes No
 If yes, representatives (includes company employees if the applicant is a corporation, as well as legal counsel or consultants) should provide their information below if they desire to be included on correspondence with the rental applicant.

Representative Kristin Moore Professional Title Sen. Water Right Analyst

Organization Rocky Mtn Environmental Assoc. Relationship to Applicant Consultant

Mailing Address 482 Constitution Way Ste 303, Idaho Falls, ID 83402

Email Address kristin.rmea@gmail.com Phone Number 208-524-2353

2. MAP

Create a map of the proposed point(s) of diversion, place(s) of use and water diversion, delivery and distribution systems. Make sure the rental place of use is outlined and annotated with legal land descriptions (Township, Range, Section and Quarter-Quarters) or with GPS coordinates. For irrigation purposes, mark the number of acres you desire to irrigate. Attach the map to this application and label it **Attachment 2**.

3. DESCRIPTION OF PROPOSED USE FOR RENTAL WATER

A. Describe why you desire to rent water and provide a detailed description of your proposed use. If the proposed use is not for irrigation, describe in detail how you determined the amount of rental water required. If the space below is insufficient, attach additional sheets as required and label them **Attachment 3A**:

This is for the irrigation of end guns on 2 1/2 of 4 center pivots in 06N 41E 24. The pivots are covered under existing water rights which do not cover the end guns. The water will be diverted from the same Points of Diversion as the existing water rights. Another application will pursue additional acres for the other 1 1/2 pivots.

B. Enter the desired and/or minimum rates of flow, volume, or irrigable acres requested for your rental purposes:

Desired Rate (Cubic Feet/Second)	Desired Volume (Acre-Foot)	Minimum Rate* (Cubic Feet/Second)	Minimum Volume* (Acre-Foot)	Desired Acres (if applicable)
0.58 CFS	100.8 AF	0.43 CFS	49 AF	28.8 AC

* Sometimes water rights provide an exceptionally low rate per acre and/or low volume per acre. This section is meant to establish an acceptable range of water sufficient for your proposed water use. Please see question 4B and complete if necessary.

C. This section must be completed in full. Enter the proposed start date and latest possible start date for using rental water as well as the number of years you would like to rent water. The latest possible start is the latest possible date by which you would be willing to pay for a rental and be able to benefit from utilizing rental water.

Desired Start Date (month/day/year)	Latest Possible Start Date (month/day/year)	*Mark Desired Rental Duration (Calendar Years)					**Applicant's preference if rental application cannot be processed prior to the latest possible start?	
4/15/2018	6/1/2018	<input type="checkbox"/>	<input type="checkbox"/>	<input checked="" type="checkbox"/>	<input type="checkbox"/>	<input type="checkbox"/>	<input checked="" type="checkbox"/> Process application as soon as possible	<input type="checkbox"/> Return application to applicant

* The number of years permissible for a rental is subject to the lease contract duration for the water right(s) being rented.
 ** Per Idaho Code 42-201, it is unlawful to divert or use water without a valid water right. Water Supply Bank rental applicants are not authorized to utilize rental water prior to the execution of an approved rental agreement. Rental requests may be returned to applicants if no water is available from the Bank to fulfill a rental request.

STATE OF IDAHO
WATER RESOURCE BOARD

Application to Rent Water (Continued)

D. Describe your water distribution system and how rental water will be delivered from the point(s) of diversion (POD) to the proposed place of use (POU):
Wells with pumps deliver water to mainlines, which convey water to center pivots. If the rental is approved, end gun valves and booster pumps will be turned on to irrigate the proposed POU.

E. Describe the physical type (pump, headgate, etc.) and location of the POD from which rental water is proposed to be diverted:

POD Description	Water Source	Other Water Rights Diverted from this POD
Two Wells		Both Wells Share with the Following WR:
T6N R41E SEC 24 NESW	Ground Water	22-7167A, 22-7052A, 22-2271D, 22-7439
T6N R41E SEC 24 SESW	Ground Water	22-14082, 22-14083, 22-14084

If the POD(s) above are located where water is turned into a canal, lateral or ditch, or if they are located on your property but are serviced by water that is delivered via a canal, lateral or ditch, your rental request must include documented authorization from all relevant canal companies, irrigation districts and/or water delivery entities, confirming that they consent to your diversion of water from their system.

F. Has documented consent from all relevant water delivery entities been obtained? Yes N/A
 If yes, include documented consent as Attachment 3F.

G. Do any POD(s) identified in Question 3E divert from a water source that may require water modeling? Yes No
Refer to the Water Modeling Requirements Information Sheet to determine if a rental POD may require water modeling.

H. Has water modeling been provided with your rental request? Yes N/A
 If yes, label modeling Attachment 3 H.
Rental applications that require modeling will be returned if modeling is not provided.

I. Specify the desired beneficial use of water and the requested season of use or number of acres required:
 Irrigation 28.8 (number of acres) Duration: Subject to IDWR standard seasons of use
 Commercial from: _____ (mm/dd) to: _____ (mm/dd)
 Stockwater from: _____ (mm/dd) to: _____ (mm/dd)
 Industrial from: _____ (mm/dd) to: _____ (mm/dd)
 Other: _____ from: _____ (mm/dd) to: _____ (mm/dd)

J. For irrigation uses, do you propose to divert water at a rate greater than 0.02 cfs/acre? N/A Yes No
 If yes, justify the rate of flow and attach any supporting documents as Attachment 3J. Justification may include information on soil composition, conveyance losses, crop type, irrigation systems, public access areas, etc. A rate of 0.03 cfs/acre is permissible for irrigation of 5 acres or less.

K. Do you own the land at the proposed rental place of use (POU)? Yes No
 If no, attach documentation from the POU owner/operator confirming your authorization to use the POU and label it Attachment 3K.

L. List all other water rights and sources of water at the rental place of use for the same purpose, including privately owned water rights and water received from a municipal supplier, an irrigation district, a canal company or any other water delivery entity. Explain why additional water is required:
Other Ground Water Rights that cover the center pivots, but not the end guns: 22-7167A, 22-7052A, 22-2271D, 22-7439, 22-14082, 22-14083, 22-14084

STATE OF IDAHO
WATER RESOURCE BOARD

Application to Rent Water (Continued)

4. RENTAL REQUESTS FOR SPECIFIC WATER RIGHTS

A. Are you requesting to rent specific water rights? Yes No

If yes, specify below the elements of the water rights you are requesting to rent. If no, continue to Question 4B.

Important Information: Diversion rates and volumes sought for rent must be proportionate to the per acre diversion rates and per acre volume limits of the water right under lease contract to the Water Supply Bank. Prior to completing this section, applicants should review all water right lease contracts and any active rental agreements to determine which elements of a water right are available to satisfy a rental request. Lease and rental documents are searchable via [IDWR's website](#).

Water rights identified below must either already be leased to the Bank or a lease proposal should accompany this rental request. **Rental requests for water rights not yet leased to the Bank will be returned if companion lease applications are not provided with the rental request.** For leased rights featuring combined limits, rentals must be consistent with combined diversion rate, volume or acre limits. Combined limits should be listed on a row below water right numbers.

Water Right Elements Leased to Water Supply Bank					Leased totals, minus water right elements involved in active rental agreements, equals water right elements available for rent	Water Supply Bank Rental Request		
Water Right Number (leave blank if sub-total of combined limits)	Nature of Use	Diversion Rate (CFS)	Volume (AF)	Acres (AC)		Diversion Rate (CFS)	Volume (AF)	Acres (AC)
22-13440	Irrigation	0.53	126	36		0.42	100.8	28.8
Applicants must ensure the requested rate per acre and volume per acre do not exceed the rate per acre and volume per acre limits of water rights leased to the Water Supply Bank					TOTAL	0.42	100.8	28.8
						CFS	AF	AC

**Attach multiple copies of this page if space above is insufficient to list all water rights requested to be rented on this application.*

B. If water right conditions, combined limits, or the sum of all water right elements being requested provide an unconventional duty of water (e.g., an unusually low rate per acre or volume per acre for irrigation use), explain how your proposed rental will sufficiently accomplish your intended purposes. Attach a separate page if space is insufficient and label it **Attachment 4B**:

N/A

C. Does your rental request propose to change the nature of use for any water right(s) being rented? Yes No

If yes, explain how the water right(s) will be converted to new uses. Include the historic, consumptive use amounts for the water right being rented if you have it, as well as the new consumptive use amount for your proposed beneficial use. If space below is insufficient, attach a separate page and label it **Attachment 4C**:

STATE OF IDAHO
WATER RESOURCE BOARD

Application to Rent Water (Continued)

5. ADDITIONAL INFORMATION

A. Is this the first time that rental water is being requested for this purpose at the rental place of use? Yes No

If no, list previous rental requests/agreements and explain why you have not secured a permanent water right for your needs:
Applicant has secured water rights for a portion of the pivots, but have not yet secured enough to cover the end guns. Most recent rental agreement was from 2017.

B. Have you or do you intend to submit an application for permit or transfer proposing a similar use as this rental? Yes No
If yes, describe:

C. Was this rental application submitted in response to a Notice of Violation (NOV) or a pending NOV? Yes No
If yes, describe the date and location of the NOV.

D. Additional Information
Two applications for rental are being submitted. This rental proposes to contract enough water to cover about half of the applicants needs for 3 years. The companion rental proposes to contract enough water to cover the remaining acreage, but the rights are only available for 1 year.

DECLARATION

I hereby assert that the information contained in this application is true to the best of my knowledge. I understand that any willful misrepresentations made in this application may result in rejection of the application or cancellation of an approval. I understand that if this rental application is approved, it will be subject to the provisions of Section 42-1766, Idaho Code and all applicable state and federal laws. I understand that the submission of a rental application provides no guarantee for approval of a rental agreement. I also understand that, per Idaho Code 42-201, it is unlawful to divert or use water without a valid water right and that I am not authorized to utilize water as proposed in this application prior to the execution of an approved rental agreement.

Signature of Applicant

Ray Pocock
Printed Name of Applicant

1-5-2018
Date

Signature of Representative

Printed Name of Representative





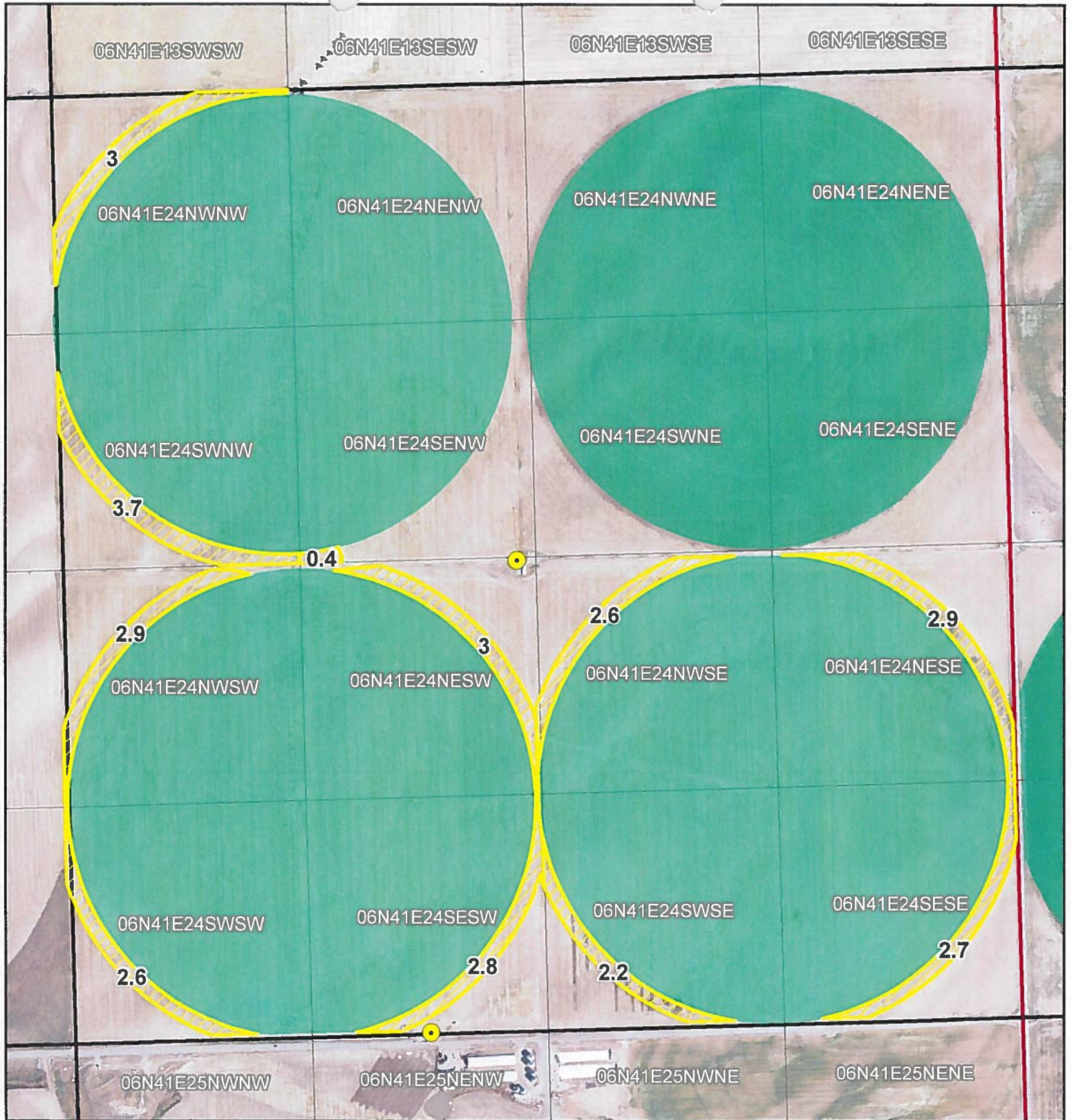

Date

Mail to:
Idaho Department of Water Resources
P.O. Box 83720
Boise, ID 83720-0098



2015 Aerial Photography

Legend

-  Proposed POD
-  WSB 2018 3 yr Rental
-  Existing WR POU
-  Twp & Rng
-  Section
-  QQ

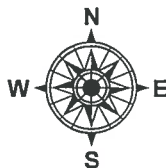

WSB Rental Application

The Ralph R and Beth Pocock Family Ltd Partnership

RMEA #13-0070

by: KM

Date: 1/4/2018



Eastern Snake Plain Aquifer Modeling Analysis and Narrative

WSB Rental Application for WR#22-13440

The Ralph R and Beth Pocock Family Limited Partnership

The Applicant requires an additional 56.6 acres at the proposed place of use to irrigate acres under end guns of 4 center pivots. As there are no water rights available in the Water Supply Bank that can provide that quantity of water for more than one year, the applicant proposes to submit two applications. The first application proposes to rent water from water right 22-13440 from 2018-2020 that will cover 28.8 acres under the end guns, for about 2 ½ pivots of the total 4 pivots. The companion application proposes to rent water from water right nos. 35-13855, 35-13993, and 35-13995 for the 2018 season that will cover the remaining acres required.

Proposed Irrigated Crops

Applicant irrigates *Potatoes – cold pack*¹ and *Spring Grain – irrigated* in rotation on the proposed place of use. The consumptive irrigation requirement for potatoes is 1.44 af/ac and grain is 1.7 af/ac. For the purposes of modeling, the higher consumptive volume is used.

Data Input Values

Consumptive use values for each well were used for input volumes. The FROM well was based on the standard consumptive irrigation value of 2.5 af/acre. This value is approximately the consumptive use of alfalfa in the area of the FROM well location. For the TO well input volume, the consumptive irrigation requirement of 1.7 af/acre was used. The table below gives a summary of input values. See Figure 1 for excerpts of the Data Input page.

Application #1	acres	WELL INFO			MODELING QUANTITIES			RENTAL QUANTITIES		
		Priority	Row	Col	CU AF/ac	CU AFA	CU AF/tri	acres	cfs	AFA
TO Well	28.8		64	192	1.7	48.96	16.32	28.8	0.42	100.8
FROM 1	28.8	19651026	62	183	2.5	72	24.0	28.8	0.42	100.8

Results

Using ESPAM 2.1 to simulate the depletions of transferring 28.8 acres to the proposed place of use, the affects do not exceed the threshold of 2.0 af/trimester. No mitigation is required.

¹ Values taken from the Rexburg – AgriMet Station. Allen, Richard G. and Clarence W. Robison, 2012. **Evapotranspiration and Consumptive Irrigation Water Requirements for Idaho: Supplement updating the Time Series through December 2008**, Research Technical Completion Report, Kimberly Research and Extension Center, University of Idaho, Moscow, ID

Figures 2-3 include excerpts from the ESPAM 2.1 simulation.

Figure 1. Data Entry

ENHANCED GROUND-WATER RIGHTS TRANS

UNIVERSITY OF IDAHO - IDAHO WATER RESOURCES RESEARCH INSTITUTE IDAHO DEPA

Cells this color are set up for user entries

UPDATE DATES

RUN MODEL

GET OUTPUT

CALCULATE EFFECTS

ENTER STARTING DATE FOR SIMULATION. THEN PUSH "UPDATE DATES" BUTTO

TRANSFER NO: 22-13440

YEAR: 1965 TRANSFER NAME: Pocock

SEASON: SUMMER

ENTER CELL LOCATIONS:

	'TO' CELL	'FROM1' CELL	'FROM2' CELL	'FROM3' CELL
ROW	64	62	0	0
COLUMN	192	183	0	0

33.4

TRIMESTER OF ACTIVITY	TO WELL		FROM1 WELL		FROM2 WELL		FROM3 WELL	
	Projected Use AF/TRIMESTER	With Transfer AF/TRIMESTER	Without Transfer AF/TRIMESTER	With Transfer AF/TRIMESTER	Without Transfer AF/TRIMESTER	With Transfer AF/TRIMESTER	Without Transfer AF/TRIMESTER	
SUM 1965	0	24	24	0	0	0	0	
WIN 1965	0	24	24	0	0	0	0	
SPR 1966	0	24	24	0	0	0	0	
SUM 1966	0	24	24	0	0	0	0	
WIN 1966	0	24	24	0	0	0	0	
SPR 1967	0	24	24	0	0	0	0	
SUM 1967	0	24	24	0	0	0	0	
WIN 1967	0	24	24	0	0	0	0	
SPR 2018	0	24	24	0	0	0	0	
SUM 2018	0	24	24	0	0	0	0	
WIN 2018	0	24	24	0	0	0	0	
SPR 2017	0	24	24	0	0	0	0	
SUM 2017	0	24	24	0	0	0	0	
WIN 2017	0	24	24	0	0	0	0	
SPR 2018	16	0	24	0	0	0	0	
SUM 2018	16	0	24	0	0	0	0	
WIN 2018	16	0	24	0	0	0	0	
SPR 2019	16	0	24	0	0	0	0	
SUM 2019	16	0	24	0	0	0	0	
WIN 2019	16	0	24	0	0	0	0	
SPR 2020	16	0	24	0	0	0	0	
SUM 2020	16	0	24	0	0	0	0	
WIN 2020	16	0	24	0	0	0	0	
SPR 2021	0	24	24	0	0	0	0	
SUM 2021	0	24	24	0	0	0	0	
WIN 2021	0	24	24	0	0	0	0	
SPR 2022	0	24	24	0	0	0	0	
SUM 2022	0	24	24	0	0	0	0	
WIN 2022	0	24	24	0	0	0	0	
SPR 2023	0	24	24	0	0	0	0	
SUM 2023	0	24	24	0	0	0	0	
WIN 2023	0	24	24	0	0	0	0	
SPR 2112	0	24	24	0	0	0	0	
SUM 2112	0	24	24	0	0	0	0	
WIN 2112	0	24	24	0	0	0	0	
SPR 2113	0	24	24	0	0	0	0	
SUM 2113	0	24	24	0	0	0	0	
WIN 2113	0	24	24	0	0	0	0	
SPR 2114	0	24	24	0	0	0	0	
SUM 2114	0	24	24	0	0	0	0	
WIN 2114	0	24	24	0	0	0	0	
SPR 2115	0	24	24	0	0	0	0	

Figure 2. Net Transfer Graphs

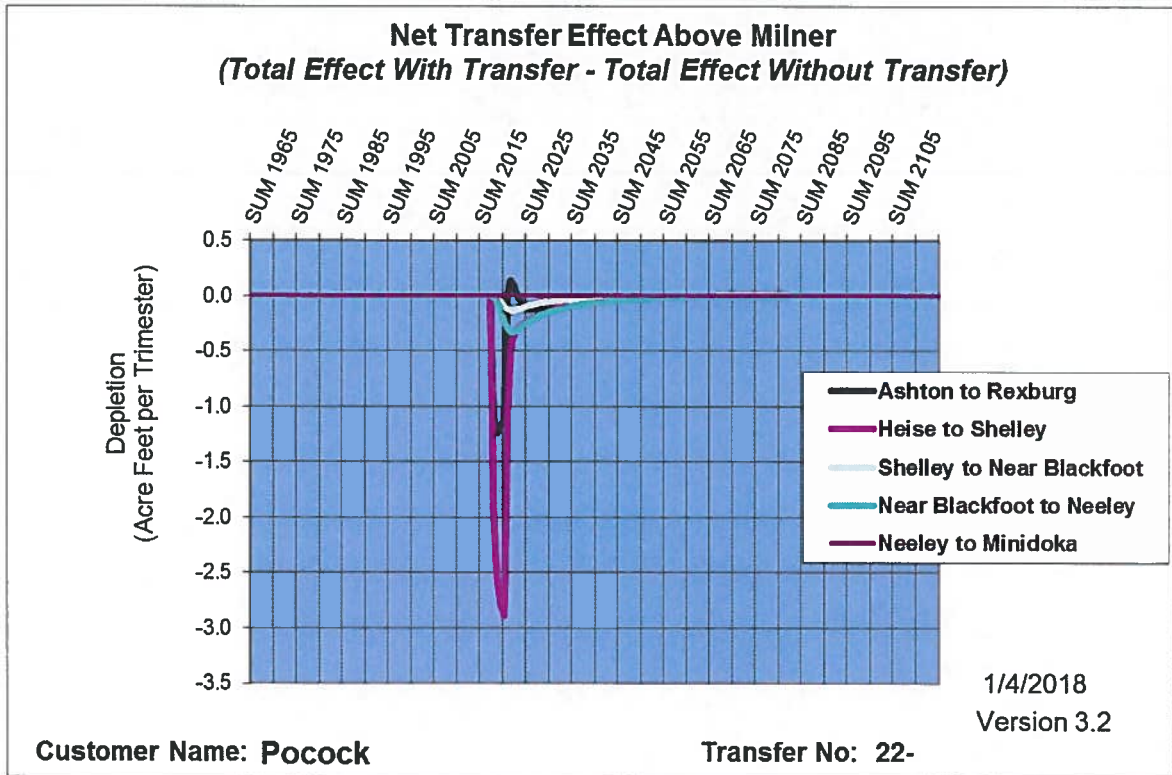
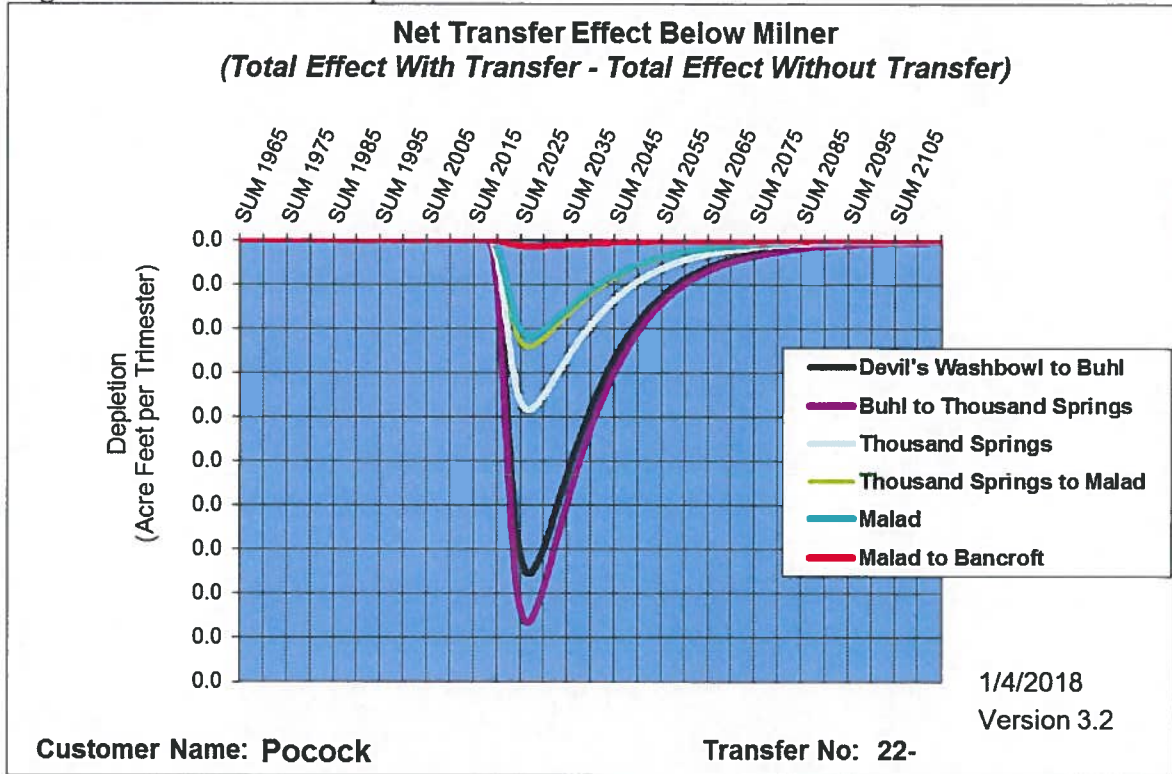

Figure 3. Calculated Affects Beginning Prior to Proposed Rental Period

	Net Transfer Effect (AF/four months)										
	Ashton to Rexburg	Heise to Shelley	Shelley to Nr Bickft	Nr Bickft Neeley	Neeley to Minidoka	Dev. Wbl. Buhl	Buhl to Kspr	Kspr Kspr	Kspr to Malad	Malad Malad	Malad to Bancroft
SPR 2016	0.0	0.0	0.0	0.0	0.0	0.0	0.0	0.0	0.0	0.0	0.0
SUM 2016	0.0	0.0	0.0	0.0	0.0	0.0	0.0	0.0	0.0	0.0	0.0
WIN 2016	0.0	0.0	0.0	0.0	0.0	0.0	0.0	0.0	0.0	0.0	0.0
SPR 2017	0.0	0.0	0.0	0.0	0.0	0.0	0.0	0.0	0.0	0.0	0.0
SUM 2017	0.0	0.0	0.0	0.0	0.0	0.0	0.0	0.0	0.0	0.0	0.0
WIN 2017	0.0	0.0	0.0	0.0	0.0	0.0	0.0	0.0	0.0	0.0	0.0
SPR 2018	-0.8	-1.2	0.0	0.0	0.0	0.0	0.0	0.0	0.0	0.0	0.0
SUM 2018	-1.1	-1.9	0.0	0.0	0.0	0.0	0.0	0.0	0.0	0.0	0.0
WIN 2018	-1.2	-2.3	0.0	0.0	0.0	0.0	0.0	0.0	0.0	0.0	0.0
SPR 2019	-1.2	-2.5	0.0	-0.1	0.0	0.0	0.0	0.0	0.0	0.0	0.0
SUM 2019	-1.2	-2.7	0.0	-0.1	0.0	0.0	0.0	0.0	0.0	0.0	0.0
WIN 2019	-1.2	-2.7	0.0	-0.1	0.0	0.0	0.0	0.0	0.0	0.0	0.0
SPR 2020	-1.2	-2.8	-0.1	-0.2	0.0	0.0	0.0	0.0	0.0	0.0	0.0
SUM 2020	-1.1	-2.8	-0.1	-0.2	0.0	0.0	0.0	0.0	0.0	0.0	0.0
WIN 2020	-1.1	-2.9	-0.1	-0.2	0.0	0.0	0.0	0.0	0.0	0.0	0.0
SPR 2021	-0.3	-1.8	-0.1	-0.3	0.0	0.0	0.0	0.0	0.0	0.0	0.0
SUM 2021	0.0	-1.1	-0.1	-0.3	0.0	0.0	0.0	0.0	0.0	0.0	0.0
WIN 2021	0.1	-0.7	-0.1	-0.3	0.0	0.0	0.0	0.0	0.0	0.0	0.0
SPR 2022	0.1	-0.5	-0.1	-0.3	0.0	0.0	0.0	0.0	0.0	0.0	0.0
SUM 2022	0.1	-0.4	-0.1	-0.3	0.0	0.0	0.0	0.0	0.0	0.0	0.0
WIN 2022	0.1	-0.4	-0.1	-0.3	0.0	0.0	0.0	0.0	0.0	0.0	0.0
SPR 2023	0.0	-0.3	-0.1	-0.3	0.0	0.0	0.0	0.0	0.0	0.0	0.0
SUM 2023	0.0	-0.3	-0.1	-0.3	0.0	0.0	0.0	0.0	0.0	0.0	0.0
WIN 2023	0.0	-0.3	-0.1	-0.3	0.0	0.0	0.0	0.0	0.0	0.0	0.0
SPR 2024	0.0	-0.3	-0.1	-0.3	0.0	0.0	0.0	0.0	0.0	0.0	0.0
SUM 2024	-0.1	-0.3	-0.1	-0.3	0.0	0.0	0.0	0.0	0.0	0.0	0.0
WIN 2024	-0.1	-0.3	-0.1	-0.3	0.0	0.0	0.0	0.0	0.0	0.0	0.0
SPR 2025	-0.1	-0.2	-0.1	-0.3	0.0	0.0	0.0	0.0	0.0	0.0	0.0
SUM 2025	-0.1	-0.2	-0.1	-0.2	0.0	0.0	0.0	0.0	0.0	0.0	0.0
WIN 2025	-0.1	-0.2	-0.1	-0.2	0.0	0.0	0.0	0.0	0.0	0.0	0.0
SPR 2026	-0.1	-0.2	-0.1	-0.2	0.0	0.0	0.0	0.0	0.0	0.0	0.0
SUM 2026	-0.1	-0.2	-0.1	-0.2	0.0	0.0	0.0	0.0	0.0	0.0	0.0
WIN 2026	-0.1	-0.2	-0.1	-0.2	0.0	0.0	0.0	0.0	0.0	0.0	0.0
SPR 2027	-0.1	-0.2	-0.1	-0.2	0.0	0.0	0.0	0.0	0.0	0.0	0.0
SUM 2027	-0.1	-0.2	-0.1	-0.2	0.0	0.0	0.0	0.0	0.0	0.0	0.0
WIN 2027	-0.1	-0.2	-0.1	-0.2	0.0	0.0	0.0	0.0	0.0	0.0	0.0
SPR 2028	-0.1	-0.2	-0.1	-0.2	0.0	0.0	0.0	0.0	0.0	0.0	0.0
SUM 2028	-0.1	-0.2	-0.1	-0.2	0.0	0.0	0.0	0.0	0.0	0.0	0.0
WIN 2028	-0.1	-0.2	-0.1	-0.2	0.0	0.0	0.0	0.0	0.0	0.0	0.0
SPR 2029	-0.1	-0.2	-0.1	-0.2	0.0	0.0	0.0	0.0	0.0	0.0	0.0
SUM 2029	-0.1	-0.1	-0.1	-0.2	0.0	0.0	0.0	0.0	0.0	0.0	0.0
WIN 2029	-0.1	-0.1	-0.1	-0.2	0.0	0.0	0.0	0.0	0.0	0.0	0.0
SPR 2030	-0.1	-0.1	-0.1	-0.1	0.0	0.0	0.0	0.0	0.0	0.0	0.0
SUM 2030	-0.1	-0.1	-0.1	-0.1	0.0	0.0	0.0	0.0	0.0	0.0	0.0
WIN 2030	-0.1	-0.1	-0.1	-0.1	0.0	0.0	0.0	0.0	0.0	0.0	0.0
SPR 2031	-0.1	-0.1	-0.1	-0.1	0.0	0.0	0.0	0.0	0.0	0.0	0.0
SUM 2031	-0.1	-0.1	0.0	-0.1	0.0	0.0	0.0	0.0	0.0	0.0	0.0
WIN 2031	-0.1	-0.1	0.0	-0.1	0.0	0.0	0.0	0.0	0.0	0.0	0.0
SPR 2032	-0.1	-0.1	0.0	-0.1	0.0	0.0	0.0	0.0	0.0	0.0	0.0
SUM 2032	-0.1	-0.1	0.0	-0.1	0.0	0.0	0.0	0.0	0.0	0.0	0.0
WIN 2032	-0.1	-0.1	0.0	-0.1	0.0	0.0	0.0	0.0	0.0	0.0	0.0
SPR 2033	-0.1	-0.1	0.0	-0.1	0.0	0.0	0.0	0.0	0.0	0.0	0.0
SUM 2033	-0.1	-0.1	0.0	-0.1	0.0	0.0	0.0	0.0	0.0	0.0	0.0



State of Idaho

DEPARTMENT OF WATER RESOURCES

322 East Front Street • P.O. Box 83720 • Boise, Idaho 83720-0098

Phone: (208) 287-4800 • Fax: (208) 287-6700 • Website: www.idwr.idaho.gov

C.L. "BUTCH" OTTER
Governor

GARY SPACKMAN
Director

March 13, 2018

THE RALPH R & BETH POCOCK FAMILY LTD PARTNERSHIP
2964 N 5000 E
SUGAR CITY ID 83448

**RE: RENTAL OF WATER FROM THE WATER SUPPLY BANK
WATER RIGHT NO. 22-13440**

Dear Renter:

Please find enclosed a receipt in the amount of **\$4,288.00** and a copy of a fully executed Water Supply Bank Rental Agreement in connection with the rental of 100.8 acre-feet of water for irrigation of 28.8 acres during 2018. Upon receipt of this fully executed agreement, you are authorized to divert water in compliance with the conditions of water use described in the agreement.

Pursuant to the Water Supply Bank Rules, 90% or \$1,814.40 of the rental fee will be paid to the lessor(s) and 10% or \$201.60 will be retained by the Department to offset administrative costs.

If you have any questions, please contact this office at (208) 287-4800.

Sincerely,

A handwritten signature in black ink, appearing to read "Garry Spackman". The signature is written in a cursive style and is positioned above the typed name "Garry Spackman".

Garry Spackman
Water Supply Bank

Enclosures: Receipt No. C104752
Rental Agreement (copy)

c: Sascha Marston – Fiscal
James Cefalo – IDWR Eastern Regional Office/Water District # 120
Kristin Moore – Rocky Mountain Environmental
Madison GWD



State of Idaho

DEPARTMENT OF WATER RESOURCES

322 East Front Street • P.O. Box 83720 • Boise, Idaho 83720-0098
Phone: (208) 287-4800 • Fax: (208) 287-6700 • Website: www.idwr.idaho.gov

C.L. "BUTCH" OTTER
Governor

GARY SPACKMAN
Director

February 26, 2018

THE RALPH R & BETH POCOCK FAMILY LTD PARTNERSHIP
2964 N 5000 E
SUGAR CITY ID 83448

**RE: APPLICATION TO RENT WATER FROM THE WATER SUPPLY BANK
WATER RIGHT NO 22-13440**

*****TIME SENSITIVE RESPONSE REQUIRED*****

Dear Applicant:

The Department of Water Resources acknowledges receipt of your application to rent water from the Water Supply Bank. **I have enclosed a Water Supply Bank Rental Agreement for your review and signature.** Upon signature and return of the original agreement, together with the rental fee described below, the Department will also sign the original agreement and return an executed copy to you. Execution of the agreement and compliance with the conditions of approval authorize diversion and use of water as provided in the agreement.

A rental fee of \$2,016.00 was calculated based on the current rental rate of \$20.00 per acre-foot times a diversion volume of 100.80 acre-feet. An annual payment shall be received by the Department prior to the execution of this agreement and prior to January 1 in all subsequent years for the duration of the rental period. The agreement will be void if payment is not received prior to the due date in a given year. If you would like to terminate the agreement prior to the end of the rental period, you must submit written notice of your intent to the Department at least 30 days prior to the rental fee due date.

Please send a check for \$2,016.00 made payable to the Idaho Department of Water Resources, **together with the signed rental agreement, within 14 days** so I can complete processing. Pursuant to the Water Supply Bank Rules, 90% or \$1,814.40 of the rental fee will be paid to the lessor(s) and 10% or \$201.60 will be retained by the Department to offset administrative costs.

If you have any questions, please contact this office at (208) 287-4800.

Sincerely,

Water Supply Bank

Enclosure

c: IDWR Front Desk
Kristin Moore – Rocky Mountain Environmental

Edl, Michele

From: Cefalo, James
Sent: Tuesday, February 13, 2018 9:44 AM
To: Edl, Michele
Subject: RE: WSB request for comment

Michele,

I don't have any concerns with the proposed WSB rentals.

James

From: Edl, Michele
Sent: Friday, February 09, 2018 2:08 PM
To: Cefalo, James <James.Cefalo@idwr.idaho.gov>
Subject: WSB request for comment

James,

I have completed my review of 2 WSB rental proposals for the Pocock Family. One is for 1 year and ~ 1.5 of the pivot end gun rings; the other for 3 years and ~3.5 of the end gun rings.

Kristin Moore provided separate ESPA modeling. I have confirmed the models individually and in combination. No additional mitigation is required.

One rental (agreement 220), will be for the 2018 irrigation season only. The modeling was based on consumptive use of actual crops vs default crop consumptive use. Because the specific crops were named and modeled, the WSB should expect those crops to be planted.

One rental (agreement 218) will be for 2018-2020.

The lease well-PODs is in Bingham GWD. The rental well-POD is in Madison GWD. The leased rights are subject to WD 100, the rental point of diversion is subject to WD 120.

I am recommending that these proposals be processed with 1/10 acre reduction to the 2018 rental proposal. That reduction is the result of recalculating the splits of the Ritchie rights 35-13993 and 35-13995.

I have attached a copy of my review memos for the rentals and maps showing the 2 different rental POUs.

Please let me know if you have questions or concerns about these rentals.

Michele Edl
208-287-4946

MEMORANDUM

To: Right(s) 22-13440

From: Michele Edl

Date: February 9, 2018

Re: Review & Analysis of WSB Application #981 to Rent Water from the State Water Supply Bank

PURPOSE/NARRATIVE: On January 8, 2018, Kristin Moore (Sr WR Analyst, Rocky Mountain Environmental Associates, Inc) submitted a WSB rental application on behalf of the Ralph R and Beth Pocock Family Limited Partnership. The application requested a three-year rental and identified a specific water right. The rented water will be used to irrigate 28.8 acres within the applicant's property. The 28.8 acres are irrigated by pivot end-guns and aren't covered by any of the applicant's water rights, although the cores of the pivots are. This rental application is sufficient for approximately half of the acreage needed. Another WSB rental application will be proposed to cover the remaining end-gun acres.

AUTHORITY TO FILE: According to available Madison County taxlot information, the proposed place-of-use is owned by the Pocock, Ralph & Beth Fam Lmt & Prt. The Ralph R. and Beth Pocock Family Limited Partnership is listed with ISOS as #L3323. Ray R. Pocock is listed as a general partner and he signed the application.

The proposed PODs are two existing wells. They are the authorized PODs for water rights 22-7167A, 22-7052A, 22-2271D, 22-7439, 22-14082, 22-14083 and 22-14084 which are held by The Ralph R & Beth Pocock Family Ltd Partnership.

WATER RIGHT VALIDITY:

Right 22-13440 is for irrigation use and has been leased to the bank since 2016. Forfeiture is not an issue at this time. The current lease is in effect until December 31, 2020. A sufficient quantity of the right is available to satisfy this request but will exhaust the leased water amounts

INJURY TO OTHER WATER RIGHTS: No injury is apparent.

The consultant and I modeled this water rental using the current version of the ETRAN modeling utility. The modeling inputs provided by the consultant were based on the consumptive use of two proposed crops (potato or grain) rather than on the model's default crop (alfalfa). No mitigation is required for this rental.

ENLARGEMENT OF USE: No enlargement is anticipated.

The rate and volume rented from the right will be made proportionate to the leased elements of the right. The authorized rental rate will be approximately 0.014 cfs/ac which is sufficient for pivot irrigation of crops planted in these fields. The native water rights delivered by the pivots average less than 0.02 cfs/ac.

The consultant is aware of the rate limitation of the proposed right. The rental places-of-use have no water rights and according to the consultant, the renter plants either a potato or a spring grain crop in yearly rotation. Neither of those crops demand a high rate or consumptive use volume per acre so the proposed right will provide enough water for a three-year rotation.

LOCAL PUBLIC INTEREST: Review staff has no information to suggest this application is inconsistent with the local public interest.

BENEFICIAL USE/CONSERVATION OF WATER RESOURCES: The rental appears consistent with the conservation of water resources in Idaho.

DEPARTMENT STAFF OR WATERMASTER COMMENTS: The rental location is subject to Water District #100. The leased water is subject to Water District #120. Comment has been solicited from the watermaster who oversees both water districts. He is not opposed to this rental. Nor is Eastern Region.

The lease wells are located within the Bingham GW District.
The rental wells are located within the Madison GW District

One-Way Analysis of Independent Transfers

Pocock 2018 & 2018-2020 combined into 1:

W/F No.	Div. Rate (CFS)	Cor. Vol. (AF/A)	No. of Irr. Acres	Priority Date	POD Location	Dedicated Vol. AF/A AFT	Model Node	Impact by Reach (AFT/Trimester)												
								Ashion to Rankburg	Hesse to Shelley	Shelley to Nr Bickit	Nr Bickit To Nealey	Nealey to Mindokva	Dev. Wbl. To Buhl	Buhl to Kspr	Kspr to Kspr	Kspr to Maled	Maled to Maled	Maled to Bancroft		
Transfer 1: Proposed Steady State Impacts following Transfer																				
777	777	275.6	88.9	1/1/1980	8S28E-3	275.6	91.9	10.27	11.66	7.26	21.05	0.12	0.39	0.45	0.20	0.12	0.11	0.01		
777	777	275.6	88.9	1/1/1980	8S28E-3	275.6	91.9	10.27	11.66	7.26	21.05	0.12	0.39	0.45	0.20	0.12	0.11	0.01		
Transfer 1: Worst Case Transient State Impacts following Transfer																				
777	777	275.6	88.9	1/1/1980	8S28E-3	275.6	91.9	10.27	11.66	7.26	21.05	0.12	0.39	0.45	0.20	0.12	0.11	0.01		
777	777	275.6	88.9	1/1/1980	8S28E-3	275.6	91.9	11.24	11.66	7.26	21.05	0.12	0.39	0.45	0.20	0.12	0.11	0.01		

Steady State Analysis		Mitigation Check 1 - >10% of Historical:		Mitigation Check 2: > 2 AFT/:		Mitigation Check 3 - >10% of Total:		Mitigation Required?:		Mitigation Vol. Req'd (ac-ft):	
0.0%	0.0	0.0%	0.0	0.0%	0.0	0.0%	0.0	NO	0.0	NO	0.0
0.0%	0.0	0.0%	0.0	0.0%	0.0	0.0%	0.0	NO	0.0	NO	0.0
19.9%	22.6%	14.1%	40.9%	0.2%	0.8%	0.9%	0.4%	NO	NO	NO	NO
0.0	0.0	0.0	0.0	0.0	0.0	0.0	0.0	NO	NO	NO	NO

Transient State Analysis		Mitigation Check 1 - >10% of Historical:		Mitigation Check 2: > 2.01 AFT/:		Mitigation Required?:		Mitigation Vol. Req'd (ac-ft):	
9.4%	0.0	0.0%	0.0	0.0%	0.0	NO	1.0	NO	0.0
0.0%	0.0	0.0%	0.0	0.0%	0.0	NO	0.0	NO	0.0
0.0%	0.0	0.0%	0.0	0.0%	0.0	NO	0.0	NO	0.0
0.0%	0.0	0.0%	0.0	0.0%	0.0	NO	0.0	NO	0.0

Read Me

Not Used

