

3.

Delivery System Diagram Attached (required). Indicate all major components and distances between components. Indicate weir size/pipe as applicable.

Map Attached Showing Location(s) of point(s) of diversion and place(s) of use (required). Scale must be 1:24,000 or greater.

Aerial Photo Attached (required for irrigation of 10+ acres).

Photo of Diversion and System Attached

4.

Well or Diversion ID No.*	Motor Make	Hp	Motor Serial No.	Pump Make	Pump Serial No. or Discharge Size

D. FLOW MEASUREMENTS

1.

Measurement Equipment	Type	Make	Model No.	Serial No.	Size	Calib. Date

2. Measurements:

E. FLOW CALCULATIONS

Additional Computation Sheets Attached

Measured Method:

F. VOLUME CALCULATIONS

1. Volume Calculations for irrigation:

$$V_{I.R.} = (\text{Acres Irrigated}) \times (\text{Irrigation Requirement}) =$$

$$V_{D.R.} = [\text{Diversion Rate (cfs)}] \times (\text{Days in Irrigation season}) \times 1.9835 =$$

$$V = \text{Smaller of } V_{I.R.} \text{ and } V_{D.R.} =$$

2. Volume Calculations for Other Uses: Domestic 1.2 AF for indoor and outdoor use up to ½ acre. See application processing memo # 22.

G. NARRATIVE/REMARKS/COMMENTS: ArcMap and Bonner County confirm dwelling on property and current owner to be Larsen Trust. The source is a well that is located on the Larsen Property. They are sharing this well with their neighbors and water right 97-9558. The well was drilled in January, 2019. (See attached well log.) The place of use and point of diversion are located on Lot 12A, Sherwood Beach Lots. This right is for indoor and outdoor use. The volume will be 1.2 af.

* *AG*
3/10/2020

Have conditions of permit approval been met? ☒ Yes ☐ No

H. RECOMMENDATIONS

1. Recommended Amounts

Beneficial Use	Period of Use	Rate of Diversion	Annual Volume
DOMESTIC	01/01 to 12/31	0.04 CFS	1.2 AF
Totals:		0.04 CFS	1.2 AF

2. Recommended Amendments

☐ Change P.D. as reflected above ☐ Add P.D. as reflected above ☒ None

☐ Change P.U. as reflected above ☐ Add P.U. as reflected above ☒ None

I. AUTHENTICATION

Jean Hersley - Technical Records Specialist 2

Field Examiner's Name *Jean Hersley* Date March 4, 2020

Reviewer *Angela M. Gamm* Date 3/10/2020

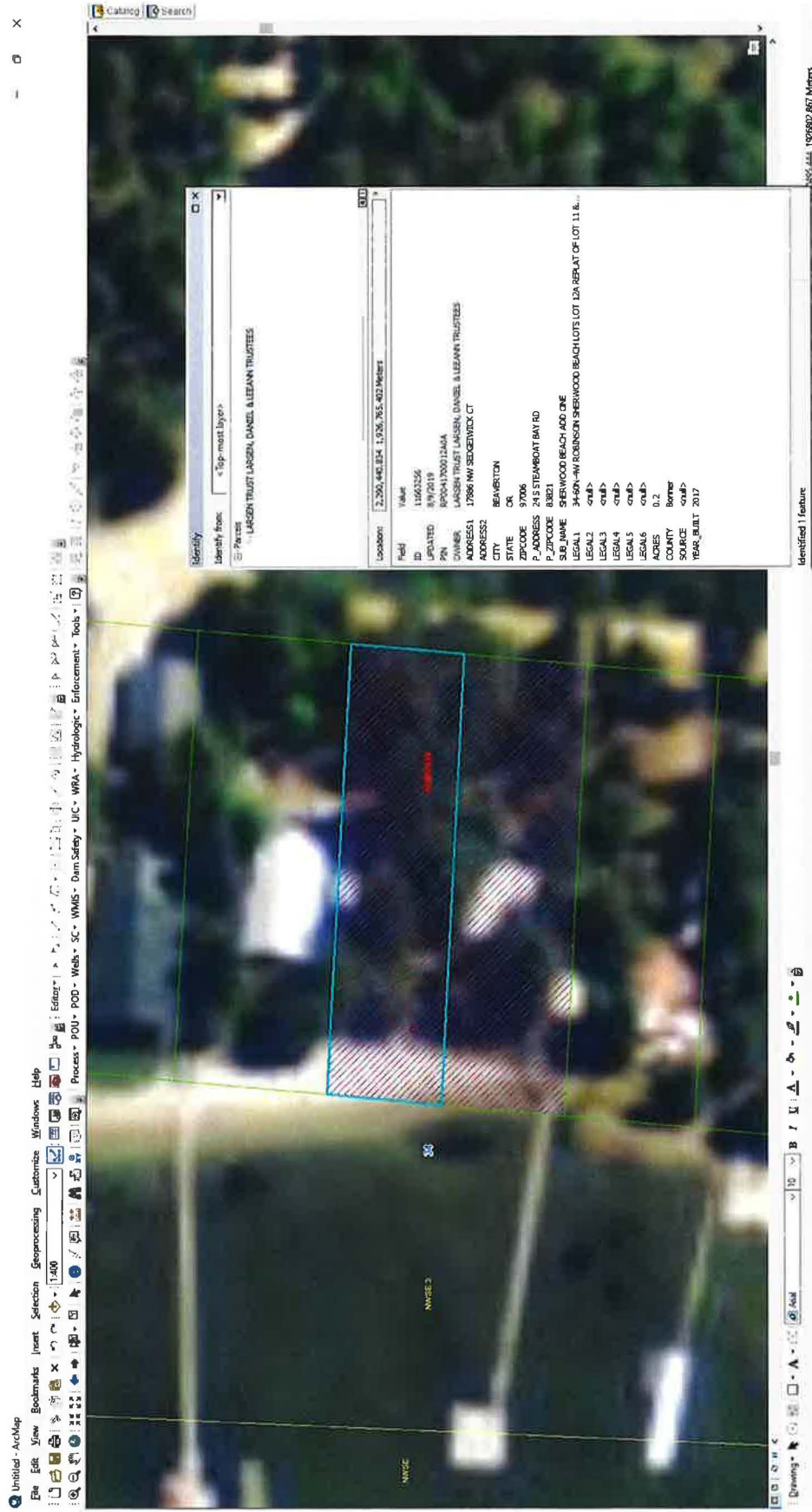

Parcel owners are the permit holders.



Parcel: 1 of 1

Parcel #: PR041706012A0A
Owner: Larson Trust
Subdivision Name: Robinson Sherwood Beach Lots
Reg'd 07/10/11 & 12
Area: 0.251
Tax Code Area: 0140000
Description: 35' Road Improv on cat 15
Last Assessed Value: \$29,855
Ded: 528,124 WD
Ded: 528,124 WD
Ded: 528,124 WD
Ded: 528,124 WD
Legal Description: 34.48% - NW ROBINSON
SHERWOOD BEACH LOTS LOT 12A REF. AT OF
LOT 11 & 12

Bonner County