

**IDAHO DEPARTMENT OF WATER RESOURCES**  
**Proof Report**

3/25/2020

**Water Right 34-14222**

*After Split*

**Owner Type**  
Current Owner

**Name and Address**  
BONNIE JO SIMPSON  
37156 S GOLF COURSE DR  
TUCSON, AZ 85739-1149

**Priority Date:** 5/1/1885

**Basis:** Decreed

**Status:** Active

**Source**  
BIG LOST RIVER

**Tributary**  
SINKS

**Beneficial Use**

IRRIGATION

**From**

05/01

**To**

10/15

**Diversion Rate**

0.380 CFS

**Volume**

**Total Diversion**

0.380 CFS

**Source and Point(s) of Diversion**

BIG LOST RIVER

NESWNW

Sec. 15, Twp 08N, Rge 21E, CUSTER County

**Place Of Use**

IRRIGATION within CUSTER County

			NE				NW				SW				SE				Totals
Twp	Rng	Sec	NE	NW	SW	SE	NE	NW	SW	SE	NE	NW	SW	SE	NE	NW	SW	SE	
08N	22E	17			8.5					10.5									19.0

Right Acre Limit: 18.5

POU Total Acres: 19.0

**Conditions of Approval:**





1. C18 THIS PARTIAL DECREE IS SUBJECT TO SUCH GENERAL PROVISIONS NECESSARY FOR THE DEFINITION OF THE RIGHTS OR FOR THE EFFICIENT ADMINISTRATION OF THE WATER RIGHTS AS MAY BE ULTIMATELY DETERMINED BY THE COURT AT A POINT IN TIME NO LATER THAN THE ENTRY OF A FINAL UNIFIED DECREE. SECTION 42-1412(6), IDAHO CODE.
2. C05 RIGHT INCLUDES ACCOMPLISHED CHANGE IN PLACE OF USE PURSUANT TO SECTION 42-1425, IDAHO CODE.
3. USE OF THIS RIGHT WITH THE RIGHTS LISTED BELOW IS LIMITED TO THE IRRIGATION OF A COMBINED TOTAL OF 19 ACRES IN A SINGLE IRRIGATION SEASON.  
COMBINED RIGHT NOS.: 34-14219 AND 34-14225.  
THIS RIGHT IS LIMITED TO THE IRRIGATION OF 18.5 ACRES WITHIN THE PLACE OF USE DESCRIBED ABOVE IN A SINGLE IRRIGATION SEASON.
4. S34 THE PERIOD OF USE FOR IRRIGATION DESCRIBED ABOVE MAY BE EXTENDED IN SEASONS OF UNUSUAL CHARACTERISTICS TO A BEGINNING DATE OF 04-20 AND AN ENDING DATE OF 10-31 AT THE DISCRETION OF THE DIRECTOR OF THE IDAHO DEPARTMENT OF WATER RESOURCES.
5. WATER IS DELIVERED THROUGH NEILSEN DITCH.

**Comments:**

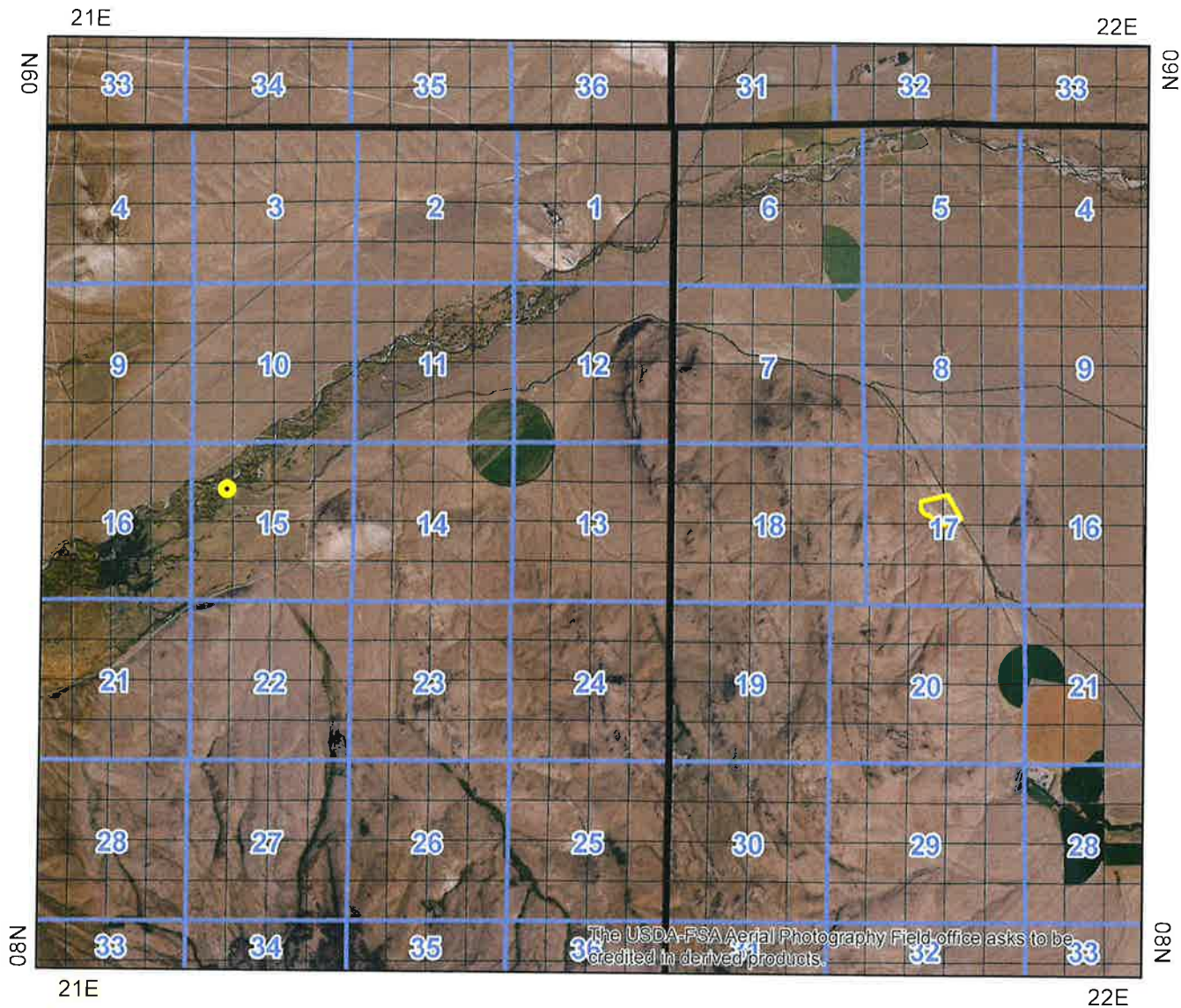
5. jborg 3/25/2020 Change in Ownership  
water right 34-14222 was split into 34-14222 and 34-14781.

State of Idaho  
Department of Water Resources  
**Water Right**  
34-14219, 34-14222 & 34-14225  
After Split



-  Point of Diversion
-  Place Of Use Boundary
-  Townships
-  PLS Sections
-  Quarter Quarters

0 0.5 1 2 Miles



State of Idaho  
Department of Water Resources

# Water Right

34-14219, 34-14222 & 34-14225  
After Split



- Place Of Use Boundary
- Townships
- PLS Sections
- Quarter Quarters

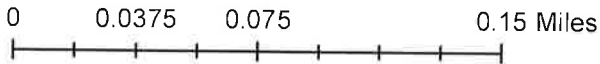



IDAHO DEPARTMENT OF WATER RESOURCES  
Proof Report

3/24/2020

Water Right 34-14222 *Before Split*

**Owner Type**      **Name and Address**  
Current Owner      BONNIE JO SIMPSON  
37156 S GOLF COURSE DR  
TUCSON, AZ 85739-1149

**Priority Date:** 5/1/1885

**Basis:** Decreed

**Status:** Active

**Source**  
BIG LOST RIVER

**Tributary**  
SINKS

<b>Beneficial Use</b>	<b>From</b>	<b>To</b>	<b>Diversion Rate</b>	<b>Volume</b>
IRRIGATION	05/01	10/15	0.580 CFS	
	<b>Total Diversion</b>		0.580 CFS	

**Source and Point(s) of Diversion**

BIG LOST RIVER      NESWNW      Sec. 15, Twp 08N, Rge 21E, CUSTER County

**Place Of Use**

IRRIGATION within CUSTER County

Twp	Rng	Sec	NE				NW				SW				SE				Totals
			NE	NW	SW	SE	NE	NW	SW	SE	NE	NW	SW	SE	NE	NW	SW	SE	
08N	22E	17			9.0		1.0			19.0									29.0

Right Acre Limit: 28.3





POU Total Acres: 29.0

**Conditions of Approval:**

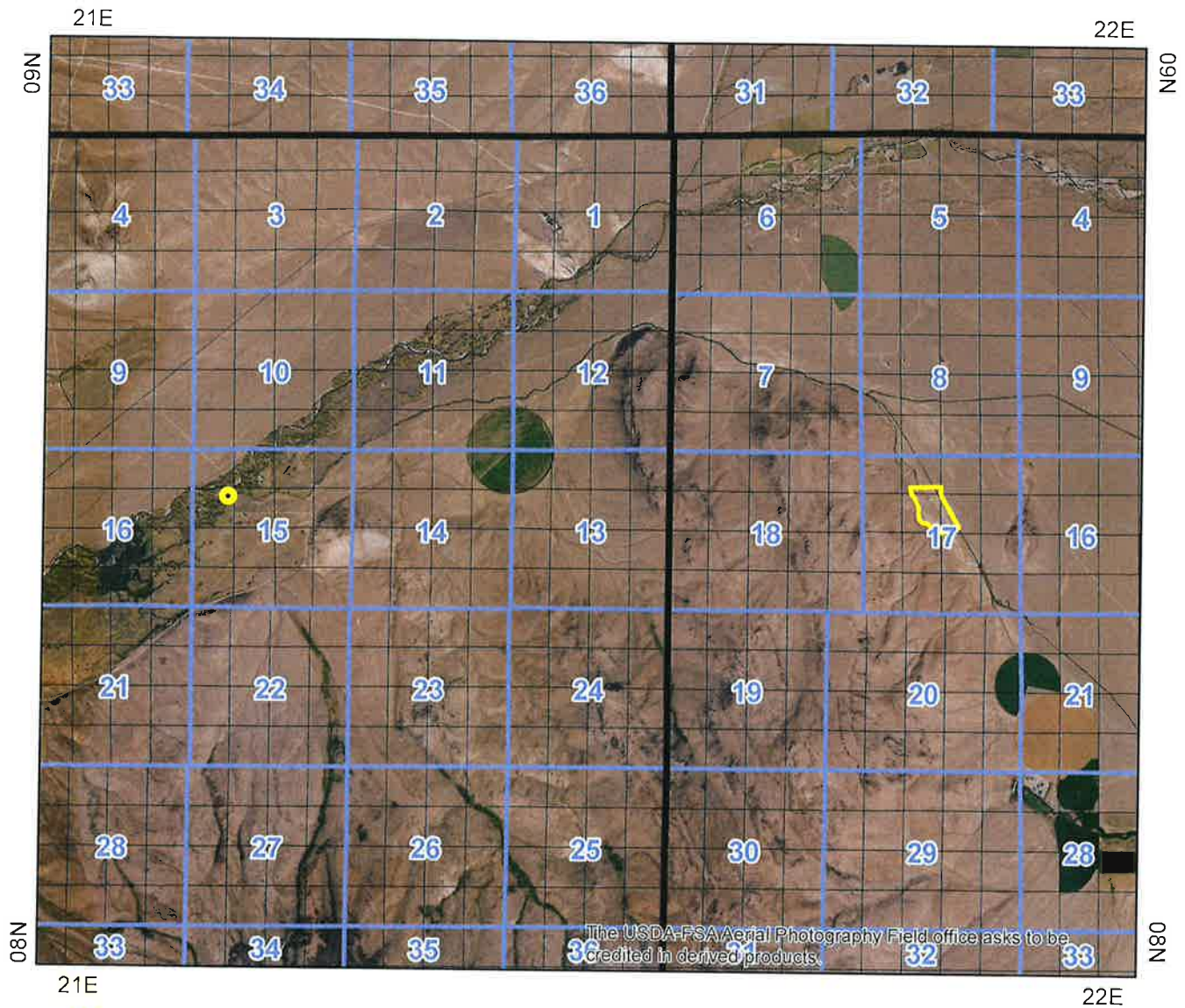
1. C18 THIS PARTIAL DECREE IS SUBJECT TO SUCH GENERAL PROVISIONS NECESSARY FOR THE DEFINITION OF THE RIGHTS OR FOR THE EFFICIENT ADMINISTRATION OF THE WATER RIGHTS AS MAY BE ULTIMATELY DETERMINED BY THE COURT AT A POINT IN TIME NO LATER THAN THE ENTRY OF A FINAL UNIFIED DECREE. SECTION 42-1412(6), IDAHO CODE.
2. C05 RIGHT INCLUDES ACCOMPLISHED CHANGE IN PLACE OF USE PURSUANT TO SECTION 42-1425, IDAHO CODE.
3. USE OF THIS RIGHT WITH THE RIGHTS LISTED BELOW IS LIMITED TO THE IRRIGATION OF A COMBINED TOTAL OF 29 ACRES IN A SINGLE IRRIGATION SEASON.  
COMBINED RIGHT NOS.: 34-14219 AND 34-14225.  
THIS RIGHT IS LIMITED TO THE IRRIGATION OF 28.3 ACRES WITHIN THE PLACE OF USE DESCRIBED ABOVE IN A SINGLE IRRIGATION SEASON.
4. S34 THE PERIOD OF USE FOR IRRIGATION DESCRIBED ABOVE MAY BE EXTENDED IN SEASONS OF UNUSUAL CHARACTERISTICS TO A BEGINNING DATE OF 04-20 AND AN ENDING DATE OF 10-31 AT THE DISCRETION OF THE DIRECTOR OF THE IDAHO DEPARTMENT OF WATER RESOURCES.
5. WATER IS DELIVERED THROUGH NEILSEN DITCH.

State of Idaho  
Department of Water Resources  
**Water Rights**  
34-14219, 34-14222 & 34-14225  
Before Split



-  Point of Diversion
-  Place Of Use Boundary
-  Townships
-  PLS Sections
-  Quarter Quarters

0 0.5 1 2 Miles

