

MAY 06 2020  
IDWR/NORTH

84048  
STATE OF IDAHO  
DEPARTMENT OF WATER RESOURCES  
**APPLICATION FOR PERMIT**  
To appropriate the public waters of the State of Idaho

Ident. No. 96-9802

1. Name of applicant(s) DENNIS GORDON & PATRICIA GORDON Phone 406-369-2433  
Name connector (check one): ☒ and ☐ or ☐ and/or  
Mailing address 245 BIRCH BANKS ROAD City SAGLE  
State IDAHO ZIP 83860 Email NCRCONSULTINGDG@GMAIL.COM
2. Name of representative, if any N/A Phone \_\_\_\_\_  
Mailing address \_\_\_\_\_ City \_\_\_\_\_  
State \_\_\_\_\_ ZIP \_\_\_\_\_ Email \_\_\_\_\_
- a. ☐ Send all correspondence for this application to the representative and not to the applicant OR  
☒ Send original correspondence to the applicant and copies to the representative.
- b. ☐ The representative may submit information for the applicant but is not authorized to sign for the applicant OR  
☐ The representative is authorized to sign for the applicant. Attach a Power of Attorney or other documentation.
3. Source of water supply LAKE PEND O'REILLE which is a tributary of PEND O'REILLE RIVER
4. Location of point(s) of diversion:

Twp	Rge	Sec	Govt Lot	1/4	1/4	1/4	County	Source	Local name or tag #
56N	2W	2	3		NE	NW	BONNER	LAKE PEND O'REILLE	

5. Water will be used for the following purposes:
- Amount 0.03 CFS for IRRIGATION purposes from 4/1 to 10/31 (both dates inclusive)  
(cfs or acre-feet per year)
- Amount \_\_\_\_\_ for \_\_\_\_\_ purposes from \_\_\_\_\_ to \_\_\_\_\_ (both dates inclusive)  
(cfs or acre-feet per year)
- Amount \_\_\_\_\_ for \_\_\_\_\_ purposes from \_\_\_\_\_ to \_\_\_\_\_ (both dates inclusive)  
(cfs or acre-feet per year)
- Amount \_\_\_\_\_ for \_\_\_\_\_ purposes from \_\_\_\_\_ to \_\_\_\_\_ (both dates inclusive)  
(cfs or acre-feet per year)
6. Total quantity to be appropriated is (a) 0.03 cubic feet per second (cfs) and/or (b) \_\_\_\_\_ acre-feet per year (af).
7. Proposed diverting works:
- a. Describe type and size of devices used to divert water from the source. 1 HP ELECTRIC PUMP WITH 1 1/4 SUCTION PIPE FROM LAKE
- b. Height of storage dam N/A feet; active reservoir capacity \_\_\_\_\_ acre-feet; total reservoir capacity \_\_\_\_\_ acre-feet. If the reservoir will be filled more than once each year, describe the refill plan in item 12. For dams 10 feet or more in height AND having a storage capacity of 50 acre-feet or more, submit a separate . Application required? ☐ Yes ☐ No
- c. Proposed well diameter is \_\_\_\_\_ inches; proposed depth of well is \_\_\_\_\_ feet.
- d. Is ground water with a temperature of greater than 85°F being sought? ☐ Yes ☐ No
- e. If well is already drilled, when? \_\_\_\_\_; drilling firm \_\_\_\_\_; well was drilled for (well owner) \_\_\_\_\_; Drilling Permit No. \_\_\_\_\_.

For Department Use

Received by TA Date 4-27-2020 Time \_\_\_\_\_ Preliminary check by \_\_\_\_\_  
Fee \$ 100.00 Received by TA Receipt No. N436035 Date 4-27-2020

8. Description of proposed uses (if irrigation only, go to item 9):
- Hydropower; show total feet of head and proposed capacity in kW. \_\_\_\_\_
  - Stockwatering; list number and kind of livestock. \_\_\_\_\_
  - Municipal; must complete and attach the Municipal Water Right Application Checklist.
  - Domestic; show number of households \_\_\_\_\_
  - Other; describe fully. \_\_\_\_\_

9. Description of place of use:

- If water is for irrigation, indicate acreage in each subdivision in the tabulation below.
- If water is used for other purposes, place a symbol of the use (example: D for Domestic) in the corresponding place of use below. See instructions for standard symbols.

TWP	RGE	SEC	NE				NW				SW				SE				TOTALS
			NE	NW	SW	SE	NE	NW	SW	SE	NE	NW	SW	SE	NE	NW	SW	SE	
56 N	2W	2					0.5												0.5
							3												

Total number of acres to be irrigated: 0.5

10. Describe any other water rights used for the same purposes as described above. Include water delivered by a municipality, canal company, or irrigation district. If this application is for domestic purposes, do you intend to use this water, water from another source, or both, to irrigate your lawn, garden, and/or landscaping? \_\_\_\_\_
11. a. Who owns the property at the point of diversion? APPLICANT
- b. Who owns the land to be irrigated or place of use? APPLICANT
- c. If the property is owned by a person other than the applicant, describe the arrangement enabling the applicant to make this filing: N/A
12. Describe your proposal in narrative form, and provide additional explanation for any of the items above. Attach additional pages if necessary. APPLICANT PLANS TO USE WATER FROM LAKE TO IRRIGATE LAWN, GARDEN, AND LANDSCAPE. POU IS FOR LOT 14.
13. Time required for completion of works and application of water to proposed beneficial use is 5 years (minimum 1 year).
14. **MAP OF PROPOSED PROJECT REQUIRED** - Attach an 8½" x 11" map or maps clearly identifying the proposed point of diversion, place of use, section #, township & range. The map scale shall not be less than two (2) inches equal to one (1) mile.





The information contained in this application is true to the best of my knowledge. I understand that any willful misrepresentations made in this application may result in rejection of the application or cancellation of an approval.

  
 Signature of Applicant  
DENNIS C. GORDON  
 Print Name (and title, if applicable)

  
 Signature of Applicant  
PATRICIA GORDON  
 Print Name (and title, if applicable)



## Legend

-  Parcels
-  Township/Range
-  Sections
-  QQ
- 2013 (0.5 meter)**
- RGB**
-  Red: Red
-  Green: Green
-  Blue: Blue

0 0.0175 0.035 0.07 Miles



FORM 202-51.01.01.D

APR 27 2020

IDWR / NORTH

STATE OF IDAHO  
DEPARTMENT OF WATER RESOURCES  
**APPLICATION FOR PERMIT**  
To appropriate the public waters of the State of Idaho

Ident. No. \_\_\_\_\_

1. Name of applicant(s) DENNIS GORDON & PATRICIA GORDON Phone 406.369.2433  
 Name connector (check one): ☒ and ☐ or ☐ and/or  
 Mailing address 245 BIRCH BANKS ROAD City SAGLE  
 State IDAHO ZIP 83860 Email ncrconsulting4@gmail.com
2. Name of representative, if any NA Phone \_\_\_\_\_  
 Mailing address \_\_\_\_\_ City \_\_\_\_\_  
 State \_\_\_\_\_ ZIP \_\_\_\_\_ Email \_\_\_\_\_
- a. ☐ Send all correspondence for this application to the representative and not to the applicant OR  
☒ Send original correspondence to the applicant and copies to the representative.
- b. ☐ The representative may submit information for the applicant but is not authorized to sign for the applicant OR  
☐ The representative is authorized to sign for the applicant. Attach a Power of Attorney or other documentation.
3. Source of water supply LAKE PEND O'REILLE which is a tributary of CLARK FORK RIVER
4. Location of point(s) of diversion:

Twp	Rge	Sec	Govt Lot	1/4	1/4	1/4	County	Source	Local name or tag #
<u>56N</u>	<u>2W</u>	<u>2</u>		<u>SE</u>	<u>NW</u>		<u>BONNER</u>	<u>LAKE PEND O'REILLE</u>	

5. Water will be used for the following purposes:

Amount 1 ACRE FEET for IRRIGATION purposes from APRIL 15 to OCT. 15 (both dates inclusive)  
 (cfs or acre-feet per year)

Amount \_\_\_\_\_ for \_\_\_\_\_ purposes from \_\_\_\_\_ to \_\_\_\_\_ (both dates inclusive)  
 (cfs or acre-feet per year)

Amount \_\_\_\_\_ for \_\_\_\_\_ purposes from \_\_\_\_\_ to \_\_\_\_\_ (both dates inclusive)  
 (cfs or acre-feet per year)

Amount \_\_\_\_\_ for \_\_\_\_\_ purposes from \_\_\_\_\_ to \_\_\_\_\_ (both dates inclusive)  
 (cfs or acre-feet per year)

6. Total quantity to be appropriated is (a) \_\_\_\_\_ cubic feet per second (cfs) and/or (b) \_\_\_\_\_ acre-feet per year (af).
7. Proposed diverting works:

- a. Describe type and size of devices used to divert water from the source. 1 HP ELECTRIC PUMP  
WITH 1 1/4" SUCTION PIPE
- b. Height of storage dam NA feet; active reservoir capacity \_\_\_\_\_ acre-feet; total reservoir capacity \_\_\_\_\_ acre-feet. If the reservoir will be filled more than once each year, describe the refill plan in item 12. For dams 10 feet or more in height AND having a storage capacity of 50 acre-feet or more, submit a separate  
 . Application required? ☐ Yes ☐ No
- c. Proposed well diameter is NA inches; proposed depth of well is \_\_\_\_\_ feet.
- d. Is ground water with a temperature of greater than 85°F being sought? ☐ Yes ☐ No
- e. If well is already drilled, when? \_\_\_\_\_; drilling firm \_\_\_\_\_;  
 well was drilled for (well owner) \_\_\_\_\_; Drilling Permit No. \_\_\_\_\_.

For Department Use

Received by Ja Date 4-27-2020 Time \_\_\_\_\_ Preliminary check by \_\_\_\_\_  
 Fee \$ 1000 Received by Ja Receipt No. NO36034 Date 4-27-2020

8. Description of proposed uses (if irrigation only, go to item 9):

- Hydropower; show total feet of head and proposed capacity in kW. \_\_\_\_\_
- Stockwatering; list number and kind of livestock. \_\_\_\_\_
- Municipal; must complete and attach the \_\_\_\_\_
- Domestic; show number of households \_\_\_\_\_
- Other; describe fully. \_\_\_\_\_

9. Description of place of use:

- If water is for irrigation, indicate acreage in each subdivision in the tabulation below.
- If water is used for other purposes, place a symbol of the use (example: D for Domestic) in the corresponding place of use below. See instructions for standard symbols.

TWP	RGE	SEC	NE				NW				SW				SE				TOTALS
			NE	NW	SW	SE	NE	NW	SW	SE	NE	NW	SW	SE	NE	NW	SW	SE	
56N	2W	2								1/2									
										IRRIGATION									

Total number of acres to be irrigated: 1/2 ACRE

10. Describe any other water rights used for the same purposes as described above. Include water delivered by a municipality, canal company, or irrigation district. If this application is for domestic purposes, do you intend to use this water, water from another source, or both, to irrigate your lawn, garden, and/or landscaping? THIS WATER TO IRRIGATE LAWN, GARDEN AND LANDSCAPING

- Who owns the property at the point of diversion? APPLICANT
- Who owns the land to be irrigated or place of use? APPLICANT
- If the property is owned by a person other than the applicant, describe the arrangement enabling the applicant to make this filing: N/A

12. Describe your proposal in narrative form, and provide additional explanation for any of the items above. Attach additional pages if necessary.

POINT OF DIVERSION: 48° 14' 00.02" N, 116° 32' 01.37" W

POINT OF USE: 48° 13' 59.61" N, 116° 32' 09.83" W

13. Time required for completion of works and application of water to proposed beneficial use is 1 years (minimum 1 year).

14. **MAP OF PROPOSED PROJECT REQUIRED** - Attach an 8½" x 11" map or maps clearly identifying the proposed point of diversion, place of use, section #, township & range. The map scale shall not be less than two (2) inches equal to one (1) mile.

The information contained in this application is true to the best of my knowledge. I understand that any willful misrepresentations made in this application may result in rejection of the application or cancellation of an approval.

Dennis C Gordon  
Signature of Applicant  
DENNIS C GORDON  
Print Name (and title, if applicable)

Patricia Gordon  
Signature of Applicant  
PATRICIA GORDON  
Print Name (and title, if applicable)

**General Vicinity Map of Proposed Water Right Application  
at 217 Birch Banks Road, Sagle, ID**

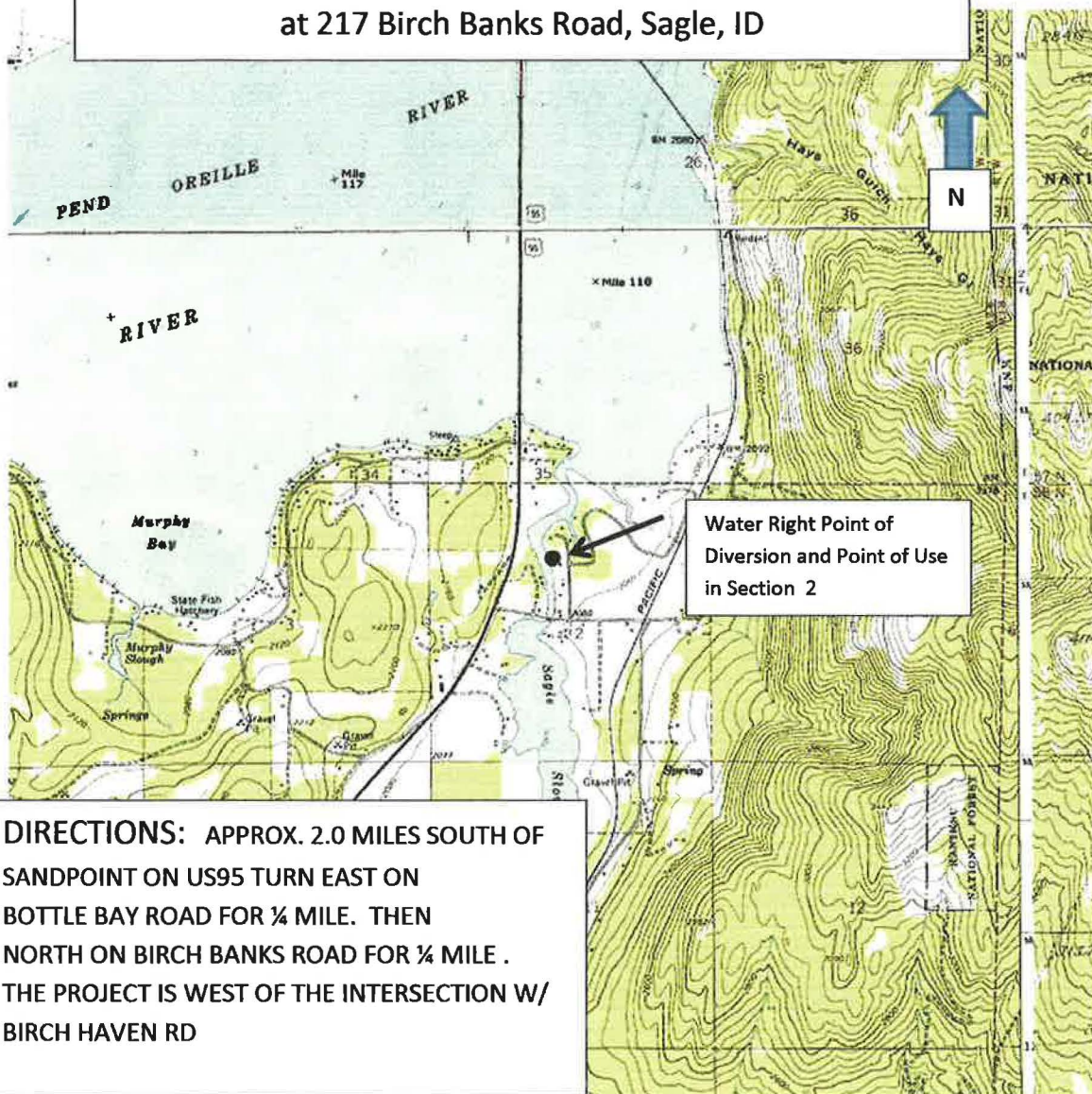

**DIRECTIONS:** APPROX. 2.0 MILES SOUTH OF  
SANDPOINT ON US95 TURN EAST ON  
BOTTLE BAY ROAD FOR ¼ MILE. THEN  
NORTH ON BIRCH BANKS ROAD FOR ¼ MILE .  
THE PROJECT IS WEST OF THE INTERSECTION W/  
BIRCH HAVEN RD

**Water Right Application**

Dennis and Patricia Gordon  
245 Birch Banks Road  
Sagle, ID  
Lake Pend Oreille  
Bonner County, ID

## Location of Proposed Water Right:

217 Birch Banks Road, Sagle, ID 83860

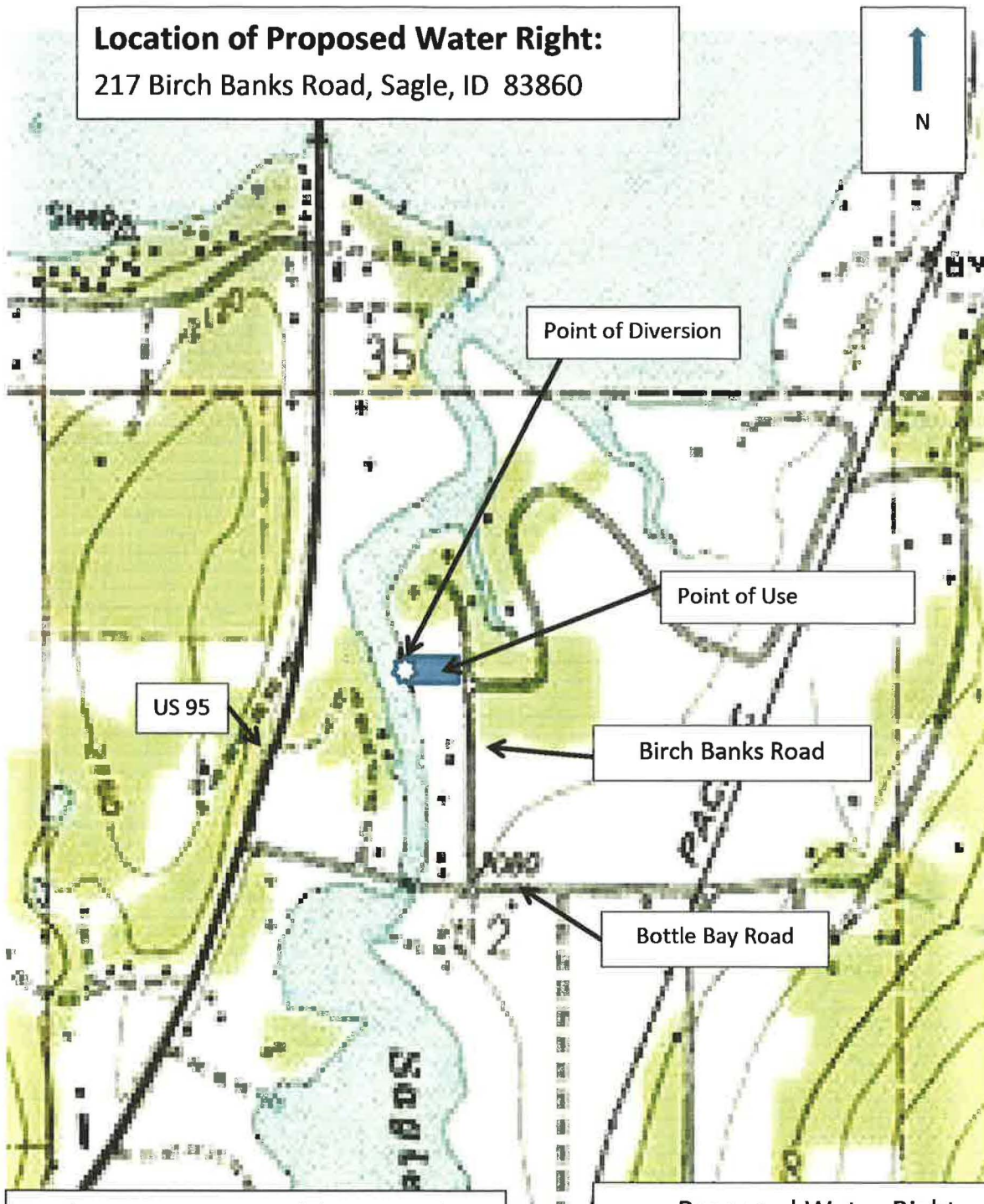

Legal Description of point of diversion and point of use:

Lot 12, Block 1 of Birch Bank Lots

SE  $\frac{1}{4}$  of NW  $\frac{1}{4}$  Sec.2, T 56N R2

Coordinates:

Diversion 48 14 00.02N, 116 32 01.37W

Use 48 13 59.61N, 116 32 09.83W

## Proposed Water Right

Dennis and Patricia Gordon

245 Birch Banks Road

Sagle, ID

Pend Oreille

Bonner county, ID

April 23, 2020



State of Idaho

## DEPARTMENT OF WATER RESOURCES

NORTHERN Region • 7600 N MINERAL DR STE 100 • COEUR D ALENE, ID 83815-7763  
Phone: (208)762-2800 • Fax: (208)769-2819 • Website: [www.idwr.idaho.gov](http://www.idwr.idaho.gov)

Brad Little  
Governor

Gary Spackman  
Director

May 13, 2020

DENNIS GORDON  
PATRICIA GORDON  
245 BIRCH BANKS RD  
SAGLE, ID 83860-9262

RE: Applications for Permit No. 96-9802 & 96-9803

Dear Applicants:

The Department of Water Resources has received your water right applications. Please refer to the numbers referenced above in all future correspondence regarding these applications.

A legal notice of the applications have been prepared and are scheduled for publication in the BONNER COUNTY DAILY BEE on 5/21/2020 and 5/28/2020. Protests to these applications may be submitted for a period ending ten (10) days after the second publication.

If the application(s) is/are protested, you will be sent a copy of each protest. All protests must be resolved before the application(s) can be considered for approval. If the protest(s) cannot be resolved voluntarily, the Department will conduct a conference and/or hearing on the matter.

If the applications are not protested, the Department will process your applications and notify you of any action taken on the applications. If your applications are approved, the Department will send you a copy of the permits.

Please contact this office if you have any questions regarding the applications.

Sincerely,

A handwritten signature in blue ink that reads 'Tammy Alleman'.

Tammy Alleman  
Administrative Assistant

## Alleman, Tammy

---

**From:** Alleman, Tammy  
**Sent:** Wednesday, May 13, 2020 1:49 PM  
**To:** 'Amidy Fuson'; 'Mike Ahmer'; 'Chantilly.Higbee@deq.idaho.gov';  
'Anna.Moody@deq.idaho.gov'; 'Horsmon,Merritt'  
**Subject:** Request for Comments on WR# 96-9802

Dear Interested Agencies:

The Department of Water Resources is seeking written comment and/or recommendations from your agency regarding the above referenced Water Right application. You can find copies of the application attached to the email and also at: <http://www.idwr.idaho.gov/apps/ExtSearch/WRAJSearch/WRADJSearch.aspx>.

This office can publish notice of the application as soon as the initial review is completed; therefore, your prompt response to this request is appreciated. If your agency desires to formally protest the approval of the application, you may do so after the notice is published by filing a written protest along with a \$25.00 filing fee within 10 days after final publication. The deadline for comments on the application is June 8, 2020.

Please contact the Northern Region Office at (208) 762-2800 if you have any questions regarding the application.

Thank you,

Tammy

*Tammy Alleman  
Administrative Assistant  
Idaho Department of Water Resources  
7600 N Mineral Drive, Suite 100  
Coeur d'Alene, ID 83815-7763  
Phone: (208) 762-2800  
Fax (208) 762-2819*

**Alleman, Tammy**

---

**From:** Alleman, Tammy  
**Sent:** Wednesday, May 13, 2020 1:48 PM  
**To:** 'bcdblegals@cdapress.com'  
**Subject:** Legal Notice  
**Attachments:** Legal Notice for 96-9802 through 96-9805.docx

Please publish the enclosed legal notice in the **Bonner County Daily Bee** on the dates indicated **May 21<sup>st</sup> & May 28<sup>th</sup>, 2020** (once a week for two consecutive weekly issues). If you cannot publish the notice on the proposed dates, please contact us immediately. Please send a proof once you have the article ready for print for our review.

An affidavit of publication must be submitted to the Department along with the publication bill. Please send the affidavit and bill to this office before **June 8, 2020**. Your cooperation is appreciated.

Thank you,

Tammy

*Tammy Alleman  
Administrative Assistant  
Idaho Department of Water Resources  
7600 N Mineral Drive, Suite 100  
Coeur d'Alene, ID 83815-7763  
Phone: (208) 762-2800  
Fax (208) 762-2819*

The following application(s) have been filed to appropriate the public waters of the State of Idaho:

**96-9802**

DENNIS GORDON  
PATRICIA GORDON  
245 BIRCH BANKS RD  
SAGLE, ID 83860-9262  
Point of Diversion L3(NENW)  
S2 T56N R02W  
BONNER County  
Source LAKE PEND OREILLE  
Tributary PEND OREILLE RIVER  
Use: IRRIGATION  
04/01 to 10/31  
Total Diversion: 0.03 CFS  
Date Filed: 05-06-2020  
Place Of Use: IRRIGATION  
T56N R02W S2 L3(NENW)  
Total Acres: 0.5

**96-9803**

DENNIS GORDON  
PATRICIA GORDON  
245 BIRCH BANKS RD  
SAGLE, ID 83860-9262  
Point of Diversion SENW  
S2 T56N R02W  
BONNER County  
Source LAKE PEND OREILLE  
Tributary PEND OREILLE RIVER  
Use: IRRIGATION  
04/01 to 10/31  
Total Diversion: 0.03 CFS  
Date Filed: 05-06-2020  
Place Of Use: IRRIGATION  
T56N R02W S2 SENW  
Total Acres: 0.5

**96-9804**

DAN STAGLUND  
PATRICIA SCHWARTZ  
26 WATERVIEW LN  
SAGLE, ID 83860-9791  
Point of Diversion L3(SENW)  
S3 T56N R02W  
BONNER County  
Source PEND OREILLE RIVER  
Tributary COLUMBIA RIVER  
Use: IRRIGATION  
04/01 to 10/31  
Total Diversion: 0.08 CFS  
Date Filed: 05-06-2020  
Place Of Use: IRRIGATION  
T56N R02W S3  
L3(SENW)  
Total Acres: 2.5

**96-9805**

MARIE FORBES  
LANCE FORBES  
13482 W PINE ST  
SANDPOINT, ID 83864-7323  
Point of Diversion NESW  
S30 T57N R02W  
BONNER County  
Source GROUND WATER  
Use: IRRIGATION  
04/01 to 10/31  
Total Diversion: 0.06 CFS  
Date Filed: 05-11-2020  
Place Of Use: IRRIGATION  
T57N R02W S30  
NESW, SENW  
Total Acres: 3

Permits will be subject to all prior water rights. For additional information concerning the property location, contact the Northern office at (208)762-2800; or for a full description of the right(s), please see <https://idwr.idaho.gov/apps/ExtSearch/WRAApplicationResults/>. Protests may be submitted based on the criteria of Idaho Code § 42-203A. Any protest against the approval of this application must be filed with the Director, Dept. of Water Resources, Northern Region, 7600 N MINERAL DR STE 100, COEUR D'ALENE ID 83815-7763 together with a protest fee of \$25.00 for each application on or before 6/8/2020. The protestant must also send a copy of the protest to the applicant.

GARY SPACKMAN, Director

Published on 5/21/2020 and 5/28/2020