

RECEIVED

MAY 06 2020

IDWR/NORTH

FORM 202 Rev. 09/16

84049

STATE OF IDAHO
DEPARTMENT OF WATER RESOURCES
APPLICATION FOR PERMIT
To appropriate the public waters of the State of Idaho

Ident. No. 96-9803

Name of applicant(s) DENNIS GORDON & PATRICIA GORDON Phone 406-369-2433

Name connector (check one): ☒ and ☐ or ☐ and/or

Mailing address 245 BIRCH BANKS ROAD City SAGLE

State IDAHO ZIP 83860 Email NCRCONSULTINGDG@GMAIL.COM

2. Name of representative, if any N/A Phone _____

Mailing address _____ City _____

State _____ ZIP _____ Email _____

a. ☐ Send all correspondence for this application to the representative and not to the applicant OR

☒ Send original correspondence to the applicant and copies to the representative.

b. ☐ The representative may submit information for the applicant but is not authorized to sign for the applicant OR

☐ The representative is authorized to sign for the applicant. Attach a Power of Attorney or other documentation.

3. Source of water supply LAKE PEND O'REILLE which is a tributary of PEND O'REILLE RIVER

4. Location of point(s) of diversion:

Twp	Rge	Sec	Govt Lot	1/4	1/4	1/4	County	Source	Local name or tag #
56N	2W	2			SE	NW	BONNER	LAKE PEND O'REILLE	

5. Water will be used for the following purposes:

Amount 0.03 CFS for IRRIGATION purposes from 4/1 to 10/31 (both dates inclusive)
(cfs or acre-feet per year)

Amount _____ for _____ purposes from _____ to _____ (both dates inclusive)
(cfs or acre-feet per year)

Amount _____ for _____ purposes from _____ to _____ (both dates inclusive)
(cfs or acre-feet per year)

Amount _____ for _____ purposes from _____ to _____ (both dates inclusive)
(cfs or acre-feet per year)

6. Total quantity to be appropriated is (a) 0.03 cubic feet per second (cfs) and/or (b) _____ acre-feet per year (af).

7. Proposed diverting works:

a. Describe type and size of devices used to divert water from the source. 1 HP ELECTRIC PUMP WITH 1 1/4 SUCTION PIPE FROM LAKE

b. Height of storage dam N/A feet; active reservoir capacity _____ acre-feet; total reservoir capacity _____ acre-feet. If the reservoir will be filled more than once each year, describe the refill plan in item 12. For dams 10 feet or more in height AND having a storage capacity of 50 acre-feet or more, submit a separate

Application required? ☐ Yes ☐ No

c. Proposed well diameter is _____ inches; proposed depth of well is _____ feet.

d. Is ground water with a temperature of greater than 85°F being sought? ☐ Yes ☐ No

e. If well is already drilled, when? _____; drilling firm _____; well was drilled for (well owner) _____; Drilling Permit No. _____

For Department Use

Received by TA Date 4-27-2020 Time _____ Preliminary check by _____

Fee \$ 100.00 Received by TA Receipt No. NO 36034 Date 4-27-2020

8. Description of proposed uses (if irrigation only, go to item 9):

- Hydropower; show total feet of head and proposed capacity in kW. _____
- Stockwatering; list number and kind of livestock. _____
- Municipal; must complete and attach the Municipal Water Right Application Checklist.
- Domestic; show number of households _____
- Other; describe fully. _____

9. Description of place of use:

- If water is for irrigation, indicate acreage in each subdivision in the tabulation below.
- If water is used for other purposes, place a symbol of the use (example: D for Domestic) in the corresponding place of use below. See instructions for standard symbols.

TWP	RGE	SEC	NE				NW				SW				SE				TOTALS
			NE	NW	SW	SE	NE	NW	SW	SE	NE	NW	SW	SE	NE	NW	SW	SE	
56 N	2W	2								0.5									0.5

Total number of acres to be irrigated: 0.5

10. Describe any other water rights used for the same purposes as described above. Include water delivered by a municipality, canal company, or irrigation district. If this application is for domestic purposes, do you intend to use this water, water from another source, or both, to irrigate your lawn, garden, and/or landscaping? _____

- Who owns the property at the point of diversion? APPLICANT
- Who owns the land to be irrigated or place of use? APPLICANT
- If the property is owned by a person other than the applicant, describe the arrangement enabling the applicant to make this filing: N/A

12. Describe your proposal in narrative form, and provide additional explanation for any of the items above. Attach additional pages if necessary. APPLICANT PLANS TO USE WATER FROM LAKE TO IRRIGATE LAWN, GARDEN, AND LANDSCAPE. POU IS FOR LOT 12.

13. Time required for completion of works and application of water to proposed beneficial use is 5 years (minimum 1 year).

14. **MAP OF PROPOSED PROJECT REQUIRED** - Attach an 8½" x 11" map or maps clearly identifying the proposed point of diversion, place of use, section #, township & range. The map scale shall not be less than two (2) inches equal to one (1) mile.

The information contained in this application is true to the best of my knowledge. I understand that any willful misrepresentations made in this application may result in rejection of the application or cancellation of an approval.

Signature of Applicant

DENNIS C GORDON
Print Name (and title, if applicable)

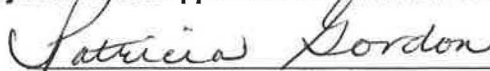
Signature of Applicant

PATRICIA GORDON
Print Name (and title, if applicable)



Legend

- Parcels
- Township/Range
- Sections
- QQ
- 2013 (0.5 meter)**
- RGB**
- Red: Red
- Green: Green
- Blue: Blue

0 0.0175 0.035 0.07 Miles



APR 27 2020

DEPARTMENT OF WATER RESOURCES
APPLICATION FOR PERMIT
To appropriate the public waters of the State of Idaho

IDWR / NORTH

- Name of applicant(s) DENNIS GORDON & PATRICIA GORDON Phone 406.369.2433
Name connector (check one): ☒ and ☐ or ☐ and/or
Mailing address 245 BIRCH BANKS ROAD City SAGE
State IDAHO ZIP 83860 Email ncrconsulting4@gmail.com
- Name of representative, if any NA Phone _____
Mailing address _____ City _____
State _____ ZIP _____ Email _____
- a. ☐ Send all correspondence for this application to the representative and not to the applicant OR
☒ Send original correspondence to the applicant and copies to the representative.
- b. ☐ The representative may submit information for the applicant but is not authorized to sign for the applicant OR
☐ The representative is authorized to sign for the applicant. Attach a Power of Attorney or other documentation.
- Source of water supply LAKE PEND O'REILLE which is a tributary of CLARK FORK RIVER
- Location of point(s) of diversion:

Twp	Rge	Sec	Govt Lot	1/4	1/4	1/4	County	Source	Local name or tag #
56N	2W	2		SE	NW		BONNER	LAKE PEND O'REILLE	

- Water will be used for the following purposes:
Amount 1 ACRE FEET for IRRIGATION purposes from APRIL 15 to OCT. 15 (both dates inclusive)
(cfs or acre-feet per year)
Amount _____ for _____ purposes from _____ to _____ (both dates inclusive)
(cfs or acre-feet per year)
Amount _____ for _____ purposes from _____ to _____ (both dates inclusive)
(cfs or acre-feet per year)
Amount _____ for _____ purposes from _____ to _____ (both dates inclusive)
(cfs or acre-feet per year)
- Total quantity to be appropriated is (a) _____ cubic feet per second (cfs) and/or (b) _____ acre-feet per year (af).
- Proposed diverting works:
 - Describe type and size of devices used to divert water from the source. 1 HP ELECTRIC PUMP WITH 1 1/4" SUCTION PIPE
 - Height of storage dam NA feet; active reservoir capacity _____ acre-feet; total reservoir capacity _____ acre-feet. If the reservoir will be filled more than once each year, describe the refill plan in item 12. For dams 10 feet or more in height AND having a storage capacity of 50 acre-feet or more, submit a separate Application required? ☐ Yes ☐ No
 - Proposed well diameter is NA inches; proposed depth of well is _____ feet.
 - Is ground water with a temperature of greater than 85°F being sought? ☐ Yes ☐ No
 - If well is already drilled, when? _____; drilling firm _____; well was drilled for (well owner) _____; Drilling Permit No. _____

SUPERSEDED

For Department Use

Received by JA Date 4-27-2020 Time _____ Preliminary check by _____
Fee \$ 1000 Receipted by JA Receipt No. N036035 Date 4-27-2020

8. Description of proposed uses (if irrigation only, go to item 9):

- Hydropower; show total feet of head and proposed capacity in kW. _____
- Stockwatering; list number and kind of livestock. _____
- Municipal; must complete and attach the _____
- Domestic; show number of households _____
- Other; describe fully. _____

9. Description of place of use:

- If water is for irrigation, indicate acreage in each subdivision in the tabulation below.
- If water is used for other purposes, place a symbol of the use (example: D for Domestic) in the corresponding place of use below. See instructions for standard symbols.

TWP	RGE	SEC	NE				NW				SW				SE				TOTALS
			NE	NW	SW	SE	NE	NW	SW	SE	NE	NW	SW	SE	NE	NW	SW	SE	
56N	2W	2								1/2									
										IRRIGATION									

Total number of acres to be irrigated: 1/2 ACRE

10. Describe any other water rights used for the same purposes as described above. Include water delivered by a municipality, canal company, or irrigation district. If this application is for domestic purposes, do you intend to use this water, water from another source, or both, to irrigate your lawn, garden, and/or landscaping? THIS WATER TO IRRIGATE LAWN, GARDEN AND LANDSCAPING

- Who owns the property at the point of diversion? APPLICANT
- Who owns the land to be irrigated or place of use? APPLICANT
- If the property is owned by a person other than the applicant, describe the arrangement enabling the applicant to make this filing: N/A

12. Describe your proposal in narrative form, and provide additional explanation for any of the items above. Attach additional pages if necessary. _____

POINT OF DIVERSION = 48° 14' 01.66" N, 116° 32' 14.14" W

POINT OF USE : 48° 14' 01.55" N, 116° 32' 10.36" W

13. Time required for completion of works and application of water to proposed beneficial use is 1 years (minimum 1 year).

14. **MAP OF PROPOSED PROJECT REQUIRED** - Attach an 8½" x 11" map or maps clearly identifying the proposed point of diversion, place of use, section #, township & range. The map scale shall not be less than two (2) inches equal to one (1) mile.

The information contained in this application is true to the best of my knowledge. I understand that any willful misrepresentations made in this application may result in rejection of the application or cancellation of an approval.

[Signature]
 Signature of Applicant
DENNIS C GORDON
 Print Name (and title, if applicable)

[Signature]
 Signature of Applicant
PATRICIA GORDON
 Print Name (and title, if applicable)

General Vicinity Map Associated of
Proposed Water Right Application
at 245 Birch Banks Road, Sagle, ID

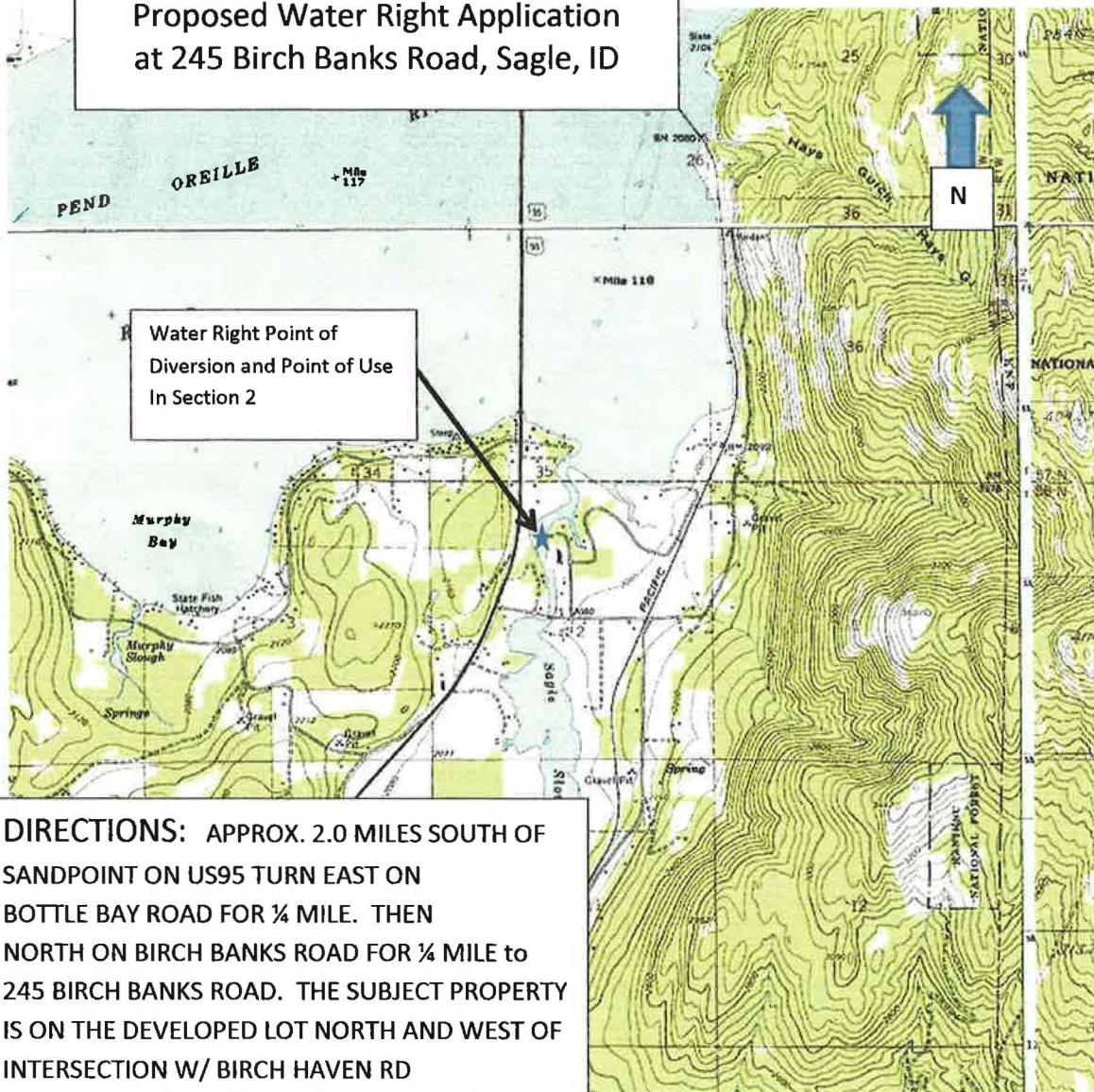

Water Right Application

Dennis and Patricia Gordon
245 Birch Banks Road
Sagle, ID
Lake Pend Oreille
Bonner County, ID

April 23, 2020

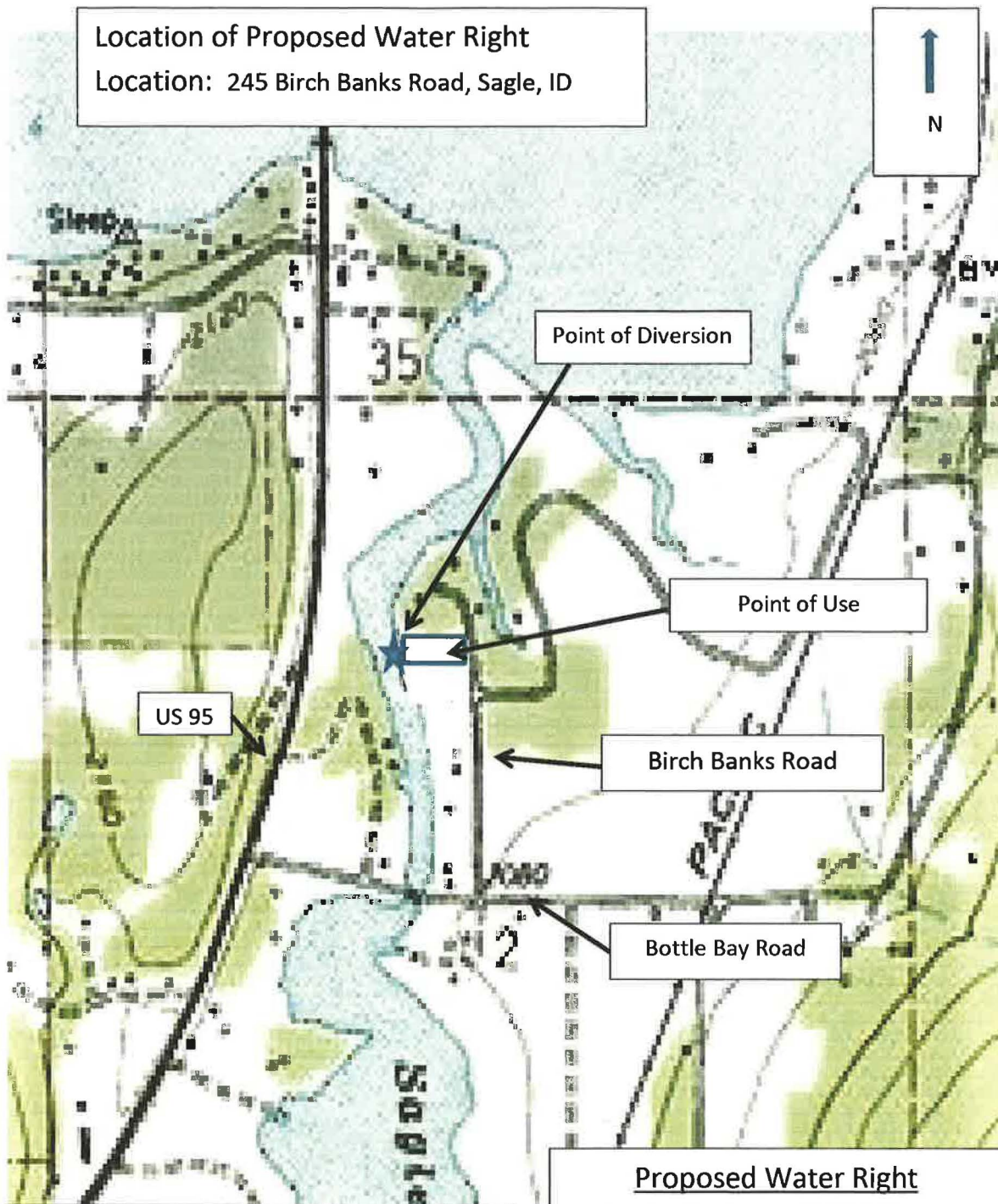

Legal Description of point of diversion and
point of use:

Lot 14, Block 1 of Birch Bank Lots
SE ¼ of NW ¼ Sec.2, T 56N R2W
Lat./Long.: 48.13.59N, 116.32.12W

Proposed Water Right

Dennis Gordon and Patricia Gordon
245 Birch Banks Road
Sagle, ID
Lake Pend Oreille
Bonner County, ID

April 23, 2020



Brad Little
Governor

State of Idaho

DEPARTMENT OF WATER RESOURCES

NORTHERN Region • 7600 N MINERAL DR STE 100 • COEUR D'ALENE, ID 83815-7763
Phone: (208)762-2800 • Fax: (208)769-2819 • Website: www.idwr.idaho.gov

Gary Spackman
Director

May 13, 2020

DENNIS GORDON
PATRICIA GORDON
245 BIRCH BANKS RD
SAGLE, ID 83860-9262

RE: Applications for Permit No. 96-9802 & 96-9803

Dear Applicants:

The Department of Water Resources has received your water right applications. Please refer to the numbers referenced above in all future correspondence regarding these applications.

A legal notice of the applications have been prepared and are scheduled for publication in the BONNER COUNTY DAILY BEE on 5/21/2020 and 5/28/2020. Protests to these applications may be submitted for a period ending ten (10) days after the second publication.

If the application(s) is/are protested, you will be sent a copy of each protest. All protests must be resolved before the application(s) can be considered for approval. If the protest(s) cannot be resolved voluntarily, the Department will conduct a conference and/or hearing on the matter.

If the applications are not protested, the Department will process your applications and notify you of any action taken on the applications. If your applications are approved, the Department will send you a copy of the permits.

Please contact this office if you have any questions regarding the applications.

Sincerely,

Tammy Alleman
Administrative Assistant

Alleman, Tammy

From: Alleman, Tammy
Sent: Wednesday, May 13, 2020 1:50 PM
To: 'Amidy Fuson'; 'Mike Ahmer'; 'Chantilly.Higbee@deq.idaho.gov';
'Anna.Moody@deq.idaho.gov'; 'Horsmon,Merritt'
Subject: Request for Comments on WR# 96-9803

Dear Interested Agencies:

The Department of Water Resources is seeking written comment and/or recommendations from your agency regarding the above referenced Water Right application. You can find copies of the application attached to the email and also at: <http://www.idwr.idaho.gov/apps/ExtSearch/WRAJSearch/WRADJSearch.aspx>.

This office can publish notice of the application as soon as the initial review is completed; therefore, your prompt response to this request is appreciated. If your agency desires to formally protest the approval of the application, you may do so after the notice is published by filing a written protest along with a \$25.00 filing fee within 10 days after final publication. The deadline for comments on the application is June 8, 2020.

Please contact the Northern Region Office at (208) 762-2800 if you have any questions regarding the application.

Thank you,

Tammy

*Tammy Alleman
Administrative Assistant
Idaho Department of Water Resources
7600 N Mineral Drive, Suite 100
Coeur d'Alene, ID 83815-7763
Phone: (208) 762-2800
Fax (208) 762-2819*

Alleman, Tammy

From: Alleman, Tammy
Sent: Wednesday, May 13, 2020 1:48 PM
To: 'bcdblegals@cdapress.com'
Subject: Legal Notice
Attachments: Legal Notice for 96-9802 through 96-9805.docx

Please publish the enclosed legal notice in the **Bonner County Daily Bee** on the dates indicated **May 21st & May 28th, 2020** (once a week for two consecutive weekly issues). If you cannot publish the notice on the proposed dates, please contact us immediately. Please send a proof once you have the article ready for print for our review.

An affidavit of publication must be submitted to the Department along with the publication bill. Please send the affidavit and bill to this office before **June 8, 2020**. Your cooperation is appreciated.

Thank you,

Tammy

*Tammy Alleman
Administrative Assistant
Idaho Department of Water Resources
7600 N Mineral Drive, Suite 100
Coeur d'Alene, ID 83815-7763
Phone: (208) 762-2800
Fax (208) 762-2819*

The following application(s) have been filed to appropriate the public waters of the State of Idaho:

96-9802

DENNIS GORDON
PATRICIA GORDON
245 BIRCH BANKS RD
SAGLE, ID 83860-9262
Point of Diversion L3(NENW)
S2 T56N R02W
BONNER County
Source LAKE PEND OREILLE
Tributary PEND OREILLE RIVER
Use: IRRIGATION
04/01 to 10/31
Total Diversion: 0.03 CFS
Date Filed: 05-06-2020
Place Of Use: IRRIGATION
T56N R02W S2 L3(NENW)
Total Acres: 0.5

96-9803

DENNIS GORDON
PATRICIA GORDON
245 BIRCH BANKS RD
SAGLE, ID 83860-9262
Point of Diversion SENW
S2 T56N R02W
BONNER County
Source LAKE PEND OREILLE
Tributary PEND OREILLE RIVER
Use: IRRIGATION
04/01 to 10/31
Total Diversion: 0.03 CFS
Date Filed: 05-06-2020
Place Of Use: IRRIGATION
T56N R02W S2 SENW
Total Acres: 0.5

96-9804

DAN STAGLUND
PATRICIA SCHWARTZ
26 WATERVIEW LN
SAGLE, ID 83860-9791
Point of Diversion L3(SENW)
S3 T56N R02W
BONNER County
Source PEND OREILLE RIVER
Tributary COLUMBIA RIVER
Use: IRRIGATION
04/01 to 10/31
Total Diversion: 0.08 CFS
Date Filed: 05-06-2020
Place Of Use: IRRIGATION
T56N R02W S3
L3(SENW)
Total Acres: 2.5

96-9805

MARIE FORBES
LANCE FORBES
13482 W PINE ST
SANDPOINT, ID 83864-7323
Point of Diversion NESW
S30 T57N R02W
BONNER County
Source GROUND WATER
Use: IRRIGATION
04/01 to 10/31
Total Diversion: 0.06 CFS
Date Filed: 05-11-2020
Place Of Use: IRRIGATION
T57N R02W S30
NESW, SENW
Total Acres: 3

Permits will be subject to all prior water rights. For additional information concerning the property location, contact the Northern office at (208)762-2800; or for a full description of the right(s), please see <https://idwr.idaho.gov/apps/ExtSearch/WRAApplicationResults/>. Protests may be submitted based on the criteria of Idaho Code § 42-203A. Any protest against the approval of this application must be filed with the Director, Dept. of Water Resources, Northern Region, 7600 N MINERAL DR STE 100, COEUR D'ALENE ID 83815-7763 together with a protest fee of \$25.00 for each application on or before 6/8/2020. The protestant must also send a copy of the protest to the applicant.

GARY SPACKMAN, Director

Published on 5/21/2020 and 5/28/2020