

IDAHO DEPARTMENT OF WATER RESOURCES
Proof Report

6/3/2020

Water Permit 41-7050

Owner Type **Name and Address**
Current Owner STEPHEN E WEGNER
 PO BOX 242
 ROCKLAND, ID 83271
 (208) 548-2349

Current Owner F FRED WEGNER
 PO BOX 323
 ROCKLAND, ID 83271
 (208) 548-2247

Status: Lapsed

Source

Tributary

<u>Beneficial Use</u>	<u>From</u>	<u>To</u>	<u>Diversion Rate</u>	<u>Volume</u>
------------------------------	--------------------	------------------	------------------------------	----------------------

Source and Point(s) of Diversion

Place Of Use

Conditions of Approval:

Comments:

Dates and Other Information

Water District Number: TBD
Mitigation Plan: False

Combined Use Limits

N/A

SubCase:

N/A

Water Supply Bank:

N/A

6/3/2020

STATE OF IDAHO
DEPARTMENT OF WATER RESOURCES
APPLICATION FOR PERMIT

APPROVED

RECEIVED
JUN 8 1981
Department of Water Resources
SOUTHERN DISTRICT OFFICE

appropriate the public waters of the State of Idaho

1. Name of applicant Stephen E. Wegner &/or F. Fred Wegner Phone 548-2349

Post office address P.O. Box 323, Rockland, Idaho, 83271

2. Source of water supply Groundwater which is a tributary of _____

3. Location of point of diversion is SW $\frac{1}{4}$ of NE $\frac{1}{4}$ of Section 10 Township 11S

Range 30E B.M. Power County, additional points of diversion if any: _____

4. Water will be used for the following purposes:

Amount 1.00 for Irrigation purposes from Mar. 15 to Nov. 15 (both dates inclusive)
(cfs or acre-feet per annum)

Amount _____ for _____ purposes from _____ to _____ (both dates inclusive)
(cfs or acre-feet per annum)

Amount _____ for _____ purposes from _____ to _____ (both dates inclusive)
(cfs or acre-feet per annum)

Amount _____ for _____ purposes from _____ to _____ (both dates inclusive)
(cfs or acre-feet per annum)

5. Total quantity to be appropriated:

a. 1.00 cubic feet per second and/or b. _____ acre-feet per annum.

6. Proposed diverting works:

a. Description of ditches, flumes, pumps, headgates, etc. Well & Pump delivering to sprinkler
system

b. Height of storage dam _____ feet, active reservoir capacity _____ acre-feet; total reservoir
capacity _____ acre-feet, materials used in storage dam: _____

Period of year when water will be diverted to storage _____ to _____ inclusive.
(Month/Day) (Month/Day)

c. Proposed well diameter is 16 inches; proposed depth of well is 900 feet.

7. Time required for the completion of the works and application of the water to the proposed beneficial

use is 5 years (minimum 1 year — maximum 5 years).

8. Description of proposed uses:

a. If water is not for irrigation:

(1) Give the place of use of water: _____ $\frac{1}{4}$ of _____ $\frac{1}{4}$ of Section _____ Township _____

Range _____ B.M. _____

(2) Amount of power to be generated: _____ horsepower under _____ feet of head.

(3) List number of each kind of livestock to be watered _____

(4) Name of municipality to be served _____, or number of families to be
supplied with domestic water _____.

(5) If water is to be used for other purposes describe: _____

41-7050

b. If water is for irrigation, indicate acreage in each subdivision in the tabulation below:

TWP	RANGE	SEC.	NE¼				NW¼				SW¼				SE¼				TOTALS
			NE¼	NW¼	SW¼	SE¼	NE¼	NW¼	SW¼	SE¼	NE¼	NW¼	SW¼	SE¼	NE¼	NW¼	SW¼	SE¼	
11S	30E	10	40	40	40	40				40	40	40				40			320
		11						40	40										80
		3															40	40	80

Total number of acres to be irrigated 480

c. Describe any other water rights used for the same purposes as described above. _____

None

9. a. Who owns the property at the point of diversion Applicant

b. Who owns the land to be irrigated or place of use Applicant

c. If the property is owned by a person other than the applicant, describe the arrangement enabling the applicant to make this filing _____

10. Remarks Applicant filing on a well and will file additional permit if well proves to be good well.

11. Map of proposed project: show clearly the proposed point of diversion, place of use, section number, township and range number.

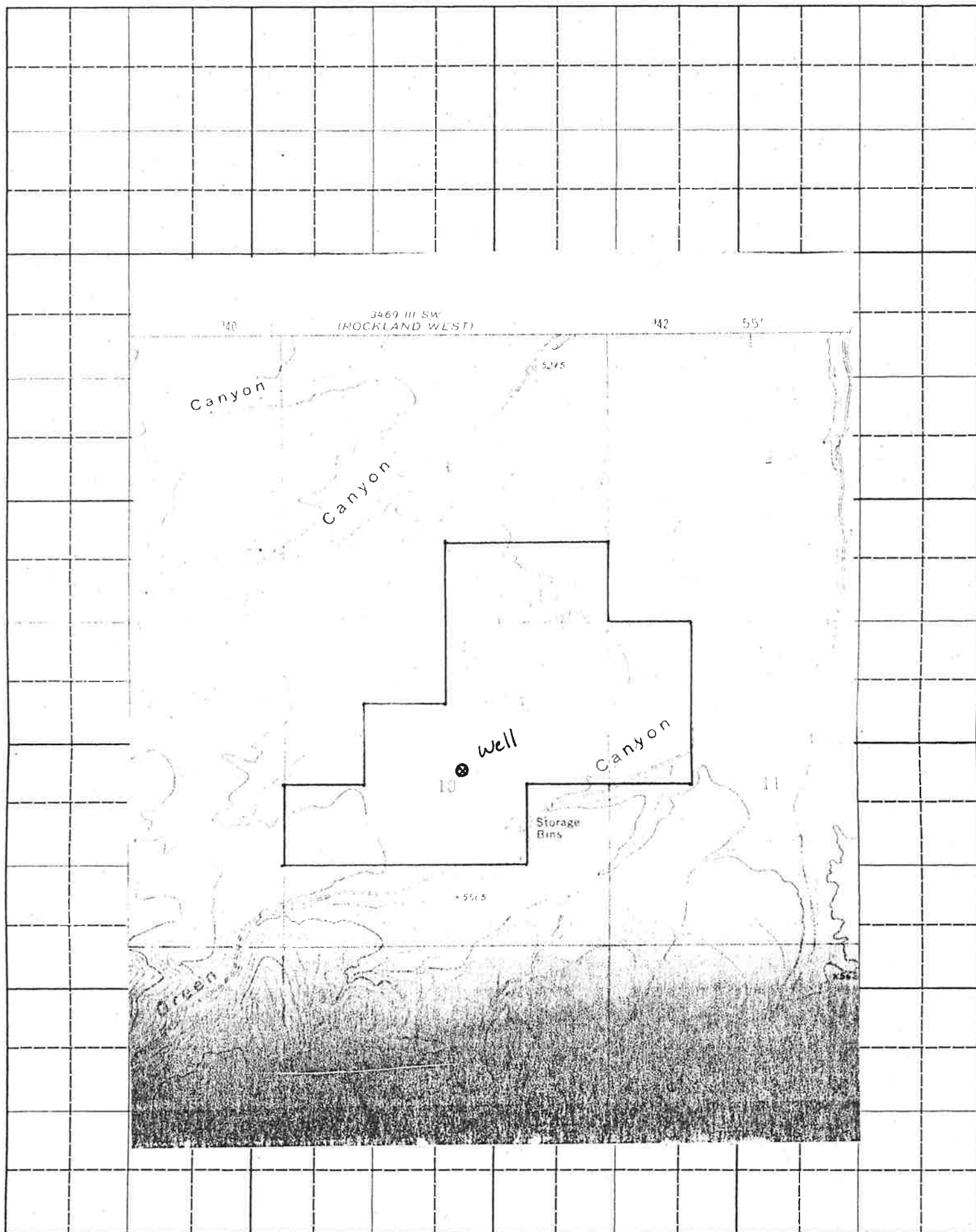

Scale: 2 inches equal 1 mile.

BE IT KNOWN that the undersigned hereby makes application for permit to appropriate the public waters of the State of Idaho as herein set forth.

Stephen C. Hepler
(Applicant)

Proposed Priority

4/6/81

Received by ADM Date 4/6/81 Time 11:00 am

Preliminary check by [initials] Fee \$ \$45⁰⁰

Received by ADM Date 4/6/81 # 16948

Publication prepared by [initials] Date 4/13/81

Published in Bureau Co. News

Publication dates 4/29 + 5/6/81

Publication approved [initials] Date 4/24/81

Protests filed by: None

Copies of protests forwarded by _____

Hearing held by _____ Date _____

Recommended for approval denial by ADM [initials]

ACTION OF THE DIRECTOR, DEPARTMENT OF WATER RESOURCES

This is to certify that I have examined Application for Permit to appropriate the public waters of the State of Idaho No. 41-7050, and said application is hereby approved.

1. Approval of said application is subject to the following limitations and conditions:

- a. SUBJECT TO ALL PRIOR WATER RIGHTS.
- b. Proof of construction of works and application of water to beneficial use shall be submitted on or before June 1, 19 86.
- c. The rate of diversion, if water is to be used for irrigation under this permit, when combined with all other water rights for the same land shall not exceed 0.02 cubic feet per second for each acre of land.
- d. Other: An access port or other device as specified by the Department shall be installed by the permit holder to provide for the installation of measuring equipment and the determination of the rate of diversion by the Department.

Witness my hand this 4th day of June, 19 81.

L. Glen Saxton