

IDAHO DEPARTMENT OF WATER RESOURCES  
Proof Report

6/5/2020

Water Permit 43-7061

<u>Owner Type</u>	<u>Name and Address</u>
Current Owner	MERLE JONES HC 72 BOX 2346 MALTA, ID 83342 (208) 824-5719

Status: Lapsed

Source

Tributary

Beneficial Use

From

To

Diversion Rate

Volume

Source and Point(s) of Diversion

Place Of Use

Conditions of Approval:

Comments:

Dates and Other Information

Water District Number: TBD  
Mitigation Plan: False

Combined Use Limits

N/A

SubCase:

N/A

Water Supply Bank:

N/A



IDAHO DEPARTMENT OF WATER RESOURCES  
Proof Report

6/5/2020

Water Application 43-7061

<u>Owner Type</u>	<u>Name and Address</u>
Current Owner	MERLE JONES HC 72 BOX 2346 MALTA, ID 83342 (208) 824-5719

Status: Closed

<u>Source</u>	<u>Tributary</u>
---------------	------------------

<u>Beneficial Use</u>	<u>From</u>	<u>To</u>	<u>Diversion Rate</u>	<u>Volume</u>
-----------------------	-------------	-----------	-----------------------	---------------

Source and Point(s) of Diversion

Place Of Use

Conditions of Approval:

Comments:

Dates and Other Information

Number of Protests: 0  
Water District Number: TBD  
Application Type: New Appropriation  
Mitigation Plan: False

Combined Use Limits

N/A

SubCase:

N/A

Water Supply Bank:

N/A

RECEIVED

MAY 18 1976

Department of Water Resources  
Southern District Office

STATE OF IDAHO  
DEPARTMENT OF WATER RESOURCES  
APPLICATION FOR PERMIT

RECEIVED

To Appropriate the Public Waters of the State of Idaho  
(TYPE OR PRINT IN INK)

FEB 11 1976

Department of Water Resources  
Southern District Office

1. Name of applicant Merle Jones Phone: 673-5608 (Naf Store)  
post office address Naf, Idaho
2. Source of water supply run-off water which is a tributary of Round mtw. Creek
3. a. Location of point of diversion is NW  $\frac{1}{4}$  of NW  $\frac{1}{4}$  of Section 19 Township 16S  
Range 28E B.M. Cassia County; additional points of diversion if any: \_\_\_\_\_
- b. If water is not consumed, it will be discharged into \_\_\_\_\_ at a point in \_\_\_\_\_  $\frac{1}{4}$   
of \_\_\_\_\_  $\frac{1}{4}$  of Section \_\_\_\_\_ Township \_\_\_\_\_ Range \_\_\_\_\_ B.M. \_\_\_\_\_
4. Water will be used for the following purposes:  
Amount 1000 storage for purpose from Jan. 1 to Dec. 31 (both dates inclusive)  
feet acre for irrigation (cfs or acre-feet per annum)  
Amount 1000 for irrigation purpose from March 15 to Nov. 15 (both dates inclusive)  
14.4 (cfs or acre-feet per annum)  
Amount 14.4 for irrigation purpose from March 15 to Nov. 15 (both dates inclusive)  
(cfs or acre-feet per annum)
5. Total quantity to be appropriated;  
a. 14.4 cubic feet per second and/or  
b. 1000 acre feet per annum.
6. Proposed diverting works:  
a. Description of ditches, flumes, pumps, headgates, etc. Dam and reservoir 16 feet high-  
1200 feet wide -  $\frac{1}{2}$  mile long at furthestest point
- b. Height of storage dam 16 feet, active reservoir capacity 1000 acre feet; total reservoir  
capacity 1000 acre feet, materials used in storage dam: dirt, rock & cement  
Period of year during which storage will occur Jan 1 to Dec 31 inclusive.  
(Mo. Day) (Mo. Day)
- c. Proposed well diameter is \_\_\_\_\_ inches; proposed depth of well is \_\_\_\_\_ feet.
7. a. Time required for the completion of the works and application of the water to the proposed beneficial use  
is 3 years.  
b. Estimated construction cost is \$ 20,000.
8. Description of proposed uses:  
a. If water is **not** for irrigation:  
(1) Give the place of use of water: \_\_\_\_\_  $\frac{1}{4}$  of \_\_\_\_\_  $\frac{1}{4}$  of Section \_\_\_\_\_ Township \_\_\_\_\_  
Range \_\_\_\_\_ B.M. \_\_\_\_\_  
(2) Amount of power to be generated: \_\_\_\_\_ hp under \_\_\_\_\_ feet of head.  
(3) List number of each kind of livestock to be watered \_\_\_\_\_  
(4) Name of municipality to be served \_\_\_\_\_, or number of families to be  
supplied with domestic water \_\_\_\_\_  
(5) If water is to be used for other purposes describe: flood control

43-7061

b. If water is for irrigation, indicate acreage in each subdivision in the tabulation below:

TWP.	RANGE	SEC.	NE1/4				NW1/4				SW1/4				SE1/4				TOTALS
			NE1/4	NW1/4	SW1/4	SE1/4	NE1/4	NW1/4	SW1/4	SE1/4	NE1/4	NW1/4	SW1/4	SE1/4	NE1/4	NW1/4	SW1/4	SE1/4	
16S	27E	12											40				40	40	120
16S	27E	13	40	40		40	40								40	40	40	40	320
16S	27E	13			40					40	40			40					160
16S	27	24	40	40	40														120

Total number of acres to be irrigated 720

c. Describe any other water rights used for the same purposes as described above. NONE

9. a. Who owns the property at the point of diversion Merle Jones

b. Who owns the land to be irrigated or place of use Merle Jones

c. If the property is owned by a person other than the applicant, describe the arrangement enabling the applicant to make this filing \_\_\_\_\_

10. Remarks The excessive cfs. is needed because the runoff period is short and the reservoir will fill in a relatively short period.

11. Map of proposed project: show clearly the proposed point of diversion, place of use, section number, township and range number.

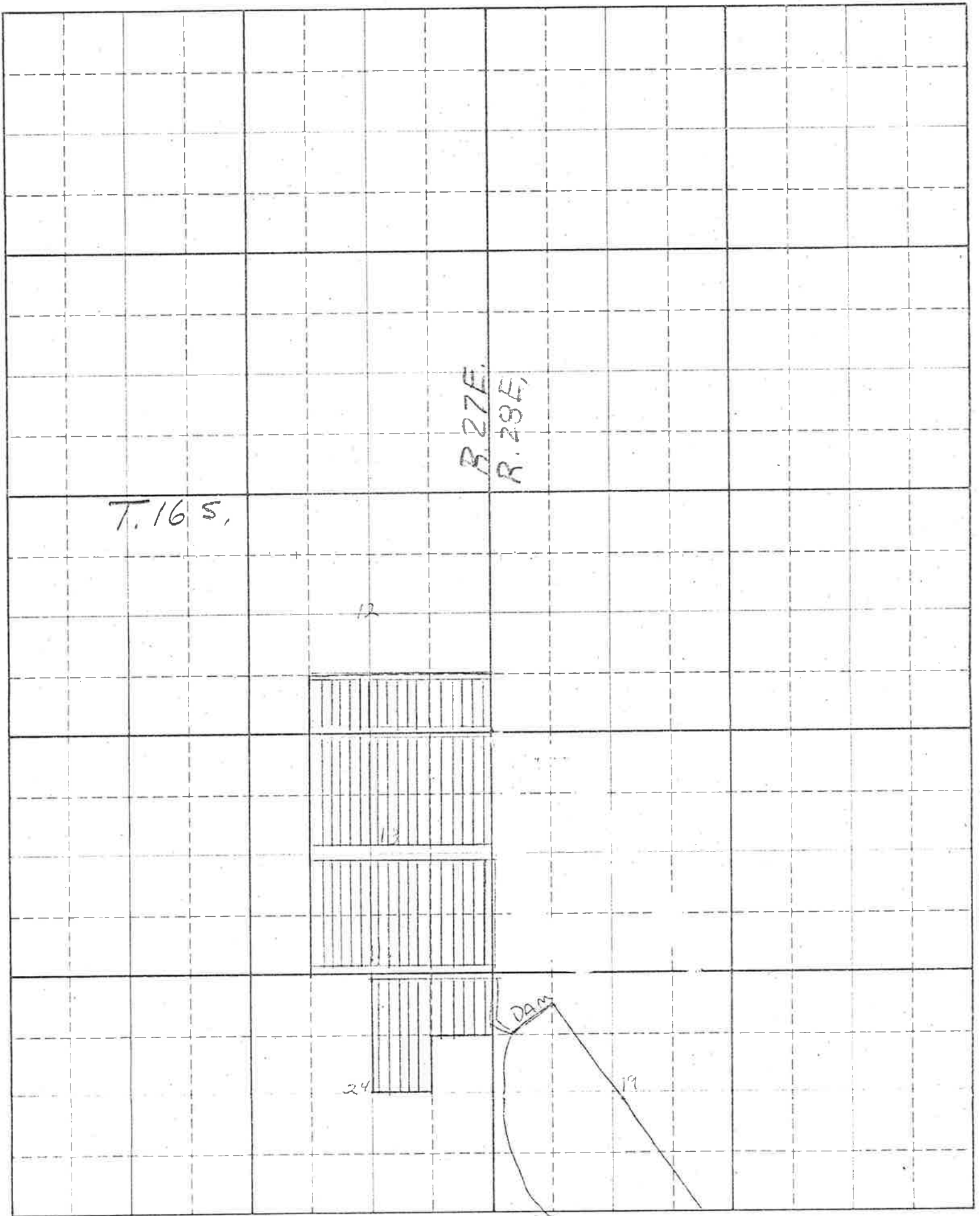

Scale: 2 inches equal 1 mile

BE IT KNOWN that the undersigned hereby makes application for permit to appropriate the public waters of the State of Idaho as herein set forth.

Merle Jones  
(Applicant)

Proposed Priority 3-18-76

Received by CC Date 3-18-76 Time 2:00 p.m.

Preliminary check by IB Fee \$ 165.00

# 2055

Received by CC Date 3-23-76

Publication prepared by CC Date 3-23-76

Published in So. Ida. Press

Publication dates 3-30 & 4-6-76

Publication approved CC Date 4-9-76

Priority reduced to \_\_\_\_\_ Reason \_\_\_\_\_

Protests filed by: \_\_\_\_\_

Copies of protests forwarded by \_\_\_\_\_

Hearing held by \_\_\_\_\_ Date \_\_\_\_\_

Recommended for approval denial by mls ~~DF~~

#### ACTION OF THE DIRECTOR, DEPARTMENT OF WATER RESOURCES

This is to certify that I have examined Application for Permit to appropriate the public waters of the State of Idaho No. 43-7061, and said application is hereby APPROVED.

1. Approval of said application is subject to the following limitations and conditions:

- a. SUBJECT TO ALL PRIOR WATER RIGHTS.
- b. Proof of construction of works and application of water to beneficial use shall be submitted on or before June 1, 19 79.
- c. Other: A measuring device of a type approved by the Director shall be permanently installed and maintained as part of the diverting works.

2. Denial of said application is for the following reasons: \_\_\_\_\_

Witness my hand this 14 day of May, 19 76.

  
Director