

IDAHO DEPARTMENT OF WATER RESOURCES
Proof Report

6/8/2020

Water Permit 43-7274

<u>Owner Type</u>	<u>Name and Address</u>
Current Owner	CHILD INVESTMENT/IDAHO FARMS CO , ZZ

Status: Relinquished

<u>Source</u>	<u>Tributary</u>
---------------	------------------

<u>Beneficial Use</u>	<u>From</u>	<u>To</u>	<u>Diversion Rate</u>	<u>Volume</u>
-----------------------	-------------	-----------	-----------------------	---------------

Source and Point(s) of Diversion

Place Of Use

Conditions of Approval:

Comments:

Dates and Other Information

Water District Number: TBD
Mitigation Plan: False

Combined Use Limits

N/A

SubCase:

N/A

Water Supply Bank:

N/A

IDAHO DEPARTMENT OF WATER RESOURCES
Proof Report

6/8/2020

Water Application 43-7274

<u>Owner Type</u>	<u>Name and Address</u>
Current Owner	CHILD INVESTMENT/IDAHO FARMS CO , ZZ

Status: Closed

<u>Source</u>	<u>Tributary</u>
---------------	------------------

<u>Beneficial Use</u>	<u>From</u>	<u>To</u>	<u>Diversion Rate</u>	<u>Volume</u>
-----------------------	-------------	-----------	-----------------------	---------------

Source and Point(s) of Diversion

Place Of Use

Conditions of Approval:

Comments:

Dates and Other Information

Number of Protests: 0
Water District Number: TBD
Application Type: New Appropriation
Mitigation Plan: False

Combined Use Limits

N/A

SubCase:

N/A

Water Supply Bank:

N/A

Date Sent to S.O.

FEB 10 1992

RECEIVED

To: Department of Water Resources
222 Shoshone Street East
Twin Falls, ID 83301

FEB 07 1992

Department of Water Resources
Southern Region Office

Gentlemen:

I/we wish to withdraw Application for Permit To Appropriate
the Public Waters of the State of Idaho, No. 43-7274
filed in the name of Child Investment/Idaho Farms Co

Dated this 6 day of Feb, 1992.

Robert Moss
Name

Manager
Title

Star Pt Box 33
Address

Duck Id 83323
Address

ATTEST:

43-7274

STATE OF IDAHO
DEPARTMENT OF WATER RESOURCES
APPLICATION FOR PERMIT

To appropriate the public waters of the State of Idaho

1. Name of applicant Child Investment/Idaho Farms Co. Phone _____

Post office address 1693 W. 2700 S., Syracuse, UT 84041

2. Source of water supply Warm Creek which is a tributary of Raft River

3. Location of point of diversion is SE $\frac{1}{4}$ of SE NW $\frac{1}{4}$ of NE $\frac{1}{4}$, Govt. Lot (Lot 2)

Sec. 34 2 Township 11S 12S Range 27E B.M. Cassia County; additional
Lot 2 or 3

points of diversion if any: (NW 1/4 NE 1/4 or NE 1/4 NW 1/4) Sec. 2 T. 12S R. 27E

POD & RATE OF DIVERSION CHANGED PER TELECON W/ ROBERT MOSS ON 12-13-90
TJD. 12-13-90

4. Water will be used for the following purposes:

Amount 2.00 for Irrigation purposes from Mar 15 to Nov 15 (both dates inclusive)
(cfs or acre-feet per annum)

Amount _____ for _____ purposes from _____ to _____ (both dates inclusive)
(cfs or acre-feet per annum)

Amount _____ for _____ purposes from _____ to _____ (both dates inclusive)
(cfs or acre-feet per annum)

Amount _____ for _____ purposes from _____ to _____ (both dates inclusive)
(cfs or acre-feet per annum)

5. Total quantity to be appropriated is (a) 12.68 2.00 and/or (b) _____
cubic feet per second acre feet per annum

6. Proposed diverting works:

a. Description of ditches, flumes, pumps, headgates, etc. Excavated ponds in stream channel;
pumps to sprinklers. / In 3 section Pump.

b. Height of storage dam _____ feet; active reservoir capacity _____ acre-feet; total
reservoir capacity _____ acre-feet; period of year when water will be diverted to storage:
_____ to _____ inclusive.

c. Proposed well diameter is _____ inches; proposed depth of well is _____ feet.

d. Is ground water with a temperature of greater than 90°F being sought? No

7. Time required for the completion of the works and application of the water to the proposed beneficial use is
5 years (minimum 1 year).

8. Description of proposed uses (if irrigation only, go to item 9):

- Hydropower; show total feet of head and proposed capacity in KW. _____
- Stockwatering; list number and kind of livestock. _____
- Municipal; show name of municipality. _____
- Domestic; show number of households. _____
- Other; describe fully. _____

9. Description of place of use:

- If water is for irrigation, indicate acreage in each subdivision in the tabulation below.
- If water is used for other purposes, place a symbol of the use (example: *D* for Domestic) in the corresponding place of use below. See instructions for standard symbols.

TWP	RANGE	SEC.	NE¼				NW¼				SW¼				SE¼				TOTALS
			NE¼	NW¼	SW¼	SE¼	NE¼	NW¼	SW¼	SE¼	NE¼	NW¼	SW¼	SE¼	NE¼	NW¼	SW¼	SE¼	
11S	27E	34	40	40	40	40			1st 00						40	40	40	40	320
12S	27E	2	Lt1 37	Lt2 37	40	40	Lt3 37	Lt4 37	✓ 40	40									308
		3	Lt1 3	Lt2 3															6

Total number of acres to be irrigated 634

10. Describe any other water rights used for the same purposes as described above. _____

Groundwater rights

- Who owns the property at the point of diversion? Applicant
- Who owns the land to be irrigated or place of use? "
- If the property is owned by a person other than the applicant, describe the arrangement enabling the applicant to make this filing. _____

12. Remarks: This stream rarely reached Raft River before the 1970's. Since then,
higher stream flows and previous rehabilitation of the Warm Creek channel,
have allowed a good flow of water to reach Raft River.
Use of surface water would greatly reduce our power costs as compared to
groundwater pumping.

Local contact is Clarence Parr, 810 South River Dr., Heyburn, ID

13. Map of proposed project: show clearly the proposed point of diversion, place of use, section number, township and range number.

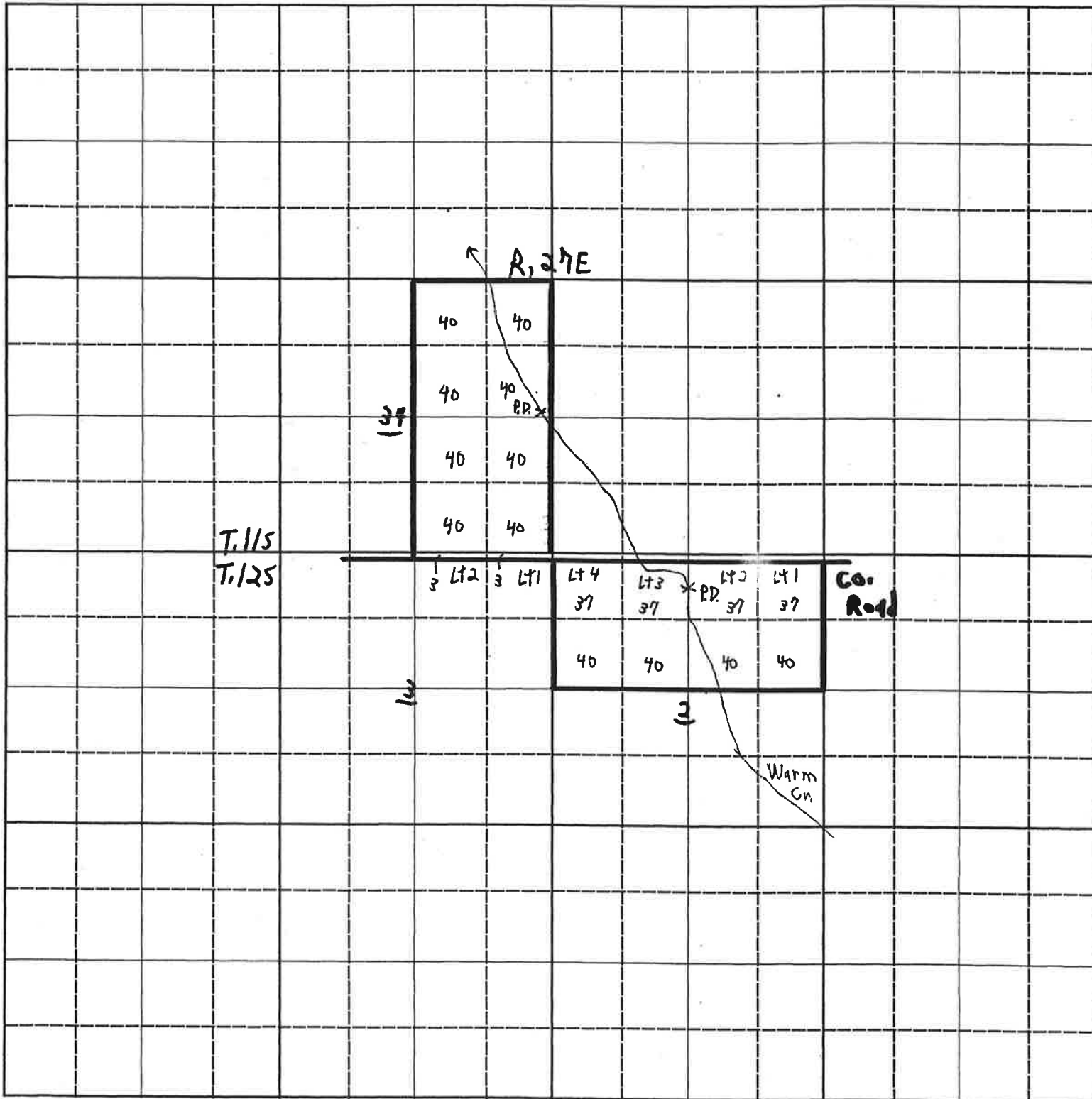

Scale: 2 inches equal 1 mile.

BE IT KNOWN that the undersigned hereby makes application for permit to appropriate the public waters of the State of Idaho as herein set forth.

Child Investment by the and for the
(Applicant)

Received by JP Date 5-1-86 Time 10:35 Preliminary check by D.S.
Fee \$ 285⁰⁰ Receipted by JP # 40093 Date 5-1-86
Publication prepared by ~~BM~~ BM Date 12-26-90 Published in So. Id Press
Publication approved TJL Date 1-17-91

ACTION OF THE DIRECTOR, DEPARTMENT OF WATER RESOURCES

This is to certify that I have examined Application for Permit to appropriate the public waters of the State of Idaho No. _____, and said application is hereby _____.

1. Approval of said application is subject to the following limitations and conditions:

a. SUBJECT TO ALL PRIOR WATER RIGHTS.

b. Proof of construction of works and application of water to beneficial use shall be submitted on or before _____, 19 ____.

c. The rate of diversion, if water is to be used for irrigation under this permit, when combined with all other water rights for the same land shall not exceed 0.02 cubic feet per second for each acre of land.

d. The water right acquired under this permit if for hydropower purposes shall be junior and subordinate to all rights to the use of water, other than hydropower, within the State of Idaho that are initiated later in time than the priority of this permit and shall not give rise to any right or claim against any future rights to the use of water, other than hydropower, within the State of Idaho initiated later in time than the priority of this permit.

e. Other: