

IDAHO DEPARTMENT OF WATER RESOURCES
Proof Report

6/9/2020

Water Permit 45-7122

<u>Owner Type</u>	<u>Name and Address</u>
Current Owner	L HAROLD STANGER 596 S 550 E BURLEY, ID 83318 (208) 678-2320

Status: Lapsed

Source

Tributary

<u>Beneficial Use</u>	<u>From</u>	<u>To</u>	<u>Diversion Rate</u>	<u>Volume</u>
------------------------------	--------------------	------------------	------------------------------	----------------------

Source and Point(s) of Diversion

Place Of Use

Conditions of Approval:

Comments:

Dates and Other Information

Water District Number: TBD
Mitigation Plan: False

Combined Use Limits

N/A

SubCase:

N/A

Water Supply Bank:

N/A

RECEIVED

JAN 31 1978

STATE OF IDAHO
DEPARTMENT OF WATER RESOURCES

Department of Water Resources
Southern District Office

APPLICATION FOR EXTENSION OF TIME

RECEIVED

FEB 14 1978

Department of Water Resources
Southern District Office

State of Idaho)
County of Twin Falls)

Permit No. 45-7122

L. Harold Stanger of Route 3 Box 202, Burley, Idaho 83318
(name) (address)

State of Idaho, being first duly sworn, upon his oath deposes and says:

That he is the holder, or the duly authorized agent of the holder *, of Permit to
Appropriate the Public Waters of the State of Idaho No. 45-7122.

That under the terms and conditions of said permit, work thereunder was required
to be completed on or before March 1, 1978.

That he has heretofore performed the following work described under said permit:

sprinklers for 80 acres have been purchased. well has not been dug yet.

Costing \$ 25,000.

That he is unable to complete the remainder of the work within the required time for
the following reasons, to-wit: original permit holder was present holder's father.
original permittee retired, but his son could not afford to buy the land and also
set up sprinkler system. Land is now purchased, but well driller chosen to do
the work will not be available for some time.

Wherefore, he asks that the Department of Water Resources extend the time for the
completion of obligations under said permit to March 1, 1983.

L. Harold Stanger
(signature) *

Subscribed and sworn before me this 31st day of January, 1978.

seal

Notary Public residing at

My commission expires 7-22-82

ACTION OF THE DIRECTOR OF THE DEPARTMENT OF WATER RESOURCES

IT IS HEREBY ORDERED that the above application for extension of time be DENIED
for failure of the permit holder to proceed with diligence in the completion of
the project, on Permit No. 45-7122.

DENIED

Witness my hand this 13 day of February, 1978.

Bobby D. Hansen
Chief, Operations Bureau

* IF OTHER THAN HOLDER, Power of Attorney must be supplied. Forms are available
through the Department of Water Resources, Statehouse, Boise, Idaho 83720.

45-7122

RECEIVED
MAR 8 1973
Department of Water Administration
Southern District Office

Identification No. _____

Application No. 45-7122

STATE OF IDAHO
DEPARTMENT OF WATER ADMINISTRATION
APPLICATION FOR PERMIT

APPROVED

To Appropriate the Public Waters of the State of Idaho
(TYPE OR PRINT IN INK)

1. Name of applicant Charles Earl Stanger
post office address Route 3, Box 193, Burley, ID 83318
2. Source of water supply Groundwater which is a tributary of _____
3. a. Location of point of diversion is SW $\frac{1}{4}$ of NE $\frac{1}{4}$ of Section 21 Township 11S
Range 24E B.M. Cassia County; additional points of diversion if any: _____

- b. If water is not consumed, it will be discharged into _____ at a point in _____ $\frac{1}{4}$
of _____ $\frac{1}{4}$ of Section _____ Township _____ Range _____ B.M. _____
4. Water will be used for the following purposes:
Amount 4.8 for Irrigation purpose from March 15 to Nov. 15 (both dates inclusive)
(cfs or acre-feet per annum)
Amount .02 for stockwater purpose from Jan. 1 to Dec. 31 (both dates inclusive)
(cfs or acre-feet per annum)
Amount _____ for _____ purpose from _____ to _____ (both dates inclusive)
(cfs or acre-feet per annum)
5. Total quantity to be appropriated:
a. 4.8 cubic feet per second and/or
b. _____ acre feet per annum.
6. Proposed diverting works:
a. Description of ditches, flumes, pumps, headgates, etc. deep well , pump, and sprinkler

b. Height of storage dam _____ feet, active reservoir capacity _____ acre feet; total reservoir
capacity _____ acre feet, materials used in storage dam: _____
Period of year during which storage will occur _____ to _____ inclusive.
(Mo. Day) (Mo. Day)
c. Proposed well diameter is _____ inches; proposed depth of well is _____ feet.
7. a. Time required for the completion of the works and application of the water to the proposed beneficial use
is 5 years.
b. Estimated construction cost is \$ 30,000.00.
8. Description of proposed uses:
a. If water is **not** for irrigation:
(1) Give the place of use of water: SW $\frac{1}{4}$ of NE $\frac{1}{4}$ of Section 21 Township 11S
Range 24E B.M. _____
(2) Amount of power to be generated: _____ hp under _____ feet of head.
(3) List number of each kind of livestock to be watered 200 approx.

(4) Name of municipality to be served _____, or number of families to be
supplied with domestic water _____.
(5) If water is to be used for other purposes describe: _____

b. If water is for irrigation, indicate acreage in each subdivision in the tabulation below:

TWP.	RANGE	SEC.	NE $\frac{1}{4}$				NW $\frac{1}{4}$				SW $\frac{1}{4}$				SE $\frac{1}{4}$				TOTALS
			NE $\frac{1}{4}$	NW $\frac{1}{4}$	SW $\frac{1}{4}$	SE $\frac{1}{4}$	NE $\frac{1}{4}$	NW $\frac{1}{4}$	SW $\frac{1}{4}$	SE $\frac{1}{4}$	NE $\frac{1}{4}$	NW $\frac{1}{4}$	SW $\frac{1}{4}$	SE $\frac{1}{4}$	NE $\frac{1}{4}$	NW $\frac{1}{4}$	SW $\frac{1}{4}$	SE $\frac{1}{4}$	
11S	24E	21													40	40	40	40	160
11S	24E	22									40	40	40	40					160
11S	24E	28					40	40	40	40									160

Total number of acres to be irrigated 480

c. Describe any other water rights used for the same purposes as described above. None

9. a. Who owns the property at the point of diversion Applicant

b. Who owns the land to be irrigated or place of use Applicant

c. If the property is owned by a person other than the applicant, describe the arrangement enabling the applicant to make this filing _____

10. Remarks _____

11. Map of proposed project: show clearly the proposed point of diversion, place of use, section number, township and range number.

24.E

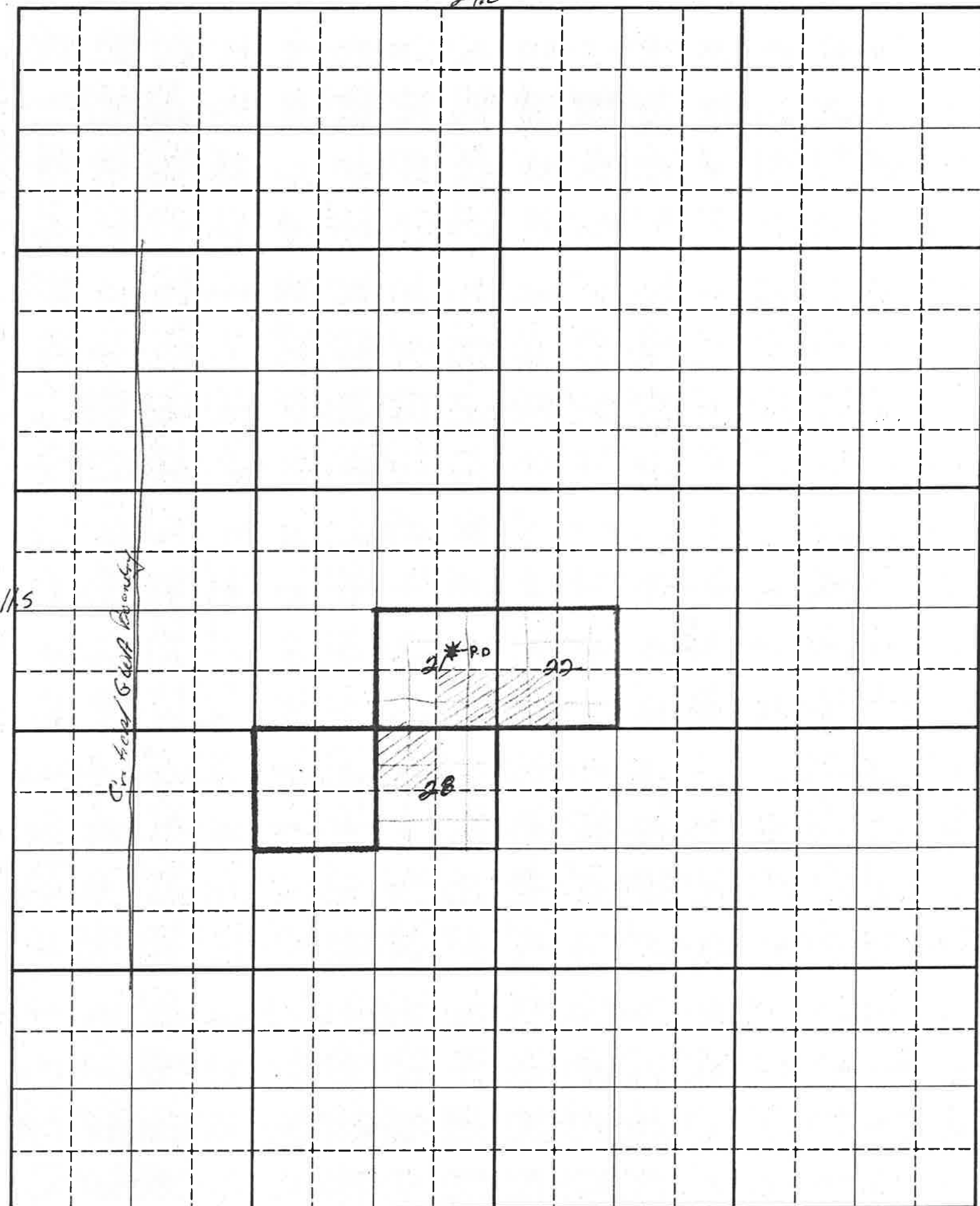

Scale: 2 inches equal 1 mile

BE IT KNOWN that the undersigned hereby makes application for permit to appropriate the public waters of the State of Idaho as herein set forth.

Charles Earl Stanger
(Applicant)

Proposed Priority 1-19-1973

Received by MKS Date 1-19-73 Time 3:15
Preliminary check by PKA Fee \$ 65.00 # 9524
Receipted by alw Date 1-19-73
alw Publication prepared by alw Date 1-24-73
Published in South Idaho Press, Burley, ID
Publication dates 2-6 & 2-13-73
Publication approved alw Date 2-20-73
Priority ~~reduced~~ to 1-19-73 Reason _____

Protests filed by: _____

Copies of protests forwarded by _____

Hearing held by _____ Date _____

Recommended for approval denial by D

ACTION OF THE DIRECTOR, DEPARTMENT OF WATER ADMINISTRATION

This is to certify that I have examined Application for Permit to appropriate the public waters of the State of Idaho No. 45-7122, and said application is hereby APPROVED.

1. Approval of said application is subject to the following limitations and conditions:

- a. SUBJECT TO ALL PRIOR WATER RIGHTS.
- b. Proof of construction of works and application of water to beneficial use shall be submitted on or before March 1, 19 78.
- c. Other: A measuring device of a type approved by this Department shall be permanently installed and maintained as part of the diverting works.

2. Denial of said application is for the following reasons: _____

Witness my hand this 2nd day of March 19 73.

Deputy Director

March 2, 1973

Re. Permit No.: 45-7122

Charles Earl Stanger
Route 3, Box 193
Burley, Idaho 83318

Dear Mr. Stanger:

Enclosed is a copy of your approved Application for Permit No. 45-7122 . We direct your attention to the conditions of approval as listed on the fourth page.

Be sure to note that a special condition requiring you to install and maintain a measuring device at your point of diversion has been placed upon your permit. We are enclosing a letter describing different types of measuring devices accepted by this office.

Very truly yours,

BOBBY D. FLEENOR
Assistant Director

BDF: cd

Enclosures