

RECEIVED

JUN 03 2020

STATE OF IDAHO
DEPARTMENT OF WATER RESOURCES

IDWR / NORTH Notice of Change in Water Right Ownership

1. List the numbers of all water rights and/or adjudication claim records to be changed. If you only acquired a portion of the water right or adjudication claim, check "Yes" in the "Split?" column. If the water right is leased to the Water Supply Bank, check "Yes". If you are not sure if the water right is leased to the Water Supply Bank, see 206 of the instructions.

Water Right/Claim No.	Split?	Leased to Water Supply Bank?	Water Right/Claim No.	Split?	Leased to Water Supply Bank?
82-4023	Yes <input type="checkbox"/>	Yes <input type="checkbox"/>		Yes <input type="checkbox"/>	Yes <input type="checkbox"/>
82-4024	Yes <input type="checkbox"/>	Yes <input type="checkbox"/>		Yes <input type="checkbox"/>	Yes <input type="checkbox"/>
82-12107	Yes <input type="checkbox"/>	Yes <input type="checkbox"/>		Yes <input type="checkbox"/>	Yes <input type="checkbox"/>
	Yes <input type="checkbox"/>	Yes <input type="checkbox"/>		Yes <input type="checkbox"/>	Yes <input type="checkbox"/>
	Yes <input type="checkbox"/>	Yes <input type="checkbox"/>		Yes <input type="checkbox"/>	Yes <input type="checkbox"/>

2. Previous Owner's Name: Charlotte J Choate & Stanley D Choate
Name of current water right holder/claimant
3. New Owner(s)/Claimant(s): Tracy S Moore and/or James J Venable II
New owner(s) as listed on the conveyance document Name connector ☐ and ☐ or ☒ and/or
- PO Box 282 Stites ID 83552
Mailing address City State ZIP
208-926-7192 blurubytrucking@gmail.com
Telephone Email
4. If the water rights and/or adjudication claims were split, how did the division occur?
☐ The water rights or claims were divided as specifically identified in a deed, contract, or other conveyance document.
☐ The water rights or claims were divided proportionately based on the portion of their place(s) of use acquired by the new owner.
5. Date you acquired the water rights and/or claims listed above: June 2, 2005
6. If the water right is leased to the Water Supply Bank changing ownership of a water right will reassign to the new owner any Water Supply Bank leases associated with the water right. Payment of revenue generated from any rental of a leased water right requires a completed IRS Form W-9 for payment to be issued to an owner. A new owner for a water right under lease shall supply a W-9. Water rights with multiple owners must specify a designated lessor, using a completed _____ form. Beginning in the calendar year following an acknowledged change in water right ownership, compensation for any rental will go to the new owner(s).
7. This form must be signed and submitted with the following **REQUIRED** items:
☒ A copy of the conveyance document – warranty deed, quitclaim deed, court decree, contract of sale, etc. The conveyance document must include a legal description of the property or description of the water right(s) if no land is conveyed.
☒ Plat map, survey map or aerial photograph which clearly shows the place of use and point of diversion for each water right and/or claim listed above (if necessary to clarify division of water rights or complex property descriptions).
☒ Filing fee (see instructions for further explanation):
 • \$25 per *undivided* water right.
 ○ \$100 per *split* water right.
 ○ No fee is required for pending adjudication claims.
☐ If water right(s) are leased to the Water Supply Bank AND there are multiple owners, a Lessor Designation form is required.
☐ If water right(s) are leased to the Water Supply Bank, the individual owner or designated lessor must complete, sign and submit an IRS Form W-9.

SUPPORT DATA

IN FILE # 82-4023

8. Signature: Tracy S. Moore Title, if applicable _____ Date 5/31/2020
Signature of new owner/claimant

Signature: James J. Venable II Title, if applicable _____ Date 5/31/2020
Signature of new owner/claimant

For IDWR Office Use Only: ja Date 6-8-2020 Receipt No. N036154 Receipt Amt. 50.00
ja Date 6-3-2020 Receipt No. N036132 Receipt Amt. 2500

Active in the Water Supply Bank? Yes ☐ No ☐ If yes, forward to the State Office for processing W-9 received? Yes ☐ No ☐
Name on W-9 _____ Approved by _____ Processed by NS Date 6-10-20

441892

WARRANTY DEED

STATE of IDAHO	
County of Idaho	
Recorded at request of	
INI AND TITLE CO	
at 420 p.m.	on 6-2-05
ROSE E. GEHRING	
By <i>[Signature]</i>	Recorder
Fees \$ 600	Deputy

m/pu

For Value Received **STANLEY D. CHOATE and CHARLOTTE J. CHOATE, husband and wife**, Hereinafter called the Grantor, hereby grants, bargains, sells and conveys unto **TRACY S. MOORE, a married woman, and JAMES J. VENABLE II, a minor**, whose address is: 3807 W. SIERRA HWY #6-4441, ACTON, CA 93510, Hereinafter called the Grantee, the following described premises situated in IDAHO County, Idaho, to-wit:

Township 32 North, Range 4 East, Boise Meridian, Idaho County, Idaho

Section 28: A parcel of land being a portion of the SW $\frac{1}{4}$ NW $\frac{1}{4}$, SE $\frac{1}{4}$ NW $\frac{1}{4}$, SW $\frac{1}{4}$ NE $\frac{1}{4}$ and the SW $\frac{1}{4}$, and;

Section 29: A parcel of land being a portion of the SE $\frac{1}{4}$ NE $\frac{1}{4}$, more particularly described as follows:

Beginning at the North 1/16 corner between Sections 28 and 29, a 5/8 inch rebar with cap THE TRUE POINT OF BEGINNING;

Thence S.75°34'42"E., 83.50 feet along the Southerly right of way line of a county road;

Thence S.64°42'28"E., 92.86 feet continuing along the Southerly right of way line;

Thence S.76°31'45"E., 74.79 feet;

Thence N.87°30'50"E., 125.98 feet;

Thence N.84°45'08"E., 236.32 feet;

Thence N.89°15'27"E., 234.09 feet;

Thence S.83°51'52"E., 303.38 feet;

Thence S.75°35'45"E., 176.20 feet;

Thence S.70°13'05"E., 179.82 feet;

Thence S.73°51'03"E., 312.65 feet;

Thence S.74°45'07"E., 140.44 feet;

Thence S.79°45'51"E., 447.37 feet;

Thence S.74°34'33"E., 326.71 feet;

Thence S.78°18'20"E., 165.19 feet;

Thence S.70°57'01"E., 195.84 feet;

Thence S.66°44'14"E., 251.29 feet;

Thence S.68°57'49"E., 194.94 feet;

Thence S.73°04'43"E., 179.76 feet;

Thence S.69°24'09"E., 240.91 feet;

Thence S.63°06'27"E., 137.43 feet to the East line of the SW $\frac{1}{4}$ NE $\frac{1}{4}$ of Section 28 and a monument;

Thence S.00°02'31"W., 456.22 feet leaving the South right of way line of the county road along the East line of the SW $\frac{1}{4}$ NE $\frac{1}{4}$ to the C-E 1/16 corner of Section 28, a monument,

Thence N.88°57'59"W., 1321.42 feet along the South line of the SW $\frac{1}{4}$ NE $\frac{1}{4}$ to the C $\frac{1}{4}$ corner of Section 28, a monument;

Thence S.00°03'57"W., 2656.87 feet along the center subdivisional line of Section 28 to the S $\frac{1}{4}$ corner of Section 28, a monument;

Thence N.46°10'24"W., 335.37 feet along the center of a creek,

Thence N.32°09'40"W., 255.44 feet continuing along the center of the creek;

Thence N.39°39'00"W., 118.46 feet;

Thence N.36°37'30"W., 270.12 feet;

Thence N.29°27'42"W., 128.37 feet;

Thence N.49°40'40"W., 151.74 feet;

Thence N.22°20'38"W., 134.48 feet;

Thence N.53°13'18"W., 308.56 feet to the intersection of the creek with a county road,

Thence N.03°57'51"W., 106.26 feet leaving the creek and continuing along the centerline of the county road;

Thence N.09°27'36"W., 179.23 feet;

Thence N.39°35'03"W., 260.86 feet;

Thence N.51°22'39"W., 218.19 feet;

Thence N.35°20'36"W., 151.09 feet;

Thence N.41°01'39"W., 246.44 feet;

Thence N.56°47'14"W., 108.46 feet;

Thence N.51°30'00"W., 363.00 feet;

Thence N.11°28'40"W., 115.50 feet;

Thence N.01°01'20"E., 66.00 feet;

Thence N.65°58'31"W., 66.00 feet to the South line of the SW $\frac{1}{4}$ NW $\frac{1}{4}$ of Section 28;

Thence N.88°57'59"W., 27.47 feet along the South line of the SW¼NW¼ of Section 28 to the East line of Tax Number 112;
Thence N.05°01'27"W., 221.14 feet along the East line of Tax Number 112;
Thence N.88°32'44"W., 412.73 feet to the Easterly right of way line of State Highway 13;
Thence N.05°01'27"W., 679.54 feet along the Easterly right of way line to the beginning of a curve concave to the Southwest, the curve delta 37°48'51", a curve radius 333.00 feet, a curve length of 219.77 feet, a chord bearing of N.23°55'53"W., and a chord length of 215.81 feet;
Thence N.42°50'18"W., 305.84 feet to a curve concave to the Northeast, the curve having a delta of 04°15'02", a radius of 167.00 feet, a length of 12.39 feet, a chord bearing of N.40°42'46"W., a chord length of 12.39 feet;
Thence S.89°15'33"E., 373.45 feet leaving the Easterly right of way line of State Highway 13 along the North line of the SE¼NE¼ of Section 29 to the TRUE POINT OF BEGINNING.

LESS: County Road Right of Way.

All monuments referred to are 5/8" by 24" rebar with plastic caps.

SUBJECT TO all easements, right of ways, covenants, restrictions, reservations, applicable building and zoning ordinances and use regulations and restrictions of record, and payment of accruing present year taxes and assessments as agreed to by parties above.

TO HAVE AND TO HOLD the said premises, with their appurtenances unto the said Grantee and to the Grantee's heirs and assigns forever. And the said Grantor does hereby covenant to and with the said Grantee, that the Grantor is the owner in fee simple of said premises; that said premises are free from all encumbrances except current years taxes, levies, and assessments, and except U. S. Patent reservations, restrictions, easements of record, and easements visible upon the premises, and that Grantor will warrant and defend the same from all claims whatsoever.

Dated: May 27, 2005

Stanley D Choate
STANLEY D/CHOATE

Charlotte J. Choate
CHARLOTTE J. CHOATE

State of Idaho

County of Idaho

On this 27th day of May, 2005, before me a Notary Public for the said County and State, personally appeared Stanley D. Choate and Charlotte J. Choate

✓ who is personally known to me

✓ whose identity I proved on the basis of _____

✓ whose identity I proved on the oath/affirmation of _____, a credible

witness to be the signer of the above document,

Personally appeared before me, and he/she/they acknowledged that he/she/they signed it.

Leona Marie
Notary Public

My commission expires: April 01, 2009

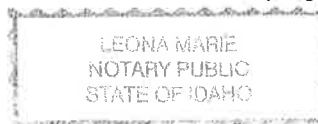

82-4023

sec. 28

NW NE
SW SE

sec. 28

29. 32 33

Map should show the location of the point of diversion and the place of use of the water by 40-acre subdivisions, section, township and range of the public land survey system.

Be it known that the undersigned, being duly sworn, deposes and says that he, ~~me,~~^{they} subscribed the foregoing claim to a water right, together with all attached information, and that the matters and facts therein are true to the best of the affiant's knowledge.

Sworn to before me this 18 day of April,

19 79

ATTACHMENT A

(1) Describe source of water: (name of stream, lake, spring, etc., or ground water)

Anderson Creek and flow into Anderson Creek from spring about one rod south of Anderson Creek on the Southeast Quarter of the Southwest Quarter (SE $\frac{1}{4}$ SW $\frac{1}{4}$) of Section 28, Township 32 North, Range 4 East Boise Meridian, tributary to, South Fork of Clearwater River.

RECEIVED

(8) Remarks

82-4024

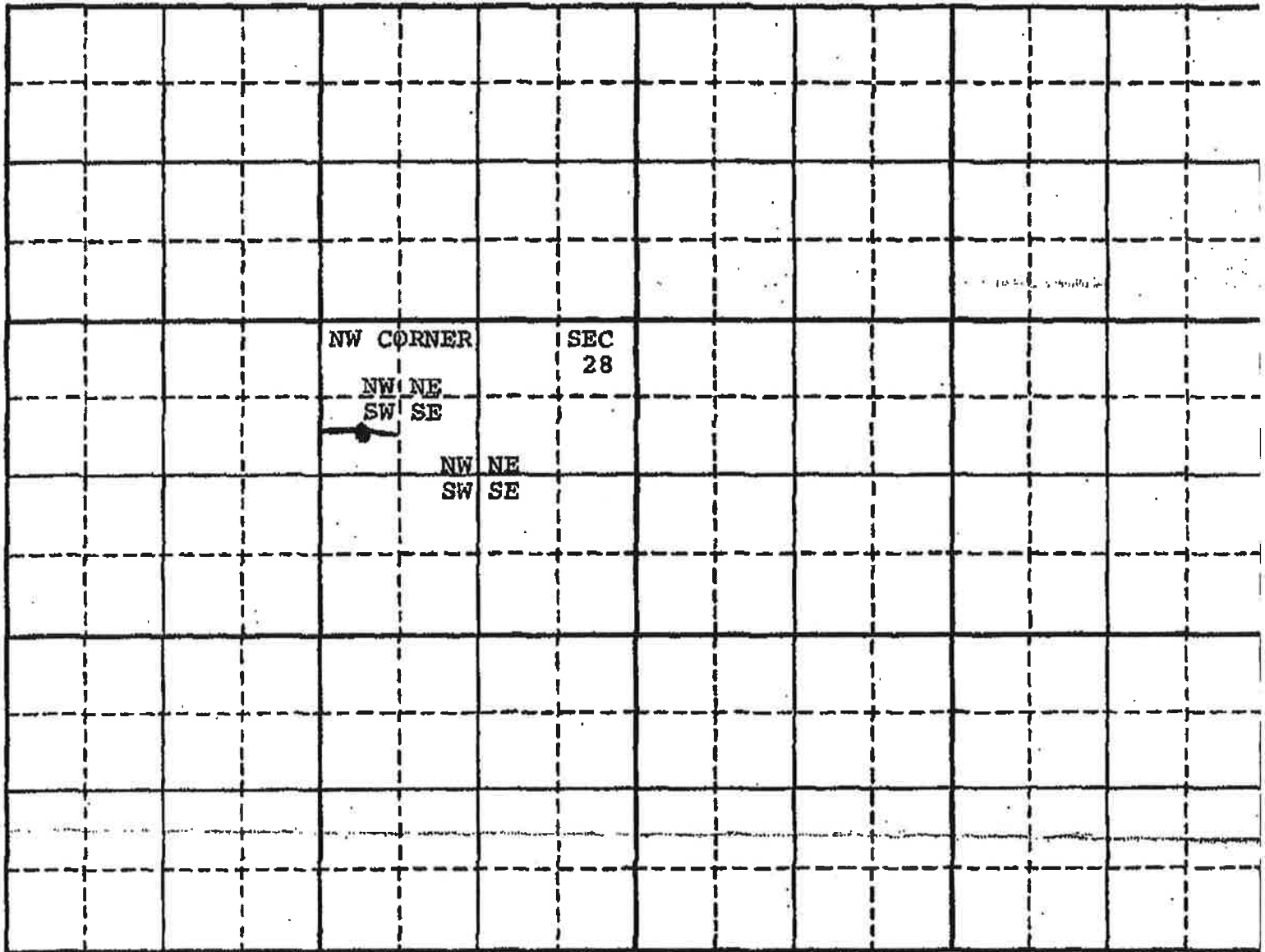

Scale: 2 inches equal 1 mile.

Map should show the location of the point of diversion and the place of use of the water by 40-acre subdivisions, section, township and range of the public land survey system.

State of Idaho)
) ss.
County of Idaho)

Be it known that the undersigned, being duly sworn, deposes and says that he, she, they subscribed the foregoing claim to a water right, together with all attached information, and that the matters and facts therein are true to the best of the affiants knowledge.

Charles B. Starkey
(Claimant)



Sworn to before me this 21 day of June

19 75

ATTACHMENT "A"

(1) Describe source of water: (name of stream, lake, spring, etc., or ground water)

Stites Canyon Creek and flow into Stites Canyon Creek on a line S.22°22' East from the NW corner of Section 28, Township 32N, R4E, B.M., a distance of 1488.37 feet.

tributary to, South Fork of Clearwater River

IN THE DISTRICT COURT OF THE FIFTH JUDICIAL DISTRICT OF THE
STATE OF IDAHO, IN AND FOR THE COUNTY OF TWIN FALLS

In Re SRBA

Case No. 39576

PARTIAL DECREE PURSUANT TO
I.R.C.P. 54(b) FOR

Water Right 82-12107

NAME AND ADDRESS: CHARLOTTE J CHOATE
STANLEY D CHOATE
BOX 317
STITES, ID 83552-0317

SOURCE: SOUTH FORK CLEARWATER RIVER TRIBUTARY: CLEARWATER RIVER

QUANTITY: 0.209 CFS

PRIORITY DATE: 03/11/1907

POINT OF DIVERSION: T32N R04E S29 SENE Within Idaho County

PURPOSE AND PERIOD OF USE:	PURPOSE OF USE	PERIOD OF USE	QUANTITY
	Irrigation	03-15 TO 11-15	0.209 CFS

PLACE OF USE: Irrigation Within Idaho County
T32N R04E S28 SWNW 2.5
S29 SENE 1.2
3.7 Acres Total

OTHER PROVISIONS NECESSARY FOR DEFINITION OR ADMINISTRATION OF THIS WATER RIGHT:

THIS PARTIAL DECREE IS SUBJECT TO SUCH GENERAL PROVISIONS
NECESSARY FOR THE DEFINITION OF THE RIGHTS OR FOR THE EFFICIENT
ADMINISTRATION OF THE WATER RIGHTS AS MAY BE ULTIMATELY
DETERMINED BY THE COURT AT A POINT IN TIME NO LATER THAN THE
ENTRY OF A FINAL UNIFIED DECREE. I.C. SECTION 42-1412(6).

RULE 54(b) CERTIFICATE

With respect to the issues determined by the above judgment or order, it is hereby CERTIFIED, in accordance with Rule 54(b), I.R.C.P., that the court has determined that there is no just reason for delay of the entry of a final judgment and that the court has and does hereby direct that the above judgment or order shall be a final judgment upon which execution may issue and an appeal may be taken as provided by the Idaho Appellate Rules.

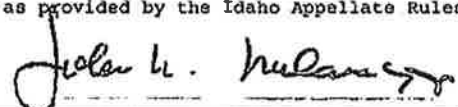
John M. Melanson
Presiding Judge of the
Snake River Basin Adjudication

State of Idaho
Department of Water Resources

Water Right
82-12107

IRRIGATION

The map depicts the place of use for the water use listed above and point(s) of diversion of this right as currently derived from interpretations of the paper records and is used solely for illustrative purposes. Discrepancies between the computer representation and the permanent document file will be resolved in favor of the actual water right documents in the water right file.

04E



- ⊙ Point of Diversion
- Place Of Use Boundary

- Townships
- PLS Sections
- Quarter Quarters

0 0.035 0.07 0.14 Miles





State of Idaho

DEPARTMENT OF WATER RESOURCES

Northern Region • 7600 N MINERAL DR STE 100 • COEUR D ALENE, ID 83815-7763
Phone: (208)762-2800 • Fax: (208)769-2819 • Website: www.idwr.idaho.gov

Brad Little
Governor

Gary Spackman
Director

June 10, 2020

TRACY S MOORE
JAMES J VENABLE II
PO BOX 282
STITES ID 83552-0282

Re: Change in Ownership for Water Right No(s): 82-4023, 82-4024, & 82-12107

Dear Water Right Holder(s):

The Department of Water Resources (Department) acknowledges the receipt of correspondence changing ownership of the above referenced water right(s) to you. The Department has modified its records and has enclosed a computer-generated report for you.

Updating the ownership record for a water right does not reconfirm the validity of the right. When processing a Notice of Change in Water Right Ownership, the Department does not review the history of water use to determine if the right has been forfeited or deliberately abandoned through five years or more of non-use. To read more about water right forfeiture, including how to protect a water right from forfeiture, please see Idaho Code §§ 42-222 and 42-223.

Please note, water right owners are required to report any change of water right ownership and any change of mailing address to the Department within 120 days of the change. Reporting forms are available from any office of the Department, or from the Department's website.

If you have any questions concerning the enclosed information, please contact me at (208) 762-2813.

Sincerely,

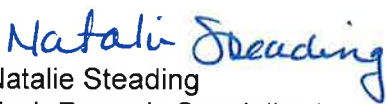
Natalie Steading
Tech Records Specialist 1

Enclosure(s)