

IDAHO DEPARTMENT OF WATER RESOURCES
Proof Report

6/11/2020

Water Application 45-7256

<u>Owner Type</u>	<u>Name and Address</u>
Current Owner	ANNE CLARK , ZZ

Status: Denied

<u>Source</u>	<u>Tributary</u>
---------------	------------------

<u>Beneficial Use</u>	<u>From</u>	<u>To</u>	<u>Diversion Rate</u>	<u>Volume</u>
-----------------------	-------------	-----------	-----------------------	---------------

Source and Point(s) of Diversion

Place Of Use

Conditions of Approval:

Comments:

Dates and Other Information

Number of Protests: 0
Water District Number: TBD
Application Type: New Appropriation
Mitigation Plan: False

Combined Use Limits

N/A

SubCase:

N/A

Water Supply Bank:

N/A

BEFORE THE DIRECTOR OF THE DEPARTMENT OF WATER RESOURCES
OF THE
STATE OF IDAHO

RECEIVED

MAR 24 1986

IN THE MATTER OF APPLICATION)
FOR PERMIT NO. 45-7256 IN)
THE NAME OF ANNE CLARK)

ORDER

Department of Water Resources
Sandra L. Clark, Clerk

WHEREAS, on December 18, 1975 Anne Clark applied to the Department of Water Resources for a permit to appropriate 6.4 cubic feet per second of water from a groundwater source to be diverted within the NW1/4SE1/4, Section 33, Township 12 South, Range 21 East, B.M., Cassia County, to be used for irrigation purposes in connection with a Desert Land Entry; and,

WHEREAS, on December 30, 1985, the Desert Land Entry was classified unsuitable for entry by the Bureau of Land Management; and,

WHEREAS, on February 6, 1986, the Department corresponded with the applicant requesting evidence to show possessory interest in the proposed place of use; and,

WHEREAS, the Department received no response to its inquiry; and,

WHEREAS, the provisions of Section 42-203(A), Idaho Code, provides the Director of the Department of Water Resources may deny Applications for Permit which have been filed for speculative purposes; and,

WHEREAS, lack of possessory interest in the proposed place of use is speculative in nature;

45-7256

IT IS, THEREFORE, ORDERED that pursuant to provisions of Section 42-203(A), Idaho Code, Application for Permit No. 45-7256 is hereby Denied.

Dated this 18th day of March, 1986.

A. KENNETH DUNN
Director

85
Identification No. 45-7256

Application No. _____

STATE OF IDAHO
DEPARTMENT OF WATER ADMINISTRATION

APPLICATION FOR PERMIT

To Appropriate the Public Waters of the State of Idaho
(TYPE OR PRINT IN INK)

1. Name of applicant Anne Clark
post office address 1924 Grandview Lane Burley, Idaho 83318
2. Source of water supply deep wells which is a tributary of _____
3. a. Location of point of diversion is NW $\frac{1}{4}$ of SE $\frac{1}{4}$ of Section 33 Township 12S.
Range 21 E B.M. Cassia County; additional points of diversion if any: _____

- b. If water is not consumed, it will be discharged into _____ at a point in _____ $\frac{1}{4}$
of _____ $\frac{1}{4}$ of Section _____ Township _____ Range _____ B.M. _____
4. Water will be used for the following purposes:
Amount 6.4 for irrigation purpose from April 1 to Nov. 1 (both dates inclusive)
(cfs or acre-feet per annum)
Amount _____ for _____ purpose from _____ to _____ (both dates inclusive)
(cfs or acre-feet per annum)
Amount _____ for _____ purpose from _____ to _____ (both dates inclusive)
(cfs or acre-feet per annum)
5. Total quantity to be appropriated:
a. 6.4 cubic feet per second and/or
b. _____ acre feet per annum.
6. Proposed diverting works:
a. Description of ditches, flumes, pumps, headgates, etc. _____
Deep well with main lines feeding sprinkler systems

- b. Height of storage dam _____ feet, active reservoir capacity _____ acre feet; total reservoir
capacity _____ acre feet, materials used in storage dam: _____
Period of year during which storage will occur _____ to _____ inclusive.
(Mo. Day) (Mo. Day)
- c. Proposed well diameter is 20 inches; proposed depth of well is 1300 feet.
7. a. Time required for the completion of the works and application of the water to the proposed beneficial use
is 5 years.
b. Estimated construction cost is \$ \$33,000.00.
8. Description of proposed uses:
a. If water is not for irrigation:
(1) Give the place of use of water: _____ $\frac{1}{4}$ of _____ $\frac{1}{4}$ of Section _____ Township _____
Range _____ B.M. _____
(2) Amount of power to be generated: _____ hp under _____ feet of head.
(3) List number of each kind of livestock to be watered _____

(4) Name of municipality to be served _____, or number of families to be
supplied with domestic water _____.
(5) If water is to be used for other purposes describe: _____

45-7256
DLE

b. If water is for irrigation, indicate acreage in each subdivision in the tabulation below:

[illegible]

Total number of acres to be irrigated 320

c. Describe any other water rights used for the same purposes as described above.

9. a. Who owns the property at the point of diversion U.S.

b. Who owns the land to be irrigated or place of use U.S.

c. If the property is owned by a person other than the applicant, describe the arrangement enabling the applicant to make this filing _____

Desert Land Entry

10. Remarks

11. Map of proposed project: show clearly the proposed point of diversion, place of use, section number, township and range number.

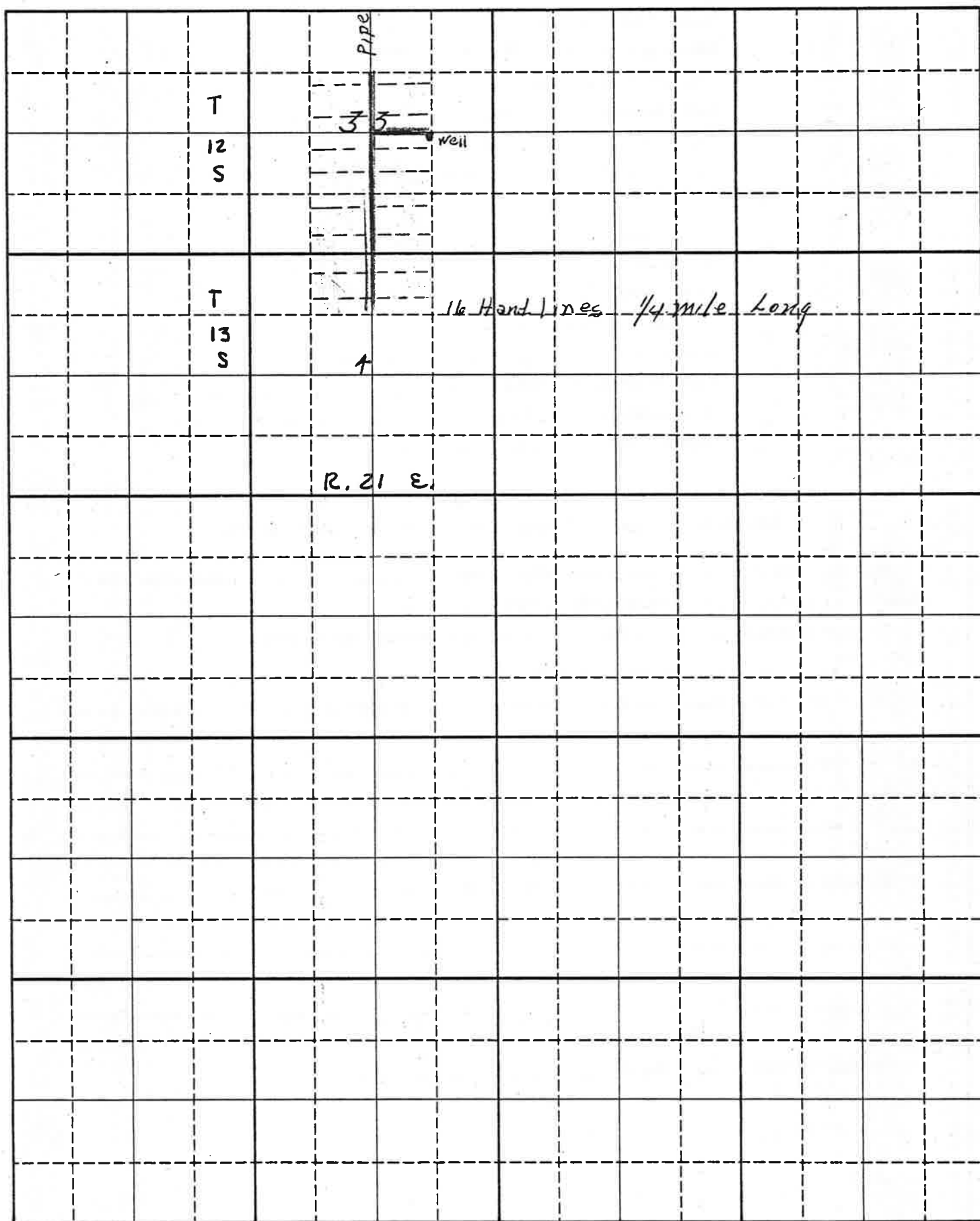

Scale: 2 inches equal 1 mile

BE IT KNOWN that the undersigned hereby makes application for permit to appropriate the public waters of the State of Idaho as herein set forth.

Asme Clark
(Applicant)

Received by UF Date 12-18-75 Time 2:45
Preliminary check by ADM Fee \$ 85.00
Received by CC Date 12-18-75
Publication prepared by Eh Date 12/22/75
Published in South Ida Press
Publication dates 12/30/75 & 1/6/76
Publication approved Eh Date 1/14/76
Priority reduced to _____ Reason _____

#1781

Protests filed by: _____

Copies of protests forwarded by _____

Hearing held by _____ Date _____

Recommended for approval denial by _____

ACTION OF THE DIRECTOR, DEPARTMENT OF WATER ADMINISTRATION

This is to certify that I have examined Application for Permit to appropriate the public waters of the State of Idaho No. _____, and said application is hereby _____.

1. Approval of said application is subject to the following limitations and conditions:

a. SUBJECT TO ALL PRIOR WATER RIGHTS.

b. Proof of construction of works and application of water to beneficial use shall be submitted on or before _____, 19____.

c. Other: _____

2. Denial of said application is for the following reasons: _____

Witness my hand this _____ day of _____, 19____.

Director

STATE OF IDAHO
DEPARTMENT OF WATER RESOURCES

CERTIFICATION OF OWNERSHIP

I hereby certify that the lands listed in Permit/Application No. _____
are not under private ownership and are owned and administered by the federal
government and are suitable for filing under the provisions stipulated in the
program.

Dated this ~~17~~ 17 day of DEC, 19 75

Anne Clark

STATE OF IDAHO
County of CASSIA } ss.

On this 17 day of DEC, 19 75, personally appeared before
me the signer(s) of the above instrument, who duly acknowledged to me that he (she)
(they) executed the same.

seal

Shirley Coleman
Notary Public
Residing at Burley, Ida

My Commission expires:

July - 76