

IDAHO DEPARTMENT OF WATER RESOURCES  
Proof Report

6/12/2020

Water Permit 45-7271

Owner Type      Name and Address

Status: See Remarks

Source

Tributary

Beneficial Use

From

To

Diversion Rate

Volume

Source and Point(s) of Diversion

Place Of Use

Conditions of Approval:

1. SEE RT. 47-7541.

Comments:

Dates and Other Information

Water District Number: TBD

Mitigation Plan: False

Combined Use Limits

N/A

SubCase:

N/A

Water Supply Bank:

N/A

SEE 10/1/20

RECEIVED

Ident. No. 45-7271

RECEIVED

STATE OF IDAHO  
DEPARTMENT OF WATER RESOURCES

RECEIVED

SEP 27 1970  
Department of Water Resources

APPLICATION FOR AMENDMENT OF A PERMIT

JUL 16 1970

To change the point of diversion and/or the place of use.

(Legal Representative)

Comes now

J. Carl Dille (Dille Farms)

of (address) 118 Maple, Boise, Idaho 83702, and represents to the  
Dille Farms - 825 Kimberly, Idaho 83341 - Route 2 Box 304 A  
Director of the Idaho Department of Water Resources:

That he is the owner and holder of Permit to appropriate the Public Waters of the State of Idaho  
No. 45-7271, and requests that the permit and permit map be changed as follows:

1. 2 Point of diversion: SW 1/4 SW 1/4, Section 8, Township 11S, Range 19E, B.M.,  
County of Twin Falls. Other points of diversion: SE 1/4 SW 1/4, Sec. 8,  
T11S, R19E, B.M. & NE 1/4 NW 1/4, Sec. 8, T11S,  
R19E, B.M. (A Total of 4 Diversions)

2. Period and nature of use: (irrigation, domestic, stockwatering, industrial, etc.)

Amount 1.91 for Irrigation purposes from Mar. 15 to Nov. 15 (both dates inclusive)  
(cfs or acre feet per annum)

Amount for purposes from to (both dates inclusive)  
(cfs or acre feet per annum)

Amount for purposes from to (both dates inclusive)  
(cfs or acre feet per annum)

Amount for purposes from to (both dates inclusive)  
(cfs or acre feet per annum)

3. Place of use or land to be irrigated:

TWP	RGE	SEC	NE 1/4				NW 1/4				SW 1/4				SE 1/4				TOTALS
			NE 1/4	NW 1/4	SW 1/4	SE 1/4	NE 1/4	NW 1/4	SW 1/4	SE 1/4	NE 1/4	NW 1/4	SW 1/4	SE 1/4	NE 1/4	NW 1/4	SW 1/4	SE 1/4	
11S	19E	8									40	40	40	40					160

Total number of acres to be irrigated = 160

4. a. Who owns the property at the point of diversion? Dille Farms  
b. Who owns the land to be irrigated or the place of use? Dille Farms  
c. If the property is owned by a person other than the applicant, describe the arrangement enabling the applicant to make this filing:

Complete the following map by showing land and point of diversion as proposed by this amendment.

Show 40-acre subdivisions, townships, ranges and ditches.

T11S R19E

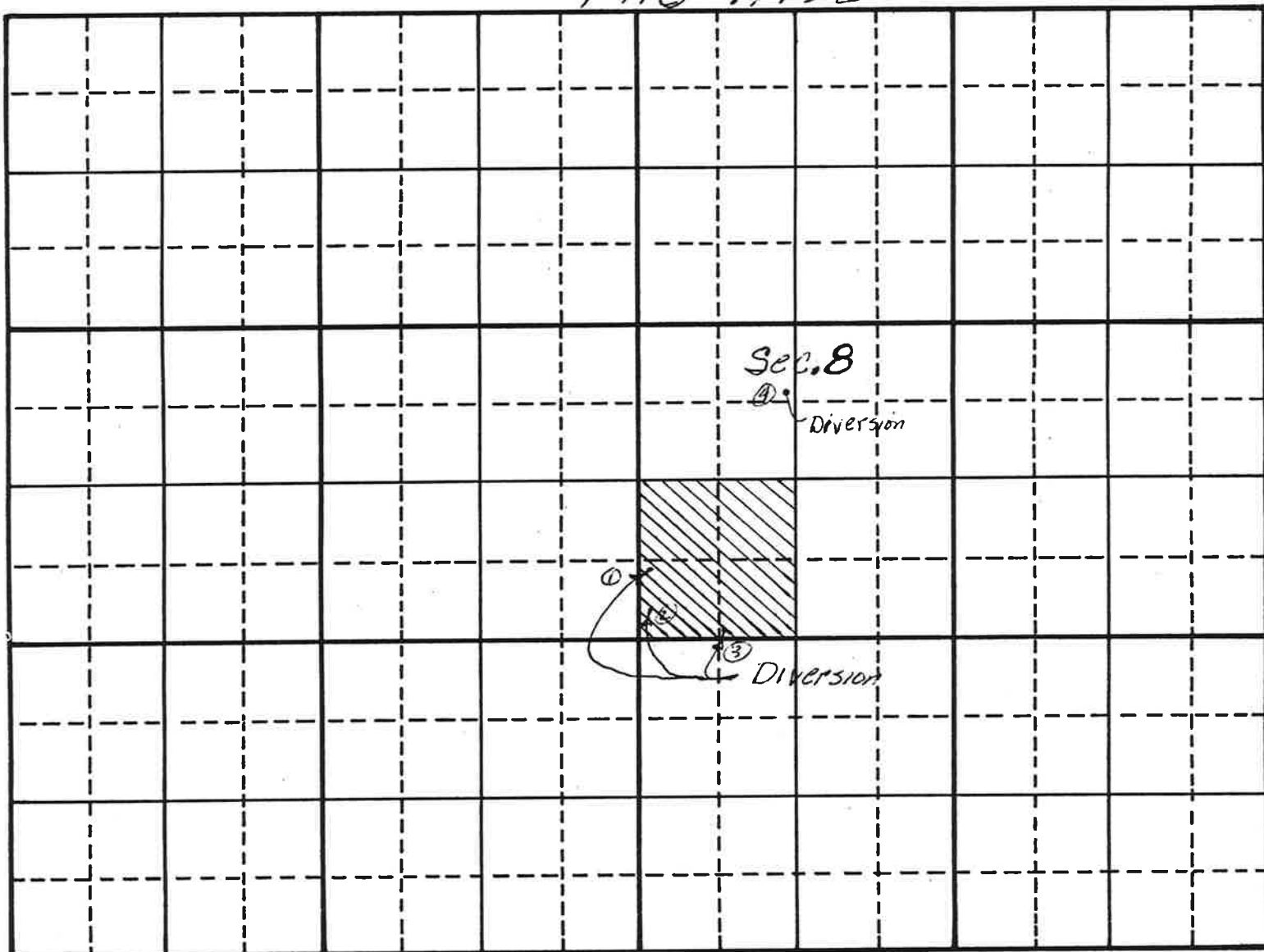

Scale: 2 inches equal 1 mile.

That no one will be injured by such change, and that such change will be made at permit holder's own risk.

Signed at Boise, Idaho, this 10 day of July, 19 79.

J. Carl Dille  
(Signature)

FOR DEPARTMENT USE ONLY

Preliminary check by LS Fee = \$20.00 Received by TEB Date 7-18-79 # 13267  
Publication prepared by maria Date 7/24/79 Published in times news  
Publication dates 8/9 & 8/16/79

ACTION OF THE DIRECTOR, DEPARTMENT OF WATER RESOURCES

I, L. GLEN SAXTON, Chief, Operations Bureau, of the Department of Water Resources hereby

APPROVE this application for Amendment on Permit No. 45-7271.

Witness my hand this 6<sup>th</sup> day of November

19 79

L. Glen Saxton  
Chief, Operations Bureau

RECEIVED

NOV 7 1979

State of Idaho  
Department of Water Resources

RECEIVED

NOV 13 1979

ASSIGNMENT OF PERMIT

Department of Water Resources  
Northern District Office

Department of Water Resources  
Southern District Office

I, Bernice E. Dille, hereby assign to Dille Farms  
of Route # 2-304A Box 151 Kimberly Idaho 83341  
Address

CHECK ONE

- ☒ All my right, title, and interest in and to Permit No. 45-7271  
to appropriate the public waters of the State of Idaho.
- ☐ The following described portion of my right, title, and interest in and to Permit  
No. \_\_\_\_\_ to appropriate the public waters of the State of Idaho.
- (Describe that portion of the permit being assigned by listing the acreage within  
each 40 acre subdivision, the point of diversion and the amount of water in cubic  
feet per second for direct diversion, or acre feet for storage)

assigned to Dille Farms per  
assignment submitted Aug. '79

Made this 16 day of July, 19 79.

Bernice E. Dille  
Permit Holder

\_\_\_\_\_  
Spouse of Permit Holder

State of Idaho )  
County of Blaine ) ss.

On this 16 day of July, 19 79, personally  
appeared before me the signer(s) of the above instrument, who duly acknowledged to me  
that he (she) (they) executed the same.

seal

Notary Public  
Notary Public residing at  
Kimberly Idaho

My commission expires:  
1980

45-7271

STATE OF IDAHO  
DEPARTMENT OF WATER RESOURCES

APPLICATION FOR AMENDMENT OF A PERMIT

To change the point of diversion and/or the place of use.

(Legal Representative)  
Comes now J. Carl Dille (Dille Farms)  
of (address) 118 Maple, Boise, Idaho 83702, and represents to the  
Dille Farms - 225 Kimberly, Idaho 83341 - Route #2 Box 304A  
Director of the Idaho Department of Water Resources:

That he is the owner and holder of Permit to appropriate the Public Waters of the State of Idaho  
No. 45-7271, and requests that the permit and permit map be changed as follows:

1. 2 Point of diversion: SW 1/4 SW 1/4, Section 8, Township 11S, Range 19E, B.M.,  
County of Twin Falls. Other points of diversion: SE 1/4 SW 1/4, Sec. 8,  
T11S, R19E, B.M. & NE 1/4 NW 1/4, Sec. 8, T11S,  
R19E, B.M. (A Total of 4 Diversions)

2. Period and nature of use: (irrigation, domestic, stockwatering, industrial, etc.)

Amount 1.91 for Irrigation purposes from Mar. 15 to Nov. 15 (both dates inclusive)  
(cfs or acre feet per annum)  
Amount \_\_\_\_\_ for \_\_\_\_\_ purposes from \_\_\_\_\_ to \_\_\_\_\_ (both dates inclusive)  
(cfs or acre feet per annum)  
Amount \_\_\_\_\_ for \_\_\_\_\_ purposes from \_\_\_\_\_ to \_\_\_\_\_ (both dates inclusive)  
(cfs or acre feet per annum)  
Amount \_\_\_\_\_ for \_\_\_\_\_ purposes from \_\_\_\_\_ to \_\_\_\_\_ (both dates inclusive)  
(cfs or acre feet per annum)

3. Place of use or land to be irrigated:

TWP	RGE	SEC	NE 1/4				NW 1/4				SW 1/4				SE 1/4				TOTALS
			NE 1/4	NW 1/4	SW 1/4	SE 1/4	NE 1/4	NW 1/4	SW 1/4	SE 1/4	NE 1/4	NW 1/4	SW 1/4	SE 1/4	NE 1/4	NW 1/4	SW 1/4	SE 1/4	
11S	19E	8									40	40	40	40					160

Total number of acres to be irrigated = 160

4. a. Who owns the property at the point of diversion? Dille Farms  
b. Who owns the land to be irrigated or the place of use? Dille Farms  
c. If the property is owned by a person other than the applicant, describe the arrangement enabling the applicant to make this filing: \_\_\_\_\_

Show 40-acre subdivisions, townships, ranges and ditches.

T11S R19E

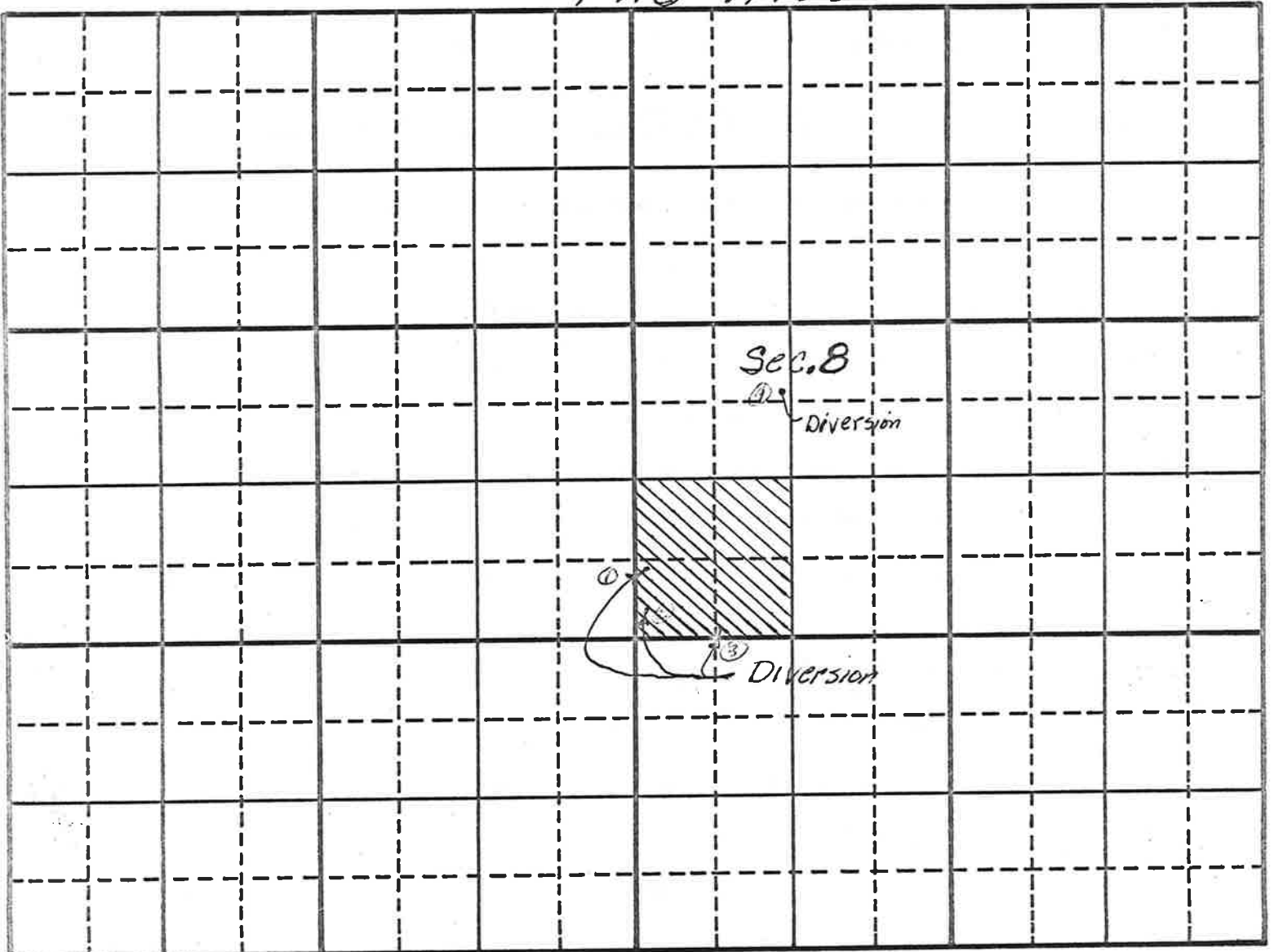

Scale: 2 inches equal 1 mile.

That no one will be injured by such change, and that such change will be made at permit holder's own risk.

Signed at Boise, Idaho, this 10 day of July, 19 79.

J. Carl Dille  
(Signature)

FOR DEPARTMENT USE ONLY

Preliminary check by LS Fee = \$20.00 Received by T66 Date 7-18-79 # 13267  
Publication prepared by maria Date 7/24/79 Published in Times news  
Publication dates 8/9 + 8/10/79

ACTION OF THE DIRECTOR, DEPARTMENT OF WATER RESOURCES

I, \_\_\_\_\_, Director of the Department of Water Resources hereby

Witness my hand this \_\_\_\_\_ day of \_\_\_\_\_, 19 \_\_\_\_\_.

Director

RECEIVED

Identification No. \_\_\_\_\_

Application No. 45-7271

SEP 1 1976

Department of Water Resources  
Southern District Office

STATE OF IDAHO  
DEPARTMENT OF WATER RESOURCES  
APPLICATION FOR PERMIT

APPROVED

To Appropriate the Public Waters of the State of Idaho  
(TYPE OR PRINT IN INK)

1. Name of applicant Mr Joe Dille Phone: 423-4424  
post office address Kimberly, Idaho
2. Source of water supply Ground water which is a tributary of \_\_\_\_\_
3. a. Location of point of diversion is SW  $\frac{1}{4}$  of SW  $\frac{1}{4}$  of Section 8 Township 11S  
Range 19E B.M. Twin Falls County; additional points of diversion if any: \_\_\_\_\_
- b. If water is not consumed, it will be discharged into \_\_\_\_\_ at a point in \_\_\_\_\_  $\frac{1}{4}$   
of \_\_\_\_\_  $\frac{1}{4}$  of Section \_\_\_\_\_ Township \_\_\_\_\_ Range \_\_\_\_\_ B.M. \_\_\_\_\_
4. Water will be used for the following purposes:  
Amount 2.50 for irrigation purpose from Apr. 1 to Oct. 15 (both dates inclusive)  
(cfs or acre-feet per annum)  
Amount \_\_\_\_\_ for \_\_\_\_\_ purpose from \_\_\_\_\_ to \_\_\_\_\_ (both dates inclusive)  
(cfs or acre-feet per annum)  
Amount \_\_\_\_\_ for \_\_\_\_\_ purpose from \_\_\_\_\_ to \_\_\_\_\_ (both dates inclusive)  
(cfs or acre-feet per annum)
5. Total quantity to be appropriated:  
a. 2.50 cubic feet per second and/or  
b. \_\_\_\_\_ acre feet per annum.
6. Proposed diverting works:  
a. Description of ditches, flumes, pumps, headgates, etc. Pump, 6" & 8" main line,  
hand lines (sprinkler system)
- b. Height of storage dam \_\_\_\_\_ feet, active reservoir capacity \_\_\_\_\_ acre feet; total reservoir  
capacity \_\_\_\_\_ acre feet, materials used in storage dam: \_\_\_\_\_  
Period of year during which storage will occur \_\_\_\_\_ to \_\_\_\_\_ inclusive.  
(Mo. Day) (Mo. Day)
- c. Proposed well diameter is 18 inches; proposed depth of well is 380 feet.
7. a. Time required for the completion of the works and application of the water to the proposed beneficial use  
is 3 years.  
b. Estimated construction cost is \$ 36,000.
8. Description of proposed uses:  
a. If water is **not** for irrigation:  
(1) Give the place of use of water: \_\_\_\_\_  $\frac{1}{4}$  of \_\_\_\_\_  $\frac{1}{4}$  of Section \_\_\_\_\_ Township \_\_\_\_\_  
Range \_\_\_\_\_ B.M. \_\_\_\_\_  
(2) Amount of power to be generated: \_\_\_\_\_ hp under \_\_\_\_\_ feet of head.  
(3) List number of each kind of livestock to be watered \_\_\_\_\_  
(4) Name of municipality to be served \_\_\_\_\_, or number of families to be  
supplied with domestic water \_\_\_\_\_  
(5) If water is to be used for other purposes describe: \_\_\_\_\_

b. If water is for irrigation, indicate acreage in each subdivision in the tabulation below:

[illegible]

Total number of acres to be irrigated 160

c. Describe any other water rights used for the same purposes as described above. None

9. a. Who owns the property at the point of diversion? Mr. Joe Dille

b. Who owns the land to be irrigated or place of use Pete Link

c. If the property is owned by a person other than the applicant, describe the arrangement enabling the applicant to make this filing Rental agreement

10. Remarks

11. Map of proposed project: show clearly the proposed point of diversion, place of use, section number, township and range number.

T11S R19E

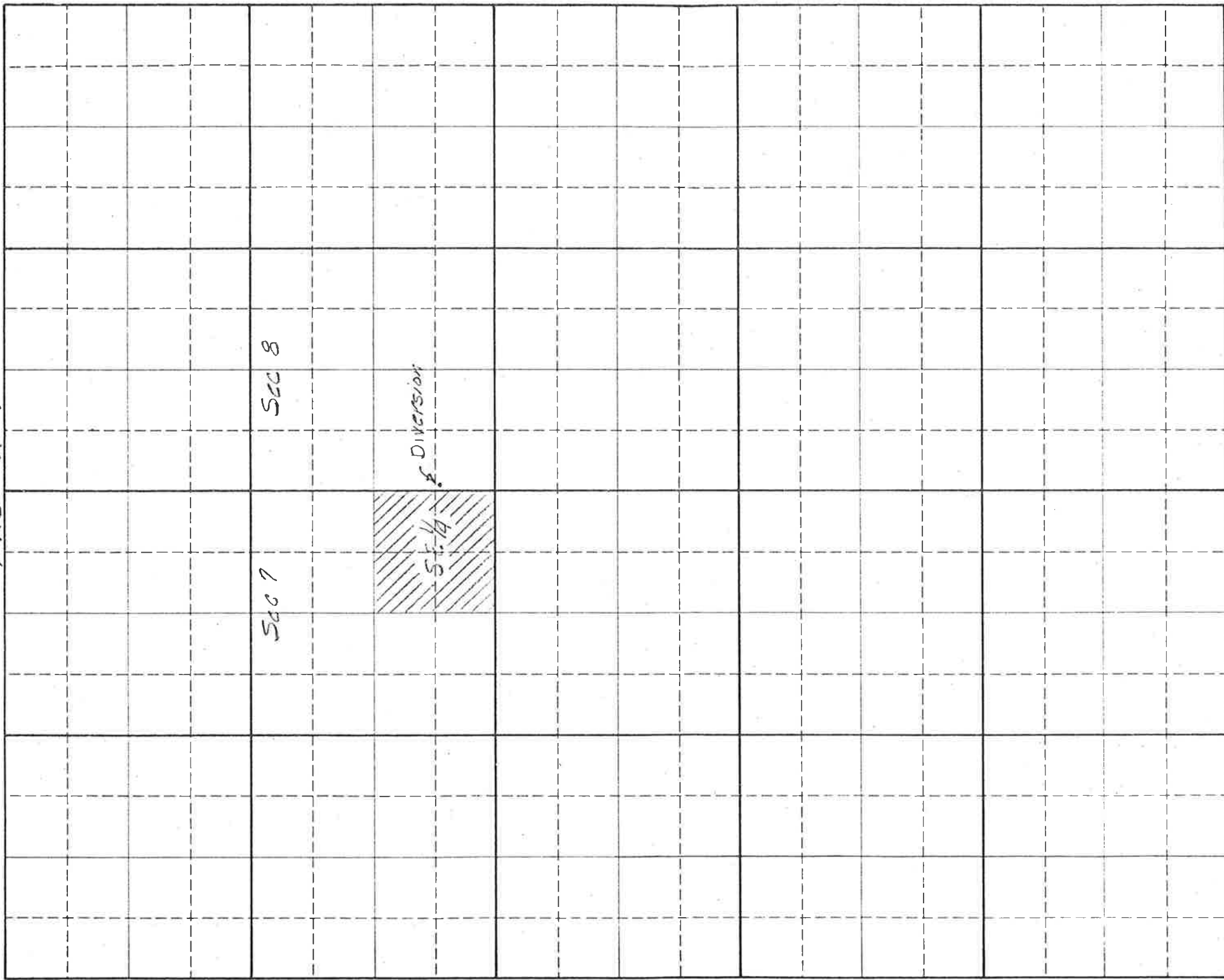

Scale: 2 inches equal 1 mile

BE IT KNOWN that the undersigned hereby makes application for permit to appropriate the public waters of the State of Idaho as herein set forth.

Marjorie Miller  
(Applicant)

Proposed Priority 7-7-76

Received by GLE Date 7-7-76 Time 10:00AM

Preliminary check by RSN Fee \$ 45.00

#2086

Received by CC Date 7-7-76

Publication prepared by pj Date 7-13-76

Published in Times News

Publication dates 7-22 & 29, 1976

Publication approved (7) Date 7-30-76

Priority reduced to \_\_\_\_\_ Reason \_\_\_\_\_

Protests filed by: \_\_\_\_\_

Copies of protests forwarded by \_\_\_\_\_

Hearing held by \_\_\_\_\_ Date \_\_\_\_\_

Recommended for approval denial by mls DRT

#### ACTION OF THE DIRECTOR, DEPARTMENT OF WATER RESOURCES

This is to certify that I have examined Application for Permit to appropriate the public waters of the State of Idaho No. 45-7271, and said application is hereby APPROVED.

1. Approval of said application is subject to the following limitations and conditions:

- a. SUBJECT TO ALL PRIOR WATER RIGHTS.
- b. Proof of construction of works and application of water to beneficial use shall be submitted on or before September 1, 19 79.
- c. Other: A measuring device of a type approved by the Director shall be permanently installed and maintained as part of the diverting works.

2. Denial of said application is for the following reasons: \_\_\_\_\_

Witness my hand this 30 day of August, 19 76.

  
Director