

IDAHO DEPARTMENT OF WATER RESOURCES
Proof Report

6/12/2020

Water Permit 45-7300

<u>Owner Type</u>	<u>Name and Address</u>
Current Owner	JAMES M RODGERS RT 1 BOX 79 DECLO, ID 83323 (208) 654-2145

Status: Relinquished

<u>Source</u>	<u>Tributary</u>
---------------	------------------

<u>Beneficial Use</u>	<u>From</u>	<u>To</u>	<u>Diversion Rate</u>	<u>Volume</u>
-----------------------	-------------	-----------	-----------------------	---------------

Source and Point(s) of Diversion

Place Of Use

Conditions of Approval:

Comments:

Dates and Other Information

Water District Number: TBD
Mitigation Plan: False

Combined Use Limits

N/A

SubCase:

N/A

Water Supply Bank:

N/A

Depend
Southern

Route 1, Box 79
Declo, Idaho 83323
July 18, 1977

State of Idaho Department of Water Resources
Southern Region Office
1041 Blue Lakes Blvd.
Twin Falls, Idaho 83301

Re: Application For Permit No. 45-7300

Gentlemen:

I hereby withdraw my application for water use permit # 45-7300.

Very truly yours,

James M. Rodgers

James M. Rodgers

Identification No. _____

Application No. 45-7300

STATE OF IDAHO
DEPARTMENT OF WATER RESOURCES
APPLICATION FOR PERMIT

To Appropriate the Public Waters of the State of Idaho
(TYPE OR PRINT IN INK)

1. Name of applicant James M. Rodgers Phone: 654-4972
post office address Rte. 1, Box 79 Declo, Idaho 83323
2. Source of water supply Marsh Creek which is a tributary of Snake River
3. a. Location of point of diversion is SW $\frac{1}{4}$ of SE $\frac{1}{4}$ of Section 30 Township 10S
25E., Cassia County; additional points of diversion if any: _____
Range _____ B.M. _____

- b. If water is not consumed, it will be discharged into Marsh Creek at a point in SE $\frac{1}{4}$
of SW $\frac{1}{4}$ of Section 30 Township 10S Range 25E., B.M. _____
4. Water will be used for the following purposes:
Amount .30cfs for irrigation purpose from March 15 to Nov. 15 (both dates inclusive)
(cfs or acre-feet per annum)
Amount _____ for _____ purpose from _____ to _____ (both dates inclusive)
(cfs or acre-feet per annum)
Amount _____ for _____ purpose from _____ to _____ (both dates inclusive)
(cfs or acre-feet per annum)
5. Total quantity to be appropriated:
a. .30cfs cubic feet per second and/or
b. _____ acre feet per annum.
6. Proposed diverting works:
a. Description of ditches, flumes, pumps, headgates, etc. pump, sprinklers

b. Height of storage dam _____ feet, active reservoir capacity _____ acre feet; total reservoir
capacity _____ acre feet, materials used in storage dam: _____
Period of year during which storage will occur _____ to _____ inclusive.
(Mo. Day) (Mo. Day)
c. Proposed well diameter is _____ inches; proposed depth of well is _____ feet.
7. a. Time required for the completion of the works and application of the water to the proposed beneficial use
is 5 years.
b. Estimated construction cost is \$ 3,200.00
8. Description of proposed uses:
a. If water is **not** for irrigation:
(1) Give the place of use of water: _____ $\frac{1}{4}$ of _____ $\frac{1}{4}$ of Section _____ Township _____
Range _____ B.M. _____
(2) Amount of power to be generated: _____ hp under _____ feet of head.
(3) List number of each kind of livestock to be watered _____

(4) Name of municipality to be served _____, or number of families to be
supplied with domestic water _____.
(5) If water is to be used for other purposes describe: _____

b. If water is for irrigation, indicate acreage in each subdivision in the tabulation below:

TWP.	RANGE	SEC.	NE1/4				NW1/4				SW1/4				SE1/4				TOTALS
			NE1/4	NW1/4	SW1/4	SE1/4	NE1/4	NW1/4	SW1/4	SE1/4	NE1/4	NW1/4	SW1/4	SE1/4	NE1/4	NW1/4	SW1/4	SE1/4	
10S	25E	30															15		15

Total number of acres to be irrigated 15

c. Describe any other water rights used for the same purposes as described above. Burley Irrigation District water

9. a. Who owns the property at the point of diversion APPLICANT
- b. Who owns the land to be irrigated or place of use APPLICANT
- c. If the property is owned by a person other than the applicant, describe the arrangement enabling the applicant to make this filing

10. Remarks

11. Map of proposed project: show clearly the proposed point of diversion, place of use, section number, township and range number.

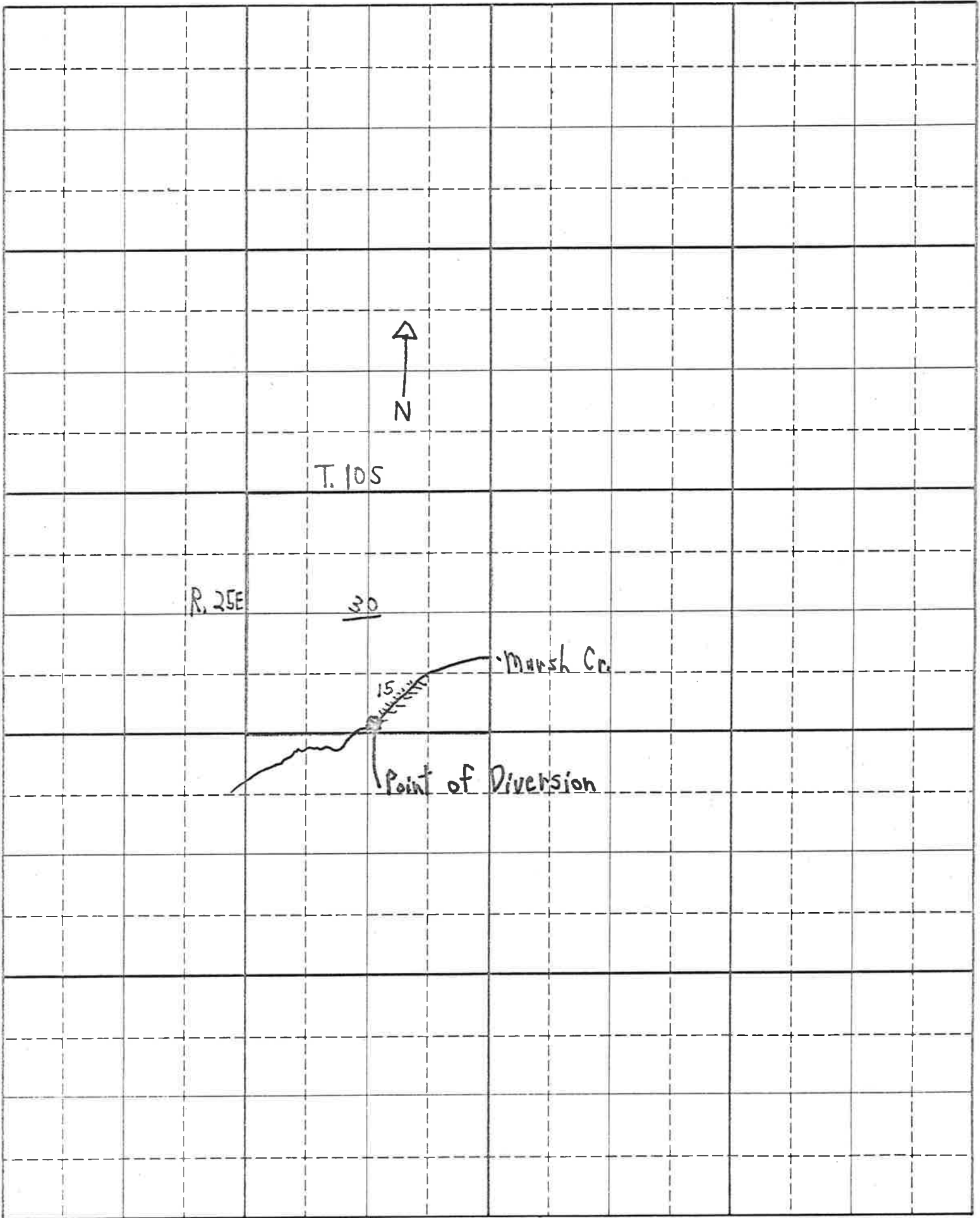

Scale: 2 inches equal 1 mile

BE IT KNOWN that the undersigned hereby makes application for permit to appropriate the public waters of the State of Idaho as herein set forth.

James M. Rodgers
(Applicant)

Received by JS Date 5-6-77 Time 3 PM
Preliminary check by DS Fee \$ 25.00 # 3499
Receipted by SB Date 5/6/77
Publication prepared by SB Date 5/10/77
Published in South Idaho Press
Publication dates 5/17 + 5/24/77
Publication approved lm Date 5/17/77
Priority reduced to _____ Reason _____

Protests filed by: _____

Copies of protests forwarded by _____
Hearing held by _____ Date _____
Recommended for approval (denial) by mls

ACTION OF THE DIRECTOR, DEPARTMENT OF WATER RESOURCES

This is to certify that I have examined Application for Permit to appropriate the public waters of the State of Idaho No. _____, and said application is hereby _____.

1. Approval of said application is subject to the following limitations and conditions:

- a. SUBJECT TO ALL PRIOR WATER RIGHTS.
- b. Proof of construction of works and application of water to beneficial use shall be submitted on or before _____, 19____.
- c. Other: _____

2. Denial of said application is for the following reasons: _____

Witness my hand this _____ day of _____ 19____.

Director