

IDAHO DEPARTMENT OF WATER RESOURCES
Proof Report

6/12/2020

Water Permit 45-7301

<u>Owner Type</u>	<u>Name and Address</u>
Current Owner	DON CARLOS LOVELAND 227 S 350 E BURLEY, ID 83318 (208) 678-5091

Status: Lapsed

Source

Tributary

Beneficial Use

From

To

Diversion Rate

Volume

Source and Point(s) of Diversion

Place Of Use

Conditions of Approval:

Comments:

Dates and Other Information

Water District Number: TBD
Mitigation Plan: False

Combined Use Limits

N/A

SubCase:

N/A

Water Supply Bank:

N/A

Identification No. _____

Application No. 45-7301

STATE OF IDAHO
DEPARTMENT OF WATER RESOURCES

APPLICATION FOR PERMIT

APPROVED

To Appropriate the Public Waters of the State of Idaho
(TYPE OR PRINT IN INK)

1. Name of applicant Don Carlos Loveland Phone: 678-5091
post office address Route #1, Burley, ID
2. Source of water supply ground water which is a tributary of _____
3. a. Location of point of diversion is SW $\frac{1}{4}$ of NW $\frac{1}{4}$ of Section 1 Township 11S
Range 23E B.M. Cassia County; additional points of diversion if any: _____

- b. If water is not consumed, it will be discharged into _____ at a point in _____ $\frac{1}{4}$
of _____ $\frac{1}{4}$ of Section _____ Township _____ Range _____ B.M. _____
4. Water will be used for the following purposes:
Amount 4.0 cfs for irrigation purpose from March 15 to Nov. 15 (both dates inclusive)
(cfs or acre-feet per annum)
Amount _____ for _____ purpose from _____ to _____ (both dates inclusive)
(cfs or acre-feet per annum)
Amount _____ for _____ purpose from _____ to _____ (both dates inclusive)
(cfs or acre-feet per annum)
5. Total quantity to be appropriated:
a. 4.0 cubic feet per second and/or
b. _____ acre feet per annum.
6. Proposed diverting works:
a. Description of ditches, flumes, pumps, headgates, etc. _____
well, pump, ditches, tubes

- b. Height of storage dam _____ feet, active reservoir capacity _____ acre feet; total reservoir
capacity _____ acre feet, materials used in storage dam: _____
Period of year during which storage will occur _____ to _____ inclusive.
(Mo., Day) (Mo., Day)
- c. Proposed well diameter is 16 inches; proposed depth of well is 100 feet.
7. a. Time required for the completion of the works and application of the water to the proposed beneficial use
is 5 years.
b. Estimated construction cost is \$5,000.00
8. Description of proposed uses:
a. If water is **not** for irrigation:
(1) Give the place of use of water: _____ $\frac{1}{4}$ of _____ $\frac{1}{4}$ of Section _____ Township _____
Range _____ B.M. _____
(2) Amount of power to be generated: _____ hp under _____ feet of head
(3) List number of each kind of livestock to be watered: _____

(4) Name of municipality to be served _____, or number of families to be
supplied with domestic water: _____
(5) If water is to be used for other purposes describe: _____

b. If water is for irrigation, indicate acreage in each subdivision in the tabulation below:

TWP.	RANGE	SEC.	NE $\frac{1}{4}$				NW $\frac{1}{4}$				SW $\frac{1}{4}$				SE $\frac{1}{4}$				TOTALS
			NE $\frac{1}{4}$	NW $\frac{1}{4}$	SW $\frac{1}{4}$	SE $\frac{1}{4}$	NE $\frac{1}{4}$	NW $\frac{1}{4}$	SW $\frac{1}{4}$	SE $\frac{1}{4}$	NE $\frac{1}{4}$	NW $\frac{1}{4}$	SW $\frac{1}{4}$	SE $\frac{1}{4}$	NE $\frac{1}{4}$	NW $\frac{1}{4}$	SW $\frac{1}{4}$	SE $\frac{1}{4}$	
11S	23E	1					40	40	40	40									160
		2	40																40

Total number of acres to be irrigated 200

c. Describe any other water rights used for the same purposes as described above. Burley Irrigation District Water.

9. a. Who owns the property at the point of diversion applicant

b. Who owns the land to be irrigated or place of use applicant owns 80 acres.

c. If the property is owned by a person other than the applicant, describe the arrangement enabling the applicant to make this filing 120 acres owned by Don C. Loveland; leased to applicant.

10. Remarks

11. Map of proposed project: show clearly the proposed point of diversion, place of use, section number, township and range number.

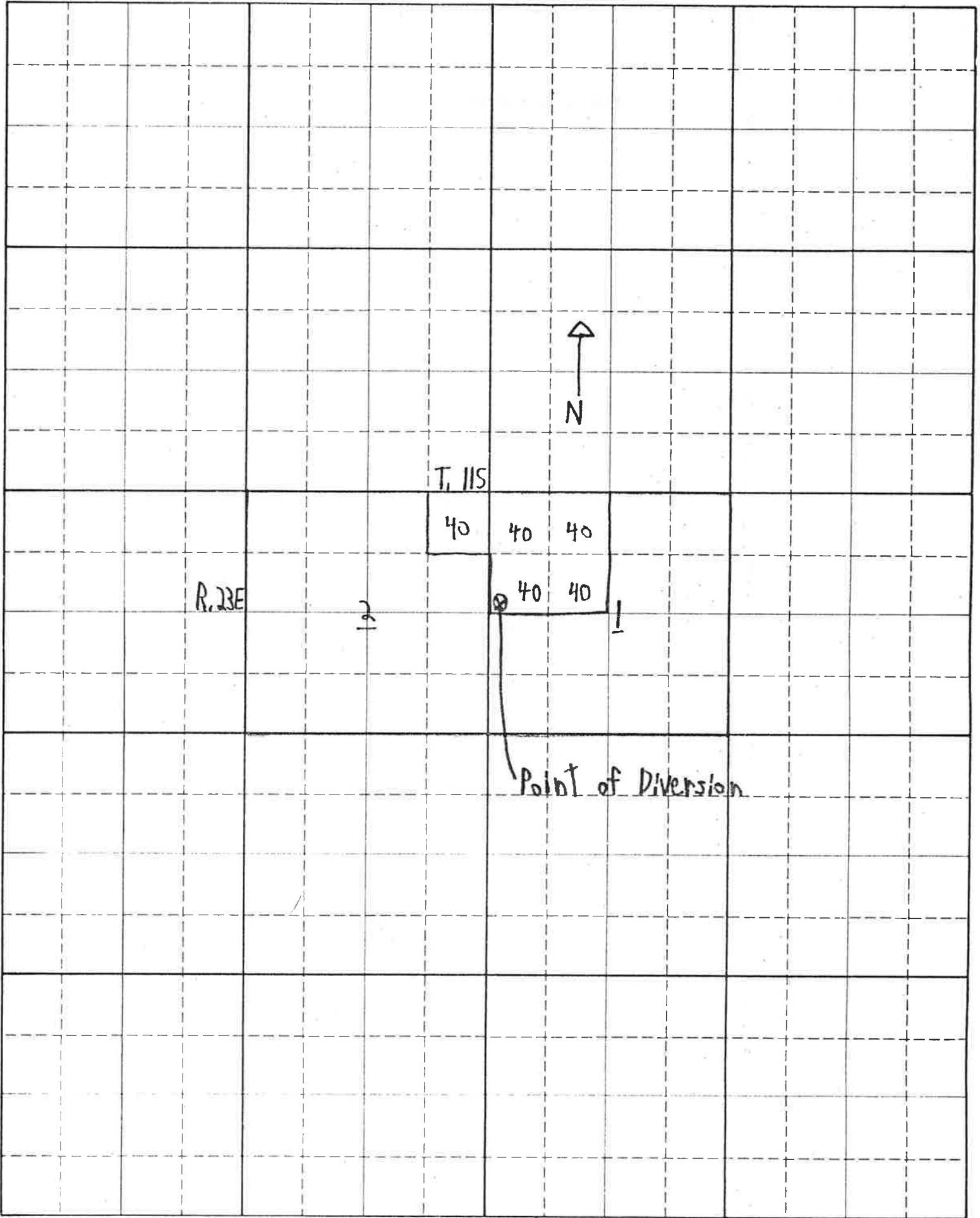

Scale: 2 inches equal 1 mile

BE IT KNOWN that the undersigned hereby makes application for permit to appropriate the public waters of the State of Idaho as herein set forth.

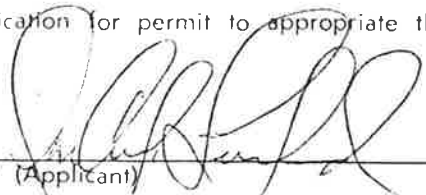
(Applicant)

Proposed Priority 5/ 9/77

Received by gs Date 5-9-77 Time 10 am

Preliminary check by ADM Fee \$ 55.00 # 3501

Receipted by gs Date 5-9-77

Publication prepared by Am Date 5/10/77

Published in South Idaho Press

Publication dates 5/17 + 5/24/77

Publication approved Am Date 5/17/77

Priority reduced to _____ Reason _____

Protests filed by: _____

Copies of protests forwarded by _____

Hearing held by _____ Date _____

Recommended for approval denial by mts jg

ACTION OF THE DIRECTOR, DEPARTMENT OF WATER RESOURCES

This is to certify that I have examined Application for Permit to appropriate the public waters of the State of Idaho No. 45-7301, and said application is hereby APPROVED.

1. Approval of said application is subject to the following limitations and conditions:

a. SUBJECT TO ALL PRIOR WATER RIGHTS.

b. Proof of construction of works and application of water to beneficial use shall be submitted on or before August 1, 19 82.

c. Other: For licensing purposes a scientific measurement of the diversion rate of the system as it is normally operated shall be provided by either properly installing an approved type of measuring device or by having a professional engineer certify the rate of diversion to the Department prior to submitting proof of beneficial use of water.

The rate of diversion of water for irrigation under this permit and all other water rights on the same land shall not exceed 0.02 cubic feet per second for each acre of land.

The issuance of this permit in no way grants any right-of-way or easement across the land of another.

Witness my hand this 30 day of _____ August _____ 19 77.

Director