

6/12/2020

RECEIVED
OCT 25 1978
Department of Water Resources
Bozeman District Office

STATE OF IDAHO
DEPARTMENT OF WATER RESOURCES
APPLICATION FOR PERMIT

Ident. No. 45-7357

APPROVED

To appropriate the public waters of the State of Idaho

1. Name of applicant Janet A. &/or Kenneth J. Cobbley Phone 408-372-0638

Post office address 1140 Monarch Lane, Apt. 201, Pacific Grove, CA 93950

2. Source of water supply ground water which is a tributary of

3. Location of point of diversion is NE ¼ of SE ¼ of Section 26 Township 11S

Range 24E., B.M. Cassia County, additional points of diversion if any:

NW¼NW¼, Sec. 25, Twp. 11S, Rge. 24E., B. M.

4. Water will be used for the following purposes:

Amount 2.4cfs for Irrigation purposes from Mar. 15 to Nov. 15 (both dates inclusive)
(cfs or acre-feet per annum)

Amount for purposes from to (both dates inclusive)
(cfs or acre-feet per annum)

Amount for purposes from to (both dates inclusive)
(cfs or acre-feet per annum)

Amount for purposes from to (both dates inclusive)
(cfs or acre-feet per annum)

5. Total quantity to be appropriated:

a. 2.4 cubic feet per second and/or b. acre-feet per annum.

6. Proposed diverting works:

a. Description of ditches, flumes, pumps, headgates, etc. well

b. Height of storage dam feet, active reservoir capacity acre-feet; total reservoir capacity acre-feet, materials used in storage dam:

Period of year when water will be diverted to storage to inclusive.
(Month/Day) (Month/Day)

c. Proposed well diameter is 20 inches; proposed depth of well is 700 feet.

7. Time required for the completion of the works and application of the water to the proposed beneficial use is 5 years (minimum 1 year - maximum 5 years).

8. Description of proposed uses:

a. If water is not for irrigation:

(1) Give the place of use of water: ¼ of ¼ of Section Township
Range B.M.

(2) Amount of power to be generated: horsepower under feet of head.

(3) List number of each kind of livestock to be watered

(4) Name of municipality to be served, or number of families to be supplied with domestic water

(5) If water is to be used for other purposes describe:

45-7357

b. If water is for irrigation, indicate acreage in each subdivision in the tabulation below:

[illegible]

Total number of acres to be irrigated 120

c. Describe any other water rights used for the same purposes as described above. None

9. a. Who owns the property at the point of diversion Applicants

b. Who owns the land to be irrigated or place of use Applicants

c. If the property is owned by a person other than the applicant, describe the arrangement enabling the applicant to make this filing

10. Remarks

11. Map of proposed project: show clearly the proposed point of diversion, place of use, section number, township and range number.

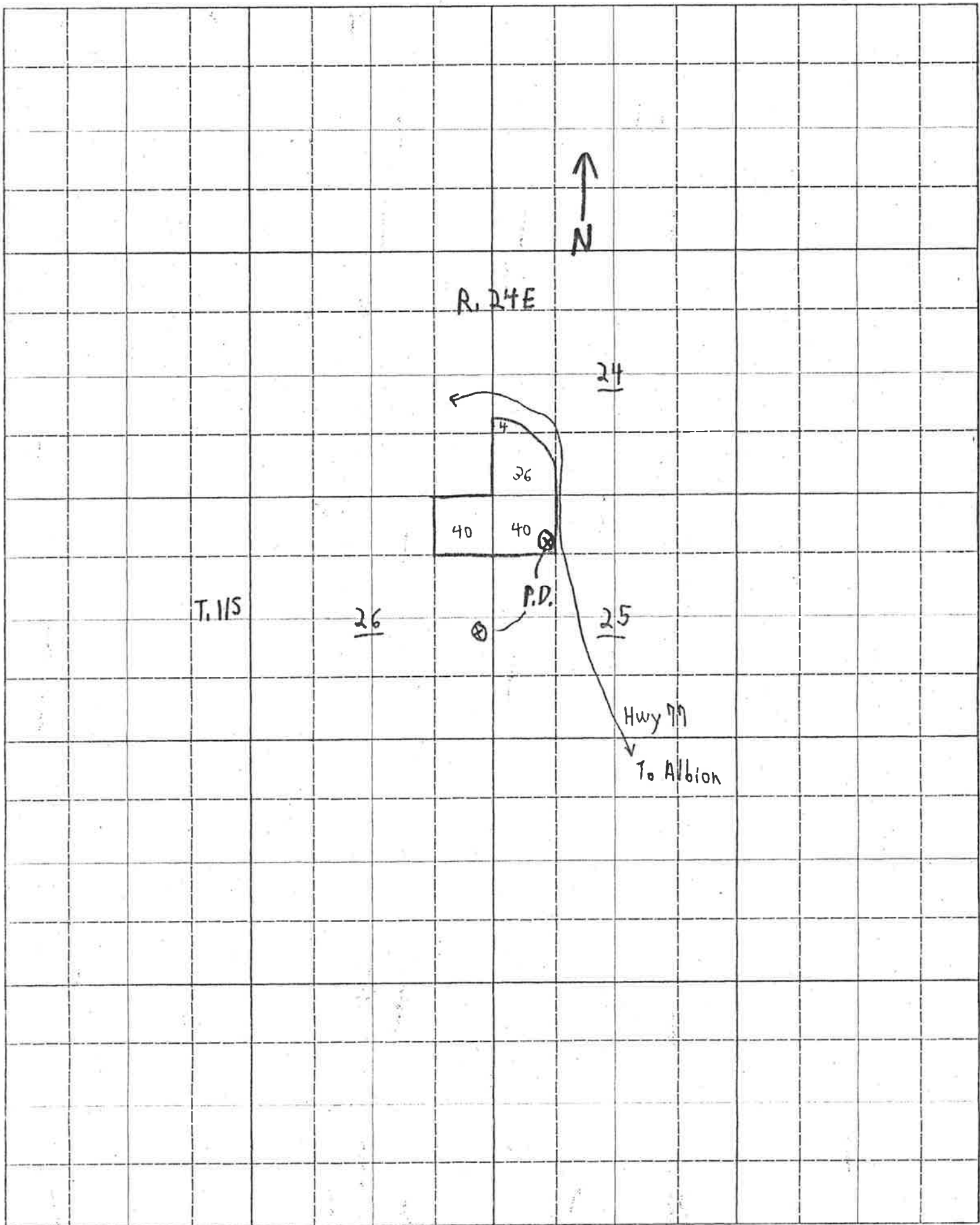

Scale: 2 inches equal 1 mile.

BE IT KNOWN that the undersigned hereby makes application for permit to appropriate the public waters of the State of Idaho as herein set forth.

Kenneth P. McElroy
(Applicant)

Proposed Priority 8-30-78

Received by JS Date 8-30-78 Time 3pm
Preliminary check by ADM Fee \$ 55⁰⁰ # 10551
Receipted by marva Date 9/1/78
Publication prepared by marva Date 9/7/78
Published in south idaho news
Publication dates sept. 19 + sept. 26, 1978
Publication approved marva Date 9/18/78
Protests filed by: _____

Copies of protests forwarded by _____

Hearing held by _____ Date _____

Recommended for approval denial by JK JG

ACTION OF THE DIRECTOR, DEPARTMENT OF WATER RESOURCES

This is to certify that I have examined Application for Permit to appropriate the public waters of the State of Idaho No. 45-7357, and said application is hereby APPROVED.

1. Approval of said application is subject to the following limitations and conditions:

- a. SUBJECT TO ALL PRIOR WATER RIGHTS.
- b. Proof of construction of works and application of water to beneficial use shall be submitted on or before October 1, 19 83.
- c. The rate of diversion, if water is to be used for irrigation under this permit, when combined with all other water rights for the same land shall not exceed 0.02 cubic feet per second for each acre of land.
- d. Other: An access port or other device as specified by the Department shall be installed by the permit holder to provide for the installation of measuring equipment and the determination of the rate of diversion by the Department.

Witness my hand this 20th day of October, 1978.

L. Glen Saxton
Chief, Operations Bureau