

IDAHO DEPARTMENT OF WATER RESOURCES  
Proof Report

6/16/2020

Water Permit 47-7224

<u>Owner Type</u>	<u>Name and Address</u>
Current Owner	FOREST C WEAVER RT 1 BUHL, ID 83316 (208) 543-6851

Status: Lapsed

<u>Source</u>	<u>Tributary</u>
---------------	------------------

<u>Beneficial Use</u>	<u>From</u>	<u>To</u>	<u>Diversion Rate</u>	<u>Volume</u>
-----------------------	-------------	-----------	-----------------------	---------------

Source and Point(s) of Diversion

Place Of Use

Conditions of Approval:

Comments:

Dates and Other Information

Water District Number: TBD  
Mitigation Plan: False

Combined Use Limits

N/A

SubCase:

N/A

Water Supply Bank:

N/A

Identification No. \_\_\_\_\_

Application No. 47-7224

RECEIVED

NOV 26 1973

Department of Water Administration  
Southern District Office

STATE OF IDAHO  
DEPARTMENT OF WATER ADMINISTRATION

APPLICATION FOR PERMIT

APPROVED

To Appropriate the Public Waters of the State of Idaho  
(TYPE OR PRINT IN INK)

1. Name of applicant FOREST WEAVER  
post office address Route 1, Buhl, Idaho

2. Source of water supply Unnamed Stream which is a tributary of SNAKE RIVER

3. a. Location of point of diversion is NW  $\frac{1}{4}$  of SW  $\frac{1}{4}$  of Section 4 Township 9 S  
Range 14 E B.M. Twin Falls County; additional points of diversion if any: \_\_\_\_\_

b. If water is not consumed, it will be discharged into \_\_\_\_\_ at a point in \_\_\_\_\_  $\frac{1}{4}$   
of \_\_\_\_\_  $\frac{1}{4}$  of Section \_\_\_\_\_ Township \_\_\_\_\_ Range \_\_\_\_\_ B.M. \_\_\_\_\_

4. Water will be used for the following purposes:

Amount .40 for Domestic purpose from Jan. 1 to Dec. 31 (both dates inclusive)

Amount .10 for Irrigation purpose from March 15 to Nov. 15 (both dates inclusive)

Amount .40 for Fish propagation purpose from Jan. 1 to Dec. 31 (both dates inclusive)

5. Total quantity to be appropriated:

a. .40 cubic feet per second and/or

b. \_\_\_\_\_ acre feet per annum.

6. Proposed diverting works:

a. Description of ditches, flumes, pumps, headgates, etc. Pressure pump for domestic.  
Pipeline for irrigation. 20' x 30' fish pond.

b. Height of storage dam \_\_\_\_\_ feet, active reservoir capacity \_\_\_\_\_ acre feet; total reservoir  
capacity \_\_\_\_\_ acre feet, materials used in storage dam: \_\_\_\_\_

Period of year during which storage will occur \_\_\_\_\_ to \_\_\_\_\_ inclusive.  
(Mo. Day) (Mo. Day)

c. Proposed well diameter is \_\_\_\_\_ inches; proposed depth of well is \_\_\_\_\_ feet.

7. a. Time required for the completion of the works and application of the water to the proposed beneficial use  
is 5 years.

b. Estimated construction cost is \$ 200.00.

8. Description of proposed uses:

a. If water is **not** for irrigation:

(1) Give the place of use of water: Gov. Lots 7 & 4  $\frac{1}{4}$  of \_\_\_\_\_  $\frac{1}{4}$  of Section 4 Township 9 S  
Range 14 E B.M. \_\_\_\_\_

(2) Amount of power to be generated: \_\_\_\_\_ hp under \_\_\_\_\_ feet of head.

(3) List number of each kind of livestock to be watered \_\_\_\_\_

(4) Name of municipality to be served \_\_\_\_\_, or number of families to be  
supplied with domestic water 10.

(5) If water is to be used for other purposes describe: Fish pond is for applicant's own  
recreational purposes

47-7224

b. If water is for irrigation, indicate acreage in each subdivision in the tabulation below:

TWP.	RANGE	SEC.	NE¼				NW¼				SW¼				SE¼				TOTALS
			NE¼	NW¼	SW¼	SE¼	NE¼	NW¼	SW¼	SE¼	NE¼	NW¼	SW¼	SE¼	NE¼	NW¼	SW¼	SE¼	
9 S	14 E	4									Gov. Lot 4 (2.5)								5
											Gov. Lot 7 (2.5)								

Total number of acres to be irrigated 5

c. Describe any other water rights used for the same purposes as described above. None

9. a. Who owns the property at the point of diversion Applicant

b. Who owns the land to be irrigated or place of use Applicant

c. If the property is owned by a person other than the applicant, describe the arrangement enabling the applicant to make this filing

10. Remarks

11. Map of proposed project: show clearly the proposed point of diversion, place of use, section number, township and range number.

R 4 E

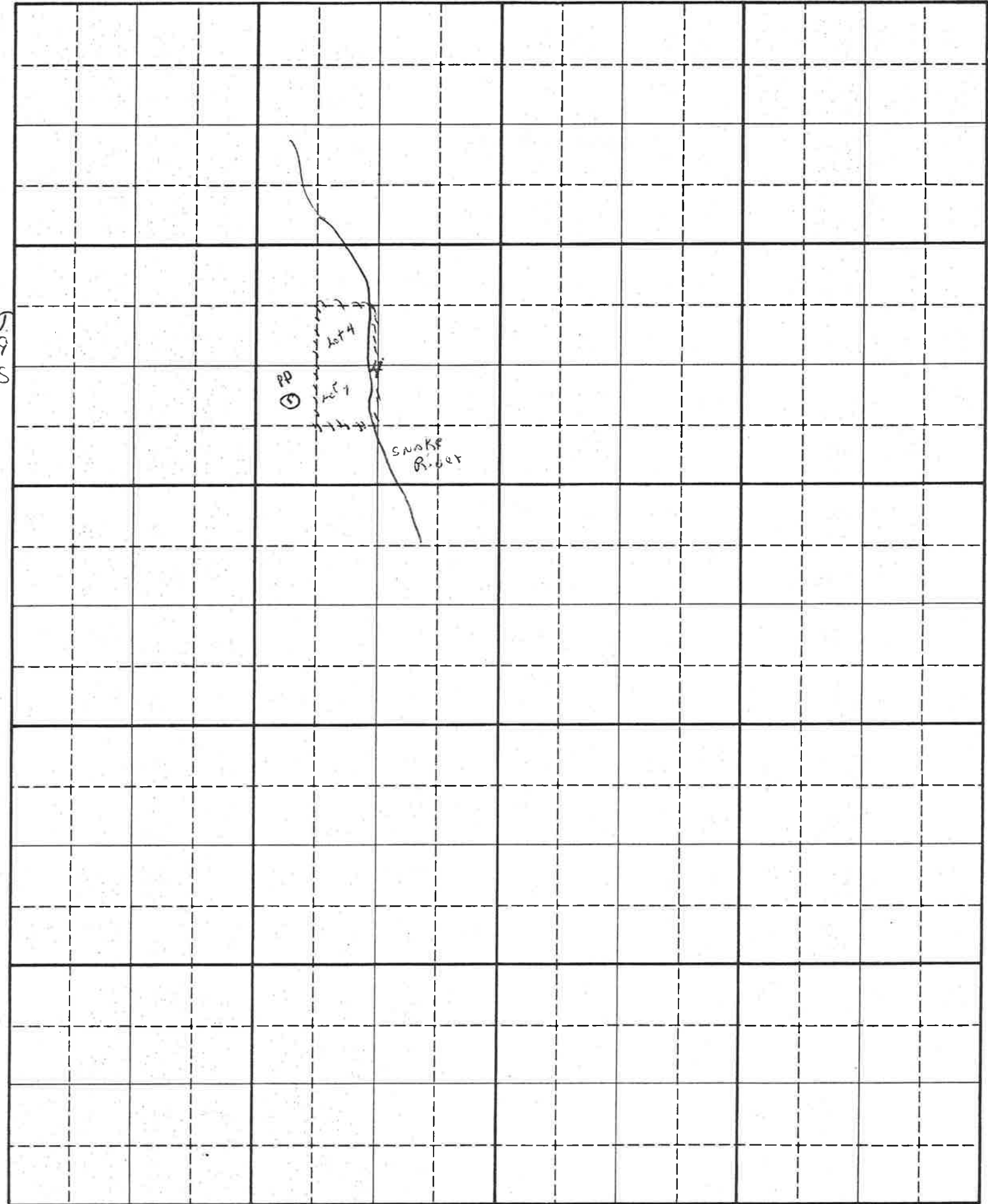

Scale: 2 inches equal 1 mile

BE IT KNOWN that the undersigned hereby makes application for permit to appropriate the public waters of the State of Idaho as herein set forth.

Forest Weaver  
(Applicant)

Proposed Priority 10-5-1973

Received by EB Date 10/5/73 Time 11:00 am

Preliminary check by EB Fee \$ 25.00

Receipted by 21 Date 10-5-73 Reel # 12467

RA Publication prepared by jmm Date 10-16-73

Published in Times News

Publication dates 10-25 & 11-1-73

Publication approved jmm Date 11-2-73

Priority reduced to \_\_\_\_\_ Reason \_\_\_\_\_

Protests filed by: \_\_\_\_\_

Copies of protests forwarded by \_\_\_\_\_

Hearing held by \_\_\_\_\_ Date \_\_\_\_\_

Recommended for approval denial by du EDF

#### ACTION OF THE DIRECTOR, DEPARTMENT OF WATER ADMINISTRATION

This is to certify that I have examined Application for Permit to appropriate the public waters of the State of Idaho No. 47-7224, and said application is hereby APPROVED.

1. Approval of said application is subject to the following limitations and conditions:

- a. SUBJECT TO ALL PRIOR WATER RIGHTS.
- b. Proof of construction of works and application of water to beneficial use shall be submitted on or before November 1, 19 78.
- c. Other: A measuring device of a type approved by this department shall be permanently installed and maintained as part of the diverting works.

2. Denial of said application is for the following reasons: \_\_\_\_\_

Witness my hand this 20th day of November 19 73.

R. Keith Higin  
Director