

IDAHO DEPARTMENT OF WATER RESOURCES  
Proof Report

6/16/2020

Water Permit 47-7147

<u>Owner Type</u>	<u>Name and Address</u>
Current Owner	ANDREW C LANG , ZZ
Current Owner	WILLIAM A LANG , ZZ

Status: Lapsed

Source

Tributary

<u>Beneficial Use</u>	<u>From</u>	<u>To</u>	<u>Diversion Rate</u>	<u>Volume</u>
-----------------------	-------------	-----------	-----------------------	---------------

Source and Point(s) of Diversion

Place Of Use

Conditions of Approval:

Comments:

Dates and Other Information

Water District Number: TBD  
Mitigation Plan: False

Combined Use Limits

N/A

SubCase:

N/A

Water Supply Bank:

N/A

Identification No. \_\_\_\_\_  
Application No. 47-7147

STATE OF IDAHO  
DEPARTMENT OF WATER ADMINISTRATION  
**APPLICATION FOR PERMIT** **APPROVED**

To Appropriate the Public Waters of the State of Idaho  
(TYPE OR PRINT IN INK) Lang

1. Name of applicant ANDREW C. LANG &/or WILLIAM A. LANG  
post office address 405 Gardner Avenue, Twin Falls, Idaho
2. Source of water supply ground water which is a tributary of \_\_\_\_\_
3. a. Location of point of diversion is NE  $\frac{1}{4}$  of NW  $\frac{1}{4}$  of Section 21 Township 10 S  
Range 17 E B.M. Twin Falls County; additional points of diversion if any: \_\_\_\_\_  
(5 wells in same 40 acre subdivision)
- b. If water is not consumed, it will be discharged into \_\_\_\_\_ at a point in \_\_\_\_\_  $\frac{1}{4}$   
of \_\_\_\_\_  $\frac{1}{4}$  of Section \_\_\_\_\_ Township \_\_\_\_\_ Range \_\_\_\_\_ B.M. \_\_\_\_\_
4. Water will be used for the following purposes:  
Amount 0.32 for irrigation purpose from Mar. 15 to Nov. 15 (both dates inclusive)  
(cfs or acre-feet per annum)  
Amount 0.02 for stock water purpose from Jan. 1 to Dec. 31 (both dates inclusive)  
(cfs or acre-feet per annum)  
Amount 1.16 for fish prop purpose from Jan. 1 to Dec. 31 (both dates inclusive)  
(cfs or acre-feet per annum)
5. Total quantity to be appropriated:  
a. 1.16 cubic feet per second and/or  
b. \_\_\_\_\_ acre feet per annum.
6. Proposed diverting works:  
a. Description of ditches, flumes, pumps, headgates, etc. \_\_\_\_\_  
well, pump and electric motor  
fish ponds will be built of cinder blocks  
b. Height of storage dam \_\_\_\_\_ feet, active reservoir capacity \_\_\_\_\_ acre feet; total reservoir  
capacity \_\_\_\_\_ acre feet, materials used in storage dam: \_\_\_\_\_  
Period of year during which storage will occur \_\_\_\_\_ to \_\_\_\_\_ inclusive.  
(Mo. Day) (Mo. Day)  
c. Proposed well diameter is \_\_\_\_\_ inches; proposed depth of well is \_\_\_\_\_ feet.  
5 existing wells
7. a. Time required for the completion of the works and application of the water to the proposed beneficial use  
is 5 years.  
b. Estimated construction cost is \$ \_\_\_\_\_.
8. Description of proposed uses:  
a. If water is **not** for irrigation: W.A.L.  
NW NX  
(1) Give the place of use of water: NE  $\frac{1}{4}$  of NW  $\frac{1}{4}$  of Section 21 Township 10 S  
Range 17 E B.M.  
(2) Amount of power to be generated: \_\_\_\_\_ hp under \_\_\_\_\_ feet of head.  
(3) List number of each kind of livestock to be watered \_\_\_\_\_  
25 head of cattle  
(4) Name of municipality to be served \_\_\_\_\_, or number of families to be  
supplied with domestic water \_\_\_\_\_.  
(5) If water is to be used for other purposes describe: \_\_\_\_\_  
fish propogation

47-7147

b. If water is for irrigation, indicate acreage in each subdivision in the tabulation below:

TWP.	RANGE	SEC.	NE <sup>1</sup> / <sub>4</sub>				NW <sup>1</sup> / <sub>4</sub>				SW <sup>1</sup> / <sub>4</sub>				SE <sup>1</sup> / <sub>4</sub>				TOTALS
			NE <sup>1</sup> / <sub>4</sub>	NW <sup>1</sup> / <sub>4</sub>	SW <sup>1</sup> / <sub>4</sub>	SE <sup>1</sup> / <sub>4</sub>	NE <sup>1</sup> / <sub>4</sub>	NW <sup>1</sup> / <sub>4</sub>	SW <sup>1</sup> / <sub>4</sub>	SE <sup>1</sup> / <sub>4</sub>	NE <sup>1</sup> / <sub>4</sub>	NW <sup>1</sup> / <sub>4</sub>	SW <sup>1</sup> / <sub>4</sub>	SE <sup>1</sup> / <sub>4</sub>	NE <sup>1</sup> / <sub>4</sub>	NW <sup>1</sup> / <sub>4</sub>	SW <sup>1</sup> / <sub>4</sub>	SE <sup>1</sup> / <sub>4</sub>	
10 S	17 E	21					8												8

Total number of acres to be irrigated 8

c. Describe any other water rights used for the same purposes as described above. NONE

9. a. Who owns the property at the point of diversion applicant

b. Who owns the land to be irrigated or place of use applicant

c. If the property is owned by a person other than the applicant, describe the arrangement enabling the applicant to make this filing \_\_\_\_\_

10. Remarks Two inches of water./ Irrigated acre is applied for due to the small tract of land and the design of the system

11. Map of proposed project: show clearly the proposed point of diversion, place of use, section number, township and range number.

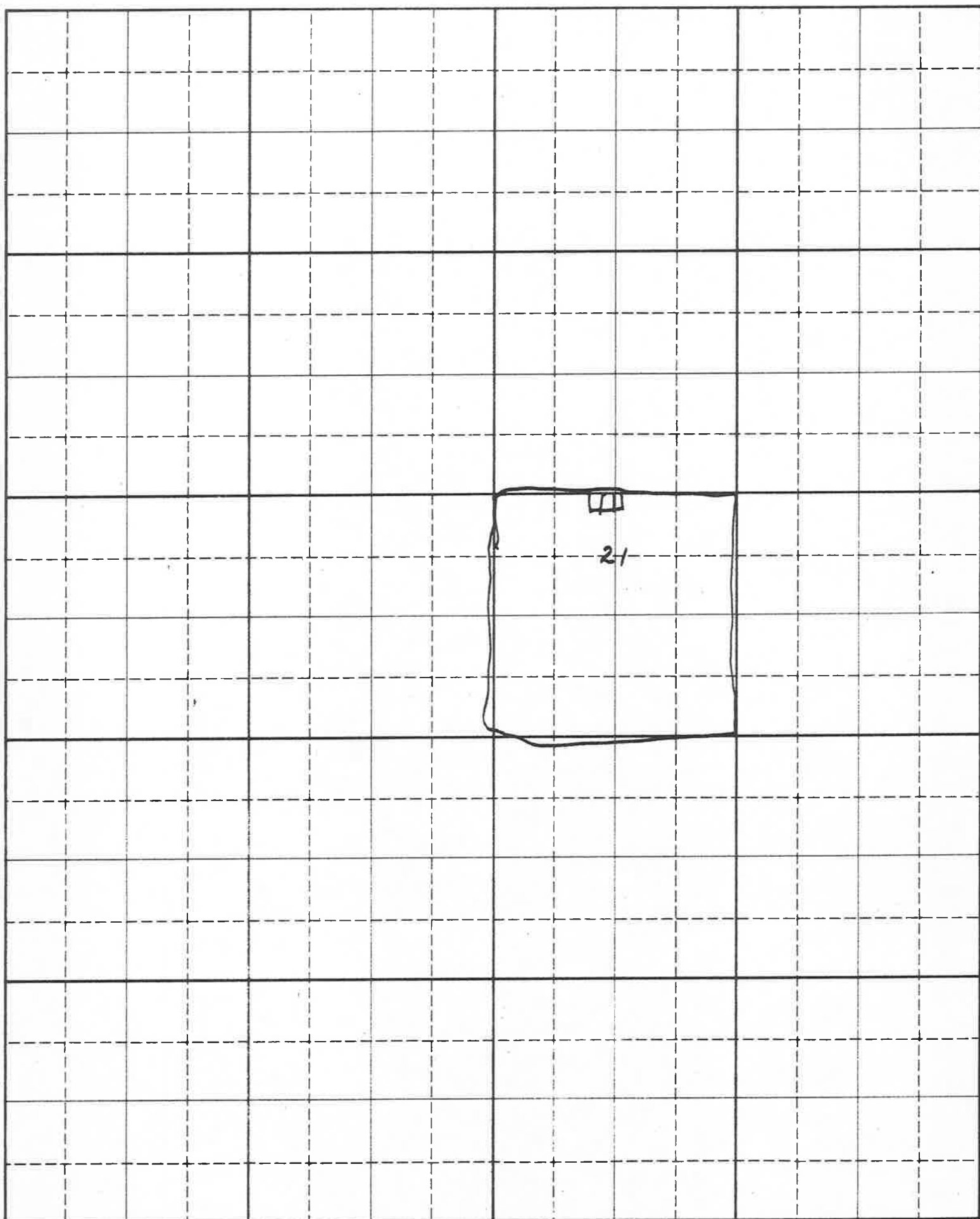

Scale: 2 inches equal 1 mile

BE IT KNOWN that the undersigned hereby makes application for permit to appropriate the public waters of the State of Idaho as herein set forth.

x William A. Lang  
(Applicant)

Leit # 9331

Received by De Date 6/12/72 Time 11:45 A  
Preliminary check by De Fee \$ 35.00  
Received by De Date 6-16-72  
Publication prepared by alw Date 6-16-72  
Published in Times News, Twin Falls  
Publication dates June 22 & June 29, 1972  
Publication approved alw Date 7-7-72  
Priority reduced to 6/12/72 Reason \_\_\_\_\_

Protests filed by: \_\_\_\_\_

Copies of protests forwarded by \_\_\_\_\_

Hearing held by \_\_\_\_\_ Date \_\_\_\_\_

Recommended for approval denial by 1) BDF

#### ACTION OF THE DIRECTOR, DEPARTMENT OF WATER ADMINISTRATION

This is to certify that I have examined Application for Permit to appropriate the public waters of the State of Idaho No. 47-7147, and said application is hereby APPROVED.

1. Approval of said application is subject to the following limitations and conditions:

- a. SUBJECT TO ALL PRIOR WATER RIGHTS.
- b. Proof of construction of works and application of water to beneficial use shall be submitted on or before July 1, 1977.
- c. Other: Measuring devices of a type approved by this Department shall be permanently installed and maintained at the point of diversion and the point of effluent discharge.

2. Denial of said application is for the following reasons: \_\_\_\_\_

Witness my hand this 25 day of July, 1972.

R. Keith Higin  
Director

C  
July 27, 1972

O  
Andrew C. Lang &/or William A. Lang  
405 Gardner Avenue  
Twin Falls, Idaho 83301

Gentlemen.

Enclosed is a copy of your approved Application for Permit No. 47-7147 . We direct your attention to the conditions of approval as listed on the fourth page.

Be sure to note that a special condition requiring you to install and maintain a measuring device at your point of diversion has been placed upon your permit. We are enclosing a letter describing different types of measuring devices accepted by this office.

Very truly yours,

OBBY D. FLEENOR  
Assistant Director

DF:cr

closures