

IDAHO DEPARTMENT OF WATER RESOURCES
Proof Report

6/17/2020

Water Permit 47-7310

<u>Owner Type</u>	<u>Name and Address</u>
Current Owner	JAMES T EDWARDS , ZZ

Status: Lapsed

<u>Source</u>	<u>Tributary</u>
---------------	------------------

<u>Beneficial Use</u>	<u>From</u>	<u>To</u>	<u>Diversion Rate</u>	<u>Volume</u>
-----------------------	-------------	-----------	-----------------------	---------------

Source and Point(s) of Diversion

Place Of Use

Conditions of Approval:

Comments:

Dates and Other Information

Water District Number: TBD
Mitigation Plan: False

Combined Use Limits

N/A

SubCase:

N/A

Water Supply Bank:

N/A

RECEIVED

OCT 31 1975

Department of Water Resources
Southern District Office

STATE OF IDAHO
DEPARTMENT OF WATER RESOURCES

APPLICATION FOR PERMIT

APPROVED

To Appropriate the Public Waters of the State of Idaho

(TYPE OR PRINT IN INK)

Identification No. _____

Application No. 47-7310

1. Name of applicant JAMES T. EDWARDS Phone: 423-4437
post office address Route 2, Kimberly, Idaho 83341
2. Source of water supply waste water (unnamed ditch) which is a tributary of Snake River
3. a. Location of point of diversion is NE $\frac{1}{4}$ of SE $\frac{1}{4}$ of Section 20 Township 11 S.
Range 18 E. B.M. Twin Falls County; additional points of diversion if any: _____

b. If water is not consumed, it will be discharged into Rock Creek at a point in SE $\frac{1}{4}$
of NE $\frac{1}{4}$ of Section 20 Township 11 S. Range 18 E. B.M. _____
4. Water will be used for the following purposes:
Amount .05 for irrigation purpose from April 1 to October 15 (both dates inclusive)
(cfs or acre-feet per annum)
Amount .02 for livestock purpose from January 1 to December 31 (both dates inclusive)
(cfs or acre-feet per annum)
Amount _____ for _____ purpose from _____ to _____ (both dates inclusive)
(cfs or acre-feet per annum)
5. Total quantity to be appropriated:
a. .07 cfs _____ cubic feet per second and/or
b. _____ acre feet per annum.
6. Proposed diverting works:
a. Description of ditches, flumes, pumps, headgates, etc. Pumping from ditch to sprinkle
pastures and flood irrigation of lawn

b. Height of storage dam _____ feet, active reservoir capacity _____ acre feet; total reservoir
capacity _____ acre feet, materials used in storage dam: _____
Period of year during which storage will occur _____ to _____ inclusive.
(Mo., Day) (Mo., Day)
c. Proposed well diameter is _____ inches; proposed depth of well is _____ feet.
7. a. Time required for the completion of the works and application of the water to the proposed beneficial use
is 5 years. (already completed)
b. Estimated construction cost is \$ 50.00
8. Description of proposed uses:
a. If water is **not** for irrigation:
(1) Give the place of use of water: NE $\frac{1}{4}$ of SE $\frac{1}{4}$ of Section 20 Township 11 S.
Range 18 E. B.M.
(2) Amount of power to be generated: _____ hp under _____ feet of head
(3) List number of each kind of livestock to be watered 4 head of cattle and 2 horses

(4) Name of municipality to be served _____, or number of families to be
supplied with domestic water _____
(5) If water is to be used for other purposes describe: _____

47-7310

b. If water is for irrigation, indicate acreage in each subdivision in the tabulation below:

TWP.	RANGE	SEC.	NE1/4				NW1/4				SW1/4				SE1/4				TOTALS
			NE1/4	NW1/4	SW1/4	SE1/4	NE1/4	NW1/4	SW1/4	SE1/4	NE1/4	NW1/4	SW1/4	SE1/4	NE1/4	NW1/4	SW1/4	SE1/4	
11 S	18E	20													2.38				2.38

Total number of acres to be irrigated 2.38

c. Describe any other water rights used for the same purposes as described above.

9. a. Who owns the property at the point of diversion applicant
- b. Who owns the land to be irrigated or place of use applicant
- c. If the property is owned by a person other than the applicant, describe the arrangement enabling the applicant to make this filing applicant is buying land on contract in escrow.

10. Remarks This is a filing on water waste from the property of David Brown, Route 2, Kimberly, Idaho.

11. Map of proposed project: show clearly the proposed point of diversion, place of use, section number, township and range number.

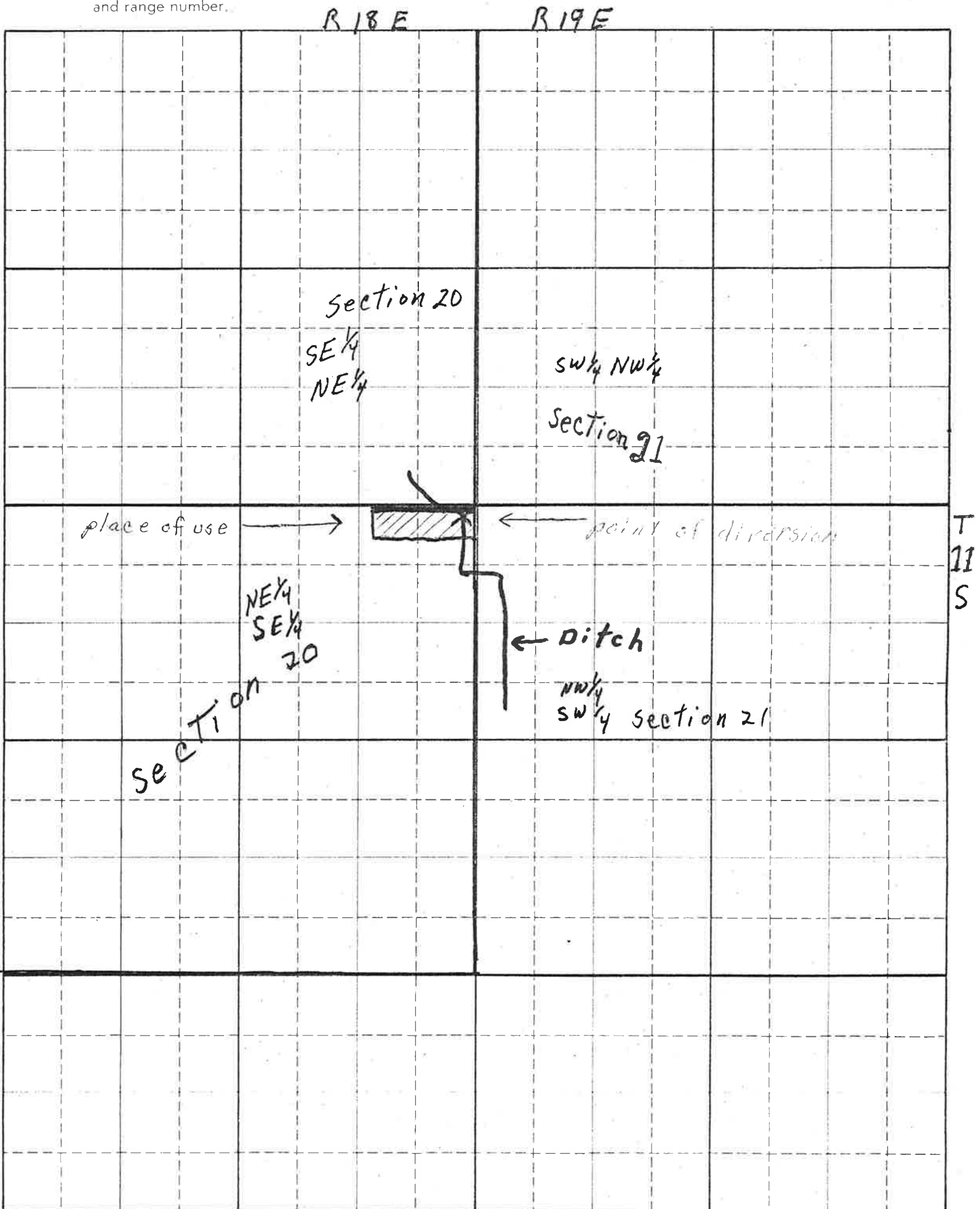

Scale: 2 inches equal $\frac{1}{4}$ mile

BE IT KNOWN that the undersigned hereby makes application for permit to appropriate the public waters of the State of Idaho as herein set forth.

James T. Edwards
(Applicant)

Proposed Priority 9-12-1975

Received by GLF Date 9-12-75 Time 4:00 PM

Preliminary check by GLF Fee \$ 10.00

Receipted by CC Date 9-16-75

Publication prepared by CC Date 9-16-75

Published in Times News

Publication dates 9-25 & 10-2-75

Publication approved CC Date 10-3-75

Priority reduced to _____ Reason _____

Protests filed by: _____

Copies of protests forwarded by _____

Hearing held by _____ Date _____

Recommended for approval denial by W. J. D.

ACTION OF THE DIRECTOR, DEPARTMENT OF WATER RESOURCES

This is to certify that I have examined Application for Permit to appropriate the public waters of the State of Idaho No: 47-7310, and said application is hereby APPROVED.

1. Approval of said application is subject to the following limitations and conditions:

a. SUBJECT TO ALL PRIOR WATER RIGHTS.

b. Proof of construction of works and application of water to beneficial use shall be submitted on or before October 1, 19 80.

c. Other: _____

2. Denial of said application is for the following reasons: _____

Witness my hand this 28 day of October, 19 75.

L. Keith Higin
Director