

IDAHO DEPARTMENT OF WATER RESOURCES
Proof Report

6/16/2020

Water Permit 47-7162

<u>Owner Type</u>	<u>Name and Address</u>
Current Owner	CRYSTAL SPRINGS RANCH LTD PARTNERSHIP 20924 SE 213TH ST MAPLE VALLEY, WA 98038 (206) 432-5772

Status: Lapsed

Source

Tributary

<u>Beneficial Use</u>	<u>From</u>	<u>To</u>	<u>Diversion Rate</u>	<u>Volume</u>
-----------------------	-------------	-----------	-----------------------	---------------

Source and Point(s) of Diversion

Place Of Use

Conditions of Approval:

Comments:

Dates and Other Information

Water District Number: TBD
Mitigation Plan: False

Combined Use Limits

N/A

SubCase:

N/A

Water Supply Bank:

N/A

IDAHO DEPARTMENT OF WATER RESOURCES
Proof Report

6/16/2020

Water Application 47-7162

<u>Owner Type</u>	<u>Name and Address</u>
Current Owner	CRYSTAL SPRINGS RANCH LTD PARTNERSHIP 20924 SE 213TH ST MAPLE VALLEY, WA 98038 (206) 432-5772

Status: Closed

Source

Tributary

Beneficial Use

From

To

Diversion Rate

Volume

Source and Point(s) of Diversion

Place Of Use

Conditions of Approval:

Comments:

Dates and Other Information

Number of Protests: 0

Water District Number: TBD

Application Type: New Appropriation

Mitigation Plan: False

Combined Use Limits

N/A

SubCase:

N/A

Water Supply Bank:

N/A

RECEIVED

JAN 10 1973

Department of Water Administration
Southern District Office

Identification No. _____

Application No. 47-7162

STATE OF IDAHO

DEPARTMENT OF WATER ADMINISTRATION

APPLICATION FOR PERMIT

APPROVED

To appropriate the Public Waters of the State of Idaho
(TYPE OR PRINT IN INK)

1. Name of applicant Crystal Springs Ranch, Inc.
post office address P. O. Box 109, Buhl, Idaho 83316
2. Source of water supply Twin Falls Canal Waste ^{way} which is a tributary of Snake River
3. a. Location of point of diversion is SE $\frac{1}{4}$ of SE $\frac{1}{4}$ of Section 12 Township 9S
Range 15 E.B.M. Twin Falls County; additional points of diversion if any: _____

b. If water is not consumed, it will be discharged into Snake River at a point in SE $\frac{1}{4}$
of NW $\frac{1}{4}$ of Section 11 Township 9 S. Range 15 E. B.M. Twin Falls County
4. Water will be used for the following purposes:
Amount 2.2 ^(cfs) for irrigation purpose from Feb. 1 to Nov. 30 (both dates inclusive)
Amount .1 ^(cfs) for stockwater purpose from Jan. 1 to Dec. 31 (both dates inclusive)
Amount 10.0 ^(cfs) for fish prop. purpose from Jan. 1 to Dec. 31 (both dates inclusive)
5. Total quantity to be appropriated:
a. Ten (10) cubic feet per second and/or
b. _____ acre feet per annum.
6. Proposed diverting works:
a. Description of ditches, flumes, pumps, headgates, etc. Water comes from wasteway
No. 7 of Twin Falls Canal Company and will be picked up in closed
sprinkler system for irrigation and stockwater, remainder being
used for fish propagation on year around basis.
b. Height of storage dam _____ feet, active reservoir capacity _____ acre feet; total reservoir
capacity _____ acre feet, materials used in storage dam: _____
Period of year during which storage will occur _____ to _____ inclusive.
(Mo. Day) (Mo. Day)
c. Proposed well diameter is _____ inches; proposed depth of well is _____ feet.
7. a. Time required for the completion of the works and application of the water to the proposed beneficial use
is 5 years.
b. Estimated construction cost is \$ 15,000.
8. Description of proposed uses:
a. If water is not for irrigation:
(1) Give the place of use of water: SW $\frac{1}{4}$ of SE $\frac{1}{4}$ of Section 12 Township 9 S.
Range 16 E. B.M.
(2) Amount of power to be generated: _____ hp under _____ feet of head.
(3) List number of each kind of livestock to be watered 350 head in winter and 600
head in summer on total ranch.
(4) Name of municipality to be served _____, or number of families to be
supplied with domestic water _____
(5) If water is to be used for other purposes describe: Amount not used for irrigation
and stockwater will be purified and used in spawner ponds for
trout operation.

47-7162

b. If water is for irrigation, indicate acreage in each subdivision in the tabulation below:

TWP.	RANGE	SEC.	NE1/4				NW1/4				SW1/4				SE1/4				TOTALS
			NE1/4	NW1/4	SW1/4	SE1/4	NE1/4	NW1/4	SW1/4	SE1/4	NE1/4	NW1/4	SW1/4	SE1/4	NE1/4	NW1/4	SW1/4	SE1/4	
9S	15EBM	12														6	40	33	79
9S	16EBM	7										9							9
9S	16EBM	18	22																22

Total number of acres to be irrigated 110

c. Describe any other water rights used for the same purposes as described above. None

9. a. Who owns the property at the point of diversion Applicant
- b. Who owns the land to be irrigated or place of use Applicant
- c. If the property is owned by a person other than the applicant, describe the arrangement enabling the applicant to make this filing Purchasing on contract of sale.

10. Remarks

1. Map of proposed project:

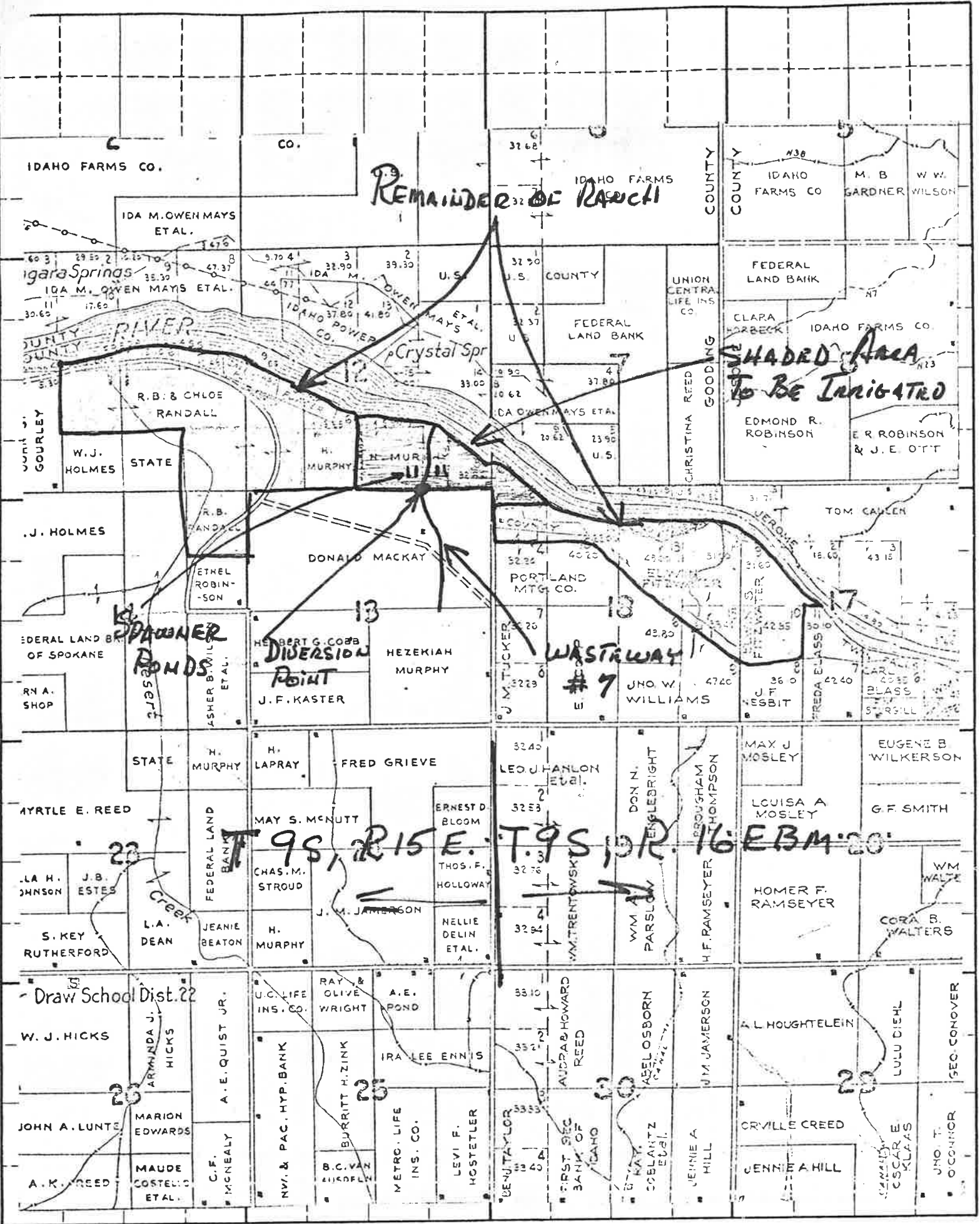

Scale: 2 inches equal 1 mile

BE IT KNOWN that the undersigned hereby makes application for permit to appropriate the public waters of the State of Idaho as herein set forth.

CRYSTAL SPRINGS RANCH, INC.

By: L Roy Bylund
(Applicant) L Roy Bylund, Vice President

Received by alw Date 11-9-72 Time 2:40 pm.

Preliminary check by RA Fee \$ 115.00 # 9468

Receipted by alw Date 11-9-72

RA Publication prepared by alw Date 11-10-72

Published in Times News, Twin Falls, ID

Publication dates 11-16 & 11-23-72

Publication approved alw Date 11-27-72

Priority reduced to 11-9-72 Reason _____

Protests filed by: _____

Copies of protests forwarded by _____

Hearing held by _____ Date _____

Recommended for approval denial by D 3DF

ACTION OF THE DIRECTOR, DEPARTMENT OF WATER ADMINISTRATION

This is to certify that I have examined Application for Permit to appropriate the public waters of the State of Idaho No. 47-7162, and said application is hereby APPROVED.

1. Approval of said application is subject to the following limitations and conditions:

a. SUBJECT TO ALL PRIOR WATER RIGHTS.

b. Proof of construction of works and application of water to beneficial use shall be submitted on or before December 1, 19 77.

c. Other: A measuring device of a type approved by this Department shall be permanently installed and maintained as part of the diverting works.

The permit shall not be assigned or sold without first securing the written approval of the Department of Water Administration.

2. Denial of said application is for the following reasons: _____

Witness my hand this 12th day of December 1972.

R. Karl Higin
Director

January 5, 1973

Re: 47-7162

Crystal Springs Ranch, Inc.
P. O. Box 109
Buhl, Idaho 83316

Gentlemen:

Enclosed is a copy of your approved Application for Permit No. 47-7162. We direct your attention to the conditions of approval as listed on the fourth page.

Be sure to note that a special condition requiring you to install and maintain a measuring device at your point of diversion has been placed upon your permit. We are enclosing a letter describing different types of measuring devices accepted by this office.

Very truly yours,

BOBBY D. FLEENOR
Assistant Director

BDF: cd

Enclosure