

IDAHO DEPARTMENT OF WATER RESOURCES
Proof Report

6/17/2020

Water Permit 47-7416

<u>Owner Type</u>	<u>Name and Address</u>
Current Owner	KAREN A WRIGHT , ZZ
Current Owner	BOB WRIGHT 23981 STONE LN CALDWELL, ID 83607 (208) 250-7081

Status: Lapsed

Source

Tributary

<u>Beneficial Use</u>	<u>From</u>	<u>To</u>	<u>Diversion Rate</u>	<u>Volume</u>
-----------------------	-------------	-----------	-----------------------	---------------

Source and Point(s) of Diversion

Place Of Use

Conditions of Approval:

Comments:

Dates and Other Information

Water District Number: TBD
Mitigation Plan: False

Combined Use Limits

N/A

SubCase:

N/A

Water Supply Bank:

N/A

[REDACTED]

RECEIVED

DEC 19 1977

Department of Water Resources
Southern District Office

Identification No. _____
Application No. 47-7416

STATE OF IDAHO
DEPARTMENT OF WATER RESOURCES

APPLICATION FOR PERMIT **APPROVED**

To appropriate the Public Waters of the State of Idaho
(TYPE OR PRINT IN INK)

1. Name of applicant Bob &/or Karen A. Wright Phone: 423-5011
post office address Rte. 1, Hansen, Idaho 83334
2. Source of water supply waste water which is a tributary of unnamed lateral
3. a. Location of point of diversion is SE $\frac{1}{4}$ of SE $\frac{1}{4}$ of Section 22 Township 10S
Range 18E B.M. Twin Falls County; additional points of diversion if any: _____
- b. If water is not consumed, it will be discharged into unnamed lateral at a point in NE $\frac{1}{4}$
of SE $\frac{1}{4}$ of Section 22 Township 10S Range 18E B.M. _____
4. Water will be used for the following purposes:
Amount 0.40 cfs for irrigation purpose from Mar 15 to Nov 15 (both dates inclusive)
(cfs or acre-feet per annum)
Amount _____ for _____ purpose from _____ to _____ (both dates inclusive)
(cfs or acre-feet per annum)
Amount _____ for _____ purpose from _____ to _____ (both dates inclusive)
(cfs or acre-feet per annum)
5. Total quantity to be appropriated:
a. 0.40 cubic feet per second and/or
b. _____ acre feet per annum.
6. Proposed diverting works:
a. Description of ditches, flumes, pumps, headgates, etc. Settling ponds, concrete ditches

b. Height of storage dam _____ feet, active reservoir capacity _____ acre feet; total reservoir
capacity _____ acre feet, materials used in storage dam: _____
Period of year during which storage will occur _____ to _____ inclusive
(Mo., Day) (Mo., Day)
c. Proposed well diameter is _____ inches; proposed depth of well is _____ feet.
7. a. Time required for the completion of the works and application of the water to the proposed beneficial use
is 5 years.
b. Estimated construction cost is \$ 2,000.
8. Description of proposed uses:
a. If water is **not** for irrigation:
(1) Give the place of use of water: _____ $\frac{1}{4}$ of _____ $\frac{1}{4}$ of Section _____ Township
Range _____ B.M. _____
(2) Amount of power to be generated. _____ hp under _____ feet of head
(3) List number of each kind of livestock to be watered _____

(4) Name of municipality to be served _____, or number of families to be
supplied with domestic water _____
(5) If water is to be used for other purposes describe: _____

47-7416

b. If water is for irrigation, indicate acreage in each subdivision in the tabulation below:

TWP.	RANGE	SEC.	NE $\frac{1}{4}$				NW $\frac{1}{4}$				SW $\frac{1}{4}$				SE $\frac{1}{4}$				TOTALS
			NE $\frac{1}{4}$	NW $\frac{1}{4}$	SW $\frac{1}{4}$	SE $\frac{1}{4}$	NE $\frac{1}{4}$	NW $\frac{1}{4}$	SW $\frac{1}{4}$	SE $\frac{1}{4}$	NE $\frac{1}{4}$	NW $\frac{1}{4}$	SW $\frac{1}{4}$	SE $\frac{1}{4}$	NE $\frac{1}{4}$	NW $\frac{1}{4}$	SW $\frac{1}{4}$	SE $\frac{1}{4}$	
10S	18E	22													10			10	20

Total number of acres to be irrigated 20

c. Describe any other water rights used for the same purposes as described above. 60 shares Twin Falls Canal Co. water

9. a. Who owns the property at the point of diversion applicants

b. Who owns the land to be irrigated or place of use applicants

c. If the property is owned by a person other than the applicant, describe the arrangement enabling the applicant to make this filing _____

10. Remarks waste water originates mainly on applicants' property

11. Map of proposed project; show clearly the proposed point of diversion, place of use, section number, township and range number.

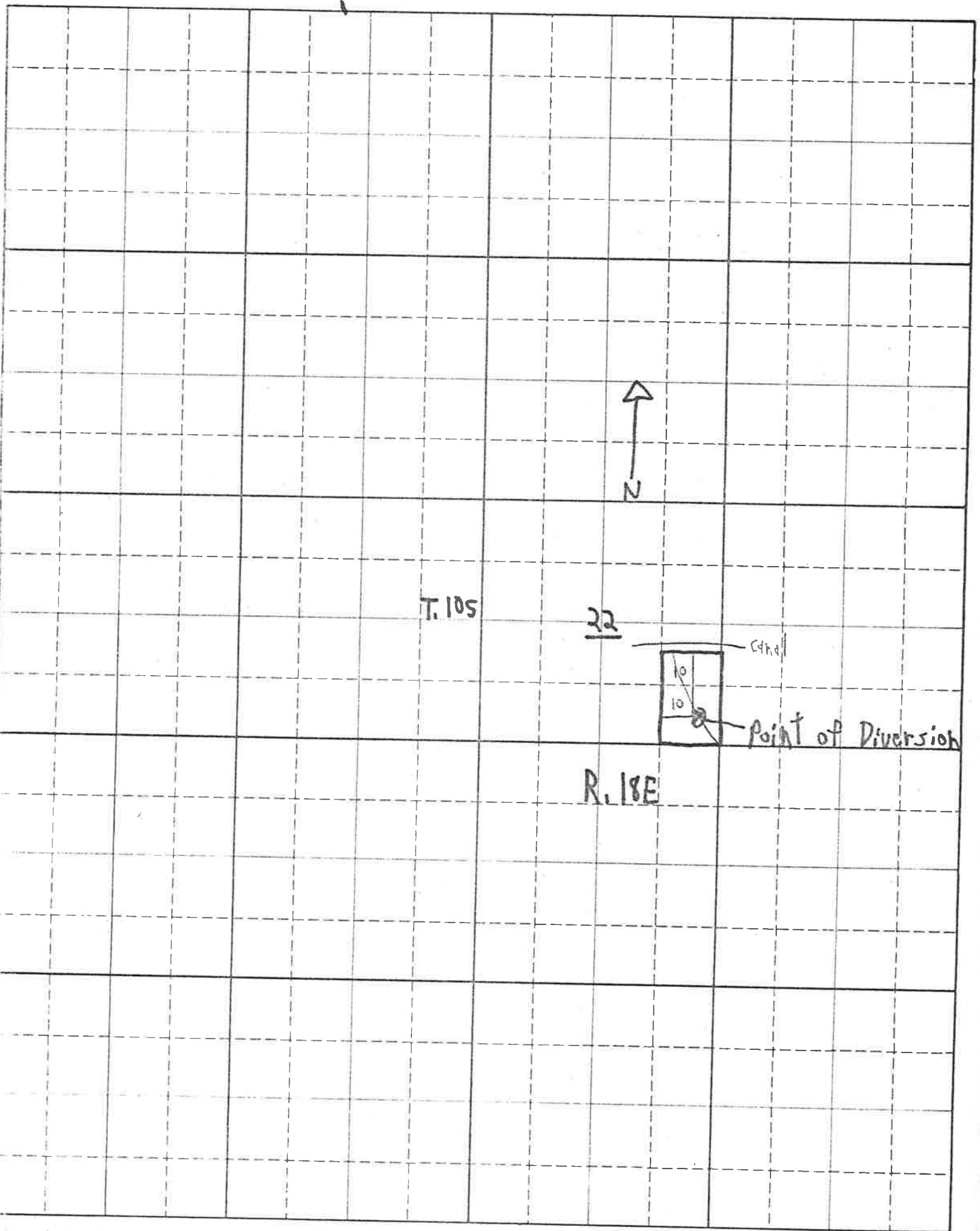

Scale: 2 inches equal 1 mile

BE IT KNOWN that the undersigned hereby makes application for permit to appropriate the public waters of the State of Idaho as herein set forth.

Bob Wright.
(Applicant)

6-23-1977

Received by JL Date 6-23-77 Time 2pm
Preliminary check by AS Fee \$ 25.00
Receipted by JL Date 6-24-77 \$ 86.09
Publication prepared by Am Date 6/30/77
Published in Times News
Publication dates 7/14 & 7/21/77
Publication approved AD Date 8/16/77
Priority reduced to _____ Reason _____

Protests filed by: _____
Copies of protests forwarded by _____
Hearing held by _____ Date _____
Recommended for approval denial by mls jp

ACTION OF THE DIRECTOR, DEPARTMENT OF WATER RESOURCES

This is to certify that I have examined Application for Permit to appropriate the public waters of the State of Idaho No. 47-7416, and said application is hereby APPROVED.

1. Approval of said application is subject to the following limitations and conditions:

- a. SUBJECT TO ALL PRIOR WATER RIGHTS.
- b. Proof of construction of works and application of water to beneficial use shall be submitted on or before December 1, 19 82.
- c. Other: For licensing purposes a scientific measurement of the diversion rate of the system as it is normally operated shall be provided by either properly installing an approved type of measuring device or by having a professional engineer certify the rate of diversion to the Department prior to submitting proof of beneficial use of water.

2. The rate of diversion of water for irrigation under this permit and all other water rights on the same land shall not exceed 0.02 cubic feet per second for each acre of land.

Witness my hand this 14 day of December 19 77.

[Signature]
Deputy Director