

IDAHO DEPARTMENT OF WATER RESOURCES
Proof Report

6/17/2020

Water Permit 47-7441

| <u>Owner Type</u> | <u>Name and Address</u> |
|-------------------|-------------------------|
| Current Owner | C L KENITZER , ZZ |

Status: Relinquished

| <u>Source</u> | <u>Tributary</u> |
|---------------|------------------|
|---------------|------------------|

| <u>Beneficial Use</u> | <u>From</u> | <u>To</u> | <u>Diversion Rate</u> | <u>Volume</u> |
|-----------------------|-------------|-----------|-----------------------|---------------|
|-----------------------|-------------|-----------|-----------------------|---------------|

Source and Point(s) of Diversion

Place Of Use

Conditions of Approval:

Comments:

Dates and Other Information

Water District Number: TBD
Mitigation Plan: False

Combined Use Limits

N/A

SubCase:

N/A

Water Supply Bank:

N/A

RECEIVED

DEC 27 1977

Department of Water Resources
Southern District Office

RELINQUISHMENT

TO WHOM IT MAY CONCERN:

I hereby relinquish to the State of Idaho,
all my right, title and interest in and to (Application for Permit)
(~~Permit~~) to Appropriate the Public Waters of the State of Idaho,
No. 47-7441.

Signed at Hayden
this 5th day of December, 19 77.

C. L. Rensinger
Applicant/Permit Holder

ATTEST:

John B. Amey

Identification No. _____

Application No. 47-7441

STATE OF IDAHO
DEPARTMENT OF WATER RESOURCES

APPLICATION FOR PERMIT

To Appropriate the Public Waters of the State of Idaho
(TYPE OR PRINT IN INK)

1. Name of applicant C. L. Kenitzer Phone: 837-4963
post office address Rte. 1, Hagerman, Idaho 83332
2. Source of water supply SNAKE RIVER which is a tributary of Columbia River
3. a. Location of point of diversion is Lot 11 $\frac{1}{4}$ of _____ $\frac{1}{4}$ of Section 1 Township 8S
Range 13E B.M. Gooding County; additional points of diversion if any: _____

- b. If water is not consumed, it will be discharged into _____ at a point in _____ $\frac{1}{4}$
of _____ $\frac{1}{4}$ of Section _____ Township _____ Range _____ B.M. _____
4. Water will be used for the following purposes:
Amount .02cfs for irrigation purpose from Mar 15 to Nov 15 (both dates inclusive)
(cfs or acre-feet per annum)
Amount _____ for _____ purpose from _____ to _____ (both dates inclusive)
(cfs or acre-feet per annum)
Amount _____ for _____ purpose from _____ to _____ (both dates inclusive)
(cfs or acre-feet per annum)
5. Total quantity to be appropriated:
a. .02 cubic feet per second and/or
b. _____ acre feet per annum.
6. Proposed diverting works:
a. Description of ditches, flumes, pumps, headgates, etc. portable pump, sprinklers

- b. Height of storage dam _____ feet, active reservoir capacity _____ acre feet; total reservoir
capacity _____ acre feet, materials used in storage dam: _____
Period of year during which storage will occur _____ to _____ inclusive.
(Mo. Day) (Mo. Day)
- c. Proposed well diameter is _____ inches; proposed depth of well is _____ feet.
7. a. Time required for the completion of the works and application of the water to the proposed beneficial use
is 3 years.
b. Estimated construction cost is \$ 300.
8. Description of proposed uses:
a. If water is **not** for irrigation:
(1) Give the place of use of water: _____ $\frac{1}{4}$ of _____ $\frac{1}{4}$ of Section _____ Township _____
Range _____ B.M. _____
(2) Amount of power to be generated: _____ hp under _____ feet of head.
(3) List number of each kind of livestock to be watered _____

(4) Name of municipality to be served _____, or number of families to be
supplied with domestic water _____
(5) If water is to be used for other purposes describe: _____

47-7441

b. If water is for irrigation, indicate acreage in each subdivision in the tabulation below:

| TWP | RANGE | SEC. | NE1/4 | | | | NW1/4 | | | | SW1/4 | | | | SE1/4 | | | | TOTALS |
|-----|-------|------|-------|-------|-------|-------|-------|-------|-------|-------|-------|-------|-------|-------|--------------|-------|-------|-------|--------|
| | | | NE1/4 | NW1/4 | SW1/4 | SE1/4 | NE1/4 | NW1/4 | SW1/4 | SE1/4 | NE1/4 | NW1/4 | SW1/4 | SE1/4 | NE1/4 | NW1/4 | SW1/4 | SE1/4 | |
| 8S | 13E | 1 | | | | | | | | | | | | | Lt. 11 .5 | | | | .5 |
| | | | | | | | | | | | | | | | | | | | |
| | | | | | | | | | | | | | | | | | | | |
| | | | | | | | | | | | | | | | | | | | |
| | | | | | | | | | | | | | | | | | | | |
| | | | | | | | | | | | | | | | | | | | |
| | | | | | | | | | | | | | | | | | | | |
| | | | | | | | | | | | | | | | | | | | |
| | | | | | | | | | | | | | | | | | | | |
| | | | | | | | | | | | | | | | | | | | |

Total number of acres to be irrigated .5

c. Describe any other water rights used for the same purposes as described above. Riley Creek decreed water

9. a. Who owns the property at the point of diversion applicant

b. Who owns the land to be irrigated or place of use applicant

c. If the property is owned by a person other than the applicant, describe the arrangement enabling the applicant to make this filing _____

10. Remarks Applicant will use this water instead of decreed water. When area was subdivided, system for transporting decreed water was removed. Use of Snake R. water is less expensive than building quarter-mile pipeline to transport decreed water.

11. Map of proposed project: show clearly the proposed point of diversion, place of use, section number, township and range number.

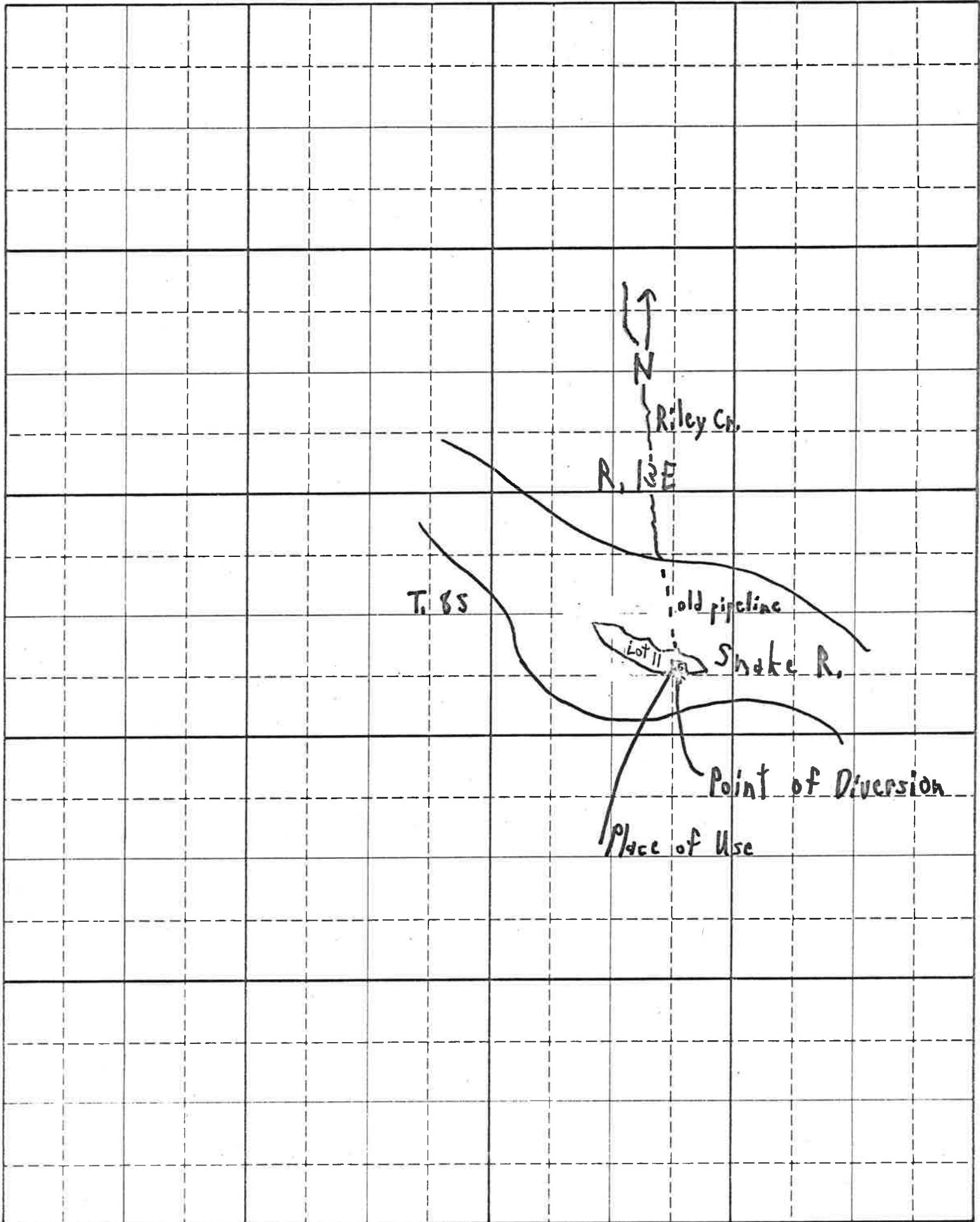

Scale: 2 inches equal 1 mile

BE IT KNOWN that the undersigned hereby makes application for permit to appropriate the public waters of the State of Idaho as herein set forth.

C. L. Kenitzer
(Applicant)

Received by QA Date 10-20-77 Time 2 pm
Preliminary check by A.S. Fee \$ 10.00 # 7404
Receipted by DF Date 10/20/77
Publication prepared by DF Date 10/21/77
Published in Leading Country Leader
Publication dates 10/27 + 11/3/77
Publication approved _____ Date _____
Priority reduced to _____ Reason _____

Protests filed by: _____

Copies of protests forwarded by _____
Hearing held by _____ Date _____
Recommended for approval denial by mls

ACTION OF THE DIRECTOR, DEPARTMENT OF WATER RESOURCES

This is to certify that I have examined Application for Permit to appropriate the public waters of the State of Idaho No. _____, and said application is hereby _____.

1. Approval of said application is subject to the following limitations and conditions:

- a. SUBJECT TO ALL PRIOR WATER RIGHTS.
- b. Proof of construction of works and application of water to beneficial use shall be submitted on or before _____, 19____.
- c. Other: _____

2. Denial of said application is for the following reasons: _____

Witness my hand this _____ day of _____ 19____.

Director