

IDAHO DEPARTMENT OF WATER RESOURCES  
Proof Report

6/17/2020

Water Permit 47-7442

<u>Owner Type</u>	<u>Name and Address</u>
Current Owner	DONALD R HICKS 1967 E 4300 N RT 4 BUHL, ID 83316 (208) 543-5081

Status: Lapsed

Source

Tributary

Beneficial Use

From

To

Diversion Rate

Volume

Source and Point(s) of Diversion

Place Of Use

Conditions of Approval:

Comments:

Dates and Other Information

Water District Number: TBD

Mitigation Plan: False

Combined Use Limits

N/A

SubCase:

N/A

Water Supply Bank:

N/A

RECEIVED

FEB 2 1976

Department of Water Resources  
Southern District Office

STATE OF IDAHO  
DEPARTMENT OF WATER RESOURCES

APPLICATION FOR PERMIT

APPROVED

To Appropriate the Public Waters of the State of Idaho  
(TYPE OR PRINT IN INK)

Identification No. \_\_\_\_\_

Application No. 47-7442

1. Name of applicant Donald R. Hicks Phone: 543-5081  
post office address Route 4, Buhl, Idaho 83316
2. Source of water supply unnamed coulee which is a tributary of Cedar Draw
3. a. Location of point of diversion is SW  $\frac{1}{4}$  of NE  $\frac{1}{4}$  of Section 26 Township 9S  
Range 15E B.M. Twin Falls County; additional points of diversion if any: NW  $\frac{1}{4}$  NE  $\frac{1}{4}$ , Sec. 26, Twp. 9S, Rge. 15E B. M.
- b. If water is not consumed, it will be discharged into unnamed coulee at a point in NW  $\frac{1}{4}$  of NE  $\frac{1}{4}$  of Section 26 Township 9S Range 15E B.M. Twin Falls
4. Water will be used for the following purposes:  
Amount 0.24 cfs for irrigation purpose from Mar. 15 to Nov. 15 (both dates inclusive)  
(cfs or acre-feet per annum)  
Amount \_\_\_\_\_ for \_\_\_\_\_ purpose from \_\_\_\_\_ to \_\_\_\_\_ (both dates inclusive)  
(cfs or acre-feet per annum)  
Amount \_\_\_\_\_ for \_\_\_\_\_ purpose from \_\_\_\_\_ to \_\_\_\_\_ (both dates inclusive)  
(cfs or acre-feet per annum)
5. Total quantity to be appropriated:  
a. 0.24 cubic feet per second and/or  
b. \_\_\_\_\_ acre feet per annum.
6. Proposed diverting works:  
a. Description of ditches, flumes, pumps, headgates, etc. Diversion by existing headgates  
into existing gravity flow ditches
- b. Height of storage dam \_\_\_\_\_ feet, active reservoir capacity \_\_\_\_\_ acre feet; total reservoir capacity \_\_\_\_\_ acre feet, materials used in storage dam: \_\_\_\_\_  
Period of year during which storage will occur \_\_\_\_\_ to \_\_\_\_\_ inclusive.  
(Mo. Day) (Mo. Day)
- c. Proposed well diameter is \_\_\_\_\_ inches; proposed depth of well is \_\_\_\_\_ feet.
7. a. Time required for the completion of the works and application of the water to the proposed beneficial use is 5 years.  
b. Estimated construction cost is \$ 0.00
8. Description of proposed uses:  
a. If water is **not** for irrigation:  
(1) Give the place of use of water: \_\_\_\_\_  $\frac{1}{4}$  of \_\_\_\_\_  $\frac{1}{4}$  of Section \_\_\_\_\_ Township \_\_\_\_\_ Range \_\_\_\_\_ B.M. \_\_\_\_\_  
(2) Amount of power to be generated: \_\_\_\_\_ hp. under \_\_\_\_\_ feet of head.  
(3) List number of each kind of livestock to be watered: \_\_\_\_\_  
(4) Name of municipality to be served \_\_\_\_\_, or number of families to be supplied with domestic water: \_\_\_\_\_  
(5) If water is to be used for other purposes describe: \_\_\_\_\_

b. If water is for irrigation, indicate acreage in each subdivision in the tabulation below:

TWP	RANGE	SEC	NE 1/4				NW 1/4				SW 1/4				SE 1/4				TOTALS
			NE 1/4	NW 1/4	SW 1/4	SE 1/4	NE 1/4	NW 1/4	SW 1/4	SE 1/4	NE 1/4	NW 1/4	SW 1/4	SE 1/4	NE 1/4	NW 1/4	SW 1/4	SE 1/4	
9S	15E	26	32																32

Total number of acres to be irrigated 32

c. Describe any other water rights used for the same purposes as described above.

Portion of License 47-2146

9. a. Who owns the property at the point of diversion applicant & E. B. Hicks, brother of applicant

b. Who owns the land to be irrigated or place of use applicant

c. If the property is owned by a person other than the applicant, describe the arrangement enabling the applicant to make this filing applicant has existing ditch rights thru brothers land

10. Remarks 32 acres x 0.02 cfs/acre = 0.64 cfs max.

Existing portion of 47-2146 = 32 x  $\frac{6}{48}$  = 0.40

Allowable filing equals 0.64 - 0.40 = 0.24 cfs

10/20/77  
CIVIL SERVICE

Received by ADM Date 10/20/77 Time 2:30  
Preliminary check by GM Fee \$ 25.00 # 7406  
Received by Am Date 11/29/77  
Publication prepared by Rj Date 10/21/77  
Published in Times News  
Publication dates 10/27 + 11/3/77  
Publication approved Am Date 11/14/77  
Priority reduced to \_\_\_\_\_ Reason \_\_\_\_\_  
\_\_\_\_\_  
\_\_\_\_\_  
\_\_\_\_\_  
Protests filed by: \_\_\_\_\_  
\_\_\_\_\_  
\_\_\_\_\_  
Copies of protests forwarded by \_\_\_\_\_  
Hearing held by \_\_\_\_\_ Date \_\_\_\_\_  
Recommended for approval denial by ms WTH

#### ACTION OF THE DIRECTOR, DEPARTMENT OF WATER RESOURCES

This is to certify that I have examined Application for Permit to appropriate the public waters of the State of Idaho No. 47-7442, and said application is hereby APPROVED.

1. Approval of said application is subject to the following limitations and conditions:

- a. SUBJECT TO ALL PRIOR WATER RIGHTS.
- b. Proof of construction of works and application of water to beneficial use shall be submitted on or before January 1, 1983.
- c. Other: The issuance of this permit in no way grants any right-of-way or easement across the land of another.

2. Denial of said application is for the following reasons: \_\_\_\_\_  
\_\_\_\_\_  
\_\_\_\_\_  
\_\_\_\_\_  
\_\_\_\_\_

Witness my hand this 29 day of January 1978.

  
DEPUTY Director

11. Map of proposed project: show clearly the proposed point of diversion, place of use, section number, township and range number.

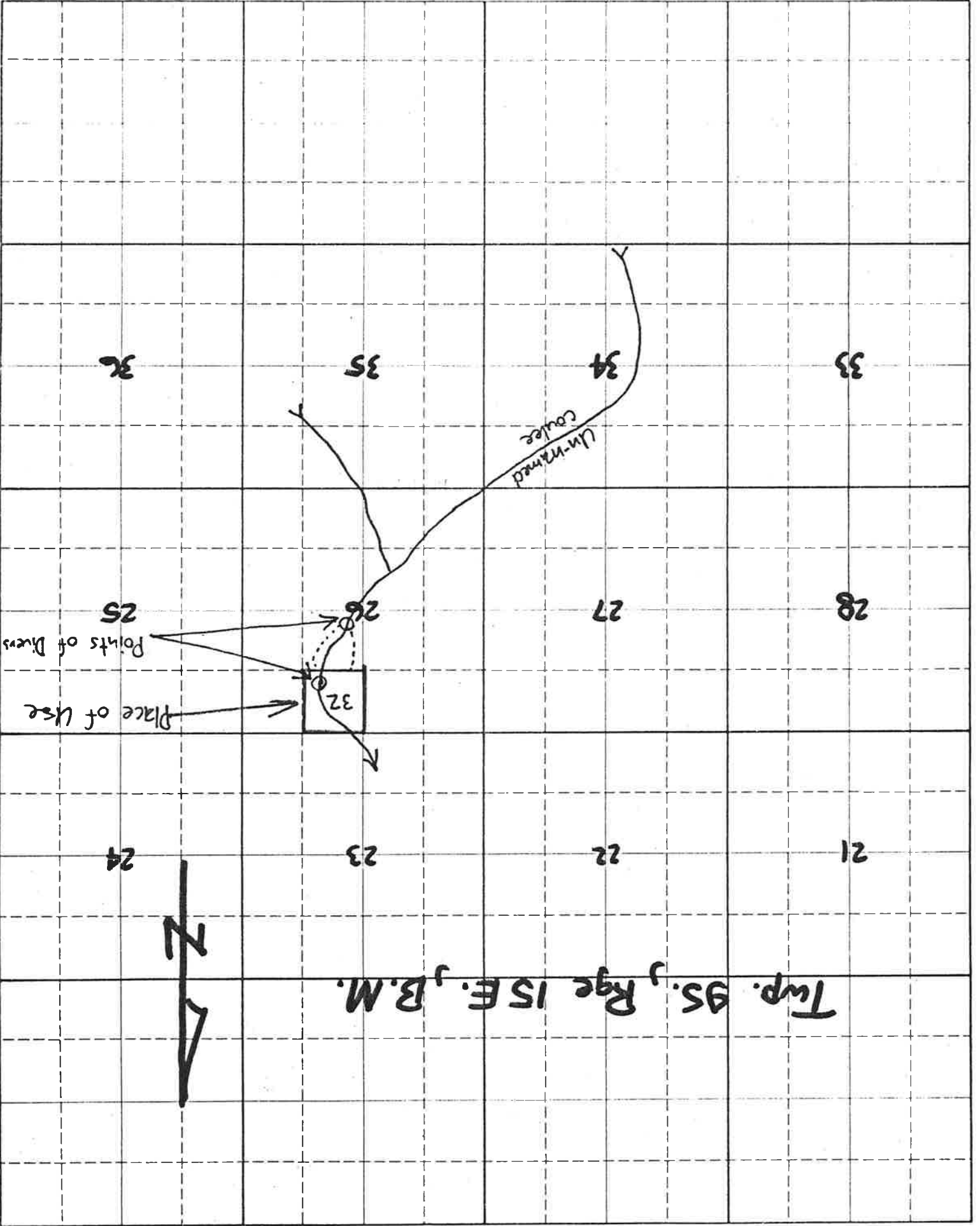

Scale 2 inches equal 1 mile

BE IT KNOWN that the undersigned hereby makes application for permit to appropriate the public waters of the State of Idaho as herein set forth.

*Donald R. Nick*  
(Applicant)