

IDAHO DEPARTMENT OF WATER RESOURCES
Proof Report

6/22/2020

Water Permit 47-7630

<u>Owner Type</u>	<u>Name and Address</u>
Current Owner	C B CANNON , ZZ

Status: Relinquished

<u>Source</u>	<u>Tributary</u>
---------------	------------------

<u>Beneficial Use</u>	<u>From</u>	<u>To</u>	<u>Diversion Rate</u>	<u>Volume</u>
-----------------------	-------------	-----------	-----------------------	---------------

Source and Point(s) of Diversion

Place Of Use

Conditions of Approval:

Comments:

Dates and Other Information

Water District Number: TBD
Mitigation Plan: False

Combined Use Limits

N/A

SubCase:

N/A

Water Supply Bank:

N/A



State of Idaho

DEPARTMENT OF WATER RESOURCES

1301 North Orchard Street, Statehouse Mail, Boise, Idaho 83720-9000

Phone: (208) 327-7900 FAX: (208) 327-7866

Date Sent to S.O. JUN 20 1991

CECIL D. ANDRUS
GOVERNOR

R. KEITH HIGGINSON
DIRECTOR

June 5, 1991

C. B. Cannon
920 Owyhee St.
Boise, ID 83705

138757
CERTIFIED MAIL
RECEIVED

RE: PROTESTED APPLICATION FOR PERMIT NO. 47-7630

JUN 07 1991

Dear Mr. Cannon:

The department of Water Resources (DWR) is currently reviewing protested applications for permit which are pending before the department. Our files show that the above referenced application was filed on February 25, 1980 proposing the diversion of 2.0 cubic feet per second (cfs) of water from an Unnamed Spring via Lateral 44 and 44A in Twin Falls County to be used year round for recreation and livestock purposes. The application was subsequently protested by The Twin Falls Canal Company.

Since substantial time has passed after the filing of the application, the department requests that you advise us of your continued interest in the protested application before we schedule a hearing in the matter. It appears that one of two potential actions needs to occur in connection with the application as follows:

1. If you are no longer interested in pursuing the development proposed in the application, please complete and return the enclosed relinquishment form. The application will then be removed from DWR records.
2. If you are interested in pursuing the proposed development you need to specifically advise the department in writing of your continued interest within thirty (30) days of the date of this letter. In addition, you must advise the department of potential hearing dates which are acceptable to you during the next several months.

If you do not timely respond to this letter, the department will reject the application as being filed for speculative purposes. If you do timely respond and provide the required information, the department will schedule a hearing if appropriate.

47-7630

Feel free to contact this office or our Southern Regional Office in Twin Falls if you have questions.

Sincerely,

A handwritten signature in cursive script, reading "L. Glen Saxton". The signature is written in dark ink and is positioned above the typed name.

L. GLEN SAXTON, Chief
Water Allocation Bureau

c: IDWR - S. Region
Twin Falls Canal Co.

Encl: 1

2/12/87

47-7630 (Amended)
C.B. Cannon

Source: Seepage tributary to Deep Creek

Amount & Use: 2.0 cfs for recreation
.02 cfs for stockwater

Analysis: This source is designated Lateral 44A by the Twin Falls Canal Co.

This waterway is a man-made conveyance used to deliver water to stockholders.

Proposed Condition:

The Department will not issue a permit without evidence that the applicant has obtained the permission of the Twin Falls Canal Company to use the ditch.

STATE OF IDAHO
DEPARTMENT OF WATER RESOURCES

Ident. No. 47-7630

Amended

AMENDED

APPLICATION FOR PERMIT

APR 27 1990

To appropriate the public waters of the State of Idaho

Department of Water Resources
Southern District Office

1. Name of applicant C. B. Cannon Phone 543-6318 or 342-8122

Post office address 920 Owyhee St., Boise, Idaho 83705

2. Source of water supply Seepage which is a tributary of Deep Creek

3. Location of point of diversion is SW $\frac{1}{4}$ of SW $\frac{1}{4}$ of Section 21 Township 9S

Range 14E B.M. Twin Falls County, additional points of diversion if any: _____

4. Water will be used for the following purposes:

Amount 2.0 cfs for recreation purposes from Jan 1 to Dec 31 (both dates inclusive)
(cfs or acre-feet per annum)

Amount 0.02 cfs for livestock purposes from Jan 1 to Dec 31 (both dates inclusive)
(cfs or acre-feet per annum)

Amount _____ for _____ purposes from _____ to _____ (both dates inclusive)
(cfs or acre-feet per annum)

Amount _____ for _____ purposes from _____ to _____ (both dates inclusive)
(cfs or acre-feet per annum)

5. Total quantity to be appropriated:

a. 2.0 cubic feet per second and/or b. _____ acre-feet per annum.

6. Proposed diverting works:

a. Description of ditches, flumes, pumps, headgates, etc. Check dam, headgate, ditch to pond,
ditch back into stream

b. Height of storage dam _____ feet, active reservoir capacity _____ acre-feet; total reservoir
capacity _____ acre-feet, materials used in storage dam: _____

Period of year when water will be diverted to storage _____ to _____ inclusive.
(Month/Day) (Month/Day)

c. Proposed well diameter is _____ inches; proposed depth of well is _____ feet.

7. Time required for the completion of the works and application of the water to the proposed beneficial
use is 5 years (minimum 1 year — maximum 5 years).

8. Description of proposed uses:

a. If water is not for irrigation:

(1) Give the place of use of water: SW $\frac{1}{4}$ of SW $\frac{1}{4}$ of Section 21 Township 9S

Range 14E B.M.

(2) Amount of power to be generated: _____ horsepower under _____ feet of head.

(3) List number of each kind of livestock to be watered _____

(4) Name of municipality to be served _____, or number of families to be
supplied with domestic water _____.

(5) If water is to be used for other purposes describe: small recreation pond

b. If water is for irrigation, indicate acreage in each subdivision in the tabulation below:

[illegible]

Total number of acres to be irrigated

c. Describe any other water rights used for the same purposes as described above.

9. a. Who owns the property at the point of diversion Applicant

b. Who owns the land to be irrigated or place of use "

c. If the property is owned by a person other than the applicant, describe the arrangement enabling the applicant to make this filing _____

10. Remarks Water spills into Twin Falls Canal Co. Lateral #44, which runs thru
applicant's land as Lateral #44A.

47-7360
Cannon

SEC 21
T9S R14E

Lat 44A

Mud (N Coulee)

M E L

V A

Eagle Bluff

Dam

Flume

Clear

Lat 44

DITCH

DITCH

30

3340

3364

3378

17

16

15

20

20

3532

29

3567

32

28

27

33

34

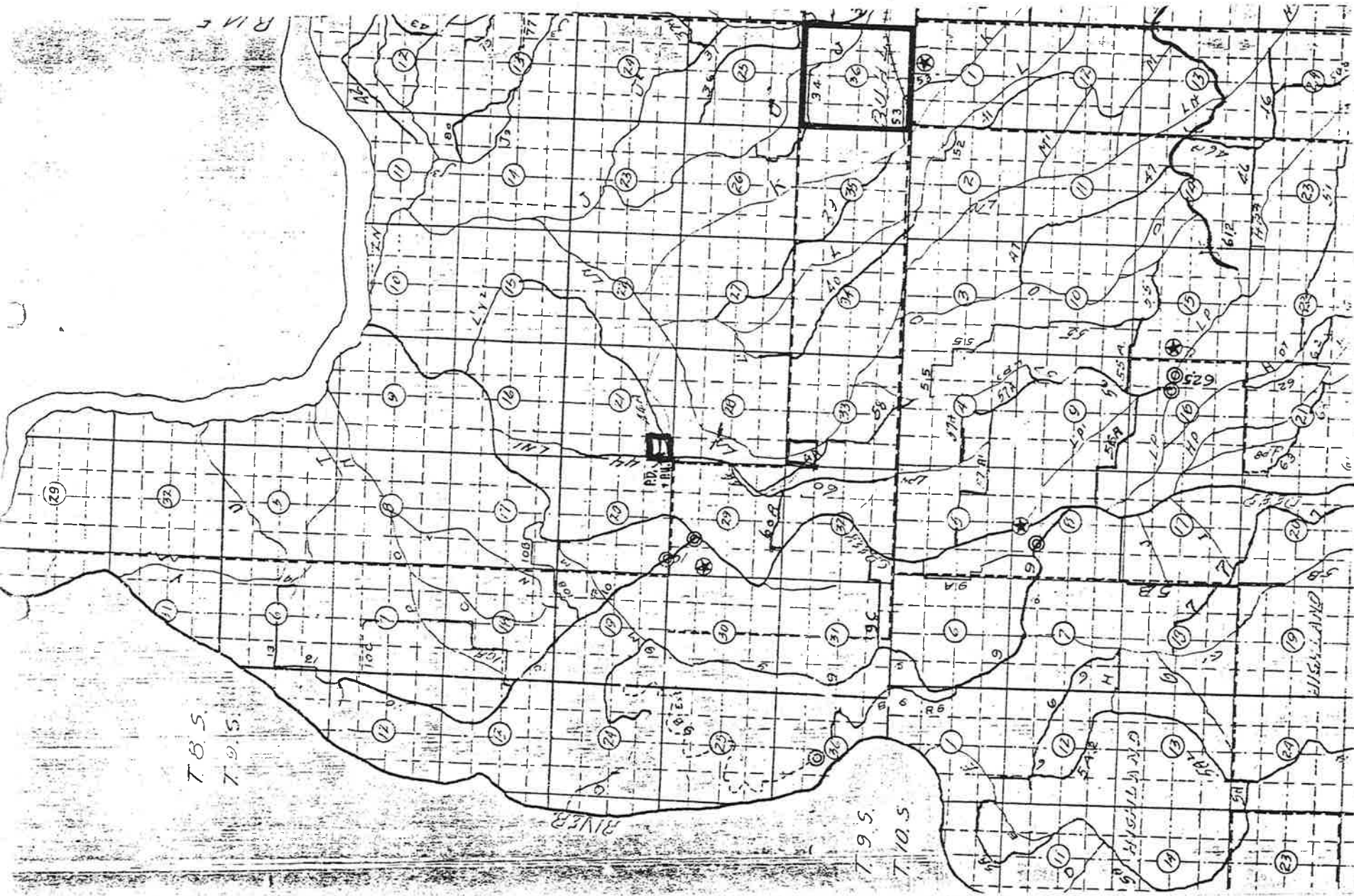

Received by JA Date 4-14-80 Time 10:15 am
Preliminary check by _____ Fee \$ 20⁰⁰ # 17195
Received by maya Date 4/14/80
Publication prepared by _____ Date _____
Published in _____
Publication dates _____
Publication approved _____ Date _____
Protests filed by: _____

Copies of protests forwarded by _____
Hearing held by _____ Date _____
Recommended for approval denial by _____

ACTION OF THE DIRECTOR, DEPARTMENT OF WATER RESOURCES

This is to certify that I have examined Application for Permit to appropriate the public waters of the State of Idaho No. _____, and said application is hereby _____.

1. Approval of said application is subject to the following limitations and conditions:

- a. SUBJECT TO ALL PRIOR WATER RIGHTS.
- b. Proof of construction of works and application of water to beneficial use shall be submitted on or before _____, 19 ____.
- c. The rate of diversion, if water is to be used for irrigation under this permit, when combined with all other water rights for the same land shall not exceed 0.02 cubic feet per second for each acre of land.
- d. Other: _____

Witness my hand this _____ day of _____, 19 ____.

Director