

STATE OF IDAHO
DEPARTMENT OF WATER RESOURCES
Southern Region

1041 Blue Lakes Blvd. N.
Twin Falls, Idaho 83301
(208) 734-3578

MAY ²³~~15~~ 1983

LANCE UDY
STAR RT.
MALTA

ID 83342

RE: Claim No. 43-4151

Dear Claimant:

The Department of Water Resources has completed the advertising of your claim to a water right, and no further action is authorized under Section 42-243 and 42-244, IDAHO CODE. Your claim will be retained in our files and will be available at any time for use by you or the court.

The filing and advertising of the claim does not confirm the water right claimed, but will serve to record and preserve the information and the evidence which you included in your claim.

If, at a later date, you find that you have additional information or supporting evidence that you would like to have included with the claim, you may have that information or evidence added at any time. Please refer to the claim identification number when corresponding with this office.

We are enclosing a copy of your claim for your records. If you have questions, or if this office may be of further assistance, please feel free to contact us.

Yours truly,



ALLEN D. MERRITT
Senior Water Resource Analyst

Enclosure

STATE OF IDAHO
DEPARTMENT OF WATER RESOURCES



CLAIM TO A WATER RIGHT

Under the provisions of Section 42-243, Idaho Code, any person using or claiming rights to the public waters of Idaho established by diversion and application to a beneficial use must file a claim with the Department of Water Resources on or before June 30, 1983. Exempted from this filing are single family domestic uses as defined in Section 42-230(d), Idaho Code. Also exempted are rights represented by a permit, license, decree, adjudicated right, or a previously filed claim.

The filing of this claim does not confirm the water right claimed but failure to file may result in forfeiture of a water right.

Notice is hereby given that Lance Udy
(Name of Claimant)
Star Route Malta, ID 83342
(Mailing Address) Telephone No. 645-2254
(Zip Code)

claims a right to the diversion and beneficial use of the surface or ground water. The extent and nature of said claim is as follows:

(1) Date of priority: (When was the water first applied to a beneficial use) 4/1/1954

A claim is not acceptable on a ground water source with a priority later than March 25, 1963 or on a surface water source with a priority later than May 20, 1971. An exception is that a claim may be filed on single family domestic use from a ground water source.

(2) Describe the source of water: (Name of stream, lake, spring, etc., or ground water)
Groundwater tributary to _____

(3) Describe the purpose for which the water has been used and the time during the year when you have used the right claimed:

						(Both dates inclusive)	
		(cfs, gpd, AFA)	(Domestic, Irrigation, Stock, Etc.)			(Mo., Day)	(Mo., Day)
Quantity	<u>1.44</u>	Use	<u>Irrigation</u>	Period of Use From	<u>3/15</u>	To	<u>11/15</u>
Quantity		Use		Period of Use From		To	
Quantity		Use		Period of Use From		To	
Quantity		Use		Period of Use From		To	
Quantity		Use		Period of Use From		To	

(4) 1.44 TOTAL QUANTITY USED.
(cfs, gpd, AFA)

(5) A) Point of diversion: (Location of point where water is diverted from its source)
SE ¼ NW ¼, Sec. 24 Twp. 15S Rge. 26E B.M., County of Cassia
Additional points of diversion: _____

B) Describe means of diversion of water: (Pump and pipeline, well, diversion dam, reservoir, length of ditch and field, etc.). Give sizes and capacities: be as specific as possible. Describe any changes in the system and give the date of the change. Well & Pump

(6) A) Describe location of use by listing number of irrigated acres within each 40-acre tract in appropriate box. If use is not for irrigation, place an "X" in appropriate box to show location.

T	R	SEC.	NE¼				NW¼				SW¼				SE¼				TOTAL
			NE¼	NW¼	SW¼	SE¼	NE¼	NW¼	SW¼	SE¼	NE¼	NW¼	SW¼	SE¼	NE¼	NW¼	SW¼	SE¼	
15S	26E	13	40		40	40								40	40	40	40	40	320
		24		40			40	40											120
15S	27E	18									37	(Tot 4)							37

No. of acres 477

B) If water is used for other than irrigation, fully describe that use, being as specific as possible: _____

NOTE: Include here the type and number of stock watered: _____

(7) If you are claiming water as a member of an organization, list name of organization: _____

43-4151

(8) Remarks Other rts are 43-2292 (Raft R.) & 43-2293 (GW).
Pump was upgraded to 2200 gpm with electric power & additional land irrigated in 1954

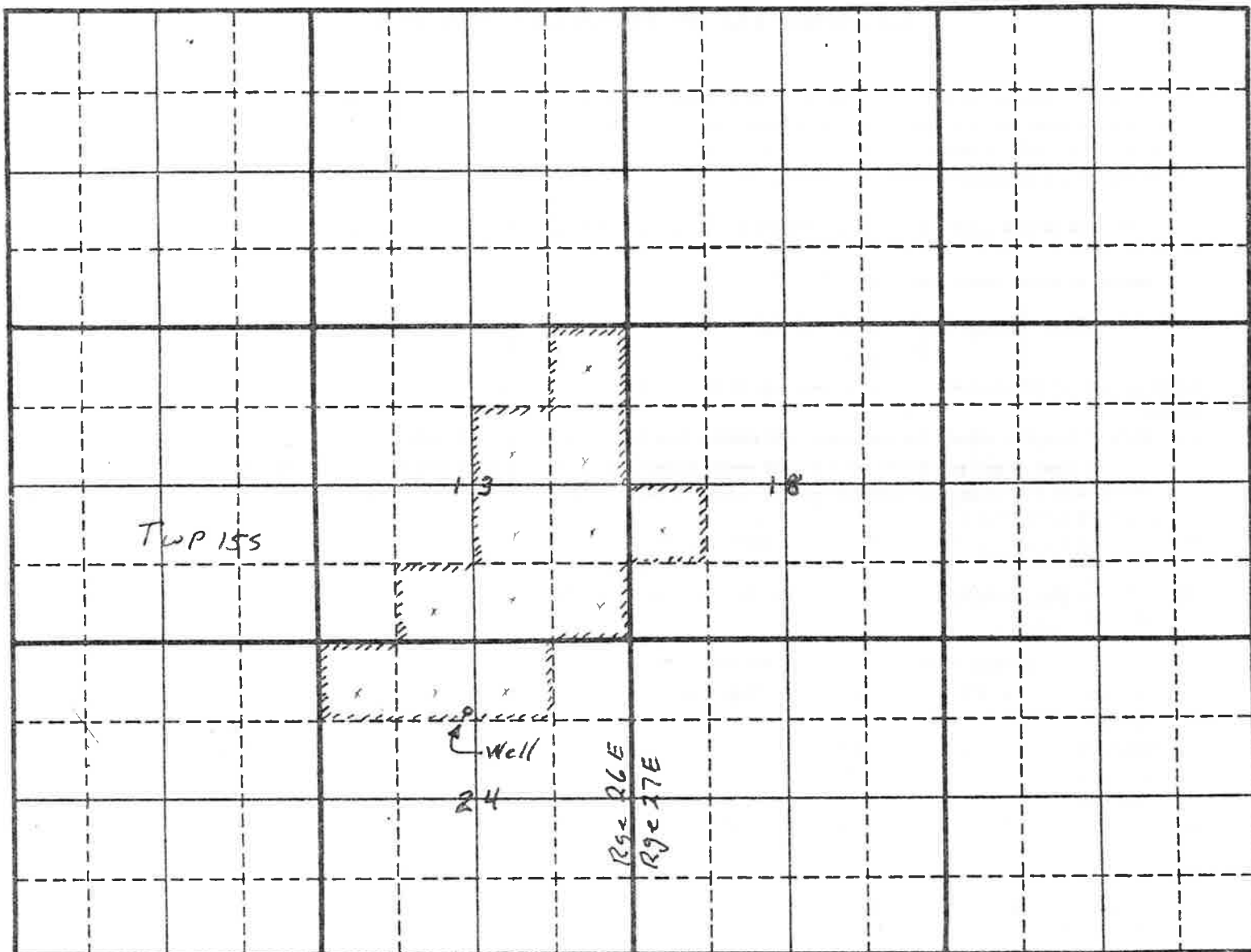

Scale: 2 inches equal 1 mile.

Map should show the location of the point of diversion and the place of use of the water by 40-acre subdivisions, section, township and range of the public land survey system.

State of Idaho)
County of Twin Falls) ss.

Be it known that the undersigned, being duly sworn, deposes and says that he, she, they subscribed the foregoing claim to a water right, together with all attached information, and that the matters and facts therein are true to the best of the affiant's knowledge.

Sworn to before me this 31 day of MARCH, 19 83.
Lance R. Rely
(Claimant)

Lance O. Halmer
Notary Public
Residing at Twin Falls, ID

My commission expires Life

FOR DEPARTMENT USE ONLY

Received by LH Date 3/31/83 Exception filed by: _____ Date _____
Prelim. check by BS Date _____
\$30.00 fee received by LH Date 3/31/83 # 26144
Published in Snake River Press _____
Dates 5/5 + 5/12/83 _____