

IDAHO DEPARTMENT OF WATER RESOURCES
Proof Report

6/25/2020

Water Permit 45-7503

<u>Owner Type</u>	<u>Name and Address</u>
Current Owner	MERIEL B PETERSON PO BOX 181 OAKLEY, ID 83346 (208) 862-3303

Status: Lapsed

Source

Tributary

<u>Beneficial Use</u>	<u>From</u>	<u>To</u>	<u>Diversion Rate</u>	<u>Volume</u>
-----------------------	-------------	-----------	-----------------------	---------------

Source and Point(s) of Diversion

Place Of Use

Conditions of Approval:

Comments:

Dates and Other Information

Water District Number: TBD
Mitigation Plan: False

Combined Use Limits

N/A

SubCase:

N/A

Water Supply Bank:

N/A

STATE OF IDAHO
DEPARTMENT OF WATER RESOURCES
APPLICATION FOR PERMIT

APPROVED

RECEIVED
OCT 25 1982
Department of Water Resources
Southern District Office

To appropriate the public waters of the State of Idaho

Name of applicant Meriel B. Peterson Phone 862-3303
Post office address Box 181, Oakley, ID 83346

2. Source of water supply Wastewater which is a tributary of High Line Canal from Bird Cr.
3. Location of point of diversion is SW $\frac{1}{4}$ of NW $\frac{1}{4}$ of Section 3 Township 14S
Range 22E B.M. Cassia County, additional points of diversion if any: _____

4. Water will be used for the following purposes:

Amount 1.38cfs for irrigation purposes from Apr 1 to Nov 1 (both dates inclusive)
(cfs or acre-feet per annum)
Amount _____ for _____ purposes from _____ to _____ (both dates inclusive)
(cfs or acre-feet per annum)
Amount _____ for _____ purposes from _____ to _____ (both dates inclusive)
(cfs or acre-feet per annum)
Amount _____ for _____ purposes from _____ to _____ (both dates inclusive)
(cfs or acre-feet per annum)

5. Total quantity to be appropriated:

a. 1.38 cubic feet per second and/or b. _____ acre-feet per annum.

6. Proposed diverting works:

a. Description of ditches, flumes, pumps, headgates, etc. Check dam & pipeline

b. Height of storage dam _____ feet, active reservoir capacity _____ acre-feet; total reservoir capacity _____ acre-feet, materials used in storage dam: _____
Period of year when water will be diverted to storage _____ to _____ inclusive.
(Month/Day) (Month/Day)

c. Proposed well diameter is _____ inches; proposed depth of well is _____ feet.

7. Time required for the completion of the works and application of the water to the proposed beneficial use is 5 years (minimum 1 year — maximum 5 years).

8. Description of proposed uses:

a. If water is **not** for irrigation:

(1) Give the place of use of water: _____ $\frac{1}{4}$ of _____ $\frac{1}{4}$ of Section _____ Township _____
Range _____ B.M.

(2) Amount of power to be generated: _____ horsepower under _____ feet of head.

(3) List number of each kind of livestock to be watered _____

(4) Name of municipality to be served _____, or number of families to be supplied with domestic water _____.

(5) If water is to be used for other purposes describe: _____

45-7503

b. If water is for irrigation, indicate acreage in each subdivision in the tabulation below:

TWP	RANGE	SEC.	NE $\frac{1}{4}$				NW $\frac{1}{4}$				SW $\frac{1}{4}$				SE $\frac{1}{4}$				TOTALS
			NE $\frac{1}{4}$	NW $\frac{1}{4}$	SW $\frac{1}{4}$	SE $\frac{1}{4}$	NE $\frac{1}{4}$	NW $\frac{1}{4}$	SW $\frac{1}{4}$	SE $\frac{1}{4}$	NE $\frac{1}{4}$	NW $\frac{1}{4}$	SW $\frac{1}{4}$	SE $\frac{1}{4}$	NE $\frac{1}{4}$	NW $\frac{1}{4}$	SW $\frac{1}{4}$	SE $\frac{1}{4}$	
14S	22E	4	7	10		30									22				69

Total number of acres to be irrigated 69

c. Describe any other water rights used for the same purposes as described above. _____

Birch Creek decreed rights & Oakley Canal Co. shares on 15 acres

9. a. Who owns the property at the point of diversion Henry Callahan

b. Who owns the land to be irrigated or place of use Applicant, Mrs. Mac Boren, Mrs. Gee

c. If the property is owned by a person other than the applicant, describe the arrangement enabling the applicant to make this filing verbal lease agreement on 7 acres; rest of the land is owned by applicant.

10. Remarks Due to a recent transfer of Birch Cr. water, this wastewater flows more than in previous years, & also carries considerable silt that is blocking the High Line Canal. Something has to be done to alleviate this problem, so I propose to put the water to beneficial use.

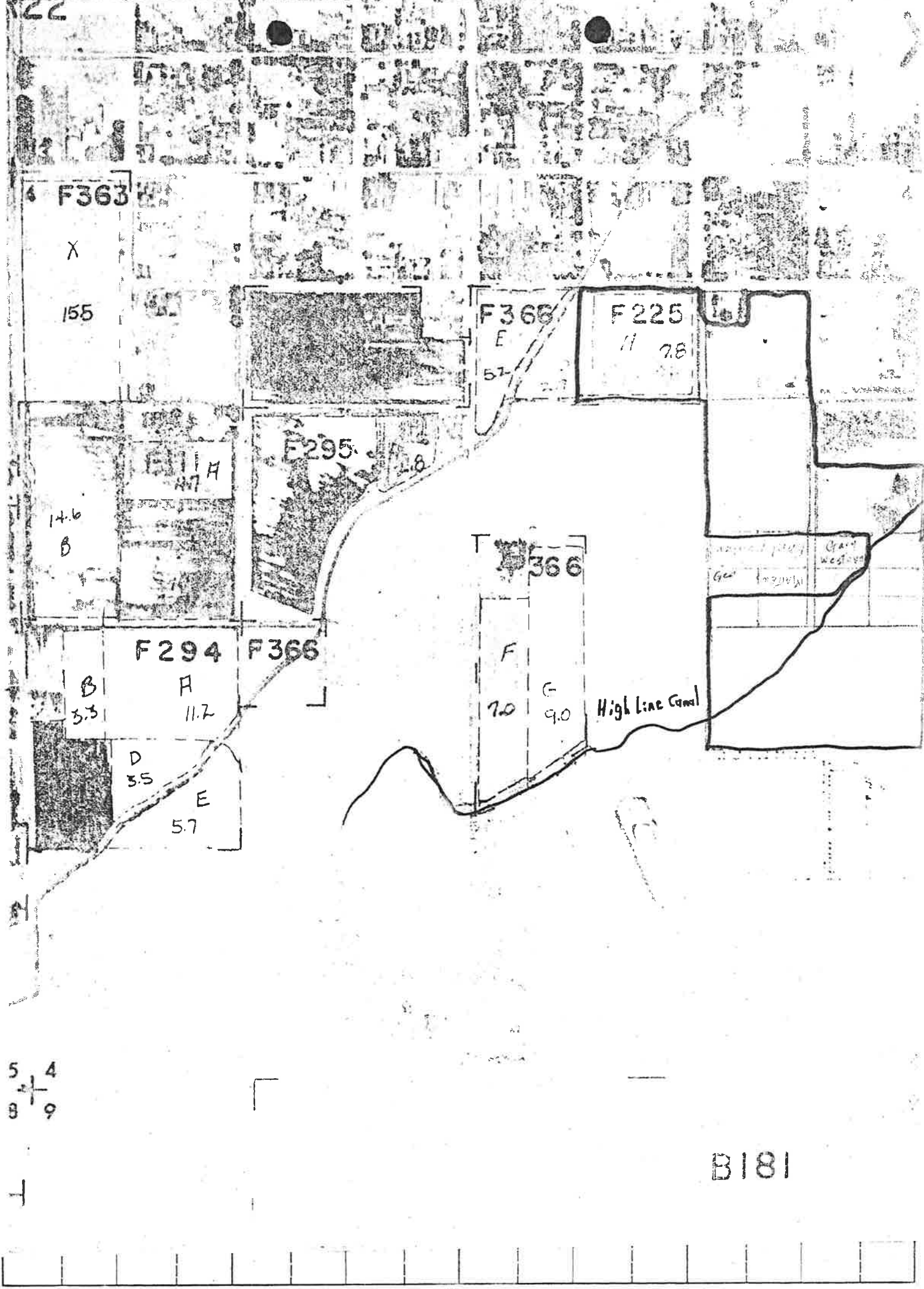

BE IT KNOWN that the undersigned hereby makes application for permit to appropriate the public waters of the State of Idaho as herein set forth.

Merrill L. Peterson
(Applicant)

Proposed Priority 6/1/1982

Received by JS Date 6-1-1982 Time 12:15 pm
Preliminary check by ADM Fee \$ 65.00
Receipted by JS Date 6-1-82 # 20803
Publication prepared by maria Date 7/15/82
Published in south ada press
Publication dates 6/24 + 7/1/82
Publication approved maria Date 7/28/82
Protests filed by: ronald archibald - royan luckley
withdrawn 9/27/82
Copies of protests forwarded by _____
Hearing held by _____ Date _____
Recommended for approval denial by ADM RC

ACTION OF THE DIRECTOR, DEPARTMENT OF WATER RESOURCES

This is to certify that I have examined Application for Permit to appropriate the public waters of the State of Idaho No. 45-7503, and said application is hereby APPROVED.

1. Approval of said application is subject to the following limitations and conditions:

- a. SUBJECT TO ALL PRIOR WATER RIGHTS.
- b. Proof of construction of works and application of water to beneficial use shall be submitted on or before October 1, 19 87.
- c. The rate of diversion, if water is to be used for irrigation under this permit, when combined with all other water rights for the same land shall not exceed 0.02 cubic feet per second for each acre of land.
- d. Other: Permit holder shall commence the excavation or construction of diverting works within one year of the date this permit is issued and shall proceed diligently until the project is complete.

An access port or other device as specified by the Department shall be installed by the permit holder to provide for the installation of measuring equipment and the determination of the rate of diversion by the Department.

Water shall not be diverted under this permit until a written agreement with the irrigation district or canal company serving the area containing the point of diversion is filed with the Department of Water Resources providing for the coordination of the permit use with the irrigation district or canal company operation.

Witness my hand this 7th day of October, 1982.

L. Glen Saxton
Chief, Operations Bureau