

IDAHO DEPARTMENT OF WATER RESOURCES
Proof Report

7/1/2020

Water Permit 45-7121

Owner Type Name
Current Owner JESSE F SEARLE

Status: **Lapsed**

Source

Tributary

Beneficial Use

From

To

Diversion Rate

Volume

Source and Point(s) of Diversion

Place Of Use

Conditions of Approval:

Combined Use Limits

N/A

SubCase:

N/A

Water Supply Bank:

N/A

February 23, 1973

Re. Permit No.: 45-7121

Jesse F. Searle
Box 192,
Route 3,
Burley, Idaho 83318

Dear Mr. Searle:

Enclosed is a copy of your approved Application for Permit No. 45-7121 . We direct your attention to the conditions of approval as listed on the fourth page.

Be sure to note that a special condition requiring you to install and maintain a measuring device at your point of diversion has been placed upon your permit. We are enclosing a letter describing different types of measuring devices accepted by this office.

Very truly yours,

BOBBY D. FLEENOR
Assistant Director

BDF: cd

Enclosures

RECEIVED

FEB 27 1973

Department of Water Administration
Southern District Office

Identification No. _____

Application No. 45-7121

STATE OF IDAHO

DEPARTMENT OF WATER ADMINISTRATION

APPLICATION FOR PERMIT

APPROVED

To Appropriate the Public Waters of the State of Idaho

(TYPE OR PRINT IN INK)

1. Name of applicant Jesse F. Searle
post office address Box 192, Route 3, Burley, ID 83318
2. Source of water supply Groundwater which is a tributary of _____
3. a. Location of point of diversion is SW $\frac{1}{4}$ of SE $\frac{1}{4}$ of Section 29 Township 11S
Range 24E B.M. Cassia County; additional points of diversion if any: _____

b. If water is not consumed, it will be discharged into _____ at a point in _____ $\frac{1}{4}$
of _____ $\frac{1}{4}$ of Section _____ Township _____ Range _____ B.M. _____
4. Water will be used for the following purposes:
Amount 1.6 for Irrigation purpose from March 15 to Nov. 15 (both dates inclusive)
(cfs or acre-feet per annum)
Amount _____ for _____ purpose from _____ to _____ (both dates inclusive)
(cfs or acre-feet per annum)
Amount _____ for _____ purpose from _____ to _____ (both dates inclusive)
(cfs or acre-feet per annum)
5. Total quantity to be appropriated:
a. 1.60 cubic feet per second and/or
b. _____ acre feet per annum.
6. Proposed diverting works:
a. Description of ditches, flumes, pumps, headgates, etc. well, pump, and electric motor
& Sprinkler System.

b. Height of storage dam _____ feet, active reservoir capacity _____ acre feet; total reservoir
capacity _____ acre feet, materials used in storage dam: _____
Period of year during which storage will occur _____ to _____ inclusive.
(Mo. Day) (Mo. Day)
c. Proposed well diameter is 20 inches; proposed depth of well is 800 feet.
7. a. Time required for the completion of the works and application of the water to the proposed beneficial use
is 5 years.
b. Estimated construction cost is \$ 30,000.00.
8. Description of proposed uses:
a. If water is **not** for irrigation:
(1) Give the place of use of water: _____ $\frac{1}{4}$ of _____ $\frac{1}{4}$ of Section _____ Township _____
Range _____ B.M. _____
(2) Amount of power to be generated: _____ hp under _____ feet of head.
(3) List number of each kind of livestock to be watered _____

(4) Name of municipality to be served _____, or number of families to be
supplied with domestic water _____.
(5) If water is to be used for other purposes describe: _____

45-7121

b. If water is for irrigation, indicate acreage in each subdivision in the tabulation below:

TWP.	RANGE	SEC.	NE¼				NW¼				SW¼				SE¼				TOTALS
			NE¼	NW¼	SW¼	SE¼	NE¼	NW¼	SW¼	SE¼	NE¼	NW¼	SW¼	SE¼	NE¼	NW¼	SW¼	SE¼	
11S	24E	29														40	40		80

Total number of acres to be irrigated 80

c. Describe any other water rights used for the same purposes as described above. None

9. a. Who owns the property at the point of diversion Applicant

b. Who owns the land to be irrigated or place of use Applicant

c. If the property is owned by a person other than the applicant, describe the arrangement enabling the applicant to make this filing

10. Remarks

11. Map of proposed project: show clearly the proposed point of diversion, place of use, section number, township and range number.

R 24 E

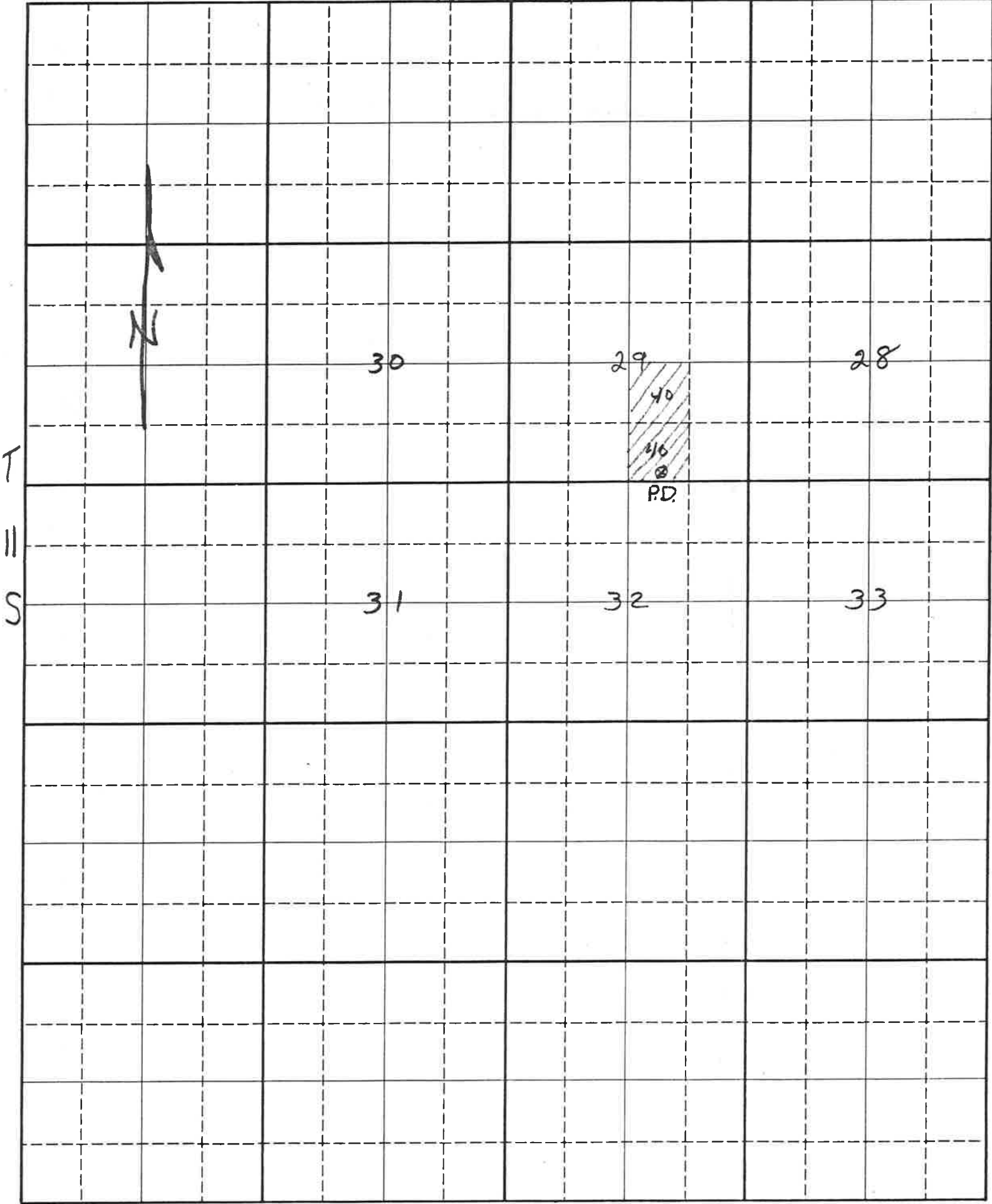

Scale: 2 inches equal 1 mile

BE IT KNOWN that the undersigned hereby makes application for permit to appropriate the public waters of the State of Idaho as herein set forth.

James F. Seale
(Applicant)

Proposed Priority 1-18-1973

Received by GLF Date 1-18-72 Time 2:25 P.M.

Preliminary check by _____ Fee \$ 35⁰⁰ # 9521

Receipted by GLF Date 1-18-73

Publication prepared by alw Date 1-19-73

Published in South Idaho Press, Burley, ID

Publication dates 1-30 & 2-6-73

Publication approved alw Date 2-13-73

Priority ~~reduced~~ to 1-18-73 Reason _____

Protests filed by: _____

Copies of protests forwarded by _____

Hearing held by _____ Date _____

Recommended for approval denial by BDF

ACTION OF THE DIRECTOR, DEPARTMENT OF WATER ADMINISTRATION

This is to certify that I have examined Application for Permit to appropriate the public waters of the State of Idaho No. 45-7121, and said application is hereby APPROVED.

1. Approval of said application is subject to the following limitations and conditions:

- a. SUBJECT TO ALL PRIOR WATER RIGHTS.
- b. Proof of construction of works and application of water to beneficial use shall be submitted on or before February 1, 1978.
- c. Other: A measuring device of a type approved by this Department shall be permanently installed and maintained as part of the diverting works.

2. Denial of said application is for the following reasons: _____

Witness my hand this 23rd day of February, 1973.

D. Karl Higgin
Director