

IDAHO DEPARTMENT OF WATER RESOURCES
Proof Report

7/1/2020

Water Permit 72-7254

<u>Owner Type</u>	<u>Name and Address</u>
Current Owner	VIOLA G STARK DUFFY , ZZ

Status: Lapsed

Source

Tributary

<u>Beneficial Use</u>	<u>From</u>	<u>To</u>	<u>Diversion Rate</u>	<u>Volume</u>
-----------------------	-------------	-----------	-----------------------	---------------

Source and Point(s) of Diversion

Place Of Use

Conditions of Approval:

Comments:

Dates and Other Information

Water District Number: TBD
Mitigation Plan: False

Combined Use Limits

N/A

SubCase:

N/A

Water Supply Bank:

N/A

7/1/2020

IDAHO DEPARTMENT OF WATER RESOURCES
Proof Report

7/1/2020

Water Application 72-7254

<u>Owner Type</u>	<u>Name and Address</u>
Current Owner	VIOLA G STARK DUFFY , ZZ

Status: Closed

<u>Source</u>	<u>Tributary</u>
---------------	------------------

<u>Beneficial Use</u>	<u>From</u>	<u>To</u>	<u>Diversion Rate</u>	<u>Volume</u>
-----------------------	-------------	-----------	-----------------------	---------------

Source and Point(s) of Diversion

Place Of Use

Conditions of Approval:

Comments:

Dates and Other Information

Number of Protests: 0
Water District Number: TBD
Application Type: New Appropriation
Mitigation Plan: False

Combined Use Limits

N/A

SubCase:

N/A

Water Supply Bank:

N/A



RECEIVED
MAY 17 1983
Department of Water Resources
Southern District Office

STATE OF IDAHO
DEPARTMENT OF WATER RESOURCES
APPLICATION FOR PERMIT

APPROVED

To appropriate the public waters of the State of Idaho

1. Name of applicant Viola G. Stark Duffy Phone 879-2587

Post office address P.O. Box 599 CHALLIS, IDA. 83226

2. Source of water supply groundwater which is a tributary of _____

3. Location of point of diversion is SW $\frac{1}{4}$ of NE $\frac{1}{4}$ of Section 34 Township 14N

Range 19E B.M. CUSTER County, additional points of diversion if any: _____

4. Water will be used for the following purposes:

Amount 0.04 cfs for IRRIGATION purposes from 4-1 to 11-1 (both dates inclusive)
(cfs or acre-feet per annum)

Amount 0.04 cfs for DOMESTIC purposes from JAN 1 to Dec 31 (both dates inclusive)
(cfs or acre-feet per annum)

Amount _____ for _____ purposes from _____ to _____ (both dates inclusive)
(cfs or acre-feet per annum)

Amount _____ for _____ purposes from _____ to _____ (both dates inclusive)
(cfs or acre-feet per annum)

5. Total quantity to be appropriated:

a. 0.08 cfs cubic feet per second and/or b. _____ acre-feet per annum.

6. Proposed diverting works:

a. Description of ditches, flumes, pumps, headgates, etc. WELL, MOTOR, PUMP.
PRESSURE TANK.

b. Height of storage dam _____ feet, active reservoir capacity _____ acre-feet; total reservoir capacity _____ acre-feet, materials used in storage dam: _____

Period of year when water will be diverted to storage _____ to _____ inclusive.
(Month/Day) (Month/Day)

c. Proposed well diameter is 6 inches; proposed depth of well is 102' feet.

7. Time required for the completion of the works and application of the water to the proposed beneficial use is 5 years (minimum 1 year — maximum 5 years).

8. Description of proposed uses:

a. If water is not for irrigation:

(1) Give the place of use of water: SW $\frac{1}{4}$ of NE $\frac{1}{4}$ of Section 34 Township 14N
Range 19E B.M.

(2) Amount of power to be generated: _____ horsepower under _____ feet of head.

(3) List number of each kind of livestock to be watered _____

(4) Name of municipality to be served _____, or number of families to be supplied with domestic water (1).

(5) If water is to be used for other purposes describe: _____

72-7254

b. If water is for irrigation, indicate acreage in each subdivision in the tabulation below:

TWP	RANGE	SEC.	NE¼				NW¼				SW¼				SE¼				TOTALS
			NE¼	NW¼	SW¼	SE¼	NE¼	NW¼	SW¼	SE¼	NE¼	NW¼	SW¼	SE¼	NE¼	NW¼	SW¼	SE¼	
14N	19E	34			2														2

Total number of acres to be irrigated _____

c. Describe any other water rights used for the same purposes as described above. NONE.

9. a. Who owns the property at the point of diversion Applicant

b. Who owns the land to be irrigated or place of use Applicant

c. If the property is owned by a person other than the applicant, describe the arrangement enabling the applicant to make this filing _____

10. Remarks _____

11. Map of proposed project: show clearly the proposed point of diversion, place of use, section number, township and range number.

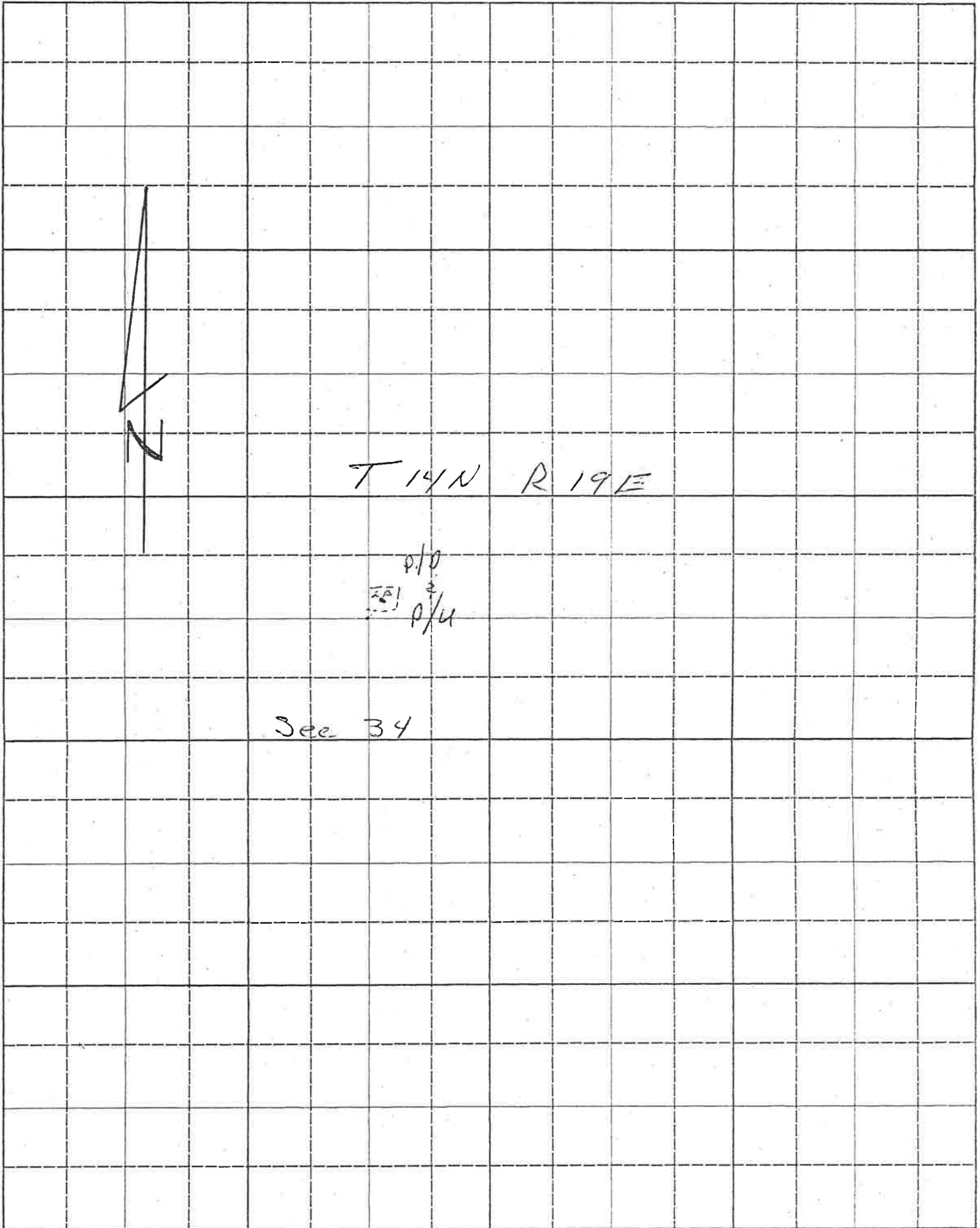

Scale: 2 inches equal 1 mile.

BE IT KNOWN that the undersigned hereby makes application for permit to appropriate the public waters of the State of Idaho as herein set forth.

x Viola C. Stark Duffy
(Applicant)

Proposed Priority 2/3/1983

Received by A. J. Indebry Date 2/3/1983 Time 9:50 A.M.

Preliminary check by Q Fee \$ 30.00

Receipted by macepa Date 2/14/83 # 23994

Publication prepared by macepa Date 3/8/83

Published in Custer Publishing Co

Publication dates 3/17 & 3/24/83

Publication approved macepa Date 3/28/83

Protests filed by: None

Copies of protests forwarded by _____

Hearing held by _____ Date _____

Recommended for approval denial by ADN

ACTION OF THE DIRECTOR, DEPARTMENT OF WATER RESOURCES

This is to certify that I have examined Application for Permit to appropriate the public waters of the State of Idaho No. 72-7254, and said application is hereby APPROVED.

1. Approval of said application is subject to the following limitations and conditions:

- a. SUBJECT TO ALL PRIOR WATER RIGHTS.
- b. Proof of construction of works and application of water to beneficial use shall be submitted on or before May 1, 19 88.
- c. The rate of diversion, if water is to be used for irrigation under this permit, when combined with all other water rights for the same land shall not exceed 0.02 cubic feet per second for each acre of land.
- d. Other: Permit holder shall commence the excavation or construction of diverting works within one year of the date this permit is issued and shall proceed diligently until the project is complete.

Witness my hand this 2nd day of May, 1983.

J. Glen Saxton
Chief, Operations Bureau