

7/1/2020

<u>Owner Type</u>	<u>Name and Address</u>
Current Owner	MARTY J JENNINGS , ZZ

Current Owner WILLIAM M JENNINGS
, ZZ

Tributary

N/A

7/1/2020

<u>Owner Type</u>	<u>Name and Address</u>
Current Owner	MARTY J JENNINGS , ZZ

Current Owner WILLIAM M JENNINGS
, ZZ

Source

Tributary

From

To

Diversion Rate

Volume

Source and Point(s) of Diversion

Place Of Use

Conditions of Approval:

Comments:

Dates and Other Information

Number of Protests: 0
Water District Number: TBD
Application Type: New Appropriation
Mitigation Plan: False

Combined Use Limits

N/A

SubCase:

N/A

Water Supply Bank:

N/A

RECEIVED

SEP 8 1988

BEFORE THE DEPARTMENT OF WATER RESOURCES

Department of Water Resources
Southern Region Office

OF THE
STATE OF IDAHO

IN THE MATTER OF PERMIT NO. 72-7270 IN THE)
NAME OF WILLIAM M. OR MARTY J. JENNINGS)
_____)

ORDER

WHEREAS, the Department issued the above-captioned permit and subsequent request for extension of time with the condition that proof of construction of works and application of water to beneficial use be submitted on or before October 1, 1988; and,

WHEREAS, proper notice was not given to the permit holders sixty days prior to the date that proof of beneficial use of water was due as required by section 42-204, Idaho Code;

IT IS, THEREFORE, HEREBY ORDERED that the time within which to submit proof of beneficial use be extended to November 1, 1988.

Dated this 1st day of September, 1988.

L. GLEN SAXTON
Chief, Operations Bureau

72-7270

STATE OF IDAHO
DEPARTMENT OF WATER RESOURCES
APPLICATION FOR PERMIT

RECEIVED
NOV 14 1983

RECEIVED
APPROVED
MAY 12 1983

To appropriate the public waters of the State of Idaho

Department of Water Resources

1. Name of applicant William M. or Marty J. Jennings Phone 736-4332

Post office address P.O. Box 2228, Salmon, Idaho 83467

2. Source of water supply Groundwater which is a tributary of _____

3. Location of point of diversion is SE $\frac{1}{4}$ of NE $\frac{1}{4}$ of Section 31 Township 14 N

Range 19 E B.M. Custer County, additional points of diversion if any: _____

4. Water will be used for the following purposes:

Amount 0.12 cfs for Irrigation purposes from 4/1 to 11/1 (both dates inclusive)
(cfs or acre-feet per annum)

Amount _____ for _____ purposes from _____ to _____ (both dates inclusive)
(cfs or acre-feet per annum)

Amount _____ for _____ purposes from _____ to _____ (both dates inclusive)
(cfs or acre-feet per annum)

Amount _____ for _____ purposes from _____ to _____ (both dates inclusive)
(cfs or acre-feet per annum)

5. Total quantity to be appropriated:

a. 0.12 cubic feet per second and/or b. _____ acre-feet per annum.

6. Proposed diverting works:

a. Description of ditches, flumes, pumps, headgates, etc. well pump with distribution line to sprinklers and stock watering

b. Height of storage dam _____ feet, active reservoir capacity _____ acre-feet; total reservoir capacity _____ acre-feet, materials used in storage dam: _____

Period of year when water will be diverted to storage _____ to _____ inclusive.
(Month/Day) (Month/Day)

c. Proposed well diameter is 6 inches; proposed depth of well is 100 feet.

7. Time required for the completion of the works and application of the water to the proposed beneficial use is 5 years (minimum 1 year — maximum 5 years).

8. Description of proposed uses:

a. If water is not for irrigation:

(1) Give the place of use of water: _____ $\frac{1}{4}$ of _____ $\frac{1}{4}$ of Section _____ Township _____

Range _____ B.M. _____

(2) Amount of power to be generated: _____ horsepower under _____ feet of head.

(3) List number of each kind of livestock to be watered _____

(4) Name of municipality to be served _____, or number of families to be supplied with domestic water _____

(5) If water is to be used for other purposes describe: _____

72-7270

b. If water is for irrigation, indicate acreage in each subdivision in the tabulation below:

TWP	RANGE	SEC.	NE¼				NW¼				SW¼				SE¼				TOTALS
			NE¼	NW¼	SW¼	SE¼	NE¼	NW¼	SW¼	SE¼	NE¼	NW¼	SW¼	SE¼	NE¼	NW¼	SW¼	SE¼	
14N	19E	31				4													4

Total number of acres to be irrigated 4

c. Describe any other water rights used for the same purposes as described above. _____

9. a. Who owns the property at the point of diversion Applicant

b. Who owns the land to be irrigated or place of use applicant

c. If the property is owned by a person other than the applicant, describe the arrangement enabling the applicant to make this filing _____

10. Remarks _____

11. Map of proposed project: show clearly the proposed point of diversion, place of use, section number, township and range number.

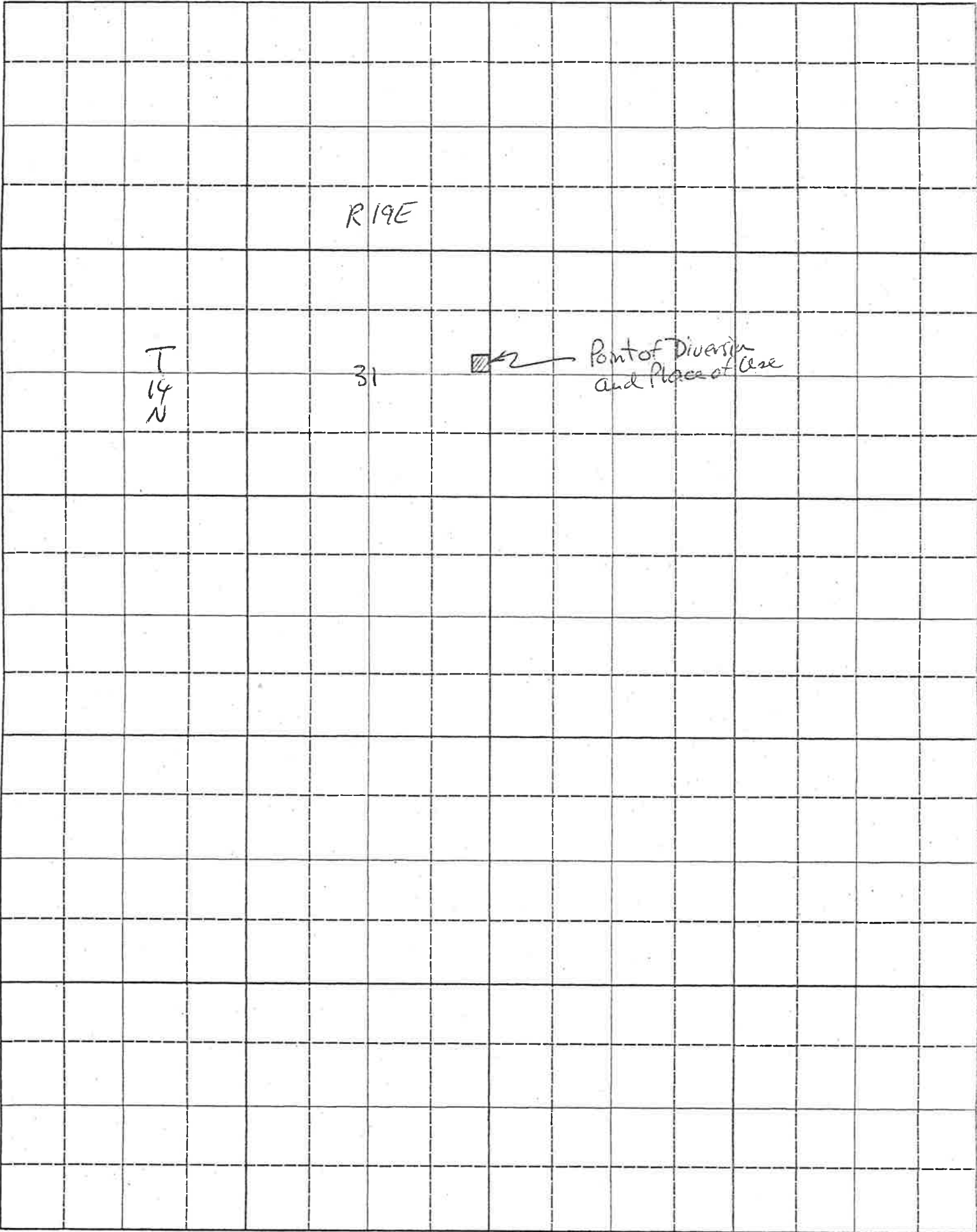

Scale: 2 inches equal 1 mile.

BE IT KNOWN that the undersigned hereby makes application for permit to appropriate the public waters of the State of Idaho as herein set forth.

Marty J. Jennings
(Applicant)
William M. Jennings

Proposed Priority 5/12/83

Received by menya Date 5/12/83 Time 11:30 a

Preliminary check by J Fee \$ 30⁰⁰

Receipted by menya Date 5/12/83 # 27336

Publication prepared by menya Date 9/1/83

Published in Euster Publishing Co

Publication dates 9/8 + 9/15/83 9/15 + 9/22/83

Publication approved menya Date 9/26/83

Protests filed by: None

Copies of protests forwarded by _____

Hearing held by _____ Date _____

Recommended for approval denial by ADM kw

ACTION OF THE DIRECTOR, DEPARTMENT OF WATER RESOURCES

This is to certify that I have examined Application for Permit to appropriate the public waters of the State of Idaho No. 72-7270 , and said application is hereby APPROVED .

1. Approval of said application is subject to the following limitations and conditions:

- a. SUBJECT TO ALL PRIOR WATER RIGHTS.
- b. Proof of construction of works and application of water to beneficial use shall be submitted on or before October 1 , 19 88 .
- c. The rate of diversion, if water is to be used for irrigation under this permit, when combined with all other water rights for the same land shall not exceed 0.02 cubic feet per second for each acre of land.
- d. Other: Permit holder shall commence the excavation or construction of diverting works within one year of the date this permit is issued and shall proceed diligently until the project is complete.

Witness my hand this 20th day of October, 1983.

J. Glen Saxton
Chief, Operations Bureau