

7/21/2020

<u>Owner Type</u>	<u>Name and Address</u>
Current Owner	RODNEY J CHRISTENSEN , ZZ
Current Owner	CHARLENE CHRISTENSEN , ZZ

N/A



State of Idaho
Department of Water Resources
Permit To Appropriate Water

NO. 45-07723

Proposed Priority: April 29, 1994

Maximum Storage Volume: 0.3 AF

This is to certify, that **RODNEY J CHRISTENSEN**
CHARLENE CHRISTENSEN
RT 1 BOX 1698
BURLEY ID 83318

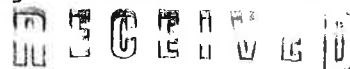

JUL 08 1994

has applied for a permit to appropriate water from:

Department of Water Resources
Boise Office

SPRINGS

tributary of **SPRING CREEK**

and a permit is **APPROVED** for development of water as follows:

<u>BENEFICIAL USE</u>	<u>PERIOD OF USE</u>	<u>RATE OF DIVERSION</u>	<u>ANNUAL VOLUME</u>
RECREATION STORAGE	01/01 to 12/31		0.3 AF

LOCATION OF POINT(S) OF DIVERSION:

NWENW , Sec. 32, Township 10S, Range 24E
CASSIA County

PLACE OF USE: RECREATION STORAGE

TWN RGE SEC

10S 24E 32

NENW

CONDITIONS/REMARKS:

1. Proof of construction of works and application of water to beneficial use shall be submitted on or before July 1, 1996.
2. Subject to all prior water rights.
3. Project construction shall commence within one year from the date of permit issuance and shall proceed diligently to completion unless it can be shown to the satisfaction of the Director of the Department of Water Resources that delays were due to circumstances over which permit holder had no control.
4. Use of water under this right is subject to control by the watermaster of State Water District No. 01.
5. Recreation use is for a pond for fishing.

This permit is issued pursuant to the provisions of Section 42-204, Idaho Code.
Witness the signature of the Director, affixed at Boise, this

23rd day of June, 1994.

R. Keith Higginson
R. Keith Higginson, Director

bon

45-07723

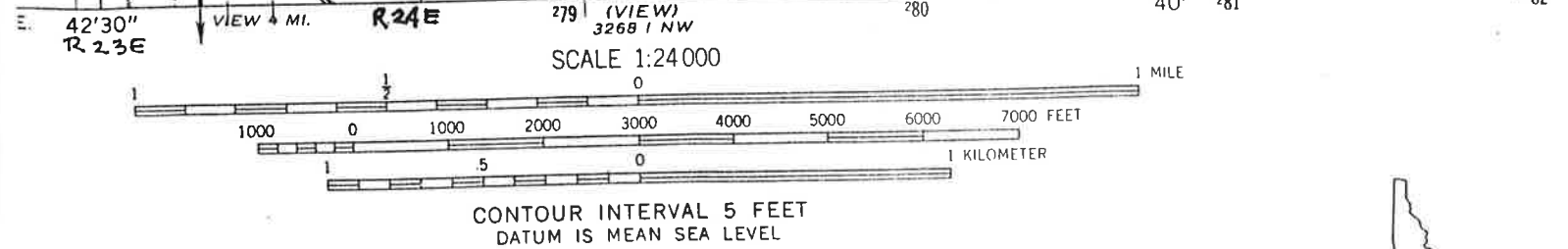
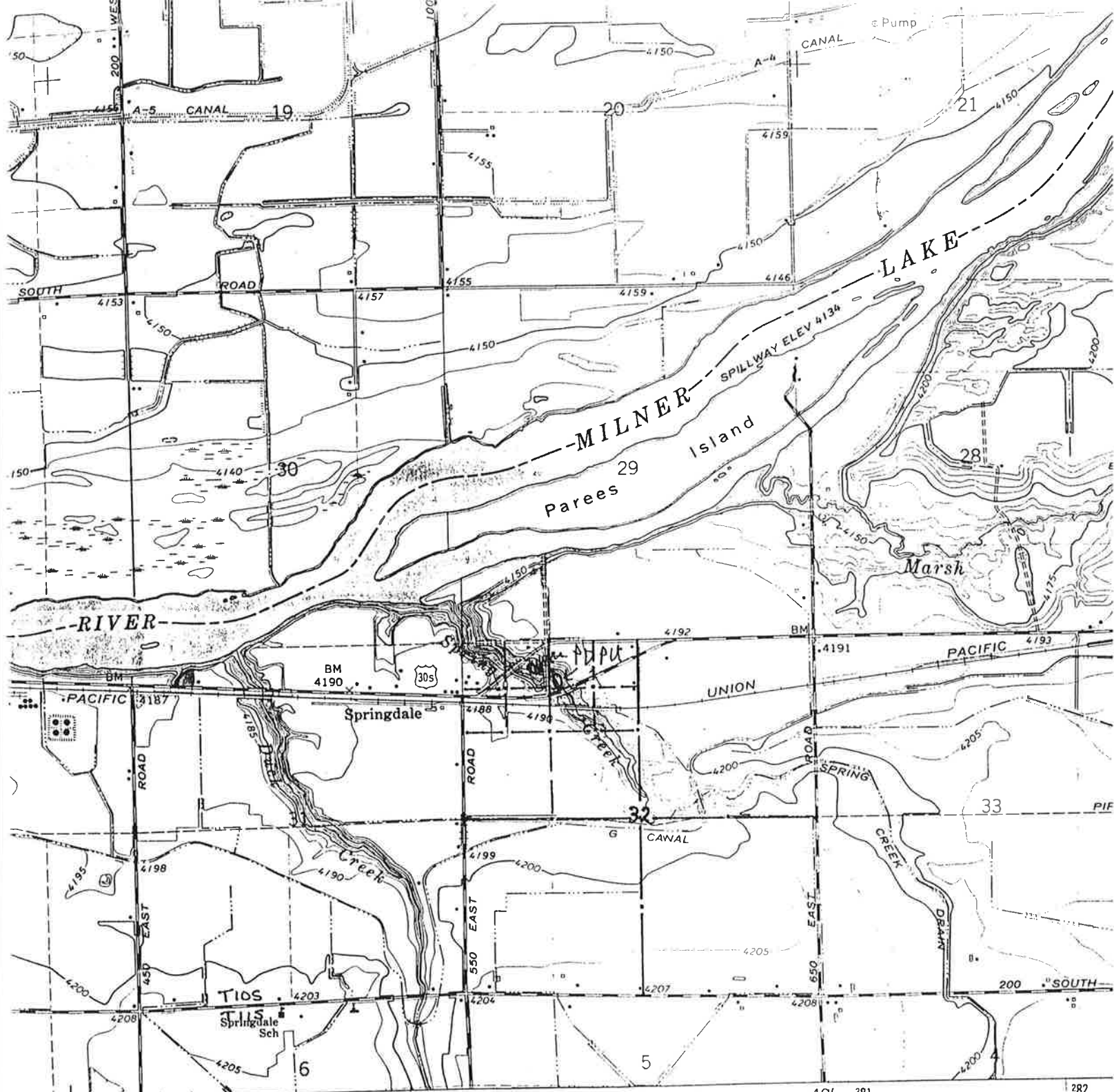

THIS MAP COMPLIES WITH NATIONAL MAP ACCURACY STANDARDS
FOR SALE BY U. S. GEOLOGICAL SURVEY, DENVER, COLORADO 80225. OR WASHINGTON, D. C. 20242
A FOLDER DESCRIBING TOPOGRAPHIC MAPS AND SYMBOLS IS AVAILABLE ON REQUEST

45-07723

Date Sent to S JUN 13 1994

Form 202

RECEIVED

STATE OF IDAHO
DEPARTMENT OF WATER RESOURCES
APPLICATION FOR PERMIT

Ident. No. 45-07723

APR 29 1994

Department of Water resources To appropriate the public waters of the State of Idaho
Southern Region Office

1. Name of applicant Rodney J. &/or Charlene Christensen Phone 654-2107
Post office address RT. 1 Box 1698, Burley, ID 83318
2. Source of water supply Springs which is a tributary of Spring Creek
3. Location of point of diversion is NW $\frac{1}{4}$ of NE $\frac{1}{4}$ of NW $\frac{1}{4}$, Govt. Lot _____
Sec. 32 Township 10S Range 24E B.M. Cassia County; additional points of diversion if any: _____
4. Water will be used for the following purposes:
Amount 0.3 for Storage for Recreation purposes from 1-1 to 12-31 (both dates inclusive)
(cfs or acre-feet per annum)
Amount _____ for _____ purposes from _____ to _____ (both dates inclusive)
(cfs or acre-feet per annum)
Amount _____ for _____ purposes from _____ to _____ (both dates inclusive)
(cfs or acre-feet per annum)
Amount _____ for _____ purposes from _____ to _____ (both dates inclusive)
(cfs or acre-feet per annum)
5. Total quantity to be appropriated is (a) _____ and/or (b) 0.3
cubic feet per second acre feet per annum
6. Proposed diverting works:
 - a. Description of ditches, flumes, pumps, headgates, etc. Dam & Pond dug to catch spring water, overflow to Spring Creek.
 - b. Height of storage dam 8 feet; active reservoir capacity 0.15 acre-feet; total reservoir capacity 0.3 acre-feet; period of year when water will be diverted to storage: 1-1 to 12-31 inclusive.
 - c. Proposed well diameter is _____ inches; proposed depth of well is _____ feet.
 - d. Is ground water with a temperature of greater than 85°F being sought? _____
 - e. If well is already drilled, when? _____; Drilling firm _____;
Well was drilled for (well owner) _____
7. Time required for the completion of the works and application of the water to be proposed beneficial use is 2 years (minimum 1 year).

45-07723

8. Description of proposed uses (if irrigation only, go to item 9):
- Hydropower; show total feet of head and proposed capacity in KW. _____
 - Stockwatering; list number and kind of livestock. _____
 - Municipal; show name of municipality. _____
 - Domestic; show number of households. _____
 - Other; describe fully. Recreation - pond for fishing, etc. (private use)

9. Description of place of use:

- If water is for irrigation, indicate acreage in each subdivision in the tabulation below.
- If water is used for other purposes, place a symbol of the use (example: D for Domestic) in the corresponding place of use below. See instructions for standard symbols.

TWP	RANGE	SEC.	NE¼				NW¼				SW¼				SE¼				TOTALS
			NE¼	NW¼	SW¼	SE¼	NE¼	NW¼	SW¼	SE¼	NE¼	NW¼	SW¼	SE¼	NE¼	NW¼	SW¼	SE¼	
10S	24E	32					AS												

AS recreation storage

Total number of acres to be irrigated _____

10. Describe any other water rights used for the same purposes as described above. _____
11. a. Who owns the property at the point of diversion? Applicants
- b. Who owns the land to be irrigated or place of use? "
- c. If the property is owned by a person other than the applicant, describe the arrangement enabling the applicant to make this filing. _____
12. Remarks: This application replaces lapsed permit 45-07630.

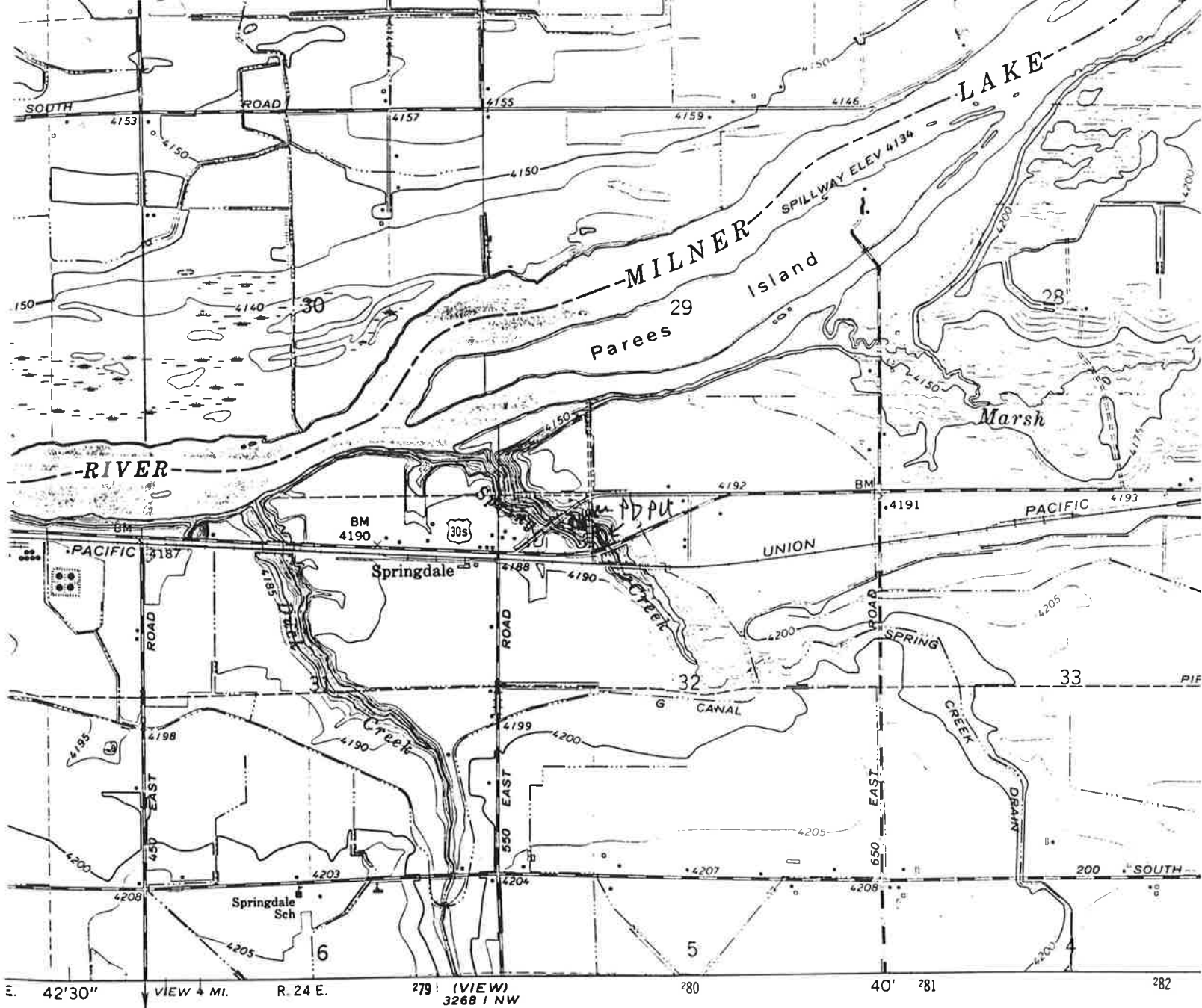

SCALE 1:24 000

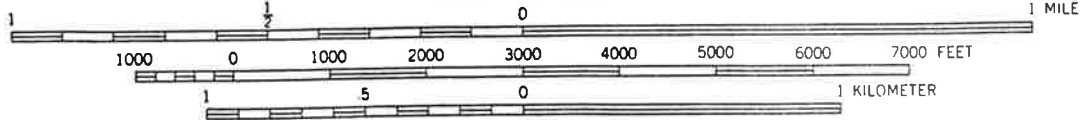

CONTOUR INTERVAL 5 FEET
DATUM IS MEAN SEA LEVEL



THIS MAP COMPLIES WITH NATIONAL MAP ACCURACY STANDARDS
FOR SALE BY U. S. GEOLOGICAL SURVEY, DENVER, COLORADO 80225, OR WASHINGTON, D. C. 20242
A FOLDER DESCRIBING TOPOGRAPHIC MAPS AND SYMBOLS IS AVAILABLE ON REQUEST

45-0 7723

BE IT KNOWN that the undersigned hereby makes application for permit to appropriate the public waters of the State of Idaho as herein set forth.

Rodney Christman
(Applicant)

Received by J.F. Stanton Date 4-29-94 Time 11:20 am Preliminary check by MTS
Fee \$ 30.00 Receipted by [Signature] # 5016832 Date 4-29-94
Publication prepared by MB Date 5/10/94 Published in So. Id. Press
Publication approved MBaldwin Date 5/27/94

ACTION OF THE DIRECTOR, DEPARTMENT OF WATER RESOURCES

This is to certify that I have examined Application for Permit to appropriate the public waters of the State of Idaho No. _____, and said application is hereby _____.

1. Approval of said application is subject to the following limitations and conditions:

a. SUBJECT TO ALL PRIOR WATER RIGHTS.

b. Proof of construction of works and application of water to beneficial use shall be submitted on or before _____, 19 ____.

c. The rate of diversion, if water is to be used for irrigation under this permit, when combined with all other water rights for the same land shall not exceed 0.02 cubic feet per second for each acre of land.

d. The water right acquired under this permit if for hydropower purposes shall be junior and subordinate to all rights to the use of water, other than hydropower, within the State of Idaho that are initiated later in time than the priority of this permit and shall not give rise to any right or claim against any future rights to the use of water, other than hydropower, within the State of Idaho initiated later in time than the priority of this permit.

e. Other: